

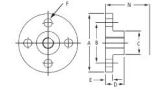

# MBA

## Actuators - Screw - Translating - Top Plate



Precision linear adjustment.

Material : Steel.

### Actuators - Screw - Translating - Top Plate

| Part Number | Suits Actuator Size | Plate Hub Diameter (C) mm | Plate Hub Diameter (C) mm | Plate Overall Thickness (D) mm | Plate Flange Thickness (E) mm | Plate Bolt Hole Size (F) mm | M and N Upr/Inv mm |
|-------------|---------------------|---------------------------|---------------------------|--------------------------------|-------------------------------|-----------------------------|--------------------|
|             |                     | <i>inches</i>             | <i>inches</i>             | <i>inches</i>                  | <i>inches</i>                 | <i>inches</i>               | <i>inches</i>      |
| # SJ10TP    | 10                  | 65.0<br><i>2.559</i>      | 25.0<br><i>0.984</i>      | 21.0<br><i>0.827</i>           | 8.0<br><i>0.315</i>           | 9<br><i>0.354</i>           | 115 / 600          |
| # SJ14TP    | 14                  | 80.0<br><i>3.150</i>      | 30.0<br><i>1.181</i>      | 24.0<br><i>0.945</i>           | 10.0<br><i>0.394</i>          | 11<br><i>0.433</i>          | 145 / 650          |
| # SJ16TP    | 16                  | 100.0<br><i>3.937</i>     | 40.0<br><i>1.575</i>      | 31.5<br><i>1.240</i>           | 12.0<br><i>0.472</i>          | 13.5<br><i>0.531</i>        | 170 / 800          |
| # SJ19TP    | 19                  | 120.0<br><i>4.724</i>     | 50.0<br><i>1.969</i>      | 36.5<br><i>1.437</i>           | 16.0<br><i>0.630</i>          | 18<br><i>0.709</i>          | 215 / 900          |

# Indicates item not stocked at time of printing - Please enquire for lead time

E&OE Pricing and all details subject to change without notice - Copyright Miniature Bearings Australia Pty Ltd

MBA Size Listings are a guide to sizes only and must not be solely relied on for critical design information.

## Actuators - Screw - Translating - Top Plate

| Part Number | Suits Actuator Size | Plate Hub Diameter (C) mm | Plate Hub Diameter (C) mm | Plate Overall Thickness (D) mm | Plate Flange Thickness (E) mm | Plate Bolt Hole Size (F) mm | M and N Upr/Inv mm |
|-------------|---------------------|---------------------------|---------------------------|--------------------------------|-------------------------------|-----------------------------|--------------------|
|             |                     | <i>inches</i>             | <i>inches</i>             | <i>inches</i>                  | <i>inches</i>                 | <i>inches</i>               | <i>inches</i>      |
| # SJ25TP    | 25                  | 150.0                     | 65.0                      | 42.0                           | 20.0                          | 22                          | 245 / 125          |
|             |                     | 5.906                     | 2.559                     | 1.654                          | 0.787                         | 0.866                       |                    |

# Indicates item not stocked at time of printing - Please enquire for lead time

E&OE Pricing and all details subject to change without notice - Copyright Miniature Bearings Australia Pty Ltd

MBA Size Listings are a guide to sizes only and must not be solely relied on for critical design information.



DISTRIBUTED BY

Ask us to put your name and address here

<http://www.minibearings.com.au/product>

Ph +61 7 3245 7977

Fax +61 7 3245 1017

Catalogue requests to [catalogues@minibearings.com.au](mailto:catalogues@minibearings.com.au)

