

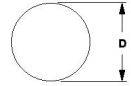

MBA

Balls - Chrome Steel



Hardness: Rockwell C: 60-70.

Tolerances available on request.

SAE 52100 Chrome Steel.

Hardness: Rockwell C: 60-70.

Specific Gravity: 7.833.

This catalogue to be read in conjunction with information at <http://www.minibearings.com.au/ical/balls/>
<http://www.minibearings.com.au/categories/balls/all/pics/>

Balls - Chrome Steel

Part Number	Diameter (D) mm <i>inches</i>	Material	Precision Grade	Hardness	Properties	Colour	Specific Gravity
BL-00.250-CH-G3	0.250 <i>0.010</i>	SAE52100	Grade 3	Rockwell C: 60-70			7.833
# BL-00.300-CH-G3	0.300 <i>0.012</i>	SAE52100	Grade 3	Rockwell C: 60-70			7.833
# BL-00.200-CH-G3	0.200 <i>0.008</i>	SAE52100	Grade 3	Rockwell C: 60-70			7.833

Indicates item not stocked at time of printing - Please enquire for lead time

E&OE Pricing and all details subject to change without notice - Copyright Miniature Bearings Australia Pty Ltd

MBA Size Listings are a guide to sizes only and must not be solely relied on for critical design information.

Balls - Chrome Steel

Part Number	Diameter (D) mm <i>inches</i>	Material	Precision Grade	Hardness	Properties	Colour	Specific Gravity
BL-00.397-CH-G3	0.397 <i>0.016</i>	SAE52100	Grade 3	Rockwell C: 60-70			7.833
# BL-00.400-CH-G28	0.400 <i>0.016</i>	SAE52100	Grade 28	Rockwell C: 60-70			7.833
# BL-00.500-CH-G3	0.500 <i>0.020</i>	SAE52100	Grade 3	Rockwell C: 60-70			7.833
# BL-00.600-CH-G3	0.600 <i>0.024</i>	SAE52100	Grade 3	Rockwell C: 60-70			7.833
# BL-00.650-CH-G3	0.650 <i>0.026</i>	SAE52100	Grade 3	Rockwell C: 60-70			7.833
# BL-00.700-CH-G28	0.700 <i>0.028</i>	SAE52100	Grade 28	Rockwell C: 60-70			7.833
# BL-00.794-CH-G3	0.794 <i>0.031</i>	SAE52100	Grade 3	Rockwell C: 60-70			7.833
BL-01.000-CH-G16	1.000 <i>0.039</i>	SAE52100	Grade 16	Rockwell C: 60-70			7.833
# BL-01.150-CH-G3	1.150 <i>0.045</i>	SAE52100	Grade 3	Rockwell C: 60-70			7.833
BL-01.191-CH-G3	1.191 <i>0.047</i>	SAE52100	Grade 3	Rockwell C: 60-70			7.833

Indicates item not stocked at time of printing - Please enquire for lead time

E&OE Pricing and all details subject to change without notice - Copyright Miniature Bearings Australia Pty Ltd

MBA Size Listings are a guide to sizes only and must not be solely relied on for critical design information.

Balls - Chrome Steel

Part Number	Diameter (D) mm <i>inches</i>	Material	Precision Grade	Hardness	Properties	Colour	Specific Gravity
# BL-01.200-CH-G28	1.200 <i>0.047</i>	SAE52100	Grade 28	Rockwell C: 60-70			7.833
# BL-01.500-CH-G28	1.500 <i>0.059</i>	SAE52100	Grade 28	Rockwell C: 60-70			7.833
# BL-01.500-CH-G2000x1KG	1.500 <i>0.059</i>	SAE52100	Grade 2000	Rockwell C: 60-70	1 KG = Approx 70,000 Balls		7.833
# BL-01.588-CH-G3	1.588 <i>0.063</i>	SAE52100	Grade 3	Rockwell C: 60-70			7.833
# BL-01.588-CH-G25	1.588 <i>0.063</i>	SAE52100	Grade 25	Rockwell C: 60-70			7.833
# BL-01.750-CH-G3	1.750 <i>0.069</i>	SAE52100	Grade 3	Rockwell C: 60-70			7.833
BL-02.000-CH-G10	2.000 <i>0.079</i>	SAE52100	Grade 10	Rockwell C: 60-70			7.833
# BL-02.100-CH-G3	2.100 <i>0.083</i>	SAE52100	Grade 3	Rockwell C: 60-70			7.833
BL-02.381-CH-G25	2.381 <i>0.094</i>	SAE52100	Grade 25	Rockwell C: 60-70			7.833
# BL-02.381-CH-G3	2.381 <i>0.094</i>	SAE52100	Grade 3	Rockwell C: 60-70			7.833

Indicates item not stocked at time of printing - Please enquire for lead time

E&OE Pricing and all details subject to change without notice - Copyright Miniature Bearings Australia Pty Ltd

MBA Size Listings are a guide to sizes only and must not be solely relied on for critical design information.

Balls - Chrome Steel

Part Number	Diameter (D) mm <i>inches</i>	Material	Precision Grade	Hardness	Properties	Colour	Specific Gravity
# BL-02.450-CH-G3	2.450 <i>0.096</i>	SAE52100	Grade 3	Rockwell C: 60-70			7.833
# BL-02.500-CH-G28	2.500 <i>0.098</i>	SAE52100	Grade 28	Rockwell C: 60-70			7.833
# BL-03.000-CH-G28	3.000 <i>0.118</i>	SAE52100	Grade 28	Rockwell C: 60-70			7.833
# BL-03.175-CH-G25	3.175 <i>0.125</i>	SAE52100	Grade 25	Rockwell C: 60-70			7.833
BL-03.400-CH-G25	3.400 <i>0.134</i>	SAE52100	25	Rockwell C: 60-70	-	-	7.833
BL-03.500-CH-G28	3.500 <i>0.138</i>	SAE52100	Grade 28	Rockwell C: 60-70			7.833
BL-03.969-CH-G25	3.969 <i>0.156</i>	SAE52100	Grade 25	Rockwell C: 60-70			7.833
# BL-04.000-CH-G28	4.000 <i>0.157</i>	SAE52100	Grade 28	Rockwell C: 60-70			7.833
# BL-04.500-CH-G28	4.500 <i>0.177</i>	SAE52100	Grade 28	Rockwell C: 60-70			7.833
# BL-04.762-CH-G25	4.763 <i>0.188</i>	SAE52100	Grade 25	Rockwell C: 60-70			7.833

Indicates item not stocked at time of printing - Please enquire for lead time

E&OE Pricing and all details subject to change without notice - Copyright Miniature Bearings Australia Pty Ltd

MBA Size Listings are a guide to sizes only and must not be solely relied on for critical design information.

Balls - Chrome Steel

Part Number	Diameter (D) mm <i>inches</i>	Material	Precision Grade	Hardness	Properties	Colour	Specific Gravity
BL-04.762-CH-G20	4.763 <i>0.188</i>	SAE52100	Grade 20	Rockwell C: 60-70			7.833
BL-05.000-CH-G28	5.000 <i>0.197</i>	SAE52100	Grade 28	Rockwell C: 60-70			7.833
# BL-05.000-CH-G3	5.000 <i>0.197</i>	SAE52100	Grade 3	Rockwell C: 60-70			7.833
# BL-05.500-CH-G28	5.500 <i>0.217</i>	SAE52100	Grade 28	Rockwell C: 60-70			7.833
BL-05.556-CH-G25	5.556 <i>0.219</i>	SAE52100	Grade 25	Rockwell C: 60-70			7.833
# BL-05.556-CH-G28	5.556 <i>0.219</i>	SAE52100	Grade 28	Rockwell C: 60-70			7.833
# BL-06.350-CH-G20	6.350 <i>0.250</i>	SAE52100	Grade 20	Rockwell C: 60-70			7.833
BL-06.350-CH-G25	6.350 <i>0.250</i>	SAE52100	Grade 25	Rockwell C: 60-70			7.833
# BL-06.500-CH-G28	6.500 <i>0.256</i>	SAE52100	Grade 28	Rockwell C: 60-70			7.833
# BL-07.000-CH-G28	7.000 <i>0.276</i>	SAE52100	Grade 28	Rockwell C: 60-70			7.833

Indicates item not stocked at time of printing - Please enquire for lead time

E&OE Pricing and all details subject to change without notice - Copyright Miniature Bearings Australia Pty Ltd

MBA Size Listings are a guide to sizes only and must not be solely relied on for critical design information.

Balls - Chrome Steel

Part Number	Diameter (D) mm <i>inches</i>	Material	Precision Grade	Hardness	Properties	Colour	Specific Gravity
# BL-07.144-CH-G28	7.144 <i>0.281</i>	SAE52100	Grade 28	Rockwell C: 60-70			7.833
# BL-07.500-CH-G28	7.500 <i>0.295</i>	SAE52100	Grade 28	Rockwell C: 60-70			7.833
BL-07.938-CH-G25	7.938 <i>0.313</i>	SAE52100	Grade 25	Rockwell C: 60-70			7.833
# BL-07.938-CH-G28	7.938 <i>0.313</i>	SAE52100	Grade 28	Rockwell C: 60-70			7.833
# BL-08.500-CH-G28	8.500 <i>0.335</i>	SAE52100	Grade 28	Rockwell C: 60-70			7.833
# BL-08.731-CH-G28	8.731 <i>0.344</i>	SAE52100	Grade 28	Rockwell C: 60-70			7.833
# BL-09.000-CH-G28	9.000 <i>0.354</i>	SAE52100	Grade 28	Rockwell C: 60-70			7.833
BL-09.525-CH-G25	9.525 <i>0.375</i>	SAE52100	Grade 25	Rockwell C: 60-70			7.833
# BL-10.319-CH-G28	10.319 <i>0.406</i>	SAE52100	Grade 28	Rockwell C: 60-70			7.833
# BL-11.000-CH-G28	11.000 <i>0.433</i>	SAE52100	Grade 28	Rockwell C: 60-70			7.833

Indicates item not stocked at time of printing - Please enquire for lead time

E&OE Pricing and all details subject to change without notice - Copyright Miniature Bearings Australia Pty Ltd

MBA Size Listings are a guide to sizes only and must not be solely relied on for critical design information.

Balls - Chrome Steel

Part Number	Diameter (D) mm <i>inches</i>	Material	Precision Grade	Hardness	Properties	Colour	Specific Gravity
# BL-11.113-CH-G28	11.112 <i>0.437</i>	SAE52100	Grade 28	Rockwell C: 60-70			7.833
# BL-11.500-CH-G28	11.500 <i>0.453</i>	SAE52100	Grade 28	Rockwell C: 60-70			7.833
# BL-11.906-CH-G28	11.906 <i>0.469</i>	SAE52100	Grade 28	Rockwell C: 60-70			7.833
# BL-12.000-CH-G28	12.000 <i>0.472</i>	SAE52100	Grade 28	Rockwell C: 60-70			7.833
# BL-12.500-CH-G28	12.500 <i>0.492</i>	SAE52100	Grade 28	Rockwell C: 60-70			7.833
BL-12.700-CH-G25	12.700 <i>0.500</i>	SAE52100	Grade 25	Rockwell C: 60-70			7.833

Indicates item not stocked at time of printing - Please enquire for lead time

E&OE Pricing and all details subject to change without notice - Copyright Miniature Bearings Australia Pty Ltd

MBA Size Listings are a guide to sizes only and must not be solely relied on for critical design information.



DISTRIBUTED BY

Ask us to put your name and address here

<http://www.minibearings.com.au/product>

Ph +61 7 3245 7977

Fax +61 7 3245 1017

Catalogue requests to catalogues@minibearings.com.au

