

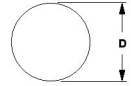

# MBA

## Balls - Tungsten Carbide



Extreme hardness and wear resistance.

Tolerances available on request.

Precision Grade: Grade 25.

Hardness: Rockwell A: 91.5 (Approx 77 Rockwell C).

Extreme hardness and wear resistance.

Specific Gravity: 14.95.

This catalogue to be read in conjunction with information at <http://www.minibearings.com.au/ical/balls/>

<http://www.minibearings.com.au/categories/balls/all/pics/>

### Balls - Tungsten Carbide

| Part Number      | Diameter (D) mm<br><i>inches</i> | Material                               | Precision Grade | Hardness         | Properties                            | Colour    | Specific Gravity |
|------------------|----------------------------------|--|-----------------|------------------|---------------------------------------|-----------|------------------|
| BL-00.500-TC-G25 | 0.500<br><i>0.020</i>            | Tungsten Carbide                       | Grade 25        | Rockwell A: 91.5 | Extreme hardness and wear resistance. | Dull Grey | 14.95            |
| BL-02.000-TC-G25 | 2.000<br><i>0.079</i>            | Tungsten Carbide -<br>6% Nickel Binder | 25              | Rockwell A: 91.5 | Extreme hardness and wear resistance. | Dull Grey | 14.95            |

# Indicates item not stocked at time of printing - Please enquire for lead time

E&OE Pricing and all details subject to change without notice - Copyright Miniature Bearings Australia Pty Ltd

MBA Size Listings are a guide to sizes only and must not be solely relied on for critical design information.

## Balls - Tungsten Carbide

| Part Number        | Diameter (D) mm<br><i>inches</i> | Material         | Precision Grade | Hardness         | Properties                            | Colour    | Specific Gravity |
|--------------------|----------------------------------|------------------|-----------------|------------------|---------------------------------------|-----------|------------------|
| BL-02.381-TC-G25   | 2.381<br><i>0.094</i>            | Tungsten Carbide | Grade 25        | Rockwell A: 91.5 | Extreme hardness and wear resistance. | Dull Grey | 14.95            |
| BL-03.000-TC-G25   | 3.000<br><i>0.118</i>            | Tungsten Carbide | 25              | Rockwell A: 91.5 | Extreme hardness and wear resistance. | Dull Grey | 14.95            |
| BL-03.175-TC-G25   | 3.175<br><i>0.125</i>            | Tungsten Carbide | Grade 25        | Rockwell A: 91.5 | Extreme hardness and wear resistance. | Dull Grey | 14.95            |
| BL-04.000-TC-G25   | 4.000<br><i>0.157</i>            | Tungsten Carbide | Grade 25        | Rockwell A: 91.5 | Extreme hardness and wear resistance. | Dull Grey | 14.95            |
| BL-04.762-TC-G25   | 4.763<br><i>0.188</i>            | Tungsten Carbide | 25              | Rockwell A: 91.5 | Extreme hardness and wear resistance. | Dull Grey | 14.95            |
| BL-06.350-TC-G25   | 6.350<br><i>0.250</i>            | Tungsten Carbide | 25              | Rockwell A: 91.5 | Extreme hardness and wear resistance. | Dull Grey | 14.95            |
| # BL-09.525-TC-G25 | 9.525<br><i>0.375</i>            | Tungsten Carbide | Grade 25        | Rockwell A: 91.5 | Extreme hardness and wear resistance. | Dull Grey | 14.95            |
| # BL-17.463-TC-G25 | 17.463<br><i>0.688</i>           | Tungsten Carbide | Grade 25        | Rockwell A: 91.5 | Extreme hardness and wear resistance. | Dull Grey | 14.95            |

# Indicates item not stocked at time of printing - Please enquire for lead time

E&OE Pricing and all details subject to change without notice - Copyright Miniature Bearings Australia Pty Ltd

MBA Size Listings are a guide to sizes only and must not be solely relied on for critical design information.



DISTRIBUTED BY

Ask us to put your name and address here

<http://www.minibearings.com.au/product>

Ph +61 7 3245 7977

Fax +61 7 3245 1017

Catalogue requests to [catalogues@minibearings.com.au](mailto:catalogues@minibearings.com.au)

|  |  |  |  |  |  |
|--|--|--|--|--|--|
|  |  |  |  |  |  |
|  |  |  |  |  |  |
|  |  |  |  |  |  |