

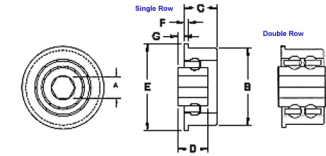

MBA

Bearings - Conveyor - Hex Bore



Plastic and Stainless Steel.

Loads and Speeds are for reference only. Testing recommended.

Bearings - Conveyor - Hex Bore

Part Number	Hex Bore (A) mm	Outside Diameter (B) mm	Outer Ring Width (C) mm	Inner Ring Width (D) mm	Flange Diameter (E) mm	Flange Width (F) mm	Material	Max RPM (No Load)	Load Capacity (Dyn/Static) Kg	Ball Rows
# CBD07.94HX-25.40	7.94	25.40	9.40	11.68	28.45	1.52	Polypropylene Races / 316 Stainless Balls	1280	26.8 / 19.2	Double Row
	<i>0.313</i>	<i>1.000</i>	<i>0.370</i>	<i>0.460</i>	<i>1.120</i>	<i>0.060</i>				
# S6-CB07.94HX-25.40	7.94	25.40	9.40	11.68	28.45	1.52	316 Stainless Balls and Races	1600	56.3 / 44.2	Single Row
	<i>0.313</i>	<i>1.000</i>	<i>0.370</i>	<i>0.460</i>	<i>1.120</i>	<i>0.060</i>				
CB07.94HX-25.40	7.94	25.40	9.40	11.68	28.45	1.52	Polypropylene Races / 316 Stainless Balls	1600	18.8 / 14.7	Single Row
	<i>0.313</i>	<i>1.000</i>	<i>0.370</i>	<i>0.460</i>	<i>1.120</i>	<i>0.060</i>				

Indicates item not stocked at time of printing - Please enquire for lead time

E&OE Pricing and all details subject to change without notice - Copyright Miniature Bearings Australia Pty Ltd

MBA Size Listings are a guide to sizes only and must not be solely relied on for critical design information.

Bearings - Conveyor - Hex Bore

Part Number	Hex Bore (A) mm	Outside Diameter (B) mm	Outer Ring Width (C) mm	Inner Ring Width (D) mm	Flange Diameter (E) mm	Flange Width (F) mm	Material	Max RPM (No Load)	Load Capacity (Dyn/Static) Kg	Ball Rows
# S6-CBD07.94HX-25.40	7.94	25.40	9.40	11.68	28.45	1.52	316 Stainless Balls and Races	1280	84.4 / 66.1	Double Row
	<i>0.313</i>	<i>1.000</i>	<i>0.370</i>	<i>0.460</i>	<i>1.120</i>	<i>0.060</i>				
# CBD11.11HX-38.10	11.11	38.10	17.78	23.62	39.62	2.54	Polypropylene Races / 316 Stainless Balls	855	37.9 / 30.4	Double Row
	<i>0.437</i>	<i>1.500</i>	<i>0.700</i>	<i>0.930</i>	<i>1.560</i>	<i>0.100</i>				
# S6-CB11.11HX-38.10	11.11	38.10	17.78	23.62	39.62	2.54	316 Stainless Balls and Races	1069	92.4 / 61.6	Single Row
	<i>0.437</i>	<i>1.500</i>	<i>0.700</i>	<i>0.930</i>	<i>1.560</i>	<i>0.100</i>				
# CBD11.11HX-45.21	11.11	45.21	27.94	23.62	47.24	2.54	Polypropylene Races / 316 Stainless Balls	855	37.9 / 30.4	Double Row
	<i>0.437</i>	<i>1.780</i>	<i>1.100</i>	<i>0.930</i>	<i>1.860</i>	<i>0.100</i>				
# S6-CB11.11HX-45.21	11.11	45.21	27.94	23.62	47.24	2.54	316 Stainless Balls and Races	1069	92.4 / 61.6	Single Row
	<i>0.437</i>	<i>1.780</i>	<i>1.100</i>	<i>0.930</i>	<i>1.860</i>	<i>0.100</i>				
# S6-CB11.11HX-47.50	11.11	47.50	17.78	23.62	50.80	2.54	316 Stainless Balls and Races	729	92.4 / 61.6	Single Row
	<i>0.437</i>	<i>1.870</i>	<i>0.700</i>	<i>0.930</i>	<i>2.000</i>	<i>0.100</i>				
# CBD11.11HX-47.50	11.11	47.50	17.78	23.62	50.80	2.54	Polypropylene Races / 316 Stainless Balls	672	66.1 / 40.6	Double Row
	<i>0.437</i>	<i>1.870</i>	<i>0.700</i>	<i>0.930</i>	<i>2.000</i>	<i>0.100</i>				

Indicates item not stocked at time of printing - Please enquire for lead time

E&OE Pricing and all details subject to change without notice - Copyright Miniature Bearings Australia Pty Ltd

MBA Size Listings are a guide to sizes only and must not be solely relied on for critical design information.

Bearings - Conveyor - Hex Bore

Part Number	Hex Bore (A) mm	Outside Diameter (B) mm	Outer Ring Width (C) mm	Inner Ring Width (D) mm	Flange Diameter (E) mm	Flange Width (F) mm	Material	Max RPM (No Load)	Load Capacity (Dyn/Static) Kg	Ball Rows
# CBD11.11HX-52.22	11.11	52.22	17.78	23.62	58.93	2.54	Polypropylene Races / 316 Stainless Balls	672	66.1 / 40.6	Double Row
	<i>0.437</i>	<i>2.056</i>	<i>0.700</i>	<i>0.930</i>	<i>2.320</i>	<i>0.100</i>				
# S6-CB11.11HX-52.22	11.11	52.22	17.78	23.62	58.93	2.54	316 Stainless Balls and Races	729	104.5 / 69.6	Single Row
	<i>0.437</i>	<i>2.056</i>	<i>0.700</i>	<i>0.930</i>	<i>2.320</i>	<i>0.100</i>				
# CBD11.11HX-57.40	11.11	57.40	17.78	23.62	60.20	2.54	Polypropylene Races / 316 Stainless Balls	672	66.1 / 40.6	Double Row
	<i>0.437</i>	<i>2.260</i>	<i>0.700</i>	<i>0.930</i>	<i>2.370</i>	<i>0.100</i>				
# S6-CB11.11HX-57.40	11.11	57.40	17.78	23.62	60.20	2.54	316 Stainless Balls and Races	729	125.0 / 95.1	Single Row
	<i>0.437</i>	<i>2.260</i>	<i>0.700</i>	<i>0.930</i>	<i>2.370</i>	<i>0.100</i>				
# S6-CB17.46HX-52.22	17.46	52.22	17.78	23.62	58.93	2.54	316 Stainless Balls and Races	729	104.5 / 69.6	Single Row
	<i>0.687</i>	<i>2.056</i>	<i>0.700</i>	<i>0.930</i>	<i>2.320</i>	<i>0.100</i>				
# CBD17.46HX-52.22	17.46	52.22	17.78	23.62	58.93	2.54	Polypropylene Races / 316 Stainless Balls	672	66.1 / 40.6	Double Row
	<i>0.687</i>	<i>2.056</i>	<i>0.700</i>	<i>0.930</i>	<i>2.320</i>	<i>0.100</i>				
# CBD17.46HX-57.40	17.46	57.40	27.94	23.62	60.20	2.54	Polypropylene Races / 316 Stainless Balls	672	66.1 / 40.6	Double Row
	<i>0.687</i>	<i>2.260</i>	<i>1.100</i>	<i>0.930</i>	<i>2.370</i>	<i>0.100</i>				

Indicates item not stocked at time of printing - Please enquire for lead time

E&OE Pricing and all details subject to change without notice - Copyright Miniature Bearings Australia Pty Ltd

MBA Size Listings are a guide to sizes only and must not be solely relied on for critical design information.

Bearings - Conveyor - Hex Bore

Part Number	Hex Bore (A) mm	Outside Diameter (B) mm	Outer Ring Width (C) mm	Inner Ring Width (D) mm	Flange Diameter (E) mm	Flange Width (F) mm	Material	Max RPM (No Load)	Load Capacity (Dyn/Static) Kg	Ball Rows
# SSCB687-2.26SR-6	-	-	-	-	-	-				
# SSCB437-1.5DR-6	-	-	-	-	-	-				
# SSCB437-1.6DR-6	-	-	-	-	-	-				
# SSCB437-1.6SR-6	-	-	-	-	-	-				
# SSCB437-1.78DR-6	-	-	-	-	-	-				
# SSCB437-1.87DR-6	-	-	-	-	-	-				
# SSCB437-2.05DR-6	-	-	-	-	-	-				
# SSCB437-2.26DR-6	-	-	-	-	-	-				
# SSCB687-2.05DR-6	-	-	-	-	-	-				
# SSCB687-2.26DR-6	-	-	-	-	-	-				

Indicates item not stocked at time of printing - Please enquire for lead time

E&OE Pricing and all details subject to change without notice - Copyright Miniature Bearings Australia Pty Ltd

MBA Size Listings are a guide to sizes only and must not be solely relied on for critical design information.



DISTRIBUTED BY

Ask us to put your name and address here

<http://www.minibearings.com.au/product>

Ph +61 7 3245 7977

Fax +61 7 3245 1017

Catalogue requests to catalogues@minibearings.com.au

