

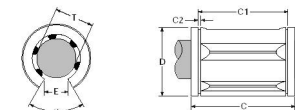

# MBA

## Bearings - Linear - Ball - Thomson Precision Steel (Open)



For running on shafts supported by a rail along their length.

This catalogue to be read in conjunction with information at <http://www.minibearings.com.au/ogue/tech/linear/steelopen.pdf>

<http://www.minibearings.com.au/categories/shafting/all/pics/>

### Bearings - Linear - Ball - Thomson Precision Steel (Open)

Part Number	Nom. Shaft Size (T) mm	Working Bore Diameter (T) mm	Length ( C ) mm	Groove Distance (C1) mm	Groove Width (C2) mm	Slot Width (E) mm	No. Ball Circuits	Weight Kg	Dynamic Load Cap. kgf	Recom. Housing Bore mm
	<i>inches</i>	<i>inches</i>	<i>inches</i>	<i>inches</i>	<i>inches</i>	<i>inches</i>				<i>inches</i>
# TOPN-81420	12.70	12.687 to 12.713	31.750 (+0.00-0.38)	24.562 (+0.00-0.41)	1.17	7.87	3	0.03	27	22.200 to 22.250
	<i>0.500</i>				<i>0.046</i>	<i>0.310</i>				
# TOPN-101824	15.88	15.862 to 15.888	38.100 (+0.00-0.38)	28.143 (+0.00-0.41)	1.42	9.65	3	0.05	47	28.550 to 28.600
	<i>0.625</i>				<i>0.056</i>	<i>0.380</i>				
# TOPN-122026	19.05	19.037 to 19.063	41.275 (+0.00-0.38)	29.718 (+0.00-0.41)	1.42	11.18	4	0.08	63	31.725 to 31.775
	<i>0.750</i>				<i>0.056</i>	<i>0.440</i>				

# Indicates item not stocked at time of printing - Please enquire for lead time

E&OE Pricing and all details subject to change without notice - Copyright Miniature Bearings Australia Pty Ltd

MBA Size Listings are a guide to sizes only and must not be solely relied on for critical design information.

## Bearings - Linear - Ball - Thomson Precision Steel (Open)

Part Number	Nom. Shaft Size (T) mm	Working Bore Diameter (T) mm	Length (C) mm	Groove Distance (C1) mm	Groove Width (C2) mm	Slot Width (E) mm	No. Ball Circuits	Weight Kg	Dynamic Load Cap. kgf	Recom. Housing Bore mm
	<i>inches</i>	<i>inches</i>	<i>inches</i>	<i>inches</i>	<i>inches</i>	<i>inches</i>				<i>inches</i>
# TOPN-162536	25.40 <i>1.000</i>	25.387 to 25.413	57.150 (+0.00-0.38)	44.679 (+0.00-0.46)	1.73 <i>0.068</i>	14.22 <i>0.560</i>	4	0.15	107	39.662 to 39.713
# TOPN-203242	31.75 <i>1.250</i>	31.735 to 31.765	66.675 (+0.00-0.51)	51.029 (+0.00-0.46)	1.73 <i>0.068</i>	16.00 <i>0.630</i>	5	0.41	179	50.775 to 50.825
# TOPN-243848	38.10 <i>1.500</i>	38.085 to 38.115	76.200 (+0.00-0.51)	60.350 (+0.00-0.46)	2.18 <i>0.086</i>	19.05 <i>0.750</i>	5	0.51	268	60.300 to 60.350
# TOPN-324864	50.80 <i>2.000</i>	50.780 to 50.820	101.600 (+0.00-0.51)	76.225 (+0.00-0.46)	2.62 <i>0.103</i>	25.40 <i>1.000</i>	5	0.98	384	76.175 to 76.375
# TOPN-406080	63.50 <i>2.500</i>	63.475 to 63.525	127.000 (+0.00-0.64)	95.288 (+0.00-0.51)	3.05 <i>0.120</i>	31.75 <i>1.250</i>	5	1.92	616	95.212 to 95.288
# TOPN-487296	76.20 <i>3.000</i>	76.170 to 76.230	152.400 (+0.00-0.76)	114.338 (+0.00-0.51)	3.05 <i>0.120</i>	38.10 <i>1.500</i>	5	3.32	893	114.262 to 144.338
# TOPN-6496128	101.60 <i>4.000</i>	101.549 to 101.651	203.200 (+0.00-1.02)	152.451 (+0.00-0.76)	3.53 <i>0.139</i>	50.80 <i>2.000</i>	5	7.82	1696	152.349 to 152.451

# Indicates item not stocked at time of printing - Please enquire for lead time

E&OE Pricing and all details subject to change without notice - Copyright Miniature Bearings Australia Pty Ltd

MBA Size Listings are a guide to sizes only and must not be solely relied on for critical design information.



DISTRIBUTED BY

Ask us to put your name and address here

<http://www.minibearings.com.au/product>

Ph +61 7 3245 7977

Fax +61 7 3245 1017

Catalogue requests to [catalogues@minibearings.com.au](mailto:catalogues@minibearings.com.au)

