

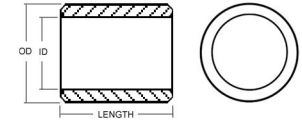

MBA

Bearings - Needle Roller - Inner Rings



Hardened sleeves for needle roller bearings.

<http://www.minibearings.com.au//categories/shafting/all/pics/>

Bearings - Needle Roller - Inner Rings

Part Number	ID mm	OD mm	Length (L) mm
	<i>inches</i>	<i>inches</i>	<i>inches</i>
# IR-05.000x07.000x10.000	5.000 <i>0.197</i>	7.000 <i>0.276</i>	10.000 <i>0.394</i>
IR-05.000x08.000x12.000	5.000 <i>0.197</i>	8.000 <i>0.315</i>	12.000 <i>0.472</i>
# IR-05.000x08.000x16.000	5.000 <i>0.197</i>	8.000 <i>0.315</i>	16.000 <i>0.630</i>
IR-06.000x08.000x10.000	6.000 <i>0.236</i>	8.000 <i>0.315</i>	10.000 <i>0.394</i>

Indicates item not stocked at time of printing - Please enquire for lead time
 E&OE Pricing and all details subject to change without notice - Copyright Miniature Bearings Australia Pty Ltd
 MBA Size Listings are a guide to sizes only and must not be solely relied on for critical design information.

Bearings - Needle Roller - Inner Rings

Part Number	ID mm	OD mm	Length (L) mm
	<i>inches</i>	<i>inches</i>	<i>inches</i>
# IR-06.000x09.000x12.000	6.000 <i>0.236</i>	9.000 <i>0.354</i>	12.000 <i>0.472</i>
# IR-06.000x09.000x16.000	6.000 <i>0.236</i>	9.000 <i>0.354</i>	16.000 <i>0.630</i>
IR-06.000x10.000x10.000	6.000 <i>0.236</i>	10.000 <i>0.394</i>	10.000 <i>0.394</i>
IR-06.350x11.112x13.610	6.350 <i>0.250</i>	11.112 <i>0.437</i>	13.360 - 13.610
# IR-07.000x09.000x10.000	7.000 <i>0.276</i>	9.000 <i>0.354</i>	10.000 <i>0.394</i>
# IR-07.000x10.000x10.500	7.000 <i>0.276</i>	10.000 <i>0.394</i>	10.500 <i>0.413</i>
# IR-07.000x10.000x12.000	7.000 <i>0.276</i>	10.000 <i>0.394</i>	12.000 <i>0.472</i>
# IR-07.000x10.000x12.500	7.000 <i>0.276</i>	10.000 <i>0.394</i>	12.500 <i>0.492</i>
# IR-07.000x10.000x15.500	7.000 <i>0.276</i>	10.000 <i>0.394</i>	15.500 <i>0.610</i>
# IR-07.000x10.000x16.000	7.000 <i>0.276</i>	10.000 <i>0.394</i>	16.000 <i>0.630</i>

Indicates item not stocked at time of printing - Please enquire for lead time

E&OE Pricing and all details subject to change without notice - Copyright Miniature Bearings Australia Pty Ltd

MBA Size Listings are a guide to sizes only and must not be solely relied on for critical design information.

Bearings - Needle Roller - Inner Rings

Part Number	ID mm	OD mm	Length (L) mm
	<i>inches</i>	<i>inches</i>	<i>inches</i>
IR-07.938x12.700x12.950	7.938 <i>0.313</i>	12.700 <i>0.500</i>	12.950 <i>0.510</i>
IR-08.000x10.000x11.000	8.000 <i>0.315</i>	10.000 <i>0.394</i>	11.000 <i>0.433</i>
IR-08.000x12.000x10.630	8.000 <i>0.315</i>	12.000 <i>0.472</i>	10.370 - 10.630
IR-08.000x12.000x12.630	8.000 <i>0.315</i>	12.000 <i>0.472</i>	12.370 - 12.630
# IR-08.000x12.000x15.500	8.000 <i>0.315</i>	12.000 <i>0.472</i>	15.500 <i>0.610</i>
# IR-09.000x12.000x11.000	9.000 <i>0.354</i>	12.000 <i>0.472</i>	11.000 <i>0.433</i>
# IR-09.000x12.000x12.000	9.000 <i>0.354</i>	12.000 <i>0.472</i>	12.000 <i>0.472</i>
IR-09.000x12.000x16.000	9.000 <i>0.354</i>	12.000 <i>0.472</i>	16.000 <i>0.630</i>
IR-09.525x14.288x12.950	9.525 <i>0.375</i>	14.288 <i>0.563</i>	12.950 <i>0.510</i>
IR-09.525x14.288x19.300	9.525 <i>0.375</i>	14.288 <i>0.563</i>	19.300 <i>0.760</i>

Indicates item not stocked at time of printing - Please enquire for lead time

E&OE Pricing and all details subject to change without notice - Copyright Miniature Bearings Australia Pty Ltd

MBA Size Listings are a guide to sizes only and must not be solely relied on for critical design information.

Bearings - Needle Roller - Inner Rings

Part Number	ID mm	OD mm	Length (L) mm
	<i>inches</i>	<i>inches</i>	<i>inches</i>
# IR-09.525x15.875x12.950	9.525 <i>0.375</i>	15.875 <i>0.625</i>	12.950 <i>0.510</i>
# IR-09.525x15.875x19.300	9.525 <i>0.375</i>	15.875 <i>0.625</i>	19.300 <i>0.760</i>
# IR-09.525x15.875x25.650	9.525 <i>0.375</i>	15.875 <i>0.625</i>	25.650 <i>1.010</i>
# IR-10.000x13.000x12.500	10.000 <i>0.394</i>	13.000 <i>0.512</i>	12.500 <i>0.492</i>
# IR-10.000x14.000x12.000	10.000 <i>0.394</i>	14.000 <i>0.551</i>	12.000 <i>0.472</i>
# IR-10.000x14.000x12.500	10.000 <i>0.394</i>	14.000 <i>0.551</i>	12.500 <i>0.492</i>
# IR-10.000x14.000x13.000	10.000 <i>0.394</i>	14.000 <i>0.551</i>	13.000 <i>0.512</i>
# IR-10.000x14.000x16.000	10.000 <i>0.394</i>	14.000 <i>0.551</i>	16.000 <i>0.630</i>
# IR-10.000x14.000x16.500	10.000 <i>0.394</i>	14.000 <i>0.551</i>	16.500 <i>0.650</i>
IR-10.000x14.000x20.000	10.000 <i>0.394</i>	14.000 <i>0.551</i>	20.000 <i>0.787</i>

Indicates item not stocked at time of printing - Please enquire for lead time

E&OE Pricing and all details subject to change without notice - Copyright Miniature Bearings Australia Pty Ltd

MBA Size Listings are a guide to sizes only and must not be solely relied on for critical design information.

Bearings - Needle Roller - Inner Rings

Part Number	ID mm	OD mm	Length (L) mm
	<i>inches</i>	<i>inches</i>	<i>inches</i>
# IR-10.000x14.000x20.500	10.000 <i>0.394</i>	14.000 <i>0.551</i>	20.500 <i>0.807</i>
# IR-10.000x15.000x10.500	10.000 <i>0.394</i>	15.000 <i>0.591</i>	10.500 <i>0.413</i>
# IR-10.000x15.000x12.500	10.000 <i>0.394</i>	15.000 <i>0.591</i>	12.500 <i>0.492</i>
# IR-10.000x15.000x13.000	10.000 <i>0.394</i>	15.000 <i>0.591</i>	13.000 <i>0.512</i>
# IR-10.000x15.000x15.500	10.000 <i>0.394</i>	15.000 <i>0.591</i>	15.500 <i>0.610</i>
# IR-10.000x15.000x20.500	10.000 <i>0.394</i>	15.000 <i>0.591</i>	20.500 <i>0.807</i>
# IR-10.000x15.000x25.500	10.000 <i>0.394</i>	15.000 <i>0.591</i>	25.500 <i>1.004</i>
IR-11.112x15.875x13.070	11.112 <i>0.437</i>	15.875 <i>0.625</i>	12.820 - 13.070
# IR-11.112x15.875x12.950	11.112 <i>0.437</i>	15.875 <i>0.625</i>	12.950 <i>0.510</i>
# IR-11.112x15.875x19.300	11.112 <i>0.437</i>	15.875 <i>0.625</i>	19.300 <i>0.760</i>

Indicates item not stocked at time of printing - Please enquire for lead time

E&OE Pricing and all details subject to change without notice - Copyright Miniature Bearings Australia Pty Ltd

MBA Size Listings are a guide to sizes only and must not be solely relied on for critical design information.

Bearings - Needle Roller - Inner Rings

Part Number	ID mm	OD mm	Length (L) mm
	<i>inches</i>	<i>inches</i>	<i>inches</i>
# IR-11.112x15.875x22.475	11.112 <i>0.437</i>	15.875 <i>0.625</i>	22.475 <i>0.885</i>
# IR-11.112x15.875x25.650	11.112 <i>0.437</i>	15.875 <i>0.625</i>	25.650 <i>1.010</i>
# IR-12.000x15.000x12.500	12.000 <i>0.472</i>	15.000 <i>0.591</i>	12.500 <i>0.492</i>
# IR-12.000x15.000x16.500	12.000 <i>0.472</i>	15.000 <i>0.591</i>	16.500 <i>0.650</i>
# IR-12.000x15.000x22.500	12.000 <i>0.472</i>	15.000 <i>0.591</i>	22.500 <i>0.886</i>
# IR-12.000x16.000x12.000	12.000 <i>0.472</i>	16.000 <i>0.630</i>	12.000 <i>0.472</i>
IR-12.000x16.000x12.500	12.000 <i>0.472</i>	16.000 <i>0.630</i>	12.500 <i>0.492</i>
# IR-12.000x16.000x13.000	12.000 <i>0.472</i>	16.000 <i>0.630</i>	13.000 <i>0.512</i>
# IR-12.000x16.000x16.000	12.000 <i>0.472</i>	16.000 <i>0.630</i>	16.000 <i>0.630</i>
# IR-12.000x16.000x16.500	12.000 <i>0.472</i>	16.000 <i>0.630</i>	16.500 <i>0.650</i>

Indicates item not stocked at time of printing - Please enquire for lead time

E&OE Pricing and all details subject to change without notice - Copyright Miniature Bearings Australia Pty Ltd

MBA Size Listings are a guide to sizes only and must not be solely relied on for critical design information.

Bearings - Needle Roller - Inner Rings

Part Number	ID mm	OD mm	Length (L) mm
	<i>inches</i>	<i>inches</i>	<i>inches</i>
# IR-12.000x16.000x20.000	12.000 <i>0.472</i>	16.000 <i>0.630</i>	20.000 <i>0.787</i>
# IR-12.000x16.000x20.500	12.000 <i>0.472</i>	16.000 <i>0.630</i>	20.500 <i>0.807</i>
# IR-12.000x16.000x22.000	12.000 <i>0.472</i>	16.000 <i>0.630</i>	22.000 <i>0.866</i>
# IR-12.000x16.000x22.500	12.000 <i>0.472</i>	16.000 <i>0.630</i>	22.500 <i>0.886</i>
# IR-12.000x17.000x13.000	12.000 <i>0.472</i>	17.000 <i>0.669</i>	13.000 <i>0.512</i>
IR-12.000x17.000x15.500	12.000 <i>0.472</i>	17.000 <i>0.669</i>	15.500 <i>0.610</i>
# IR-12.000x17.000x20.500	12.000 <i>0.472</i>	17.000 <i>0.669</i>	20.500 <i>0.807</i>
# IR-12.000x17.000x25.500	12.000 <i>0.472</i>	17.000 <i>0.669</i>	25.500 <i>1.004</i>
# IR-12.700x17.462x09.775	12.700 <i>0.500</i>	17.462 <i>0.687</i>	9.775 <i>0.385</i>
# IR-12.700x17.462x12.950	12.700 <i>0.500</i>	17.462 <i>0.687</i>	12.950 <i>0.510</i>

Indicates item not stocked at time of printing - Please enquire for lead time

E&OE Pricing and all details subject to change without notice - Copyright Miniature Bearings Australia Pty Ltd

MBA Size Listings are a guide to sizes only and must not be solely relied on for critical design information.

Bearings - Needle Roller - Inner Rings

Part Number	ID mm	OD mm	Length (L) mm
	<i>inches</i>	<i>inches</i>	<i>inches</i>
# IR-12.700x17.462x19.300	12.700 <i>0.500</i>	17.462 <i>0.687</i>	19.300 <i>0.760</i>
# IR-12.700x19.050x12.950	12.700 <i>0.500</i>	19.050 <i>0.750</i>	12.950 <i>0.510</i>
# IR-12.700x19.050x16.125	12.700 <i>0.500</i>	19.050 <i>0.750</i>	16.125 <i>0.635</i>
IR-12.700x19.050x19.300	12.700 <i>0.500</i>	19.050 <i>0.750</i>	19.300 <i>0.760</i>
# IR-12.700x19.050x22.475	12.700 <i>0.500</i>	19.050 <i>0.750</i>	22.475 <i>0.885</i>
# IR-12.700x19.050x25.650	12.700 <i>0.500</i>	19.050 <i>0.750</i>	25.650 <i>1.010</i>
# IR-14.000x17.000x17.000	14.000 <i>0.551</i>	17.000 <i>0.669</i>	17.000 <i>0.669</i>
# IR-14.288x20.638x12.950	14.288 <i>0.563</i>	20.638 <i>0.813</i>	12.950 <i>0.510</i>
# IR-14.288x20.638x16.125	14.288 <i>0.563</i>	20.638 <i>0.813</i>	16.125 <i>0.635</i>
# IR-14.288x20.638x19.300	14.288 <i>0.563</i>	20.638 <i>0.813</i>	19.300 <i>0.760</i>

Indicates item not stocked at time of printing - Please enquire for lead time

E&OE Pricing and all details subject to change without notice - Copyright Miniature Bearings Australia Pty Ltd

MBA Size Listings are a guide to sizes only and must not be solely relied on for critical design information.

Bearings - Needle Roller - Inner Rings

Part Number	ID mm	OD mm	Length (L) mm
	<i>inches</i>	<i>inches</i>	<i>inches</i>
# IR-14.288x20.638x22.475	14.288 <i>0.563</i>	20.638 <i>0.813</i>	22.475 <i>0.885</i>
# IR-14.288x20.638x25.650	14.288 <i>0.563</i>	20.638 <i>0.813</i>	25.650 <i>1.010</i>
# IR-14.288x20.638x32.000	14.288 <i>0.563</i>	20.638 <i>0.813</i>	32.000 <i>1.260</i>
# IR-15.000x18.000x12.500	15.000 <i>0.591</i>	18.000 <i>0.709</i>	12.500 <i>0.492</i>
# IR-15.000x18.000x13.500	15.000 <i>0.591</i>	18.000 <i>0.709</i>	13.500 <i>0.531</i>
# IR-15.000x18.000x15.500	15.000 <i>0.591</i>	18.000 <i>0.709</i>	15.500 <i>0.610</i>
# IR-15.000x18.000x16.500	15.000 <i>0.591</i>	18.000 <i>0.709</i>	16.500 <i>0.650</i>
# IR-15.000x18.000x17.500	15.000 <i>0.591</i>	18.000 <i>0.709</i>	17.500 <i>0.689</i>
# IR-15.000x18.000x19.500	15.000 <i>0.591</i>	18.000 <i>0.709</i>	19.500 <i>0.768</i>
# IR-15.000x18.000x20.500	15.000 <i>0.591</i>	18.000 <i>0.709</i>	20.500 <i>0.807</i>

Indicates item not stocked at time of printing - Please enquire for lead time

E&OE Pricing and all details subject to change without notice - Copyright Miniature Bearings Australia Pty Ltd

MBA Size Listings are a guide to sizes only and must not be solely relied on for critical design information.

Bearings - Needle Roller - Inner Rings

Part Number	ID mm	OD mm	Length (L) mm
	<i>inches</i>	<i>inches</i>	<i>inches</i>
# IR-15.000x18.000x25.500	15.000 <i>0.591</i>	18.000 <i>0.709</i>	25.500 <i>1.004</i>
# IR-15.000x19.000x16.000	15.000 <i>0.591</i>	19.000 <i>0.748</i>	16.000 <i>0.630</i>
# IR-15.000x19.000x16.500	15.000 <i>0.591</i>	19.000 <i>0.748</i>	16.500 <i>0.650</i>
# IR-15.000x19.000x20.000	15.000 <i>0.591</i>	19.000 <i>0.748</i>	20.000 <i>0.787</i>
# IR-15.000x19.000x20.500	15.000 <i>0.591</i>	19.000 <i>0.748</i>	20.500 <i>0.807</i>
# IR-15.000x20.000x12.000	15.000 <i>0.591</i>	20.000 <i>0.787</i>	12.000 <i>0.472</i>
# IR-15.000x20.000x13.000	15.000 <i>0.591</i>	20.000 <i>0.787</i>	13.000 <i>0.512</i>
# IR-15.000x20.000x15.500	15.000 <i>0.591</i>	20.000 <i>0.787</i>	15.500 <i>0.610</i>
# IR-15.000x20.000x20.500	15.000 <i>0.591</i>	20.000 <i>0.787</i>	20.500 <i>0.807</i>
# IR-15.000x20.000x23.000	15.000 <i>0.591</i>	20.000 <i>0.787</i>	23.000 <i>0.906</i>

Indicates item not stocked at time of printing - Please enquire for lead time

E&OE Pricing and all details subject to change without notice - Copyright Miniature Bearings Australia Pty Ltd

MBA Size Listings are a guide to sizes only and must not be solely relied on for critical design information.

Bearings - Needle Roller - Inner Rings

Part Number	ID mm	OD mm	Length (L) mm
	<i>inches</i>	<i>inches</i>	<i>inches</i>
# IR-15.000x20.000x25.500	15.000 <i>0.591</i>	20.000 <i>0.787</i>	25.500 <i>1.004</i>
# IR-15.000x20.000x26.000	15.000 <i>0.591</i>	20.000 <i>0.787</i>	26.000 <i>1.024</i>
# IR-15.000x20.000x30.500	15.000 <i>0.591</i>	20.000 <i>0.787</i>	30.500 <i>1.201</i>
# IR-15.875x22.225x09.775	15.875 <i>0.625</i>	22.225 <i>0.875</i>	9.775 <i>0.385</i>
# IR-15.875x22.225x12.950	15.875 <i>0.625</i>	22.225 <i>0.875</i>	12.950 <i>0.510</i>
# IR-15.875x22.225x19.300	15.875 <i>0.625</i>	22.225 <i>0.875</i>	19.300 <i>0.760</i>
# IR-15.875x22.225x22.475	15.875 <i>0.625</i>	22.225 <i>0.875</i>	22.475 <i>0.885</i>
# IR-15.875x22.225x25.650	15.875 <i>0.625</i>	22.225 <i>0.875</i>	25.650 <i>1.010</i>
# IR-15.875x22.225x35.175	15.875 <i>0.625</i>	22.225 <i>0.875</i>	35.175 <i>1.385</i>
# IR-17.000x20.000x16.500	17.000 <i>0.669</i>	20.000 <i>0.787</i>	16.500 <i>0.650</i>

Indicates item not stocked at time of printing - Please enquire for lead time

E&OE Pricing and all details subject to change without notice - Copyright Miniature Bearings Australia Pty Ltd

MBA Size Listings are a guide to sizes only and must not be solely relied on for critical design information.

Bearings - Needle Roller - Inner Rings

Part Number	ID mm	OD mm	Length (L) mm
	<i>inches</i>	<i>inches</i>	<i>inches</i>
# IR-17.000x20.000x20.500	17.000 <i>0.669</i>	20.000 <i>0.787</i>	20.500 <i>0.807</i>
# IR-17.000x20.000x30.500	17.000 <i>0.669</i>	20.000 <i>0.787</i>	30.500 <i>1.201</i>
# IR-17.000x21.000x16.000	17.000 <i>0.669</i>	21.000 <i>0.827</i>	16.000 <i>0.630</i>
# IR-17.000x21.000x16.500	17.000 <i>0.669</i>	21.000 <i>0.827</i>	16.500 <i>0.650</i>
# IR-17.000x21.000x20.000	17.000 <i>0.669</i>	21.000 <i>0.827</i>	20.000 <i>0.787</i>
# IR-17.000x21.000x20.500	17.000 <i>0.669</i>	21.000 <i>0.827</i>	20.500 <i>0.807</i>
# IR-17.000x22.000x10.500	17.000 <i>0.669</i>	22.000 <i>0.866</i>	10.500 <i>0.413</i>
# IR-17.000x22.000x13.000	17.000 <i>0.669</i>	22.000 <i>0.866</i>	13.000 <i>0.512</i>
# IR-17.000x22.000x15.500	17.000 <i>0.669</i>	22.000 <i>0.866</i>	15.500 <i>0.610</i>
# IR-17.000x22.000x16.000	17.000 <i>0.669</i>	22.000 <i>0.866</i>	16.000 <i>0.630</i>

Indicates item not stocked at time of printing - Please enquire for lead time

E&OE Pricing and all details subject to change without notice - Copyright Miniature Bearings Australia Pty Ltd

MBA Size Listings are a guide to sizes only and must not be solely relied on for critical design information.

Bearings - Needle Roller - Inner Rings

Part Number	ID mm	OD mm	Length (L) mm
	<i>inches</i>	<i>inches</i>	<i>inches</i>
# IR-17.000x22.000x16.500	17.000 <i>0.669</i>	22.000 <i>0.866</i>	16.500 <i>0.650</i>
# IR-17.000x22.000x20.500	17.000 <i>0.669</i>	22.000 <i>0.866</i>	20.500 <i>0.807</i>
# IR-17.000x22.000x23.000	17.000 <i>0.669</i>	22.000 <i>0.866</i>	23.000 <i>0.906</i>
# IR-17.000x22.000x25.500	17.000 <i>0.669</i>	22.000 <i>0.866</i>	25.500 <i>1.004</i>
# IR-17.000x22.000x26.000	17.000 <i>0.669</i>	22.000 <i>0.866</i>	26.000 <i>1.024</i>
# IR-17.000x22.000x30.500	17.000 <i>0.669</i>	22.000 <i>0.866</i>	30.500 <i>1.201</i>
# IR-17.000x22.000x32.000	17.000 <i>0.669</i>	22.000 <i>0.866</i>	32.000 <i>1.260</i>
# IR-17.462x23.812x16.125	17.462 <i>0.687</i>	23.812 <i>0.937</i>	16.125 <i>0.635</i>
# IR-17.462x23.812x25.650	17.462 <i>0.687</i>	23.812 <i>0.937</i>	25.650 <i>1.010</i>
# IR-19.050x25.400x12.950	19.050 <i>0.750</i>	25.400 <i>1.000</i>	12.950 <i>0.510</i>

Indicates item not stocked at time of printing - Please enquire for lead time

E&OE Pricing and all details subject to change without notice - Copyright Miniature Bearings Australia Pty Ltd

MBA Size Listings are a guide to sizes only and must not be solely relied on for critical design information.

Bearings - Needle Roller - Inner Rings

Part Number	ID mm	OD mm	Length (L) mm
	<i>inches</i>	<i>inches</i>	<i>inches</i>
# IR-19.050x25.400x19.300	19.050 <i>0.750</i>	25.400 <i>1.000</i>	19.300 <i>0.760</i>
# IR-19.050x25.400x22.475	19.050 <i>0.750</i>	25.400 <i>1.000</i>	22.475 <i>0.885</i>
# IR-19.050x25.400x25.650	19.050 <i>0.750</i>	25.400 <i>1.000</i>	25.650 <i>1.010</i>
# IR-19.050x25.400x32.000	19.050 <i>0.750</i>	25.400 <i>1.000</i>	32.000 <i>1.260</i>
# IR-20.000x24.000x16.000	20.000 <i>0.787</i>	24.000 <i>0.945</i>	16.000 <i>0.630</i>
# IR-20.000x24.000x16.500	20.000 <i>0.787</i>	24.000 <i>0.945</i>	16.500 <i>0.650</i>
# IR-20.000x24.000x20.000	20.000 <i>0.787</i>	24.000 <i>0.945</i>	20.000 <i>0.787</i>
# IR-20.000x24.000x20.500	20.000 <i>0.787</i>	24.000 <i>0.945</i>	20.500 <i>0.807</i>
# IR-20.000x24.000x28.500	20.000 <i>0.787</i>	24.000 <i>0.945</i>	28.500 <i>1.122</i>
# IR-20.000x25.000x10.500	20.000 <i>0.787</i>	25.000 <i>0.984</i>	10.500 <i>0.413</i>

Indicates item not stocked at time of printing - Please enquire for lead time

E&OE Pricing and all details subject to change without notice - Copyright Miniature Bearings Australia Pty Ltd

MBA Size Listings are a guide to sizes only and must not be solely relied on for critical design information.

Bearings - Needle Roller - Inner Rings

Part Number	ID mm	OD mm	Length (L) mm
	<i>inches</i>	<i>inches</i>	<i>inches</i>
# IR-20.000x25.000x15.500	20.000 <i>0.787</i>	25.000 <i>0.984</i>	15.500 <i>0.610</i>
# IR-20.000x25.000x16.000	20.000 <i>0.787</i>	25.000 <i>0.984</i>	16.000 <i>0.630</i>
# IR-20.000x25.000x17.000	20.000 <i>0.787</i>	25.000 <i>0.984</i>	17.000 <i>0.669</i>
# IR-20.000x25.000x20.500	20.000 <i>0.787</i>	25.000 <i>0.984</i>	20.500 <i>0.807</i>
# IR-20.000x25.000x25.500	20.000 <i>0.787</i>	25.000 <i>0.984</i>	25.500 <i>1.004</i>
# IR-20.000x25.000x26.000	20.000 <i>0.787</i>	25.000 <i>0.984</i>	26.000 <i>1.024</i>
# IR-20.000x25.000x26.500	20.000 <i>0.787</i>	25.000 <i>0.984</i>	26.500 <i>1.043</i>
# IR-20.000x25.000x30.000	20.000 <i>0.787</i>	25.000 <i>0.984</i>	30.000 <i>1.181</i>
# IR-20.000x25.000x30.500	20.000 <i>0.787</i>	25.000 <i>0.984</i>	30.500 <i>1.201</i>
# IR-20.000x25.000x32.000	20.000 <i>0.787</i>	25.000 <i>0.984</i>	32.000 <i>1.260</i>

Indicates item not stocked at time of printing - Please enquire for lead time

E&OE Pricing and all details subject to change without notice - Copyright Miniature Bearings Australia Pty Ltd

MBA Size Listings are a guide to sizes only and must not be solely relied on for critical design information.

Bearings - Needle Roller - Inner Rings

Part Number	ID mm	OD mm	Length (L) mm
	<i>inches</i>	<i>inches</i>	<i>inches</i>
# IR-20.000x25.000x38.500	20.000 <i>0.787</i>	25.000 <i>0.984</i>	38.500 <i>1.516</i>
# IR-20.638x25.400x25.650	20.638 <i>0.813</i>	25.400 <i>1.000</i>	25.650 <i>1.010</i>
# IR-22.000x26.000x16.000	22.000 <i>0.866</i>	26.000 <i>1.024</i>	16.000 <i>0.630</i>
# IR-22.000x26.000x16.500	22.000 <i>0.866</i>	26.000 <i>1.024</i>	16.500 <i>0.650</i>
# IR-22.000x26.000x20.000	22.000 <i>0.866</i>	26.000 <i>1.024</i>	20.000 <i>0.787</i>
# IR-22.000x26.000x20.500	22.000 <i>0.866</i>	26.000 <i>1.024</i>	20.500 <i>0.807</i>
# IR-22.000x28.000x17.000	22.000 <i>0.866</i>	28.000 <i>1.102</i>	17.000 <i>0.669</i>
# IR-22.000x28.000x20.500	22.000 <i>0.866</i>	28.000 <i>1.102</i>	20.500 <i>0.807</i>
# IR-22.000x28.000x30.000	22.000 <i>0.866</i>	28.000 <i>1.102</i>	30.000 <i>1.181</i>
# IR-22.000x28.000x30.500	22.000 <i>0.866</i>	28.000 <i>1.102</i>	30.500 <i>1.201</i>

Indicates item not stocked at time of printing - Please enquire for lead time

E&OE Pricing and all details subject to change without notice - Copyright Miniature Bearings Australia Pty Ltd

MBA Size Listings are a guide to sizes only and must not be solely relied on for critical design information.

Bearings - Needle Roller - Inner Rings

Part Number	ID mm	OD mm	Length (L) mm
	<i>inches</i>	<i>inches</i>	<i>inches</i>
# IR-22.225x28.575x12.950	22.225 <i>0.875</i>	28.575 <i>1.125</i>	12.950 <i>0.510</i>
IR-22.225x28.575x19.300	22.225 <i>0.875</i>	28.575 <i>1.125</i>	19.300 <i>0.760</i>
# IR-22.225x28.575x25.650	22.225 <i>0.875</i>	28.575 <i>1.125</i>	25.650 <i>1.010</i>
# IR-22.225x28.575x32.000	22.225 <i>0.875</i>	28.575 <i>1.125</i>	32.000 <i>1.260</i>
# IR-25.000x29.000x20.000	25.000 <i>0.984</i>	29.000 <i>1.142</i>	20.000 <i>0.787</i>
# IR-25.000x29.000x20.500	25.000 <i>0.984</i>	29.000 <i>1.142</i>	20.500 <i>0.807</i>
# IR-25.000x29.000x30.000	25.000 <i>0.984</i>	29.000 <i>1.142</i>	30.000 <i>1.181</i>
# IR-25.000x29.000x30.500	25.000 <i>0.984</i>	29.000 <i>1.142</i>	30.500 <i>1.201</i>
# IR-25.000x30.000x15.500	25.000 <i>0.984</i>	30.000 <i>1.181</i>	15.500 <i>0.610</i>
# IR-25.000x30.000x16.000	25.000 <i>0.984</i>	30.000 <i>1.181</i>	16.000 <i>0.630</i>

Indicates item not stocked at time of printing - Please enquire for lead time

E&OE Pricing and all details subject to change without notice - Copyright Miniature Bearings Australia Pty Ltd

MBA Size Listings are a guide to sizes only and must not be solely relied on for critical design information.

Bearings - Needle Roller - Inner Rings

Part Number	ID mm	OD mm	Length (L) mm
	<i>inches</i>	<i>inches</i>	<i>inches</i>
# IR-25.000x30.000x17.000	25.000 <i>0.984</i>	30.000 <i>1.181</i>	17.000 <i>0.669</i>
# IR-25.000x30.000x20.500	25.000 <i>0.984</i>	30.000 <i>1.181</i>	20.500 <i>0.807</i>
# IR-25.000x30.000x25.500	25.000 <i>0.984</i>	30.000 <i>1.181</i>	25.500 <i>1.004</i>
# IR-25.000x30.000x26.000	25.000 <i>0.984</i>	30.000 <i>1.181</i>	26.000 <i>1.024</i>
# IR-25.000x30.000x26.500	25.000 <i>0.984</i>	30.000 <i>1.181</i>	26.500 <i>1.043</i>
# IR-25.000x30.000x30.000	25.000 <i>0.984</i>	30.000 <i>1.181</i>	30.000 <i>1.181</i>
# IR-25.000x30.000x30.500	25.000 <i>0.984</i>	30.000 <i>1.181</i>	30.500 <i>1.201</i>
# IR-25.000x30.000x32.000	25.000 <i>0.984</i>	30.000 <i>1.181</i>	32.000 <i>1.260</i>
# IR-25.000x30.000x38.500	25.000 <i>0.984</i>	30.000 <i>1.181</i>	38.500 <i>1.516</i>
# IR-25.000x58.000x40.000	25.000 <i>0.984</i>	58.000 <i>2.283</i>	40.000 <i>1.575</i>

Indicates item not stocked at time of printing - Please enquire for lead time

E&OE Pricing and all details subject to change without notice - Copyright Miniature Bearings Australia Pty Ltd

MBA Size Listings are a guide to sizes only and must not be solely relied on for critical design information.

Bearings - Needle Roller - Inner Rings

Part Number	ID mm	OD mm	Length (L) mm
	<i>inches</i>	<i>inches</i>	<i>inches</i>
# IR-25.400x31.750x12.950	25.400 <i>1.000</i>	31.750 <i>1.250</i>	12.950 <i>0.510</i>
# IR-25.400x31.750x16.125	25.400 <i>1.000</i>	31.750 <i>1.250</i>	16.125 <i>0.635</i>
# IR-25.400x31.750x19.300	25.400 <i>1.000</i>	31.750 <i>1.250</i>	19.300 <i>0.760</i>
# IR-25.400x31.750x25.650	25.400 <i>1.000</i>	31.750 <i>1.250</i>	25.650 <i>1.010</i>
# IR-25.400x31.750x32.000	25.400 <i>1.000</i>	31.750 <i>1.250</i>	32.000 <i>1.260</i>
# IR-25.400x33.338x12.950	25.400 <i>1.000</i>	33.338 <i>1.313</i>	12.950 <i>0.510</i>
# IR-25.400x33.338x16.125	25.400 <i>1.000</i>	33.338 <i>1.313</i>	16.125 <i>0.635</i>
# IR-25.400x33.338x19.300	25.400 <i>1.000</i>	33.338 <i>1.313</i>	19.300 <i>0.760</i>
# IR-28.000x32.000x17.000	28.000 <i>1.102</i>	32.000 <i>1.260</i>	17.000 <i>0.669</i>
# IR-28.000x32.000x20.000	28.000 <i>1.102</i>	32.000 <i>1.260</i>	20.000 <i>0.787</i>

Indicates item not stocked at time of printing - Please enquire for lead time

E&OE Pricing and all details subject to change without notice - Copyright Miniature Bearings Australia Pty Ltd

MBA Size Listings are a guide to sizes only and must not be solely relied on for critical design information.

Bearings - Needle Roller - Inner Rings

Part Number	ID mm	OD mm	Length (L) mm
	<i>inches</i>	<i>inches</i>	<i>inches</i>
# IR-28.000x32.000x20.500	28.000 <i>1.102</i>	32.000 <i>1.260</i>	20.500 <i>0.807</i>
# IR-28.000x32.000x30.000	28.000 <i>1.102</i>	32.000 <i>1.260</i>	30.000 <i>1.181</i>
# IR-28.000x32.000x30.500	28.000 <i>1.102</i>	32.000 <i>1.260</i>	30.500 <i>1.201</i>
# IR-28.575x34.925x12.950	28.575 <i>1.125</i>	34.925 <i>1.375</i>	12.950 <i>0.510</i>
# IR-28.575x34.925x19.300	28.575 <i>1.125</i>	34.925 <i>1.375</i>	19.300 <i>0.760</i>
# IR-28.575x34.925x25.650	28.575 <i>1.125</i>	34.925 <i>1.375</i>	25.650 <i>1.010</i>
# IR-28.575x34.925x32.000	28.575 <i>1.125</i>	34.925 <i>1.375</i>	32.000 <i>1.260</i>
# IR-30.000x35.000x12.500	30.000 <i>1.181</i>	35.000 <i>1.378</i>	12.500 <i>0.492</i>
# IR-30.000x35.000x15.500	30.000 <i>1.181</i>	35.000 <i>1.378</i>	15.500 <i>0.610</i>
# IR-30.000x35.000x16.000	30.000 <i>1.181</i>	35.000 <i>1.378</i>	16.000 <i>0.630</i>

Indicates item not stocked at time of printing - Please enquire for lead time

E&OE Pricing and all details subject to change without notice - Copyright Miniature Bearings Australia Pty Ltd

MBA Size Listings are a guide to sizes only and must not be solely relied on for critical design information.

Bearings - Needle Roller - Inner Rings

Part Number	ID mm	OD mm	Length (L) mm
	<i>inches</i>	<i>inches</i>	<i>inches</i>
# IR-30.000x35.000x17.000	30.000 <i>1.181</i>	35.000 <i>1.378</i>	17.000 <i>0.669</i>
# IR-30.000x35.000x20.000	30.000 <i>1.181</i>	35.000 <i>1.378</i>	20.000 <i>0.787</i>
# IR-30.000x35.000x20.500	30.000 <i>1.181</i>	35.000 <i>1.378</i>	20.500 <i>0.807</i>
# IR-30.000x35.000x25.500	30.000 <i>1.181</i>	35.000 <i>1.378</i>	25.500 <i>1.004</i>
# IR-30.000x35.000x26.000	30.000 <i>1.181</i>	35.000 <i>1.378</i>	26.000 <i>1.024</i>
# IR-30.000x35.000x30.000	30.000 <i>1.181</i>	35.000 <i>1.378</i>	30.000 <i>1.181</i>
# IR-30.000x35.000x30.500	30.000 <i>1.181</i>	35.000 <i>1.378</i>	30.500 <i>1.201</i>
# IR-30.000x35.000x32.000	30.000 <i>1.181</i>	35.000 <i>1.378</i>	32.000 <i>1.260</i>
# IR-31.750x38.100x16.125	31.750 <i>1.250</i>	38.100 <i>1.500</i>	16.125 <i>0.635</i>
# IR-31.750x38.100x22.475	31.750 <i>1.250</i>	38.100 <i>1.500</i>	22.475 <i>0.885</i>

Indicates item not stocked at time of printing - Please enquire for lead time

E&OE Pricing and all details subject to change without notice - Copyright Miniature Bearings Australia Pty Ltd

MBA Size Listings are a guide to sizes only and must not be solely relied on for critical design information.

Bearings - Needle Roller - Inner Rings

Part Number	ID mm	OD mm	Length (L) mm
	<i>inches</i>	<i>inches</i>	<i>inches</i>
# IR-31.750x38.100x25.650	31.750 <i>1.250</i>	38.100 <i>1.500</i>	25.650 <i>1.010</i>
# IR-31.750x38.100x32.000	31.750 <i>1.250</i>	38.100 <i>1.500</i>	32.000 <i>1.260</i>
# IR-32.000x37.000x20.000	32.000 <i>1.260</i>	37.000 <i>1.457</i>	20.000 <i>0.787</i>
# IR-32.000x37.000x20.500	32.000 <i>1.260</i>	37.000 <i>1.457</i>	20.500 <i>0.807</i>
# IR-32.000x37.000x30.000	32.000 <i>1.260</i>	37.000 <i>1.457</i>	30.000 <i>1.181</i>
# IR-32.000x37.000x30.500	32.000 <i>1.260</i>	37.000 <i>1.457</i>	30.500 <i>1.201</i>
# IR-32.000x38.000x15.500	32.000 <i>1.260</i>	38.000 <i>1.496</i>	15.500 <i>0.610</i>
# IR-32.000x38.000x20.500	32.000 <i>1.260</i>	38.000 <i>1.496</i>	20.500 <i>0.807</i>
# IR-32.000x38.000x25.500	32.000 <i>1.260</i>	38.000 <i>1.496</i>	25.500 <i>1.004</i>
# IR-32.000x38.000x30.500	32.000 <i>1.260</i>	38.000 <i>1.496</i>	30.500 <i>1.201</i>

Indicates item not stocked at time of printing - Please enquire for lead time

E&OE Pricing and all details subject to change without notice - Copyright Miniature Bearings Australia Pty Ltd

MBA Size Listings are a guide to sizes only and must not be solely relied on for critical design information.

Bearings - Needle Roller - Inner Rings

Part Number	ID mm	OD mm	Length (L) mm
	<i>inches</i>	<i>inches</i>	<i>inches</i>
# IR-32.000x38.000x45.500	32.000 <i>1.260</i>	38.000 <i>1.496</i>	45.500 <i>1.791</i>
# IR-32.000x40.000x20.000	32.000 <i>1.260</i>	40.000 <i>1.575</i>	20.000 <i>0.787</i>
# IR-32.000x40.000x20.500	32.000 <i>1.260</i>	40.000 <i>1.575</i>	20.500 <i>0.807</i>
# IR-32.000x40.000x36.000	32.000 <i>1.260</i>	40.000 <i>1.575</i>	36.000 <i>1.417</i>
# IR-34.925x41.275x16.125	34.925 <i>1.375</i>	41.275 <i>1.625</i>	16.125 <i>0.635</i>
# IR-34.925x41.275x25.650	34.925 <i>1.375</i>	41.275 <i>1.625</i>	25.650 <i>1.010</i>
# IR-34.925x41.275x32.000	34.925 <i>1.375</i>	41.275 <i>1.625</i>	32.000 <i>1.260</i>
# IR-35.000x40.000x15.500	35.000 <i>1.378</i>	40.000 <i>1.575</i>	15.500 <i>0.610</i>
# IR-35.000x40.000x17.000	35.000 <i>1.378</i>	40.000 <i>1.575</i>	17.000 <i>0.669</i>
# IR-35.000x40.000x20.000	35.000 <i>1.378</i>	40.000 <i>1.575</i>	20.000 <i>0.787</i>

Indicates item not stocked at time of printing - Please enquire for lead time

E&OE Pricing and all details subject to change without notice - Copyright Miniature Bearings Australia Pty Ltd

MBA Size Listings are a guide to sizes only and must not be solely relied on for critical design information.

Bearings - Needle Roller - Inner Rings

Part Number	ID mm	OD mm	Length (L) mm
	<i>inches</i>	<i>inches</i>	<i>inches</i>
# IR-35.000x40.000x25.500	35.000 <i>1.378</i>	40.000 <i>1.575</i>	25.500 <i>1.004</i>
# IR-35.000x40.000x30.000	35.000 <i>1.378</i>	40.000 <i>1.575</i>	30.000 <i>1.181</i>
# IR-35.000x40.000x30.500	35.000 <i>1.378</i>	40.000 <i>1.575</i>	30.500 <i>1.201</i>
# IR-35.000x40.000x34.000	35.000 <i>1.378</i>	40.000 <i>1.575</i>	34.000 <i>1.339</i>
# IR-35.000x40.000x40.000	35.000 <i>1.378</i>	40.000 <i>1.575</i>	40.000 <i>1.575</i>
# IR-35.000x40.000x40.500	35.000 <i>1.378</i>	40.000 <i>1.575</i>	40.500 <i>1.594</i>
# IR-35.000x42.000x20.000	35.000 <i>1.378</i>	42.000 <i>1.654</i>	20.000 <i>0.787</i>
# IR-35.000x42.000x30.500	35.000 <i>1.378</i>	42.000 <i>1.654</i>	30.500 <i>1.201</i>
# IR-35.000x42.000x36.000	35.000 <i>1.378</i>	42.000 <i>1.654</i>	36.000 <i>1.417</i>
# IR-36.512x44.450x25.650	36.512 <i>1.437</i>	44.450 <i>1.750</i>	25.650 <i>1.010</i>

Indicates item not stocked at time of printing - Please enquire for lead time

E&OE Pricing and all details subject to change without notice - Copyright Miniature Bearings Australia Pty Ltd

MBA Size Listings are a guide to sizes only and must not be solely relied on for critical design information.

Bearings - Needle Roller - Inner Rings

Part Number	ID mm	OD mm	Length (L) mm
	<i>inches</i>	<i>inches</i>	<i>inches</i>
# IR-38.000x43.000x20.000	38.000 <i>1.496</i>	43.000 <i>1.693</i>	20.000 <i>0.787</i>
# IR-38.000x43.000x30.000	38.000 <i>1.496</i>	43.000 <i>1.693</i>	30.000 <i>1.181</i>
# IR-38.100x44.450x19.300	38.100 <i>1.500</i>	44.450 <i>1.750</i>	19.300 <i>0.760</i>
# IR-38.100x44.450x25.650	38.100 <i>1.500</i>	44.450 <i>1.750</i>	25.650 <i>1.010</i>
# IR-38.100x44.450x32.000	38.100 <i>1.500</i>	44.450 <i>1.750</i>	32.000 <i>1.260</i>
# IR-38.100x44.450x38.350	38.100 <i>1.500</i>	44.450 <i>1.750</i>	38.350 <i>1.510</i>
# IR-38.100x47.625x12.950	38.100 <i>1.500</i>	47.625 <i>1.875</i>	12.950 <i>0.510</i>
# IR-38.100x47.625x16.125	38.100 <i>1.500</i>	47.625 <i>1.875</i>	16.125 <i>0.635</i>
# IR-38.100x47.625x32.000	38.100 <i>1.500</i>	47.625 <i>1.875</i>	32.000 <i>1.260</i>
# IR-40.000x45.000x17.000	40.000 <i>1.575</i>	45.000 <i>1.772</i>	17.000 <i>0.669</i>

Indicates item not stocked at time of printing - Please enquire for lead time

E&OE Pricing and all details subject to change without notice - Copyright Miniature Bearings Australia Pty Ltd

MBA Size Listings are a guide to sizes only and must not be solely relied on for critical design information.

Bearings - Needle Roller - Inner Rings

Part Number	ID mm	OD mm	Length (L) mm
	<i>inches</i>	<i>inches</i>	<i>inches</i>
# IR-40.000x45.000x20.000	40.000 <i>1.575</i>	45.000 <i>1.772</i>	20.000 <i>0.787</i>
# IR-40.000x45.000x20.500	40.000 <i>1.575</i>	45.000 <i>1.772</i>	20.500 <i>0.807</i>
# IR-40.000x45.000x25.500	40.000 <i>1.575</i>	45.000 <i>1.772</i>	25.500 <i>1.004</i>
# IR-40.000x45.000x30.000	40.000 <i>1.575</i>	45.000 <i>1.772</i>	30.000 <i>1.181</i>
# IR-40.000x45.000x30.500	40.000 <i>1.575</i>	45.000 <i>1.772</i>	30.500 <i>1.201</i>
# IR-40.000x45.000x34.000	40.000 <i>1.575</i>	45.000 <i>1.772</i>	34.000 <i>1.339</i>
# IR-40.000x45.000x40.000	40.000 <i>1.575</i>	45.000 <i>1.772</i>	40.000 <i>1.575</i>
# IR-40.000x45.000x40.500	40.000 <i>1.575</i>	45.000 <i>1.772</i>	40.500 <i>1.594</i>
# IR-40.000x48.000x22.000	40.000 <i>1.575</i>	48.000 <i>1.890</i>	22.000 <i>0.866</i>
# IR-40.000x48.000x40.000	40.000 <i>1.575</i>	48.000 <i>1.890</i>	40.000 <i>1.575</i>

Indicates item not stocked at time of printing - Please enquire for lead time

E&OE Pricing and all details subject to change without notice - Copyright Miniature Bearings Australia Pty Ltd

MBA Size Listings are a guide to sizes only and must not be solely relied on for critical design information.

Bearings - Needle Roller - Inner Rings

Part Number	ID mm	OD mm	Length (L) mm
	<i>inches</i>	<i>inches</i>	<i>inches</i>
# IR-41.275x50.800x25.650	41.275 <i>1.625</i>	50.800 <i>2.000</i>	25.650 <i>1.010</i>
# IR-41.275x50.800x32.000	41.275 <i>1.625</i>	50.800 <i>2.000</i>	32.000 <i>1.260</i>
# IR-41.275x50.800x44.700	41.275 <i>1.625</i>	50.800 <i>2.000</i>	44.700 <i>1.760</i>
# IR-42.000x47.000x20.000	42.000 <i>1.654</i>	47.000 <i>1.850</i>	20.000 <i>0.787</i>
# IR-42.000x47.000x30.000	42.000 <i>1.654</i>	47.000 <i>1.850</i>	30.000 <i>1.181</i>
# IR-42.000x48.000x30.500	42.000 <i>1.654</i>	48.000 <i>1.890</i>	30.500 <i>1.201</i>
# IR-42.862x50.800x32.000	42.862 <i>1.687</i>	50.800 <i>2.000</i>	32.000 <i>1.260</i>
# IR-44.450x57.150x38.350	44.450 <i>1.750</i>	57.150 <i>2.250</i>	38.350 <i>1.510</i>
# IR-44.450x57.150x44.700	44.450 <i>1.750</i>	57.150 <i>2.250</i>	44.700 <i>1.760</i>
# IR-45.000x50.000x12.500	45.000 <i>1.772</i>	50.000 <i>1.969</i>	12.500 <i>0.492</i>

Indicates item not stocked at time of printing - Please enquire for lead time

E&OE Pricing and all details subject to change without notice - Copyright Miniature Bearings Australia Pty Ltd

MBA Size Listings are a guide to sizes only and must not be solely relied on for critical design information.

Bearings - Needle Roller - Inner Rings

Part Number	ID mm	OD mm	Length (L) mm
	<i>inches</i>	<i>inches</i>	<i>inches</i>
# IR-45.000x50.000x15.500	45.000 <i>1.772</i>	50.000 <i>1.969</i>	15.500 <i>0.610</i>
# IR-45.000x50.000x20.000	45.000 <i>1.772</i>	50.000 <i>1.969</i>	20.000 <i>0.787</i>
# IR-45.000x50.000x20.500	45.000 <i>1.772</i>	50.000 <i>1.969</i>	20.500 <i>0.807</i>
# IR-45.000x50.000x25.000	45.000 <i>1.772</i>	50.000 <i>1.969</i>	25.000 <i>0.984</i>
# IR-45.000x50.000x25.500	45.000 <i>1.772</i>	50.000 <i>1.969</i>	25.500 <i>1.004</i>
# IR-45.000x50.000x30.500	45.000 <i>1.772</i>	50.000 <i>1.969</i>	30.500 <i>1.201</i>
# IR-45.000x50.000x35.000	45.000 <i>1.772</i>	50.000 <i>1.969</i>	35.000 <i>1.378</i>
# IR-45.000x50.000x40.000	45.000 <i>1.772</i>	50.000 <i>1.969</i>	40.000 <i>1.575</i>
# IR-45.000x50.000x40.500	45.000 <i>1.772</i>	50.000 <i>1.969</i>	40.500 <i>1.594</i>
# IR-45.000x50.000x45.500	45.000 <i>1.772</i>	50.000 <i>1.969</i>	45.500 <i>1.791</i>

Indicates item not stocked at time of printing - Please enquire for lead time

E&OE Pricing and all details subject to change without notice - Copyright Miniature Bearings Australia Pty Ltd

MBA Size Listings are a guide to sizes only and must not be solely relied on for critical design information.

Bearings - Needle Roller - Inner Rings

Part Number	ID mm	OD mm	Length (L) mm
	<i>inches</i>	<i>inches</i>	<i>inches</i>
# IR-45.000x52.000x22.000	45.000 <i>1.772</i>	52.000 <i>2.047</i>	22.000 <i>0.866</i>
# IR-45.000x52.000x40.000	45.000 <i>1.772</i>	52.000 <i>2.047</i>	40.000 <i>1.575</i>
# IR-45.000x55.000x20.000	45.000 <i>1.772</i>	55.000 <i>2.165</i>	20.000 <i>0.787</i>
# IR-45.000x55.000x40.000	45.000 <i>1.772</i>	55.000 <i>2.165</i>	40.000 <i>1.575</i>
# IR-47.625x53.975x25.650	47.625 <i>1.875</i>	53.975 <i>2.125</i>	25.650 <i>1.010</i>
# IR-47.625x53.975x38.350	47.625 <i>1.875</i>	53.975 <i>2.125</i>	38.350 <i>1.510</i>
# IR-50.000x55.000x20.000	50.000 <i>1.969</i>	55.000 <i>2.165</i>	20.000 <i>0.787</i>
# IR-50.000x55.000x20.500	50.000 <i>1.969</i>	55.000 <i>2.165</i>	20.500 <i>0.807</i>
# IR-50.000x55.000x25.000	50.000 <i>1.969</i>	55.000 <i>2.165</i>	25.000 <i>0.984</i>
# IR-50.000x55.000x25.500	50.000 <i>1.969</i>	55.000 <i>2.165</i>	25.500 <i>1.004</i>

Indicates item not stocked at time of printing - Please enquire for lead time

E&OE Pricing and all details subject to change without notice - Copyright Miniature Bearings Australia Pty Ltd

MBA Size Listings are a guide to sizes only and must not be solely relied on for critical design information.

Bearings - Needle Roller - Inner Rings

Part Number	ID mm	OD mm	Length (L) mm
	<i>inches</i>	<i>inches</i>	<i>inches</i>
# IR-50.000x55.000x30.500	50.000 <i>1.969</i>	55.000 <i>2.165</i>	30.500 <i>1.201</i>
# IR-50.000x55.000x35.000	50.000 <i>1.969</i>	55.000 <i>2.165</i>	35.000 <i>1.378</i>
# IR-50.000x55.000x40.000	50.000 <i>1.969</i>	55.000 <i>2.165</i>	40.000 <i>1.575</i>
# IR-50.000x55.000x40.500	50.000 <i>1.969</i>	55.000 <i>2.165</i>	40.500 <i>1.594</i>
# IR-50.000x55.000x45.500	50.000 <i>1.969</i>	55.000 <i>2.165</i>	45.500 <i>1.791</i>
# IR-50.000x55.000x50.500	50.000 <i>1.969</i>	55.000 <i>2.165</i>	50.500 <i>1.988</i>
# IR-50.000x58.000x22.000	50.000 <i>1.969</i>	58.000 <i>2.283</i>	22.000 <i>0.866</i>
# IR-50.000x58.000x45.500	50.000 <i>1.969</i>	58.000 <i>2.283</i>	45.500 <i>1.791</i>
# IR-50.000x60.000x20.000	50.000 <i>1.969</i>	60.000 <i>2.362</i>	20.000 <i>0.787</i>
# IR-50.000x60.000x25.500	50.000 <i>1.969</i>	60.000 <i>2.362</i>	25.500 <i>1.004</i>

Indicates item not stocked at time of printing - Please enquire for lead time

E&OE Pricing and all details subject to change without notice - Copyright Miniature Bearings Australia Pty Ltd

MBA Size Listings are a guide to sizes only and must not be solely relied on for critical design information.

Bearings - Needle Roller - Inner Rings

Part Number	ID mm	OD mm	Length (L) mm
	<i>inches</i>	<i>inches</i>	<i>inches</i>
# IR-50.000x60.000x30.500	50.000 <i>1.969</i>	60.000 <i>2.362</i>	30.500 <i>1.201</i>
# IR-50.000x60.000x40.000	50.000 <i>1.969</i>	60.000 <i>2.362</i>	40.000 <i>1.575</i>
# IR-50.000x60.000x40.500	50.000 <i>1.969</i>	60.000 <i>2.362</i>	40.500 <i>1.594</i>
# IR-50.000x60.000x45.500	50.000 <i>1.969</i>	60.000 <i>2.362</i>	45.500 <i>1.791</i>
# IR-50.000x60.000x50.500	50.000 <i>1.969</i>	60.000 <i>2.362</i>	50.500 <i>1.988</i>
# IR-50.800x63.500x38.350	50.800 <i>2.000</i>	63.500 <i>2.500</i>	38.350 <i>1.510</i>
# IR-50.800x63.500x44.700	50.800 <i>2.000</i>	63.500 <i>2.500</i>	44.700 <i>1.760</i>
# IR-52.000x62.000x12.500	52.000 <i>2.047</i>	62.000 <i>2.441</i>	12.500 <i>0.492</i>
# IR-55.000x60.000x25.000	55.000 <i>2.165</i>	60.000 <i>2.362</i>	25.000 <i>0.984</i>
# IR-55.000x60.000x35.000	55.000 <i>2.165</i>	60.000 <i>2.362</i>	35.000 <i>1.378</i>

Indicates item not stocked at time of printing - Please enquire for lead time

E&OE Pricing and all details subject to change without notice - Copyright Miniature Bearings Australia Pty Ltd

MBA Size Listings are a guide to sizes only and must not be solely relied on for critical design information.

Bearings - Needle Roller - Inner Rings

Part Number	ID mm	OD mm	Length (L) mm
	<i>inches</i>	<i>inches</i>	<i>inches</i>
# IR-55.000x62.000x38.500	55.000 <i>2.165</i>	62.000 <i>2.441</i>	38.500 <i>1.516</i>
# IR-55.000x63.000x25.000	55.000 <i>2.165</i>	63.000 <i>2.480</i>	25.000 <i>0.984</i>
# IR-55.000x63.000x45.000	55.000 <i>2.165</i>	63.000 <i>2.480</i>	45.000 <i>1.772</i>
# IR-55.000x65.000x25.500	55.000 <i>2.165</i>	65.000 <i>2.559</i>	25.500 <i>1.004</i>
# IR-55.000x65.000x30.000	55.000 <i>2.165</i>	65.000 <i>2.559</i>	30.000 <i>1.181</i>
# IR-55.000x65.000x30.500	55.000 <i>2.165</i>	65.000 <i>2.559</i>	30.500 <i>1.201</i>
# IR-55.000x65.000x45.500	55.000 <i>2.165</i>	65.000 <i>2.559</i>	45.500 <i>1.791</i>
# IR-55.000x65.000x50.500	55.000 <i>2.165</i>	65.000 <i>2.559</i>	50.500 <i>1.988</i>
# IR-55.000x65.000x60.000	55.000 <i>2.165</i>	65.000 <i>2.559</i>	60.000 <i>2.362</i>
# IR-57.150x66.675x25.650	57.150 <i>2.250</i>	66.675 <i>2.625</i>	25.650 <i>1.010</i>

Indicates item not stocked at time of printing - Please enquire for lead time

E&OE Pricing and all details subject to change without notice - Copyright Miniature Bearings Australia Pty Ltd

MBA Size Listings are a guide to sizes only and must not be solely relied on for critical design information.

Bearings - Needle Roller - Inner Rings

Part Number	ID mm	OD mm	Length (L) mm
	<i>inches</i>	<i>inches</i>	<i>inches</i>
# IR-57.150x69.850x38.350	57.150 <i>2.250</i>	69.850 <i>2.750</i>	38.350 <i>1.510</i>
# IR-57.150x69.850x44.700	57.150 <i>2.250</i>	69.850 <i>2.750</i>	44.700 <i>1.760</i>
# IR-60.000x68.000x25.000	60.000 <i>2.362</i>	68.000 <i>2.677</i>	25.000 <i>0.984</i>
# IR-60.000x68.000x35.000	60.000 <i>2.362</i>	68.000 <i>2.677</i>	35.000 <i>1.378</i>
# IR-60.000x68.000x45.000	60.000 <i>2.362</i>	68.000 <i>2.677</i>	45.000 <i>1.772</i>
# IR-60.000x70.000x25.500	60.000 <i>2.362</i>	70.000 <i>2.756</i>	25.500 <i>1.004</i>
# IR-60.000x70.000x30.000	60.000 <i>2.362</i>	70.000 <i>2.756</i>	30.000 <i>1.181</i>
# IR-60.000x70.000x30.500	60.000 <i>2.362</i>	70.000 <i>2.756</i>	30.500 <i>1.201</i>
# IR-60.000x70.000x40.000	60.000 <i>2.362</i>	70.000 <i>2.756</i>	40.000 <i>1.575</i>
# IR-60.000x70.000x40.500	60.000 <i>2.362</i>	70.000 <i>2.756</i>	40.500 <i>1.594</i>

Indicates item not stocked at time of printing - Please enquire for lead time

E&OE Pricing and all details subject to change without notice - Copyright Miniature Bearings Australia Pty Ltd

MBA Size Listings are a guide to sizes only and must not be solely relied on for critical design information.

Bearings - Needle Roller - Inner Rings

Part Number	ID mm	OD mm	Length (L) mm
	<i>inches</i>	<i>inches</i>	<i>inches</i>
# IR-60.000x70.000x45.500	60.000 <i>2.362</i>	70.000 <i>2.756</i>	45.500 <i>1.791</i>
# IR-60.000x70.000x50.500	60.000 <i>2.362</i>	70.000 <i>2.756</i>	50.500 <i>1.988</i>
# IR-60.000x70.000x60.000	60.000 <i>2.362</i>	70.000 <i>2.756</i>	60.000 <i>2.362</i>
# IR-63.500x69.850x25.650	63.500 <i>2.500</i>	69.850 <i>2.750</i>	25.650 <i>1.010</i>
# IR-63.500x69.850x32.000	63.500 <i>2.500</i>	69.850 <i>2.750</i>	32.000 <i>1.260</i>
# IR-63.500x76.200x38.350	63.500 <i>2.500</i>	76.200 <i>3.000</i>	38.350 <i>1.510</i>
# IR-63.500x76.200x44.700	63.500 <i>2.500</i>	76.200 <i>3.000</i>	44.700 <i>1.760</i>
# IR-65.000x72.000x25.000	65.000 <i>2.559</i>	72.000 <i>2.835</i>	25.000 <i>0.984</i>
# IR-65.000x72.000x45.000	65.000 <i>2.559</i>	72.000 <i>2.835</i>	45.000 <i>1.772</i>
# IR-65.000x73.000x35.000	65.000 <i>2.559</i>	73.000 <i>2.874</i>	35.000 <i>1.378</i>

Indicates item not stocked at time of printing - Please enquire for lead time

E&OE Pricing and all details subject to change without notice - Copyright Miniature Bearings Australia Pty Ltd

MBA Size Listings are a guide to sizes only and must not be solely relied on for critical design information.

Bearings - Needle Roller - Inner Rings

Part Number	ID mm	OD mm	Length (L) mm
	<i>inches</i>	<i>inches</i>	<i>inches</i>
# IR-65.000x75.000x30.000	65.000 <i>2.559</i>	75.000 <i>2.953</i>	30.000 <i>1.181</i>
# IR-65.000x75.000x60.000	65.000 <i>2.559</i>	75.000 <i>2.953</i>	60.000 <i>2.362</i>
# IR-69.850x82.550x44.700	69.850 <i>2.750</i>	82.550 <i>3.250</i>	44.700 <i>1.760</i>
# IR-69.850x82.550x51.050	69.850 <i>2.750</i>	82.550 <i>3.250</i>	51.050 <i>2.010</i>
# IR-70.000x80.000x25.000	70.000 <i>2.756</i>	80.000 <i>3.150</i>	25.000 <i>0.984</i>
# IR-70.000x80.000x30.000	70.000 <i>2.756</i>	80.000 <i>3.150</i>	30.000 <i>1.181</i>
# IR-70.000x80.000x35.000	70.000 <i>2.756</i>	80.000 <i>3.150</i>	35.000 <i>1.378</i>
# IR-70.000x80.000x54.000	70.000 <i>2.756</i>	80.000 <i>3.150</i>	54.000 <i>2.126</i>
# IR-70.000x80.000x60.000	70.000 <i>2.756</i>	80.000 <i>3.150</i>	60.000 <i>2.362</i>
# IR-75.000x83.000x45.500	75.000 <i>2.953</i>	83.000 <i>3.268</i>	45.500 <i>1.791</i>

Indicates item not stocked at time of printing - Please enquire for lead time

E&OE Pricing and all details subject to change without notice - Copyright Miniature Bearings Australia Pty Ltd

MBA Size Listings are a guide to sizes only and must not be solely relied on for critical design information.

Bearings - Needle Roller - Inner Rings

Part Number	ID mm	OD mm	Length (L) mm
	<i>inches</i>	<i>inches</i>	<i>inches</i>
# IR-75.000x85.000x25.000	75.000 <i>2.953</i>	85.000 <i>3.346</i>	25.000 <i>0.984</i>
# IR-75.000x85.000x30.000	75.000 <i>2.953</i>	85.000 <i>3.346</i>	30.000 <i>1.181</i>
# IR-76.200x88.900x51.050	76.200 <i>3.000</i>	88.900 <i>3.500</i>	51.050 <i>2.010</i>
# IR-82.550x95.250x51.050	82.550 <i>3.250</i>	95.250 <i>3.750</i>	51.050 <i>2.010</i>
# IR-88.900x101.600x51.050	88.900 <i>3.500</i>	101.600 <i>4.000</i>	51.050 <i>2.010</i>
# IR-95.250x107.950x51.050	95.250 <i>3.750</i>	107.950 <i>4.250</i>	51.050 <i>2.010</i>

Indicates item not stocked at time of printing - Please enquire for lead time

E&OE Pricing and all details subject to change without notice - Copyright Miniature Bearings Australia Pty Ltd

MBA Size Listings are a guide to sizes only and must not be solely relied on for critical design information.



DISTRIBUTED BY

Ask us to put your name and address here

<http://www.minibearings.com.au/product>

Ph +61 7 3245 7977

Fax +61 7 3245 1017

Catalogue requests to catalogues@minibearings.com.au

