

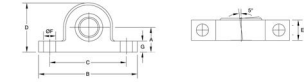

# MBA

## Bearings - Spyraflo - Pillow Block - Self Aligning



Robust light weight aluminium housing with self aligning needle roller or bronze bearings.

See links at bottom of web page for more information

+/- 5% Static Alignment

Sintered aluminium housing

Corrosion Resistant

Light weight

This catalogue to be read in conjunction with information at <http://www.minibearings.com.au/ogue/tech/spyraflo/Spyraflo Sizes and Types Guide.pdf>

<http://www.minibearings.com.au/ogue/tech/>

<http://www.minibearings.com.au/www.spyraflo.com/products/animation.php>

### Bearings - Spyraflo - Pillow Block - Self Aligning

Part Number	Nominal Shaft Size mm	Max. Radial Dynamic Load N	Material	Min to Max Shaft Dia. mm	Max Speed RPM	A mm	B mm	C mm	D mm	More Information
	<i>inches</i>			<i>inches</i>		<i>inches</i>	<i>inches</i>	<i>inches</i>	<i>inches</i>	
PB1-6M-B	6.000	940	Sintered Bronze SAE840	6.020 to 6.040	16110	14.50	57.00	44.50	28.50	Refer Tech Data Sheet
	0.236					0.571	2.244	1.752	1.122	

# Indicates item not stocked at time of printing - Please enquire for lead time

E&OE Pricing and all details subject to change without notice - Copyright Miniature Bearings Australia Pty Ltd

MBA Size Listings are a guide to sizes only and must not be solely relied on for critical design information.

## Bearings - Spyraflo - Pillow Block - Self Aligning

Part Number	Nominal Shaft Size mm	Max. Radial Dynamic Load N	Material	Min to Max Shaft Dia. mm	Max Speed RPM	A mm	B mm	C mm	D mm	More Information
	<i>inches</i>			<i>inches</i>		<i>inches</i>	<i>inches</i>	<i>inches</i>	<i>inches</i>	
PB1-6M-N	6.000	940	Needle Roller	5.992 to 6.000	35000	14.50	57.00	44.50	28.50	Refer Tech Data Sheet
	<i>0.236</i>					<i>0.571</i>	<i>2.244</i>	<i>1.752</i>	<i>1.122</i>	
# PB1-6M-P	6.000	950	Teflon Bronze	5.978 to 5.990	6360	14.50	57.00	44.50	28.50	Refer Tech Data Sheet
	<i>0.236</i>					<i>0.571</i>	<i>2.244</i>	<i>1.752</i>	<i>1.122</i>	
# PB1-6M-LT	6.000	950	Teflon Bronze - Low Temperature	5.978 to 5.990	6360	14.50	57.00	44.50	28.50	Refer Tech Data Sheet
	<i>0.236</i>					<i>0.571</i>	<i>2.244</i>	<i>1.752</i>	<i>1.122</i>	
# PB1-6M-HT	6.000	950	Teflon Bronze - High Temperature	5.978 to 5.990	6360	14.50	57.00	44.50	28.50	Refer Tech Data Sheet
	<i>0.236</i>					<i>0.571</i>	<i>2.244</i>	<i>1.752</i>	<i>1.122</i>	
# PB1-250-HT	6.350	934	Teflon Bronze - High Temperature	6.328 to 6.340	6020	14.22	57.15	44.45	28.70	Refer Tech Data Sheet
	<i>0.250</i>					<i>0.560</i>	<i>2.250</i>	<i>1.750</i>	<i>1.130</i>	
# PB1-250-P	6.350	934	Teflon Bronze	6.328 to 6.340	6020	14.22	57.15	44.45	28.70	Refer Tech Data Sheet
	<i>0.250</i>					<i>0.560</i>	<i>2.250</i>	<i>1.750</i>	<i>1.130</i>	
PB1-250-B	6.350	934	Sintered Bronze SAE840	6.370 to 6.390	15270	14.22	57.15	44.45	28.70	Refer Tech Data Sheet
	<i>0.250</i>					<i>0.560</i>	<i>2.250</i>	<i>1.750</i>	<i>1.130</i>	

# Indicates item not stocked at time of printing - Please enquire for lead time

E&OE Pricing and all details subject to change without notice - Copyright Miniature Bearings Australia Pty Ltd

MBA Size Listings are a guide to sizes only and must not be solely relied on for critical design information.

## Bearings - Spyraflo - Pillow Block - Self Aligning

Part Number	Nominal Shaft Size mm	Max. Radial Dynamic Load N	Material	Min to Max Shaft Dia. mm	Max Speed RPM	A mm	B mm	C mm	D mm	More Information
	<i>inches</i>			<i>inches</i>		<i>inches</i>	<i>inches</i>	<i>inches</i>	<i>inches</i>	
# PB1-250-LT	6.350	934	Teflon Bronze - Low Temperature	6.328 to 6.340	6020	14.22	57.15	44.45	28.70	Refer Tech Data Sheet
	<i>0.250</i>					<i>0.560</i>	<i>2.250</i>	<i>1.750</i>	<i>1.130</i>	
PB1-250-N	6.350	934	Needle Roller	6.342 to 6.350	44000	14.22	57.15	44.45	28.58	Refer Tech Data Sheet
	<i>0.250</i>					<i>0.560</i>	<i>2.250</i>	<i>1.750</i>	<i>1.125</i>	
PB1-312-N	7.938	934	Needle Roller	7.929 to 7.938	35500	14.22	57.15	44.45	28.58	Refer Tech Data Sheet
	<i>0.313</i>					<i>0.560</i>	<i>2.250</i>	<i>1.750</i>	<i>1.125</i>	
# PB1-312-P	7.938	934	Teflon Bronze	7.910 to 7.925	4820	14.22	57.15	44.45	28.70	Refer Tech Data Sheet
	<i>0.313</i>					<i>0.560</i>	<i>2.250</i>	<i>1.750</i>	<i>1.130</i>	
PB1-312-B	7.938	934	Sintered Bronze SAE840	7.958 to 7.978	12240	14.22	57.15	44.45	28.70	Refer Tech Data Sheet
	<i>0.313</i>					<i>0.560</i>	<i>2.250</i>	<i>1.750</i>	<i>1.130</i>	
# PB1-312-HT	7.938	934	Teflon Bronze - High Temperature	7.916 to 7.928	4820	14.22	57.15	44.45	28.70	Refer Tech Data Sheet
	<i>0.313</i>					<i>0.560</i>	<i>2.250</i>	<i>1.750</i>	<i>1.130</i>	
# PB1-312-LT	7.938	934	Teflon Bronze - Low Temperature	7.916 to 7.928	4820	14.22	57.15	44.45	28.70	Refer Tech Data Sheet
	<i>0.313</i>					<i>0.560</i>	<i>2.250</i>	<i>1.750</i>	<i>1.130</i>	

# Indicates item not stocked at time of printing - Please enquire for lead time

E&OE Pricing and all details subject to change without notice - Copyright Miniature Bearings Australia Pty Ltd

MBA Size Listings are a guide to sizes only and must not be solely relied on for critical design information.

## Bearings - Spyraflo - Pillow Block - Self Aligning

Part Number	Nominal Shaft Size mm	Max. Radial Dynamic Load N	Material	Min to Max Shaft Dia. mm	Max Speed RPM	A mm	B mm	C mm	D mm	More Information
	<i>inches</i>			<i>inches</i>		<i>inches</i>	<i>inches</i>	<i>inches</i>	<i>inches</i>	
PB1-8M-N	8.000	940	Needle Roller	7.991 to 8.000	28000	14.50	57.00	44.50	28.50	Refer Tech Data Sheet
	<i>0.315</i>					<i>0.571</i>	<i>2.244</i>	<i>1.752</i>	<i>1.122</i>	
# PB1-8M-HT	8.000	950	Teflon Bronze - High Temperature	7.978 to 7.990	4770	14.50	57.00	44.50	28.50	Refer Tech Data Sheet
	<i>0.315</i>					<i>0.571</i>	<i>2.244</i>	<i>1.752</i>	<i>1.122</i>	
# PB1-8M-LT	8.000	950	Teflon Bronze - Low Temperature	7.978 to 7.990	4770	14.50	57.00	44.50	28.50	Refer Tech Data Sheet
	<i>0.315</i>					<i>0.571</i>	<i>2.244</i>	<i>1.752</i>	<i>1.122</i>	
# PB1-8M-P	8.000	950	Teflon Bronze	7.972 to 7.987	4770	14.50	57.00	44.50	28.50	Refer Tech Data Sheet
	<i>0.315</i>					<i>0.571</i>	<i>2.244</i>	<i>1.752</i>	<i>1.122</i>	
PB1-8M-B	8.000	960	Sintered Bronze SAE840	8.020 to 8.040	12120	14.50	57.00	44.50	28.50	Refer Tech Data Sheet
	<i>0.315</i>					<i>0.571</i>	<i>2.244</i>	<i>1.752</i>	<i>1.122</i>	
# PB1-375-HT	9.525	934	Teflon Bronze - High Temperature	9.502 to 9.512	4010	14.22	57.15	44.45	28.70	Refer Tech Data Sheet
	<i>0.375</i>					<i>0.560</i>	<i>2.250</i>	<i>1.750</i>	<i>1.130</i>	
# PB1-375-LT	9.525	934	Teflon Bronze - Low Temperature	9.502 to 9.512	4010	14.22	57.15	44.45	28.70	Refer Tech Data Sheet
	<i>0.375</i>					<i>0.560</i>	<i>2.250</i>	<i>1.750</i>	<i>1.130</i>	

# Indicates item not stocked at time of printing - Please enquire for lead time

E&OE Pricing and all details subject to change without notice - Copyright Miniature Bearings Australia Pty Ltd

MBA Size Listings are a guide to sizes only and must not be solely relied on for critical design information.

## Bearings - Spyraflo - Pillow Block - Self Aligning

Part Number	Nominal Shaft Size mm	Max. Radial Dynamic Load N	Material	Min to Max Shaft Dia. mm	Max Speed RPM	A mm	B mm	C mm	D mm	More Information
	<i>inches</i>			<i>inches</i>		<i>inches</i>	<i>inches</i>	<i>inches</i>	<i>inches</i>	
# PB1-375-P	9.525	934	Teflon Bronze	9.497 to 9.512	4010	14.22	57.15	44.45	28.70	Refer Tech Data Sheet
	<i>0.375</i>					<i>0.560</i>	<i>2.250</i>	<i>1.750</i>	<i>1.130</i>	
PB1-375-N	9.525	979	Needle Roller	9.516 to 9.525	29500	14.22	57.15	44.45	28.58	Refer Tech Data Sheet
	<i>0.375</i>					<i>0.560</i>	<i>2.250</i>	<i>1.750</i>	<i>1.125</i>	
PB1-375-B	9.525	979	Sintered Bronze SAE840	9.545 to 9.565	10180	14.22	57.15	44.45	28.70	Refer Tech Data Sheet
	<i>0.375</i>					<i>0.560</i>	<i>2.250</i>	<i>1.750</i>	<i>1.130</i>	
# PB1-10M-P	10.000	950	Teflon Bronze	9.977 to 9.987	3820	14.50	57.00	44.50	28.50	Refer Tech Data Sheet
	<i>0.394</i>					<i>0.571</i>	<i>2.244</i>	<i>1.752</i>	<i>1.122</i>	
# PB1-10M-HT	10.000	950	Teflon Bronze - High Temperature	9.977 to 9.987	3820	14.50	57.00	44.50	28.50	Refer Tech Data Sheet
	<i>0.394</i>					<i>0.571</i>	<i>2.244</i>	<i>1.752</i>	<i>1.122</i>	
# PB1-10M-LT	10.000	950	Teflon Bronze - Low Temperature	9.977 to 9.987	3820	14.50	57.00	44.50	28.50	Refer Tech Data Sheet
	<i>0.394</i>					<i>0.571</i>	<i>2.244</i>	<i>1.752</i>	<i>1.122</i>	
PB1-10M-N	10.000	960	Needle Roller	9.991 to 10.000	23000	14.50	57.00	44.50	28.50	Refer Tech Data Sheet
	<i>0.394</i>					<i>0.571</i>	<i>2.244</i>	<i>1.752</i>	<i>1.122</i>	

# Indicates item not stocked at time of printing - Please enquire for lead time

E&OE Pricing and all details subject to change without notice - Copyright Miniature Bearings Australia Pty Ltd

MBA Size Listings are a guide to sizes only and must not be solely relied on for critical design information.

## Bearings - Spyraflo - Pillow Block - Self Aligning

Part Number	Nominal Shaft Size mm	Max. Radial Dynamic Load N	Material	Min to Max Shaft Dia. mm	Max Speed RPM	A mm	B mm	C mm	D mm	More Information
	<i>inches</i>			<i>inches</i>		<i>inches</i>	<i>inches</i>	<i>inches</i>	<i>inches</i>	
PB1-10M-B	10.000	960	Sintered Bronze SAE840	10.020 to 10.040	9700	14.50	57.00	44.50	28.50	Refer Tech Data Sheet
	<i>0.394</i>					<i>0.571</i>	<i>2.244</i>	<i>1.752</i>	<i>1.122</i>	
PB1-12M-B	12.000	960	Sintered Bronze SAE840	12.030 to 12.050	8060	14.50	57.00	44.50	28.50	Refer Tech Data Sheet
	<i>0.472</i>					<i>0.571</i>	<i>2.244</i>	<i>1.752</i>	<i>1.122</i>	
# PB1-12M-P	12.000	1000	Teflon Bronze	11.972 to 11.987	2180	14.50	57.00	44.50	28.50	Refer Tech Data Sheet
	<i>0.472</i>					<i>0.571</i>	<i>2.244</i>	<i>1.752</i>	<i>1.122</i>	
# PB1-12M-HT	12.000	1000	Teflon Bronze - High Temperature	11.966 to 11.984	2180	14.50	57.00	44.50	28.50	Refer Tech Data Sheet
	<i>0.472</i>					<i>0.571</i>	<i>2.244</i>	<i>1.752</i>	<i>1.122</i>	
# PB1-12M-LT	12.000	1000	Teflon Bronze - Low Temperature	11.966 to 11.984	2180	14.50	57.00	44.50	28.50	Refer Tech Data Sheet
	<i>0.472</i>					<i>0.571</i>	<i>2.244</i>	<i>1.752</i>	<i>1.122</i>	
# PB2-12M-B	12.000	1700	Sintered Bronze SAE840	12.030 to 12.050	8060	19.00	82.50	63.50	39.50	Refer Tech Data Sheet
	<i>0.472</i>					<i>0.748</i>	<i>3.248</i>	<i>2.500</i>	<i>1.555</i>	
PB2-12M-N	12.000	1700	Needle Roller	11.989 to 12.000	20000	19.00	82.50	63.50	39.50	Refer Tech Data Sheet
	<i>0.472</i>					<i>0.748</i>	<i>3.248</i>	<i>2.500</i>	<i>1.555</i>	

# Indicates item not stocked at time of printing - Please enquire for lead time

E&OE Pricing and all details subject to change without notice - Copyright Miniature Bearings Australia Pty Ltd

MBA Size Listings are a guide to sizes only and must not be solely relied on for critical design information.

## Bearings - Spyraflo - Pillow Block - Self Aligning

Part Number	Nominal Shaft Size mm	Max. Radial Dynamic Load N	Material	Min to Max Shaft Dia. mm	Max Speed RPM	A mm	B mm	C mm	D mm	More Information
	<i>inches</i>			<i>inches</i>		<i>inches</i>	<i>inches</i>	<i>inches</i>	<i>inches</i>	
PB1-500-B	12.700	979	Sintered Bronze SAE840	12.730 to 12.750	7640	14.22	57.15	44.45	28.70	Refer Tech Data Sheet
	<i>0.500</i>					<i>0.560</i>	<i>2.250</i>	<i>1.750</i>	<i>1.130</i>	
# PB2-500-HT	12.700	1690	Teflon Bronze - High Temperature	12.666 to 12.684	3010	19.05	82.55	63.50	39.62	Refer Tech Data Sheet
	<i>0.500</i>					<i>0.750</i>	<i>3.250</i>	<i>2.500</i>	<i>1.560</i>	
# PB2-500-P	12.700	1690	Teflon Bronze	12.672 to 12.687	3010	19.05	82.55	63.50	39.62	Refer Tech Data Sheet
	<i>0.500</i>					<i>0.750</i>	<i>3.250</i>	<i>2.500</i>	<i>1.560</i>	
# PB2-500-LT	12.700	1690	Teflon Bronze - Low Temperature	12.666 to 12.684	3010	19.05	82.55	63.50	39.62	Refer Tech Data Sheet
	<i>0.500</i>					<i>0.750</i>	<i>3.250</i>	<i>2.500</i>	<i>1.560</i>	
PB2-500-N	12.700	1690	Needle Roller	12.689 to 12.700	22000	19.05	82.55	63.50	39.62	Refer Tech Data Sheet
	<i>0.500</i>					<i>0.750</i>	<i>3.250</i>	<i>2.500</i>	<i>1.560</i>	
# PB3-500-B	12.700	2135	Sintered Bronze SAE840	12.730 to 12.750	7640	25.40	101.60	79.50	49.28	Refer Tech Data Sheet
	<i>0.500</i>					<i>1.000</i>	<i>4.000</i>	<i>3.130</i>	<i>1.940</i>	
# PB2-15M-N	15.000	1500	Needle Roller	14.989 to 15.000	16000	19.00	82.50	63.50	39.50	Refer Tech Data Sheet
	<i>0.591</i>					<i>0.748</i>	<i>3.248</i>	<i>2.500</i>	<i>1.555</i>	

# Indicates item not stocked at time of printing - Please enquire for lead time

E&OE Pricing and all details subject to change without notice - Copyright Miniature Bearings Australia Pty Ltd

MBA Size Listings are a guide to sizes only and must not be solely relied on for critical design information.

## Bearings - Spyraflo - Pillow Block - Self Aligning

Part Number	Nominal Shaft Size mm	Max. Radial Dynamic Load N	Material	Min to Max Shaft Dia. mm	Max Speed RPM	A mm	B mm	C mm	D mm	More Information
	<i>inches</i>			<i>inches</i>		<i>inches</i>	<i>inches</i>	<i>inches</i>	<i>inches</i>	
PB2-15M-B	15.000	1700	Sintered Bronze SAE840	15.030 to 15.050	6460	19.00	82.50	63.50	39.50	Refer Tech Data Sheet
	<i>0.591</i>					<i>0.748</i>	<i>3.248</i>	<i>2.500</i>	<i>1.555</i>	
# PB2-625-HT	15.875	1468	Teflon Bronze - High Temperature	15.841 to 15.859	2410	19.05	82.55	63.50	39.62	Refer Tech Data Sheet
	<i>0.625</i>					<i>0.750</i>	<i>3.250</i>	<i>2.500</i>	<i>1.560</i>	
# PB2-625-P	15.875	1468	Teflon Bronze	15.824 to 15.849	2410	19.05	82.55	63.50	39.62	Refer Tech Data Sheet
	<i>0.625</i>					<i>0.750</i>	<i>3.250</i>	<i>2.500</i>	<i>1.560</i>	
# PB2-625-LT	15.875	1468	Teflon Bronze - Low Temperature	15.841 to 15.859	2410	19.05	82.55	63.50	39.62	Refer Tech Data Sheet
	<i>0.625</i>					<i>0.750</i>	<i>3.250</i>	<i>2.500</i>	<i>1.560</i>	
PB2-625-N	15.875	1468	Needle Roller	15.864 to 15.875	17600	19.05	82.55	63.50	39.62	Refer Tech Data Sheet
	<i>0.625</i>					<i>0.750</i>	<i>3.250</i>	<i>2.500</i>	<i>1.560</i>	
PB2-625-B	15.875	1690	Sintered Bronze SAE840	15.905 to 15.925	6110	19.05	82.55	63.50	49.28	Refer Tech Data Sheet
	<i>0.625</i>					<i>0.750</i>	<i>3.250</i>	<i>2.500</i>	<i>1.940</i>	
# PB3-625-B	15.875	2135	Sintered Bronze SAE840	15.905 to 15.925	6110	25.40	101.60	79.50	49.28	Refer Tech Data Sheet
	<i>0.625</i>					<i>1.000</i>	<i>4.000</i>	<i>3.130</i>	<i>1.940</i>	

# Indicates item not stocked at time of printing - Please enquire for lead time

E&OE Pricing and all details subject to change without notice - Copyright Miniature Bearings Australia Pty Ltd

MBA Size Listings are a guide to sizes only and must not be solely relied on for critical design information.

## Bearings - Spyraflo - Pillow Block - Self Aligning

Part Number	Nominal Shaft Size mm	Max. Radial Dynamic Load N	Material	Min to Max Shaft Dia. mm	Max Speed RPM	A mm	B mm	C mm	D mm	More Information
	<i>inches</i>			<i>inches</i>		<i>inches</i>	<i>inches</i>	<i>inches</i>	<i>inches</i>	
# PB2-16M-P	16.000	1500	Teflon Bronze	15.966 to 15.984	2390	19.00	82.50	63.50	39.50	Refer Tech Data Sheet
	<i>0.630</i>					<i>0.748</i>	<i>3.248</i>	<i>2.500</i>	<i>1.555</i>	
# PB2-16M-HT	16.000	1500	Teflon Bronze - High Temperature	15.966 to 15.984	2390	19.00	82.50	63.50	39.50	Refer Tech Data Sheet
	<i>0.630</i>					<i>0.748</i>	<i>3.248</i>	<i>2.500</i>	<i>1.555</i>	
# PB2-16M-N	16.000	1500	Needle Roller	15.989 to 16.000	16000	19.00	82.50	63.50	39.50	Refer Tech Data Sheet
	<i>0.630</i>					<i>0.748</i>	<i>3.248</i>	<i>2.500</i>	<i>1.555</i>	
# PB2-16M-LT	16.000	1500	Teflon Bronze - Low Temperature	15.966 to 15.984	2390	19.00	82.50	63.50	39.50	Refer Tech Data Sheet
	<i>0.630</i>					<i>0.748</i>	<i>3.248</i>	<i>2.500</i>	<i>1.555</i>	
# PB2-18M-B	18.000	1500	Sintered Bronze SAE840	18.030 to 18.050	5830	19.00	82.50	63.50	39.50	Refer Tech Data Sheet
	<i>0.709</i>					<i>0.748</i>	<i>3.248</i>	<i>2.500</i>	<i>1.555</i>	
# PB2-18M-HT	18.000	1500	Teflon Bronze - High Temperature	17.966 to 17.984	2120	19.00	82.50	63.50	39.50	Refer Tech Data Sheet
	<i>0.709</i>					<i>0.748</i>	<i>3.248</i>	<i>2.500</i>	<i>1.555</i>	
# PB2-18M-LT	18.000	1500	Teflon Bronze - Low Temperature	17.966 to 17.984	2120	19.00	82.50	63.50	39.50	Refer Tech Data Sheet
	<i>0.709</i>					<i>0.748</i>	<i>3.248</i>	<i>2.500</i>	<i>1.555</i>	

# Indicates item not stocked at time of printing - Please enquire for lead time

E&OE Pricing and all details subject to change without notice - Copyright Miniature Bearings Australia Pty Ltd

MBA Size Listings are a guide to sizes only and must not be solely relied on for critical design information.

## Bearings - Spyraflo - Pillow Block - Self Aligning

Part Number	Nominal Shaft Size mm	Max. Radial Dynamic Load N	Material	Min to Max Shaft Dia. mm	Max Speed RPM	A mm	B mm	C mm	D mm	More Information
	<i>inches</i>			<i>inches</i>		<i>inches</i>	<i>inches</i>	<i>inches</i>	<i>inches</i>	
# PB2-18M-P	18.000 <i>0.709</i>	1500	Teflon Bronze	17.966 to 17.984	2120	19.00 <i>0.748</i>	82.50 <i>3.248</i>	63.50 <i>2.500</i>	39.50 <i>1.555</i>	Refer Tech Data Sheet
# PB4-18M-N	18.000 <i>0.709</i>	4450	Needle Roller	17.989 to 18.000	14700	32.00 <i>1.260</i>	127.00 <i>5.000</i>	101.00 <i>3.976</i>	65.00 <i>2.559</i>	Refer Tech Data Sheet
# PB2-750-P	19.050 <i>0.750</i>	1468	Teflon Bronze	19.016 to 19.034	2010	19.05 <i>0.750</i>	82.55 <i>3.250</i>	63.50 <i>2.500</i>	39.62 <i>1.560</i>	Refer Tech Data Sheet
# PB2-750-HT	19.050 <i>0.750</i>	1468	Teflon Bronze - High Temperature	19.016 to 19.034	2010	19.05 <i>0.750</i>	82.55 <i>3.250</i>	63.50 <i>2.500</i>	39.62 <i>1.560</i>	Refer Tech Data Sheet
PB2-750-B	19.050 <i>0.750</i>	1468	Sintered Bronze SAE840	19.080 to 19.100	5090	19.05 <i>0.750</i>	82.55 <i>3.250</i>	63.50 <i>2.500</i>	39.62 <i>1.560</i>	Refer Tech Data Sheet
# PB2-750-LT	19.050 <i>0.750</i>	1468	Teflon Bronze - Low Temperature	19.016 to 19.034	2010	19.05 <i>0.750</i>	82.55 <i>3.250</i>	63.50 <i>2.500</i>	39.62 <i>1.560</i>	Refer Tech Data Sheet
# PB3-750-B	19.050 <i>0.750</i>	2135	Sintered Bronze SAE840	19.080 to 19.100	5090	25.40 <i>1.000</i>	101.60 <i>4.000</i>	79.50 <i>3.130</i>	49.28 <i>1.940</i>	Refer Tech Data Sheet

# Indicates item not stocked at time of printing - Please enquire for lead time

E&OE Pricing and all details subject to change without notice - Copyright Miniature Bearings Australia Pty Ltd

MBA Size Listings are a guide to sizes only and must not be solely relied on for critical design information.

## Bearings - Spyraflo - Pillow Block - Self Aligning

Part Number	Nominal Shaft Size mm	Max. Radial Dynamic Load N	Material	Min to Max Shaft Dia. mm	Max Speed RPM	A mm	B mm	C mm	D mm	More Information
	<i>inches</i>			<i>inches</i>		<i>inches</i>	<i>inches</i>	<i>inches</i>	<i>inches</i>	
# PB4-750-N	19.050 <i>0.750</i>	4448	Needle Roller	19.039 to 19.050	14700	31.75 <i>1.250</i>	127.00 <i>5.000</i>	101.60 <i>4.000</i>	65.02 <i>2.560</i>	Refer Tech Data Sheet
# PB3-20M-LT	20.000 <i>0.787</i>	1700	Teflon Bronze - Low Temperature	19.959 to 19.980	1900	25.00 <i>0.984</i>	100.00 <i>3.937</i>	79.40 <i>3.126</i>	49.20 <i>1.937</i>	Refer Tech Data Sheet
# PB3-20M-HT	20.000 <i>0.787</i>	1700	Teflon Bronze - High Temperature	19.959 to 19.980	1900	25.00 <i>0.984</i>	100.00 <i>3.937</i>	79.40 <i>3.126</i>	49.20 <i>1.937</i>	Refer Tech Data Sheet
PB3-875-B	22.225 <i>0.875</i>	1690	Sintered Bronze SAE840	22.255 to 22.275	4850	25.40 <i>1.000</i>	101.60 <i>4.000</i>	79.50 <i>3.130</i>	49.28 <i>1.940</i>	Refer Tech Data Sheet
# PB4-25M-LT	25.000 <i>0.984</i>	4450	Teflon Bronze - Low Temperature	24.959 to 24.980	1500	32.00 <i>1.260</i>	127.00 <i>5.000</i>	101.50 <i>3.996</i>	65.00 <i>2.559</i>	Refer Tech Data Sheet
# PB4-25M-HT	25.000 <i>0.984</i>	4450	Teflon Bronze - High Temperature	24.959 to 24.980	1500	32.00 <i>1.260</i>	127.00 <i>5.000</i>	101.50 <i>3.996</i>	65.00 <i>2.559</i>	Refer Tech Data Sheet
# PB4-25M-P	25.000 <i>0.984</i>	4450	Teflon Bronze	24.966 to 24.984	1500	32.00 <i>1.260</i>	127.00 <i>5.000</i>	101.50 <i>3.996</i>	65.00 <i>2.559</i>	Refer Tech Data Sheet

# Indicates item not stocked at time of printing - Please enquire for lead time

E&OE Pricing and all details subject to change without notice - Copyright Miniature Bearings Australia Pty Ltd

MBA Size Listings are a guide to sizes only and must not be solely relied on for critical design information.

## Bearings - Spyraflo - Pillow Block - Self Aligning

Part Number	Nominal Shaft Size mm	Max. Radial Dynamic Load N	Material	Min to Max Shaft Dia. mm	Max Speed RPM	A mm	B mm	C mm	D mm	More Information
	<i>inches</i>			<i>inches</i>		<i>inches</i>	<i>inches</i>	<i>inches</i>	<i>inches</i>	
PB4-25M-B	25.000	4450	Sintered Bronze SAE840	25.030 to 25.070	4600	32.00	127.00	101.50	65.00	Refer Tech Data Sheet
	<i>0.984</i>					<i>1.260</i>	<i>5.000</i>	<i>3.996</i>	<i>2.559</i>	
# PB4-1000-P	25.400	4448	Teflon Bronze	25.366 to 25.384	1500	31.75	127.00	101.60	65.02	Refer Tech Data Sheet
	<i>1.000</i>					<i>1.250</i>	<i>5.000</i>	<i>4.000</i>	<i>2.560</i>	
# PB4-1000-HT	25.400	4448	Teflon Bronze - High Temperature	25.359 to 25.380	1500	31.75	127.00	101.60	65.02	Refer Tech Data Sheet
	<i>1.000</i>					<i>1.250</i>	<i>5.000</i>	<i>4.000</i>	<i>2.560</i>	
# PB4-1000-LT	25.400	4448	Teflon Bronze - Low Temperature	25.359 to 25.380	1500	31.75	127.00	101.60	65.02	Refer Tech Data Sheet
	<i>1.000</i>					<i>1.250</i>	<i>5.000</i>	<i>4.000</i>	<i>2.560</i>	
# PB4-1000-B	25.400	4448	Sintered Bronze SAE840	25.430 to 25.470	4500	31.75	127.00	101.60	65.02	Refer Tech Data Sheet
	<i>1.000</i>					<i>1.250</i>	<i>5.000</i>	<i>4.000</i>	<i>2.560</i>	
# PB4-30M-B	30.000	4450	Sintered Bronze SAE840	30.030 to 30.070	3850	32.00	127.00	101.50	65.00	Refer Tech Data Sheet
	<i>1.181</i>					<i>1.260</i>	<i>5.000</i>	<i>3.996</i>	<i>2.559</i>	
# PB4-1250-B	31.750	4448	Sintered Bronze SAE840	31.780 to 31.820	3600	31.75	127.00	101.60	65.02	Refer Tech Data Sheet
	<i>1.250</i>					<i>1.250</i>	<i>5.000</i>	<i>4.000</i>	<i>2.560</i>	

# Indicates item not stocked at time of printing - Please enquire for lead time

E&OE Pricing and all details subject to change without notice - Copyright Miniature Bearings Australia Pty Ltd

MBA Size Listings are a guide to sizes only and must not be solely relied on for critical design information.



DISTRIBUTED BY

Ask us to put your name and address here

<http://www.minibearings.com.au/product>

Ph +61 7 3245 7977

Fax +61 7 3245 1017

Catalogue requests to [catalogues@minibearings.com.au](mailto:catalogues@minibearings.com.au)

