

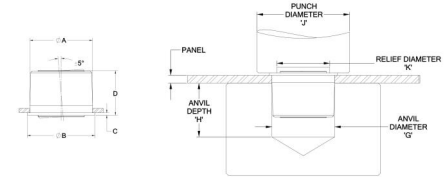

MBA

Bearings - Spyraflo - Press-Fit - Self Aligning



Needle roller, bronze and acetal bearings in specially designed press fit retainers

See links at bottom of web page for more information

+/- 5% Static Alignment

Use punch of min dia. J relieved to dia. K x 2mm deep.

Refer datasheet for dia. K and J. Link at bottom of web page.

This catalogue to be read in conjunction with information at <http://www.minibearings.com.au/ogue/tech/spyraflo/Spyraflo Sizes and Types Guide.pdf>

<http://www.minibearings.com.au/ogue/tech/>

Bearings - Spyraflo - Press-Fit - Self Aligning

Part Number	Nominal Shaft Size mm	Max. Radial Dynamic Load N	Material	Min to Max Shaft Dia. mm	Max Speed RPM	Mounting Hole (A) +0.07/-0.00 mm	Flange Diameter (B) mm	Flange Height (C) mm	Bearing Length (D) mm	More Information
# PSD-125-AF	3.175	133	Delrin AF	3.200 to 3.251	3010	8.74	10.41	0.76	6.86	Refer Tech Data Sheet
	0.125					0.344	0.410	0.030	0.270	
# PSD-125	3.175	133	Delrin	3.200 to 3.251	3010	8.74	10.41	0.76	6.86	Refer Tech Data Sheet
	0.125					0.344	0.410	0.030	0.270	

Indicates item not stocked at time of printing - Please enquire for lead time

E&OE Pricing and all details subject to change without notice - Copyright Miniature Bearings Australia Pty Ltd

MBA Size Listings are a guide to sizes only and must not be solely relied on for critical design information.

Bearings - Spyraflo - Press-Fit - Self Aligning

Part Number	Nominal Shaft Size mm	Max. Radial Dynamic Load N	Material	Min to Max Shaft Dia. mm	Max Speed RPM	Mounting Hole (A) +0.07/-0.00 mm	Flange Diameter (B) mm	Flange Height (C) mm	Bearing Length (D) mm	More Information
# PSB-125	3.175	311	Sintered Bronze SAE840	3.188 to 3.200	30550	8.74	10.41	0.76	6.86	Refer Tech Data Sheet
	<i>0.125</i>					<i>0.344</i>	<i>0.410</i>	<i>0.030</i>	<i>0.270</i>	
# PSN-125	3.175	1068	Needle Roller	3.167 to 3.175	31500	12.70	14.22	0.76	9.40	Refer Tech Data Sheet
	<i>0.125</i>					<i>0.500</i>	<i>0.560</i>	<i>0.030</i>	<i>0.370</i>	
# PSD-4M-AF	4.000	150	Delrin AF	4.020 to 4.070	2430	12.70	14.20	0.75	9.60	Refer Tech Data Sheet
	<i>0.157</i>					<i>0.500</i>	<i>0.559</i>	<i>0.030</i>	<i>0.378</i>	
# PSD-4M	4.000	150	Delrin	4.020 to 4.070	2430	12.70	14.20	0.75	9.60	Refer Tech Data Sheet
	<i>0.157</i>					<i>0.500</i>	<i>0.559</i>	<i>0.030</i>	<i>0.378</i>	
# PSB-4M	4.000	530	Sintered Bronze SAE840	4.010 to 4.030	24170	12.70	14.20	0.75	9.60	Refer Tech Data Sheet
	<i>0.157</i>					<i>0.500</i>	<i>0.559</i>	<i>0.030</i>	<i>0.378</i>	
# PSN-4M	4.000	1780	Needle Roller	3.992 to 4.000	41000	15.90	17.40	0.75	10.80	Refer Tech Data Sheet
	<i>0.157</i>					<i>0.626</i>	<i>0.685</i>	<i>0.030</i>	<i>0.425</i>	
# PSD-187	4.762	222	Delrin	4.788 to 4.839	2010	12.70	14.22	0.76	9.65	Refer Tech Data Sheet
	<i>0.187</i>					<i>0.500</i>	<i>0.560</i>	<i>0.030</i>	<i>0.380</i>	
# PSD-187-AF	4.762	222	Delrin AF	4.788 to 4.839	2010	12.70	14.22	0.76	9.65	Refer Tech Data Sheet
	<i>0.187</i>					<i>0.500</i>	<i>0.560</i>	<i>0.030</i>	<i>0.380</i>	

Indicates item not stocked at time of printing - Please enquire for lead time

E&OE Pricing and all details subject to change without notice - Copyright Miniature Bearings Australia Pty Ltd

MBA Size Listings are a guide to sizes only and must not be solely relied on for critical design information.

Bearings - Spyraflo - Press-Fit - Self Aligning

Part Number	Nominal Shaft Size mm	Max. Radial Dynamic Load N	Material	Min to Max Shaft Dia. mm	Max Speed RPM	Mounting Hole (A) +0.07/-0.00 mm	Flange Diameter (B) mm	Flange Height (C) mm	Bearing Length (D) mm	More Information
# PSB-187	4.762	623	Sintered Bronze SAE840	4.783 to 4.796	20310	12.70	14.22	0.76	9.65	Refer Tech Data Sheet
	<i>0.187</i>					<i>0.500</i>	<i>0.560</i>	<i>0.030</i>	<i>0.380</i>	
# PSN-187	4.762	2802	Needle Roller	4.755 to 4.763	21000	15.88	17.53	0.76	10.92	Refer Tech Data Sheet
	<i>0.187</i>					<i>0.625</i>	<i>0.690</i>	<i>0.030</i>	<i>0.430</i>	
# PSD-6M-AF	6.000	270	Delrin AF	6.020 to 6.040	1620	12.70	14.20	0.75	9.60	Refer Tech Data Sheet
	<i>0.236</i>					<i>0.500</i>	<i>0.559</i>	<i>0.030</i>	<i>0.378</i>	
# PSD-6M	6.000	270	Delrin	6.020 to 6.040	1620	12.70	14.20	0.75	9.60	Refer Tech Data Sheet
	<i>0.236</i>					<i>0.500</i>	<i>0.559</i>	<i>0.030</i>	<i>0.378</i>	
# PSB-6M	6.000	790	Sintered Bronze SAE840	6.020 to 6.040	16110	12.70	14.20	0.75	9.60	Refer Tech Data Sheet
	<i>0.236</i>					<i>0.500</i>	<i>0.559</i>	<i>0.030</i>	<i>0.378</i>	
# PSN-6M	6.000	2030	Needle Roller	5.992 to 6.000	35000	15.90	17.40	0.75	10.80	Refer Tech Data Sheet
	<i>0.236</i>					<i>0.626</i>	<i>0.685</i>	<i>0.030</i>	<i>0.425</i>	
# PSD-250	6.350	311	Delrin	6.375 to 6.426	1520	12.70	14.22	0.76	9.65	Refer Tech Data Sheet
	<i>0.250</i>					<i>0.500</i>	<i>0.560</i>	<i>0.030</i>	<i>0.380</i>	
# PSD-250-AF	6.350	311	Delrin AF	6.375 to 6.426	1520	12.70	14.22	0.76	9.65	Refer Tech Data Sheet
	<i>0.250</i>					<i>0.500</i>	<i>0.560</i>	<i>0.030</i>	<i>0.380</i>	

Indicates item not stocked at time of printing - Please enquire for lead time

E&OE Pricing and all details subject to change without notice - Copyright Miniature Bearings Australia Pty Ltd

MBA Size Listings are a guide to sizes only and must not be solely relied on for critical design information.

Bearings - Spyraflo - Press-Fit - Self Aligning

Part Number	Nominal Shaft Size mm	Max. Radial Dynamic Load N	Material	Min to Max Shaft Dia. mm	Max Speed RPM	Mounting Hole (A) +0.07/-0.00 mm	Flange Diameter (B) mm	Flange Height (C) mm	Bearing Length (D) mm	More Information
# PSB-250	6.350	845	Sintered Bronze SAE840	6.370 to 6.383	15270	12.70	14.22	0.76	9.65	Refer Tech Data Sheet
	<i>0.250</i>					<i>0.500</i>	<i>0.560</i>	<i>0.030</i>	<i>0.380</i>	
# PSNS-250	6.350	2535	Needle Roller Sealed	6.337 to 6.350	44000	15.88	17.53	0.76	10.92	Refer Tech Data Sheet
	<i>0.250</i>					<i>0.625</i>	<i>0.690</i>	<i>0.030</i>	<i>0.430</i>	
# PSN-250	6.350	2535	Needle Roller	6.337 to 6.350	44000	15.88	17.53	0.76	10.92	Refer Tech Data Sheet
	<i>0.250</i>					<i>0.625</i>	<i>0.690</i>	<i>0.030</i>	<i>0.430</i>	
# PSD-312-AF	7.938	534	Delrin AF	7.963 to 8.014	1220	15.88	17.53	0.76	11.25	Refer Tech Data Sheet
	<i>0.313</i>					<i>0.625</i>	<i>0.690</i>	<i>0.030</i>	<i>0.443</i>	
# PSD-312	7.938	534	Delrin	7.963 to 8.014	1220	15.88	17.53	0.76	11.25	Refer Tech Data Sheet
	<i>0.313</i>					<i>0.625</i>	<i>0.690</i>	<i>0.030</i>	<i>0.443</i>	
# PSB-312	7.938	1201	Sintered Bronze SAE840	7.958 to 7.976	12240	15.88	17.53	0.76	10.92	Refer Tech Data Sheet
	<i>0.313</i>					<i>0.625</i>	<i>0.690</i>	<i>0.030</i>	<i>0.430</i>	
# PSN-312	7.938	2891	Needle Roller	7.925 to 7.938	35500	20.62	22.35	0.76	15.24	Refer Tech Data Sheet
	<i>0.313</i>					<i>0.812</i>	<i>0.880</i>	<i>0.030</i>	<i>0.600</i>	
# PSNS-312	7.938	2891	Needle Roller Sealed	7.925 to 7.938	35500	20.62	22.35	0.76	15.24	Refer Tech Data Sheet
	<i>0.313</i>					<i>0.812</i>	<i>0.880</i>	<i>0.030</i>	<i>0.600</i>	

Indicates item not stocked at time of printing - Please enquire for lead time

E&OE Pricing and all details subject to change without notice - Copyright Miniature Bearings Australia Pty Ltd

MBA Size Listings are a guide to sizes only and must not be solely relied on for critical design information.

Bearings - Spyraflo - Press-Fit - Self Aligning

Part Number	Nominal Shaft Size mm	Max. Radial Dynamic Load N	Material	Min to Max Shaft Dia. mm	Max Speed RPM	Mounting Hole (A) +0.07/-0.00 mm	Flange Diameter (B) mm	Flange Height (C) mm	Bearing Length (D) mm	More Information
# PSD-8M-AF	8.000 <i>0.315</i>	530	Delrin AF	8.030 to 8.080	1210	15.90 <i>0.626</i>	17.40 <i>0.685</i>	0.75 <i>0.030</i>	10.80 <i>0.425</i>	Refer Tech Data Sheet
PSD-8M	8.000 <i>0.315</i>	530	Delrin	8.030 to 8.080	1210	15.90 <i>0.626</i>	17.40 <i>0.685</i>	0.75 <i>0.030</i>	10.80 <i>0.425</i>	Refer Tech Data Sheet
# PSB-8M	8.000 <i>0.315</i>	1190	Sintered Bronze SAE840	8.020 to 8.040	12120	15.90 <i>0.626</i>	17.40 <i>0.685</i>	0.75 <i>0.030</i>	10.80 <i>0.425</i>	Refer Tech Data Sheet
# PSN-8M	8.000 <i>0.315</i>	2750	Needle Roller	7.991 to 8.000	28000	20.60 <i>0.811</i>	22.20 <i>0.874</i>	0.75 <i>0.030</i>	15.20 <i>0.598</i>	Refer Tech Data Sheet
# PSD-375	9.525 <i>0.375</i>	845	Delrin	9.550 to 9.601	1010	15.88 <i>0.625</i>	17.53 <i>0.690</i>	0.76 <i>0.030</i>	10.92 <i>0.430</i>	Refer Tech Data Sheet
# PSD-375-AF	9.525 <i>0.375</i>	845	Delrin AF	9.550 to 9.601	1010	15.88 <i>0.625</i>	17.53 <i>0.690</i>	0.76 <i>0.030</i>	10.92 <i>0.430</i>	Refer Tech Data Sheet
# PSB-375	9.525 <i>0.375</i>	1423	Sintered Bronze SAE840	9.545 to 9.563	10180	15.88 <i>0.625</i>	17.53 <i>0.690</i>	0.76 <i>0.030</i>	10.92 <i>0.430</i>	Refer Tech Data Sheet
# PSNS-375	9.525 <i>0.375</i>	2535	Needle Roller Sealed	6.337 to 6.350	44000	15.88 <i>0.625</i>	17.53 <i>0.690</i>	0.76 <i>0.030</i>	10.92 <i>0.430</i>	Refer Tech Data Sheet

Indicates item not stocked at time of printing - Please enquire for lead time

E&OE Pricing and all details subject to change without notice - Copyright Miniature Bearings Australia Pty Ltd

MBA Size Listings are a guide to sizes only and must not be solely relied on for critical design information.

Bearings - Spyraflo - Press-Fit - Self Aligning

Part Number	Nominal Shaft Size mm	Max. Radial Dynamic Load N	Material	Min to Max Shaft Dia. mm	Max Speed RPM	Mounting Hole (A) +0.07/-0.00 mm	Flange Diameter (B) mm	Flange Height (C) mm	Bearing Length (D) mm	More Information
# PSN-375	9.525 <i>0.375</i>	2535	Needle Roller	6.337 to 6.350	44000	15.88 <i>0.625</i>	17.53 <i>0.690</i>	0.76 <i>0.030</i>	10.92 <i>0.430</i>	Refer Tech Data Sheet
# PSD-10M-AF	10.000 <i>0.394</i>	860	Delrin AF	10.030 to 10.080	970	15.90 <i>0.626</i>	17.40 <i>0.685</i>	0.75 <i>0.030</i>	10.80 <i>0.425</i>	Refer Tech Data Sheet
# PSD-10M	10.000 <i>0.394</i>	860	Delrin	10.030 to 10.080	970	15.90 <i>0.626</i>	17.40 <i>0.685</i>	0.75 <i>0.030</i>	10.80 <i>0.425</i>	Refer Tech Data Sheet
# PSB-10M	10.000 <i>0.394</i>	1490	Sintered Bronze SAE840	10.020 to 10.040	9700	15.90 <i>0.626</i>	17.40 <i>0.685</i>	0.75 <i>0.030</i>	10.80 <i>0.425</i>	Refer Tech Data Sheet
# PSN-10M	10.000 <i>0.394</i>	4400	Needle Roller	9.991 to 10.000	23000	20.60 <i>0.811</i>	22.20 <i>0.874</i>	0.75 <i>0.030</i>	15.20 <i>0.598</i>	Refer Tech Data Sheet
# PSD-12M-AF	12.000 <i>0.472</i>	1330	Delrin AF	12.030 to 12.080	810	20.60 <i>0.811</i>	22.20 <i>0.874</i>	0.75 <i>0.030</i>	14.90 <i>0.587</i>	Refer Tech Data Sheet
# PSB-12M	12.000 <i>0.472</i>	2430	Sintered Bronze SAE840	12.030 to 12.050	8060	20.60 <i>0.811</i>	22.20 <i>0.874</i>	0.75 <i>0.030</i>	15.20 <i>0.598</i>	Refer Tech Data Sheet
# PSNS-12M	12.000 <i>0.472</i>	2535	Needle Roller Sealed	6.337 to 6.350	44000	15.88 <i>0.625</i>	17.53 <i>0.690</i>	0.76 <i>0.030</i>	10.92 <i>0.430</i>	Refer Tech Data Sheet

Indicates item not stocked at time of printing - Please enquire for lead time

E&OE Pricing and all details subject to change without notice - Copyright Miniature Bearings Australia Pty Ltd

MBA Size Listings are a guide to sizes only and must not be solely relied on for critical design information.

Bearings - Spyraflo - Press-Fit - Self Aligning

Part Number	Nominal Shaft Size mm	Max. Radial Dynamic Load N	Material	Min to Max Shaft Dia. mm	Max Speed RPM	Mounting Hole (A) +0.07/-0.00 mm	Flange Diameter (B) mm	Flange Height (C) mm	Bearing Length (D) mm	More Information
# PSN-12M	12.000 <i>0.472</i>	2535	Needle Roller	6.337 to 6.350	44000	15.88 <i>0.625</i>	17.53 <i>0.690</i>	0.76 <i>0.030</i>	10.92 <i>0.430</i>	Refer Tech Data Sheet
# PSD-500	12.700 <i>0.500</i>	1423	Delrin	12.725 to 12.802	760	20.62 <i>0.812</i>	22.35 <i>0.880</i>	0.76 <i>0.030</i>	15.24 <i>0.600</i>	Refer Tech Data Sheet
# PSD-500-AF	12.700 <i>0.500</i>	1423	Delrin AF	12.725 to 12.802	760	20.62 <i>0.812</i>	22.35 <i>0.880</i>	0.76 <i>0.030</i>	15.24 <i>0.600</i>	Refer Tech Data Sheet
# PSB-500	12.700 <i>0.500</i>	2669	Sintered Bronze SAE840	12.725 to 12.743	7640	20.62 <i>0.812</i>	22.35 <i>0.880</i>	0.76 <i>0.030</i>	15.24 <i>0.600</i>	Refer Tech Data Sheet
# PSNS-500	12.700 <i>0.500</i>	4626	Needle Roller Sealed	12.687 to 12.700	22000	27.00 <i>1.063</i>	28.70 <i>1.130</i>	0.76 <i>0.030</i>	19.56 <i>0.770</i>	Refer Tech Data Sheet
# PSN-500	12.700 <i>0.500</i>	4626	Needle Roller	12.687 to 12.700	22000	27.00 <i>1.063</i>	28.70 <i>1.130</i>	0.76 <i>0.030</i>	19.56 <i>0.770</i>	Refer Tech Data Sheet
# PSD-15M	15.000 <i>0.591</i>	1870	Delrin	15.030 to 15.050	650	27.00 <i>1.063</i>	28.50 <i>1.122</i>	0.75 <i>0.030</i>	19.60 <i>0.772</i>	Refer Tech Data Sheet
# PSD-15M-AF	15.000 <i>0.591</i>	1870	Delrin AF	15.030 to 15.050	650	27.00 <i>1.063</i>	28.50 <i>1.122</i>	0.75 <i>0.030</i>	19.60 <i>0.772</i>	Refer Tech Data Sheet

Indicates item not stocked at time of printing - Please enquire for lead time

E&OE Pricing and all details subject to change without notice - Copyright Miniature Bearings Australia Pty Ltd

MBA Size Listings are a guide to sizes only and must not be solely relied on for critical design information.

Bearings - Spyraflo - Press-Fit - Self Aligning

Part Number	Nominal Shaft Size mm	Max. Radial Dynamic Load N	Material	Min to Max Shaft Dia. mm	Max Speed RPM	Mounting Hole (A) +0.07/-0.00 mm	Flange Diameter (B) mm	Flange Height (C) mm	Bearing Length (D) mm	More Information
# PSB-15M	15.000	3750	Sintered Bronze SAE840	15.030 to 15.050	6460	27.00	28.50	0.75	19.60	Refer Tech Data Sheet
	<i>0.591</i>					<i>1.063</i>	<i>1.122</i>	<i>0.030</i>	<i>0.772</i>	
# PSN-15M	15.000	7900	Needle Roller	14.989 to 15.000	16000	31.80	33.30	0.75	21.60	Refer Tech Data Sheet
	<i>0.591</i>					<i>1.252</i>	<i>1.311</i>	<i>0.030</i>	<i>0.850</i>	
# PSD-625	15.875	2002	Delrin	15.800 to 15.951	610	27.00	28.45	0.76	19.56	Refer Tech Data Sheet
	<i>0.625</i>					<i>1.063</i>	<i>1.120</i>	<i>0.030</i>	<i>0.770</i>	
# PSD-625-AF	15.875	2002	Delrin AF	15.800 to 15.951	610	27.00	28.45	0.76	19.56	Refer Tech Data Sheet
	<i>0.625</i>					<i>1.063</i>	<i>1.120</i>	<i>0.030</i>	<i>0.770</i>	
# PSB-625	15.875	3959	Sintered Bronze SAE840	15.900 to 15.926	6110	27.00	28.70	0.76	19.56	Refer Tech Data Sheet
	<i>0.625</i>					<i>1.063</i>	<i>1.130</i>	<i>0.030</i>	<i>0.770</i>	
# PSN-625	15.875	8140	Needle Roller	15.862 to 15.875	17600	31.75	33.27	0.76	21.59	Refer Tech Data Sheet
	<i>0.625</i>					<i>1.250</i>	<i>1.310</i>	<i>0.030</i>	<i>0.850</i>	
# PSD-16M	16.000	1870	Delrin	16.030 to 16.080	650	27.00	28.50	0.75	19.60	Refer Tech Data Sheet
	<i>0.630</i>					<i>1.063</i>	<i>1.122</i>	<i>0.030</i>	<i>0.772</i>	
# PSB-750	19.050	8896	Sintered Bronze SAE840	19.075 to 19.101	1150	31.75	33.27	0.76	21.59	Refer Tech Data Sheet
	<i>0.750</i>					<i>1.250</i>	<i>1.310</i>	<i>0.030</i>	<i>0.850</i>	

Indicates item not stocked at time of printing - Please enquire for lead time

E&OE Pricing and all details subject to change without notice - Copyright Miniature Bearings Australia Pty Ltd

MBA Size Listings are a guide to sizes only and must not be solely relied on for critical design information.

Bearings - Spyraflo - Press-Fit - Self Aligning

Part Number	Nominal Shaft Size mm	Max. Radial Dynamic Load N	Material	Min to Max Shaft Dia. mm	Max Speed RPM	Mounting Hole (A) +0.07/-0.00 mm	Flange Diameter (B) mm	Flange Height (C) mm	Bearing Length (D) mm	More Information
# PSD-750	19.050	-	Delrin	-	-	-	-	-	-	Refer Tech Data Sheet
	0.750									

Indicates item not stocked at time of printing - Please enquire for lead time

E&OE Pricing and all details subject to change without notice - Copyright Miniature Bearings Australia Pty Ltd

MBA Size Listings are a guide to sizes only and must not be solely relied on for critical design information.



DISTRIBUTED BY

Ask us to put your name and address here

<http://www.minibearings.com.au/product>

Ph +61 7 3245 7977

Fax +61 7 3245 1017

Catalogue requests to catalogues@minibearings.com.au

