

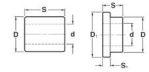

MBA

Bushes - Bronze - Hobby



A small selection of popular sizes. Solid precision LG2 bronze bushes.

See main listings for sizes not shown here.

ID Tolerance : -0.0127 / +0.040 --- OD Tolerance : +0.060 / +0.102.

LENGTH Tolerance : -0.254 / +0.254.

Composition (Approx.) : Copper 85%, Tin 5%, Zinc 5%, Lead 5%.

Hardness : 70-90 BHN.

Bushes - Bronze - Hobby

Part Number	ID (d) mm	OD (D) mm	Length (S) mm	Flange OD (D1) mm	Flange Thickness (S1) mm
	<i>inches</i>	<i>inches</i>	<i>inches</i>	<i>inches</i>	<i>inches</i>
BP00800-01000-0100-LG2	8.000 <i>0.315</i>	10.000 <i>0.394</i>	10.00 <i>0.394</i>		
BP00900-01200-0040-LG2	9.000 <i>0.354</i>	12.000 <i>0.472</i>	4.00 <i>0.157</i>		
BP00953-01270-0191-LG2	9.525 <i>0.375</i>	12.700 <i>0.500</i>	19.05 <i>0.750</i>		

Indicates item not stocked at time of printing - Please enquire for lead time

E&OE Pricing and all details subject to change without notice - Copyright Miniature Bearings Australia Pty Ltd

MBA Size Listings are a guide to sizes only and must not be solely relied on for critical design information.

Bushes - Bronze - Hobby

Part Number	ID (d) mm	OD (D) mm	Length (S) mm	Flange OD (D1) mm	Flange Thickness (S1) mm
	<i>inches</i>	<i>inches</i>	<i>inches</i>	<i>inches</i>	<i>inches</i>
BP01000-01200-0200-LG2	10.000 <i>0.394</i>	12.000 <i>0.472</i>	20.00 <i>0.787</i>		
BP01200-01600-0200-LG2	12.000 <i>0.472</i>	16.000 <i>0.630</i>	20.00 <i>0.787</i>		
BP01200-02000-0200-LG2	12.000 <i>0.472</i>	20.000 <i>0.787</i>	20.00 <i>0.787</i>		
BP01200-02000-0300-LG2	12.000 <i>0.472</i>	20.000 <i>0.787</i>	30.00 <i>1.181</i>		
BP01270-01588-0191-LG2	12.700 <i>0.500</i>	15.875 <i>0.625</i>	19.05 <i>0.750</i>		
BP01588-02540-0508-LG2	15.875 <i>0.625</i>	25.400 <i>1.000</i>	50.80 <i>2.000</i>		
BP01600-02000-0200-LG2	16.000 <i>0.630</i>	20.000 <i>0.787</i>	20.00 <i>0.787</i>		
BP01905-02223-0191-LG2	19.050 <i>0.750</i>	22.225 <i>0.875</i>	19.05 <i>0.750</i>		
BP01905-02540-0508-LG2	19.050 <i>0.750</i>	25.400 <i>1.000</i>	50.80 <i>2.000</i>		
BP01905-02540-0254-LG2	19.050 <i>0.750</i>	25.400 <i>1.000</i>	25.40 <i>1.000</i>		

Indicates item not stocked at time of printing - Please enquire for lead time

E&OE Pricing and all details subject to change without notice - Copyright Miniature Bearings Australia Pty Ltd

MBA Size Listings are a guide to sizes only and must not be solely relied on for critical design information.

Bushes - Bronze - Hobby

Part Number	ID (d) mm	OD (D) mm	Length (S) mm	Flange OD (D1) mm	Flange Thickness (S1) mm
	<i>inches</i>	<i>inches</i>	<i>inches</i>	<i>inches</i>	<i>inches</i>
BP02000-02400-0300-LG2	20.000	24.000	30.00		
	<i>0.787</i>	<i>0.945</i>	<i>1.181</i>		

Indicates item not stocked at time of printing - Please enquire for lead time

E&OE Pricing and all details subject to change without notice - Copyright Miniature Bearings Australia Pty Ltd

MBA Size Listings are a guide to sizes only and must not be solely relied on for critical design information.



DISTRIBUTED BY

Ask us to put your name and address here

<http://www.minibearings.com.au/product>

Ph +61 7 3245 7977

Fax +61 7 3245 1017

Catalogue requests to catalogues@minibearings.com.au

