

# MBA

## Bushes - Plastic - Iglidur A290 - Unflanged



Food grade for low speeds and direct contact with food and pharmaceuticals.

Specific Gravity 1.39 g/cm<sup>3</sup>.

Operating Temp 180 C short term / 140 C long term.

Tensile Strength at 20 deg C = 250 Mpa.

Hardness 88 Shore D (DIN53505).

Tolerances listed are after H7 Pressfit.

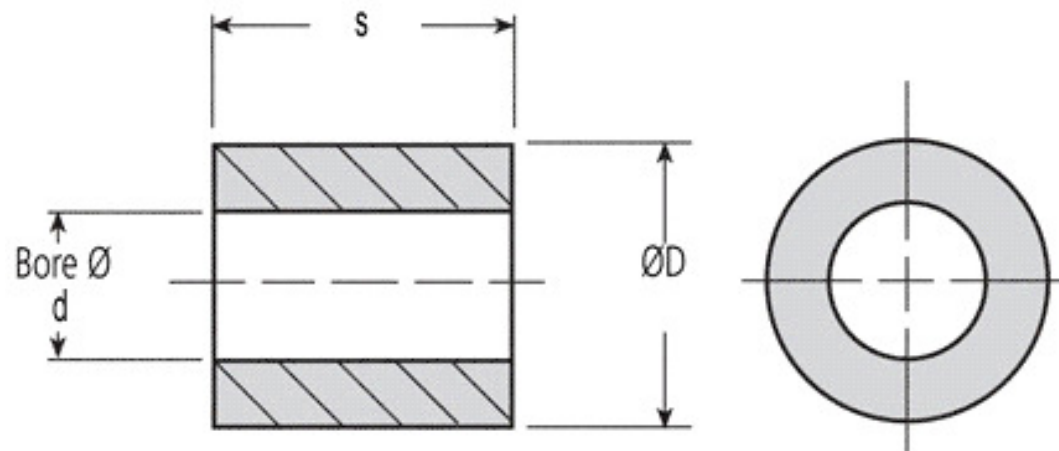

### Bushes - Plastic - Iglidur A290 - Unflanged

Part Number	Nom. ID (d) mm <i>inches</i>	Nom. OD (D) mm <i>inches</i>	Length (s) mm <i>inches</i>	Tolerance of ID after Pressfit
# BP00300-00450-0030-A29	3.000 <i>0.118</i>	4.500 <i>0.177</i>	3.000 <i>0.118</i>	+0.020/+0.080
# BP00400-00550-0040-A29	4.000 <i>0.157</i>	5.500 <i>0.217</i>	4.000 <i>0.157</i>	+0.030/+0.105
# BP00500-00700-0050-A29	5.000 <i>0.197</i>	7.000 <i>0.276</i>	5.000 <i>0.197</i>	+0.030/+0.105

# Indicates item not stocked at time of printing - Please enquire for lead time  
 E&OE Pricing and all details subject to change without notice - Copyright Miniature Bearings Australia Pty Ltd  
 MBA Size Listings are a guide to sizes only and must not be solely relied on for critical design information.

## Bushes - Plastic - Iglidur A290 - Unflanged

Part Number	Nom. ID (d) mm <i>inches</i>	Nom. OD (D) mm <i>inches</i>	Length (s) mm <i>inches</i>	Tolerance of ID after Pressfit
# BP00600-00800-0060-A29	6.000 <i>0.236</i>	8.000 <i>0.315</i>	6.000 <i>0.236</i>	+0.030/+0.105
# BP00800-01000-0080-A29	8.000 <i>0.315</i>	10.000 <i>0.394</i>	8.000 <i>0.315</i>	+0.040/+0.130
# BP01000-01200-0100-A29	10.000 <i>0.394</i>	12.000 <i>0.472</i>	10.000 <i>0.394</i>	+0.040/+0.130
# BP01200-01400-0150-A29	12.000 <i>0.472</i>	14.000 <i>0.551</i>	15.000 <i>0.591</i>	+0.050/+0.160
# BP01500-01700-0150-A29	15.000 <i>0.591</i>	17.000 <i>0.669</i>	15.000 <i>0.591</i>	+0.050/+0.160
# BP01600-01800-0150-A29	16.000 <i>0.630</i>	18.000 <i>0.709</i>	15.000 <i>0.591</i>	+0.050/+0.160
# BP01800-02000-0150-A29	18.000 <i>0.709</i>	20.000 <i>0.787</i>	15.000 <i>0.591</i>	+0.050/+0.160
# BP02000-02300-0200-A29	20.000 <i>0.787</i>	23.000 <i>0.906</i>	20.000 <i>0.787</i>	+0.065/+0.195
# BP02500-02800-0200-A29	25.000 <i>0.984</i>	28.000 <i>1.102</i>	20.000 <i>0.787</i>	+0.065/+0.195
# BP03000-03400-0300-A29	30.000 <i>1.181</i>	34.000 <i>1.339</i>	30.000 <i>1.181</i>	+0.065/+0.195

# Indicates item not stocked at time of printing - Please enquire for lead time

E&OE Pricing and all details subject to change without notice - Copyright Miniature Bearings Australia Pty Ltd

MBA Size Listings are a guide to sizes only and must not be solely relied on for critical design information.

## Bushes - Plastic - Iglidur A290 - Unflanged

Part Number	Nom. ID (d) mm <i>inches</i>	Nom. OD (D) mm <i>inches</i>	Length (s) mm <i>inches</i>	Tolerance of ID after Pressfit
# BP03500-03900-0400-A29	35.000 <i>1.378</i>	39.000 <i>1.535</i>	40.000 <i>1.575</i>	+0.080/+0.240
# BP04000-04400-0500-A29	40.000 <i>1.575</i>	44.000 <i>1.732</i>	50.000 <i>1.969</i>	+0.080/+0.240
# BP05000-05500-0400-A29	50.000 <i>1.969</i>	55.000 <i>2.165</i>	40.000 <i>1.575</i>	+0.080/+0.240

# Indicates item not stocked at time of printing - Please enquire for lead time

E&OE Pricing and all details subject to change without notice - Copyright Miniature Bearings Australia Pty Ltd

MBA Size Listings are a guide to sizes only and must not be solely relied on for critical design information.

# MBA

# MINIATURE BEARINGS AUSTRALIA PTY LTD

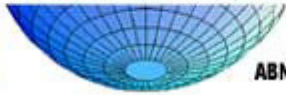

ABN 94 069 113 800



DISTRIBUTED BY

Ask us to put your name and address here

<http://www.minibearings.com.au/product>

Ph +61 7 3245 7977

Fax +61 7 3245 1017

Catalogue requests to [catalogues@minibearings.com.au](mailto:catalogues@minibearings.com.au)

**SDPSI**  
Stock Drive Products / Spring Instrument

**JK**

ANOTHER QUALITY PRODUCT BY  
**MOLYTEC**  
Australia

**Origin**  
BEARING

**WIB**

**THOMSON**

**EZO**



 **myonic**  
solutions in microspace

**rino**



**inox**  
Quality Products

**GRW**

**DualVee<sup>x</sup>**  
Bishop-Wisecarver Corp.

**ondrives**  
Precision Manufacturing

**RMB**

**SOLARBOTICS<sup>INTL</sup>**

**KSK**  
BALL BEARING