



MBA

Bushes - Plastic - Iglidur F - Unflanged

Electrically conductive. High Compressive Strength. High Temp. Resistant to Chemicals.

Specific Gravity 1.25 g/cm³.

Operating Temp 180 C short term / 140 C long term.

Tensile Strength at 20 deg C = 260 Mpa.

Hardness 84 Shore D (DIN53505).

Tolerances listed are after H7 Pressfit.

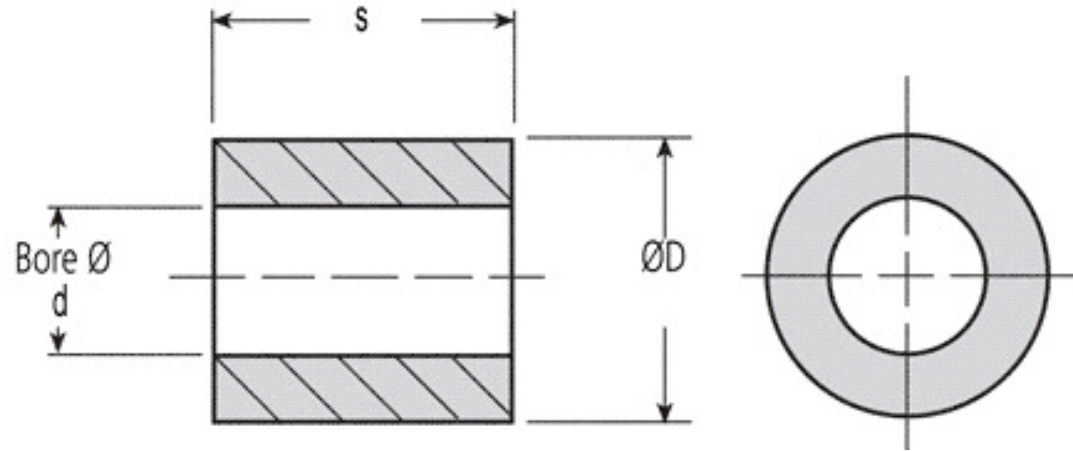

Bushes - Plastic - Iglidur F - Unflanged

Part Number	Nom. ID (d) mm <i>inches</i>	Nom. OD (D) mm <i>inches</i>	Length (s) mm <i>inches</i>	Tolerance of ID after Pressfit
# BP00200-00350-0030-F	2.000 <i>0.079</i>	3.500 <i>0.138</i>	3.000 <i>0.118</i>	+0.020/+0.080
# BP00300-00450-0030-F	3.000 <i>0.118</i>	4.500 <i>0.177</i>	3.000 <i>0.118</i>	+0.020/+0.080
# BP00400-00550-0040-F	4.000 <i>0.157</i>	5.500 <i>0.217</i>	4.000 <i>0.157</i>	+0.030/+0.105

Indicates item not stocked at time of printing - Please enquire for lead time
 E&OE Pricing and all details subject to change without notice - Copyright Miniature Bearings Australia Pty Ltd
 MBA Size Listings are a guide to sizes only and must not be solely relied on for critical design information.

Bushes - Plastic - Iglidur F - Unflanged

Part Number	Nom. ID (d) mm <i>inches</i>	Nom. OD (D) mm <i>inches</i>	Length (s) mm <i>inches</i>	Tolerance of ID after Pressfit
# BP00500-00700-0050-F	5.000 <i>0.197</i>	7.000 <i>0.276</i>	5.000 <i>0.197</i>	+0.030/+0.105
# BP00500-00700-0080-F	5.000 <i>0.197</i>	7.000 <i>0.276</i>	8.000 <i>0.315</i>	+0.030/+0.105
# BP00600-00800-0060-F	6.000 <i>0.236</i>	8.000 <i>0.315</i>	6.000 <i>0.236</i>	+0.030/+0.105
# BP00600-00800-0080-F	6.000 <i>0.236</i>	8.000 <i>0.315</i>	8.000 <i>0.315</i>	+0.030/+0.105
# BP00600-00800-0100-F	6.000 <i>0.236</i>	8.000 <i>0.315</i>	10.000 <i>0.394</i>	+0.030/+0.105
# BP00600-00800-0138-F	6.000 <i>0.236</i>	8.000 <i>0.315</i>	13.800 <i>0.543</i>	+0.030/+0.105
# BP00700-00900-0100-F	7.000 <i>0.276</i>	9.000 <i>0.354</i>	10.000 <i>0.394</i>	+0.040/+0.130
# BP00700-00900-0120-F	7.000 <i>0.276</i>	9.000 <i>0.354</i>	12.000 <i>0.472</i>	+0.040/+0.130
# BP00800-01000-0100-F	8.000 <i>0.315</i>	10.000 <i>0.394</i>	10.000 <i>0.394</i>	+0.040/+0.130
# BP00800-01000-0150-F	8.000 <i>0.315</i>	10.000 <i>0.394</i>	15.000 <i>0.591</i>	+0.040/+0.130

Indicates item not stocked at time of printing - Please enquire for lead time

E&OE Pricing and all details subject to change without notice - Copyright Miniature Bearings Australia Pty Ltd

MBA Size Listings are a guide to sizes only and must not be solely relied on for critical design information.

Bushes - Plastic - Iglidur F - Unflanged

Part Number	Nom. ID (d) mm <i>inches</i>	Nom. OD (D) mm <i>inches</i>	Length (s) mm <i>inches</i>	Tolerance of ID after Pressfit
# BP01000-01200-0060-F	10.000 <i>0.394</i>	12.000 <i>0.472</i>	6.000 <i>0.236</i>	+0.040/+0.130
# BP01000-01200-0100-F	10.000 <i>0.394</i>	12.000 <i>0.472</i>	10.000 <i>0.394</i>	+0.040/+0.130
# BP01200-01400-0100-F	12.000 <i>0.472</i>	14.000 <i>0.551</i>	10.000 <i>0.394</i>	+0.050/+0.160
# BP01200-01400-0150-F	12.000 <i>0.472</i>	14.000 <i>0.551</i>	15.000 <i>0.591</i>	+0.050/+0.160
# BP01400-01600-0150-F	14.000 <i>0.551</i>	16.000 <i>0.630</i>	15.000 <i>0.591</i>	+0.050/+0.160
# BP01500-01700-0150-F	15.000 <i>0.591</i>	17.000 <i>0.669</i>	15.000 <i>0.591</i>	+0.050/+0.160
# BP01500-01700-0200-F	15.000 <i>0.591</i>	17.000 <i>0.669</i>	20.000 <i>0.787</i>	+0.050/+0.160
# BP01600-01800-0150-F	16.000 <i>0.630</i>	18.000 <i>0.709</i>	15.000 <i>0.591</i>	+0.050/+0.160
# BP01800-02000-0150-F	18.000 <i>0.709</i>	20.000 <i>0.787</i>	15.000 <i>0.591</i>	+0.050/+0.160
# BP01800-02000-0200-F	18.000 <i>0.709</i>	20.000 <i>0.787</i>	20.000 <i>0.787</i>	+0.050/+0.160

Indicates item not stocked at time of printing - Please enquire for lead time

E&OE Pricing and all details subject to change without notice - Copyright Miniature Bearings Australia Pty Ltd

MBA Size Listings are a guide to sizes only and must not be solely relied on for critical design information.

Bushes - Plastic - Iglidur F - Unflanged

Part Number	Nom. ID (d) mm <i>inches</i>	Nom. OD (D) mm <i>inches</i>	Length (s) mm <i>inches</i>	Tolerance of ID after Pressfit
# BP02000-02200-0145-F	20.000 <i>0.787</i>	22.000 <i>0.866</i>	14.500 <i>0.571</i>	+0.065/+0.195
# BP02000-02200-0200-F	20.000 <i>0.787</i>	22.000 <i>0.866</i>	20.000 <i>0.787</i>	+0.065/+0.195
# BP02000-02300-0150-F	20.000 <i>0.787</i>	23.000 <i>0.906</i>	15.000 <i>0.591</i>	+0.065/+0.195
# BP02000-02300-0200-F	20.000 <i>0.787</i>	23.000 <i>0.906</i>	20.000 <i>0.787</i>	+0.065/+0.195
# BP02200-02500-0150-F	22.000 <i>0.866</i>	25.000 <i>0.984</i>	15.000 <i>0.591</i>	+0.065/+0.195
# BP02500-02800-0200-F	25.000 <i>0.984</i>	28.000 <i>1.102</i>	20.000 <i>0.787</i>	+0.065/+0.195
# BP02800-03200-0200-F	28.000 <i>1.102</i>	32.000 <i>1.260</i>	20.000 <i>0.787</i>	+0.065/+0.195
# BP02800-03200-0300-F	28.000 <i>1.102</i>	32.000 <i>1.260</i>	30.000 <i>1.181</i>	+0.065/+0.195
# BP03000-03400-0200-F	30.000 <i>1.181</i>	34.000 <i>1.339</i>	20.000 <i>0.787</i>	+0.065/+0.195
# BP03000-03400-0300-F	30.000 <i>1.181</i>	34.000 <i>1.339</i>	30.000 <i>1.181</i>	+0.065/+0.195

Indicates item not stocked at time of printing - Please enquire for lead time

E&OE Pricing and all details subject to change without notice - Copyright Miniature Bearings Australia Pty Ltd

MBA Size Listings are a guide to sizes only and must not be solely relied on for critical design information.

Bushes - Plastic - Iglidur F - Unflanged

Part Number	Nom. ID (d) mm <i>inches</i>	Nom. OD (D) mm <i>inches</i>	Length (s) mm <i>inches</i>	Tolerance of ID after Pressfit
# BP03000-03400-0400-F	30.000 <i>1.181</i>	34.000 <i>1.339</i>	40.000 <i>1.575</i>	+0.065/+0.195
# BP03200-03600-0300-F	32.000 <i>1.260</i>	36.000 <i>1.417</i>	30.000 <i>1.181</i>	+0.080/+0.240
# BP03500-03900-0300-F	35.000 <i>1.378</i>	39.000 <i>1.535</i>	30.000 <i>1.181</i>	+0.080/+0.240
# BP03500-03900-0400-F	35.000 <i>1.378</i>	39.000 <i>1.535</i>	40.000 <i>1.575</i>	+0.080/+0.240
# BP04000-04400-0300-F	40.000 <i>1.575</i>	44.000 <i>1.732</i>	30.000 <i>1.181</i>	+0.080/+0.240
# BP04000-04400-0500-F	40.000 <i>1.575</i>	44.000 <i>1.732</i>	50.000 <i>1.969</i>	+0.080/+0.240
# BP04500-05000-0500-F	45.000 <i>1.772</i>	50.000 <i>1.969</i>	50.000 <i>1.969</i>	+0.080/+0.240
# BP05000-05500-0400-F	50.000 <i>1.969</i>	55.000 <i>2.165</i>	40.000 <i>1.575</i>	+0.080/+0.240
# BP05500-06000-0500-F	55.000 <i>2.165</i>	60.000 <i>2.362</i>	50.000 <i>1.969</i>	+0.100/+0.290
# BP06000-06500-0600-F	60.000 <i>2.362</i>	65.000 <i>2.559</i>	60.000 <i>2.362</i>	+0.100/+0.290

Indicates item not stocked at time of printing - Please enquire for lead time

E&OE Pricing and all details subject to change without notice - Copyright Miniature Bearings Australia Pty Ltd

MBA Size Listings are a guide to sizes only and must not be solely relied on for critical design information.



DISTRIBUTED BY

Ask us to put your name and address here

<http://www.minibearings.com.au/product>

Ph +61 7 3245 7977

Fax +61 7 3245 1017

Catalogue requests to catalogues@minibearings.com.au

