

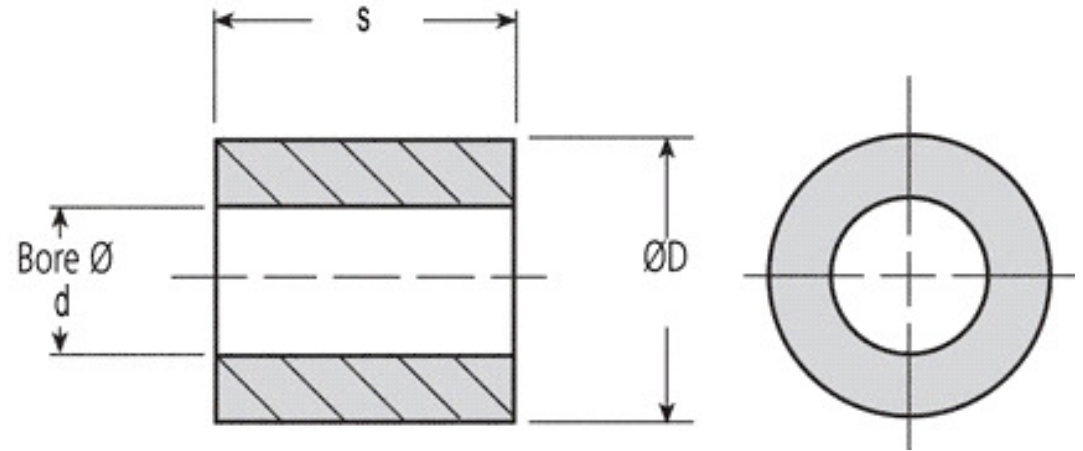

MBA

Bushes - Plastic - Iglidur G - Unflanged



General purpose maintenance free dry running.

Specific Gravity 1.45 g/cm³.

Operating Temp 220 C short term / 130 C long term.

Tensile Strength at 20 deg C 210 Mpa.

Hardness 81 Shore D (DIN53505).

Tolerances listed are after H7 Pressfit.

This catalogue to be read in conjunction with information at http://www.minibearings.com.au/ogue/tech/materials/iglidur_g300.pdf

Bushes - Plastic - Iglidur G - Unflanged

Part Number	Nom. ID (d) mm	Nom. OD (D) mm	Length (s) mm	Inner Diameter after Press Fit mm	Tolerance of ID after Pressfit mm	Housing Bore (Max. / Min.)
	<i>inches</i>	<i>inches</i>	<i>inches</i>	<i>inches</i>	<i>inches</i>	
BP00150-00300-0020-G	1.500 <i>0.059</i>	3.000 <i>0.118</i>	2.000 <i>0.079</i>	1.554 / 1.514	+0.014/+0.054	1.506 / 1.500
# BP00200-00350-0030-G	2.000 <i>0.079</i>	3.500 <i>0.138</i>	3.000 <i>0.118</i>	2.054 / 2.006	+ 0.014 / + 0.054	3.508 / 3.508
# BP00250-00450-0050-G	2.500 <i>0.098</i>	4.500 <i>0.177</i>	5.000 <i>0.197</i>		+0.014/+0.054	

Indicates item not stocked at time of printing - Please enquire for lead time

E&OE Pricing and all details subject to change without notice - Copyright Miniature Bearings Australia Pty Ltd

MBA Size Listings are a guide to sizes only and must not be solely relied on for critical design information.

Bushes - Plastic - Iglidur G - Unflanged

Part Number	Nom. ID (d) mm	Nom. OD (D) mm	Length (s) mm	Inner Diameter after Press Fit mm	Tolerance of ID after Pressfit mm	Housing Bore (Max. / Min.)
	<i>inches</i>	<i>inches</i>	<i>inches</i>	<i>inches</i>	<i>inches</i>	
# BP00300-00450-0030-G	3.000 <i>0.118</i>	4.500 <i>0.177</i>	3.000 <i>0.118</i>		+0.014/+0.054	
BP00300-00450-0050-G	3.000 <i>0.118</i>	4.500 <i>0.177</i>	5.000 <i>0.197</i>		+0.014/+0.054	
# BP00300-00450-0060-G	3.000 <i>0.118</i>	4.500 <i>0.177</i>	6.000 <i>0.236</i>	3.054 / 3.006	+ 0.014 / + 0.054	4.512 / 4.512
# BP00318-00476-0048-G	3.175 <i>0.125</i>	4.763 <i>0.188</i>	4.763 <i>0.188</i>			
# BP00318-00476-0064-G	3.175 <i>0.125</i>	4.763 <i>0.188</i>	6.350 <i>0.250</i>			
# BP00318-00476-0095-G	3.175 <i>0.125</i>	4.763 <i>0.188</i>	9.525 <i>0.375</i>			
BP00400-00550-0040-G	4.000 <i>0.157</i>	5.500 <i>0.217</i>	4.000 <i>0.157</i>	4.068 / 4.010	+ 0.020 / + 0.068	5.512 / 5.512
# BP00400-00550-0060-G	4.000 <i>0.157</i>	5.500 <i>0.217</i>	6.000 <i>0.236</i>		+0.020/+0.068	
# BP00400-00600-0080-G	4.000 <i>0.157</i>	6.000 <i>0.236</i>	8.000 <i>0.315</i>	4.068 / 4.020	+ 0.020 / +0.068	6.012 / 6.000
# BP00400-00700-0055-G	4.000 <i>0.157</i>	7.000 <i>0.276</i>	5.500 <i>0.217</i>		+0.020/+0.068	

Indicates item not stocked at time of printing - Please enquire for lead time

E&OE Pricing and all details subject to change without notice - Copyright Miniature Bearings Australia Pty Ltd

MBA Size Listings are a guide to sizes only and must not be solely relied on for critical design information.

Bushes - Plastic - Iglidur G - Unflanged

Part Number	Nom. ID (d) mm	Nom. OD (D) mm	Length (s) mm	Inner Diameter after Press Fit mm	Tolerance of ID after Pressfit mm	Housing Bore (Max. / Min.)
	<i>inches</i>	<i>inches</i>	<i>inches</i>	<i>inches</i>	<i>inches</i>	
# BP00476-00635-0064-G	4.763 <i>0.188</i>	6.350 <i>0.250</i>	6.350 <i>0.250</i>			
# BP00476-00635-0095-G	4.763 <i>0.188</i>	6.350 <i>0.250</i>	9.525 <i>0.375</i>			
# BP00476-00635-0127-G	4.763 <i>0.188</i>	6.350 <i>0.250</i>	12.700 <i>0.500</i>			
BP00500-00600-0050-G	5.000 <i>0.197</i>	6.000 <i>0.236</i>	5.000 <i>0.197</i>		+0.010/+0.040	
# BP00500-00600-0070-G	5.000 <i>0.197</i>	6.000 <i>0.236</i>	7.000 <i>0.276</i>		+0.010/+0.040	
# BP00500-00700-0050-G	5.000 <i>0.197</i>	7.000 <i>0.276</i>	5.000 <i>0.197</i>		+0.020/+0.068	
# BP00500-00700-0080-G	5.000 <i>0.197</i>	7.000 <i>0.276</i>	8.000 <i>0.315</i>	5.068 / 5.010	+ 0.020 / + 0.068	7.015 / 7.015
BP00500-00700-0100-G	5.000 <i>0.197</i>	7.000 <i>0.276</i>	10.000 <i>0.394</i>		+0.020/+0.068	
BP00600-00700-0060-G	6.000 <i>0.236</i>	7.000 <i>0.276</i>	6.000 <i>0.236</i>		+0.010/+0.040	
# BP00600-00700-0175-G	6.000 <i>0.236</i>	7.000 <i>0.276</i>	17.500 <i>0.689</i>		+0.010/+0.040	

Indicates item not stocked at time of printing - Please enquire for lead time

E&OE Pricing and all details subject to change without notice - Copyright Miniature Bearings Australia Pty Ltd

MBA Size Listings are a guide to sizes only and must not be solely relied on for critical design information.

Bushes - Plastic - Iglidur G - Unflanged

Part Number	Nom. ID (d) mm	Nom. OD (D) mm	Length (s) mm	Inner Diameter after Press Fit mm	Tolerance of ID after Pressfit mm	Housing Bore (Max. / Min.)
	<i>inches</i>	<i>inches</i>	<i>inches</i>	<i>inches</i>	<i>inches</i>	
# BP00600-00800-0040-G	6.000 <i>0.236</i>	8.000 <i>0.315</i>	4.000 <i>0.157</i>		+0.020/+0.068	
# BP00600-00800-0050-G	6.000 <i>0.236</i>	8.000 <i>0.315</i>	5.000 <i>0.197</i>		+0.020/+0.068	
# BP00600-00800-0055-G	6.000 <i>0.236</i>	8.000 <i>0.315</i>	5.500 <i>0.217</i>		+0.020/+0.068	
BP00600-00800-0060-G	6.000 <i>0.236</i>	8.000 <i>0.315</i>	6.000 <i>0.236</i>		+0.020/+0.068	
# BP00600-00800-0080-G	6.000 <i>0.236</i>	8.000 <i>0.315</i>	8.000 <i>0.315</i>	6.068 / 6.010	+ 0.020 / + 0.068	8.015 / 8.015
# BP00600-00800-0095-G	6.000 <i>0.236</i>	8.000 <i>0.315</i>	9.500 <i>0.374</i>		+0.020/+0.068	
BP00600-00800-0100-G	6.000 <i>0.236</i>	8.000 <i>0.315</i>	10.000 <i>0.394</i>		+0.020/+0.068	
# BP00600-00800-0118-G	6.000 <i>0.236</i>	8.000 <i>0.315</i>	11.800 <i>0.465</i>		+0.020/+0.068	
# BP00600-00800-0138-G	6.000 <i>0.236</i>	8.000 <i>0.315</i>	13.800 <i>0.543</i>		+0.020/+0.068	
# BP00635-00794-0064-G	6.350 <i>0.250</i>	7.938 <i>0.313</i>	6.350 <i>0.250</i>			

Indicates item not stocked at time of printing - Please enquire for lead time

E&OE Pricing and all details subject to change without notice - Copyright Miniature Bearings Australia Pty Ltd

MBA Size Listings are a guide to sizes only and must not be solely relied on for critical design information.

Bushes - Plastic - Iglidur G - Unflanged

Part Number	Nom. ID (d) mm	Nom. OD (D) mm	Length (s) mm	Inner Diameter after Press Fit mm	Tolerance of ID after Pressfit mm	Housing Bore (Max. / Min.)
	<i>inches</i>	<i>inches</i>	<i>inches</i>	<i>inches</i>	<i>inches</i>	
# BP00635-00794-0079-G	6.350 <i>0.250</i>	7.938 <i>0.313</i>	7.938 <i>0.313</i>			
# BP00635-00794-0095-G	6.350 <i>0.250</i>	7.938 <i>0.313</i>	9.525 <i>0.375</i>			
# BP00635-00794-0127-G	6.350 <i>0.250</i>	7.938 <i>0.313</i>	12.700 <i>0.500</i>			
# BP00635-00794-0159-G	6.350 <i>0.250</i>	7.938 <i>0.313</i>	15.875 <i>0.625</i>			
# BP00635-00794-0191-G	6.350 <i>0.250</i>	7.938 <i>0.313</i>	19.050 <i>0.750</i>			
# BP00700-00800-0100-G	7.000 <i>0.276</i>	8.000 <i>0.315</i>	10.000 <i>0.394</i>		+0.013/+0.049	
# BP00700-00800-0190-G	7.000 <i>0.276</i>	8.000 <i>0.315</i>	19.000 <i>0.748</i>		+0.013/+0.049	
# BP00700-00900-0090-G	7.000 <i>0.276</i>	9.000 <i>0.354</i>	9.000 <i>0.354</i>		+0.025/+0.083	
BP00700-00900-0100-G	7.000 <i>0.276</i>	9.000 <i>0.354</i>	10.000 <i>0.394</i>		+0.025/+0.083	
# BP00700-00900-0120-G	7.000 <i>0.276</i>	9.000 <i>0.354</i>	12.000 <i>0.472</i>		+0.025/+0.083	

Indicates item not stocked at time of printing - Please enquire for lead time

E&OE Pricing and all details subject to change without notice - Copyright Miniature Bearings Australia Pty Ltd

MBA Size Listings are a guide to sizes only and must not be solely relied on for critical design information.

Bushes - Plastic - Iglidur G - Unflanged

Part Number	Nom. ID (d) mm	Nom. OD (D) mm	Length (s) mm	Inner Diameter after Press Fit mm	Tolerance of ID after Pressfit mm	Housing Bore (Max. / Min.)
	<i>inches</i>	<i>inches</i>	<i>inches</i>	<i>inches</i>	<i>inches</i>	
# BP00794-00953-0064-G	7.938 <i>0.313</i>	9.525 <i>0.375</i>	6.350 <i>0.250</i>			
# BP00794-00953-0095-G	7.938 <i>0.313</i>	9.525 <i>0.375</i>	9.530 <i>0.375</i>			
# BP00794-00953-0127-G	7.938 <i>0.313</i>	9.525 <i>0.375</i>	12.700 <i>0.500</i>			
# BP00794-00953-0191-G	7.938 <i>0.313</i>	9.525 <i>0.375</i>	19.050 <i>0.750</i>			
# BP00800-00900-0080-G	8.000 <i>0.315</i>	9.000 <i>0.354</i>	8.000 <i>0.315</i>		+0.013/+0.049	
# BP00800-00900-0120-G	8.000 <i>0.315</i>	9.000 <i>0.354</i>	12.000 <i>0.472</i>		+0.013/+0.049	
# BP00800-01000-0060-G	8.000 <i>0.315</i>	10.000 <i>0.394</i>	6.000 <i>0.236</i>		+0.025/+0.083	
# BP00800-01000-0070-G	8.000 <i>0.315</i>	10.000 <i>0.394</i>	7.000 <i>0.276</i>		+0.025/+0.083	
# BP00800-01000-0080-G	8.000 <i>0.315</i>	10.000 <i>0.394</i>	8.000 <i>0.315</i>		+0.025/+0.083	
# BP00800-01000-0100-G	8.000 <i>0.315</i>	10.000 <i>0.394</i>	10.000 <i>0.394</i>		+0.025/+0.083	

Indicates item not stocked at time of printing - Please enquire for lead time

E&OE Pricing and all details subject to change without notice - Copyright Miniature Bearings Australia Pty Ltd

MBA Size Listings are a guide to sizes only and must not be solely relied on for critical design information.

Bushes - Plastic - Iglidur G - Unflanged

Part Number	Nom. ID (d) mm	Nom. OD (D) mm	Length (s) mm	Inner Diameter after Press Fit mm	Tolerance of ID after Pressfit mm	Housing Bore (Max. / Min.)
	<i>inches</i>	<i>inches</i>	<i>inches</i>	<i>inches</i>	<i>inches</i>	
# BP00800-01000-0120-G	8.000 <i>0.315</i>	10.000 <i>0.394</i>	12.000 <i>0.472</i>	8.083 / 8.013	+ 0.025 / + 0.083	10.015 / 10.015
# BP00800-01000-0130-G	8.000 <i>0.315</i>	10.000 <i>0.394</i>	13.000 <i>0.512</i>		+0.025/+0.083	
# BP00800-01000-0150-G	8.000 <i>0.315</i>	10.000 <i>0.394</i>	15.000 <i>0.591</i>		+0.025/+0.083	
# BP00800-01000-0160-G	8.000 <i>0.315</i>	10.000 <i>0.394</i>	16.000 <i>0.630</i>		+0.025/+0.083	
BP00800-01000-0200-G	8.000 <i>0.315</i>	10.000 <i>0.394</i>	20.000 <i>0.787</i>		+0.025/+0.083	
# BP00800-01000-0220-G	8.000 <i>0.315</i>	10.000 <i>0.394</i>	22.000 <i>0.866</i>		+0.025/+0.083	
# BP00900-01100-0060-G	9.000 <i>0.354</i>	11.000 <i>0.433</i>	6.000 <i>0.236</i>		+0.025/+0.083	
# BP00953-01191-0064-G	9.525 <i>0.375</i>	11.906 <i>0.469</i>	6.350 <i>0.250</i>			
# BP00953-01191-0095-G	9.525 <i>0.375</i>	11.906 <i>0.469</i>	9.525 <i>0.375</i>			
# BP00953-01191-0127-G	9.525 <i>0.375</i>	11.906 <i>0.469</i>	12.700 <i>0.500</i>			

Indicates item not stocked at time of printing - Please enquire for lead time

E&OE Pricing and all details subject to change without notice - Copyright Miniature Bearings Australia Pty Ltd

MBA Size Listings are a guide to sizes only and must not be solely relied on for critical design information.

Bushes - Plastic - Iglidur G - Unflanged

Part Number	Nom. ID (d) mm	Nom. OD (D) mm	Length (s) mm	Inner Diameter after Press Fit mm	Tolerance of ID after Pressfit mm	Housing Bore (Max. / Min.)
	<i>inches</i>	<i>inches</i>	<i>inches</i>	<i>inches</i>	<i>inches</i>	
# BP00953-01191-0191-G	9.525 <i>0.375</i>	11.906 <i>0.469</i>	19.050 <i>0.750</i>			
# BP00953-01349-0127-G	9.525 <i>0.375</i>	13.494 <i>0.531</i>	12.700 <i>0.500</i>			
# BP00953-01349-0191-G	9.525 <i>0.375</i>	13.494 <i>0.531</i>	19.050 <i>0.750</i>			
# BP01000-01100-0100-G	10.000 <i>0.394</i>	11.000 <i>0.433</i>	10.000 <i>0.394</i>		+0.013/+0.049	
# BP01000-01100-0250-G	10.000 <i>0.394</i>	11.000 <i>0.433</i>	25.000 <i>0.984</i>		+0.013/+0.049	
BP01000-01200-0040-G	10.000 <i>0.394</i>	12.000 <i>0.472</i>	4.000 <i>0.157</i>	10.083 / 10.013	+ 0.025 / + 0.083	12.018 / 12.000
# BP01000-01200-0050-G	10.000 <i>0.394</i>	12.000 <i>0.472</i>	5.000 <i>0.197</i>		+0.025/+0.083	
# BP01000-01200-0060-G	10.000 <i>0.394</i>	12.000 <i>0.472</i>	6.000 <i>0.236</i>		+0.025/+0.083	
# BP01000-01200-0070-G	10.000 <i>0.394</i>	12.000 <i>0.472</i>	7.000 <i>0.276</i>		+0.025/+0.083	
# BP01000-01200-0080-G	10.000 <i>0.394</i>	12.000 <i>0.472</i>	8.000 <i>0.315</i>		+0.025/+0.083	

Indicates item not stocked at time of printing - Please enquire for lead time

E&OE Pricing and all details subject to change without notice - Copyright Miniature Bearings Australia Pty Ltd

MBA Size Listings are a guide to sizes only and must not be solely relied on for critical design information.

Bushes - Plastic - Iglidur G - Unflanged

Part Number	Nom. ID (d) mm	Nom. OD (D) mm	Length (s) mm	Inner Diameter after Press Fit mm	Tolerance of ID after Pressfit mm	Housing Bore (Max. / Min.)
	<i>inches</i>	<i>inches</i>	<i>inches</i>	<i>inches</i>	<i>inches</i>	
# BP01000-01200-0090-G	10.000 <i>0.394</i>	12.000 <i>0.472</i>	9.000 <i>0.354</i>		+0.025/+0.083	
# BP01000-01200-0100-G	10.000 <i>0.394</i>	12.000 <i>0.472</i>	10.000 <i>0.394</i>		+0.025/+0.083	
# BP01000-01200-0120-G	10.000 <i>0.394</i>	12.000 <i>0.472</i>	12.000 <i>0.472</i>	10.083 / 10.013	+ 0.025 / + 0.083	12.018 / 12.000
# BP01000-01200-0140-G	10.000 <i>0.394</i>	12.000 <i>0.472</i>	14.000 <i>0.551</i>		+0.025/+0.083	
# BP01000-01200-0150-G	10.000 <i>0.394</i>	12.000 <i>0.472</i>	15.000 <i>0.591</i>		+0.025/+0.083	
# BP01000-01200-0170-G	10.000 <i>0.394</i>	12.000 <i>0.472</i>	17.000 <i>0.669</i>		+0.025/+0.083	
# BP01000-01200-0200-G	10.000 <i>0.394</i>	12.000 <i>0.472</i>	20.000 <i>0.787</i>		+0.025/+0.083	
# BP01111-01349-0064-G	11.113 <i>0.438</i>	13.494 <i>0.531</i>	6.350 <i>0.250</i>			
# BP01111-01349-0127-G	11.113 <i>0.438</i>	13.494 <i>0.531</i>	12.700 <i>0.500</i>			
# BP01200-01300-0120-G	12.000 <i>0.472</i>	13.000 <i>0.512</i>	12.000 <i>0.472</i>		+0.016/+0.059	

Indicates item not stocked at time of printing - Please enquire for lead time

E&OE Pricing and all details subject to change without notice - Copyright Miniature Bearings Australia Pty Ltd

MBA Size Listings are a guide to sizes only and must not be solely relied on for critical design information.

Bushes - Plastic - Iglidur G - Unflanged

Part Number	Nom. ID (d) mm	Nom. OD (D) mm	Length (s) mm	Inner Diameter after Press Fit mm	Tolerance of ID after Pressfit mm	Housing Bore (Max. / Min.)
	<i>inches</i>	<i>inches</i>	<i>inches</i>	<i>inches</i>	<i>inches</i>	
# BP01200-01300-0150-G	12.000 <i>0.472</i>	13.000 <i>0.512</i>	15.000 <i>0.591</i>		+0.016/+0.059	
# BP01200-01400-0040-G	12.000 <i>0.472</i>	14.000 <i>0.551</i>	4.000 <i>0.157</i>		+0.032/+0.102	
# BP01200-01400-0060-G	12.000 <i>0.472</i>	14.000 <i>0.551</i>	6.000 <i>0.236</i>		+0.032/+0.102	
# BP01200-01400-0080-G	12.000 <i>0.472</i>	14.000 <i>0.551</i>	8.000 <i>0.315</i>		+0.032/+0.102	
# BP01200-01400-0100-G	12.000 <i>0.472</i>	14.000 <i>0.551</i>	10.000 <i>0.394</i>		+0.032/+0.102	
# BP01200-01400-0120-G	12.000 <i>0.472</i>	14.000 <i>0.551</i>	12.000 <i>0.472</i>		+0.032/+0.102	
# BP01200-01400-0140-G	12.000 <i>0.472</i>	14.000 <i>0.551</i>	14.000 <i>0.551</i>	12.102 / 12.016	+ 0.032 / + 0.102	14.018 / 14.018
# BP01200-01400-0150-G	12.000 <i>0.472</i>	14.000 <i>0.551</i>	15.000 <i>0.591</i>		+0.032/+0.102	
# BP01200-01400-0200-G	12.000 <i>0.472</i>	14.000 <i>0.551</i>	20.000 <i>0.787</i>		+0.032/+0.102	
# BP01200-01400-0250-G	12.000 <i>0.472</i>	14.000 <i>0.551</i>	25.000 <i>0.984</i>		+0.032/+0.102	

Indicates item not stocked at time of printing - Please enquire for lead time

E&OE Pricing and all details subject to change without notice - Copyright Miniature Bearings Australia Pty Ltd

MBA Size Listings are a guide to sizes only and must not be solely relied on for critical design information.

Bushes - Plastic - Iglidur G - Unflanged

Part Number	Nom. ID (d) mm	Nom. OD (D) mm	Length (s) mm	Inner Diameter after Press Fit mm	Tolerance of ID after Pressfit mm	Housing Bore (Max. / Min.)
	<i>inches</i>	<i>inches</i>	<i>inches</i>	<i>inches</i>	<i>inches</i>	
# BP01200-01500-0060-G	12.000 <i>0.472</i>	15.000 <i>0.591</i>	6.000 <i>0.236</i>		+0.032/+0.102	
# BP01200-01500-0220-G	12.000 <i>0.472</i>	15.000 <i>0.591</i>	22.000 <i>0.866</i>		+0.032/+0.102	
# BP01270-01508-0048-G	12.700 <i>0.500</i>	15.081 <i>0.594</i>	4.763 <i>0.188</i>			
# BP01270-01508-0064-G	12.700 <i>0.500</i>	15.081 <i>0.594</i>	6.350 <i>0.250</i>			
# BP01270-01508-0095-G	12.700 <i>0.500</i>	15.081 <i>0.594</i>	9.525 <i>0.375</i>			
# BP01270-01508-0127-G	12.700 <i>0.500</i>	15.081 <i>0.594</i>	12.700 <i>0.500</i>			
# BP01270-01508-0159-G	12.700 <i>0.500</i>	15.081 <i>0.594</i>	15.875 <i>0.625</i>			
# BP01270-01508-0254-G	12.700 <i>0.500</i>	15.081 <i>0.594</i>	25.400 <i>1.000</i>			
# BP01270-01588-0127-G	12.700 <i>0.500</i>	15.875 <i>0.625</i>	12.700 <i>0.500</i>			
# BP01270-01588-0191-G	12.700 <i>0.500</i>	15.875 <i>0.625</i>	19.050 <i>0.750</i>			

Indicates item not stocked at time of printing - Please enquire for lead time

E&OE Pricing and all details subject to change without notice - Copyright Miniature Bearings Australia Pty Ltd

MBA Size Listings are a guide to sizes only and must not be solely relied on for critical design information.

Bushes - Plastic - Iglidur G - Unflanged

Part Number	Nom. ID (d) mm	Nom. OD (D) mm	Length (s) mm	Inner Diameter after Press Fit mm	Tolerance of ID after Pressfit mm	Housing Bore (Max. / Min.)
	<i>inches</i>	<i>inches</i>	<i>inches</i>	<i>inches</i>	<i>inches</i>	
# BP01300-01500-0075-G	13.000 <i>0.512</i>	15.000 <i>0.591</i>	7.500 <i>0.295</i>		+0.032/+0.102	
# BP01300-01500-0100-G	13.000 <i>0.512</i>	15.000 <i>0.591</i>	10.000 <i>0.394</i>		+0.032/+0.102	
# BP01300-01500-0150-G	13.000 <i>0.512</i>	15.000 <i>0.591</i>	15.000 <i>0.591</i>		+0.032/+0.102	
# BP01300-01500-0200-G	13.000 <i>0.512</i>	15.000 <i>0.591</i>	20.000 <i>0.787</i>		+0.032/+0.102	
# BP01300-01500-0250-G	13.000 <i>0.512</i>	15.000 <i>0.591</i>	25.000 <i>0.984</i>		+0.032/+0.102	
# BP01400-01600-0030-G	14.000 <i>0.551</i>	16.000 <i>0.630</i>	3.000 <i>0.118</i>		+0.032/+0.102	
# BP01400-01600-0080-G	14.000 <i>0.551</i>	16.000 <i>0.630</i>	8.000 <i>0.315</i>		+0.032/+0.102	
# BP01400-01600-0100-G	14.000 <i>0.551</i>	16.000 <i>0.630</i>	10.000 <i>0.394</i>		+0.032/+0.102	
# BP01400-01600-0150-G	14.000 <i>0.551</i>	16.000 <i>0.630</i>	15.000 <i>0.591</i>		+0.032/+0.102	
# BP01400-01600-0200-G	14.000 <i>0.551</i>	16.000 <i>0.630</i>	20.000 <i>0.787</i>		+0.032/+0.102	

Indicates item not stocked at time of printing - Please enquire for lead time

E&OE Pricing and all details subject to change without notice - Copyright Miniature Bearings Australia Pty Ltd

MBA Size Listings are a guide to sizes only and must not be solely relied on for critical design information.

Bushes - Plastic - Iglidur G - Unflanged

Part Number	Nom. ID (d) mm	Nom. OD (D) mm	Length (s) mm	Inner Diameter after Press Fit mm	Tolerance of ID after Pressfit mm	Housing Bore (Max. / Min.)
	<i>inches</i>	<i>inches</i>	<i>inches</i>	<i>inches</i>	<i>inches</i>	
# BP01400-01600-0250-G	14.000 <i>0.551</i>	16.000 <i>0.630</i>	25.000 <i>0.984</i>		+0.032/+0.102	
# BP01429-01667-0095-G	14.288 <i>0.563</i>	16.669 <i>0.656</i>	9.525 <i>0.375</i>			
# BP01429-01667-0127-G	14.288 <i>0.563</i>	16.669 <i>0.656</i>	12.700 <i>0.500</i>			
# BP01429-01667-0159-G	14.288 <i>0.563</i>	16.669 <i>0.656</i>	15.875 <i>0.625</i>			
# BP01500-01600-0150-G	15.000 <i>0.591</i>	16.000 <i>0.630</i>	15.000 <i>0.591</i>		+0.032/+0.102	
# BP01500-01700-0040-G	15.000 <i>0.591</i>	17.000 <i>0.669</i>	4.000 <i>0.157</i>		+0.032/+0.102	
# BP01500-01700-0100-G	15.000 <i>0.591</i>	17.000 <i>0.669</i>	10.000 <i>0.394</i>		+0.032/+0.102	
# BP01500-01700-0120-G	15.000 <i>0.591</i>	17.000 <i>0.669</i>	12.000 <i>0.472</i>		+0.032/+0.102	
# BP01500-01700-0150-G	15.000 <i>0.591</i>	17.000 <i>0.669</i>	15.000 <i>0.591</i>		+0.032/+0.102	
# BP01500-01700-0200-G	15.000 <i>0.591</i>	17.000 <i>0.669</i>	20.000 <i>0.787</i>		+0.032/+0.102	

Indicates item not stocked at time of printing - Please enquire for lead time

E&OE Pricing and all details subject to change without notice - Copyright Miniature Bearings Australia Pty Ltd

MBA Size Listings are a guide to sizes only and must not be solely relied on for critical design information.

Bushes - Plastic - Iglidur G - Unflanged

Part Number	Nom. ID (d) mm	Nom. OD (D) mm	Length (s) mm	Inner Diameter after Press Fit mm	Tolerance of ID after Pressfit mm	Housing Bore (Max. / Min.)
	<i>inches</i>	<i>inches</i>	<i>inches</i>	<i>inches</i>	<i>inches</i>	
# BP01500-01700-0250-G	15.000 <i>0.591</i>	17.000 <i>0.669</i>	25.000 <i>0.984</i>		+0.032/+0.102	
# BP01588-01826-0095-G	15.875 <i>0.625</i>	18.256 <i>0.719</i>	9.525 <i>0.375</i>			
# BP01588-01826-0127-G	15.875 <i>0.625</i>	18.256 <i>0.719</i>	12.700 <i>0.500</i>			
# BP01588-01826-0159-G	15.875 <i>0.625</i>	18.256 <i>0.719</i>	15.875 <i>0.625</i>			
# BP01588-01826-0191-G	15.875 <i>0.625</i>	18.256 <i>0.719</i>	19.050 <i>0.750</i>			
# BP01588-01826-0254-G	15.875 <i>0.625</i>	18.256 <i>0.719</i>	25.400 <i>1.000</i>			
# BP01588-01826-0318-G	15.875 <i>0.625</i>	18.256 <i>0.719</i>	31.750 <i>1.250</i>			
# BP01588-01826-0476-G	15.875 <i>0.625</i>	18.256 <i>0.719</i>	47.625 <i>1.875</i>			
# BP01588-01984-0127-G	15.875 <i>0.625</i>	19.844 <i>0.781</i>	12.700 <i>0.500</i>			
# BP01588-01984-0254-G	15.875 <i>0.625</i>	19.844 <i>0.781</i>	25.400 <i>1.000</i>			

Indicates item not stocked at time of printing - Please enquire for lead time

E&OE Pricing and all details subject to change without notice - Copyright Miniature Bearings Australia Pty Ltd

MBA Size Listings are a guide to sizes only and must not be solely relied on for critical design information.

Bushes - Plastic - Iglidur G - Unflanged

Part Number	Nom. ID (d) mm	Nom. OD (D) mm	Length (s) mm	Inner Diameter after Press Fit mm	Tolerance of ID after Pressfit mm	Housing Bore (Max. / Min.)
	<i>inches</i>	<i>inches</i>	<i>inches</i>	<i>inches</i>	<i>inches</i>	
# BP01600-01800-0100-G	16.000 <i>0.630</i>	18.000 <i>0.709</i>	10.000 <i>0.394</i>		+0.032/+0.102	
# BP01600-01800-0120-G	16.000 <i>0.630</i>	18.000 <i>0.709</i>	12.000 <i>0.472</i>		+0.032/+0.102	
# BP01600-01800-0135-G	16.000 <i>0.630</i>	18.000 <i>0.709</i>	13.500 <i>0.531</i>		+0.032/+0.102	
# BP01600-01800-0150-G	16.000 <i>0.630</i>	18.000 <i>0.709</i>	15.000 <i>0.591</i>		+0.032/+0.102	
# BP01600-01800-0200-G	16.000 <i>0.630</i>	18.000 <i>0.709</i>	20.000 <i>0.787</i>	16.102 / 16.016	+ 0.032 / + 0.102	18.018 / 18.018
# BP01600-01800-0250-G	16.000 <i>0.630</i>	18.000 <i>0.709</i>	25.000 <i>0.984</i>		+0.032/+0.102	
# BP01746-01984-0222-G	17.463 <i>0.688</i>	19.844 <i>0.781</i>	22.225 <i>0.875</i>			
# BP01800-02000-0100-G	18.000 <i>0.709</i>	20.000 <i>0.787</i>	10.000 <i>0.394</i>		+0.032/+0.102	
# BP01800-02000-0120-G	18.000 <i>0.709</i>	20.000 <i>0.787</i>	12.000 <i>0.472</i>		+0.032/+0.102	
# BP01800-02000-0150-G	18.000 <i>0.709</i>	20.000 <i>0.787</i>	15.000 <i>0.591</i>		+0.032/+0.102	

Indicates item not stocked at time of printing - Please enquire for lead time

E&OE Pricing and all details subject to change without notice - Copyright Miniature Bearings Australia Pty Ltd

MBA Size Listings are a guide to sizes only and must not be solely relied on for critical design information.

Bushes - Plastic - Iglidur G - Unflanged

Part Number	Nom. ID (d) mm	Nom. OD (D) mm	Length (s) mm	Inner Diameter after Press Fit mm	Tolerance of ID after Pressfit mm	Housing Bore (Max. / Min.)
	<i>inches</i>	<i>inches</i>	<i>inches</i>	<i>inches</i>	<i>inches</i>	
# BP01800-02000-0200-G	18.000 <i>0.709</i>	20.000 <i>0.787</i>	20.000 <i>0.787</i>		+0.032/+0.102	
# BP01800-02000-0250-G	18.000 <i>0.709</i>	20.000 <i>0.787</i>	25.000 <i>0.984</i>		+0.032/+0.102	
# BP01800-02000-0450-G	18.000 <i>0.709</i>	20.000 <i>0.787</i>	45.000 <i>1.772</i>		+0.032/+0.102	
# BP01900-02200-0060-G	19.000 <i>0.748</i>	22.000 <i>0.866</i>	6.000 <i>0.236</i>		+0.040/+0.124	
# BP01900-02200-0280-G	19.000 <i>0.748</i>	22.000 <i>0.866</i>	28.000 <i>1.102</i>		+0.040/+0.124	
# BP01900-02200-0350-G	19.000 <i>0.748</i>	22.000 <i>0.866</i>	35.000 <i>1.378</i>		+0.040/+0.124	
# BP01905-02223-0032-G	19.050 <i>0.750</i>	22.225 <i>0.875</i>	3.175 <i>0.125</i>			
# BP01905-02223-0095-G	19.050 <i>0.750</i>	22.225 <i>0.875</i>	9.525 <i>0.375</i>			
# BP01905-02223-0127-G	19.050 <i>0.750</i>	22.225 <i>0.875</i>	12.700 <i>0.500</i>			
# BP01905-02223-0191-G	19.050 <i>0.750</i>	22.225 <i>0.875</i>	19.050 <i>0.750</i>			

Indicates item not stocked at time of printing - Please enquire for lead time

E&OE Pricing and all details subject to change without notice - Copyright Miniature Bearings Australia Pty Ltd

MBA Size Listings are a guide to sizes only and must not be solely relied on for critical design information.

Bushes - Plastic - Iglidur G - Unflanged

Part Number	Nom. ID (d) mm	Nom. OD (D) mm	Length (s) mm	Inner Diameter after Press Fit mm	Tolerance of ID after Pressfit mm	Housing Bore (Max. / Min.)
	<i>inches</i>	<i>inches</i>	<i>inches</i>	<i>inches</i>	<i>inches</i>	
# BP01905-02223-0254-G	19.050 <i>0.750</i>	22.225 <i>0.875</i>	25.400 <i>1.000</i>			
# BP01905-02223-0318-G	19.050 <i>0.750</i>	22.225 <i>0.875</i>	31.750 <i>1.250</i>			
# BP01905-02223-0381-G	19.050 <i>0.750</i>	22.230 <i>0.875</i>	38.100 <i>1.500</i>			
# BP02000-02100-0200-G	20.000 <i>0.787</i>	21.000 <i>0.827</i>	20.000 <i>0.787</i>		+0.020/+0.072	
# BP02000-02200-0030-G	20.000 <i>0.787</i>	22.000 <i>0.866</i>	3.000 <i>0.118</i>		+0.040/+0.124	
# BP02000-02200-0105-G	20.000 <i>0.787</i>	22.000 <i>0.866</i>	10.500 <i>0.413</i>		+0.040/+0.124	
# BP02000-02200-0150-G	20.000 <i>0.787</i>	22.000 <i>0.866</i>	15.000 <i>0.591</i>		+0.040/+0.124	
# BP02000-02200-0220-G	20.000 <i>0.787</i>	22.000 <i>0.866</i>	22.000 <i>0.866</i>	20.124 / 20.020	+ 0.040 / + 0.124	22.021 / 22.021
# BP02000-02200-0300-G	20.000 <i>0.787</i>	22.000 <i>0.866</i>	30.000 <i>1.181</i>		+0.040/+0.124	
# BP02000-02300-0100-G	20.000 <i>0.787</i>	23.000 <i>0.906</i>	10.000 <i>0.394</i>		+0.040/+0.124	

Indicates item not stocked at time of printing - Please enquire for lead time

E&OE Pricing and all details subject to change without notice - Copyright Miniature Bearings Australia Pty Ltd

MBA Size Listings are a guide to sizes only and must not be solely relied on for critical design information.

Bushes - Plastic - Iglidur G - Unflanged

Part Number	Nom. ID (d) mm	Nom. OD (D) mm	Length (s) mm	Inner Diameter after Press Fit mm	Tolerance of ID after Pressfit mm	Housing Bore (Max. / Min.)
	<i>inches</i>	<i>inches</i>	<i>inches</i>	<i>inches</i>	<i>inches</i>	
# BP02000-02300-0150-G	20.000 <i>0.787</i>	23.000 <i>0.906</i>	15.000 <i>0.591</i>		+0.040/+0.124	
# BP02000-02300-0200-G	20.000 <i>0.787</i>	23.000 <i>0.906</i>	20.000 <i>0.787</i>		+0.040/+0.124	
# BP02000-02300-0230-G	20.000 <i>0.787</i>	23.000 <i>0.906</i>	23.000 <i>0.906</i>		+0.040/+0.124	
# BP02000-02300-0240-G	20.000 <i>0.787</i>	23.000 <i>0.906</i>	24.000 <i>0.945</i>		+0.040/+0.124	
# BP02000-02300-0250-G	20.000 <i>0.787</i>	23.000 <i>0.906</i>	25.000 <i>0.984</i>		+0.040/+0.124	
# BP02000-02300-0300-G	20.000 <i>0.787</i>	23.000 <i>0.906</i>	30.000 <i>1.181</i>		+0.040/+0.124	
BP02200-02400-0150-G	22.000 <i>0.866</i>	24.000 <i>0.945</i>	15.000 <i>0.591</i>		+0.040/+0.124	
# BP02200-02400-0200-G	22.000 <i>0.866</i>	24.000 <i>0.945</i>	20.000 <i>0.787</i>		+0.040/+0.124	
# BP02200-02400-0300-G	22.000 <i>0.866</i>	24.000 <i>0.945</i>	30.000 <i>1.181</i>		+0.040/+0.124	
# BP02200-02500-0150-G	22.000 <i>0.866</i>	25.000 <i>0.984</i>	15.000 <i>0.591</i>		+0.040/+0.124	

Indicates item not stocked at time of printing - Please enquire for lead time

E&OE Pricing and all details subject to change without notice - Copyright Miniature Bearings Australia Pty Ltd

MBA Size Listings are a guide to sizes only and must not be solely relied on for critical design information.

Bushes - Plastic - Iglidur G - Unflanged

Part Number	Nom. ID (d) mm	Nom. OD (D) mm	Length (s) mm	Inner Diameter after Press Fit mm	Tolerance of ID after Pressfit mm	Housing Bore (Max. / Min.)
	<i>inches</i>	<i>inches</i>	<i>inches</i>	<i>inches</i>	<i>inches</i>	
# BP02200-02500-0200-G	22.000 <i>0.866</i>	25.000 <i>0.984</i>	20.000 <i>0.787</i>		+0.040/+0.124	
# BP02200-02500-0250-G	22.000 <i>0.866</i>	25.000 <i>0.984</i>	25.000 <i>0.984</i>		+0.040/+0.124	
BP02200-02500-0300-G	22.000 <i>0.866</i>	25.000 <i>0.984</i>	30.000 <i>1.181</i>		+0.040/+0.124	
# BP02223-02540-0095-G	22.225 <i>0.875</i>	25.400 <i>1.000</i>	9.525 <i>0.375</i>			
# BP02223-02540-0127-G	22.225 <i>0.875</i>	25.400 <i>1.000</i>	12.700 <i>0.500</i>			
# BP02223-02540-0159-G	22.225 <i>0.875</i>	25.400 <i>1.000</i>	15.875 <i>0.625</i>			
# BP02223-02540-0191-G	22.225 <i>0.875</i>	25.400 <i>1.000</i>	19.050 <i>0.750</i>			
# BP02223-02540-0254-G	22.225 <i>0.875</i>	25.400 <i>1.000</i>	25.400 <i>1.000</i>			
# BP02223-02540-0381-G	22.225 <i>0.875</i>	25.400 <i>1.000</i>	38.100 <i>1.500</i>			
# BP02400-02700-0150-G	24.000 <i>0.945</i>	27.000 <i>1.063</i>	15.000 <i>0.591</i>		+0.040/+0.124	

Indicates item not stocked at time of printing - Please enquire for lead time

E&OE Pricing and all details subject to change without notice - Copyright Miniature Bearings Australia Pty Ltd

MBA Size Listings are a guide to sizes only and must not be solely relied on for critical design information.

Bushes - Plastic - Iglidur G - Unflanged

Part Number	Nom. ID (d) mm	Nom. OD (D) mm	Length (s) mm	Inner Diameter after Press Fit mm	Tolerance of ID after Pressfit mm	Housing Bore (Max. / Min.)
	<i>inches</i>	<i>inches</i>	<i>inches</i>	<i>inches</i>	<i>inches</i>	
# BP02400-02700-0200-G	24.000 <i>0.945</i>	27.000 <i>1.063</i>	20.000 <i>0.787</i>		+0.040/+0.124	
# BP02400-02700-0250-G	24.000 <i>0.945</i>	27.000 <i>1.063</i>	25.000 <i>0.984</i>		+0.040/+0.124	
BP02400-02700-0300-G	24.000 <i>0.945</i>	27.000 <i>1.063</i>	30.000 <i>1.181</i>		+0.040/+0.124	
# BP02500-02600-0250-G	25.000 <i>0.984</i>	26.000 <i>1.024</i>	25.000 <i>0.984</i>		+0.020/+0.072	
# BP02500-02800-0120-G	25.000 <i>0.984</i>	28.000 <i>1.102</i>	12.000 <i>0.472</i>		+0.040/+0.124	
# BP02500-02800-0150-G	25.000 <i>0.984</i>	28.000 <i>1.102</i>	15.000 <i>0.591</i>		+0.040/+0.124	
# BP02500-02800-0200-G	25.000 <i>0.984</i>	28.000 <i>1.102</i>	20.000 <i>0.787</i>		+0.040/+0.124	
# BP02500-02800-0240-G	25.000 <i>0.984</i>	28.000 <i>1.102</i>	24.000 <i>0.945</i>		+0.040/+0.124	
# BP02500-02800-0250-G	25.000 <i>0.984</i>	28.000 <i>1.102</i>	25.000 <i>0.984</i>		+0.040/+0.124	
# BP02500-02800-0300-G	25.000 <i>0.984</i>	28.000 <i>1.102</i>	30.000 <i>1.181</i>		+0.040/+0.124	

Indicates item not stocked at time of printing - Please enquire for lead time

E&OE Pricing and all details subject to change without notice - Copyright Miniature Bearings Australia Pty Ltd

MBA Size Listings are a guide to sizes only and must not be solely relied on for critical design information.

Bushes - Plastic - Iglidur G - Unflanged

Part Number	Nom. ID (d) mm	Nom. OD (D) mm	Length (s) mm	Inner Diameter after Press Fit mm	Tolerance of ID after Pressfit mm	Housing Bore (Max. / Min.)
	<i>inches</i>	<i>inches</i>	<i>inches</i>	<i>inches</i>	<i>inches</i>	
# BP02500-02800-0350-G	25.000 <i>0.984</i>	28.000 <i>1.102</i>	35.000 <i>1.378</i>		+0.040/+0.124	
BP02500-02800-0500-G	25.000 <i>0.984</i>	28.000 <i>1.102</i>	50.000 <i>1.969</i>		+0.040/+0.124	
# BP02540-02858-0127-G	25.400 <i>1.000</i>	28.575 <i>1.125</i>	12.700 <i>0.500</i>			
# BP02540-02858-0191-G	25.400 <i>1.000</i>	28.575 <i>1.125</i>	19.050 <i>0.750</i>			
# BP02540-02858-0254-G	25.400 <i>1.000</i>	28.575 <i>1.125</i>	25.400 <i>1.000</i>			
# BP02540-02858-0318-G	25.400 <i>1.000</i>	28.575 <i>1.125</i>	31.750 <i>1.250</i>			
# BP02540-02858-0381-G	25.400 <i>1.000</i>	28.575 <i>1.125</i>	38.100 <i>1.500</i>			
# BP02540-02858-0524-G	25.400 <i>1.000</i>	28.575 <i>1.125</i>	52.388 <i>2.063</i>			
# BP02600-03000-0160-G	26.000 <i>1.024</i>	30.000 <i>1.181</i>	16.000 <i>0.630</i>		+0.040/+0.124	
# BP02800-03200-0105-G	28.000 <i>1.102</i>	32.000 <i>1.260</i>	10.500 <i>0.413</i>		+0.040/+0.124	

Indicates item not stocked at time of printing - Please enquire for lead time

E&OE Pricing and all details subject to change without notice - Copyright Miniature Bearings Australia Pty Ltd

MBA Size Listings are a guide to sizes only and must not be solely relied on for critical design information.

Bushes - Plastic - Iglidur G - Unflanged

Part Number	Nom. ID (d) mm	Nom. OD (D) mm	Length (s) mm	Inner Diameter after Press Fit mm	Tolerance of ID after Pressfit mm	Housing Bore (Max. / Min.)
	<i>inches</i>	<i>inches</i>	<i>inches</i>	<i>inches</i>	<i>inches</i>	
# BP02800-03200-0120-G	28.000 <i>1.102</i>	32.000 <i>1.260</i>	12.000 <i>0.472</i>		+0.040/+0.124	
# BP02800-03200-0150-G	28.000 <i>1.102</i>	32.000 <i>1.260</i>	15.000 <i>0.591</i>		+0.040/+0.124	
# BP02800-03200-0200-G	28.000 <i>1.102</i>	32.000 <i>1.260</i>	20.000 <i>0.787</i>		+0.040/+0.124	
# BP02800-03200-0230-G	28.000 <i>1.102</i>	32.000 <i>1.260</i>	23.000 <i>0.906</i>		+0.040/+0.124	
# BP02800-03200-0250-G	28.000 <i>1.102</i>	32.000 <i>1.260</i>	25.000 <i>0.984</i>		+0.040/+0.124	
# BP02800-03200-0300-G	28.000 <i>1.102</i>	32.000 <i>1.260</i>	30.000 <i>1.181</i>		+0.040/+0.124	
# BP02858-03254-0191-G	28.575 <i>1.125</i>	32.544 <i>1.281</i>	19.050 <i>0.750</i>			
# BP02858-03254-0381-G	28.575 <i>1.125</i>	32.544 <i>1.281</i>	38.100 <i>1.500</i>			
# BP03000-03100-0120-G	30.000 <i>1.181</i>	31.000 <i>1.220</i>	12.000 <i>0.472</i>		+0.020/+0.072	
# BP03000-03100-0300-G	30.000 <i>1.181</i>	31.000 <i>1.220</i>	30.000 <i>1.181</i>		+0.020/+0.072	

Indicates item not stocked at time of printing - Please enquire for lead time

E&OE Pricing and all details subject to change without notice - Copyright Miniature Bearings Australia Pty Ltd

MBA Size Listings are a guide to sizes only and must not be solely relied on for critical design information.

Bushes - Plastic - Iglidur G - Unflanged

Part Number	Nom. ID (d) mm	Nom. OD (D) mm	Length (s) mm	Inner Diameter after Press Fit mm	Tolerance of ID after Pressfit mm	Housing Bore (Max. / Min.)
	<i>inches</i>	<i>inches</i>	<i>inches</i>	<i>inches</i>	<i>inches</i>	
# BP03000-03400-0150-G	30.000 <i>1.181</i>	34.000 <i>1.339</i>	15.000 <i>0.591</i>		+0.040/+0.124	
# BP03000-03400-0200-G	30.000 <i>1.181</i>	34.000 <i>1.339</i>	20.000 <i>0.787</i>		+0.040/+0.124	
# BP03000-03400-0240-G	30.000 <i>1.181</i>	34.000 <i>1.339</i>	24.000 <i>0.945</i>		+0.040/+0.124	
# BP03000-03400-0250-G	30.000 <i>1.181</i>	34.000 <i>1.339</i>	25.000 <i>0.984</i>		+0.040/+0.124	
# BP03000-03400-0300-G	30.000 <i>1.181</i>	34.000 <i>1.339</i>	30.000 <i>1.181</i>		+0.040/+0.124	
# BP03000-03400-0350-G	30.000 <i>1.181</i>	34.000 <i>1.339</i>	35.000 <i>1.378</i>		+0.040/+0.124	
# BP03000-03400-0400-G	30.000 <i>1.181</i>	34.000 <i>1.339</i>	40.000 <i>1.575</i>		+0.040/+0.124	
# BP03175-03572-0191-G	31.750 <i>1.250</i>	35.719 <i>1.406</i>	19.050 <i>0.750</i>			
# BP03175-03572-0222-G	31.750 <i>1.250</i>	35.719 <i>1.406</i>	22.225 <i>0.875</i>			
# BP03175-03572-0254-G	31.750 <i>1.250</i>	35.719 <i>1.406</i>	25.400 <i>1.000</i>			

Indicates item not stocked at time of printing - Please enquire for lead time

E&OE Pricing and all details subject to change without notice - Copyright Miniature Bearings Australia Pty Ltd

MBA Size Listings are a guide to sizes only and must not be solely relied on for critical design information.

Bushes - Plastic - Iglidur G - Unflanged

Part Number	Nom. ID (d) mm	Nom. OD (D) mm	Length (s) mm	Inner Diameter after Press Fit mm	Tolerance of ID after Pressfit mm	Housing Bore (Max. / Min.)
	<i>inches</i>	<i>inches</i>	<i>inches</i>	<i>inches</i>	<i>inches</i>	
# BP03175-03572-0317-G	31.750 <i>1.250</i>	35.719 <i>1.406</i>	31.700 <i>1.248</i>			
# BP03175-03572-0381-G	31.750 <i>1.250</i>	35.719 <i>1.406</i>	38.100 <i>1.500</i>			
# BP03200-03600-0200-G	32.000 <i>1.260</i>	36.000 <i>1.417</i>	20.000 <i>0.787</i>		+0.050/+0.150	
# BP03200-03600-0300-G	32.000 <i>1.260</i>	36.000 <i>1.417</i>	30.000 <i>1.181</i>		+0.050/+0.150	
# BP03200-03600-0400-G	32.000 <i>1.260</i>	36.000 <i>1.417</i>	40.000 <i>1.575</i>		+0.050/+0.150	
# BP03493-03890-0254-G	34.925 <i>1.375</i>	38.899 <i>1.531</i>	25.400 <i>1.000</i>			
# BP03493-03890-0381-G	34.925 <i>1.375</i>	38.899 <i>1.531</i>	38.100 <i>1.500</i>			
# BP03493-03890-0413-G	34.925 <i>1.375</i>	38.899 <i>1.531</i>	41.275 <i>1.625</i>			
# BP03500-03900-0140-G	35.000 <i>1.378</i>	39.000 <i>1.535</i>	14.000 <i>0.551</i>		+0.050/+0.150	
# BP03500-03900-0200-G	35.000 <i>1.378</i>	39.000 <i>1.535</i>	20.000 <i>0.787</i>		+0.050/+0.150	

Indicates item not stocked at time of printing - Please enquire for lead time

E&OE Pricing and all details subject to change without notice - Copyright Miniature Bearings Australia Pty Ltd

MBA Size Listings are a guide to sizes only and must not be solely relied on for critical design information.

Bushes - Plastic - Iglidur G - Unflanged

Part Number	Nom. ID (d) mm	Nom. OD (D) mm	Length (s) mm	Inner Diameter after Press Fit mm	Tolerance of ID after Pressfit mm	Housing Bore (Max. / Min.)
	<i>inches</i>	<i>inches</i>	<i>inches</i>	<i>inches</i>	<i>inches</i>	
# BP03500-03900-0250-G	35.000 <i>1.378</i>	39.000 <i>1.535</i>	25.000 <i>0.984</i>		+0.050/+0.150	
# BP03500-03900-0300-G	35.000 <i>1.378</i>	39.000 <i>1.535</i>	30.000 <i>1.181</i>		+0.050/+0.150	
# BP03500-03900-0400-G	35.000 <i>1.378</i>	39.000 <i>1.535</i>	40.000 <i>1.575</i>		+0.050/+0.150	
# BP03500-03900-0500-G	35.000 <i>1.378</i>	39.000 <i>1.535</i>	50.000 <i>1.969</i>		+0.050/+0.150	
# BP03810-04207-0095-G	38.100 <i>1.500</i>	42.069 <i>1.656</i>	9.525 <i>0.375</i>			
# BP03810-04207-0111-G	38.100 <i>1.500</i>	42.069 <i>1.656</i>	11.113 <i>0.438</i>			
# BP03810-04207-0127-G	38.100 <i>1.500</i>	42.069 <i>1.656</i>	12.700 <i>0.500</i>			
# BP03810-04207-0191-G	38.100 <i>1.500</i>	42.069 <i>1.656</i>	19.050 <i>0.750</i>			
# BP03810-04207-0254-G	38.100 <i>1.500</i>	42.069 <i>1.656</i>	25.400 <i>1.000</i>			
# BP03810-04207-0381-G	38.100 <i>1.500</i>	42.069 <i>1.656</i>	38.100 <i>1.500</i>			

Indicates item not stocked at time of printing - Please enquire for lead time

E&OE Pricing and all details subject to change without notice - Copyright Miniature Bearings Australia Pty Ltd

MBA Size Listings are a guide to sizes only and must not be solely relied on for critical design information.

Bushes - Plastic - Iglidur G - Unflanged

Part Number	Nom. ID (d) mm	Nom. OD (D) mm	Length (s) mm	Inner Diameter after Press Fit mm	Tolerance of ID after Pressfit mm	Housing Bore (Max. / Min.)
	<i>inches</i>	<i>inches</i>	<i>inches</i>	<i>inches</i>	<i>inches</i>	
# BP04000-04400-0100-G	40.000 <i>1.575</i>	44.000 <i>1.732</i>	10.000 <i>0.394</i>		+0.050/+0.150	
# BP04000-04400-0160-G	40.000 <i>1.575</i>	44.000 <i>1.732</i>	16.000 <i>0.630</i>		+0.050/+0.150	
# BP04000-04400-0200-G	40.000 <i>1.575</i>	44.000 <i>1.732</i>	20.000 <i>0.787</i>		+0.050/+0.150	
# BP04000-04400-0300-G	40.000 <i>1.575</i>	44.000 <i>1.732</i>	30.000 <i>1.181</i>		+0.050/+0.150	
# BP04000-04400-0400-G	40.000 <i>1.575</i>	44.000 <i>1.732</i>	40.000 <i>1.575</i>		+0.050/+0.150	
# BP04000-04400-0500-G	40.000 <i>1.575</i>	44.000 <i>1.732</i>	50.000 <i>1.969</i>		+0.050/+0.150	
# BP04128-04207-0318-G	41.275 <i>1.625</i>	42.069 <i>1.656</i>	31.750 <i>1.250</i>			
# BP04200-04600-0400-G	42.000 <i>1.654</i>	46.000 <i>1.811</i>	40.000 <i>1.575</i>		+0.050/+0.150	
# BP04445-04961-0254-G	44.450 <i>1.750</i>	49.609 <i>1.953</i>	25.400 <i>1.000</i>			
# BP04445-04961-0381-G	44.450 <i>1.750</i>	49.609 <i>1.953</i>	38.100 <i>1.500</i>			

Indicates item not stocked at time of printing - Please enquire for lead time

E&OE Pricing and all details subject to change without notice - Copyright Miniature Bearings Australia Pty Ltd

MBA Size Listings are a guide to sizes only and must not be solely relied on for critical design information.

Bushes - Plastic - Iglidur G - Unflanged

Part Number	Nom. ID (d) mm	Nom. OD (D) mm	Length (s) mm	Inner Diameter after Press Fit mm	Tolerance of ID after Pressfit mm	Housing Bore (Max. / Min.)
	<i>inches</i>	<i>inches</i>	<i>inches</i>	<i>inches</i>	<i>inches</i>	
# BP04445-04961-0508-G	44.450 <i>1.750</i>	49.609 <i>1.953</i>	50.800 <i>2.000</i>			
# BP04445-04961-0635-G	44.450 <i>1.750</i>	49.609 <i>1.953</i>	63.500 <i>2.500</i>			
# BP04445-04961-0762-G	44.450 <i>1.750</i>	49.609 <i>1.953</i>	76.200 <i>3.000</i>			
# BP04500-05000-0220-G	45.000 <i>1.772</i>	50.000 <i>1.969</i>	22.000 <i>0.866</i>		+0.050/+0.150	
# BP04500-05000-0300-G	45.000 <i>1.772</i>	50.000 <i>1.969</i>	30.000 <i>1.181</i>		+0.050/+0.150	
# BP04500-05000-0380-G	45.000 <i>1.772</i>	50.000 <i>1.969</i>	38.000 <i>1.496</i>		+0.050/+0.150	
# BP04500-05000-0400-G	45.000 <i>1.772</i>	50.000 <i>1.969</i>	40.000 <i>1.575</i>		+0.050/+0.150	
# BP04500-05000-0500-G	45.000 <i>1.772</i>	50.000 <i>1.969</i>	50.000 <i>1.969</i>		+0.050/+0.150	
# BP05000-05500-0200-G	50.000 <i>1.969</i>	55.000 <i>2.165</i>	20.000 <i>0.787</i>		+0.050/+0.150	
# BP05000-05500-0250-G	50.000 <i>1.969</i>	55.000 <i>2.165</i>	25.000 <i>0.984</i>		+0.050/+0.150	

Indicates item not stocked at time of printing - Please enquire for lead time

E&OE Pricing and all details subject to change without notice - Copyright Miniature Bearings Australia Pty Ltd

MBA Size Listings are a guide to sizes only and must not be solely relied on for critical design information.

Bushes - Plastic - Iglidur G - Unflanged

Part Number	Nom. ID (d) mm	Nom. OD (D) mm	Length (s) mm	Inner Diameter after Press Fit mm	Tolerance of ID after Pressfit mm	Housing Bore (Max. / Min.)
	<i>inches</i>	<i>inches</i>	<i>inches</i>	<i>inches</i>	<i>inches</i>	
# BP05000-05500-0300-G	50.000 <i>1.969</i>	55.000 <i>2.165</i>	30.000 <i>1.181</i>		+0.050/+0.150	
# BP05000-05500-0400-G	50.000 <i>1.969</i>	55.000 <i>2.165</i>	40.000 <i>1.575</i>		+0.050/+0.150	
# BP05000-05500-0500-G	50.000 <i>1.969</i>	55.000 <i>2.165</i>	50.000 <i>1.969</i>		+0.050/+0.150	
# BP05080-05556-0254-G	50.800 <i>2.000</i>	55.563 <i>2.188</i>	25.400 <i>1.000</i>			
# BP05080-05556-0381-G	50.800 <i>2.000</i>	55.563 <i>2.188</i>	38.100 <i>1.500</i>			
# BP05080-05556-0508-G	50.800 <i>2.000</i>	55.563 <i>2.188</i>	50.800 <i>2.000</i>			
# BP05500-06000-0400-G	55.000 <i>2.165</i>	60.000 <i>2.362</i>	40.000 <i>1.575</i>		+0.060/+0.180	
# BP05500-06000-0500-G	55.000 <i>2.165</i>	60.000 <i>2.362</i>	50.000 <i>1.969</i>		+0.060/+0.180	
# BP05500-06000-0600-G	55.000 <i>2.165</i>	60.000 <i>2.362</i>	60.000 <i>2.362</i>		+0.060/+0.180	
# BP05715-06191-0508-G	57.150 <i>2.250</i>	61.913 <i>2.438</i>	50.800 <i>2.000</i>			

Indicates item not stocked at time of printing - Please enquire for lead time

E&OE Pricing and all details subject to change without notice - Copyright Miniature Bearings Australia Pty Ltd

MBA Size Listings are a guide to sizes only and must not be solely relied on for critical design information.

Bushes - Plastic - Iglidur G - Unflanged

Part Number	Nom. ID (d) mm	Nom. OD (D) mm	Length (s) mm	Inner Diameter after Press Fit mm	Tolerance of ID after Pressfit mm	Housing Bore (Max. / Min.)
	<i>inches</i>	<i>inches</i>	<i>inches</i>	<i>inches</i>	<i>inches</i>	
# BP06000-06500-0300-G	60.000 <i>2.362</i>	65.000 <i>2.559</i>	30.000 <i>1.181</i>		+0.060/+0.180	
# BP06000-06500-0400-G	60.000 <i>2.362</i>	65.000 <i>2.559</i>	40.000 <i>1.575</i>		+0.060/+0.180	
# BP06000-06500-0500-G	60.000 <i>2.362</i>	65.000 <i>2.559</i>	50.000 <i>1.969</i>		+0.060/+0.180	
# BP06200-06700-0350-G	62.000 <i>2.441</i>	67.000 <i>2.638</i>	35.000 <i>1.378</i>		+0.060/+0.180	
# BP06350-06826-0508-G	63.500 <i>2.500</i>	68.263 <i>2.688</i>	50.800 <i>2.000</i>			
# BP06500-07000-0300-G	65.000 <i>2.559</i>	70.000 <i>2.756</i>	30.000 <i>1.181</i>		+0.060/+0.180	
# BP06500-07000-0500-G	65.000 <i>2.559</i>	70.000 <i>2.756</i>	50.000 <i>1.969</i>		+0.060/+0.180	
# BP06985-07461-0508-G	69.850 <i>2.750</i>	74.613 <i>2.938</i>	50.800 <i>2.000</i>			
# BP07000-07500-0600-G	70.000 <i>2.756</i>	75.000 <i>2.953</i>	60.000 <i>2.362</i>		+0.060/+0.180	
# BP07500-08000-0400-G	75.000 <i>2.953</i>	80.000 <i>3.150</i>	40.000 <i>1.575</i>		+0.060/+0.180	

Indicates item not stocked at time of printing - Please enquire for lead time

E&OE Pricing and all details subject to change without notice - Copyright Miniature Bearings Australia Pty Ltd

MBA Size Listings are a guide to sizes only and must not be solely relied on for critical design information.

Bushes - Plastic - Iglidur G - Unflanged

Part Number	Nom. ID (d) mm	Nom. OD (D) mm	Length (s) mm	Inner Diameter after Press Fit mm	Tolerance of ID after Pressfit mm	Housing Bore (Max. / Min.)
	<i>inches</i>	<i>inches</i>	<i>inches</i>	<i>inches</i>	<i>inches</i>	
# BP07500-08000-0600-G	75.000 <i>2.953</i>	80.000 <i>3.150</i>	60.000 <i>2.362</i>		+0.060/+0.180	
# BP07620-08096-0508-G	76.200 <i>3.000</i>	80.963 <i>3.188</i>	50.800 <i>2.000</i>			
# BP08000-08500-0600-G	80.000 <i>3.150</i>	85.000 <i>3.346</i>	60.000 <i>2.362</i>		+0.060/+0.180	
# BP08000-08500-1000-G	80.000 <i>3.150</i>	85.000 <i>3.346</i>	100.000 <i>3.937</i>		+0.060/+0.180	
# BP08500-09000-1000-G	85.000 <i>3.346</i>	90.000 <i>3.543</i>	100.000 <i>3.937</i>		+0.072/+0.212	
# BP09000-09500-1000-G	90.000 <i>3.543</i>	95.000 <i>3.740</i>	100.000 <i>3.937</i>		+0.072/+0.212	
# BP09500-10000-1000-G	95.000 <i>3.740</i>	100.000 <i>3.937</i>	100.000 <i>3.937</i>		+0.072/+0.212	
# BP10000-10500-0300-G	100.000 <i>3.937</i>	105.000 <i>4.134</i>	30.000 <i>1.181</i>		+0.072/+0.212	
# BP10000-10500-1000-G	100.000 <i>3.937</i>	105.000 <i>4.134</i>	100.000 <i>3.937</i>		+0.072/+0.212	
# BP11000-11500-1000-G	110.000 <i>4.331</i>	115.000 <i>4.528</i>	100.000 <i>3.937</i>		+0.072/+0.212	

Indicates item not stocked at time of printing - Please enquire for lead time

E&OE Pricing and all details subject to change without notice - Copyright Miniature Bearings Australia Pty Ltd

MBA Size Listings are a guide to sizes only and must not be solely relied on for critical design information.

Bushes - Plastic - Iglidur G - Unflanged

Part Number	Nom. ID (d) mm	Nom. OD (D) mm	Length (s) mm	Inner Diameter after Press Fit mm	Tolerance of ID after Pressfit mm	Housing Bore (Max. / Min.)
	<i>inches</i>	<i>inches</i>	<i>inches</i>	<i>inches</i>	<i>inches</i>	
# BP12000-12500-1000-G	120.000 <i>4.724</i>	125.000 <i>4.921</i>	100.000 <i>3.937</i>		+0.072/+0.212	
# BP12500-13000-1000-G	125.000 <i>4.921</i>	130.000 <i>5.118</i>	100.000 <i>3.937</i>		+0.072/+0.212	
# BP13000-13500-1000-G	130.000 <i>5.118</i>	135.000 <i>5.315</i>	100.000 <i>3.937</i>		+0.072/+0.212	
# BP13500-14000-0800-G	135.000 <i>5.315</i>	140.000 <i>5.512</i>	80.000 <i>3.150</i>		+0.072/+0.212	
# BP14000-14500-1000-G	140.000 <i>5.512</i>	145.000 <i>5.709</i>	100.000 <i>3.937</i>		+0.072/+0.212	
# BP15000-15500-1000-G	150.000 <i>5.906</i>	155.000 <i>6.102</i>	100.000 <i>3.937</i>		+0.072/+0.212	

Indicates item not stocked at time of printing - Please enquire for lead time

E&OE Pricing and all details subject to change without notice - Copyright Miniature Bearings Australia Pty Ltd

MBA Size Listings are a guide to sizes only and must not be solely relied on for critical design information.

MBA

MINIATURE BEARINGS AUSTRALIA PTY LTD

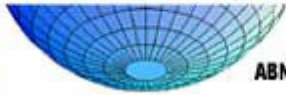

ABN 94 069 113 800



DISTRIBUTED BY

Ask us to put your name and address here

<http://www.minibearings.com.au/product>

Ph +61 7 3245 7977

Fax +61 7 3245 1017

Catalogue requests to catalogues@minibearings.com.au

SDPSI
Stock Drive Products / Spring Instrument

JK

ANOTHER QUALITY PRODUCT BY
MOLYTEC
Australia

Origin
BEARING

WIB

THOMSON

EZO



 **myonic**
solutions in microspace

rino



inox
Quality Products

GRW

DualVee^x
Bishop-Wisecarver Corp.

ondrives
Precision Manufacturing

RMB

SOLARBOTICS^{INTL}

KSK
BALL BEARING