

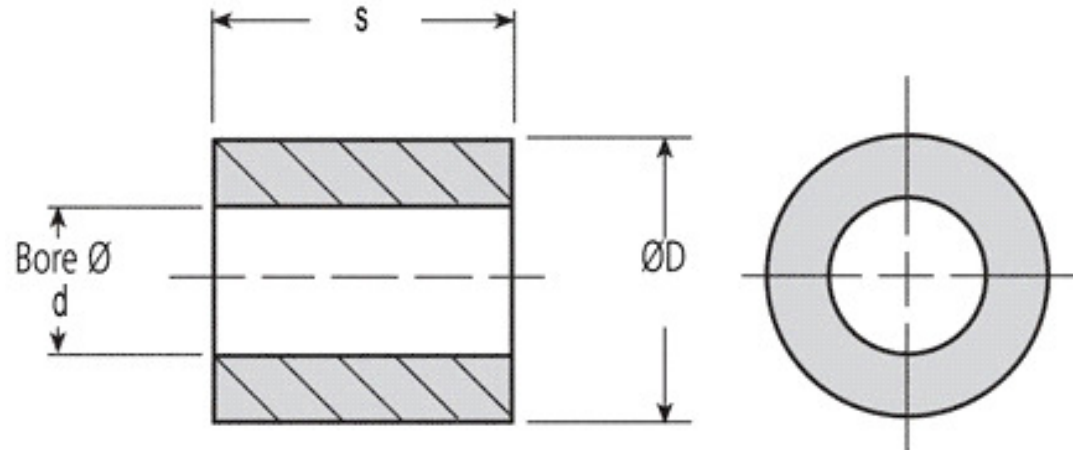

# MBA

## Bushes - Plastic - Iglidur H - Unflanged



Underwater performance. High Temp. Chemical Resistance.  
Specific Gravity 1.64 g/cm<sup>3</sup>.

Operating Temp 240 C short term / 200 C long term.

Tensile Strength at 20 deg C = 175 Mpa.

Hardness 87 Shore D (DIN53505).

Tolerances listed are after H7 Pressfit.

### Bushes - Plastic - Iglidur H - Unflanged

Part Number	Nom. ID (d) mm <i>inches</i>	Nom. OD (D) mm <i>inches</i>	Length (s) mm <i>inches</i>	Tolerance of ID after Pressfit
# BP00300-00450-0030-H	3.000 <i>0.118</i>	4.500 <i>0.177</i>	3.000 <i>0.118</i>	+0.006/+0.046
# BP00400-00550-0040-H	4.000 <i>0.157</i>	5.500 <i>0.217</i>	4.000 <i>0.157</i>	+0.010/+0.058
# BP00500-00700-0050-H	5.000 <i>0.197</i>	7.000 <i>0.276</i>	5.000 <i>0.197</i>	+0.010/+0.058

# Indicates item not stocked at time of printing - Please enquire for lead time

E&OE Pricing and all details subject to change without notice - Copyright Miniature Bearings Australia Pty Ltd

MBA Size Listings are a guide to sizes only and must not be solely relied on for critical design information.

## Bushes - Plastic - Iglidur H - Unflanged

Part Number	Nom. ID (d) mm <i>inches</i>	Nom. OD (D) mm <i>inches</i>	Length (s) mm <i>inches</i>	Tolerance of ID after Pressfit
# BP00600-00800-0060-H	6.000 <i>0.236</i>	8.000 <i>0.315</i>	6.000 <i>0.236</i>	+0.010/+0.058
# BP00800-01000-0080-H	8.000 <i>0.315</i>	10.000 <i>0.394</i>	8.000 <i>0.315</i>	+0.010/+0.058
# BP00800-01000-0100-H	8.000 <i>0.315</i>	10.000 <i>0.394</i>	10.000 <i>0.394</i>	+0.025/+0.083
# BP01000-01200-0100-H	10.000 <i>0.394</i>	12.000 <i>0.472</i>	10.000 <i>0.394</i>	+0.013/+0.071
# BP01200-01400-0100-H	12.000 <i>0.472</i>	14.000 <i>0.551</i>	10.000 <i>0.394</i>	+0.013/+0.071
# BP01200-01400-0150-H	12.000 <i>0.472</i>	14.000 <i>0.551</i>	15.000 <i>0.591</i>	+0.016/+0.086
BP01200-01400-0200-H	12.000 <i>0.472</i>	14.000 <i>0.551</i>	20.000 <i>0.787</i>	+0.016/+0.086
# BP01400-01600-0200-H	14.000 <i>0.551</i>	16.000 <i>0.630</i>	20.000 <i>0.787</i>	+0.016/+0.086
# BP01500-01700-0150-H	15.000 <i>0.591</i>	17.000 <i>0.669</i>	15.000 <i>0.591</i>	+0.016/+0.086
# BP01600-01800-0150-H	16.000 <i>0.630</i>	18.000 <i>0.709</i>	15.000 <i>0.591</i>	+0.016/+0.086

# Indicates item not stocked at time of printing - Please enquire for lead time

E&OE Pricing and all details subject to change without notice - Copyright Miniature Bearings Australia Pty Ltd

MBA Size Listings are a guide to sizes only and must not be solely relied on for critical design information.

## Bushes - Plastic - Iglidur H - Unflanged

Part Number	Nom. ID (d) mm <i>inches</i>	Nom. OD (D) mm <i>inches</i>	Length (s) mm <i>inches</i>	Tolerance of ID after Pressfit
# BP01600-01800-0200-H	16.000 <i>0.630</i>	18.000 <i>0.709</i>	20.000 <i>0.787</i>	+0.016/+0.086
# BP01600-01800-0250-H	16.000 <i>0.630</i>	18.000 <i>0.709</i>	25.000 <i>0.984</i>	+0.016/+0.086
# BP01800-02000-0150-H	18.000 <i>0.709</i>	20.000 <i>0.787</i>	15.000 <i>0.591</i>	+0.016/+0.086
# BP01800-02000-0250-H	18.000 <i>0.709</i>	20.000 <i>0.787</i>	25.000 <i>0.984</i>	+0.016/+0.086
# BP02000-02300-0200-H	20.000 <i>0.787</i>	23.000 <i>0.906</i>	20.000 <i>0.787</i>	+0.020/+0.104
# BP02200-02500-0200-H	22.000 <i>0.866</i>	25.000 <i>0.984</i>	20.000 <i>0.787</i>	+0.020/+0.104
# BP02500-02800-0200-H	25.000 <i>0.984</i>	28.000 <i>1.102</i>	20.000 <i>0.787</i>	+0.020/+0.104
# BP03000-03400-0200-H	30.000 <i>1.181</i>	34.000 <i>1.339</i>	20.000 <i>0.787</i>	+0.020/+0.104
# BP03000-03400-0300-H	30.000 <i>1.181</i>	34.000 <i>1.339</i>	30.000 <i>1.181</i>	+0.020/+0.104
# BP03000-03400-0400-H	30.000 <i>1.181</i>	34.000 <i>1.339</i>	40.000 <i>1.575</i>	+0.020/+0.104

# Indicates item not stocked at time of printing - Please enquire for lead time

E&OE Pricing and all details subject to change without notice - Copyright Miniature Bearings Australia Pty Ltd

MBA Size Listings are a guide to sizes only and must not be solely relied on for critical design information.

## Bushes - Plastic - Iglidur H - Unflanged

Part Number	Nom. ID (d) mm <i>inches</i>	Nom. OD (D) mm <i>inches</i>	Length (s) mm <i>inches</i>	Tolerance of ID after Pressfit
# BP03500-03900-0400-H	35.000 <i>1.378</i>	39.000 <i>1.535</i>	40.000 <i>1.575</i>	+0.025/+0.125
# BP04000-04400-0200-H	40.000 <i>1.575</i>	44.000 <i>1.732</i>	20.000 <i>0.787</i>	+0.025/+0.125
# BP04000-04400-0500-H	40.000 <i>1.575</i>	44.000 <i>1.732</i>	50.000 <i>1.969</i>	+0.025/+0.125
# BP04500-05000-0300-H	45.000 <i>1.772</i>	50.000 <i>1.969</i>	30.000 <i>1.181</i>	+0.025/+0.125
# BP05000-05500-0400-H	50.000 <i>1.969</i>	55.000 <i>2.165</i>	40.000 <i>1.575</i>	+0.025/+0.125
# BP05500-06000-0260-H	55.000 <i>2.165</i>	60.000 <i>2.362</i>	26.000 <i>1.024</i>	+0.030/+0.150
# BP06000-06500-0600-H	60.000 <i>2.362</i>	65.000 <i>2.559</i>	60.000 <i>2.362</i>	+0.030/+0.150
# BP07000-07500-0500-H	70.000 <i>2.756</i>	75.000 <i>2.953</i>	50.000 <i>1.969</i>	+0.030/+0.150

# Indicates item not stocked at time of printing - Please enquire for lead time

E&OE Pricing and all details subject to change without notice - Copyright Miniature Bearings Australia Pty Ltd

MBA Size Listings are a guide to sizes only and must not be solely relied on for critical design information.



DISTRIBUTED BY

Ask us to put your name and address here

<http://www.minibearings.com.au/product>

Ph +61 7 3245 7977

Fax +61 7 3245 1017

Catalogue requests to [catalogues@minibearings.com.au](mailto:catalogues@minibearings.com.au)

