

MBA

Bushes - Plastic - Iglidur J - Unflanged



Low Wear - Dry Running - Vibration Dampening - Chemical Resistance.

Specific Gravity 1.49 g/cm³.

Operating Temp 120 C short term / 90 C long term.

Tensile Strength at 20 deg C = 73 Mpa.

Hardness 74 Shore D (DIN53505).

Tolerances listed are after H7 Pressfit.

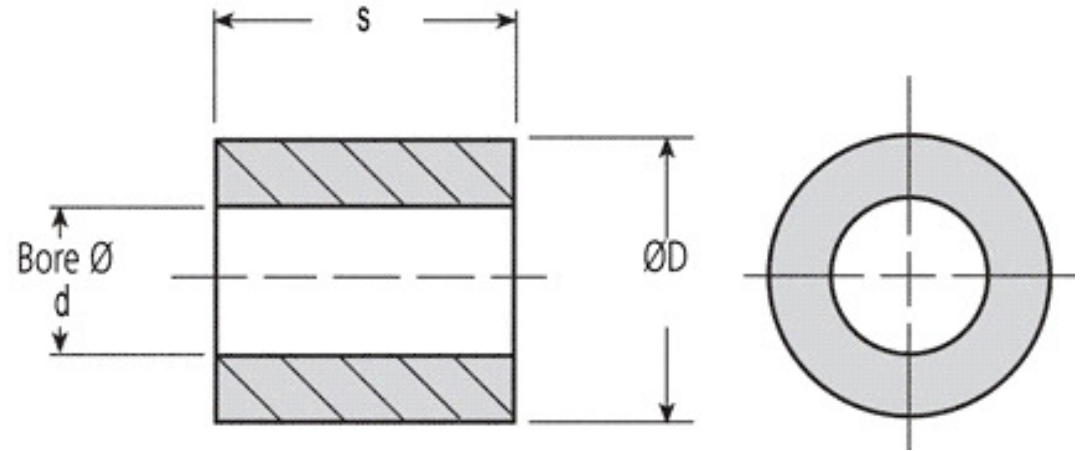

Bushes - Plastic - Iglidur J - Unflanged

Part Number	Nom. ID (d) mm	Nom. OD (D) mm	Length (s) mm	Bore Tolerance mm	Inner Diameter after Press Fit mm	Tolerance of ID after Pressfit mm	Housing Bore (Max. / Min.)
	<i>inches</i>	<i>inches</i>	<i>inches</i>	<i>inches</i>	<i>inches</i>	<i>inches</i>	
# BP00250-00600-0025-J	2.500 <i>0.098</i>	6.000 <i>0.236</i>	2.500 <i>0.098</i>			+0.020/+0.080	
# BP00300-00450-0050-J	3.000 <i>0.118</i>	4.500 <i>0.177</i>	5.000 <i>0.197</i>			+0.020/+0.080	
BP00300-00500-0040-J	3.000 <i>0.118</i>	5.000 <i>0.197</i>	4.000 <i>0.157</i>			+0.020/+0.080	

Indicates item not stocked at time of printing - Please enquire for lead time

E&OE Pricing and all details subject to change without notice - Copyright Miniature Bearings Australia Pty Ltd

MBA Size Listings are a guide to sizes only and must not be solely relied on for critical design information.

Bushes - Plastic - Iglidur J - Unflanged

Part Number	Nom. ID (d) mm	Nom. OD (D) mm	Length (s) mm	Bore Tolerance mm	Inner Diameter after Press Fit mm	Tolerance of ID after Pressfit mm	Housing Bore (Max. / Min.)
	<i>inches</i>	<i>inches</i>	<i>inches</i>	<i>inches</i>	<i>inches</i>	<i>inches</i>	
# BP00300-00800-0040-J	3.000 <i>0.118</i>	8.000 <i>0.315</i>	4.000 <i>0.157</i>			+0.020/+0.080	
# BP00318-00635-0064-J	3.175 <i>0.125</i>	6.350 <i>0.250</i>	6.350 <i>0.250</i>				
# BP00318-00635-0095-J	3.175 <i>0.125</i>	6.350 <i>0.250</i>	9.525 <i>0.375</i>				
# BP00400-00550-0040-J	4.000 <i>0.157</i>	5.500 <i>0.217</i>	4.000 <i>0.157</i>			+0.020/+0.080	
BP00400-00550-0080-J	4.000 <i>0.157</i>	5.500 <i>0.217</i>	8.000 <i>0.315</i>			+0.020/+0.080	
# BP00476-00635-0095-J	4.763 <i>0.188</i>	6.350 <i>0.250</i>	9.525 <i>0.375</i>				
# BP00476-00635-0127-J	4.763 <i>0.188</i>	6.350 <i>0.250</i>	12.700 <i>0.500</i>				
# BP00476-00794-0079-J	4.763 <i>0.188</i>	7.938 <i>0.313</i>	7.938 <i>0.313</i>				
# BP00476-00794-0095-J	4.763 <i>0.188</i>	7.938 <i>0.313</i>	9.525 <i>0.375</i>				
# BP00476-00794-0127-J	4.763 <i>0.188</i>	7.938 <i>0.313</i>	12.700 <i>0.500</i>				

Indicates item not stocked at time of printing - Please enquire for lead time

E&OE Pricing and all details subject to change without notice - Copyright Miniature Bearings Australia Pty Ltd

MBA Size Listings are a guide to sizes only and must not be solely relied on for critical design information.

Bushes - Plastic - Iglidur J - Unflanged

Part Number	Nom. ID (d) mm	Nom. OD (D) mm	Length (s) mm	Bore Tolerance mm	Inner Diameter after Press Fit mm	Tolerance of ID after Pressfit mm	Housing Bore (Max. / Min.)
	<i>inches</i>	<i>inches</i>	<i>inches</i>	<i>inches</i>	<i>inches</i>	<i>inches</i>	
# BP00500-00700-0046-J	5.000 <i>0.197</i>	7.000 <i>0.276</i>	4.600 <i>0.181</i>			+0.020/+0.080	
# BP00500-00700-0050-J	5.000 <i>0.197</i>	7.000 <i>0.276</i>	5.000 <i>0.197</i>			+0.020/+0.080	
# BP00500-00700-0100-J	5.000 <i>0.197</i>	7.000 <i>0.276</i>	10.000 <i>0.394</i>			+0.020/+0.080	
BP00600-00700-0125-J	6.000 <i>0.236</i>	7.000 <i>0.276</i>	12.500 <i>0.492</i>			+0.010/+0.058	
# BP00600-00700-0140-J	6.000 <i>0.236</i>	7.000 <i>0.276</i>	14.000 <i>0.551</i>			+0.010/+0.058	
# BP00600-00800-0043-J	6.000 <i>0.236</i>	8.000 <i>0.315</i>	4.300 <i>0.169</i>			+0.020/+0.080	
# BP00600-00800-0060-J	6.000 <i>0.236</i>	8.000 <i>0.315</i>	6.000 <i>0.236</i>			+0.020/+0.080	
# BP00600-00800-0100-J	6.000 <i>0.236</i>	8.000 <i>0.315</i>	10.000 <i>0.394</i>			+0.020/+0.080	
# BP00600-00900-0060-J	6.000 <i>0.236</i>	9.000 <i>0.354</i>	6.000 <i>0.236</i>			+0.030/+0.105	
# BP00600-01000-0100-J	6.000 <i>0.236</i>	10.000 <i>0.394</i>	10.000 <i>0.394</i>			+0.030/+0.105	

Indicates item not stocked at time of printing - Please enquire for lead time

E&OE Pricing and all details subject to change without notice - Copyright Miniature Bearings Australia Pty Ltd

MBA Size Listings are a guide to sizes only and must not be solely relied on for critical design information.

Bushes - Plastic - Iglidur J - Unflanged

Part Number	Nom. ID (d) mm	Nom. OD (D) mm	Length (s) mm	Bore Tolerance mm	Inner Diameter after Press Fit mm	Tolerance of ID after Pressfit mm	Housing Bore (Max. / Min.)
	<i>inches</i>	<i>inches</i>	<i>inches</i>	<i>inches</i>	<i>inches</i>	<i>inches</i>	
# BP00635-00794-0064-J	6.350 <i>0.250</i>	7.938 <i>0.313</i>	6.350 <i>0.250</i>				
# BP00635-00794-0095-J	6.350 <i>0.250</i>	7.938 <i>0.313</i>	9.525 <i>0.375</i>				
# BP00635-00794-0127-J	6.350 <i>0.250</i>	7.938 <i>0.313</i>	12.700 <i>0.500</i>				
# BP00635-00953-0064-J	6.350 <i>0.250</i>	9.525 <i>0.375</i>	6.350 <i>0.250</i>				
# BP00635-00953-0127-J	6.350 <i>0.250</i>	9.525 <i>0.375</i>	12.700 <i>0.500</i>				
BP00635-00953-0191-J	6.350 <i>0.250</i>	9.525 <i>0.375</i>	19.050 <i>0.750</i>				
# BP00635-00953-0254-J	6.350 <i>0.250</i>	9.525 <i>0.375</i>	25.400 <i>1.000</i>				
# BP00700-00900-0090-J	7.000 <i>0.276</i>	9.000 <i>0.354</i>	9.000 <i>0.354</i>			+0.025/+0.083	
# BP00794-00953-0095-J	7.938 <i>0.313</i>	9.525 <i>0.375</i>	9.525 <i>0.375</i>				
# BP00794-00953-0127-J	7.938 <i>0.313</i>	9.525 <i>0.375</i>	12.700 <i>0.500</i>				

Indicates item not stocked at time of printing - Please enquire for lead time

E&OE Pricing and all details subject to change without notice - Copyright Miniature Bearings Australia Pty Ltd

MBA Size Listings are a guide to sizes only and must not be solely relied on for critical design information.

Bushes - Plastic - Iglidur J - Unflanged

Part Number	Nom. ID (d) mm	Nom. OD (D) mm	Length (s) mm	Bore Tolerance mm	Inner Diameter after Press Fit mm	Tolerance of ID after Pressfit mm	Housing Bore (Max. / Min.)
	<i>inches</i>	<i>inches</i>	<i>inches</i>	<i>inches</i>	<i>inches</i>	<i>inches</i>	
# BP00794-00953-0191-J	7.938 <i>0.313</i>	9.525 <i>0.375</i>	19.050 <i>0.750</i>				
# BP00794-01111-0095-J	7.938 <i>0.313</i>	11.113 <i>0.438</i>	9.525 <i>0.375</i>				
# BP00794-01111-0127-J	7.938 <i>0.313</i>	11.113 <i>0.438</i>	12.700 <i>0.500</i>				
# BP00794-01111-0159-J	7.938 <i>0.313</i>	11.113 <i>0.438</i>	15.875 <i>0.625</i>				
# BP00800-01000-0060-J	8.000 <i>0.315</i>	10.000 <i>0.394</i>	6.000 <i>0.236</i>			+0.025/+0.083	
# BP00800-01000-0080-J	8.000 <i>0.315</i>	10.000 <i>0.394</i>	8.000 <i>0.315</i>			+0.025/+0.083	
# BP00800-01000-0100-J	8.000 <i>0.315</i>	10.000 <i>0.394</i>	10.000 <i>0.394</i>			+0.025/+0.083	
# BP00800-01000-0120-J	8.000 <i>0.315</i>	10.000 <i>0.394</i>	12.000 <i>0.472</i>			+0.025/+0.083	
# BP00800-01000-0160-J	8.000 <i>0.315</i>	10.000 <i>0.394</i>	16.000 <i>0.630</i>			+0.025/+0.083	
# BP00800-01200-0100-J	8.000 <i>0.315</i>	12.000 <i>0.472</i>	10.000 <i>0.394</i>			+0.040/+0.130	

Indicates item not stocked at time of printing - Please enquire for lead time

E&OE Pricing and all details subject to change without notice - Copyright Miniature Bearings Australia Pty Ltd

MBA Size Listings are a guide to sizes only and must not be solely relied on for critical design information.

Bushes - Plastic - Iglidur J - Unflanged

Part Number	Nom. ID (d) mm	Nom. OD (D) mm	Length (s) mm	Bore Tolerance mm	Inner Diameter after Press Fit mm	Tolerance of ID after Pressfit mm	Housing Bore (Max. / Min.)
	<i>inches</i>	<i>inches</i>	<i>inches</i>	<i>inches</i>	<i>inches</i>	<i>inches</i>	
# BP00800-01200-0120-J	8.000 <i>0.315</i>	12.000 <i>0.472</i>	12.000 <i>0.472</i>			+0.040/+0.130	
# BP00953-01111-0095-J	9.525 <i>0.375</i>	11.906 <i>0.469</i>	9.525 <i>0.375</i>				
# BP00953-01270-0048-J	9.525 <i>0.375</i>	12.700 <i>0.500</i>	4.763 <i>0.188</i>				
# BP00953-01270-0095-J	9.525 <i>0.375</i>	12.700 <i>0.500</i>	9.525 <i>0.375</i>				
# BP00953-01270-0127-J	9.525 <i>0.375</i>	12.700 <i>0.500</i>	12.700 <i>0.500</i>				
# BP00953-01270-0159-J	9.525 <i>0.375</i>	12.700 <i>0.500</i>	15.875 <i>0.625</i>				
# BP01000-01200-0050-J	10.000 <i>0.394</i>	12.000 <i>0.472</i>	5.000 <i>0.197</i>			+0.025/+0.083	
# BP01000-01200-0080-J	10.000 <i>0.394</i>	12.000 <i>0.472</i>	8.000 <i>0.315</i>			+0.025/+0.083	
# BP01000-01200-0150-J	10.000 <i>0.394</i>	12.000 <i>0.472</i>	15.000 <i>0.591</i>			+0.025/+0.083	
# BP01000-01200-0200-J	10.000 <i>0.394</i>	12.000 <i>0.472</i>	20.000 <i>0.787</i>			+0.025/+0.083	

Indicates item not stocked at time of printing - Please enquire for lead time

E&OE Pricing and all details subject to change without notice - Copyright Miniature Bearings Australia Pty Ltd

MBA Size Listings are a guide to sizes only and must not be solely relied on for critical design information.

Bushes - Plastic - Iglidur J - Unflanged

Part Number	Nom. ID (d) mm	Nom. OD (D) mm	Length (s) mm	Bore Tolerance mm	Inner Diameter after Press Fit mm	Tolerance of ID after Pressfit mm	Housing Bore (Max. / Min.)
	<i>inches</i>	<i>inches</i>	<i>inches</i>	<i>inches</i>	<i>inches</i>	<i>inches</i>	
BP01000-01400-0100-J	10.000 <i>0.394</i>	14.000 <i>0.551</i>	10.000 <i>0.394</i>			+0.040/+0.130	
# BP01000-01400-0160-J	10.000 <i>0.394</i>	14.000 <i>0.551</i>	16.000 <i>0.630</i>			+0.040/+0.130	
# BP01200-01400-0080-J	12.000 <i>0.472</i>	14.000 <i>0.551</i>	8.000 <i>0.315</i>			+0.032/+0.102	
# BP01200-01400-0090-J	12.000 <i>0.472</i>	14.000 <i>0.551</i>	9.000 <i>0.354</i>			+0.032/+0.102	
# BP01200-01400-0100-J	12.000 <i>0.472</i>	14.000 <i>0.551</i>	10.000 <i>0.394</i>			+0.032/+0.102	
# BP01200-01400-0150-J	12.000 <i>0.472</i>	14.000 <i>0.551</i>	15.000 <i>0.591</i>			+0.032/+0.102	
# BP01200-01600-0120-J	12.000 <i>0.472</i>	16.000 <i>0.630</i>	12.000 <i>0.472</i>			+0.050/+0.160	
# BP01270-01429-0095-J	12.700 <i>0.500</i>	15.081 <i>0.594</i>	9.525 <i>0.375</i>				
# BP01270-01429-0127-J	12.700 <i>0.500</i>	15.081 <i>0.594</i>	12.700 <i>0.500</i>				
# BP01270-01429-0191-J	12.700 <i>0.500</i>	15.081 <i>0.594</i>	19.050 <i>0.750</i>				

Indicates item not stocked at time of printing - Please enquire for lead time

E&OE Pricing and all details subject to change without notice - Copyright Miniature Bearings Australia Pty Ltd

MBA Size Listings are a guide to sizes only and must not be solely relied on for critical design information.

Bushes - Plastic - Iglidur J - Unflanged

Part Number	Nom. ID (d) mm	Nom. OD (D) mm	Length (s) mm	Bore Tolerance mm	Inner Diameter after Press Fit mm	Tolerance of ID after Pressfit mm	Housing Bore (Max. / Min.)
	<i>inches</i>	<i>inches</i>	<i>inches</i>	<i>inches</i>	<i>inches</i>	<i>inches</i>	
# BP01270-01588-0127-J	12.700 <i>0.500</i>	15.875 <i>0.625</i>	12.700 <i>0.500</i>				
# BP01270-01588-0191-J	12.700 <i>0.500</i>	15.875 <i>0.625</i>	19.050 <i>0.750</i>				
# BP01400-01600-0080-J	14.000 <i>0.551</i>	16.000 <i>0.630</i>	8.000 <i>0.315</i>			+0.032/+0.102	
# BP01400-01600-0100-J	14.000 <i>0.551</i>	16.000 <i>0.630</i>	10.000 <i>0.394</i>			+0.032/+0.102	
# BP01400-01600-0150-J	14.000 <i>0.551</i>	16.000 <i>0.630</i>	15.000 <i>0.591</i>			+0.032/+0.102	
# BP01400-01600-0250-J	14.000 <i>0.551</i>	16.000 <i>0.630</i>	25.000 <i>0.984</i>			+0.032/+0.102	
# BP01400-01800-0180-J	14.000 <i>0.551</i>	18.000 <i>0.709</i>	18.000 <i>0.709</i>			+0.032/+0.102	
BP01500-01700-0120-J	15.000 <i>0.591</i>	17.000 <i>0.669</i>	12.000 <i>0.472</i>			+0.032/+0.102	
# BP01500-01700-0200-J	15.000 <i>0.591</i>	17.000 <i>0.669</i>	20.000 <i>0.787</i>			+0.032/+0.102	
# BP01588-01746-0127-J	15.875 <i>0.625</i>	18.256 <i>0.719</i>	12.700 <i>0.500</i>				

Indicates item not stocked at time of printing - Please enquire for lead time

E&OE Pricing and all details subject to change without notice - Copyright Miniature Bearings Australia Pty Ltd

MBA Size Listings are a guide to sizes only and must not be solely relied on for critical design information.

Bushes - Plastic - Iglidur J - Unflanged

Part Number	Nom. ID (d) mm	Nom. OD (D) mm	Length (s) mm	Bore Tolerance mm	Inner Diameter after Press Fit mm	Tolerance of ID after Pressfit mm	Housing Bore (Max. / Min.)
	<i>inches</i>	<i>inches</i>	<i>inches</i>	<i>inches</i>	<i>inches</i>	<i>inches</i>	
# BP01588-01746-0191-J	15.875 <i>0.625</i>	18.256 <i>0.719</i>	19.050 <i>0.750</i>				
# BP01588-01905-0064-J	15.875 <i>0.625</i>	19.050 <i>0.750</i>	6.350 <i>0.250</i>				
# BP01588-01905-0095-J	15.875 <i>0.625</i>	19.050 <i>0.750</i>	9.525 <i>0.375</i>				
# BP01588-01905-0127-J	15.875 <i>0.625</i>	19.050 <i>0.750</i>	12.700 <i>0.500</i>				
# BP01588-01905-0191-J	15.875 <i>0.625</i>	19.050 <i>0.750</i>	19.050 <i>0.750</i>				
# BP01588-01905-0254-J	15.875 <i>0.625</i>	19.050 <i>0.750</i>	25.400 <i>1.000</i>				
# BP01600-01800-0120-J	16.000 <i>0.630</i>	18.000 <i>0.709</i>	12.000 <i>0.472</i>			+0.032/+0.102	
# BP01600-01800-0150-J	16.000 <i>0.630</i>	18.000 <i>0.709</i>	15.000 <i>0.591</i>			+0.032/+0.102	
# BP01600-01800-0200-J	16.000 <i>0.630</i>	18.000 <i>0.709</i>	20.000 <i>0.787</i>			+0.032/+0.102	
# BP01600-02000-0160-J	16.000 <i>0.630</i>	20.000 <i>0.787</i>	16.000 <i>0.630</i>			+0.050/+0.160	

Indicates item not stocked at time of printing - Please enquire for lead time

E&OE Pricing and all details subject to change without notice - Copyright Miniature Bearings Australia Pty Ltd

MBA Size Listings are a guide to sizes only and must not be solely relied on for critical design information.

Bushes - Plastic - Iglidur J - Unflanged

Part Number	Nom. ID (d) mm	Nom. OD (D) mm	Length (s) mm	Bore Tolerance mm	Inner Diameter after Press Fit mm	Tolerance of ID after Pressfit mm	Housing Bore (Max. / Min.)
	<i>inches</i>	<i>inches</i>	<i>inches</i>	<i>inches</i>	<i>inches</i>	<i>inches</i>	
# BP01600-02200-0160-J	16.000 <i>0.630</i>	22.000 <i>0.866</i>	16.000 <i>0.630</i>			+0.050/+0.160	
# BP01600-02200-0200-J	16.000 <i>0.630</i>	22.000 <i>0.866</i>	20.000 <i>0.787</i>			+0.050/+0.160	
# BP01800-02000-0200-J	18.000 <i>0.709</i>	20.000 <i>0.787</i>	20.000 <i>0.787</i>			+0.032/+0.102	
# BP01905-02223-0127-J	19.050 <i>0.750</i>	22.225 <i>0.875</i>	12.700 <i>0.500</i>				
# BP01905-02223-0191-J	19.050 <i>0.750</i>	22.225 <i>0.875</i>	19.050 <i>0.750</i>				
# BP01905-02223-0254-J	19.050 <i>0.750</i>	22.225 <i>0.875</i>	25.400 <i>1.000</i>				
# BP01905-02540-0191-J	19.050 <i>0.750</i>	25.400 <i>1.000</i>	19.050 <i>0.750</i>				
# BP01905-02540-0254-J	19.050 <i>0.750</i>	25.400 <i>1.000</i>	25.400 <i>1.000</i>				
# BP02000-02200-0300-J	20.000 <i>0.787</i>	22.000 <i>0.866</i>	30.000 <i>1.181</i>			+0.040/+0.124	
# BP02000-02300-0200-J	20.000 <i>0.787</i>	23.000 <i>0.906</i>	20.000 <i>0.787</i>			+0.040/+0.124	

Indicates item not stocked at time of printing - Please enquire for lead time

E&OE Pricing and all details subject to change without notice - Copyright Miniature Bearings Australia Pty Ltd

MBA Size Listings are a guide to sizes only and must not be solely relied on for critical design information.

Bushes - Plastic - Iglidur J - Unflanged

Part Number	Nom. ID (d) mm	Nom. OD (D) mm	Length (s) mm	Bore Tolerance mm	Inner Diameter after Press Fit mm	Tolerance of ID after Pressfit mm	Housing Bore (Max. / Min.)
	<i>inches</i>	<i>inches</i>	<i>inches</i>	<i>inches</i>	<i>inches</i>	<i>inches</i>	
# BP02000-02600-0060-J	20.000 <i>0.787</i>	26.000 <i>1.024</i>	6.000 <i>0.236</i>			+0.065/+0.195	
# BP02000-02600-0200-J	20.000 <i>0.787</i>	26.000 <i>1.024</i>	20.000 <i>0.787</i>			+0.065/+0.195	
# BP02000-02600-0250-J	20.000 <i>0.787</i>	26.000 <i>1.024</i>	25.000 <i>0.984</i>			+0.065/+0.195	
# BP02000-02600-0300-J	20.000 <i>0.787</i>	26.000 <i>1.024</i>	30.000 <i>1.181</i>			+0.065/+0.195	
# BP02223-02540-0191-J	22.225 <i>0.875</i>	25.400 <i>1.000</i>	19.050 <i>0.750</i>				
# BP02223-02858-0191-J	22.225 <i>0.875</i>	28.575 <i>1.125</i>	19.050 <i>0.750</i>				
# BP02223-02858-0381-J	22.225 <i>0.875</i>	28.575 <i>1.125</i>	38.100 <i>1.500</i>				
# BP02400-02700-0250-J	24.000 <i>0.945</i>	27.000 <i>1.063</i>	25.000 <i>0.984</i>			+0.040/+0.124	
# BP02500-02800-0120-J	25.000 <i>0.984</i>	28.000 <i>1.102</i>	12.000 <i>0.472</i>			+0.040/+0.124	
# BP02500-02800-0200-J	25.000 <i>0.984</i>	28.000 <i>1.102</i>	20.000 <i>0.787</i>			+0.040/+0.124	

Indicates item not stocked at time of printing - Please enquire for lead time

E&OE Pricing and all details subject to change without notice - Copyright Miniature Bearings Australia Pty Ltd

MBA Size Listings are a guide to sizes only and must not be solely relied on for critical design information.

Bushes - Plastic - Iglidur J - Unflanged

Part Number	Nom. ID (d) mm	Nom. OD (D) mm	Length (s) mm	Bore Tolerance mm	Inner Diameter after Press Fit mm	Tolerance of ID after Pressfit mm	Housing Bore (Max. / Min.)
	<i>inches</i>	<i>inches</i>	<i>inches</i>	<i>inches</i>	<i>inches</i>	<i>inches</i>	
# BP02500-02800-0300-J	25.000 <i>0.984</i>	28.000 <i>1.102</i>	30.000 <i>1.181</i>			+0.040/+0.124	
# BP02500-03200-0250-J	25.000 <i>0.984</i>	32.000 <i>1.260</i>	25.000 <i>0.984</i>			+0.065/+0.195	
# BP02500-03200-0350-J	25.000 <i>0.984</i>	32.000 <i>1.260</i>	35.000 <i>1.378</i>			+0.065/+0.195	
# BP02540-03175-0254-J	25.400 <i>1.000</i>	31.750 <i>1.250</i>	25.400 <i>1.000</i>				
# BP02540-03175-0381-J	25.400 <i>1.000</i>	31.750 <i>1.250</i>	38.100 <i>1.500</i>				
# BP02858-03493-0254-J	28.575 <i>1.125</i>	34.925 <i>1.375</i>	25.400 <i>1.000</i>				
# BP03000-03400-0250-J	30.000 <i>1.181</i>	34.000 <i>1.339</i>	25.000 <i>0.984</i>			+0.050/+0.150	
# BP03000-03400-0300-J	30.000 <i>1.181</i>	34.000 <i>1.339</i>	30.000 <i>1.181</i>			+0.050/+0.150	
# BP03175-03493-0222-J	31.750 <i>1.250</i>	34.925 <i>1.375</i>	22.225 <i>0.875</i>				
# BP03175-03810-0381-J	31.750 <i>1.250</i>	38.100 <i>1.500</i>	38.100 <i>1.500</i>				

Indicates item not stocked at time of printing - Please enquire for lead time

E&OE Pricing and all details subject to change without notice - Copyright Miniature Bearings Australia Pty Ltd

MBA Size Listings are a guide to sizes only and must not be solely relied on for critical design information.

Bushes - Plastic - Iglidur J - Unflanged

Part Number	Nom. ID (d) mm	Nom. OD (D) mm	Length (s) mm	Bore Tolerance mm	Inner Diameter after Press Fit mm	Tolerance of ID after Pressfit mm	Housing Bore (Max. / Min.)
	<i>inches</i>	<i>inches</i>	<i>inches</i>	<i>inches</i>	<i>inches</i>	<i>inches</i>	
# BP03200-03600-0300-J	32.000 <i>1.260</i>	36.000 <i>1.417</i>	30.000 <i>1.181</i>			+0.050/+0.150	
# BP03500-03900-0200-J	35.000 <i>1.378</i>	39.000 <i>1.535</i>	20.000 <i>0.787</i>			+0.050/+0.150	
# BP03500-03900-0300-J	35.000 <i>1.378</i>	39.000 <i>1.535</i>	30.000 <i>1.181</i>			+0.050/+0.150	
# BP03810-04445-0381-J	38.100 <i>1.500</i>	44.450 <i>1.750</i>	38.100 <i>1.500</i>				
# BP04000-04400-0350-J	40.000 <i>1.575</i>	44.000 <i>1.732</i>	35.000 <i>1.378</i>			+0.050/+0.150	
# BP04000-04400-0400-J	40.000 <i>1.575</i>	44.000 <i>1.732</i>	40.000 <i>1.575</i>			+0.050/+0.150	
# BP05000-05500-0300-J	50.000 <i>1.969</i>	55.000 <i>2.165</i>	30.000 <i>1.181</i>			+0.050/+0.150	
# BP05000-05500-0500-J	50.000 <i>1.969</i>	55.000 <i>2.165</i>	50.000 <i>1.969</i>			+0.050/+0.150	
# BP05500-06000-0600-J	55.000 <i>2.165</i>	60.000 <i>2.362</i>	60.000 <i>2.362</i>			+0.060/+0.180	
# BP06000-06500-0600-J	60.000 <i>2.362</i>	65.000 <i>2.559</i>	60.000 <i>2.362</i>			+0.060/+0.180	

Indicates item not stocked at time of printing - Please enquire for lead time

E&OE Pricing and all details subject to change without notice - Copyright Miniature Bearings Australia Pty Ltd

MBA Size Listings are a guide to sizes only and must not be solely relied on for critical design information.

Bushes - Plastic - Iglidur J - Unflanged

Part Number	Nom. ID (d) mm	Nom. OD (D) mm	Length (s) mm	Bore Tolerance mm	Inner Diameter after Press Fit mm	Tolerance of ID after Pressfit mm	Housing Bore (Max. / Min.)
	<i>inches</i>	<i>inches</i>	<i>inches</i>	<i>inches</i>	<i>inches</i>	<i>inches</i>	
# BP07500-08000-0600-J	75.000 <i>2.953</i>	80.000 <i>3.150</i>	60.000 <i>2.362</i>			+0.060/+0.180	

Indicates item not stocked at time of printing - Please enquire for lead time

E&OE Pricing and all details subject to change without notice - Copyright Miniature Bearings Australia Pty Ltd

MBA Size Listings are a guide to sizes only and must not be solely relied on for critical design information.



DISTRIBUTED BY

Ask us to put your name and address here

<http://www.minibearings.com.au/product>

Ph +61 7 3245 7977

Fax +61 7 3245 1017

Catalogue requests to catalogues@minibearings.com.au

