



MBA

Bushes - Plastic - Iglidur M250 - Unflanged

For impact resistance vibration dampening unclean environments.

Specific Gravity 1.14 g/cm³.

Operating Temp 170 C short term / 80 C long term.

Tensile Strength at 20 deg C = 112 Mpa.

Hardness 79 Shore D (DIN53505).

Tolerances listed are after H7 Pressfit.

This catalogue to be read in conjunction with information at http://www.minibearings.com.au/ogue/tech/materials/iglidur_m250.pdf

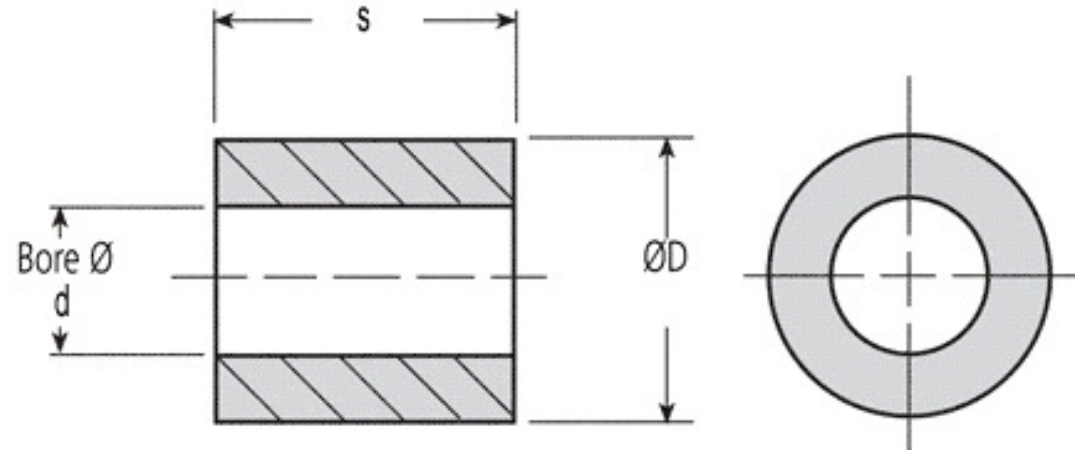

Bushes - Plastic - Iglidur M250 - Unflanged

Part Number	Nom. ID (d) mm	Nom. OD (D) mm	Length (s) mm	Bore Tolerance	Inner Diameter after Press Fit	Tolerance of ID after Pressfit	Housing Bore (Max. / Min.)
	<i>inches</i>	<i>inches</i>	<i>inches</i>				
# BP00100-00200-0020-M2	1.000 <i>0.039</i>	2.000 <i>0.079</i>	2.000 <i>0.079</i>			+0.020/+0.080	
# BP00150-00400-0020-M2	1.500 <i>0.059</i>	4.000 <i>0.157</i>	2.000 <i>0.079</i>			+0.020/+0.080	

Indicates item not stocked at time of printing - Please enquire for lead time

E&OE Pricing and all details subject to change without notice - Copyright Miniature Bearings Australia Pty Ltd

MBA Size Listings are a guide to sizes only and must not be solely relied on for critical design information.

Bushes - Plastic - Iglidur M250 - Unflanged

Part Number	Nom. ID (d) mm	Nom. OD (D) mm	Length (s) mm	Bore Tolerance	Inner Diameter after Press Fit	Tolerance of ID after Pressfit	Housing Bore (Max. / Min.)
	<i>inches</i>	<i>inches</i>	<i>inches</i>				
# BP00200-00500-0010-M2	2.000 <i>0.079</i>	5.000 <i>0.197</i>	1.000 <i>0.039</i>			+0.020/+0.080	
# BP00200-00500-0020-M2	2.000 <i>0.079</i>	5.000 <i>0.197</i>	2.000 <i>0.079</i>			+0.020/+0.080	
BP00200-00500-0030-M2	2.000 <i>0.079</i>	5.000 <i>0.197</i>	3.000 <i>0.118</i>			+0.020/+0.080 After H7 Pressfit	
# BP00250-00600-0030-M2	2.500 <i>0.098</i>	6.000 <i>0.236</i>	3.000 <i>0.118</i>			+0.020/+0.080	
# BP00300-00500-0030-M2	3.000 <i>0.118</i>	5.000 <i>0.197</i>	3.000 <i>0.118</i>			+0.020/+0.080	
# BP00300-00500-0040-M2	3.000 <i>0.118</i>	5.000 <i>0.197</i>	4.000 <i>0.157</i>			+0.020/+0.080	
# BP00300-00600-0030-M2	3.000 <i>0.118</i>	6.000 <i>0.236</i>	3.000 <i>0.118</i>			+0.020/+0.080	
# BP00300-00600-0040-M2	3.000 <i>0.118</i>	6.000 <i>0.236</i>	4.000 <i>0.157</i>	+ 0.020 / + 0.080	3.080 / 3.020		6.012 / 6.000
# BP00318-00476-0032-M2	3.175 <i>0.125</i>	4.763 <i>0.188</i>	3.175 <i>0.125</i>				
# BP00318-00476-0064-M2	3.175 <i>0.125</i>	4.763 <i>0.188</i>	6.350 <i>0.250</i>				

Indicates item not stocked at time of printing - Please enquire for lead time

E&OE Pricing and all details subject to change without notice - Copyright Miniature Bearings Australia Pty Ltd

MBA Size Listings are a guide to sizes only and must not be solely relied on for critical design information.

Bushes - Plastic - Iglidur M250 - Unflanged

Part Number	Nom. ID (d) mm <i>inches</i>	Nom. OD (D) mm <i>inches</i>	Length (s) mm <i>inches</i>	Bore Tolerance	Inner Diameter after Press Fit	Tolerance of ID after Pressfit	Housing Bore (Max. / Min.)
# BP00318-00635-0032-M2	3.175 <i>0.125</i>	6.350 <i>0.250</i>	3.175 <i>0.125</i>				
# BP00318-00635-0048-M2	3.175 <i>0.125</i>	6.350 <i>0.250</i>	4.763 <i>0.188</i>				
# BP00318-00635-0064-M2	3.175 <i>0.125</i>	6.350 <i>0.250</i>	6.350 <i>0.250</i>				
# BP00318-00635-0095-M2	3.175 <i>0.125</i>	6.350 <i>0.250</i>	9.525 <i>0.375</i>				
# BP00400-00700-0030-M2	4.000 <i>0.157</i>	7.000 <i>0.276</i>	3.000 <i>0.118</i>			+0.030/+0.105	
# BP00400-00700-0040-M2	4.000 <i>0.157</i>	7.000 <i>0.276</i>	4.000 <i>0.157</i>			+0.030/+0.105	
# BP00400-00700-0060-M2	4.000 <i>0.157</i>	7.000 <i>0.276</i>	6.000 <i>0.236</i>			+0.030/+0.105	
# BP00400-00800-0040-M2	4.000 <i>0.157</i>	8.000 <i>0.315</i>	4.000 <i>0.157</i>			+0.030/+0.105	
BP00400-00800-0060-M2	4.000 <i>0.157</i>	8.000 <i>0.315</i>	6.000 <i>0.236</i>	+ 0.030 / + 0.105	4.105 / 4.030		8.015 / 8.000
# BP00476-00635-0064-M2	4.763 <i>0.188</i>	6.350 <i>0.250</i>	6.350 <i>0.250</i>				

Indicates item not stocked at time of printing - Please enquire for lead time

E&OE Pricing and all details subject to change without notice - Copyright Miniature Bearings Australia Pty Ltd

MBA Size Listings are a guide to sizes only and must not be solely relied on for critical design information.

Bushes - Plastic - Iglidur M250 - Unflanged

Part Number	Nom. ID (d) mm <i>inches</i>	Nom. OD (D) mm <i>inches</i>	Length (s) mm <i>inches</i>	Bore Tolerance	Inner Diameter after Press Fit	Tolerance of ID after Pressfit	Housing Bore (Max. / Min.)
# BP00476-00635-0095-M2	4.763 <i>0.188</i>	6.350 <i>0.250</i>	9.525 <i>0.375</i>				
# BP00476-00635-0127-M2	4.763 <i>0.188</i>	6.350 <i>0.250</i>	12.700 <i>0.500</i>				
# BP00476-00794-0032-M2	4.763 <i>0.188</i>	7.938 <i>0.313</i>	3.175 <i>0.125</i>				
# BP00476-00794-0048-M2	4.763 <i>0.188</i>	7.938 <i>0.313</i>	4.763 <i>0.188</i>				
# BP00476-00794-0064-M2	4.763 <i>0.188</i>	7.938 <i>0.313</i>	6.350 <i>0.250</i>				
# BP00476-00794-0079-M2	4.763 <i>0.188</i>	7.938 <i>0.313</i>	7.938 <i>0.313</i>				
# BP00476-00794-0095-M2	4.763 <i>0.188</i>	7.938 <i>0.313</i>	9.525 <i>0.375</i>				
# BP00476-00794-0127-M2	4.763 <i>0.188</i>	7.938 <i>0.313</i>	12.700 <i>0.500</i>				
# BP00500-00800-0040-M2	5.000 <i>0.197</i>	8.000 <i>0.315</i>	4.000 <i>0.157</i>			+0.030/+0.105	
# BP00500-00800-0050-M2	5.000 <i>0.197</i>	8.000 <i>0.315</i>	5.000 <i>0.197</i>			+0.030/+0.105	

Indicates item not stocked at time of printing - Please enquire for lead time

E&OE Pricing and all details subject to change without notice - Copyright Miniature Bearings Australia Pty Ltd

MBA Size Listings are a guide to sizes only and must not be solely relied on for critical design information.

Bushes - Plastic - Iglidur M250 - Unflanged

Part Number	Nom. ID (d) mm <i>inches</i>	Nom. OD (D) mm <i>inches</i>	Length (s) mm <i>inches</i>	Bore Tolerance	Inner Diameter after Press Fit	Tolerance of ID after Pressfit	Housing Bore (Max. / Min.)
# BP00500-00800-0080-M2	5.000 <i>0.197</i>	8.000 <i>0.315</i>	8.000 <i>0.315</i>			+0.030/+0.105	
# BP00500-00900-0050-M2	5.000 <i>0.197</i>	9.000 <i>0.354</i>	5.000 <i>0.197</i>			+0.030/+0.105	
# BP00500-00900-0080-M2	5.000 <i>0.197</i>	9.000 <i>0.354</i>	8.000 <i>0.315</i>	+ 0.030 / + 0.105	5.105 / 5.030		9.015 / 9.000
# BP00600-00800-0100-M2	6.000 <i>0.236</i>	8.000 <i>0.315</i>	10.000 <i>0.394</i>			+0.030/+0.105	
# BP00600-00900-0060-M2	6.000 <i>0.236</i>	9.000 <i>0.354</i>	6.000 <i>0.236</i>			+0.030/+0.105	
# BP00600-01000-0020-M2	6.000 <i>0.236</i>	10.000 <i>0.394</i>	2.000 <i>0.079</i>			+0.030/+0.105	
BP00600-01000-0040-M2	6.000 <i>0.236</i>	10.000 <i>0.394</i>	4.000 <i>0.157</i>			+0.030/+0.105	
# BP00600-01000-0060-M2	6.000 <i>0.236</i>	10.000 <i>0.394</i>	6.000 <i>0.236</i>			+0.030/+0.105	
# BP00600-01000-0080-M2	6.000 <i>0.236</i>	10.000 <i>0.394</i>	8.000 <i>0.315</i>	+ 0.030 / + 0.105	6.105 / 6.030		10.015 / 10.000
# BP00600-01000-0100-M2	6.000 <i>0.236</i>	10.000 <i>0.394</i>	10.000 <i>0.394</i>			+0.030/+0.105	

Indicates item not stocked at time of printing - Please enquire for lead time

E&OE Pricing and all details subject to change without notice - Copyright Miniature Bearings Australia Pty Ltd

MBA Size Listings are a guide to sizes only and must not be solely relied on for critical design information.

Bushes - Plastic - Iglidur M250 - Unflanged

Part Number	Nom. ID (d) mm	Nom. OD (D) mm	Length (s) mm	Bore Tolerance	Inner Diameter after Press Fit	Tolerance of ID after Pressfit	Housing Bore (Max. / Min.)
	<i>inches</i>	<i>inches</i>	<i>inches</i>				
# BP00600-01100-0040-M2	6.000 <i>0.236</i>	11.000 <i>0.433</i>	4.000 <i>0.157</i>			+0.030/+0.105	
# BP00600-01200-0060-M2	6.000 <i>0.236</i>	12.000 <i>0.472</i>	6.000 <i>0.236</i>			+0.030/+0.105	
# BP00600-01200-0100-M2	6.000 <i>0.236</i>	12.000 <i>0.472</i>	10.000 <i>0.394</i>			+0.030/+0.105	
# BP00635-00794-0048-M2	6.350 <i>0.250</i>	7.938 <i>0.313</i>	4.763 <i>0.188</i>				
# BP00635-00794-0095-M2	6.350 <i>0.250</i>	7.938 <i>0.313</i>	9.525 <i>0.375</i>				
# BP00635-00794-0127-M2	6.350 <i>0.250</i>	7.938 <i>0.313</i>	12.700 <i>0.500</i>				
# BP00635-00953-0032-M2	6.350 <i>0.250</i>	9.525 <i>0.375</i>	3.175 <i>0.125</i>				
# BP00635-00953-0048-M2	6.350 <i>0.250</i>	9.525 <i>0.375</i>	4.763 <i>0.188</i>				
# BP00635-00953-0064-M2	6.350 <i>0.250</i>	9.525 <i>0.375</i>	6.350 <i>0.250</i>				
# BP00635-00953-0079-M2	6.350 <i>0.250</i>	9.525 <i>0.375</i>	7.938 <i>0.313</i>				

Indicates item not stocked at time of printing - Please enquire for lead time

E&OE Pricing and all details subject to change without notice - Copyright Miniature Bearings Australia Pty Ltd

MBA Size Listings are a guide to sizes only and must not be solely relied on for critical design information.

Bushes - Plastic - Iglidur M250 - Unflanged

Part Number	Nom. ID (d) mm	Nom. OD (D) mm	Length (s) mm	Bore Tolerance	Inner Diameter after Press Fit	Tolerance of ID after Pressfit	Housing Bore (Max. / Min.)
	<i>inches</i>	<i>inches</i>	<i>inches</i>				
# BP00635-00953-0095-M2	6.350 <i>0.250</i>	9.525 <i>0.375</i>	9.525 <i>0.375</i>				
# BP00635-00953-0127-M2	6.350 <i>0.250</i>	9.525 <i>0.375</i>	12.700 <i>0.500</i>				
# BP00635-00953-0159-M2	6.350 <i>0.250</i>	9.525 <i>0.375</i>	15.875 <i>0.625</i>				
BP00635-00953-0191-M2	6.350 <i>0.250</i>	9.525 <i>0.375</i>	19.050 <i>0.750</i>				
# BP00700-01000-0050-M2	7.000 <i>0.276</i>	10.000 <i>0.394</i>	5.000 <i>0.197</i>			+0.040/+0.130	
# BP00700-01000-0080-M2	7.000 <i>0.276</i>	10.000 <i>0.394</i>	8.000 <i>0.315</i>			+0.040/+0.130	
# BP00700-01000-0100-M2	7.000 <i>0.276</i>	10.000 <i>0.394</i>	10.000 <i>0.394</i>			+0.040/+0.130	
# BP00700-01000-0160-M2	7.000 <i>0.276</i>	10.000 <i>0.394</i>	16.000 <i>0.630</i>			+0.040/+0.130	
# BP00794-00953-0064-M2	7.938 <i>0.313</i>	9.525 <i>0.375</i>	6.350 <i>0.250</i>				
# BP00794-00953-0095-M2	7.938 <i>0.313</i>	9.525 <i>0.375</i>	9.525 <i>0.375</i>				

Indicates item not stocked at time of printing - Please enquire for lead time

E&OE Pricing and all details subject to change without notice - Copyright Miniature Bearings Australia Pty Ltd

MBA Size Listings are a guide to sizes only and must not be solely relied on for critical design information.

Bushes - Plastic - Iglidur M250 - Unflanged

Part Number	Nom. ID (d) mm <i>inches</i>	Nom. OD (D) mm <i>inches</i>	Length (s) mm <i>inches</i>	Bore Tolerance	Inner Diameter after Press Fit	Tolerance of ID after Pressfit	Housing Bore (Max. / Min.)
# BP00794-00953-0127-M2	7.938 <i>0.313</i>	9.525 <i>0.375</i>	12.700 <i>0.500</i>				
# BP00794-01111-0048-M2	7.938 <i>0.313</i>	11.113 <i>0.438</i>	4.763 <i>0.188</i>				
# BP00794-01111-0064-M2	7.938 <i>0.313</i>	11.113 <i>0.438</i>	6.350 <i>0.250</i>				
# BP00794-01111-0079-M2	7.938 <i>0.313</i>	11.113 <i>0.438</i>	7.938 <i>0.313</i>				
# BP00794-01111-0095-M2	7.938 <i>0.313</i>	11.113 <i>0.438</i>	9.525 <i>0.375</i>				
# BP00794-01111-0127-M2	7.938 <i>0.313</i>	11.113 <i>0.438</i>	12.700 <i>0.500</i>				
# BP00794-01111-0159-M2	7.938 <i>0.313</i>	11.113 <i>0.438</i>	15.875 <i>0.625</i>				
# BP00794-01111-0191-M2	7.938 <i>0.313</i>	11.113 <i>0.438</i>	19.050 <i>0.750</i>				
# BP00800-01000-0060-M2	8.000 <i>0.315</i>	10.000 <i>0.394</i>	6.000 <i>0.236</i>			+0.040/+0.130	
# BP00800-01000-0080-M2	8.000 <i>0.315</i>	10.000 <i>0.394</i>	8.000 <i>0.315</i>			+0.040/+0.130	

Indicates item not stocked at time of printing - Please enquire for lead time

E&OE Pricing and all details subject to change without notice - Copyright Miniature Bearings Australia Pty Ltd

MBA Size Listings are a guide to sizes only and must not be solely relied on for critical design information.

Bushes - Plastic - Iglidur M250 - Unflanged

Part Number	Nom. ID (d) mm	Nom. OD (D) mm	Length (s) mm	Bore Tolerance	Inner Diameter after Press Fit	Tolerance of ID after Pressfit	Housing Bore (Max. / Min.)
	<i>inches</i>	<i>inches</i>	<i>inches</i>				
# BP00800-01000-0100-M2	8.000 <i>0.315</i>	10.000 <i>0.394</i>	10.000 <i>0.394</i>			+0.040/+0.130	
# BP00800-01100-0060-M2	8.000 <i>0.315</i>	11.000 <i>0.433</i>	6.000 <i>0.236</i>			+0.040/+0.130	
# BP00800-01100-0080-M2	8.000 <i>0.315</i>	11.000 <i>0.433</i>	8.000 <i>0.315</i>			+0.040/+0.130	
# BP00800-01100-0120-M2	8.000 <i>0.315</i>	11.000 <i>0.433</i>	12.000 <i>0.472</i>			+0.040/+0.130	
# BP00800-01200-0060-M2	8.000 <i>0.315</i>	12.000 <i>0.472</i>	6.000 <i>0.236</i>			+0.040/+0.130	
# BP00800-01200-0080-M2	8.000 <i>0.315</i>	12.000 <i>0.472</i>	8.000 <i>0.315</i>			+0.040/+0.130	
# BP00800-01200-0100-M2	8.000 <i>0.315</i>	12.000 <i>0.472</i>	10.000 <i>0.394</i>			+0.040/+0.130	
# BP00800-01200-0120-M2	8.000 <i>0.315</i>	12.000 <i>0.472</i>	12.000 <i>0.472</i>	+ 0.040 / + 0.130	8.130 / 8.040		10.015 / 10.000
# BP00800-01400-0060-M2	8.000 <i>0.315</i>	14.000 <i>0.551</i>	6.000 <i>0.236</i>			+0.040/+0.130	
# BP00800-01400-0100-M2	8.000 <i>0.315</i>	14.000 <i>0.551</i>	10.000 <i>0.394</i>			+0.040/+0.130	

Indicates item not stocked at time of printing - Please enquire for lead time

E&OE Pricing and all details subject to change without notice - Copyright Miniature Bearings Australia Pty Ltd

MBA Size Listings are a guide to sizes only and must not be solely relied on for critical design information.

Bushes - Plastic - Iglidur M250 - Unflanged

Part Number	Nom. ID (d) mm	Nom. OD (D) mm	Length (s) mm	Bore Tolerance	Inner Diameter after Press Fit	Tolerance of ID after Pressfit	Housing Bore (Max. / Min.)
	<i>inches</i>	<i>inches</i>	<i>inches</i>				
# BP00900-01200-0140-M2	9.000 <i>0.354</i>	12.000 <i>0.472</i>	14.000 <i>0.551</i>			+0.040/+0.130	
# BP00953-01111-0064-M2	9.525 <i>0.375</i>	11.113 <i>0.438</i>	6.350 <i>0.250</i>				
# BP00953-01111-0095-M2	9.525 <i>0.375</i>	11.113 <i>0.438</i>	9.525 <i>0.375</i>				
# BP00953-01111-0127-M2	9.525 <i>0.375</i>	11.113 <i>0.438</i>	12.700 <i>0.500</i>				
# BP00953-01270-0064-M2	9.525 <i>0.375</i>	12.700 <i>0.500</i>	6.350 <i>0.250</i>				
# BP00953-01270-0079-M2	9.525 <i>0.375</i>	12.700 <i>0.500</i>	7.938 <i>0.313</i>				
# BP00953-01270-0095-M2	9.525 <i>0.375</i>	12.700 <i>0.500</i>	9.525 <i>0.375</i>				
# BP00953-01270-0127-M2	9.525 <i>0.375</i>	12.700 <i>0.500</i>	12.700 <i>0.500</i>				
# BP00953-01270-0159-M2	9.525 <i>0.375</i>	12.700 <i>0.500</i>	15.875 <i>0.625</i>				
# BP00953-01270-0191-M2	9.525 <i>0.375</i>	12.700 <i>0.500</i>	19.050 <i>0.750</i>				

Indicates item not stocked at time of printing - Please enquire for lead time

E&OE Pricing and all details subject to change without notice - Copyright Miniature Bearings Australia Pty Ltd

MBA Size Listings are a guide to sizes only and must not be solely relied on for critical design information.

Bushes - Plastic - Iglidur M250 - Unflanged

Part Number	Nom. ID (d) mm <i>inches</i>	Nom. OD (D) mm <i>inches</i>	Length (s) mm <i>inches</i>	Bore Tolerance	Inner Diameter after Press Fit	Tolerance of ID after Pressfit	Housing Bore (Max. / Min.)
# BP00953-01270-0254-M2	9.525 <i>0.375</i>	12.700 <i>0.500</i>	25.400 <i>1.000</i>				
# BP01000-01400-0060-M2	10.000 <i>0.394</i>	14.000 <i>0.551</i>	6.000 <i>0.236</i>			+0.040/+0.130	
# BP01000-01400-0080-M2	10.000 <i>0.394</i>	14.000 <i>0.551</i>	8.000 <i>0.315</i>			+0.040/+0.130	
# BP01000-01400-0100-M2	10.000 <i>0.394</i>	14.000 <i>0.551</i>	10.000 <i>0.394</i>			+0.040/+0.130	
# BP01000-01400-0160-M2	10.000 <i>0.394</i>	14.000 <i>0.551</i>	16.000 <i>0.630</i>			+0.040/+0.130	
# BP01000-01600-0060-M2	10.000 <i>0.394</i>	16.000 <i>0.630</i>	6.000 <i>0.236</i>			+0.040/+0.130	
# BP01000-01600-0080-M2	10.000 <i>0.394</i>	16.000 <i>0.630</i>	8.000 <i>0.315</i>			+0.040/+0.130	
# BP01000-01600-0100-M2	10.000 <i>0.394</i>	16.000 <i>0.630</i>	10.000 <i>0.394</i>			+0.040/+0.130	
# BP01000-01600-0160-M2	10.000 <i>0.394</i>	16.000 <i>0.630</i>	16.000 <i>0.630</i>	+ 0.040 / + 0.130	10.130 / 10.040		16.018 / 16.000
# BP01000-01600-0500-M2	10.000 <i>0.394</i>	16.000 <i>0.630</i>	50.000 <i>1.969</i>			+0.040/+0.130	

Indicates item not stocked at time of printing - Please enquire for lead time

E&OE Pricing and all details subject to change without notice - Copyright Miniature Bearings Australia Pty Ltd

MBA Size Listings are a guide to sizes only and must not be solely relied on for critical design information.

Bushes - Plastic - Iglidur M250 - Unflanged

Part Number	Nom. ID (d) mm <i>inches</i>	Nom. OD (D) mm <i>inches</i>	Length (s) mm <i>inches</i>	Bore Tolerance	Inner Diameter after Press Fit	Tolerance of ID after Pressfit	Housing Bore (Max. / Min.)
# BP01111-01429-0095-M2	11.113 <i>0.438</i>	14.288 <i>0.563</i>	9.525 <i>0.375</i>				
# BP01111-01429-0127-M2	11.113 <i>0.438</i>	14.288 <i>0.563</i>	12.700 <i>0.500</i>				
# BP01200-01400-0150-M2	12.000 <i>0.472</i>	14.000 <i>0.551</i>	15.000 <i>0.591</i>			+0.050/+0.160	
# BP01200-01400-0200-M2	12.000 <i>0.472</i>	14.000 <i>0.551</i>	20.000 <i>0.787</i>			+0.050/+0.160	
# BP01200-01600-0150-M2	12.000 <i>0.472</i>	16.000 <i>0.630</i>	15.000 <i>0.591</i>			+0.050/+0.160	
# BP01200-01600-0200-M2	12.000 <i>0.472</i>	16.000 <i>0.630</i>	20.000 <i>0.787</i>			+0.050/+0.160	
# BP01200-01800-0080-M2	12.000 <i>0.472</i>	18.000 <i>0.709</i>	8.000 <i>0.315</i>			+0.050/+0.160	
# BP01200-01800-0100-M2	12.000 <i>0.472</i>	18.000 <i>0.709</i>	10.000 <i>0.394</i>			+0.050/+0.160	
# BP01200-01800-0150-M2	12.000 <i>0.472</i>	18.000 <i>0.709</i>	15.000 <i>0.591</i>	+ 0.050 / + 0.160	12.160 / 12.050		18.018 / 18.000
# BP01200-01800-0200-M2	12.000 <i>0.472</i>	18.000 <i>0.709</i>	20.000 <i>0.787</i>			+0.050/+0.160	

Indicates item not stocked at time of printing - Please enquire for lead time

E&OE Pricing and all details subject to change without notice - Copyright Miniature Bearings Australia Pty Ltd

MBA Size Listings are a guide to sizes only and must not be solely relied on for critical design information.

Bushes - Plastic - Iglidur M250 - Unflanged

Part Number	Nom. ID (d) mm	Nom. OD (D) mm	Length (s) mm	Bore Tolerance	Inner Diameter after Press Fit	Tolerance of ID after Pressfit	Housing Bore (Max. / Min.)
	<i>inches</i>	<i>inches</i>	<i>inches</i>				
# BP01270-01588-0064-M2	12.700 <i>0.500</i>	15.875 <i>0.625</i>	6.350 <i>0.250</i>				
# BP01270-01588-0079-M2	12.700 <i>0.500</i>	15.875 <i>0.625</i>	7.938 <i>0.313</i>				
# BP01270-01588-0095-M2	12.700 <i>0.500</i>	15.875 <i>0.625</i>	9.525 <i>0.375</i>				
# BP01270-01588-0127-M2	12.700 <i>0.500</i>	15.875 <i>0.625</i>	12.700 <i>0.500</i>				
# BP01270-01588-0159-M2	12.700 <i>0.500</i>	15.875 <i>0.625</i>	15.875 <i>0.625</i>				
# BP01270-01588-0191-M2	12.700 <i>0.500</i>	15.875 <i>0.625</i>	19.050 <i>0.750</i>				
# BP01270-01588-0254-M2	12.700 <i>0.500</i>	15.875 <i>0.625</i>	25.400 <i>1.000</i>				
# BP01400-01600-0085-M2	14.000 <i>0.551</i>	16.000 <i>0.630</i>	8.500 <i>0.335</i>			+0.050/+0.160	
# BP01400-01600-0100-M2	14.000 <i>0.551</i>	16.000 <i>0.630</i>	10.000 <i>0.394</i>			+0.050/+0.160	
# BP01400-01600-0150-M2	14.000 <i>0.551</i>	16.000 <i>0.630</i>	15.000 <i>0.591</i>			+0.050/+0.160	

Indicates item not stocked at time of printing - Please enquire for lead time

E&OE Pricing and all details subject to change without notice - Copyright Miniature Bearings Australia Pty Ltd

MBA Size Listings are a guide to sizes only and must not be solely relied on for critical design information.

Bushes - Plastic - Iglidur M250 - Unflanged

Part Number	Nom. ID (d) mm	Nom. OD (D) mm	Length (s) mm	Bore Tolerance	Inner Diameter after Press Fit	Tolerance of ID after Pressfit	Housing Bore (Max. / Min.)
	<i>inches</i>	<i>inches</i>	<i>inches</i>				
# BP01400-01600-0200-M2	14.000 <i>0.551</i>	16.000 <i>0.630</i>	20.000 <i>0.787</i>			+0.050/+0.160	
# BP01400-01600-0290-M2	14.000 <i>0.551</i>	16.000 <i>0.630</i>	29.000 <i>1.142</i>			+0.050/+0.160	
# BP01400-01800-0200-M2	14.000 <i>0.551</i>	18.000 <i>0.709</i>	20.000 <i>0.787</i>			+0.050/+0.160	
# BP01400-02000-0100-M2	14.000 <i>0.551</i>	20.000 <i>0.787</i>	10.000 <i>0.394</i>			+0.050/+0.160	
# BP01400-02000-0150-M2	14.000 <i>0.551</i>	20.000 <i>0.787</i>	15.000 <i>0.591</i>			+0.050/+0.160	
# BP01400-02000-0200-M2	14.000 <i>0.551</i>	20.000 <i>0.787</i>	20.000 <i>0.787</i>			+0.050/+0.160	
# BP01500-01700-0100-M2	15.000 <i>0.591</i>	17.000 <i>0.669</i>	10.000 <i>0.394</i>			+0.050/+0.160	
# BP01500-01700-0150-M2	15.000 <i>0.591</i>	17.000 <i>0.669</i>	15.000 <i>0.591</i>			+0.050/+0.160	
# BP01500-02100-0100-M2	15.000 <i>0.591</i>	21.000 <i>0.827</i>	10.000 <i>0.394</i>			+0.050/+0.160	
BP01500-02100-0150-M2	15.000 <i>0.591</i>	21.000 <i>0.827</i>	15.000 <i>0.591</i>			+0.050/+0.160	

Indicates item not stocked at time of printing - Please enquire for lead time

E&OE Pricing and all details subject to change without notice - Copyright Miniature Bearings Australia Pty Ltd

MBA Size Listings are a guide to sizes only and must not be solely relied on for critical design information.

Bushes - Plastic - Iglidur M250 - Unflanged

Part Number	Nom. ID (d) mm	Nom. OD (D) mm	Length (s) mm	Bore Tolerance	Inner Diameter after Press Fit	Tolerance of ID after Pressfit	Housing Bore (Max. / Min.)
	<i>inches</i>	<i>inches</i>	<i>inches</i>				
# BP01500-02100-0200-M2	15.000 <i>0.591</i>	21.000 <i>0.827</i>	20.000 <i>0.787</i>			+0.050/+0.160	
BP01500-02100-0230-M2	15.000 <i>0.591</i>	21.000 <i>0.827</i>	23.000 <i>0.906</i>			+0.050/+0.160	
# BP01588-01905-0064-M2	15.875 <i>0.625</i>	19.050 <i>0.750</i>	6.350 <i>0.250</i>				
# BP01588-01905-0095-M2	15.875 <i>0.625</i>	19.050 <i>0.750</i>	9.525 <i>0.375</i>				
# BP01588-01905-0127-M2	15.875 <i>0.625</i>	19.050 <i>0.750</i>	12.700 <i>0.500</i>				
# BP01588-01905-0159-M2	15.875 <i>0.625</i>	19.050 <i>0.750</i>	15.875 <i>0.625</i>				
# BP01588-01905-0191-M2	15.875 <i>0.625</i>	19.050 <i>0.750</i>	19.050 <i>0.750</i>				
# BP01588-01905-0254-M2	15.875 <i>0.625</i>	19.050 <i>0.750</i>	25.400 <i>1.000</i>				
# BP01588-01905-0413-M2	15.875 <i>0.625</i>	19.050 <i>0.750</i>	41.275 <i>1.625</i>				
# BP01588-02064-0095-M2	15.875 <i>0.625</i>	20.638 <i>0.813</i>	9.525 <i>0.375</i>				

Indicates item not stocked at time of printing - Please enquire for lead time

E&OE Pricing and all details subject to change without notice - Copyright Miniature Bearings Australia Pty Ltd

MBA Size Listings are a guide to sizes only and must not be solely relied on for critical design information.

Bushes - Plastic - Iglidur M250 - Unflanged

Part Number	Nom. ID (d) mm <i>inches</i>	Nom. OD (D) mm <i>inches</i>	Length (s) mm <i>inches</i>	Bore Tolerance	Inner Diameter after Press Fit	Tolerance of ID after Pressfit	Housing Bore (Max. / Min.)
# BP01588-02064-0127-M2	15.875 <i>0.625</i>	20.638 <i>0.813</i>	12.700 <i>0.500</i>				
# BP01588-02064-0159-M2	15.875 <i>0.625</i>	20.638 <i>0.813</i>	15.875 <i>0.625</i>				
# BP01588-02064-0191-M2	15.875 <i>0.625</i>	20.638 <i>0.813</i>	19.050 <i>0.750</i>				
# BP01588-02064-0254-M2	15.875 <i>0.625</i>	20.638 <i>0.813</i>	25.400 <i>1.000</i>				
# BP01600-01800-0120-M2	16.000 <i>0.630</i>	18.000 <i>0.709</i>	12.000 <i>0.472</i>			+0.050/+0.160	
# BP01600-01800-0200-M2	16.000 <i>0.630</i>	18.000 <i>0.709</i>	20.000 <i>0.787</i>	+ 0.050 / + 0.160	16.160 / 16.050		18.018 / 18.000
# BP01600-02000-0200-M2	16.000 <i>0.630</i>	20.000 <i>0.787</i>	20.000 <i>0.787</i>			+0.050/+0.160	
# BP01600-02000-0250-M2	16.000 <i>0.630</i>	20.000 <i>0.787</i>	25.000 <i>0.984</i>			+0.050/+0.160	
# BP01600-02000-0300-M2	16.000 <i>0.630</i>	20.000 <i>0.787</i>	30.000 <i>1.181</i>			+0.050/+0.160	
# BP01600-02200-0120-M2	16.000 <i>0.630</i>	22.000 <i>0.866</i>	12.000 <i>0.472</i>			+0.050/+0.160	

Indicates item not stocked at time of printing - Please enquire for lead time

E&OE Pricing and all details subject to change without notice - Copyright Miniature Bearings Australia Pty Ltd

MBA Size Listings are a guide to sizes only and must not be solely relied on for critical design information.

Bushes - Plastic - Iglidur M250 - Unflanged

Part Number	Nom. ID (d) mm <i>inches</i>	Nom. OD (D) mm <i>inches</i>	Length (s) mm <i>inches</i>	Bore Tolerance	Inner Diameter after Press Fit	Tolerance of ID after Pressfit	Housing Bore (Max. / Min.)
# BP01600-02200-0150-M2	16.000 <i>0.630</i>	22.000 <i>0.866</i>	15.000 <i>0.591</i>			+0.050/+0.160	
# BP01600-02200-0160-M2	16.000 <i>0.630</i>	22.000 <i>0.866</i>	16.000 <i>0.630</i>			+0.050/+0.160	
# BP01600-02200-0200-M2	16.000 <i>0.630</i>	22.000 <i>0.866</i>	20.000 <i>0.787</i>			+0.050/+0.160	
# BP01600-02200-0250-M2	16.000 <i>0.630</i>	22.000 <i>0.866</i>	25.000 <i>0.984</i>			+0.050/+0.160	
# BP01746-02064-0191-M2	17.463 <i>0.688</i>	20.638 <i>0.813</i>	19.050 <i>0.750</i>				
# BP01746-02064-0222-M2	17.463 <i>0.688</i>	20.638 <i>0.813</i>	22.225 <i>0.875</i>				
# BP01746-02064-0254-M2	17.463 <i>0.688</i>	20.638 <i>0.813</i>	25.400 <i>1.000</i>				
# BP01800-02400-0120-M2	18.000 <i>0.709</i>	24.000 <i>0.945</i>	12.000 <i>0.472</i>			+0.050/+0.160	
# BP01800-02400-0200-M2	18.000 <i>0.709</i>	24.000 <i>0.945</i>	20.000 <i>0.787</i>			+0.050/+0.160	
# BP01800-02400-0300-M2	18.000 <i>0.709</i>	24.000 <i>0.945</i>	30.000 <i>1.181</i>			+0.050/+0.160	

Indicates item not stocked at time of printing - Please enquire for lead time

E&OE Pricing and all details subject to change without notice - Copyright Miniature Bearings Australia Pty Ltd

MBA Size Listings are a guide to sizes only and must not be solely relied on for critical design information.

Bushes - Plastic - Iglidur M250 - Unflanged

Part Number	Nom. ID (d) mm	Nom. OD (D) mm	Length (s) mm	Bore Tolerance	Inner Diameter after Press Fit	Tolerance of ID after Pressfit	Housing Bore (Max. / Min.)
	<i>inches</i>	<i>inches</i>	<i>inches</i>				
# BP01905-02223-0095-M2	19.050 <i>0.750</i>	22.225 <i>0.875</i>	9.525 <i>0.375</i>				
# BP01905-02223-0191-M2	19.050 <i>0.750</i>	22.225 <i>0.875</i>	19.050 <i>0.750</i>				
# BP01905-02223-0254-M2	19.050 <i>0.750</i>	22.225 <i>0.875</i>	25.400 <i>1.000</i>				
# BP01905-02223-0381-M2	19.050 <i>0.750</i>	22.225 <i>0.875</i>	38.100 <i>1.500</i>				
# BP01905-02540-0095-M2	19.050 <i>0.750</i>	25.400 <i>1.000</i>	9.525 <i>0.375</i>				
# BP01905-02540-0127-M2	19.050 <i>0.750</i>	25.400 <i>1.000</i>	12.700 <i>0.500</i>				
# BP01905-02540-0159-M2	19.050 <i>0.750</i>	25.400 <i>1.000</i>	15.875 <i>0.625</i>				
# BP01905-02540-0191-M2	19.050 <i>0.750</i>	25.400 <i>1.000</i>	19.050 <i>0.750</i>				
# BP01905-02540-0254-M2	19.050 <i>0.750</i>	25.400 <i>1.000</i>	25.400 <i>1.000</i>				
# BP01905-02540-0318-M2	19.050 <i>0.750</i>	25.400 <i>1.000</i>	31.750 <i>1.250</i>				

Indicates item not stocked at time of printing - Please enquire for lead time

E&OE Pricing and all details subject to change without notice - Copyright Miniature Bearings Australia Pty Ltd

MBA Size Listings are a guide to sizes only and must not be solely relied on for critical design information.

Bushes - Plastic - Iglidur M250 - Unflanged

Part Number	Nom. ID (d) mm <i>inches</i>	Nom. OD (D) mm <i>inches</i>	Length (s) mm <i>inches</i>	Bore Tolerance	Inner Diameter after Press Fit	Tolerance of ID after Pressfit	Housing Bore (Max. / Min.)
# BP01905-02540-0381-M2	19.050 <i>0.750</i>	25.400 <i>1.000</i>	38.100 <i>1.500</i>				
# BP02000-02300-0150-M2	20.000 <i>0.787</i>	23.000 <i>0.906</i>	15.000 <i>0.591</i>			+0.065/+0.195	
# BP02000-02300-0200-M2	20.000 <i>0.787</i>	23.000 <i>0.906</i>	20.000 <i>0.787</i>			+0.065/+0.195	
# BP02000-02500-0140-M2	20.000 <i>0.787</i>	25.000 <i>0.984</i>	14.000 <i>0.551</i>			+0.065/+0.195	
# BP02000-02500-0200-M2	20.000 <i>0.787</i>	25.000 <i>0.984</i>	20.000 <i>0.787</i>	+ 0.065 / + 0.195	20.195 / 20.065		25.021 / 25.000
# BP02000-02500-0300-M2	20.000 <i>0.787</i>	25.000 <i>0.984</i>	30.000 <i>1.181</i>			+0.065/+0.195	
# BP02000-02600-0150-M2	20.000 <i>0.787</i>	26.000 <i>1.024</i>	15.000 <i>0.591</i>			+0.065/+0.195	
# BP02000-02600-0200-M2	20.000 <i>0.787</i>	26.000 <i>1.024</i>	20.000 <i>0.787</i>			+0.065/+0.195	
# BP02000-02600-0300-M2	20.000 <i>0.787</i>	26.000 <i>1.024</i>	30.000 <i>1.181</i>			+0.065/+0.195	
# BP02064-02540-0127-M2	20.638 <i>0.813</i>	25.400 <i>1.000</i>	12.700 <i>0.500</i>				

Indicates item not stocked at time of printing - Please enquire for lead time

E&OE Pricing and all details subject to change without notice - Copyright Miniature Bearings Australia Pty Ltd

MBA Size Listings are a guide to sizes only and must not be solely relied on for critical design information.

Bushes - Plastic - Iglidur M250 - Unflanged

Part Number	Nom. ID (d) mm	Nom. OD (D) mm	Length (s) mm	Bore Tolerance	Inner Diameter after Press Fit	Tolerance of ID after Pressfit	Housing Bore (Max. / Min.)
	<i>inches</i>	<i>inches</i>	<i>inches</i>				
# BP02200-02600-0150-M2	22.000 <i>0.866</i>	26.000 <i>1.024</i>	15.000 <i>0.591</i>			+0.065/+0.195	
# BP02200-02800-0100-M2	22.000 <i>0.866</i>	28.000 <i>1.102</i>	10.000 <i>0.394</i>			+0.065/+0.195	
# BP02200-02800-0150-M2	22.000 <i>0.866</i>	28.000 <i>1.102</i>	15.000 <i>0.591</i>			+0.065/+0.195	
# BP02200-02800-0200-M2	22.000 <i>0.866</i>	28.000 <i>1.102</i>	20.000 <i>0.787</i>			+0.065/+0.195	
# BP02200-02800-0300-M2	22.000 <i>0.866</i>	28.000 <i>1.102</i>	30.000 <i>1.181</i>			+0.065/+0.195	
# BP02223-02540-0191-M2	22.225 <i>0.875</i>	25.400 <i>1.000</i>	19.050 <i>0.750</i>				
# BP02223-02540-0254-M2	22.225 <i>0.875</i>	25.400 <i>1.000</i>	25.400 <i>1.000</i>				
# BP02223-02540-0381-M2	22.225 <i>0.875</i>	25.400 <i>1.000</i>	38.100 <i>1.500</i>				
# BP02223-02858-0127-M2	22.225 <i>0.875</i>	28.575 <i>1.125</i>	12.700 <i>0.500</i>				
# BP02223-02858-0191-M2	22.225 <i>0.875</i>	28.575 <i>1.125</i>	19.050 <i>0.750</i>				

Indicates item not stocked at time of printing - Please enquire for lead time

E&OE Pricing and all details subject to change without notice - Copyright Miniature Bearings Australia Pty Ltd

MBA Size Listings are a guide to sizes only and must not be solely relied on for critical design information.

Bushes - Plastic - Iglidur M250 - Unflanged

Part Number	Nom. ID (d) mm <i>inches</i>	Nom. OD (D) mm <i>inches</i>	Length (s) mm <i>inches</i>	Bore Tolerance	Inner Diameter after Press Fit	Tolerance of ID after Pressfit	Housing Bore (Max. / Min.)
# BP02223-02858-0254-M2	22.225 <i>0.875</i>	28.575 <i>1.125</i>	25.400 <i>1.000</i>				
# BP02223-02858-0381-M2	22.225 <i>0.875</i>	28.575 <i>1.125</i>	38.100 <i>1.500</i>				
# BP02400-03000-0150-M2	24.000 <i>0.945</i>	30.000 <i>1.181</i>	15.000 <i>0.591</i>			+0.065/+0.195	
# BP02400-03000-0200-M2	24.000 <i>0.945</i>	30.000 <i>1.181</i>	20.000 <i>0.787</i>			+0.065/+0.195	
# BP02400-03000-0300-M2	24.000 <i>0.945</i>	30.000 <i>1.181</i>	30.000 <i>1.181</i>			+0.065/+0.195	
# BP02500-02800-0120-M2	25.000 <i>0.984</i>	28.000 <i>1.102</i>	12.000 <i>0.472</i>			+0.065/+0.195	
# BP02500-02800-0200-M2	25.000 <i>0.984</i>	28.000 <i>1.102</i>	20.000 <i>0.787</i>			+0.065/+0.195	
# BP02500-03000-0200-M2	25.000 <i>0.984</i>	30.000 <i>1.181</i>	20.000 <i>0.787</i>			+0.065/+0.195	
# BP02500-03000-0300-M2	25.000 <i>0.984</i>	30.000 <i>1.181</i>	30.000 <i>1.181</i>			+0.065/+0.195	
# BP02500-03000-0400-M2	25.000 <i>0.984</i>	30.000 <i>1.181</i>	40.000 <i>1.575</i>			+0.065/+0.195	

Indicates item not stocked at time of printing - Please enquire for lead time

E&OE Pricing and all details subject to change without notice - Copyright Miniature Bearings Australia Pty Ltd

MBA Size Listings are a guide to sizes only and must not be solely relied on for critical design information.

Bushes - Plastic - Iglidur M250 - Unflanged

Part Number	Nom. ID (d) mm <i>inches</i>	Nom. OD (D) mm <i>inches</i>	Length (s) mm <i>inches</i>	Bore Tolerance	Inner Diameter after Press Fit	Tolerance of ID after Pressfit	Housing Bore (Max. / Min.)
# BP02500-03200-0120-M2	25.000 <i>0.984</i>	32.000 <i>1.260</i>	12.000 <i>0.472</i>			+0.065/+0.195	
# BP02500-03200-0200-M2	25.000 <i>0.984</i>	32.000 <i>1.260</i>	20.000 <i>0.787</i>			+0.065/+0.195	
# BP02500-03200-0300-M2	25.000 <i>0.984</i>	32.000 <i>1.260</i>	30.000 <i>1.181</i>			+0.065/+0.195	
# BP02500-03200-0350-M2	25.000 <i>0.984</i>	32.000 <i>1.260</i>	35.000 <i>1.378</i>			+0.065/+0.195	
# BP02500-03200-0400-M2	25.000 <i>0.984</i>	32.000 <i>1.260</i>	40.000 <i>1.575</i>			+0.065/+0.195	
# BP02540-02858-0191-M2	25.400 <i>1.000</i>	28.575 <i>1.125</i>	19.050 <i>0.750</i>				
# BP02540-02858-0254-M2	25.400 <i>1.000</i>	28.575 <i>1.125</i>	25.400 <i>1.000</i>				
# BP02540-02858-0381-M2	25.400 <i>1.000</i>	28.575 <i>1.125</i>	38.100 <i>1.500</i>				
# BP02540-03175-0127-M2	25.400 <i>1.000</i>	31.750 <i>1.250</i>	12.700 <i>0.500</i>				
# BP02540-03175-0159-M2	25.400 <i>1.000</i>	31.750 <i>1.250</i>	15.875 <i>0.625</i>				

Indicates item not stocked at time of printing - Please enquire for lead time

E&OE Pricing and all details subject to change without notice - Copyright Miniature Bearings Australia Pty Ltd

MBA Size Listings are a guide to sizes only and must not be solely relied on for critical design information.

Bushes - Plastic - Iglidur M250 - Unflanged

Part Number	Nom. ID (d) mm	Nom. OD (D) mm	Length (s) mm	Bore Tolerance	Inner Diameter after Press Fit	Tolerance of ID after Pressfit	Housing Bore (Max. / Min.)
	<i>inches</i>	<i>inches</i>	<i>inches</i>				
# BP02540-03175-0191-M2	25.400 <i>1.000</i>	31.750 <i>1.250</i>	19.050 <i>0.750</i>				
# BP02540-03175-0254-M2	25.400 <i>1.000</i>	31.750 <i>1.250</i>	25.400 <i>1.000</i>				
# BP02540-03175-0381-M2	25.400 <i>1.000</i>	31.750 <i>1.250</i>	38.100 <i>1.500</i>				
# BP02540-03175-0508-M2	25.400 <i>1.000</i>	31.750 <i>1.250</i>	50.800 <i>2.000</i>				
# BP02600-03000-0200-M2	26.000 <i>1.024</i>	30.000 <i>1.181</i>	20.000 <i>0.787</i>			+0.065/+0.195	
# BP02600-03200-0300-M2	26.000 <i>1.024</i>	32.000 <i>1.260</i>	30.000 <i>1.181</i>			+0.065/+0.195	
# BP02700-03400-0200-M2	27.000 <i>1.063</i>	34.000 <i>1.339</i>	20.000 <i>0.787</i>			+0.065/+0.195	
# BP02700-03400-0300-M2	27.000 <i>1.063</i>	34.000 <i>1.339</i>	30.000 <i>1.181</i>			+0.065/+0.195	
# BP02700-03400-0400-M2	27.000 <i>1.063</i>	34.000 <i>1.339</i>	40.000 <i>1.575</i>			+0.065/+0.195	
# BP02800-03300-0200-M2	28.000 <i>1.102</i>	33.000 <i>1.299</i>	20.000 <i>0.787</i>			+0.065/+0.195	

Indicates item not stocked at time of printing - Please enquire for lead time

E&OE Pricing and all details subject to change without notice - Copyright Miniature Bearings Australia Pty Ltd

MBA Size Listings are a guide to sizes only and must not be solely relied on for critical design information.

Bushes - Plastic - Iglidur M250 - Unflanged

Part Number	Nom. ID (d) mm	Nom. OD (D) mm	Length (s) mm	Bore Tolerance	Inner Diameter after Press Fit	Tolerance of ID after Pressfit	Housing Bore (Max. / Min.)
	<i>inches</i>	<i>inches</i>	<i>inches</i>				
# BP02800-03600-0200-M2	28.000 <i>1.102</i>	36.000 <i>1.417</i>	20.000 <i>0.787</i>			+0.065/+0.195	
# BP02800-03600-0300-M2	28.000 <i>1.102</i>	36.000 <i>1.417</i>	30.000 <i>1.181</i>			+0.065/+0.195	
# BP02800-03600-0400-M2	28.000 <i>1.102</i>	36.000 <i>1.417</i>	40.000 <i>1.575</i>			+0.065/+0.195	
# BP02858-03493-0254-M2	28.575 <i>1.125</i>	34.925 <i>1.375</i>	25.400 <i>1.000</i>				
# BP02858-03493-0381-M2	28.575 <i>1.125</i>	34.925 <i>1.375</i>	38.100 <i>1.500</i>				
# BP03000-03500-0200-M2	30.000 <i>1.181</i>	35.000 <i>1.378</i>	20.000 <i>0.787</i>			+0.065/+0.195	
# BP03000-03800-0200-M2	30.000 <i>1.181</i>	38.000 <i>1.496</i>	20.000 <i>0.787</i>			+0.065/+0.195	
# BP03000-03800-0300-M2	30.000 <i>1.181</i>	38.000 <i>1.496</i>	30.000 <i>1.181</i>			+0.065/+0.195	
# BP03000-03800-0400-M2	30.000 <i>1.181</i>	38.000 <i>1.496</i>	40.000 <i>1.575</i>			+0.065/+0.195	
# BP03000-04000-0400-M2	30.000 <i>1.181</i>	40.000 <i>1.575</i>	40.000 <i>1.575</i>			+0.065/+0.195	

Indicates item not stocked at time of printing - Please enquire for lead time

E&OE Pricing and all details subject to change without notice - Copyright Miniature Bearings Australia Pty Ltd

MBA Size Listings are a guide to sizes only and must not be solely relied on for critical design information.

Bushes - Plastic - Iglidur M250 - Unflanged

Part Number	Nom. ID (d) mm <i>inches</i>	Nom. OD (D) mm <i>inches</i>	Length (s) mm <i>inches</i>	Bore Tolerance	Inner Diameter after Press Fit	Tolerance of ID after Pressfit	Housing Bore (Max. / Min.)
# BP03175-03810-0191-M2	31.750 <i>1.250</i>	38.100 <i>1.500</i>	19.050 <i>0.750</i>				
# BP03175-03810-0254-M2	31.750 <i>1.250</i>	38.100 <i>1.500</i>	25.400 <i>1.000</i>				
# BP03175-03810-0349-M2	31.750 <i>1.250</i>	38.100 <i>1.500</i>	34.925 <i>1.375</i>				
# BP03175-03810-0381-M2	31.750 <i>1.250</i>	38.100 <i>1.500</i>	38.100 <i>1.500</i>				
# BP03175-03810-0635-M2	31.750 <i>1.250</i>	38.100 <i>1.500</i>	63.500 <i>2.500</i>				
# BP03200-04000-0200-M2	32.000 <i>1.260</i>	40.000 <i>1.575</i>	20.000 <i>0.787</i>			+0.080/+0.240	
# BP03200-04000-0300-M2	32.000 <i>1.260</i>	40.000 <i>1.575</i>	30.000 <i>1.181</i>			+0.080/+0.240	
# BP03200-04000-0400-M2	32.000 <i>1.260</i>	40.000 <i>1.575</i>	40.000 <i>1.575</i>			+0.080/+0.240	
# BP03493-04128-0254-M2	34.925 <i>1.375</i>	41.275 <i>1.625</i>	25.400 <i>1.000</i>				
# BP03500-04200-0500-M2	35.000 <i>1.378</i>	42.000 <i>1.654</i>	50.000 <i>1.969</i>			+0.080/+0.240	

Indicates item not stocked at time of printing - Please enquire for lead time

E&OE Pricing and all details subject to change without notice - Copyright Miniature Bearings Australia Pty Ltd

MBA Size Listings are a guide to sizes only and must not be solely relied on for critical design information.

Bushes - Plastic - Iglidur M250 - Unflanged

Part Number	Nom. ID (d) mm	Nom. OD (D) mm	Length (s) mm	Bore Tolerance	Inner Diameter after Press Fit	Tolerance of ID after Pressfit	Housing Bore (Max. / Min.)
	<i>inches</i>	<i>inches</i>	<i>inches</i>				
# BP03810-04445-0191-M2	38.100 <i>1.500</i>	44.450 <i>1.750</i>	19.050 <i>0.750</i>				
# BP03810-04445-0254-M2	38.100 <i>1.500</i>	44.450 <i>1.750</i>	25.400 <i>1.000</i>				
# BP03810-04445-0381-M2	38.100 <i>1.500</i>	44.450 <i>1.750</i>	38.100 <i>1.500</i>				
# BP03810-04445-0635-M2	38.100 <i>1.500</i>	44.450 <i>1.750</i>	63.500 <i>2.500</i>				
# BP04128-04763-0254-M2	41.275 <i>1.625</i>	47.625 <i>1.875</i>	25.400 <i>1.000</i>				
# BP04445-05080-0191-M2	44.445 <i>1.750</i>	50.800 <i>2.000</i>	19.050 <i>0.750</i>				
# BP04445-05080-0381-M2	44.445 <i>1.750</i>	50.800 <i>2.000</i>	38.100 <i>1.500</i>				
# BP04445-05080-0127-M2	44.450 <i>1.750</i>	50.800 <i>2.000</i>	12.700 <i>0.500</i>				
# BP04445-05080-0254-M2	44.450 <i>1.750</i>	50.800 <i>2.000</i>	25.400 <i>1.000</i>				
# BP04445-05080-0635-M2	44.450 <i>1.750</i>	50.800 <i>2.000</i>	63.500 <i>2.500</i>				

Indicates item not stocked at time of printing - Please enquire for lead time

E&OE Pricing and all details subject to change without notice - Copyright Miniature Bearings Australia Pty Ltd

MBA Size Listings are a guide to sizes only and must not be solely relied on for critical design information.

Bushes - Plastic - Iglidur M250 - Unflanged

Part Number	Nom. ID (d) mm	Nom. OD (D) mm	Length (s) mm	Bore Tolerance	Inner Diameter after Press Fit	Tolerance of ID after Pressfit	Housing Bore (Max. / Min.)
	<i>inches</i>	<i>inches</i>	<i>inches</i>				
# BP05080-05715-0254-M2	50.800 <i>2.000</i>	57.150 <i>2.250</i>	25.400 <i>1.000</i>				
# BP05080-05715-0381-M2	50.800 <i>2.000</i>	57.150 <i>2.250</i>	38.100 <i>1.500</i>				
# BP05080-05715-0508-M2	50.800 <i>2.000</i>	57.150 <i>2.250</i>	50.800 <i>2.000</i>				
# BP05080-05715-0635-M2	50.800 <i>2.000</i>	57.150 <i>2.250</i>	63.500 <i>2.500</i>				
# BP07500-08000-0500-M2	75.000 <i>2.953</i>	80.000 <i>3.150</i>	50.000 <i>1.969</i>			+0.080/+0.240	
# BP07620-08255-0254-M2	76.200 <i>3.000</i>	82.550 <i>3.250</i>	25.400 <i>1.000</i>				

Indicates item not stocked at time of printing - Please enquire for lead time

E&OE Pricing and all details subject to change without notice - Copyright Miniature Bearings Australia Pty Ltd

MBA Size Listings are a guide to sizes only and must not be solely relied on for critical design information.



DISTRIBUTED BY

Ask us to put your name and address here

<http://www.minibearings.com.au/product>

Ph +61 7 3245 7977

Fax +61 7 3245 1017

Catalogue requests to catalogues@minibearings.com.au

