

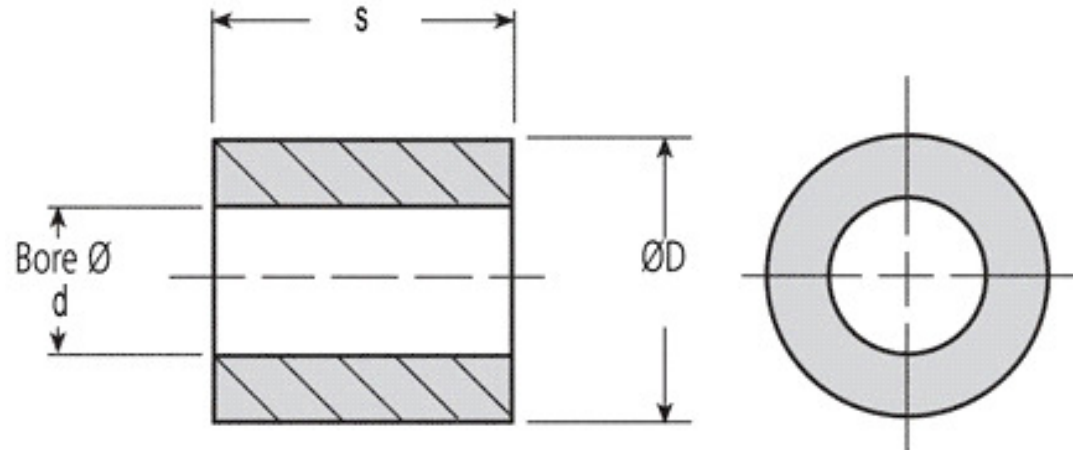

# MBA

## Bushes - Plastic - Iglidur P - Unflanged



Low water absorption. Low wear. High load.

Specific Gravity 1.47 g/cm<sup>3</sup>.

Operating Temp 200 C short term / 130 C long term.

Tensile Strength at 20 deg C = 120 Mpa.

Hardness 75 Shore D (DIN53505).

Tolerances listed are after H7 Pressfit.

### Bushes - Plastic - Iglidur P - Unflanged

Part Number	Nom. ID (d) mm <i>inches</i>	Nom. OD (D) mm <i>inches</i>	Length (s) mm <i>inches</i>	Tolerance of ID after Pressfit
# BP00300-00450-0030-P	3.000 <i>0.118</i>	4.500 <i>0.177</i>	3.000 <i>0.118</i>	+0.014/+0.054
# BP00400-00550-0040-P	4.000 <i>0.157</i>	5.500 <i>0.217</i>	4.000 <i>0.157</i>	+0.020/+0.068
# BP00500-00700-0050-P	5.000 <i>0.197</i>	7.000 <i>0.276</i>	5.000 <i>0.197</i>	+0.010/+0.040

# Indicates item not stocked at time of printing - Please enquire for lead time

E&OE Pricing and all details subject to change without notice - Copyright Miniature Bearings Australia Pty Ltd

MBA Size Listings are a guide to sizes only and must not be solely relied on for critical design information.

## Bushes - Plastic - Iglidur P - Unflanged

Part Number	Nom. ID (d) mm <i>inches</i>	Nom. OD (D) mm <i>inches</i>	Length (s) mm <i>inches</i>	Tolerance of ID after Pressfit
# BP00600-00800-0060-P	6.000 <i>0.236</i>	8.000 <i>0.315</i>	6.000 <i>0.236</i>	+0.020/+0.068
# BP00800-01000-0080-P	8.000 <i>0.315</i>	10.000 <i>0.394</i>	8.000 <i>0.315</i>	+0.025/+0.083
# BP00800-01000-0120-P	8.000 <i>0.315</i>	10.000 <i>0.394</i>	12.000 <i>0.472</i>	+0.025/+0.083
# BP01000-01200-0100-P	10.000 <i>0.394</i>	12.000 <i>0.472</i>	10.000 <i>0.394</i>	+0.025/+0.083
# BP01200-01400-0150-P	12.000 <i>0.472</i>	14.000 <i>0.551</i>	15.000 <i>0.591</i>	+0.032/+0.102
# BP01200-01400-0250-P	12.000 <i>0.472</i>	14.000 <i>0.551</i>	25.000 <i>0.984</i>	+0.032/+0.102
# BP01500-01700-0150-P	15.000 <i>0.591</i>	17.000 <i>0.669</i>	15.000 <i>0.591</i>	+0.032/+0.102
# BP01600-01800-0200-P	16.000 <i>0.630</i>	18.000 <i>0.709</i>	20.000 <i>0.787</i>	+0.032/+0.102
# BP01800-02000-0150-P	18.000 <i>0.709</i>	20.000 <i>0.787</i>	15.000 <i>0.591</i>	+0.040/+0.124
# BP02000-02200-0220-P	20.000 <i>0.787</i>	22.000 <i>0.866</i>	22.000 <i>0.866</i>	+0.040/+0.124

# Indicates item not stocked at time of printing - Please enquire for lead time

E&OE Pricing and all details subject to change without notice - Copyright Miniature Bearings Australia Pty Ltd

MBA Size Listings are a guide to sizes only and must not be solely relied on for critical design information.

## Bushes - Plastic - Iglidur P - Unflanged

Part Number	Nom. ID (d) mm <i>inches</i>	Nom. OD (D) mm <i>inches</i>	Length (s) mm <i>inches</i>	Tolerance of ID after Pressfit
# BP02000-02200-0300-P	20.000 <i>0.787</i>	22.000 <i>0.866</i>	30.000 <i>1.181</i>	+0.040/+0.124
# BP02000-02300-0150-P	20.000 <i>0.787</i>	23.000 <i>0.906</i>	15.000 <i>0.591</i>	+0.040/+0.124
# BP02000-02300-0300-P	20.000 <i>0.787</i>	23.000 <i>0.906</i>	30.000 <i>1.181</i>	+0.040/+0.124
# BP02200-02500-0150-P	22.000 <i>0.866</i>	25.000 <i>0.984</i>	15.000 <i>0.591</i>	+0.040/+0.124
# BP02500-02800-0300-P	25.000 <i>0.984</i>	28.000 <i>1.102</i>	30.000 <i>1.181</i>	+0.040/+0.124
# BP02500-02800-0350-P	25.000 <i>0.984</i>	28.000 <i>1.102</i>	35.000 <i>1.378</i>	+0.040/+0.124
# BP02800-03200-0250-P	28.000 <i>1.102</i>	32.000 <i>1.260</i>	25.000 <i>0.984</i>	+0.040/+0.124
# BP03000-03400-0200-P	30.000 <i>1.181</i>	34.000 <i>1.339</i>	20.000 <i>0.787</i>	+0.040/+0.124
# BP03000-03400-0400-P	30.000 <i>1.181</i>	34.000 <i>1.339</i>	40.000 <i>1.575</i>	+0.040/+0.124
# BP03500-03900-0400-P	35.000 <i>1.378</i>	39.000 <i>1.535</i>	40.000 <i>1.575</i>	+0.050/+0.150

# Indicates item not stocked at time of printing - Please enquire for lead time

E&OE Pricing and all details subject to change without notice - Copyright Miniature Bearings Australia Pty Ltd

MBA Size Listings are a guide to sizes only and must not be solely relied on for critical design information.

## Bushes - Plastic - Iglidur P - Unflanged

Part Number	Nom. ID (d) mm <i>inches</i>	Nom. OD (D) mm <i>inches</i>	Length (s) mm <i>inches</i>	Tolerance of ID after Pressfit
# BP04000-04400-0500-P	40.000 <i>1.575</i>	44.000 <i>1.732</i>	50.000 <i>1.969</i>	+0.050/+0.150
# BP05000-05500-0400-P	50.000 <i>1.969</i>	55.000 <i>2.165</i>	40.000 <i>1.575</i>	+0.050/+0.150
# BP06000-06500-0600-P	60.000 <i>2.362</i>	65.000 <i>2.559</i>	60.000 <i>2.362</i>	+0.060/+0.180
# BP09000-09500-1000-P	90.000 <i>3.543</i>	95.000 <i>3.740</i>	100.000 <i>3.937</i>	+0.072/+0.212
# BP09500-10000-1000-P	95.000 <i>3.740</i>	100.000 <i>3.937</i>	100.000 <i>3.937</i>	+0.072/+0.212

# Indicates item not stocked at time of printing - Please enquire for lead time

E&OE Pricing and all details subject to change without notice - Copyright Miniature Bearings Australia Pty Ltd

MBA Size Listings are a guide to sizes only and must not be solely relied on for critical design information.



DISTRIBUTED BY

Ask us to put your name and address here

<http://www.minibearings.com.au/product>

Ph +61 7 3245 7977

Fax +61 7 3245 1017

Catalogue requests to [catalogues@minibearings.com.au](mailto:catalogues@minibearings.com.au)
