

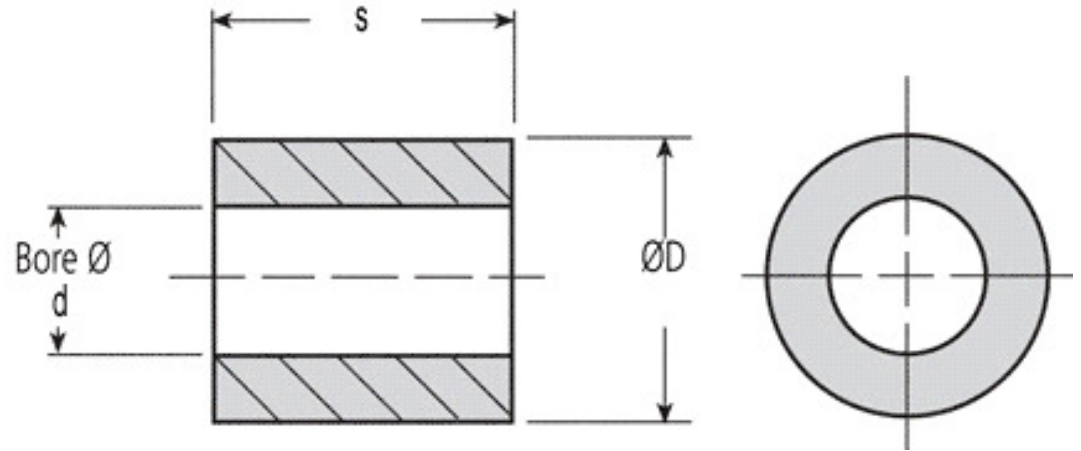

# MBA

## Bushes - Plastic - Iglidur Q - Unflanged



Excellent wear resistance under high load. Resistant to dirt.  
Specific Gravity 1.40 g/cm<sup>3</sup>.

Operating Temp 155 C short term / 135 C long term.

Tensile Strength at 20 deg C = 120 Mpa.

Hardness 83 Shore D (DIN53505).

Tolerances listed are after H7 Pressfit.

### Bushes - Plastic - Iglidur Q - Unflanged

Part Number	Nom. ID (d) mm <i>inches</i>	Nom. OD (D) mm <i>inches</i>	Length (s) mm <i>inches</i>	Tolerance of ID after Pressfit
# BP00600-00800-0100-Q	6.000 <i>0.236</i>	8.000 <i>0.315</i>	10.000 <i>0.394</i>	+0.020/+0.068
# BP00800-01000-0080-Q	8.000 <i>0.315</i>	10.000 <i>0.394</i>	8.000 <i>0.315</i>	+0.025/+0.083
# BP00953-01191-0064-Q	9.525 <i>0.375</i>	11.906 <i>0.469</i>	6.350 <i>0.250</i>	

# Indicates item not stocked at time of printing - Please enquire for lead time  
E&OE Pricing and all details subject to change without notice - Copyright Miniature Bearings Australia Pty Ltd  
MBA Size Listings are a guide to sizes only and must not be solely relied on for critical design information.

## Bushes - Plastic - Iglidur Q - Unflanged

Part Number	Nom. ID (d) mm <i>inches</i>	Nom. OD (D) mm <i>inches</i>	Length (s) mm <i>inches</i>	Tolerance of ID after Pressfit
# BP00953-01191-0095-Q	9.525 <i>0.375</i>	11.906 <i>0.469</i>	9.525 <i>0.375</i>	
# BP00953-01191-0127-Q	9.525 <i>0.375</i>	11.906 <i>0.469</i>	12.700 <i>0.500</i>	
# BP01000-01200-0100-Q	10.000 <i>0.394</i>	12.000 <i>0.472</i>	10.000 <i>0.394</i>	+0.025/+0.083
# BP01111-01349-0127-Q	11.113 <i>0.438</i>	13.494 <i>0.531</i>	12.700 <i>0.500</i>	
# BP01200-01400-0100-Q	12.000 <i>0.472</i>	14.000 <i>0.551</i>	10.000 <i>0.394</i>	+0.032/+0.102
# BP01200-01400-0200-Q	12.000 <i>0.472</i>	14.000 <i>0.551</i>	20.000 <i>0.787</i>	+0.032/+0.102
# BP01270-01508-0191-Q	12.700 <i>0.500</i>	15.081 <i>0.594</i>	19.050 <i>0.750</i>	
# BP01588-01826-0191-Q	15.875 <i>0.625</i>	18.256 <i>0.719</i>	19.050 <i>0.750</i>	
# BP01600-01800-0200-Q	16.000 <i>0.630</i>	18.000 <i>0.709</i>	20.000 <i>0.787</i>	+0.032/+0.102
# BP01800-02000-0200-Q	18.000 <i>0.709</i>	20.000 <i>0.787</i>	20.000 <i>0.787</i>	+0.032/+0.102

# Indicates item not stocked at time of printing - Please enquire for lead time

E&OE Pricing and all details subject to change without notice - Copyright Miniature Bearings Australia Pty Ltd

MBA Size Listings are a guide to sizes only and must not be solely relied on for critical design information.

## Bushes - Plastic - Iglidur Q - Unflanged

Part Number	Nom. ID (d) mm <i>inches</i>	Nom. OD (D) mm <i>inches</i>	Length (s) mm <i>inches</i>	Tolerance of ID after Pressfit
# BP01905-02223-0127-Q	19.050 <i>0.750</i>	22.225 <i>0.875</i>	12.700 <i>0.500</i>	
# BP01905-02223-0191-Q	19.050 <i>0.750</i>	22.225 <i>0.875</i>	19.050 <i>0.750</i>	
# BP01905-02223-0254-Q	19.050 <i>0.750</i>	22.225 <i>0.875</i>	25.400 <i>1.000</i>	
# BP02000-02200-0150-Q	20.000 <i>0.787</i>	22.000 <i>0.866</i>	15.000 <i>0.591</i>	+0.040/+0.124
# BP02000-02300-0150-Q	20.000 <i>0.787</i>	23.000 <i>0.906</i>	15.000 <i>0.591</i>	+0.040/+0.124
# BP02000-02300-0200-Q	20.000 <i>0.787</i>	23.000 <i>0.906</i>	20.000 <i>0.787</i>	+0.040/+0.124
# BP02000-02300-0250-Q	20.000 <i>0.787</i>	23.000 <i>0.906</i>	25.000 <i>0.984</i>	+0.040/+0.124
# BP02000-02300-0300-Q	20.000 <i>0.787</i>	23.000 <i>0.906</i>	30.000 <i>1.181</i>	+0.040/+0.124
# BP02223-02540-0254-Q	22.225 <i>0.875</i>	25.400 <i>1.000</i>	25.400 <i>1.000</i>	
# BP02500-02800-0250-Q	25.000 <i>0.984</i>	28.000 <i>1.102</i>	25.000 <i>0.984</i>	+0.040/+0.124

# Indicates item not stocked at time of printing - Please enquire for lead time

E&OE Pricing and all details subject to change without notice - Copyright Miniature Bearings Australia Pty Ltd

MBA Size Listings are a guide to sizes only and must not be solely relied on for critical design information.

## Bushes - Plastic - Iglidur Q - Unflanged

Part Number	Nom. ID (d) mm <i>inches</i>	Nom. OD (D) mm <i>inches</i>	Length (s) mm <i>inches</i>	Tolerance of ID after Pressfit
# BP02540-02858-0254-Q	25.400 <i>1.000</i>	28.575 <i>1.125</i>	25.400 <i>1.000</i>	
# BP02540-02858-0381-Q	25.400 <i>1.000</i>	28.575 <i>1.125</i>	38.100 <i>1.500</i>	
# BP02858-03254-0381-Q	28.575 <i>1.125</i>	32.544 <i>1.281</i>	38.100 <i>1.500</i>	
# BP03000-03400-0200-Q	30.000 <i>1.181</i>	34.000 <i>1.339</i>	20.000 <i>0.787</i>	+0.040/+0.124
# BP03000-03400-0400-Q	30.000 <i>1.181</i>	34.000 <i>1.339</i>	40.000 <i>1.575</i>	+0.050/+0.150
# BP03175-03572-0318-Q	31.750 <i>1.250</i>	35.719 <i>1.406</i>	31.750 <i>1.250</i>	
# BP03175-03572-0381-Q	31.750 <i>1.250</i>	35.719 <i>1.406</i>	38.100 <i>1.500</i>	
# BP03500-03900-0300-Q	35.000 <i>1.378</i>	39.000 <i>1.535</i>	30.000 <i>1.181</i>	+0.050/+0.150
# BP03500-03900-0500-Q	35.000 <i>1.378</i>	39.000 <i>1.535</i>	50.000 <i>1.969</i>	+0.050/+0.150
# BP03810-04207-0381-Q	38.100 <i>1.500</i>	42.069 <i>1.656</i>	38.100 <i>1.500</i>	

# Indicates item not stocked at time of printing - Please enquire for lead time

E&OE Pricing and all details subject to change without notice - Copyright Miniature Bearings Australia Pty Ltd

MBA Size Listings are a guide to sizes only and must not be solely relied on for critical design information.

## Bushes - Plastic - Iglidur Q - Unflanged

Part Number	Nom. ID (d) mm <i>inches</i>	Nom. OD (D) mm <i>inches</i>	Length (s) mm <i>inches</i>	Tolerance of ID after Pressfit
# BP04000-04400-0400-Q	40.000 <i>1.575</i>	44.000 <i>1.732</i>	40.000 <i>1.575</i>	+0.050/+0.150
# BP04000-04400-0470-Q	40.000 <i>1.575</i>	44.000 <i>1.732</i>	47.000 <i>1.850</i>	+0.050/+0.150
# BP04128-04524-0318-Q	41.275 <i>1.625</i>	45.244 <i>1.781</i>	31.750 <i>1.250</i>	
# BP04445-04921-0508-Q	44.450 <i>1.750</i>	49.213 <i>1.938</i>	50.800 <i>2.000</i>	
# BP04500-05000-0252-Q	45.000 <i>1.772</i>	50.000 <i>1.969</i>	25.200 <i>0.992</i>	+0.050/+0.150
# BP04500-05000-0500-Q	45.000 <i>1.772</i>	50.000 <i>1.969</i>	50.000 <i>1.969</i>	+0.050/+0.150
# BP05000-05500-0500-Q	50.000 <i>1.969</i>	55.000 <i>2.165</i>	50.000 <i>1.969</i>	+0.050/+0.150
# BP05000-05500-0600-Q	50.000 <i>1.969</i>	55.000 <i>2.165</i>	60.000 <i>2.362</i>	+0.050/+0.150
# BP05080-05533-0191-Q	50.800 <i>2.000</i>	55.334 <i>2.179</i>	19.050 <i>0.750</i>	
# BP05080-05533-0254-Q	50.800 <i>2.000</i>	55.334 <i>2.179</i>	25.400 <i>1.000</i>	

# Indicates item not stocked at time of printing - Please enquire for lead time

E&OE Pricing and all details subject to change without notice - Copyright Miniature Bearings Australia Pty Ltd

MBA Size Listings are a guide to sizes only and must not be solely relied on for critical design information.

## Bushes - Plastic - Iglidur Q - Unflanged

Part Number	Nom. ID (d) mm <i>inches</i>	Nom. OD (D) mm <i>inches</i>	Length (s) mm <i>inches</i>	Tolerance of ID after Pressfit
# BP05080-05533-0381-Q	50.800 <i>2.000</i>	55.334 <i>2.179</i>	38.100 <i>1.500</i>	
# BP05080-05533-0508-Q	50.800 <i>2.000</i>	55.334 <i>2.179</i>	50.800 <i>2.000</i>	
# BP05080-05533-0635-Q	50.800 <i>2.000</i>	55.334 <i>2.179</i>	63.500 <i>2.500</i>	
# BP05715-06191-0508-Q	57.150 <i>2.250</i>	61.913 <i>2.438</i>	50.800 <i>2.000</i>	
# BP06000-06500-0500-Q	60.000 <i>2.362</i>	65.000 <i>2.559</i>	50.000 <i>1.969</i>	+0.060/+0.180
# BP07000-07500-0600-Q	70.000 <i>2.756</i>	75.000 <i>2.953</i>	60.000 <i>2.362</i>	+0.060/+0.180

# Indicates item not stocked at time of printing - Please enquire for lead time

E&OE Pricing and all details subject to change without notice - Copyright Miniature Bearings Australia Pty Ltd

MBA Size Listings are a guide to sizes only and must not be solely relied on for critical design information.



DISTRIBUTED BY

Ask us to put your name and address here

<http://www.minibearings.com.au/product>

Ph +61 7 3245 7977

Fax +61 7 3245 1017

Catalogue requests to [catalogues@minibearings.com.au](mailto:catalogues@minibearings.com.au)

