

MBA

Bushes - Plastic - Iglidur W300 - Unflanged



Low co-efficient of friction. High wear resistance. Chemical resistant.

Specific Gravity 1.24 g/cm³.

Operating Temp 180 C short term / 90 C long term.

Tensile Strength at 20 deg C = 125 Mpa.

Hardness 77 Shore D (DIN53505).

Tolerances listed are after H7 Pressfit.

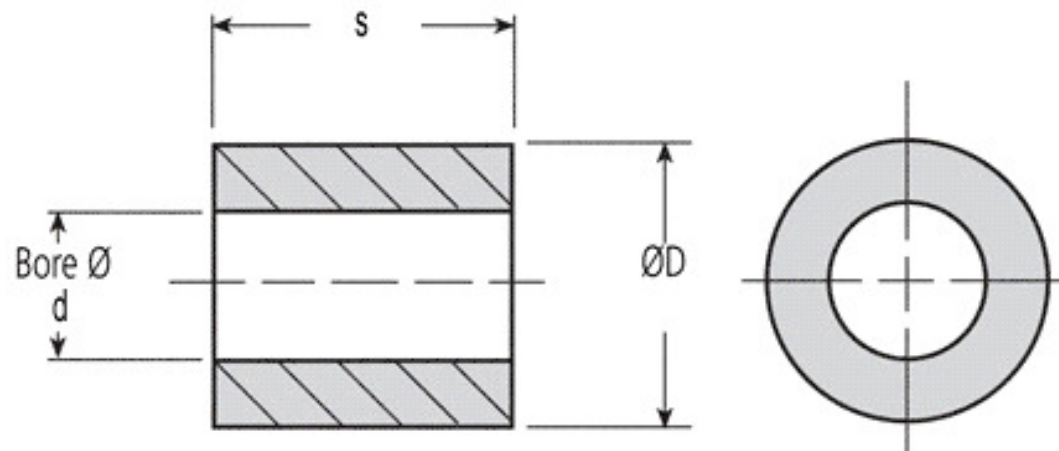

Bushes - Plastic - Iglidur W300 - Unflanged

Part Number	Nom. ID (d) mm <i>inches</i>	Nom. OD (D) mm <i>inches</i>	Length (s) mm <i>inches</i>	Tolerance of ID after Pressfit
# BP00200-00350-0030-W3	2.000 <i>0.079</i>	3.500 <i>0.138</i>	3.000 <i>0.118</i>	+0.014/+0.054
# BP00200-00450-0030-W3	2.000 <i>0.079</i>	4.500 <i>0.177</i>	3.000 <i>0.118</i>	+0.014/+0.054
# BP00300-00450-0030-W3	3.000 <i>0.118</i>	4.500 <i>0.177</i>	3.000 <i>0.118</i>	+0.014/+0.054

Indicates item not stocked at time of printing - Please enquire for lead time

E&OE Pricing and all details subject to change without notice - Copyright Miniature Bearings Australia Pty Ltd

MBA Size Listings are a guide to sizes only and must not be solely relied on for critical design information.

Bushes - Plastic - Iglidur W300 - Unflanged

Part Number	Nom. ID (d) mm <i>inches</i>	Nom. OD (D) mm <i>inches</i>	Length (s) mm <i>inches</i>	Tolerance of ID after Pressfit
# BP00300-00450-0050-W3	3.000 <i>0.118</i>	4.500 <i>0.177</i>	5.000 <i>0.197</i>	+0.014/+0.054
BP00300-00450-0060-W3	3.000 <i>0.118</i>	4.500 <i>0.177</i>	6.000 <i>0.236</i>	+0.014/+0.054
# BP00318-00476-0048-W3	3.175 <i>0.125</i>	4.763 <i>0.188</i>	4.763 <i>0.188</i>	
# BP00318-00476-0064-W3	3.175 <i>0.125</i>	4.763 <i>0.188</i>	6.350 <i>0.250</i>	
# BP00318-00476-0095-W3	3.175 <i>0.125</i>	4.763 <i>0.188</i>	9.525 <i>0.375</i>	
# BP00400-00550-0040-W3	4.000 <i>0.157</i>	5.500 <i>0.217</i>	4.000 <i>0.157</i>	+0.014/+0.054
# BP00400-00550-0060-W3	4.000 <i>0.157</i>	5.500 <i>0.217</i>	6.000 <i>0.236</i>	+0.020/+0.068
# BP00400-00550-0080-W3	4.000 <i>0.157</i>	5.500 <i>0.217</i>	8.000 <i>0.315</i>	+0.020/+0.068
# BP00400-00550-0100-W3	4.000 <i>0.157</i>	5.500 <i>0.217</i>	10.000 <i>0.394</i>	+0.020/+0.068
# BP00476-00635-0064-W3	4.763 <i>0.188</i>	6.350 <i>0.250</i>	6.350 <i>0.250</i>	

Indicates item not stocked at time of printing - Please enquire for lead time
 E&OE Pricing and all details subject to change without notice - Copyright Miniature Bearings Australia Pty Ltd
 MBA Size Listings are a guide to sizes only and must not be solely relied on for critical design information.

Bushes - Plastic - Iglidur W300 - Unflanged

Part Number	Nom. ID (d) mm <i>inches</i>	Nom. OD (D) mm <i>inches</i>	Length (s) mm <i>inches</i>	Tolerance of ID after Pressfit
# BP00476-00635-0095-W3	4.763 <i>0.188</i>	6.350 <i>0.250</i>	9.525 <i>0.375</i>	
# BP00476-00635-0127-W3	4.763 <i>0.188</i>	6.350 <i>0.250</i>	12.700 <i>0.500</i>	
# BP00500-00700-0050-W3	5.000 <i>0.197</i>	7.000 <i>0.276</i>	5.000 <i>0.197</i>	+0.020/+0.068
# BP00500-00700-0080-W3	5.000 <i>0.197</i>	7.000 <i>0.276</i>	8.000 <i>0.315</i>	+0.020/+0.068
BP00500-00700-0100-W3	5.000 <i>0.197</i>	7.000 <i>0.276</i>	10.000 <i>0.394</i>	+0.020/+0.068
# BP00600-00800-0060-W3	6.000 <i>0.236</i>	8.000 <i>0.315</i>	6.000 <i>0.236</i>	+0.020/+0.068
# BP00600-00800-0080-W3	6.000 <i>0.236</i>	8.000 <i>0.315</i>	8.000 <i>0.315</i>	+0.020/+0.068
# BP00600-00800-0095-W3	6.000 <i>0.236</i>	8.000 <i>0.315</i>	9.500 <i>0.374</i>	+0.020/+0.068
# BP00600-00800-0100-W3	6.000 <i>0.236</i>	8.000 <i>0.315</i>	10.000 <i>0.394</i>	+0.020/+0.068
# BP00600-00800-0118-W3	6.000 <i>0.236</i>	8.000 <i>0.315</i>	11.800 <i>0.465</i>	+0.020/+0.068

Indicates item not stocked at time of printing - Please enquire for lead time

E&OE Pricing and all details subject to change without notice - Copyright Miniature Bearings Australia Pty Ltd

MBA Size Listings are a guide to sizes only and must not be solely relied on for critical design information.

Bushes - Plastic - Iglidur W300 - Unflanged

Part Number	Nom. ID (d) mm <i>inches</i>	Nom. OD (D) mm <i>inches</i>	Length (s) mm <i>inches</i>	Tolerance of ID after Pressfit
# BP00600-00800-0138-W3	6.000 <i>0.236</i>	8.000 <i>0.315</i>	13.800 <i>0.543</i>	+0.020/+0.068
# BP00635-00794-0048-W3	6.350 <i>0.250</i>	7.938 <i>0.313</i>	4.763 <i>0.188</i>	
# BP00635-00794-0064-W3	6.350 <i>0.250</i>	7.938 <i>0.313</i>	6.350 <i>0.250</i>	
# BP00635-00794-0079-W3	6.350 <i>0.250</i>	7.938 <i>0.313</i>	7.938 <i>0.313</i>	
# BP00635-00794-0095-W3	6.350 <i>0.250</i>	7.938 <i>0.313</i>	9.525 <i>0.375</i>	
# BP00635-00794-0127-W3	6.350 <i>0.250</i>	7.938 <i>0.313</i>	12.700 <i>0.500</i>	
# BP00635-00794-0175-W3	6.350 <i>0.250</i>	7.938 <i>0.313</i>	17.463 <i>0.688</i>	
# BP00700-00900-0090-W3	7.000 <i>0.276</i>	9.000 <i>0.354</i>	9.000 <i>0.354</i>	+0.025/+0.083
# BP00700-00900-0120-W3	7.000 <i>0.276</i>	9.000 <i>0.354</i>	12.000 <i>0.472</i>	+0.025/+0.083
# BP00794-00953-0064-W3	7.938 <i>0.313</i>	9.525 <i>0.375</i>	6.350 <i>0.250</i>	

Indicates item not stocked at time of printing - Please enquire for lead time
 E&OE Pricing and all details subject to change without notice - Copyright Miniature Bearings Australia Pty Ltd
 MBA Size Listings are a guide to sizes only and must not be solely relied on for critical design information.

Bushes - Plastic - Iglidur W300 - Unflanged

Part Number	Nom. ID (d) mm <i>inches</i>	Nom. OD (D) mm <i>inches</i>	Length (s) mm <i>inches</i>	Tolerance of ID after Pressfit
# BP00794-00953-0095-W3	7.938 <i>0.313</i>	9.525 <i>0.375</i>	9.525 <i>0.375</i>	
# BP00794-00953-0127-W3	7.938 <i>0.313</i>	9.525 <i>0.375</i>	12.700 <i>0.500</i>	
# BP00794-00953-0191-W3	7.938 <i>0.313</i>	9.525 <i>0.375</i>	19.050 <i>0.750</i>	
# BP00800-01000-0060-W3	8.000 <i>0.315</i>	10.000 <i>0.394</i>	6.000 <i>0.236</i>	+0.025/+0.083
# BP00800-01000-0080-W3	8.000 <i>0.315</i>	10.000 <i>0.394</i>	8.000 <i>0.315</i>	+0.025/+0.083
# BP00800-01000-0100-W3	8.000 <i>0.315</i>	10.000 <i>0.394</i>	10.000 <i>0.394</i>	+0.025/+0.083
# BP00800-01000-0120-W3	8.000 <i>0.315</i>	10.000 <i>0.394</i>	12.000 <i>0.472</i>	+0.025/+0.083
# BP00800-01000-0138-W3	8.000 <i>0.315</i>	10.000 <i>0.394</i>	13.800 <i>0.543</i>	+0.025/+0.083
# BP00800-01000-0150-W3	8.000 <i>0.315</i>	10.000 <i>0.394</i>	15.000 <i>0.591</i>	+0.025/+0.083
# BP00800-01000-0160-W3	8.000 <i>0.315</i>	10.000 <i>0.394</i>	16.000 <i>0.630</i>	+0.025/+0.083

Indicates item not stocked at time of printing - Please enquire for lead time
 E&OE Pricing and all details subject to change without notice - Copyright Miniature Bearings Australia Pty Ltd
 MBA Size Listings are a guide to sizes only and must not be solely relied on for critical design information.

Bushes - Plastic - Iglidur W300 - Unflanged

Part Number	Nom. ID (d) mm <i>inches</i>	Nom. OD (D) mm <i>inches</i>	Length (s) mm <i>inches</i>	Tolerance of ID after Pressfit
# BP00800-01000-0200-W3	8.000 <i>0.315</i>	10.000 <i>0.394</i>	20.000 <i>0.787</i>	+0.025/+0.083
# BP00900-01100-0060-W3	9.000 <i>0.354</i>	11.000 <i>0.433</i>	6.000 <i>0.236</i>	+0.025/+0.083
BP00953-01191-0064-W3	9.525 <i>0.375</i>	11.906 <i>0.469</i>	6.350 <i>0.250</i>	
BP00953-01191-0095-W3	9.525 <i>0.375</i>	11.906 <i>0.469</i>	9.525 <i>0.375</i>	
# BP00953-01191-0111-W3	9.525 <i>0.375</i>	11.906 <i>0.469</i>	11.113 <i>0.438</i>	
# BP00953-01191-0127-W3	9.525 <i>0.375</i>	11.906 <i>0.469</i>	12.700 <i>0.500</i>	
# BP00953-01191-0191-W3	9.525 <i>0.375</i>	11.906 <i>0.469</i>	19.050 <i>0.750</i>	
# BP00953-01349-0191-W3	9.525 <i>0.375</i>	13.494 <i>0.531</i>	19.050 <i>0.750</i>	
# BP01000-01200-0040-W3	10.000 <i>0.394</i>	12.000 <i>0.472</i>	4.000 <i>0.157</i>	+0.025/+0.083
# BP01000-01200-0060-W3	10.000 <i>0.394</i>	12.000 <i>0.472</i>	6.000 <i>0.236</i>	+0.025/+0.083

Indicates item not stocked at time of printing - Please enquire for lead time
 E&OE Pricing and all details subject to change without notice - Copyright Miniature Bearings Australia Pty Ltd
 MBA Size Listings are a guide to sizes only and must not be solely relied on for critical design information.

Bushes - Plastic - Iglidur W300 - Unflanged

Part Number	Nom. ID (d) mm <i>inches</i>	Nom. OD (D) mm <i>inches</i>	Length (s) mm <i>inches</i>	Tolerance of ID after Pressfit
# BP01000-01200-0080-W3	10.000 <i>0.394</i>	12.000 <i>0.472</i>	8.000 <i>0.315</i>	+0.025/+0.083
# BP01000-01200-0090-W3	10.000 <i>0.394</i>	12.000 <i>0.472</i>	9.000 <i>0.354</i>	+0.025/+0.083
# BP01000-01200-0100-W3	10.000 <i>0.394</i>	12.000 <i>0.472</i>	10.000 <i>0.394</i>	+0.025/+0.083
# BP01000-01200-0120-W3	10.000 <i>0.394</i>	12.000 <i>0.472</i>	12.000 <i>0.472</i>	+0.025/+0.083
# BP01000-01200-0150-W3	10.000 <i>0.394</i>	12.000 <i>0.472</i>	15.000 <i>0.591</i>	+0.025/+0.083
# BP01000-01200-0170-W3	10.000 <i>0.394</i>	12.000 <i>0.472</i>	17.000 <i>0.669</i>	+0.025/+0.083
# BP01000-01200-0200-W3	10.000 <i>0.394</i>	12.000 <i>0.472</i>	20.000 <i>0.787</i>	+0.025/+0.083
# BP01100-01300-0080-W3	11.000 <i>0.433</i>	13.000 <i>0.512</i>	8.000 <i>0.315</i>	+0.032/+0.102
# BP01111-01349-0064-W3	11.113 <i>0.438</i>	13.494 <i>0.531</i>	6.350 <i>0.250</i>	
# BP01111-01349-0127-W3	11.113 <i>0.438</i>	13.494 <i>0.531</i>	12.700 <i>0.500</i>	

Indicates item not stocked at time of printing - Please enquire for lead time

E&OE Pricing and all details subject to change without notice - Copyright Miniature Bearings Australia Pty Ltd

MBA Size Listings are a guide to sizes only and must not be solely relied on for critical design information.

Bushes - Plastic - Iglidur W300 - Unflanged

Part Number	Nom. ID (d) mm <i>inches</i>	Nom. OD (D) mm <i>inches</i>	Length (s) mm <i>inches</i>	Tolerance of ID after Pressfit
# BP01200-01400-0040-W3	12.000 <i>0.472</i>	14.000 <i>0.551</i>	4.000 <i>0.157</i>	+0.032/+0.102
# BP01200-01400-0050-W3	12.000 <i>0.472</i>	14.000 <i>0.551</i>	5.000 <i>0.197</i>	+0.032/+0.102
# BP01200-01400-0060-W3	12.000 <i>0.472</i>	14.000 <i>0.551</i>	6.000 <i>0.236</i>	+0.032/+0.102
# BP01200-01400-0080-W3	12.000 <i>0.472</i>	14.000 <i>0.551</i>	8.000 <i>0.315</i>	+0.032/+0.102
# BP01200-01400-0100-W3	12.000 <i>0.472</i>	14.000 <i>0.551</i>	10.000 <i>0.394</i>	+0.032/+0.102
# BP01200-01400-0120-W3	12.000 <i>0.472</i>	14.000 <i>0.551</i>	12.000 <i>0.472</i>	+0.032/+0.102
# BP01200-01400-0150-W3	12.000 <i>0.472</i>	14.000 <i>0.551</i>	15.000 <i>0.591</i>	+0.032/+0.102
# BP01200-01400-0200-W3	12.000 <i>0.472</i>	14.000 <i>0.551</i>	20.000 <i>0.787</i>	+0.032/+0.102
# BP01200-01400-0250-W3	12.000 <i>0.472</i>	14.000 <i>0.551</i>	25.000 <i>0.984</i>	+0.032/+0.102
# BP01270-01508-0048-W3	12.700 <i>0.500</i>	15.081 <i>0.594</i>	4.763 <i>0.188</i>	

Indicates item not stocked at time of printing - Please enquire for lead time

E&OE Pricing and all details subject to change without notice - Copyright Miniature Bearings Australia Pty Ltd

MBA Size Listings are a guide to sizes only and must not be solely relied on for critical design information.

Bushes - Plastic - Iglidur W300 - Unflanged

Part Number	Nom. ID (d) mm <i>inches</i>	Nom. OD (D) mm <i>inches</i>	Length (s) mm <i>inches</i>	Tolerance of ID after Pressfit
# BP01270-01508-0095-W3	12.700 <i>0.500</i>	15.081 <i>0.594</i>	9.525 <i>0.375</i>	
# BP01270-01508-0127-W3	12.700 <i>0.500</i>	15.081 <i>0.594</i>	12.700 <i>0.500</i>	
# BP01270-01508-0159-W3	12.700 <i>0.500</i>	15.081 <i>0.594</i>	15.875 <i>0.625</i>	
# BP01270-01508-0254-W3	12.700 <i>0.500</i>	15.081 <i>0.594</i>	25.400 <i>1.000</i>	
# BP01270-01588-0127-W3	12.700 <i>0.500</i>	15.875 <i>0.625</i>	12.700 <i>0.500</i>	
# BP01270-01588-0159-W3	12.700 <i>0.500</i>	15.875 <i>0.625</i>	15.875 <i>0.625</i>	
# BP01270-01588-0191-W3	12.700 <i>0.500</i>	15.875 <i>0.625</i>	19.050 <i>0.750</i>	
# BP01270-01588-0254-W3	12.700 <i>0.500</i>	15.875 <i>0.625</i>	25.400 <i>1.000</i>	
# BP01300-01500-0070-W3	13.000 <i>0.512</i>	15.000 <i>0.591</i>	7.000 <i>0.276</i>	+0.032/+0.102
# BP01300-01500-0100-W3	13.000 <i>0.512</i>	15.000 <i>0.591</i>	10.000 <i>0.394</i>	+0.032/+0.102

Indicates item not stocked at time of printing - Please enquire for lead time

E&OE Pricing and all details subject to change without notice - Copyright Miniature Bearings Australia Pty Ltd

MBA Size Listings are a guide to sizes only and must not be solely relied on for critical design information.

Bushes - Plastic - Iglidur W300 - Unflanged

Part Number	Nom. ID (d) mm <i>inches</i>	Nom. OD (D) mm <i>inches</i>	Length (s) mm <i>inches</i>	Tolerance of ID after Pressfit
# BP01300-01500-0150-W3	13.000 <i>0.512</i>	15.000 <i>0.591</i>	15.000 <i>0.591</i>	+0.032/+0.102
# BP01300-01500-0200-W3	13.000 <i>0.512</i>	15.000 <i>0.591</i>	20.000 <i>0.787</i>	+0.032/+0.102
# BP01400-01600-0075-W3	14.000 <i>0.551</i>	16.000 <i>0.630</i>	7.500 <i>0.295</i>	+0.032/+0.102
# BP01400-01600-0150-W3	14.000 <i>0.551</i>	16.000 <i>0.630</i>	15.000 <i>0.591</i>	+0.032/+0.102
# BP01400-01600-0200-W3	14.000 <i>0.551</i>	16.000 <i>0.630</i>	20.000 <i>0.787</i>	+0.032/+0.102
# BP01400-01600-0250-W3	14.000 <i>0.551</i>	16.000 <i>0.630</i>	25.000 <i>0.984</i>	+0.032/+0.102
# BP01400-01600-0330-W3	14.000 <i>0.551</i>	16.000 <i>0.630</i>	33.000 <i>1.299</i>	+0.032/+0.102
# BP01429-01588-0127-W3	14.288 <i>0.563</i>	15.875 <i>0.625</i>	12.700 <i>0.500</i>	
# BP01429-01588-0191-W3	14.288 <i>0.563</i>	15.875 <i>0.625</i>	19.050 <i>0.750</i>	
# BP01500-01700-0100-W3	15.000 <i>0.591</i>	17.000 <i>0.669</i>	10.000 <i>0.394</i>	+0.032/+0.102

Indicates item not stocked at time of printing - Please enquire for lead time

E&OE Pricing and all details subject to change without notice - Copyright Miniature Bearings Australia Pty Ltd

MBA Size Listings are a guide to sizes only and must not be solely relied on for critical design information.

Bushes - Plastic - Iglidur W300 - Unflanged

Part Number	Nom. ID (d) mm <i>inches</i>	Nom. OD (D) mm <i>inches</i>	Length (s) mm <i>inches</i>	Tolerance of ID after Pressfit
# BP01500-01700-0150-W3	15.000 <i>0.591</i>	17.000 <i>0.669</i>	15.000 <i>0.591</i>	+0.032/+0.102
# BP01500-01700-0200-W3	15.000 <i>0.591</i>	17.000 <i>0.669</i>	20.000 <i>0.787</i>	+0.032/+0.102
# BP01500-01700-0250-W3	15.000 <i>0.591</i>	17.000 <i>0.669</i>	25.000 <i>0.984</i>	+0.032/+0.102
# BP01588-01826-0064-W3	15.875 <i>0.625</i>	18.256 <i>0.719</i>	6.350 <i>0.250</i>	
# BP01588-01826-0095-W3	15.875 <i>0.625</i>	18.256 <i>0.719</i>	9.525 <i>0.375</i>	
# BP01588-01826-0127-W3	15.875 <i>0.625</i>	18.256 <i>0.719</i>	12.700 <i>0.500</i>	
# BP01588-01826-0159-W3	15.875 <i>0.625</i>	18.256 <i>0.719</i>	15.875 <i>0.625</i>	
# BP01588-01826-0191-W3	15.875 <i>0.625</i>	18.256 <i>0.719</i>	19.050 <i>0.750</i>	
# BP01588-01826-0254-W3	15.875 <i>0.625</i>	18.256 <i>0.719</i>	25.400 <i>1.000</i>	
# BP01600-01800-0070-W3	16.000 <i>0.630</i>	18.000 <i>0.709</i>	7.000 <i>0.276</i>	+0.032/+0.102

Indicates item not stocked at time of printing - Please enquire for lead time

E&OE Pricing and all details subject to change without notice - Copyright Miniature Bearings Australia Pty Ltd

MBA Size Listings are a guide to sizes only and must not be solely relied on for critical design information.

Bushes - Plastic - Iglidur W300 - Unflanged

Part Number	Nom. ID (d) mm <i>inches</i>	Nom. OD (D) mm <i>inches</i>	Length (s) mm <i>inches</i>	Tolerance of ID after Pressfit
# BP01600-01800-0080-W3	16.000 <i>0.630</i>	18.000 <i>0.709</i>	8.000 <i>0.315</i>	+0.032/+0.102
# BP01600-01800-0115-W3	16.000 <i>0.630</i>	18.000 <i>0.709</i>	11.500 <i>0.453</i>	+0.032/+0.102
# BP01600-01800-0120-W3	16.000 <i>0.630</i>	18.000 <i>0.709</i>	12.000 <i>0.472</i>	+0.032/+0.102
# BP01600-01800-0150-W3	16.000 <i>0.630</i>	18.000 <i>0.709</i>	15.000 <i>0.591</i>	+0.032/+0.102
# BP01600-01800-0200-W3	16.000 <i>0.630</i>	18.000 <i>0.709</i>	20.000 <i>0.787</i>	+0.032/+0.102
# BP01600-01800-0250-W3	16.000 <i>0.630</i>	18.000 <i>0.709</i>	25.000 <i>0.984</i>	+0.032/+0.102
# BP01746-01984-0191-W3	17.463 <i>0.688</i>	19.844 <i>0.781</i>	19.050 <i>0.750</i>	
# BP01800-02000-0150-W3	18.000 <i>0.709</i>	20.000 <i>0.787</i>	15.000 <i>0.591</i>	+0.032/+0.102
# BP01800-02000-0200-W3	18.000 <i>0.709</i>	20.000 <i>0.787</i>	20.000 <i>0.787</i>	+0.032/+0.102
# BP01800-02000-0250-W3	18.000 <i>0.709</i>	20.000 <i>0.787</i>	25.000 <i>0.984</i>	+0.032/+0.102

Indicates item not stocked at time of printing - Please enquire for lead time

E&OE Pricing and all details subject to change without notice - Copyright Miniature Bearings Australia Pty Ltd

MBA Size Listings are a guide to sizes only and must not be solely relied on for critical design information.

Bushes - Plastic - Iglidur W300 - Unflanged

Part Number	Nom. ID (d) mm <i>inches</i>	Nom. OD (D) mm <i>inches</i>	Length (s) mm <i>inches</i>	Tolerance of ID after Pressfit
# BP01800-02000-0330-W3	18.000 <i>0.709</i>	20.000 <i>0.787</i>	33.000 <i>1.299</i>	+0.032/+0.102
# BP01900-02200-0280-W3	19.000 <i>0.748</i>	22.000 <i>0.866</i>	28.000 <i>1.102</i>	+0.040/+0.124
# BP01905-02223-0127-W3	19.050 <i>0.750</i>	22.225 <i>0.875</i>	12.700 <i>0.500</i>	
# BP01905-02223-0191-W3	19.050 <i>0.750</i>	22.225 <i>0.875</i>	19.050 <i>0.750</i>	
# BP01905-02223-0254-W3	19.050 <i>0.750</i>	22.225 <i>0.875</i>	25.400 <i>1.000</i>	
# BP01905-02223-0381-W3	19.050 <i>0.750</i>	22.225 <i>0.875</i>	38.100 <i>1.500</i>	
# BP02000-02200-0115-W3	20.000 <i>0.787</i>	22.000 <i>0.866</i>	11.500 <i>0.453</i>	+0.040/+0.124
# BP02000-02200-0120-W3	20.000 <i>0.787</i>	22.000 <i>0.866</i>	12.000 <i>0.472</i>	+0.040/+0.124
# BP02000-02200-0150-W3	20.000 <i>0.787</i>	22.000 <i>0.866</i>	15.000 <i>0.591</i>	+0.040/+0.124
# BP02000-02200-0200-W3	20.000 <i>0.787</i>	22.000 <i>0.866</i>	20.000 <i>0.787</i>	+0.040/+0.124

Indicates item not stocked at time of printing - Please enquire for lead time
 E&OE Pricing and all details subject to change without notice - Copyright Miniature Bearings Australia Pty Ltd
 MBA Size Listings are a guide to sizes only and must not be solely relied on for critical design information.

Bushes - Plastic - Iglidur W300 - Unflanged

Part Number	Nom. ID (d) mm <i>inches</i>	Nom. OD (D) mm <i>inches</i>	Length (s) mm <i>inches</i>	Tolerance of ID after Pressfit
# BP02000-02200-0300-W3	20.000 <i>0.787</i>	22.000 <i>0.866</i>	30.000 <i>1.181</i>	+0.040/+0.124
# BP02000-02300-0150-W3	20.000 <i>0.787</i>	23.000 <i>0.906</i>	15.000 <i>0.591</i>	+0.040/+0.124
# BP02000-02300-0200-W3	20.000 <i>0.787</i>	23.000 <i>0.906</i>	20.000 <i>0.787</i>	+0.040/+0.124
# BP02000-02300-0230-W3	20.000 <i>0.787</i>	23.000 <i>0.906</i>	23.000 <i>0.906</i>	+0.040/+0.124
# BP02000-02300-0250-W3	20.000 <i>0.787</i>	23.000 <i>0.906</i>	25.000 <i>0.984</i>	+0.040/+0.124
# BP02000-02300-0300-W3	20.000 <i>0.787</i>	23.000 <i>0.906</i>	30.000 <i>1.181</i>	+0.040/+0.124
# BP02200-02400-0150-W3	22.000 <i>0.866</i>	24.000 <i>0.945</i>	15.000 <i>0.591</i>	+0.040/+0.124
# BP02200-02400-0200-W3	22.000 <i>0.866</i>	24.000 <i>0.945</i>	20.000 <i>0.787</i>	+0.040/+0.124
# BP02200-02400-0300-W3	22.000 <i>0.866</i>	24.000 <i>0.945</i>	30.000 <i>1.181</i>	+0.040/+0.124
# BP02200-02400-0350-W3	22.000 <i>0.866</i>	24.000 <i>0.945</i>	35.000 <i>1.378</i>	+0.040/+0.124

Indicates item not stocked at time of printing - Please enquire for lead time
E&OE Pricing and all details subject to change without notice - Copyright Miniature Bearings Australia Pty Ltd
MBA Size Listings are a guide to sizes only and must not be solely relied on for critical design information.

Bushes - Plastic - Iglidur W300 - Unflanged

Part Number	Nom. ID (d) mm <i>inches</i>	Nom. OD (D) mm <i>inches</i>	Length (s) mm <i>inches</i>	Tolerance of ID after Pressfit
# BP02200-02500-0150-W3	22.000 <i>0.866</i>	25.000 <i>0.984</i>	15.000 <i>0.591</i>	+0.040/+0.124
# BP02200-02500-0200-W3	22.000 <i>0.866</i>	25.000 <i>0.984</i>	20.000 <i>0.787</i>	+0.040/+0.124
# BP02200-02500-0250-W3	22.000 <i>0.866</i>	25.000 <i>0.984</i>	25.000 <i>0.984</i>	+0.040/+0.124
# BP02200-02500-0300-W3	22.000 <i>0.866</i>	25.000 <i>0.984</i>	30.000 <i>1.181</i>	+0.040/+0.124
# BP02223-02540-0064-W3	22.225 <i>0.875</i>	25.400 <i>1.000</i>	6.350 <i>0.250</i>	
# BP02223-02540-0095-W3	22.225 <i>0.875</i>	25.400 <i>1.000</i>	9.525 <i>0.375</i>	
# BP02223-02540-0127-W3	22.225 <i>0.875</i>	25.400 <i>1.000</i>	12.700 <i>0.500</i>	
# BP02223-02540-0159-W3	22.225 <i>0.875</i>	25.400 <i>1.000</i>	15.875 <i>0.625</i>	
# BP02223-02540-0191-W3	22.225 <i>0.875</i>	25.400 <i>1.000</i>	19.050 <i>0.750</i>	
# BP02223-02540-0254-W3	22.225 <i>0.875</i>	25.400 <i>1.000</i>	25.400 <i>1.000</i>	

Indicates item not stocked at time of printing - Please enquire for lead time
 E&OE Pricing and all details subject to change without notice - Copyright Miniature Bearings Australia Pty Ltd
 MBA Size Listings are a guide to sizes only and must not be solely relied on for critical design information.

Bushes - Plastic - Iglidur W300 - Unflanged

Part Number	Nom. ID (d) mm <i>inches</i>	Nom. OD (D) mm <i>inches</i>	Length (s) mm <i>inches</i>	Tolerance of ID after Pressfit
# BP02223-02540-0381-W3	22.225 <i>0.875</i>	25.400 <i>1.000</i>	38.100 <i>1.500</i>	
# BP02400-02700-0150-W3	24.000 <i>0.945</i>	27.000 <i>1.063</i>	15.000 <i>0.591</i>	+0.040/+0.124
# BP02400-02700-0200-W3	24.000 <i>0.945</i>	27.000 <i>1.063</i>	20.000 <i>0.787</i>	+0.040/+0.124
# BP02400-02700-0250-W3	24.000 <i>0.945</i>	27.000 <i>1.063</i>	25.000 <i>0.984</i>	+0.040/+0.124
# BP02400-02700-0300-W3	24.000 <i>0.945</i>	27.000 <i>1.063</i>	30.000 <i>1.181</i>	+0.040/+0.124
# BP02500-02800-0120-W3	25.000 <i>0.984</i>	28.000 <i>1.102</i>	12.000 <i>0.472</i>	+0.040/+0.124
# BP02500-02800-0140-W3	25.000 <i>0.984</i>	28.000 <i>1.102</i>	14.000 <i>0.551</i>	+0.040/+0.124
# BP02500-02800-0150-W3	25.000 <i>0.984</i>	28.000 <i>1.102</i>	15.000 <i>0.591</i>	+0.040/+0.124
# BP02500-02800-0200-W3	25.000 <i>0.984</i>	28.000 <i>1.102</i>	20.000 <i>0.787</i>	+0.040/+0.124
# BP02500-02800-0250-W3	25.000 <i>0.984</i>	28.000 <i>1.102</i>	25.000 <i>0.984</i>	+0.040/+0.124

Indicates item not stocked at time of printing - Please enquire for lead time

E&OE Pricing and all details subject to change without notice - Copyright Miniature Bearings Australia Pty Ltd

MBA Size Listings are a guide to sizes only and must not be solely relied on for critical design information.

Bushes - Plastic - Iglidur W300 - Unflanged

Part Number	Nom. ID (d) mm <i>inches</i>	Nom. OD (D) mm <i>inches</i>	Length (s) mm <i>inches</i>	Tolerance of ID after Pressfit
# BP02500-02800-0300-W3	25.000 <i>0.984</i>	28.000 <i>1.102</i>	30.000 <i>1.181</i>	+0.040/+0.124
# BP02540-02858-0095-W3	25.400 <i>1.000</i>	28.575 <i>1.125</i>	9.525 <i>0.375</i>	
# BP02540-02858-0127-W3	25.400 <i>1.000</i>	28.575 <i>1.125</i>	12.700 <i>0.500</i>	
# BP02540-02858-0191-W3	25.400 <i>1.000</i>	28.575 <i>1.125</i>	19.050 <i>0.750</i>	
# BP02540-02858-0254-W3	25.400 <i>1.000</i>	28.575 <i>1.125</i>	25.400 <i>1.000</i>	
# BP02540-02858-0333-W3	25.400 <i>1.000</i>	28.575 <i>1.125</i>	33.338 <i>1.313</i>	
# BP02540-02858-0349-W3	25.400 <i>1.000</i>	28.575 <i>1.125</i>	34.925 <i>1.375</i>	
# BP02540-02858-0381-W3	25.400 <i>1.000</i>	28.575 <i>1.125</i>	38.100 <i>1.500</i>	
# BP02600-03000-0160-W3	26.000 <i>1.024</i>	30.000 <i>1.181</i>	16.000 <i>0.630</i>	+0.040/+0.124
# BP02800-03000-0100-W3	28.000 <i>1.102</i>	30.000 <i>1.181</i>	10.000 <i>0.394</i>	+0.040/+0.124

Indicates item not stocked at time of printing - Please enquire for lead time
 E&OE Pricing and all details subject to change without notice - Copyright Miniature Bearings Australia Pty Ltd
 MBA Size Listings are a guide to sizes only and must not be solely relied on for critical design information.

Bushes - Plastic - Iglidur W300 - Unflanged

Part Number	Nom. ID (d) mm <i>inches</i>	Nom. OD (D) mm <i>inches</i>	Length (s) mm <i>inches</i>	Tolerance of ID after Pressfit
# BP02800-03100-0100-W3	28.000 <i>1.102</i>	31.000 <i>1.220</i>	10.000 <i>0.394</i>	+0.040/+0.124
# BP02800-03200-0200-W3	28.000 <i>1.102</i>	32.000 <i>1.260</i>	20.000 <i>0.787</i>	+0.040/+0.124
# BP02800-03200-0250-W3	28.000 <i>1.102</i>	32.000 <i>1.260</i>	25.000 <i>0.984</i>	+0.040/+0.124
# BP02800-03200-0300-W3	28.000 <i>1.102</i>	32.000 <i>1.260</i>	30.000 <i>1.181</i>	+0.040/+0.124
# BP02858-03254-0191-W3	28.575 <i>1.125</i>	32.544 <i>1.281</i>	19.050 <i>0.750</i>	
# BP03000-03400-0160-W3	30.000 <i>1.181</i>	34.000 <i>1.339</i>	16.000 <i>0.630</i>	+0.040/+0.124
# BP03000-03400-0200-W3	30.000 <i>1.181</i>	34.000 <i>1.339</i>	20.000 <i>0.787</i>	+0.040/+0.124
# BP03000-03400-0250-W3	30.000 <i>1.181</i>	34.000 <i>1.339</i>	25.000 <i>0.984</i>	+0.040/+0.124
# BP03000-03400-0300-W3	30.000 <i>1.181</i>	34.000 <i>1.339</i>	30.000 <i>1.181</i>	+0.040/+0.124
# BP03000-03400-0360-W3	30.000 <i>1.181</i>	34.000 <i>1.339</i>	36.000 <i>1.417</i>	+0.040/+0.124

Indicates item not stocked at time of printing - Please enquire for lead time

E&OE Pricing and all details subject to change without notice - Copyright Miniature Bearings Australia Pty Ltd

MBA Size Listings are a guide to sizes only and must not be solely relied on for critical design information.

Bushes - Plastic - Iglidur W300 - Unflanged

Part Number	Nom. ID (d) mm <i>inches</i>	Nom. OD (D) mm <i>inches</i>	Length (s) mm <i>inches</i>	Tolerance of ID after Pressfit
# BP03000-03400-0380-W3	30.000 <i>1.181</i>	34.000 <i>1.339</i>	38.000 <i>1.496</i>	+0.040/+0.124
# BP03000-03400-0400-W3	30.000 <i>1.181</i>	34.000 <i>1.339</i>	40.000 <i>1.575</i>	+0.040/+0.124
# BP03175-03572-0222-W3	31.750 <i>1.250</i>	35.719 <i>1.406</i>	22.225 <i>0.875</i>	
# BP03175-03572-0254-W3	31.750 <i>1.250</i>	35.719 <i>1.406</i>	25.400 <i>1.000</i>	
# BP03175-03572-0318-W3	31.750 <i>1.250</i>	35.719 <i>1.406</i>	31.750 <i>1.250</i>	
# BP03175-03572-0381-W3	31.750 <i>1.250</i>	35.719 <i>1.406</i>	38.100 <i>1.500</i>	
# BP03200-03600-0200-W3	32.000 <i>1.260</i>	36.000 <i>1.417</i>	20.000 <i>0.787</i>	+0.050/+0.150
# BP03200-03600-0300-W3	32.000 <i>1.260</i>	36.000 <i>1.417</i>	30.000 <i>1.181</i>	+0.050/+0.150
# BP03200-03600-0400-W3	32.000 <i>1.260</i>	36.000 <i>1.417</i>	40.000 <i>1.575</i>	+0.050/+0.150
# BP03493-03889-0254-W3	34.925 <i>1.375</i>	38.894 <i>1.531</i>	25.400 <i>1.000</i>	

Indicates item not stocked at time of printing - Please enquire for lead time
 E&OE Pricing and all details subject to change without notice - Copyright Miniature Bearings Australia Pty Ltd
 MBA Size Listings are a guide to sizes only and must not be solely relied on for critical design information.

Bushes - Plastic - Iglidur W300 - Unflanged

Part Number	Nom. ID (d) mm <i>inches</i>	Nom. OD (D) mm <i>inches</i>	Length (s) mm <i>inches</i>	Tolerance of ID after Pressfit
# BP03493-03889-0381-W3	34.925 <i>1.375</i>	38.894 <i>1.531</i>	38.100 <i>1.500</i>	
# BP03500-03900-0200-W3	35.000 <i>1.378</i>	39.000 <i>1.535</i>	20.000 <i>0.787</i>	+0.050/+0.150
# BP03500-03900-0300-W3	35.000 <i>1.378</i>	39.000 <i>1.535</i>	30.000 <i>1.181</i>	+0.050/+0.150
# BP03500-03900-0400-W3	35.000 <i>1.378</i>	39.000 <i>1.535</i>	40.000 <i>1.575</i>	+0.050/+0.150
# BP03500-03900-0500-W3	35.000 <i>1.378</i>	39.000 <i>1.535</i>	50.000 <i>1.969</i>	+0.050/+0.150
# BP03810-04207-0191-W3	38.100 <i>1.500</i>	42.069 <i>1.656</i>	19.050 <i>0.750</i>	
# BP03810-04207-0254-W3	38.100 <i>1.500</i>	42.069 <i>1.656</i>	25.400 <i>1.000</i>	
# BP03810-04207-0381-W3	38.100 <i>1.500</i>	42.069 <i>1.656</i>	38.100 <i>1.500</i>	
# BP03810-04207-0699-W3	38.100 <i>1.500</i>	42.069 <i>1.656</i>	69.850 <i>2.750</i>	
# BP04000-04400-0200-W3	40.000 <i>1.575</i>	44.000 <i>1.732</i>	20.000 <i>0.787</i>	+0.050/+0.150

Indicates item not stocked at time of printing - Please enquire for lead time

E&OE Pricing and all details subject to change without notice - Copyright Miniature Bearings Australia Pty Ltd

MBA Size Listings are a guide to sizes only and must not be solely relied on for critical design information.

Bushes - Plastic - Iglidur W300 - Unflanged

Part Number	Nom. ID (d) mm <i>inches</i>	Nom. OD (D) mm <i>inches</i>	Length (s) mm <i>inches</i>	Tolerance of ID after Pressfit
# BP04000-04400-0300-W3	40.000 <i>1.575</i>	44.000 <i>1.732</i>	30.000 <i>1.181</i>	+0.050/+0.150
# BP04000-04400-0400-W3	40.000 <i>1.575</i>	44.000 <i>1.732</i>	40.000 <i>1.575</i>	+0.050/+0.150
# BP04000-04400-0500-W3	40.000 <i>1.575</i>	44.000 <i>1.732</i>	50.000 <i>1.969</i>	+0.050/+0.150
# BP04445-04961-0254-W3	44.450 <i>1.750</i>	49.609 <i>1.953</i>	25.400 <i>1.000</i>	
# BP04445-04961-0381-W3	44.450 <i>1.750</i>	49.609 <i>1.953</i>	38.100 <i>1.500</i>	
# BP04445-04961-0508-W3	44.450 <i>1.750</i>	49.609 <i>1.953</i>	50.800 <i>2.000</i>	
# BP04445-04961-0762-W3	44.450 <i>1.750</i>	49.609 <i>1.953</i>	76.200 <i>3.000</i>	
# BP04500-05000-0300-W3	45.000 <i>1.772</i>	50.000 <i>1.969</i>	30.000 <i>1.181</i>	+0.050/+0.150
# BP04500-05000-0500-W3	45.000 <i>1.772</i>	50.000 <i>1.969</i>	50.000 <i>1.969</i>	+0.050/+0.150
# BP04524-04961-0254-W3	45.244 <i>1.781</i>	49.609 <i>1.953</i>	25.400 <i>1.000</i>	

Indicates item not stocked at time of printing - Please enquire for lead time
 E&OE Pricing and all details subject to change without notice - Copyright Miniature Bearings Australia Pty Ltd
 MBA Size Listings are a guide to sizes only and must not be solely relied on for critical design information.

Bushes - Plastic - Iglidur W300 - Unflanged

Part Number	Nom. ID (d) mm <i>inches</i>	Nom. OD (D) mm <i>inches</i>	Length (s) mm <i>inches</i>	Tolerance of ID after Pressfit
# BP04524-04961-0318-W3	45.244 <i>1.781</i>	49.609 <i>1.953</i>	31.750 <i>1.250</i>	
# BP05000-05500-0200-W3	50.000 <i>1.969</i>	55.000 <i>2.165</i>	20.000 <i>0.787</i>	+0.050/+0.150
# BP05000-05500-0300-W3	50.000 <i>1.969</i>	55.000 <i>2.165</i>	30.000 <i>1.181</i>	+0.050/+0.150
# BP05000-05500-0400-W3	50.000 <i>1.969</i>	55.000 <i>2.165</i>	40.000 <i>1.575</i>	+0.050/+0.150
# BP05000-05500-0500-W3	50.000 <i>1.969</i>	55.000 <i>2.165</i>	50.000 <i>1.969</i>	+0.050/+0.150
# BP05080-05556-0254-W3	50.800 <i>2.000</i>	55.563 <i>2.188</i>	25.400 <i>1.000</i>	
# BP05080-05556-0381-W3	50.800 <i>2.000</i>	55.563 <i>2.188</i>	38.100 <i>1.500</i>	
# BP05080-05556-0508-W3	50.800 <i>2.000</i>	55.563 <i>2.188</i>	50.800 <i>2.000</i>	
# BP05500-06000-0400-W3	55.000 <i>2.165</i>	60.000 <i>2.362</i>	40.000 <i>1.575</i>	+0.060/+0.180
# BP05500-06000-0600-W3	55.000 <i>2.165</i>	60.000 <i>2.362</i>	60.000 <i>2.362</i>	+0.060/+0.180

Indicates item not stocked at time of printing - Please enquire for lead time
 E&OE Pricing and all details subject to change without notice - Copyright Miniature Bearings Australia Pty Ltd
 MBA Size Listings are a guide to sizes only and must not be solely relied on for critical design information.

Bushes - Plastic - Iglidur W300 - Unflanged

Part Number	Nom. ID (d) mm <i>inches</i>	Nom. OD (D) mm <i>inches</i>	Length (s) mm <i>inches</i>	Tolerance of ID after Pressfit
# BP05715-06191-0508-W3	57.150 <i>2.250</i>	61.913 <i>2.438</i>	50.800 <i>2.000</i>	
# BP06000-06500-0600-W3	60.000 <i>2.362</i>	65.000 <i>2.559</i>	60.000 <i>2.362</i>	+0.060/+0.180
# BP06500-07000-0600-W3	65.000 <i>2.559</i>	70.000 <i>2.756</i>	60.000 <i>2.362</i>	+0.060/+0.180

Indicates item not stocked at time of printing - Please enquire for lead time

E&OE Pricing and all details subject to change without notice - Copyright Miniature Bearings Australia Pty Ltd

MBA Size Listings are a guide to sizes only and must not be solely relied on for critical design information.

MBA

MINIATURE BEARINGS AUSTRALIA PTY LTD

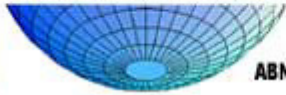

ABN 94 069 113 800



DISTRIBUTED BY

Ask us to put your name and address here

<http://www.minibearings.com.au/product>

Ph +61 7 3245 7977

Fax +61 7 3245 1017

Catalogue requests to catalogues@minibearings.com.au

SDPSI
Stock Drive Products / Spring Instrument

JK

ANOTHER QUALITY PRODUCT BY
MOLYTEC
Australia

Origin
BEARING

WIB

THOMSON

EZO



myonic
solutions in microspace

rino



inox
Quality Products

GRW

DualVee^x
Bishop-Wisecarver Corp.

ondrives
Precision Manufacturing

RMB

SOLARBOTICS^{INTL}

KSK
BALL BEARING