



MBA

Bushes - Plastic - Iglidur X - Unflanged

Very high temperature. Extreme chemical resistance. High compressive strength. Low water absorption.

Specific Gravity 1.44 g/cm³.

Operating Temp 315 C short term / 250 C long term.

Tensile Strength at 20 deg C = 170 Mpa.

Hardness 85 Shore D (DIN53505).

Tolerances listed are after H7 Pressfit.

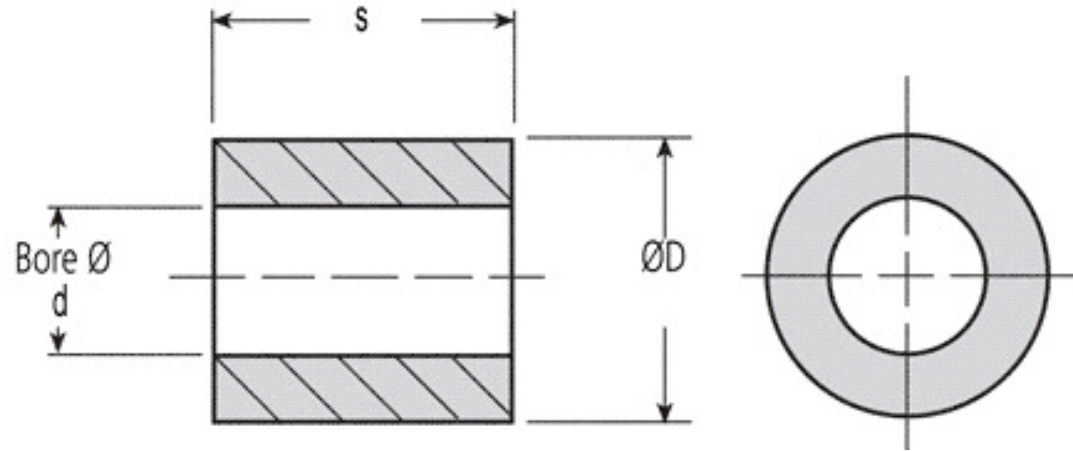

Bushes - Plastic - Iglidur X - Unflanged

Part Number	Nom. ID (d) mm <i>inches</i>	Nom. OD (D) mm <i>inches</i>	Length (s) mm <i>inches</i>	Tolerance of ID after Pressfit
# BP00200-00350-0030-X	2.000 <i>0.079</i>	3.500 <i>0.138</i>	3.000 <i>0.118</i>	+0.006/+0.046
# BP00300-00450-0030-X	3.000 <i>0.118</i>	4.500 <i>0.177</i>	3.000 <i>0.118</i>	+0.006/+0.046
# BP00300-00450-0060-X	3.000 <i>0.118</i>	4.500 <i>0.177</i>	6.000 <i>0.236</i>	+0.006/+0.046

Indicates item not stocked at time of printing - Please enquire for lead time
 E&OE Pricing and all details subject to change without notice - Copyright Miniature Bearings Australia Pty Ltd
 MBA Size Listings are a guide to sizes only and must not be solely relied on for critical design information.

Bushes - Plastic - Iglidur X - Unflanged

Part Number	Nom. ID (d) mm <i>inches</i>	Nom. OD (D) mm <i>inches</i>	Length (s) mm <i>inches</i>	Tolerance of ID after Pressfit
# BP00318-00476-0048-X	3.175 <i>0.125</i>	4.763 <i>0.188</i>	4.763 <i>0.188</i>	
# BP00318-00476-0079-X	3.175 <i>0.125</i>	4.763 <i>0.188</i>	7.938 <i>0.313</i>	
# BP00318-00476-0095-X	3.175 <i>0.125</i>	4.763 <i>0.188</i>	9.525 <i>0.375</i>	
# BP00400-00550-0040-X	4.000 <i>0.157</i>	5.500 <i>0.217</i>	4.000 <i>0.157</i>	+0.010/+0.058
# BP00476-00635-0048-X	4.763 <i>0.188</i>	6.350 <i>0.250</i>	4.763 <i>0.188</i>	
# BP00476-00635-0064-X	4.763 <i>0.188</i>	6.350 <i>0.250</i>	6.350 <i>0.250</i>	
# BP00476-00635-0095-X	4.763 <i>0.188</i>	6.350 <i>0.250</i>	9.525 <i>0.375</i>	
# BP00476-00635-0127-X	4.763 <i>0.188</i>	6.350 <i>0.250</i>	12.700 <i>0.500</i>	
# BP00500-00700-0035-X	5.000 <i>0.197</i>	7.000 <i>0.276</i>	3.500 <i>0.138</i>	+0.010/+0.058
# BP00500-00700-0050-X	5.000 <i>0.197</i>	7.000 <i>0.276</i>	5.000 <i>0.197</i>	+0.010/+0.058

Indicates item not stocked at time of printing - Please enquire for lead time
 E&OE Pricing and all details subject to change without notice - Copyright Miniature Bearings Australia Pty Ltd
 MBA Size Listings are a guide to sizes only and must not be solely relied on for critical design information.

Bushes - Plastic - Iglidur X - Unflanged

Part Number	Nom. ID (d) mm <i>inches</i>	Nom. OD (D) mm <i>inches</i>	Length (s) mm <i>inches</i>	Tolerance of ID after Pressfit
# BP00500-00700-0080-X	5.000 <i>0.197</i>	7.000 <i>0.276</i>	8.000 <i>0.315</i>	+0.010/+0.058
# BP00600-00800-0060-X	6.000 <i>0.236</i>	8.000 <i>0.315</i>	6.000 <i>0.236</i>	+0.010/+0.058
# BP00600-00800-0080-X	6.000 <i>0.236</i>	8.000 <i>0.315</i>	8.000 <i>0.315</i>	+0.010/+0.058
# BP00600-00800-0100-X	6.000 <i>0.236</i>	8.000 <i>0.315</i>	10.000 <i>0.394</i>	+0.010/+0.058
# BP00600-00800-0138-X	6.000 <i>0.236</i>	8.000 <i>0.315</i>	13.800 <i>0.543</i>	+0.010/+0.058
# BP00635-00794-0064-X	6.350 <i>0.250</i>	7.938 <i>0.313</i>	6.350 <i>0.250</i>	
# BP00635-00794-0095-X	6.350 <i>0.250</i>	7.938 <i>0.313</i>	9.525 <i>0.375</i>	
# BP00635-00794-0127-X	6.350 <i>0.250</i>	7.938 <i>0.313</i>	12.700 <i>0.500</i>	
# BP00700-00900-0100-X	7.000 <i>0.276</i>	9.000 <i>0.354</i>	10.000 <i>0.394</i>	+0.013/+0.071
# BP00700-00900-0120-X	7.000 <i>0.276</i>	9.000 <i>0.354</i>	12.000 <i>0.472</i>	+0.013/+0.071

Indicates item not stocked at time of printing - Please enquire for lead time
 E&OE Pricing and all details subject to change without notice - Copyright Miniature Bearings Australia Pty Ltd
 MBA Size Listings are a guide to sizes only and must not be solely relied on for critical design information.

Bushes - Plastic - Iglidur X - Unflanged

Part Number	Nom. ID (d) mm <i>inches</i>	Nom. OD (D) mm <i>inches</i>	Length (s) mm <i>inches</i>	Tolerance of ID after Pressfit
# BP00794-00953-0064-X	7.938 <i>0.313</i>	9.525 <i>0.375</i>	6.350 <i>0.250</i>	
# BP00794-00953-0095-X	7.938 <i>0.313</i>	9.525 <i>0.375</i>	9.525 <i>0.375</i>	
# BP00794-00953-0127-X	7.938 <i>0.313</i>	9.525 <i>0.375</i>	12.700 <i>0.500</i>	
# BP00800-01000-0100-X	8.000 <i>0.315</i>	10.000 <i>0.394</i>	10.000 <i>0.394</i>	+0.013/+0.071
# BP00800-01000-0150-X	8.000 <i>0.315</i>	10.000 <i>0.394</i>	15.000 <i>0.591</i>	+0.013/+0.071
# BP00953-01191-0064-X	9.525 <i>0.375</i>	11.906 <i>0.469</i>	6.350 <i>0.250</i>	
# BP00953-01191-0079-X	9.525 <i>0.375</i>	11.906 <i>0.469</i>	7.938 <i>0.313</i>	
# BP00953-01191-0095-X	9.525 <i>0.375</i>	11.906 <i>0.469</i>	9.525 <i>0.375</i>	
# BP00953-01191-0127-X	9.525 <i>0.375</i>	11.906 <i>0.469</i>	12.700 <i>0.500</i>	
# BP00953-01191-0159-X	9.525 <i>0.375</i>	11.906 <i>0.469</i>	15.875 <i>0.625</i>	

Indicates item not stocked at time of printing - Please enquire for lead time
 E&OE Pricing and all details subject to change without notice - Copyright Miniature Bearings Australia Pty Ltd
 MBA Size Listings are a guide to sizes only and must not be solely relied on for critical design information.

Bushes - Plastic - Iglidur X - Unflanged

Part Number	Nom. ID (d) mm <i>inches</i>	Nom. OD (D) mm <i>inches</i>	Length (s) mm <i>inches</i>	Tolerance of ID after Pressfit
# BP01000-01200-0060-X	10.000 <i>0.394</i>	12.000 <i>0.472</i>	6.000 <i>0.236</i>	+0.013/+0.071
# BP01000-01200-0080-X	10.000 <i>0.394</i>	12.000 <i>0.472</i>	8.000 <i>0.315</i>	+0.013/+0.071
# BP01000-01200-0100-X	10.000 <i>0.394</i>	12.000 <i>0.472</i>	10.000 <i>0.394</i>	+0.013/+0.071
# BP01000-01200-0120-X	10.000 <i>0.394</i>	12.000 <i>0.472</i>	12.000 <i>0.472</i>	+0.013/+0.071
# BP01000-01200-0200-X	10.000 <i>0.394</i>	12.000 <i>0.472</i>	20.000 <i>0.787</i>	+0.013/+0.071
# BP01111-01349-0064-X	11.113 <i>0.438</i>	13.494 <i>0.531</i>	6.350 <i>0.250</i>	
# BP01111-01349-0127-X	11.113 <i>0.438</i>	13.494 <i>0.531</i>	12.700 <i>0.500</i>	
# BP01111-01349-0159-X	11.113 <i>0.438</i>	13.494 <i>0.531</i>	15.875 <i>0.625</i>	
# BP01111-01349-0191-X	11.113 <i>0.438</i>	13.494 <i>0.531</i>	19.050 <i>0.750</i>	
# BP01200-01400-0060-X	12.000 <i>0.472</i>	14.000 <i>0.551</i>	6.000 <i>0.236</i>	+0.016/+0.086

Indicates item not stocked at time of printing - Please enquire for lead time
 E&OE Pricing and all details subject to change without notice - Copyright Miniature Bearings Australia Pty Ltd
 MBA Size Listings are a guide to sizes only and must not be solely relied on for critical design information.

Bushes - Plastic - Iglidur X - Unflanged

Part Number	Nom. ID (d) mm <i>inches</i>	Nom. OD (D) mm <i>inches</i>	Length (s) mm <i>inches</i>	Tolerance of ID after Pressfit
# BP01200-01400-0080-X	12.000 <i>0.472</i>	14.000 <i>0.551</i>	8.000 <i>0.315</i>	+0.016/+0.086
# BP01200-01400-0100-X	12.000 <i>0.472</i>	14.000 <i>0.551</i>	10.000 <i>0.394</i>	+0.016/+0.086
# BP01200-01400-0150-X	12.000 <i>0.472</i>	14.000 <i>0.551</i>	15.000 <i>0.591</i>	+0.016/+0.086
# BP01200-01400-0200-X	12.000 <i>0.472</i>	14.000 <i>0.551</i>	20.000 <i>0.787</i>	+0.016/+0.086
# BP01270-01508-0064-X	12.700 <i>0.500</i>	15.081 <i>0.594</i>	6.350 <i>0.250</i>	
# BP01270-01508-0095-X	12.700 <i>0.500</i>	15.081 <i>0.594</i>	9.525 <i>0.375</i>	
# BP01270-01508-0127-X	12.700 <i>0.500</i>	15.081 <i>0.594</i>	12.700 <i>0.500</i>	
# BP01270-01508-0159-X	12.700 <i>0.500</i>	15.081 <i>0.594</i>	15.875 <i>0.625</i>	
# BP01270-01508-0191-X	12.700 <i>0.500</i>	15.081 <i>0.594</i>	19.050 <i>0.750</i>	
# BP01270-01508-0254-X	12.700 <i>0.500</i>	15.081 <i>0.594</i>	25.400 <i>1.000</i>	

Indicates item not stocked at time of printing - Please enquire for lead time

E&OE Pricing and all details subject to change without notice - Copyright Miniature Bearings Australia Pty Ltd

MBA Size Listings are a guide to sizes only and must not be solely relied on for critical design information.

Bushes - Plastic - Iglidur X - Unflanged

Part Number	Nom. ID (d) mm <i>inches</i>	Nom. OD (D) mm <i>inches</i>	Length (s) mm <i>inches</i>	Tolerance of ID after Pressfit
# BP01400-01600-0120-X	14.000 <i>0.551</i>	16.000 <i>0.630</i>	12.000 <i>0.472</i>	+0.016/+0.086
# BP01400-01600-0150-X	14.000 <i>0.551</i>	16.000 <i>0.630</i>	15.000 <i>0.591</i>	+0.016/+0.086
# BP01400-01600-0200-X	14.000 <i>0.551</i>	16.000 <i>0.630</i>	20.000 <i>0.787</i>	+0.016/+0.086
# BP01429-01667-0127-X	14.288 <i>0.563</i>	16.669 <i>0.656</i>	12.700 <i>0.500</i>	
# BP01429-01667-0191-X	14.288 <i>0.563</i>	16.669 <i>0.656</i>	19.050 <i>0.750</i>	
# BP01500-01700-0150-X	15.000 <i>0.591</i>	17.000 <i>0.669</i>	15.000 <i>0.591</i>	+0.016/+0.086
# BP01500-01700-0200-X	15.000 <i>0.591</i>	17.000 <i>0.669</i>	20.000 <i>0.787</i>	+0.016/+0.086
# BP01588-01826-0064-X	15.875 <i>0.625</i>	18.256 <i>0.719</i>	6.350 <i>0.250</i>	
# BP01588-01826-0095-X	15.875 <i>0.625</i>	18.256 <i>0.719</i>	9.525 <i>0.375</i>	
# BP01588-01826-0127-X	15.875 <i>0.625</i>	18.256 <i>0.719</i>	12.700 <i>0.500</i>	

Indicates item not stocked at time of printing - Please enquire for lead time

E&OE Pricing and all details subject to change without notice - Copyright Miniature Bearings Australia Pty Ltd

MBA Size Listings are a guide to sizes only and must not be solely relied on for critical design information.

Bushes - Plastic - Iglidur X - Unflanged

Part Number	Nom. ID (d) mm <i>inches</i>	Nom. OD (D) mm <i>inches</i>	Length (s) mm <i>inches</i>	Tolerance of ID after Pressfit
# BP01588-01826-0159-X	15.875 <i>0.625</i>	18.256 <i>0.719</i>	15.875 <i>0.625</i>	
# BP01588-01826-0191-X	15.875 <i>0.625</i>	18.256 <i>0.719</i>	19.050 <i>0.750</i>	
# BP01588-01826-0254-X	15.875 <i>0.625</i>	18.256 <i>0.719</i>	25.400 <i>1.000</i>	
# BP01600-01800-0150-X	16.000 <i>0.630</i>	18.000 <i>0.709</i>	15.000 <i>0.591</i>	+0.016/+0.086
# BP01600-01800-0200-X	16.000 <i>0.630</i>	18.000 <i>0.709</i>	20.000 <i>0.787</i>	+0.016/+0.086
# BP01600-01800-0350-X	16.000 <i>0.630</i>	18.000 <i>0.709</i>	35.000 <i>1.378</i>	+0.016/+0.086
# BP01746-01984-0222-X	17.463 <i>0.688</i>	19.844 <i>0.781</i>	22.225 <i>0.875</i>	
# BP01800-02000-0150-X	18.000 <i>0.709</i>	20.000 <i>0.787</i>	15.000 <i>0.591</i>	+0.016/+0.086
# BP01800-02000-0200-X	18.000 <i>0.709</i>	20.000 <i>0.787</i>	20.000 <i>0.787</i>	+0.016/+0.086
# BP01905-02223-0095-X	19.050 <i>0.750</i>	22.225 <i>0.875</i>	9.525 <i>0.375</i>	

Indicates item not stocked at time of printing - Please enquire for lead time
 E&OE Pricing and all details subject to change without notice - Copyright Miniature Bearings Australia Pty Ltd
 MBA Size Listings are a guide to sizes only and must not be solely relied on for critical design information.

Bushes - Plastic - Iglidur X - Unflanged

Part Number	Nom. ID (d) mm <i>inches</i>	Nom. OD (D) mm <i>inches</i>	Length (s) mm <i>inches</i>	Tolerance of ID after Pressfit
# BP01905-02223-0127-X	19.050 <i>0.750</i>	22.225 <i>0.875</i>	12.700 <i>0.500</i>	
# BP01905-02223-0222-X	19.050 <i>0.750</i>	22.225 <i>0.875</i>	22.225 <i>0.875</i>	
# BP01905-02223-0254-X	19.050 <i>0.750</i>	22.225 <i>0.875</i>	25.400 <i>1.000</i>	
# BP02000-02200-0140-X	20.000 <i>0.787</i>	22.000 <i>0.866</i>	14.000 <i>0.551</i>	+0.020/+0.104
# BP02000-02200-0180-X	20.000 <i>0.787</i>	22.000 <i>0.866</i>	18.000 <i>0.709</i>	+0.020/+0.104
# BP02000-02200-0200-X	20.000 <i>0.787</i>	22.000 <i>0.866</i>	20.000 <i>0.787</i>	+0.020/+0.104
# BP02000-02300-0150-X	20.000 <i>0.787</i>	23.000 <i>0.906</i>	15.000 <i>0.591</i>	+0.020/+0.104
# BP02000-02300-0200-X	20.000 <i>0.787</i>	23.000 <i>0.906</i>	20.000 <i>0.787</i>	+0.020/+0.104
# BP02000-02300-0250-X	20.000 <i>0.787</i>	23.000 <i>0.906</i>	25.000 <i>0.984</i>	+0.020/+0.104
# BP02000-02300-0300-X	20.000 <i>0.787</i>	23.000 <i>0.906</i>	30.000 <i>1.181</i>	+0.020/+0.104

Indicates item not stocked at time of printing - Please enquire for lead time

E&OE Pricing and all details subject to change without notice - Copyright Miniature Bearings Australia Pty Ltd

MBA Size Listings are a guide to sizes only and must not be solely relied on for critical design information.

Bushes - Plastic - Iglidur X - Unflanged

Part Number	Nom. ID (d) mm <i>inches</i>	Nom. OD (D) mm <i>inches</i>	Length (s) mm <i>inches</i>	Tolerance of ID after Pressfit
# BP02200-02500-0150-X	22.000 <i>0.866</i>	25.000 <i>0.984</i>	15.000 <i>0.591</i>	+0.020/+0.104
# BP02200-02500-0200-X	22.000 <i>0.866</i>	25.000 <i>0.984</i>	20.000 <i>0.787</i>	+0.020/+0.104
# BP02223-02540-0191-X	22.225 <i>0.875</i>	25.400 <i>1.000</i>	19.050 <i>0.750</i>	
# BP02223-02540-0254-X	22.225 <i>0.875</i>	25.400 <i>1.000</i>	25.400 <i>1.000</i>	
# BP02400-02700-0200-X	24.000 <i>0.945</i>	27.000 <i>1.063</i>	20.000 <i>0.787</i>	+0.020/+0.104
# BP02500-02800-0130-X	25.000 <i>0.984</i>	28.000 <i>1.102</i>	13.000 <i>0.512</i>	+0.020/+0.104
# BP02500-02800-0200-X	25.000 <i>0.984</i>	28.000 <i>1.102</i>	20.000 <i>0.787</i>	+0.020/+0.104
# BP02500-02800-0300-X	25.000 <i>0.984</i>	28.000 <i>1.102</i>	30.000 <i>1.181</i>	+0.020/+0.104
# BP02540-02858-0127-X	25.400 <i>1.000</i>	28.575 <i>1.125</i>	12.700 <i>0.500</i>	
# BP02540-02858-0191-X	25.400 <i>1.000</i>	28.575 <i>1.125</i>	19.050 <i>0.750</i>	

Indicates item not stocked at time of printing - Please enquire for lead time

E&OE Pricing and all details subject to change without notice - Copyright Miniature Bearings Australia Pty Ltd

MBA Size Listings are a guide to sizes only and must not be solely relied on for critical design information.

Bushes - Plastic - Iglidur X - Unflanged

Part Number	Nom. ID (d) mm <i>inches</i>	Nom. OD (D) mm <i>inches</i>	Length (s) mm <i>inches</i>	Tolerance of ID after Pressfit
# BP02540-02858-0254-X	25.400 <i>1.000</i>	28.575 <i>1.125</i>	25.400 <i>1.000</i>	
# BP02540-02858-0381-X	25.400 <i>1.000</i>	28.575 <i>1.125</i>	38.100 <i>1.500</i>	
# BP02700-03000-0057-X	27.000 <i>1.063</i>	30.000 <i>1.181</i>	5.700 <i>0.224</i>	+0.020/+0.104
# BP02700-03000-0200-X	27.000 <i>1.063</i>	30.000 <i>1.181</i>	20.000 <i>0.787</i>	+0.020/+0.104
# BP02800-03200-0200-X	28.000 <i>1.102</i>	32.000 <i>1.260</i>	20.000 <i>0.787</i>	+0.020/+0.104
# BP02800-03200-0300-X	28.000 <i>1.102</i>	32.000 <i>1.260</i>	30.000 <i>1.181</i>	+0.020/+0.104
# BP02858-03254-0191-X	28.575 <i>1.125</i>	32.544 <i>1.281</i>	19.050 <i>0.750</i>	
# BP03000-03400-0200-X	30.000 <i>1.181</i>	34.000 <i>1.339</i>	20.000 <i>0.787</i>	+0.020/+0.104
# BP03000-03400-0250-X	30.000 <i>1.181</i>	34.000 <i>1.339</i>	25.000 <i>0.984</i>	+0.020/+0.104
# BP03000-03400-0300-X	30.000 <i>1.181</i>	34.000 <i>1.339</i>	30.000 <i>1.181</i>	+0.020/+0.104

Indicates item not stocked at time of printing - Please enquire for lead time

E&OE Pricing and all details subject to change without notice - Copyright Miniature Bearings Australia Pty Ltd

MBA Size Listings are a guide to sizes only and must not be solely relied on for critical design information.

Bushes - Plastic - Iglidur X - Unflanged

Part Number	Nom. ID (d) mm <i>inches</i>	Nom. OD (D) mm <i>inches</i>	Length (s) mm <i>inches</i>	Tolerance of ID after Pressfit
# BP03000-03400-0400-X	30.000 <i>1.181</i>	34.000 <i>1.339</i>	40.000 <i>1.575</i>	+0.020/+0.104
# BP03175-03572-0159-X	31.750 <i>1.250</i>	35.719 <i>1.406</i>	15.875 <i>0.625</i>	
# BP03175-03572-0318-X	31.750 <i>1.250</i>	35.719 <i>1.406</i>	31.750 <i>1.250</i>	
# BP03200-03600-0300-X	32.000 <i>1.260</i>	36.000 <i>1.417</i>	30.000 <i>1.181</i>	+0.025/+0.125
# BP03500-03900-0200-X	35.000 <i>1.378</i>	39.000 <i>1.535</i>	20.000 <i>0.787</i>	+0.025/+0.125
# BP03500-03900-0300-X	35.000 <i>1.378</i>	39.000 <i>1.535</i>	30.000 <i>1.181</i>	+0.025/+0.125
# BP03500-03900-0400-X	35.000 <i>1.378</i>	39.000 <i>1.535</i>	40.000 <i>1.575</i>	+0.025/+0.125
# BP03810-04207-0191-X	38.100 <i>1.500</i>	42.069 <i>1.656</i>	19.050 <i>0.750</i>	
# BP03810-04207-0254-X	38.100 <i>1.500</i>	42.069 <i>1.656</i>	25.400 <i>1.000</i>	
# BP03810-04207-0381-X	38.100 <i>1.500</i>	42.069 <i>1.656</i>	38.100 <i>1.500</i>	

Indicates item not stocked at time of printing - Please enquire for lead time

E&OE Pricing and all details subject to change without notice - Copyright Miniature Bearings Australia Pty Ltd

MBA Size Listings are a guide to sizes only and must not be solely relied on for critical design information.

Bushes - Plastic - Iglidur X - Unflanged

Part Number	Nom. ID (d) mm <i>inches</i>	Nom. OD (D) mm <i>inches</i>	Length (s) mm <i>inches</i>	Tolerance of ID after Pressfit
# BP04000-04400-0300-X	40.000 <i>1.575</i>	44.000 <i>1.732</i>	30.000 <i>1.181</i>	+0.025/+0.125
# BP04000-04400-0400-X	40.000 <i>1.575</i>	44.000 <i>1.732</i>	40.000 <i>1.575</i>	+0.025/+0.125
# BP04000-04400-0500-X	40.000 <i>1.575</i>	44.000 <i>1.732</i>	50.000 <i>1.969</i>	+0.025/+0.125
# BP04445-04921-0254-X	44.450 <i>1.750</i>	49.213 <i>1.938</i>	25.400 <i>1.000</i>	
# BP04500-05000-0500-X	45.000 <i>1.772</i>	50.000 <i>1.969</i>	50.000 <i>1.969</i>	+0.025/+0.125
# BP04524-04604-0318-X	45.244 <i>1.781</i>	46.038 <i>1.813</i>	31.750 <i>1.250</i>	
# BP05000-05500-0300-X	50.000 <i>1.969</i>	55.000 <i>2.165</i>	30.000 <i>1.181</i>	+0.025/+0.125
# BP05000-05500-0400-X	50.000 <i>1.969</i>	55.000 <i>2.165</i>	40.000 <i>1.575</i>	+0.025/+0.125
# BP05000-05500-0600-X	50.000 <i>1.969</i>	55.000 <i>2.165</i>	60.000 <i>2.362</i>	+0.025/+0.125
# BP05080-05556-0381-X	50.800 <i>2.000</i>	55.563 <i>2.188</i>	38.100 <i>1.500</i>	

Indicates item not stocked at time of printing - Please enquire for lead time
 E&OE Pricing and all details subject to change without notice - Copyright Miniature Bearings Australia Pty Ltd
 MBA Size Listings are a guide to sizes only and must not be solely relied on for critical design information.

Bushes - Plastic - Iglidur X - Unflanged

Part Number	Nom. ID (d) mm <i>inches</i>	Nom. OD (D) mm <i>inches</i>	Length (s) mm <i>inches</i>	Tolerance of ID after Pressfit
# BP05080-05556-0508-X	50.800 <i>2.000</i>	55.563 <i>2.188</i>	50.800 <i>2.000</i>	
# BP05500-06000-0500-X	55.000 <i>2.165</i>	60.000 <i>2.362</i>	50.000 <i>1.969</i>	+0.30/+0.150
# BP05715-06191-0508-X	57.150 <i>2.250</i>	61.913 <i>2.438</i>	50.800 <i>2.000</i>	
# BP06000-06500-0600-X	60.000 <i>2.362</i>	65.000 <i>2.559</i>	60.000 <i>2.362</i>	+0.30/+0.150
# BP06500-07000-0500-X	65.000 <i>2.559</i>	70.000 <i>2.756</i>	50.000 <i>1.969</i>	+0.30/+0.150
# BP06985-07461-0508-X	69.850 <i>2.750</i>	74.613 <i>2.938</i>	50.800 <i>2.000</i>	

Indicates item not stocked at time of printing - Please enquire for lead time

E&OE Pricing and all details subject to change without notice - Copyright Miniature Bearings Australia Pty Ltd

MBA Size Listings are a guide to sizes only and must not be solely relied on for critical design information.



DISTRIBUTED BY

Ask us to put your name and address here

<http://www.minibearings.com.au/product>

Ph +61 7 3245 7977

Fax +61 7 3245 1017

Catalogue requests to catalogues@minibearings.com.au

