



MBA

Bushes - Plastic - Iglidur Z - Unflanged

High temperature. High thermal resistance. Extreme load.
High surface speed.

Specific Gravity 1.40 g/cm³.

Operating Temp 310 C short term / 250 C long term.

Tensile Strength at 20 deg C = 95 Mpa.

Hardness 81 Shore D (DIN53505).

Tolerances listed are after H7 Pressfit.

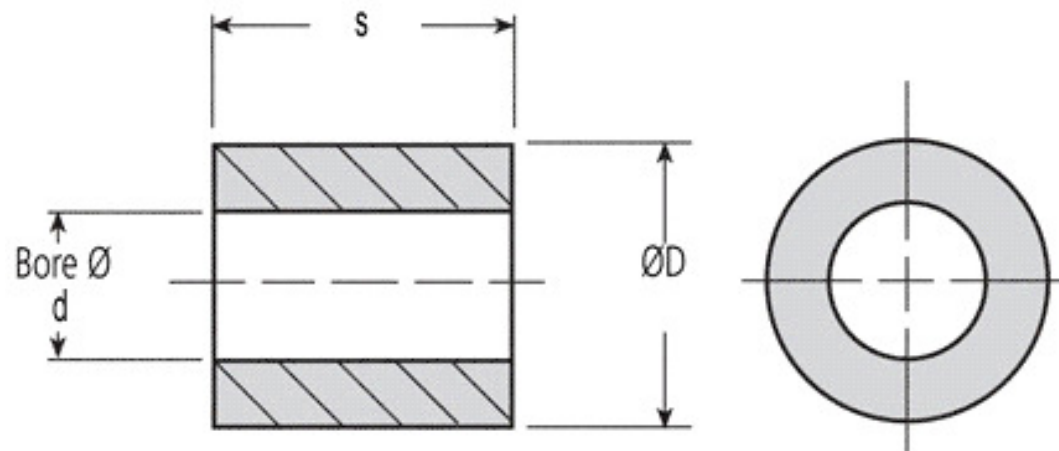

Bushes - Plastic - Iglidur Z - Unflanged

Part Number	Nom. ID (d) mm <i>inches</i>	Nom. OD (D) mm <i>inches</i>	Length (s) mm <i>inches</i>	Tolerance of ID after Pressfit
# BP00400-00550-0040-Z	4.000 <i>0.157</i>	5.500 <i>0.217</i>	4.000 <i>0.157</i>	+0.010/+0.058
# BP00500-00700-0050-Z	5.000 <i>0.197</i>	7.000 <i>0.276</i>	5.000 <i>0.197</i>	+0.010/+0.058
# BP00600-00800-0080-Z	6.000 <i>0.236</i>	8.000 <i>0.315</i>	8.000 <i>0.315</i>	+0.010/+0.058

Indicates item not stocked at time of printing - Please enquire for lead time
E&OE Pricing and all details subject to change without notice - Copyright Miniature Bearings Australia Pty Ltd
MBA Size Listings are a guide to sizes only and must not be solely relied on for critical design information.

Bushes - Plastic - Iglidur Z - Unflanged

Part Number	Nom. ID (d) mm <i>inches</i>	Nom. OD (D) mm <i>inches</i>	Length (s) mm <i>inches</i>	Tolerance of ID after Pressfit
# BP00800-01000-0100-Z	8.000 <i>0.315</i>	10.000 <i>0.394</i>	10.000 <i>0.394</i>	+0.013/+0.071
# BP00953-01191-0064-Z	9.525 <i>0.375</i>	11.906 <i>0.469</i>	6.350 <i>0.250</i>	
# BP00953-01191-0095-Z	9.525 <i>0.375</i>	11.906 <i>0.469</i>	9.525 <i>0.375</i>	
# BP00953-01191-0127-Z	9.525 <i>0.375</i>	11.906 <i>0.469</i>	12.700 <i>0.500</i>	
# BP01000-01200-0100-Z	10.000 <i>0.394</i>	12.000 <i>0.472</i>	10.000 <i>0.394</i>	+0.013/+0.071
# BP01111-01349-0127-Z	11.113 <i>0.438</i>	13.494 <i>0.531</i>	12.700 <i>0.500</i>	
# BP01200-01400-0150-Z	12.000 <i>0.472</i>	14.000 <i>0.551</i>	15.000 <i>0.591</i>	+0.016/+0.086
# BP01270-01508-0191-Z	12.700 <i>0.500</i>	15.081 <i>0.594</i>	19.050 <i>0.750</i>	
# BP01270-01588-0191-Z	12.700 <i>0.500</i>	15.875 <i>0.625</i>	19.050 <i>0.750</i>	
# BP01500-01700-0150-Z	15.000 <i>0.591</i>	17.000 <i>0.669</i>	15.000 <i>0.591</i>	+0.016/+0.086

Indicates item not stocked at time of printing - Please enquire for lead time

E&OE Pricing and all details subject to change without notice - Copyright Miniature Bearings Australia Pty Ltd

MBA Size Listings are a guide to sizes only and must not be solely relied on for critical design information.

Bushes - Plastic - Iglidur Z - Unflanged

Part Number	Nom. ID (d) mm <i>inches</i>	Nom. OD (D) mm <i>inches</i>	Length (s) mm <i>inches</i>	Tolerance of ID after Pressfit
# BP01588-01826-0191-Z	15.875 <i>0.625</i>	18.256 <i>0.719</i>	19.050 <i>0.750</i>	
# BP01600-01800-0150-Z	16.000 <i>0.630</i>	18.000 <i>0.709</i>	15.000 <i>0.591</i>	+0.016/+0.086
# BP01800-02000-0200-Z	18.000 <i>0.709</i>	20.000 <i>0.787</i>	20.000 <i>0.787</i>	+0.016/+0.086
# BP01905-02223-0191-Z	19.050 <i>0.750</i>	22.225 <i>0.875</i>	19.050 <i>0.750</i>	
# BP01905-02223-0254-Z	19.050 <i>0.750</i>	22.225 <i>0.875</i>	25.400 <i>1.000</i>	
# BP02000-02300-0150-Z	20.000 <i>0.787</i>	23.000 <i>0.906</i>	15.000 <i>0.591</i>	+0.020/+0.104
# BP02000-02300-0200-Z	20.000 <i>0.787</i>	23.000 <i>0.906</i>	20.000 <i>0.787</i>	+0.020/+0.104
# BP02000-02300-0300-Z	20.000 <i>0.787</i>	23.000 <i>0.906</i>	30.000 <i>1.181</i>	+0.020/+0.104
# BP02223-02540-0254-Z	22.225 <i>0.875</i>	25.400 <i>1.000</i>	25.400 <i>1.000</i>	
# BP02500-02800-0200-Z	25.000 <i>0.984</i>	28.000 <i>1.102</i>	20.000 <i>0.787</i>	+0.020/+0.104

Indicates item not stocked at time of printing - Please enquire for lead time
 E&OE Pricing and all details subject to change without notice - Copyright Miniature Bearings Australia Pty Ltd
 MBA Size Listings are a guide to sizes only and must not be solely relied on for critical design information.

Bushes - Plastic - Iglidur Z - Unflanged

Part Number	Nom. ID (d) mm <i>inches</i>	Nom. OD (D) mm <i>inches</i>	Length (s) mm <i>inches</i>	Tolerance of ID after Pressfit
# BP02540-02858-0254-Z	25.400 <i>1.000</i>	28.575 <i>1.125</i>	25.400 <i>1.000</i>	
# BP02540-02858-0381-Z	25.400 <i>1.000</i>	28.575 <i>1.125</i>	38.100 <i>1.500</i>	
# BP02858-03254-0381-Z	28.575 <i>1.125</i>	32.544 <i>1.281</i>	38.100 <i>1.500</i>	
# BP03000-03400-0300-Z	30.000 <i>1.181</i>	34.000 <i>1.339</i>	30.000 <i>1.181</i>	+0.020/+0.104
# BP03000-03400-0400-Z	30.000 <i>1.181</i>	34.000 <i>1.339</i>	40.000 <i>1.575</i>	+0.020/+0.104
# BP03175-03572-0286-Z	31.750 <i>1.250</i>	35.719 <i>1.406</i>	28.575 <i>1.125</i>	
# BP03810-04207-0381-Z	38.100 <i>1.500</i>	42.069 <i>1.656</i>	38.100 <i>1.500</i>	
# BP04000-04400-0400-Z	40.000 <i>1.575</i>	44.000 <i>1.732</i>	40.000 <i>1.575</i>	+0.025/+0.125
# BP04445-04921-0508-Z	44.450 <i>1.750</i>	49.213 <i>1.938</i>	50.800 <i>2.000</i>	
# BP05080-05556-0254-Z	50.800 <i>2.000</i>	55.563 <i>2.188</i>	25.400 <i>1.000</i>	

Indicates item not stocked at time of printing - Please enquire for lead time

E&OE Pricing and all details subject to change without notice - Copyright Miniature Bearings Australia Pty Ltd

MBA Size Listings are a guide to sizes only and must not be solely relied on for critical design information.

Bushes - Plastic - Iglidur Z - Unflanged

Part Number	Nom. ID (d) mm <i>inches</i>	Nom. OD (D) mm <i>inches</i>	Length (s) mm <i>inches</i>	Tolerance of ID after Pressfit
# BP05080-05556-0508-Z	50.800 <i>2.000</i>	55.563 <i>2.188</i>	50.800 <i>2.000</i>	
# BP05715-06191-0508-Z	57.150 <i>2.250</i>	61.913 <i>2.438</i>	50.800 <i>2.000</i>	
# BP06000-06500-0600-Z	60.000 <i>2.362</i>	65.000 <i>2.559</i>	60.000 <i>2.362</i>	+0.025/+0.125

Indicates item not stocked at time of printing - Please enquire for lead time

E&OE Pricing and all details subject to change without notice - Copyright Miniature Bearings Australia Pty Ltd

MBA Size Listings are a guide to sizes only and must not be solely relied on for critical design information.



DISTRIBUTED BY

Ask us to put your name and address here

<http://www.minibearings.com.au/product>

Ph +61 7 3245 7977

Fax +61 7 3245 1017

Catalogue requests to catalogues@minibearings.com.au
