



MBA

Bushes - Plastic - Rulon J - Unflanged

Non Metallic Bushes. Excellent insulator.

288 Deg C (550 Deg F) Maximum Working Temperature.

Patented all polymeric PTFE compound which operates well against soft mating surfaces.

Tolerances - ID and OD +0.051mm / - 0.000mm.

Lowest co-efficient of friction in the Rulon® product range.

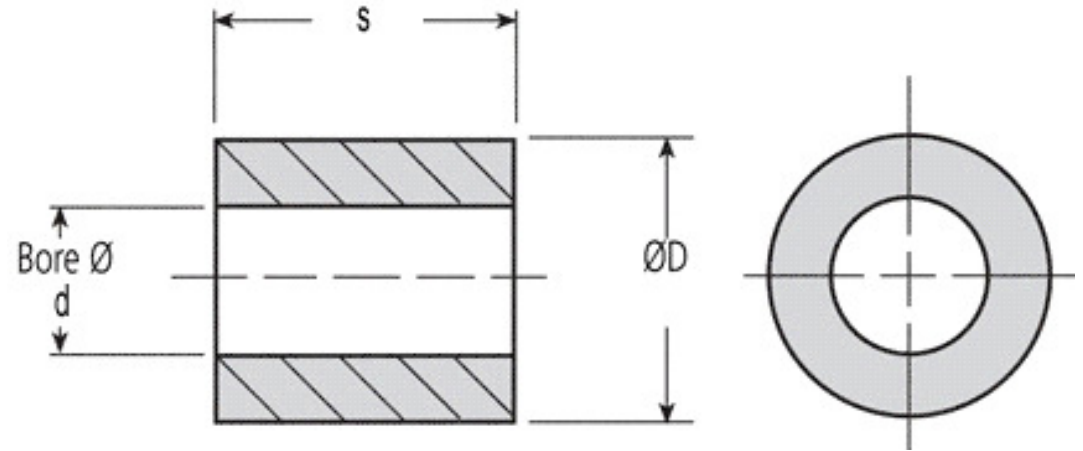

Bushes - Plastic - Rulon J - Unflanged

Part Number	Nom. ID (d) mm	Nom. OD (D) mm	Length (s) mm	Type	Rec. Housing Bore mm	Rec. Shaft Size mm
	<i>inches</i>	<i>inches</i>	<i>inches</i>		<i>inches</i>	<i>inches</i>
# BP00316-00604-0049-RJ	3.160 <i>0.124</i>	6.040 <i>0.238</i>	4.900 <i>0.193</i>	Standard	6.000 / 5.980	3.000 / 2.925
# BP00328-00638-0064-RJ	3.277 <i>0.129</i>	6.375 <i>0.251</i>	6.350 <i>0.250</i>	Standard	6.350 / 6.325	3.175 / 3.150
# BP00328-00638-0095-RJ	3.277 <i>0.129</i>	6.375 <i>0.251</i>	9.525 <i>0.375</i>	Standard	6.350 / 6.325	3.175 / 3.150

Indicates item not stocked at time of printing - Please enquire for lead time

E&OE Pricing and all details subject to change without notice - Copyright Miniature Bearings Australia Pty Ltd

MBA Size Listings are a guide to sizes only and must not be solely relied on for critical design information.

Bushes - Plastic - Rulon J - Unflanged

Part Number	Nom. ID (d) mm <i>inches</i>	Nom. OD (D) mm <i>inches</i>	Length (s) mm <i>inches</i>	Type	Rec. Housing Bore mm <i>inches</i>	Rec. Shaft Size mm <i>inches</i>
# BP00416-00704-0059-RJ	4.160 <i>0.164</i>	7.040 <i>0.277</i>	5.900 <i>0.232</i>	Standard	7.000 / 6.980	4.000 / 3.900
# BP00485-00795-0064-RJ	4.851 <i>0.191</i>	7.950 <i>0.313</i>	6.350 <i>0.250</i>	Standard	7.925 / 7.899	4.763 / 4.737
# BP00485-00795-0095-RJ	4.851 <i>0.191</i>	7.950 <i>0.313</i>	9.525 <i>0.375</i>	Standard	7.925 / 7.899	4.763 / 4.737
# BP00485-00795-0127-RJ	4.851 <i>0.191</i>	7.950 <i>0.313</i>	12.700 <i>0.500</i>	Standard	7.925 / 7.899	4.763 / 4.737
# BP00516-00804-0079-RJ	5.160 <i>0.203</i>	8.040 <i>0.317</i>	7.900 <i>0.311</i>	Standard	8.000 / 7.980	5.000 / 4.875
# BP00616-00904-0089-RJ	6.160 <i>0.243</i>	9.040 <i>0.356</i>	8.900 <i>0.350</i>	Standard	9.000 / 8.980	6.000 / 5.850
# BP00645-00955-0064-RJ	6.452 <i>0.254</i>	9.550 <i>0.376</i>	6.350 <i>0.250</i>	Standard	9.525 / 9.500	6.350 / 6.325
# BP00645-00955-0095-RJ	6.452 <i>0.254</i>	9.550 <i>0.376</i>	9.525 <i>0.375</i>	Standard	9.525 / 9.500	6.350 / 6.325
# BP00645-00955-0127-RJ	6.452 <i>0.254</i>	9.550 <i>0.376</i>	12.700 <i>0.500</i>	Standard	9.525 / 9.500	6.350 / 6.325
# BP00718-01105-0099-RJ	7.180 <i>0.283</i>	11.050 <i>0.435</i>	9.900 <i>0.390</i>	Standard	11.000 / 10.980	7.000 / 6.825

Indicates item not stocked at time of printing - Please enquire for lead time

E&OE Pricing and all details subject to change without notice - Copyright Miniature Bearings Australia Pty Ltd

MBA Size Listings are a guide to sizes only and must not be solely relied on for critical design information.

Bushes - Plastic - Rulon J - Unflanged

Part Number	Nom. ID (d) mm <i>inches</i>	Nom. OD (D) mm <i>inches</i>	Length (s) mm <i>inches</i>	Type	Rec. Housing Bore mm <i>inches</i>	Rec. Shaft Size mm <i>inches</i>
# BP00803-01273-0095-RJ	8.026 <i>0.316</i>	12.725 <i>0.501</i>	9.525 <i>0.375</i>	Standard	12.700 / 12.675	7.938 / 7.912
# BP00803-01273-0127-RJ	8.026 <i>0.316</i>	12.725 <i>0.501</i>	12.700 <i>0.500</i>	Standard	12.700 / 12.675	7.938 / 7.912
# BP00818-01205-0099-RJ	8.180 <i>0.322</i>	12.050 <i>0.474</i>	9.900 <i>0.390</i>	Standard	12.000 / 11.980	8.000 / 7.800
# BP00918-01305-0099-RJ	9.180 <i>0.361</i>	13.050 <i>0.514</i>	9.850 <i>0.388</i>	Standard	13.000 / 12.980	9.000 / 8.775
# BP00963-01430-0095-RJ	9.627 <i>0.379</i>	14.300 <i>0.563</i>	9.525 <i>0.375</i>	Standard	14.275 / 14.249	9.525 / 9.500
# BP00963-01430-0127-RJ	9.627 <i>0.379</i>	14.300 <i>0.563</i>	12.700 <i>0.500</i>	Standard	14.275 / 14.249	9.525 / 9.500
# BP00963-01430-0191-RJ	9.627 <i>0.379</i>	14.300 <i>0.563</i>	19.050 <i>0.750</i>	Standard	14.275 / 14.249	9.525 / 9.500
# BP01019-01405-0099-RJ	10.190 <i>0.401</i>	14.050 <i>0.553</i>	9.850 <i>0.388</i>	Standard	14.000 / 13.980	10.000 / 9.750
# BP01120-01590-0095-RJ	11.201 <i>0.441</i>	15.900 <i>0.626</i>	9.525 <i>0.375</i>	Standard	15.875 / 15.850	11.113 / 11.087
# BP01120-01590-0127-RJ	11.201 <i>0.441</i>	15.900 <i>0.626</i>	12.700 <i>0.500</i>	Standard	15.875 / 15.850	11.113 / 11.087

Indicates item not stocked at time of printing - Please enquire for lead time

E&OE Pricing and all details subject to change without notice - Copyright Miniature Bearings Australia Pty Ltd

MBA Size Listings are a guide to sizes only and must not be solely relied on for critical design information.

Bushes - Plastic - Rulon J - Unflanged

Part Number	Nom. ID (d) mm <i>inches</i>	Nom. OD (D) mm <i>inches</i>	Length (s) mm <i>inches</i>	Type	Rec. Housing Bore mm <i>inches</i>	Rec. Shaft Size mm <i>inches</i>
# BP01120-01590-0191-RJ	11.201 <i>0.441</i>	15.900 <i>0.626</i>	19.050 <i>0.750</i>	Standard	15.875 / 15.850	11.113 / 11.087
# BP01219-01605-0099-RJ	12.190 <i>0.480</i>	16.050 <i>0.632</i>	9.850 <i>0.388</i>	Standard	16.000 / 15.980	12.000 / 11.700
# BP01280-01908-0127-RJ	12.802 <i>0.504</i>	19.075 <i>0.751</i>	12.700 <i>0.500</i>	Standard	19.050 / 19.025	12.700 / 12.675
# BP01280-01908-0191-RJ	12.802 <i>0.504</i>	19.075 <i>0.751</i>	19.050 <i>0.750</i>	Standard	19.050 / 19.025	12.700 / 12.675
# BP01280-01908-0254-RJ	12.802 <i>0.504</i>	19.075 <i>0.751</i>	25.400 <i>1.000</i>	Standard	19.050 / 19.025	12.700 / 12.675
# BP01440-02065-0127-RJ	14.402 <i>0.567</i>	20.650 <i>0.813</i>	12.700 <i>0.500</i>	Standard	20.625 / 20.599	14.288 / 14.262
# BP01440-02065-0191-RJ	14.402 <i>0.567</i>	20.650 <i>0.813</i>	19.050 <i>0.750</i>	Standard	20.625 / 20.599	14.288 / 14.262
# BP01440-02065-0254-RJ	14.402 <i>0.567</i>	20.650 <i>0.813</i>	25.400 <i>1.000</i>	Standard	20.625 / 20.599	14.288 / 14.262
# BP01520-02105-0149-RJ	15.200 <i>0.598</i>	21.050 <i>0.829</i>	14.850 <i>0.585</i>	Standard	21.000 / 21.980	15.000 / 14.625
# BP01600-02225-0159-RJ	16.000 <i>0.630</i>	22.250 <i>0.876</i>	15.875 <i>0.625</i>	Standard	22.225 / 22.200	15.875 / 15.850

Indicates item not stocked at time of printing - Please enquire for lead time

E&OE Pricing and all details subject to change without notice - Copyright Miniature Bearings Australia Pty Ltd

MBA Size Listings are a guide to sizes only and must not be solely relied on for critical design information.

Bushes - Plastic - Rulon J - Unflanged

Part Number	Nom. ID (d) mm <i>inches</i>	Nom. OD (D) mm <i>inches</i>	Length (s) mm <i>inches</i>	Type	Rec. Housing Bore mm <i>inches</i>	Rec. Shaft Size mm <i>inches</i>
# BP01600-02225-0191-RJ	16.000 <i>0.630</i>	22.250 <i>0.876</i>	19.050 <i>0.750</i>	Standard	22.225 / 22.200	15.875 / 15.850
# BP01600-02225-0254-RJ	16.000 <i>0.630</i>	22.250 <i>0.876</i>	25.400 <i>1.000</i>	Standard	22.225 / 22.200	15.875 / 15.850
# BP01720-02305-0149-RJ	17.200 <i>0.677</i>	23.050 <i>0.907</i>	14.850 <i>0.585</i>	Standard	23.000 / 22.980	19.000 / 18.525
# BP01760-02383-0191-RJ	17.602 <i>0.693</i>	23.825 <i>0.938</i>	19.050 <i>0.750</i>	Standard	23.800 / 23.774	17.463 / 17.437
# BP01918-02543-0127-RJ	19.177 <i>0.755</i>	25.425 <i>1.001</i>	12.700 <i>0.500</i>	Standard	25.400 / 25.375	19.050 / 19.025
# BP01918-02543-0191-RJ	19.177 <i>0.755</i>	25.425 <i>1.001</i>	19.050 <i>0.750</i>	Standard	25.400 / 25.375	19.050 / 19.025
# BP01918-02543-0254-RJ	19.177 <i>0.755</i>	25.425 <i>1.001</i>	25.400 <i>1.000</i>	Standard	25.400 / 25.375	19.050 / 19.025
# BP01918-02543-0381-RJ	19.177 <i>0.755</i>	25.425 <i>1.001</i>	38.100 <i>1.500</i>	Standard	25.400 / 25.375	19.050 / 19.025
# BP02021-02606-0199-RJ	20.210 <i>0.796</i>	26.060 <i>1.026</i>	19.850 <i>0.781</i>	Standard	26.000 / 25.980	20.000 / 19.500
# BP02221-02806-0199-RJ	22.210 <i>0.874</i>	28.060 <i>1.105</i>	19.850 <i>0.781</i>	Standard	28.000 / 27.980	22.000 / 21.450

Indicates item not stocked at time of printing - Please enquire for lead time

E&OE Pricing and all details subject to change without notice - Copyright Miniature Bearings Australia Pty Ltd

MBA Size Listings are a guide to sizes only and must not be solely relied on for critical design information.

Bushes - Plastic - Rulon J - Unflanged

Part Number	Nom. ID (d) mm <i>inches</i>	Nom. OD (D) mm <i>inches</i>	Length (s) mm <i>inches</i>	Type	Rec. Housing Bore mm <i>inches</i>	Rec. Shaft Size mm <i>inches</i>
# BP02235-02860-0191-RJ	22.352 <i>0.880</i>	28.600 <i>1.126</i>	19.050 <i>0.750</i>	Standard	28.575 / 28.550	22.225 / 22.200
# BP02235-02860-0254-RJ	22.352 <i>0.880</i>	28.600 <i>1.126</i>	25.400 <i>1.000</i>	Standard	28.575 / 28.550	22.225 / 22.200
# BP02521-03106-0249-RJ	25.210 <i>0.993</i>	31.060 <i>1.223</i>	24.850 <i>0.978</i>	Standard	31.000 / 30.980	25.000 / 24.375
# BP02553-03178-0191-RJ	25.527 <i>1.005</i>	31.775 <i>1.251</i>	19.050 <i>0.750</i>	Standard	31.750 / 31.725	25.400 / 25.375
# BP02553-03178-0254-RJ	25.527 <i>1.005</i>	31.775 <i>1.251</i>	25.400 <i>1.000</i>	Standard	31.750 / 31.725	25.400 / 25.375
# BP02553-03178-0381-RJ	25.527 <i>1.005</i>	31.775 <i>1.251</i>	38.100 <i>1.500</i>	Standard	31.750 / 31.725	25.400 / 25.375
# BP02821-03406-0299-RJ	28.210 <i>1.111</i>	34.060 <i>1.341</i>	29.850 <i>1.175</i>	Standard	34.000 / 33.980	28.000 / 27.300
# BP02870-03495-0191-RJ	28.702 <i>1.130</i>	34.950 <i>1.376</i>	19.050 <i>0.750</i>	Standard	34.925 / 34.900	28.575 / 28.550
# BP02870-03495-0254-RJ	28.702 <i>1.130</i>	34.950 <i>1.376</i>	25.400 <i>1.000</i>	Standard	34.925 / 34.900	28.575 / 28.550
# BP02870-03495-0381-RJ	28.702 <i>1.130</i>	34.950 <i>1.376</i>	38.100 <i>1.500</i>	Standard	34.925 / 34.900	28.575 / 28.550

Indicates item not stocked at time of printing - Please enquire for lead time

E&OE Pricing and all details subject to change without notice - Copyright Miniature Bearings Australia Pty Ltd

MBA Size Listings are a guide to sizes only and must not be solely relied on for critical design information.

Bushes - Plastic - Rulon J - Unflanged

Part Number	Nom. ID (d) mm <i>inches</i>	Nom. OD (D) mm <i>inches</i>	Length (s) mm <i>inches</i>	Type	Rec. Housing Bore mm <i>inches</i>	Rec. Shaft Size mm <i>inches</i>
# BP03022-03606-0299-RJ	30.220 <i>1.190</i>	36.060 <i>1.420</i>	29.850 <i>1.175</i>	Standard	36.000 / 35.980	30.000 / 29.250
# BP03188-03813-0191-RJ	31.877 <i>1.255</i>	38.125 <i>1.501</i>	19.050 <i>0.750</i>	Standard	38.100 / 38.075	31.750 / 31.725
# BP03188-03813-0254-RJ	31.877 <i>1.255</i>	38.125 <i>1.501</i>	25.400 <i>1.000</i>	Standard	38.100 / 38.075	31.750 / 31.725
# BP03188-03813-0381-RJ	31.877 <i>1.255</i>	38.125 <i>1.501</i>	38.100 <i>1.500</i>	Standard	38.100 / 38.075	31.750 / 31.725
# BP03188-03813-0508-RJ	31.877 <i>1.255</i>	38.125 <i>1.501</i>	50.800 <i>2.000</i>	Standard	38.100 / 38.075	31.750 / 31.725
# BP03222-04006-0299-RJ	32.220 <i>1.269</i>	40.060 <i>1.577</i>	29.850 <i>1.175</i>	Standard	40.000 / 39.980	32.000 / 31.200
# BP03505-04130-0254-RJ	35.052 <i>1.380</i>	41.300 <i>1.626</i>	25.400 <i>1.000</i>	Standard	41.275 / 41.250	34.925 / 34.900
# BP03505-04130-0381-RJ	35.052 <i>1.380</i>	41.300 <i>1.626</i>	38.100 <i>1.500</i>	Standard	41.275 / 41.250	34.925 / 34.900
# BP03522-04306-0349-RJ	35.220 <i>1.387</i>	43.060 <i>1.695</i>	34.850 <i>1.372</i>	Standard	43.000 / 42.980	35.000 / 34.125
# BP03825-04448-0254-RJ	38.252 <i>1.506</i>	44.475 <i>1.751</i>	25.400 <i>1.000</i>	Standard	44.450 / 44.425	38.100 / 38.075

Indicates item not stocked at time of printing - Please enquire for lead time

E&OE Pricing and all details subject to change without notice - Copyright Miniature Bearings Australia Pty Ltd

MBA Size Listings are a guide to sizes only and must not be solely relied on for critical design information.

Bushes - Plastic - Rulon J - Unflanged

Part Number	Nom. ID (d) mm <i>inches</i>	Nom. OD (D) mm <i>inches</i>	Length (s) mm <i>inches</i>	Type	Rec. Housing Bore mm <i>inches</i>	Rec. Shaft Size mm <i>inches</i>
# BP03825-04448-0381-RJ	38.252 <i>1.506</i>	44.475 <i>1.751</i>	38.100 <i>1.500</i>	Standard	44.450 / 44.425	38.100 / 38.075
# BP03825-04448-0508-RJ	38.252 <i>1.506</i>	44.475 <i>1.751</i>	50.800 <i>2.000</i>	Standard	44.450 / 44.425	38.100 / 38.075
# BP04022-04806-0399-RJ	40.220 <i>1.583</i>	48.060 <i>1.892</i>	39.850 <i>1.569</i>	Standard	48.000 / 47.980	40.000 / 39.000
# BP04520-05306-0499-RJ	45.200 <i>1.780</i>	53.060 <i>2.089</i>	49.850 <i>1.963</i>	Standard	53.000 / 52.970	45.000 / 43.875
# BP05024-06006-0499-RJ	50.240 <i>1.978</i>	60.060 <i>2.365</i>	49.850 <i>1.963</i>	Standard	60.000 / 59.970	50.000 / 48.750

Indicates item not stocked at time of printing - Please enquire for lead time

E&OE Pricing and all details subject to change without notice - Copyright Miniature Bearings Australia Pty Ltd

MBA Size Listings are a guide to sizes only and must not be solely relied on for critical design information.



DISTRIBUTED BY

Ask us to put your name and address here

<http://www.minibearings.com.au/product>

Ph +61 7 3245 7977

Fax +61 7 3245 1017

Catalogue requests to catalogues@minibearings.com.au
