

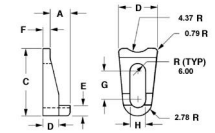

MBA

Clamps - Syncro - Mounting - Adjustable



Clamps - Syncro - Mounting - Adjustable

Part Number	A mm	B mm	C mm	D	E	F mm	Tolerances	Material	G	H
	<i>inches</i>	<i>inches</i>	<i>inches</i>			<i>inches</i>				
# CSA-02.44x07.94x3.18-303P	2.438	7.938	13.097	3.175	1.984	1.270	Precision (+0.000/-0.127)	303 Stainless Steel - Black Oxide	5.953	2.997
	<i>0.096</i>	<i>0.313</i>	<i>0.516</i>			<i>0.050</i>				
# CSA-02.44x07.94x3.18-303C	2.438	7.938	13.097	3.175	1.984	1.270	Commercial (+0.000/-0.254)	303 Stainless Steel - Black Oxide	5.953	2.997
	<i>0.096</i>	<i>0.313</i>	<i>0.516</i>			<i>0.050</i>				
# CSA-03.89x07.94x3.18-303P	3.886	7.938	13.097	3.175	1.984	1.270	Precision (+0.000/-0.127)	303 Stainless Steel - Black Oxide	5.953	2.997
	<i>0.153</i>	<i>0.313</i>	<i>0.516</i>			<i>0.050</i>				

Indicates item not stocked at time of printing - Please enquire for lead time

E&OE Pricing and all details subject to change without notice - Copyright Miniature Bearings Australia Pty Ltd

MBA Size Listings are a guide to sizes only and must not be solely relied on for critical design information.

Clamps - Syncro - Mounting - Adjustable

Part Number	A mm	B mm	C mm	D	E	F mm	Tolerances	Material	G	H
	<i>inches</i>	<i>inches</i>	<i>inches</i>			<i>inches</i>				
# CSA-03.89x07.94x3.18-303C	3.886	7.938	13.097	3.175	1.984	1.270	Commercial (+0.000/-0.254)	303 Stainless Steel - Black Oxide	5.953	2.997
	<i>0.153</i>	<i>0.313</i>	<i>0.516</i>			<i>0.050</i>				

Indicates item not stocked at time of printing - Please enquire for lead time

E&OE Pricing and all details subject to change without notice - Copyright Miniature Bearings Australia Pty Ltd

MBA Size Listings are a guide to sizes only and must not be solely relied on for critical design information.



DISTRIBUTED BY

Ask us to put your name and address here

<http://www.minibearings.com.au/product>

Ph +61 7 3245 7977

Fax +61 7 3245 1017

Catalogue requests to catalogues@minibearings.com.au
