

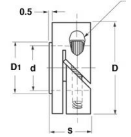

MBA

Collars - Shaft - Fairloc



Collars - Shaft - Fairloc

Part Number	Shaft Size (d) mm <i>inches</i>	Outside Diameter (D) mm <i>inches</i>	Overall Width (S) mm <i>inches</i>	Collar Style	Material	Bore Tolerance mm <i>inches</i>	Screw Size
# COL-03.00x11.00-FLC-BR	3.000 <i>0.118</i>	11.00 <i>0.433</i>	7.00 <i>0.276</i>	Fairloc Shaft Collar	Brass-Black Oxide Finish	+0.014/-0.000	
# COL-03.00x11.00-FLC-303	3.000 <i>0.118</i>	11.00 <i>0.433</i>	7.00 <i>0.276</i>	Fairloc Shaft Collar	303 Stainless Steel	+0.014/-0.000	
# COL-03.05x11.00-FLC-303	3.048 <i>0.120</i>	11.00 <i>0.433</i>	7.01 <i>0.276</i>	Fairloc Shaft collar	Stainless Steel	+ 0.025 / - 0.000	
# COL-03.05x11.00-FLC-BR	3.048 <i>0.120</i>	11.00 <i>0.433</i>	7.01 <i>0.276</i>	Fairloc Shaft collar	Brass With Black Ox	+ 0.025 / - 0.000	

Indicates item not stocked at time of printing - Please enquire for lead time
 E&OE Pricing and all details subject to change without notice - Copyright Miniature Bearings Australia Pty Ltd
 MBA Size Listings are a guide to sizes only and must not be solely relied on for critical design information.

Collars - Shaft - Fairloc

Part Number	Shaft Size (d) mm <i>inches</i>	Outside Diameter (D) mm <i>inches</i>	Overall Width (S) mm <i>inches</i>	Collar Style	Material	Bore Tolerance mm <i>inches</i>	Screw Size
# COL-03.18x11.00-FLC-303	3.175 <i>0.125</i>	11.00 <i>0.433</i>	7.01 <i>0.276</i>	Fairloc Shaft collar	Stainless Steel	+ 0.025 / - 0.000	
# COL-03.18x11.00-FLC-BR	3.175 <i>0.125</i>	11.00 <i>0.433</i>	7.01 <i>0.276</i>	Fairloc Shaft collar	Brass With Black Ox	+ 0.025 / - 0.000	
# COL-04.00x12.50-FLC-303	4.000 <i>0.157</i>	12.50 <i>0.492</i>	7.00 <i>0.276</i>	Fairloc Shaft Collar	303 Stainless Steel	+0.018/-0.000	
# COL-04.00x12.50-FLC-BR	4.000 <i>0.157</i>	12.50 <i>0.492</i>	7.00 <i>0.276</i>	Fairloc Shaft Collar	Brass-Black Oxide Finish	+0.018/-0.000	
# COL-04.76x12.57-FLC-303	4.763 <i>0.188</i>	12.57 <i>0.495</i>	7.01 <i>0.276</i>	Fairloc Shaft collar	Stainless Steel	+ 0.025 / - 0.000	
# COL-04.76x12.57-FLC-BR	4.763 <i>0.188</i>	12.57 <i>0.495</i>	7.01 <i>0.276</i>	Fairloc Shaft collar	Brass With Black Ox	+ 0.025 / - 0.000	
# COL-05.00x16.00-FLC-BR	5.000 <i>0.197</i>	16.00 <i>0.630</i>	9.00 <i>0.354</i>	Fairloc Shaft Collar	Brass-Black Oxide Finish	+0.018/-0.000	
# COL-05.00x16.00-FLC-303	5.000 <i>0.197</i>	16.00 <i>0.630</i>	9.00 <i>0.354</i>	Fairloc Shaft Collar	303 Stainless Steel	+0.018/-0.000	
# COL-06.00x16.00-FLC-303	6.000 <i>0.236</i>	16.00 <i>0.630</i>	9.00 <i>0.354</i>	Fairloc Shaft Collar	303 Stainless Steel	+0.022/-0.000	

Indicates item not stocked at time of printing - Please enquire for lead time

E&OE Pricing and all details subject to change without notice - Copyright Miniature Bearings Australia Pty Ltd

MBA Size Listings are a guide to sizes only and must not be solely relied on for critical design information.

Collars - Shaft - Fairloc

Part Number	Shaft Size (d) mm <i>inches</i>	Outside Diameter (D) mm <i>inches</i>	Overall Width (S) mm <i>inches</i>	Collar Style	Material	Bore Tolerance mm <i>inches</i>	Screw Size
# COL-06.00x16.00-FLC-BR	6.000 <i>0.236</i>	16.00 <i>0.630</i>	9.00 <i>0.354</i>	Fairloc Shaft Collar	Brass-Black Oxide Finish	+0.022/-0.000	
# COL-06.35x16.00-FLC-303	6.350 <i>0.250</i>	16.00 <i>0.630</i>	8.99 <i>0.354</i>	Fairloc Shaft collar	Stainless Steel	+ 0.025 / - 0.000	
# COL-06.35x16.00-FLC-BR	6.350 <i>0.250</i>	16.00 <i>0.630</i>	8.99 <i>0.354</i>	Fairloc Shaft collar	Brass With Black Ox	+ 0.025 / - 0.000	
COL-07.94x22.10-FLC-303	7.938 <i>0.313</i>	22.10 <i>0.870</i>	11.00 <i>0.433</i>	Fairloc Shaft collar	Stainless Steel	+ 0.025 / - 0.000	
# COL-07.94x22.10-FLC-BR	7.938 <i>0.313</i>	22.10 <i>0.870</i>	11.00 <i>0.433</i>	Fairloc Shaft collar	Brass With Black Ox	+ 0.025 / - 0.000	
# COL-08.00x22.00-FLC-BR	8.000 <i>0.315</i>	22.00 <i>0.866</i>	11.00 <i>0.433</i>	Fairloc Shaft Collar	Brass-Black Oxide Finish	+0.022/-0.000	
# COL-08.00x22.00-FLC-303	8.000 <i>0.315</i>	22.00 <i>0.866</i>	11.00 <i>0.433</i>	Fairloc Shaft Collar	303 Stainless Steel	+0.022/-0.000	
# COL-09.53x22.10-FLC-303	9.525 <i>0.375</i>	22.10 <i>0.870</i>	11.00 <i>0.433</i>	Fairloc Shaft collar	Stainless Steel	+ 0.025 / - 0.000	
# COL-09.53x22.10-FLC-BR	9.525 <i>0.375</i>	22.10 <i>0.870</i>	11.00 <i>0.433</i>	Fairloc Shaft collar	Brass With Black Ox	+ 0.025 / - 0.000	
# COL-10.00x25.00-FLC-303	10.000 <i>0.394</i>	25.00 <i>0.984</i>	11.00 <i>0.433</i>	Fairloc Shaft Collar	303 Stainless Steel	+0.027/-0.000	

Indicates item not stocked at time of printing - Please enquire for lead time

E&OE Pricing and all details subject to change without notice - Copyright Miniature Bearings Australia Pty Ltd

MBA Size Listings are a guide to sizes only and must not be solely relied on for critical design information.

Collars - Shaft - Fairloc

Part Number	Shaft Size (d) mm <i>inches</i>	Outside Diameter (D) mm <i>inches</i>	Overall Width (S) mm <i>inches</i>	Collar Style	Material	Bore Tolerance mm <i>inches</i>	Screw Size
# COL-10.00x25.00-FLC-BR	10.000 <i>0.394</i>	25.00 <i>0.984</i>	11.00 <i>0.433</i>	Fairloc Shaft Collar	Brass-Black Oxide Finish	+0.027/-0.000	
# COL-12.00x25.00-FLC-303	12.000 <i>0.472</i>	25.00 <i>0.984</i>	11.00 <i>0.433</i>	Fairloc Shaft Collar	303 Stainless Steel	+0.027/-0.000	
# COL-12.00x25.00-FLC-BR	12.000 <i>0.472</i>	25.00 <i>0.984</i>	11.00 <i>0.433</i>	Fairloc Shaft Collar	Brass-Black Oxide Finish	+0.027/-0.000	
# COL-12.70x24.99-FLC-303	12.700 <i>0.500</i>	24.99 <i>0.984</i>	11.00 <i>0.433</i>	Fairloc Shaft collar	Stainless Steel	+ 0.025 / - 0.000	
# COL-12.70x24.99-FLC-BR	12.700 <i>0.500</i>	24.99 <i>0.984</i>	11.00 <i>0.433</i>	Fairloc Shaft collar	Brass With Black Ox	+ 0.025 / - 0.000	
# COL-15.00x30.00-FLC-BR	15.000 <i>0.591</i>	30.00 <i>1.181</i>	14.00 <i>0.551</i>	Fairloc Shaft Collar	Brass-Black Oxide Finish	+0.027/-0.000	
# COL-15.00x30.00-FLC-303	15.000 <i>0.591</i>	30.00 <i>1.181</i>	14.00 <i>0.551</i>	Fairloc Shaft Collar	303 Stainless Steel	+0.027/-0.000	
# COL-15.88x30.00-FLC-303	15.875 <i>0.625</i>	30.00 <i>1.181</i>	14.00 <i>0.551</i>	Fairloc Shaft collar	Stainless Steel	+ 0.025 / - 0.000	
# COL-15.88x30.00-FLC-BR	15.875 <i>0.625</i>	30.00 <i>1.181</i>	14.00 <i>0.551</i>	Fairloc Shaft collar	Brass With Black Ox	+ 0.025 / - 0.000	

Indicates item not stocked at time of printing - Please enquire for lead time

E&OE Pricing and all details subject to change without notice - Copyright Miniature Bearings Australia Pty Ltd

MBA Size Listings are a guide to sizes only and must not be solely relied on for critical design information.

Collars - Shaft - Fairloc

Part Number	Shaft Size (d) mm <i>inches</i>	Outside Diameter (D) mm <i>inches</i>	Overall Width (S) mm <i>inches</i>	Collar Style	Material	Bore Tolerance mm <i>inches</i>	Screw Size
# COL-19.05x38.00-FLC-303	19.050 <i>0.750</i>	38.00 <i>1.496</i>	16.00 <i>0.630</i>	Fairloc Shaft collar	Stainless Steel	+ 0.025 / - 0.000	
# COL-19.05x38.00-FLC-BR	19.050 <i>0.750</i>	38.00 <i>1.496</i>	16.00 <i>0.630</i>	Fairloc Shaft collar	Brass With Black Ox	+ 0.025 / - 0.000	
# COL-20.00x38.00-FLC-BR	20.000 <i>0.787</i>	38.00 <i>1.496</i>	16.00 <i>0.630</i>	Fairloc Shaft Collar	Brass-Black Oxide Finish	+0.033/-0.000	
# COL-20.00x38.00-FLC-303	20.000 <i>0.787</i>	38.00 <i>1.496</i>	16.00 <i>0.630</i>	Fairloc Shaft Collar	303 Stainless Steel	+0.033/-0.000	

Indicates item not stocked at time of printing - Please enquire for lead time

E&OE Pricing and all details subject to change without notice - Copyright Miniature Bearings Australia Pty Ltd

MBA Size Listings are a guide to sizes only and must not be solely relied on for critical design information.



DISTRIBUTED BY

Ask us to put your name and address here

<http://www.minibearings.com.au/product>

Ph +61 7 3245 7977

Fax +61 7 3245 1017

Catalogue requests to catalogues@minibearings.com.au

