

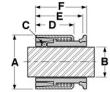

MBA

Collars - Shaft - Gripfast



Self Locking - Quick Release.

265 kg Load Capacity (600 lbs).

ABS Plastic Inner Body and Outer Sleeve.

Steel Retention Ring, Balls and Springs.

Collars - Shaft - Gripfast

Part Number	Shaft Diameter mm <i>inches</i>	Sleeve Outside Diameter mm <i>inches</i>	Overall Length mm <i>inches</i>	Sleeve Length mm <i>inches</i>	Material
# COL-03.18-GF	3.175 <i>0.125</i>	14.17 <i>0.558</i>	23.88 <i>0.940</i>	16.205 <i>0.638</i>	Plastic (ABS) & Steel
# COL-04.00-GF	4.000 <i>0.157</i>	14.17 <i>0.558</i>	23.88 <i>0.940</i>	23.880 <i>0.940</i>	Plastic (ABS) & Steel
# COL-04.76-GF	4.763 <i>0.188</i>	14.17 <i>0.558</i>	23.88 <i>0.940</i>	16.205 <i>0.638</i>	Plastic (ABS) & Steel
# COL-05.00-GF	5.000 <i>0.197</i>	14.17 <i>0.558</i>	23.88 <i>0.940</i>	23.880 <i>0.940</i>	Plastic (ABS) & Steel

Indicates item not stocked at time of printing - Please enquire for lead time

E&OE Pricing and all details subject to change without notice - Copyright Miniature Bearings Australia Pty Ltd

MBA Size Listings are a guide to sizes only and must not be solely relied on for critical design information.

Collars - Shaft - Gripfast

Part Number	Shaft Diameter mm	Sleeve Outside Diameter mm	Overall Length mm	Sleeve Length mm	Material
	<i>inches</i>	<i>inches</i>	<i>inches</i>	<i>inches</i>	
# COL-06.00-GF	6.000 <i>0.236</i>	18.14 <i>0.714</i>	25.40 <i>1.000</i>	25.400 <i>1.000</i>	Plastic (ABS) & Steel
# COL-06.35-GF304	6.350 <i>0.250</i>	18.80 <i>0.740</i>	25.40 <i>1.000</i>	16.205 <i>0.638</i>	304 Stainless Steel
# COL-06.35-GF	6.350 <i>0.250</i>	18.87 <i>0.743</i>	25.65 <i>1.010</i>	16.205 <i>0.638</i>	Plastic (ABS) & Steel
# COL-07.94-GF304	7.938 <i>0.313</i>	18.80 <i>0.740</i>	25.40 <i>1.000</i>	16.205 <i>0.638</i>	304 Stainless Steel
# COL-07.94-GF	7.938 <i>0.313</i>	18.87 <i>0.743</i>	25.65 <i>1.010</i>	16.205 <i>0.638</i>	Plastic (ABS) & Steel
# COL-08.00-GF	8.000 <i>0.315</i>	28.12 <i>1.107</i>	26.80 <i>1.055</i>	26.800 <i>1.055</i>	Plastic (ABS) & Steel
# COL-09.53-GF	9.525 <i>0.375</i>	28.12 <i>1.107</i>	26.54 <i>1.045</i>	20.320 <i>0.800</i>	Plastic (ABS) & Steel
# COL-09.53-GF304	9.525 <i>0.375</i>	28.32 <i>1.115</i>	27.94 <i>1.100</i>	20.371 <i>0.802</i>	304 Stainless Steel
# COL-10.00-GF	10.000 <i>0.394</i>	28.12 <i>1.107</i>	26.80 <i>1.055</i>	26.800 <i>1.055</i>	Plastic (ABS) & Steel
# COL-12.00-GF	12.00 <i>0.472</i>	28.12 <i>1.107</i>	26.54 <i>1.045</i>	20.32 <i>0.800</i>	ABS Plastic/Steel

Indicates item not stocked at time of printing - Please enquire for lead time

E&OE Pricing and all details subject to change without notice - Copyright Miniature Bearings Australia Pty Ltd

MBA Size Listings are a guide to sizes only and must not be solely relied on for critical design information.

Collars - Shaft - Gripfast

Part Number	Shaft Diameter mm	Sleeve Outside Diameter mm	Overall Length mm	Sleeve Length mm	Material
	<i>inches</i>	<i>inches</i>	<i>inches</i>	<i>inches</i>	
# COL-12.70-GF	12.700 <i>0.500</i>	28.12 <i>1.107</i>	26.54 <i>1.045</i>	20.320 <i>0.800</i>	Plastic (ABS) & Steel
# COL-12.70-GF304	12.700 <i>0.500</i>	28.32 <i>1.115</i>	27.94 <i>1.100</i>	20.371 <i>0.802</i>	304 Stainless Steel
# COL-13.00-GF	13.000 <i>0.512</i>	28.12 <i>1.107</i>	26.80 <i>1.055</i>	26.800 <i>1.055</i>	Plastic (ABS) & Steel
# COL-14.00-GF	14.000 <i>0.551</i>	35.56 <i>1.400</i>	37.08 <i>1.460</i>	37.080 <i>1.460</i>	Plastic (ABS) & Steel
# COL-15.88-GF	15.875 <i>0.625</i>	35.56 <i>1.400</i>	37.08 <i>1.460</i>	25.400 <i>1.000</i>	Plastic (ABS) & Steel
# COL-15.88-GF304	15.875 <i>0.625</i>	35.56 <i>1.400</i>	38.10 <i>1.500</i>	25.400 <i>1.000</i>	304 Stainless Steel
# COL-16.00-GF	16.000 <i>0.630</i>	35.56 <i>1.400</i>	37.08 <i>1.460</i>	37.080 <i>1.460</i>	Plastic (ABS) & Steel
# COL-19.05-GF	19.050 <i>0.750</i>	35.56 <i>1.400</i>	37.08 <i>1.460</i>	25.400 <i>1.000</i>	Plastic (ABS) & Steel
# COL-19.05-GF304	19.050 <i>0.750</i>	35.56 <i>1.400</i>	38.10 <i>1.500</i>	25.400 <i>1.000</i>	304 Stainless Steel
# COL-20.00-GF	20.000 <i>0.787</i>	35.56 <i>1.400</i>	37.08 <i>1.460</i>	37.080 <i>1.460</i>	Plastic (ABS) & Steel

Indicates item not stocked at time of printing - Please enquire for lead time

E&OE Pricing and all details subject to change without notice - Copyright Miniature Bearings Australia Pty Ltd

MBA Size Listings are a guide to sizes only and must not be solely relied on for critical design information.

Collars - Shaft - Gripfast

Part Number	Shaft Diameter mm <i>inches</i>	Sleeve Outside Diameter mm <i>inches</i>	Overall Length mm <i>inches</i>	Sleeve Length mm <i>inches</i>	Material
# COL-22.00-GF	22.00 <i>0.866</i>	47.24 <i>1.860</i>	50.93 <i>2.005</i>	33.66 <i>1.325</i>	ABS Plastic/Steel
# COL-22.23-GF	22.225 <i>0.875</i>	47.24 <i>1.860</i>	50.93 <i>2.005</i>	33.655 <i>1.325</i>	Plastic (ABS) & Steel
# COL-22.23-GF304	22.225 <i>0.875</i>	47.37 <i>1.865</i>	50.80 <i>2.000</i>	33.655 <i>1.325</i>	304 Stainless Steel
# COL-25.00-GF	25.000 <i>0.984</i>	47.24 <i>1.860</i>	50.93 <i>2.005</i>	50.930 <i>2.005</i>	Plastic (ABS) & Steel
# COL-25.40-GF	25.400 <i>1.000</i>	47.24 <i>1.860</i>	50.93 <i>2.005</i>	33.655 <i>1.325</i>	Plastic (ABS) & Steel
# COL-25.40-GF304	25.400 <i>1.000</i>	47.37 <i>1.865</i>	50.80 <i>2.000</i>	33.655 <i>1.325</i>	304 Stainless Steel
# COL-27.00-GF	27.000 <i>1.063</i>	47.24 <i>1.860</i>	50.93 <i>2.005</i>	50.930 <i>2.005</i>	Plastic (ABS) & Steel
# COL-28.00-GF	28.000 <i>1.102</i>	47.24 <i>1.860</i>	50.93 <i>2.005</i>	50.930 <i>2.005</i>	Plastic (ABS) & Steel
# COL-29.00-GF	29.000 <i>1.142</i>	47.24 <i>1.860</i>	50.93 <i>2.005</i>	50.930 <i>2.005</i>	Plastic (ABS) & Steel
# COL-30.00-GF	30.000 <i>1.181</i>	54.61 <i>2.150</i>	46.36 <i>1.825</i>	46.360 <i>1.825</i>	Plastic (ABS) & Steel

Indicates item not stocked at time of printing - Please enquire for lead time

E&OE Pricing and all details subject to change without notice - Copyright Miniature Bearings Australia Pty Ltd

MBA Size Listings are a guide to sizes only and must not be solely relied on for critical design information.

Collars - Shaft - Gripfast

Part Number	Shaft Diameter mm	Sleeve Outside Diameter mm	Overall Length mm	Sleeve Length mm	Material
	<i>inches</i>	<i>inches</i>	<i>inches</i>	<i>inches</i>	
# COL-31.75-GF	31.750 <i>1.250</i>	54.99 <i>2.165</i>	46.36 <i>1.825</i>	34.036 <i>1.340</i>	Plastic (ABS) & Steel
# COL-31.75-GF304	31.750 <i>1.250</i>	55.88 <i>2.200</i>	45.72 <i>1.800</i>	33.909 <i>1.335</i>	304 Stainless Steel
# COL-32.00-GF	32.000 <i>1.260</i>	54.61 <i>2.150</i>	46.36 <i>1.825</i>	46.360 <i>1.825</i>	Plastic (ABS) & Steel
# COL-34.93-GF	34.925 <i>1.375</i>	54.99 <i>2.165</i>	46.36 <i>1.825</i>	34.036 <i>1.340</i>	Plastic (ABS) & Steel
# COL-34.93-GF304	34.925 <i>1.375</i>	55.88 <i>2.200</i>	45.72 <i>1.800</i>	33.909 <i>1.335</i>	304 Stainless Steel
# COL-35.00-GF	35.000 <i>1.378</i>	54.61 <i>2.150</i>	46.36 <i>1.825</i>	46.360 <i>1.825</i>	Plastic (ABS) & Steel
# COL-38.00-GF	38.000 <i>1.496</i>	54.61 <i>2.150</i>	46.36 <i>1.825</i>	46.360 <i>1.825</i>	Plastic (ABS) & Steel
# COL-38.10-GF	38.100 <i>1.500</i>	54.99 <i>2.165</i>	46.36 <i>1.825</i>	34.036 <i>1.340</i>	Plastic (ABS) & Steel
# COL-38.10-GF304	38.100 <i>1.500</i>	55.88 <i>2.200</i>	45.72 <i>1.800</i>	33.909 <i>1.335</i>	304 Stainless Steel
# COL-44.45-GF304	44.450 <i>1.750</i>	69.09 <i>2.720</i>	52.71 <i>2.075</i>	33.909 <i>1.335</i>	304 Stainless Steel

Indicates item not stocked at time of printing - Please enquire for lead time

E&OE Pricing and all details subject to change without notice - Copyright Miniature Bearings Australia Pty Ltd

MBA Size Listings are a guide to sizes only and must not be solely relied on for critical design information.

Collars - Shaft - Gripfast

Part Number	Shaft Diameter mm <i>inches</i>	Sleeve Outside Diameter mm <i>inches</i>	Overall Length mm <i>inches</i>	Sleeve Length mm <i>inches</i>	Material
# COL-44.45-GF	44.450 <i>1.750</i>	69.22 <i>2.725</i>	52.45 <i>2.065</i>	33.909 <i>1.335</i>	Plastic (ABS) & Steel
COL-50.00-GF	50.000 <i>1.969</i>	69.09 <i>2.720</i>	52.96 <i>2.085</i>	52.960 <i>2.085</i>	Plastic (ABS) & Steel
# COL-50.80-GF304	50.800 <i>2.000</i>	69.09 <i>2.720</i>	52.71 <i>2.075</i>	33.909 <i>1.335</i>	304 Stainless Steel
# COL-50.80-GF	50.800 <i>2.000</i>	69.22 <i>2.725</i>	52.45 <i>2.065</i>	33.909 <i>1.335</i>	Plastic (ABS) & Steel
# COL-63.50-GF304	63.500 <i>2.500</i>	84.13 <i>3.312</i>	39.68 <i>1.562</i>	31.369 <i>1.235</i>	304 Stainless Steel
# COL-63.50-GF	63.500 <i>2.500</i>	84.96 <i>3.345</i>	39.88 <i>1.570</i>	31.496 <i>1.240</i>	Plastic (ABS) & Steel
# COL-70.00-GF	70.000 <i>2.756</i>	95.89 <i>3.775</i>	50.80 <i>2.000</i>	50.800 <i>2.000</i>	Plastic (ABS) & Steel
# COL-73.00-GF	73.000 <i>2.874</i>	95.89 <i>3.775</i>	50.80 <i>2.000</i>	50.800 <i>2.000</i>	Plastic (ABS) & Steel
# COL-76.00-GF	76.000 <i>2.992</i>	95.89 <i>3.775</i>	50.80 <i>2.000</i>	50.800 <i>2.000</i>	Plastic (ABS) & Steel
# COL-76.20-GF	76.200 <i>3.000</i>	95.89 <i>3.775</i>	50.29 <i>1.980</i>	40.640 <i>1.600</i>	Plastic (ABS) & Steel

Indicates item not stocked at time of printing - Please enquire for lead time

E&OE Pricing and all details subject to change without notice - Copyright Miniature Bearings Australia Pty Ltd

MBA Size Listings are a guide to sizes only and must not be solely relied on for critical design information.

Collars - Shaft - Gripfast

Part Number	Shaft Diameter mm	Sleeve Outside Diameter mm	Overall Length mm	Sleeve Length mm	Material
	<i>inches</i>	<i>inches</i>	<i>inches</i>	<i>inches</i>	
# COL-76.20-GF304	76.200	95.89	50.80	40.640	304 Stainless Steel
	<i>3.000</i>	<i>3.775</i>	<i>2.000</i>	<i>1.600</i>	

Indicates item not stocked at time of printing - Please enquire for lead time

E&OE Pricing and all details subject to change without notice - Copyright Miniature Bearings Australia Pty Ltd

MBA Size Listings are a guide to sizes only and must not be solely relied on for critical design information.



DISTRIBUTED BY

Ask us to put your name and address here

<http://www.minibearings.com.au/product>

Ph +61 7 3245 7977

Fax +61 7 3245 1017

Catalogue requests to catalogues@minibearings.com.au

