

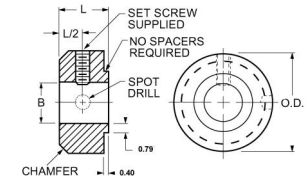

MBA

Collars - Shaft - With Integral Shim



Bore tolerance (+0.003/+0.013).

Imperial Collars have undersized tolerances.

Metric Collars have oversized tolerances.

Collars - Shaft - With Integral Shim

Part Number	Nom Shaft Size mm <i>inches</i>	Outside Diameter	Overall Width	Material
# COL-01.98x05.56-IS303	1.975 <i>0.078</i>	5.56	3.05	303 Stainless Steel
# COL-02.38x06.35-IS303	2.371 <i>0.093</i>	6.35	3.05	303 Stainless Steel
# COL-03.00x08.00-IS303	3.000 <i>0.118</i>	8.00	4.00	303 Stainless Steel
# COL-03.18x07.94-IS303	3.166 <i>0.125</i>	7.94	4.57	303 Stainless Steel

Indicates item not stocked at time of printing - Please enquire for lead time

E&OE Pricing and all details subject to change without notice - Copyright Miniature Bearings Australia Pty Ltd

MBA Size Listings are a guide to sizes only and must not be solely relied on for critical design information.

Collars - Shaft - With Integral Shim

Part Number	Nom Shaft Size mm <i>inches</i>	Outside Diameter	Overall Width	Material
# COL-03.97x07.94-IS303	3.958 <i>0.156</i>	7.94	4.57	303 Stainless Steel
# COL-04.00x10.00-IS303	4.000 <i>0.157</i>	10.00	5.00	303 Stainless Steel
# COL-04.76x09.53-IS303	4.754 <i>0.187</i>	9.53	5.59	303 Stainless Steel
COL-05.00x12.00-IS303	5.000 <i>0.197</i>	12.00	5.00	303 Stainless Steel
COL-06.00x12.00-IS303	6.000 <i>0.236</i>	12.00	6.00	303 Stainless Steel
# COL-06.11x12.70-IS303	6.105 <i>0.240</i>	12.70	6.35	303 Stainless Steel
# COL-06.35x12.70-IS303	6.341 <i>0.250</i>	12.70	6.35	303 Stainless Steel
# COL-07.00x16.00-IS303	7.000 <i>0.276</i>	16.00	6.00	303 Stainless Steel
# COL-07.94x12.70-IS303	7.929 <i>0.312</i>	12.70	6.35	303 Stainless Steel
COL-08.00x16.00-IS303	8.000 <i>0.315</i>	16.00	6.00	303 Stainless Steel

Indicates item not stocked at time of printing - Please enquire for lead time

E&OE Pricing and all details subject to change without notice - Copyright Miniature Bearings Australia Pty Ltd

MBA Size Listings are a guide to sizes only and must not be solely relied on for critical design information.

Collars - Shaft - With Integral Shim

Part Number	Nom Shaft Size mm <i>inches</i>	Outside Diameter	Overall Width	Material
# COL-09.53x19.05-IS303	9.516 <i>0.375</i>	19.05	9.53	303 Stainless Steel
# COL-10.00x19.00-IS303	10.000 <i>0.394</i>	19.00	10.00	303 Stainless Steel
# COL-12.00x19.00-IS303	12.000 <i>0.472</i>	19.00	10.00	303 Stainless Steel
# COL-12.70x25.40-IS303	12.691 <i>0.500</i>	25.40	11.10	303 Stainless Steel
# COL-15.00x32.00-IS303	15.00 <i>0.591</i>	32.00	12.00	303 Stainless Steel
# COL-15.88x31.75-IS303	15.866 <i>0.625</i>	31.75	12.70	303 Stainless Steel
# COL-16.00x32.00-IS303	16.000 <i>0.630</i>	32.00	12.00	303 Stainless Steel
# COL-19.00x38.00-IS303	19.000 <i>0.748</i>	38.00	14.00	303 Stainless Steel
# COL-19.05x38.10-IS303	19.041 <i>0.750</i>	38.10	14.28	303 Stainless Steel
# COL-20.00x38.00-IS303	20.00 <i>0.787</i>	38.00	14.00	303 Stainless Steel

Indicates item not stocked at time of printing - Please enquire for lead time

E&OE Pricing and all details subject to change without notice - Copyright Miniature Bearings Australia Pty Ltd

MBA Size Listings are a guide to sizes only and must not be solely relied on for critical design information.

Collars - Shaft - With Integral Shim

Part Number	Nom Shaft Size mm <i>inches</i>	Outside Diameter	Overall Width	Material
# COL-25.40x50.80-IS303	25.391 <i>1.000</i>	50.80	15.88	303 Stainless Steel
# COL-31.75x57.15-IS303	31.741 <i>1.250</i>	57.15	19.05	303 Stainless Steel

Indicates item not stocked at time of printing - Please enquire for lead time

E&OE Pricing and all details subject to change without notice - Copyright Miniature Bearings Australia Pty Ltd

MBA Size Listings are a guide to sizes only and must not be solely relied on for critical design information.



DISTRIBUTED BY

Ask us to put your name and address here

<http://www.minibearings.com.au/product>

Ph +61 7 3245 7977

Fax +61 7 3245 1017

Catalogue requests to catalogues@minibearings.com.au
