



MBA

Couplings - Bellows - Integral Clamp - Polished Stainless and Aluminium

Zero Backlash - Low Inertia - Compact

Polished Stainless Bellows

Anodised Aluminium Hubs

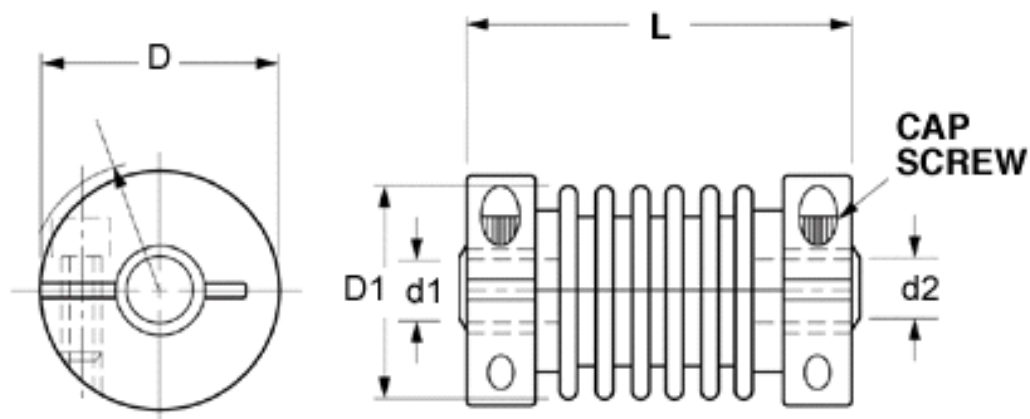

Couplings - Bellows - Integral Clamp - Polished Stainless and Aluminium

Part Number	Bellows OD (D1) mm	Bores (d1 / d2) mm	Overall Length (L) mm	Max. Torque N.m	Max. Speed RPM	Hub Diameter (D) mm	Angular Offset Deg.	Lateral Offset mm
	<i>inches</i>	<i>inches</i>	<i>inches</i>			<i>inches</i>		<i>inches</i>
# CPB2237-0794-0794-3C	22.1	7.938 / 7.938	36.5	1.06		6-32 Cap Screw / 28.58 mm	5.0	0.25
	<i>0.870</i>		<i>1.437</i>					<i>0.010</i>
# CPB2245-0794-0794-3C	22.1	7.938 / 7.938	44.5	0.70		6-32 Cap Screw / 28.58 mm	7.0	0.51
	<i>0.870</i>		<i>1.752</i>					<i>0.020</i>
# CPB2252-0794-0794-3C	22.1	7.938 / 7.938	52.4	0.70		6-32 Cap Screw / 28.58 mm	10.0	0.76
	<i>0.870</i>		<i>2.063</i>					<i>0.030</i>

Indicates item not stocked at time of printing - Please enquire for lead time

E&OE Pricing and all details subject to change without notice - Copyright Miniature Bearings Australia Pty Ltd

MBA Size Listings are a guide to sizes only and must not be solely relied on for critical design information.

Couplings - Bellows - Integral Clamp - Polished Stainless and Aluminium

Part Number	Bellows OD (D1) mm <i>inches</i>	Bores (d1 / d2) mm <i>inches</i>	Overall Length (L) mm <i>inches</i>	Max. Torque N.m	Max. Speed RPM	Hub Diameter (D) mm <i>inches</i>	Angular Offset Deg.	Lateral Offset mm <i>inches</i>
# CPB2237-0800-0800-3C	22.1 <i>0.870</i>	8.000 / 8.000	36.5 <i>1.437</i>	1.06		28.60 mm	5.0	0.25 <i>0.010</i>
# CPB2244-0800-0800-3C	22.1 <i>0.870</i>	8.000 / 8.000	44.4 <i>1.748</i>	0.71		28.60 mm	7.0	0.51 <i>0.020</i>
# CPB2252-0800-0800-3C	22.1 <i>0.870</i>	8.000 / 8.000	52.4 <i>2.063</i>	0.71		28.60 mm	10.0	0.76 <i>0.030</i>
# CPB2237-0953-0953-3C	22.1 <i>0.870</i>	9.525 / 9.525	36.5 <i>1.437</i>	1.06		6-32 Cap Screw / 28.58 mm	5.0	0.25 <i>0.010</i>
# CPB2245-0953-0953-3C	22.1 <i>0.870</i>	9.525 / 9.525	44.5 <i>1.752</i>	0.70		6-32 Cap Screw / 28.58 mm	7.0	0.51 <i>0.020</i>
# CPB2252-0953-0953-3C	22.1 <i>0.870</i>	9.525 / 9.525	52.4 <i>2.063</i>	0.70		6-32 Cap Screw / 28.58 mm	10.0	0.76 <i>0.030</i>
# CPB2237-1000-1000-3C	22.1 <i>0.870</i>	10.000 / 10.000	36.5 <i>1.437</i>	1.06		28.60 mm	5.0	0.25 <i>0.010</i>
# CPB2244-1000-1000-3C	22.1 <i>0.870</i>	10.000 / 10.000	44.4 <i>1.748</i>	0.71		28.60 mm	7.0	0.51 <i>0.020</i>
# CPB2253-1000-1000-3C	22.1 <i>0.870</i>	10.000 / 10.000	52.5 <i>2.067</i>	0.71		28.60 mm	10.0	0.76 <i>0.030</i>

Indicates item not stocked at time of printing - Please enquire for lead time

E&OE Pricing and all details subject to change without notice - Copyright Miniature Bearings Australia Pty Ltd

MBA Size Listings are a guide to sizes only and must not be solely relied on for critical design information.



DISTRIBUTED BY

Ask us to put your name and address here

<http://www.minibearings.com.au/product>

Ph +61 7 3245 7977

Fax +61 7 3245 1017

Catalogue requests to catalogues@minibearings.com.au

