

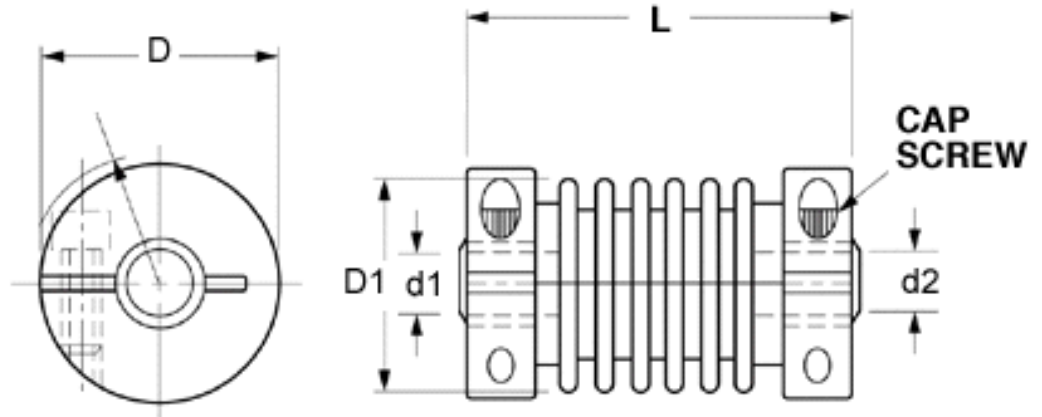

# MBA

## Couplings - Bellows - Integral Clamp - Polished Stainless



Zero Backlash - Low Inertia - Compact

Polished Stainless Bellows

Polished Stainless Hubs

## Couplings - Bellows - Integral Clamp - Polished Stainless

Part Number	Bellows OD (D1) mm <i>inches</i>	Bores (d1 / d2) mm <i>inches</i>	Overall Length (L) mm <i>inches</i>	Max. Torque N.m	Max. Speed RPM	Hub Diameter (D) mm <i>inches</i>	Angular Offset Deg.	Lateral Offset mm <i>inches</i>
# CPB1524-0300-0300-3C	14.5 <i>0.571</i>	3.000 / 3.000	23.8 <i>0.937</i>	0.49		15.20 mm	2.5	0.13 <i>0.005</i>
# CPB1530-0300-0300-3C	14.5 <i>0.571</i>	3.000 / 3.000	30.1 <i>1.185</i>	0.42		15.20 mm	5.0	0.25 <i>0.010</i>
# CPB1537-0300-0300-3C	14.5 <i>0.571</i>	3.000 / 3.000	36.5 <i>1.437</i>	0.35		15.20 mm	7.0	0.38 <i>0.015</i>
# CPB1524-0318-0318-3C	14.5 <i>0.571</i>	3.175 / 3.175	23.8 <i>0.937</i>	0.49		2-56 Cap Screw / 15.24 mm	2.5	0.13 <i>0.005</i>

# Indicates item not stocked at time of printing - Please enquire for lead time

E&OE Pricing and all details subject to change without notice - Copyright Miniature Bearings Australia Pty Ltd

MBA Size Listings are a guide to sizes only and must not be solely relied on for critical design information.

## Couplings - Bellows - Integral Clamp - Polished Stainless

Part Number	Bellows OD (D1) mm <i>inches</i>	Bores (d1 / d2) mm <i>inches</i>	Overall Length (L) mm <i>inches</i>	Max. Torque N.m	Max. Speed RPM	Hub Diameter (D) mm <i>inches</i>	Angular Offset Deg.	Lateral Offset mm <i>inches</i>
# CPB1530-0318-0318-3C	14.5 <i>0.571</i>	3.175 / 3.175	30.2 <i>1.189</i>	0.42		2-56 Cap Screw / 15.24 mm	5.0	0.25 <i>0.010</i>
# CPB1537-0318-0318-3C	14.5 <i>0.571</i>	3.175 / 3.175	36.5 <i>1.437</i>	0.35		2-56 Cap Screw / 15.24 mm	7.0	0.38 <i>0.015</i>
# CPB1524-0400-0400-3C	14.5 <i>0.571</i>	4.000 / 4.000	23.8 <i>0.937</i>	0.49		15.20 mm	2.5	0.13 <i>0.005</i>
# CPB1530-0400-0400-3C	14.5 <i>0.571</i>	4.000 / 4.000	30.1 <i>1.185</i>	0.42		15.20 mm	5.0	0.25 <i>0.010</i>
# CPB1537-0400-0400-3C	14.5 <i>0.571</i>	4.000 / 4.000	36.5 <i>1.437</i>	0.35		15.20 mm	7.0	0.38 <i>0.015</i>
# CPB1524-0476-0476-3C	14.5 <i>0.571</i>	4.762 / 4.762	23.8 <i>0.937</i>	0.49		2-56 Cap Screw / 15.24 mm	2.5	0.13 <i>0.005</i>
# CPB1530-0476-0476-3C	14.5 <i>0.571</i>	4.762 / 4.762	30.2 <i>1.189</i>	0.42		2-56 Cap Screw / 15.24 mm	5.0	0.25 <i>0.010</i>
# CPB1537-0476-0476-3C	14.5 <i>0.571</i>	4.762 / 4.762	36.5 <i>1.437</i>	0.35		2-56 Cap Screw / 15.24 mm	7.0	0.38 <i>0.015</i>
# CPB2032-0600-0600-3C	20.1 <i>0.791</i>	6.000 / 6.000	31.8 <i>1.252</i>	0.57		21.80 mm	5.0	0.25 <i>0.010</i>

# Indicates item not stocked at time of printing - Please enquire for lead time

E&OE Pricing and all details subject to change without notice - Copyright Miniature Bearings Australia Pty Ltd

MBA Size Listings are a guide to sizes only and must not be solely relied on for critical design information.

## Couplings - Bellows - Integral Clamp - Polished Stainless

Part Number	Bellows OD (D1) mm <i>inches</i>	Bores (d1 / d2) mm <i>inches</i>	Overall Length (L) mm <i>inches</i>	Max. Torque N.m	Max. Speed RPM	Hub Diameter (D) mm <i>inches</i>	Angular Offset Deg.	Lateral Offset mm <i>inches</i>
# CPB2040-0600-0600-3C	20.1 <i>0.791</i>	6.000 / 6.000	39.7 <i>1.563</i>	0.49		21.80 mm	7.0	0.51 <i>0.020</i>
# CPB2048-0600-0600-3C	20.1 <i>0.791</i>	6.000 / 6.000	47.6 <i>1.874</i>	0.35		21.80 mm	10.0	0.76 <i>0.030</i>
# CPB2032-0635-0635-3C	20.1 <i>0.791</i>	6.350 / 6.350	31.8 <i>1.252</i>	0.56		4-40 Cap Screw / 21.84 mm	5.0	0.25 <i>0.010</i>
# CPB2040-0635-0635-3C	20.1 <i>0.791</i>	6.350 / 6.350	39.7 <i>1.563</i>	0.49		4-40 Cap Screw / 21.84 mm	7.0	0.51 <i>0.020</i>
# CPB2048-0635-0635-3C	20.1 <i>0.791</i>	6.350 / 6.350	47.6 <i>1.874</i>	0.35		4-40 Cap Screw / 21.84 mm	10.0	0.76 <i>0.030</i>
# CPB2032-0794-0794-3C	20.1 <i>0.791</i>	7.938 / 7.938	31.8 <i>1.252</i>	0.56		4-40 Cap Screw / 21.84 mm	5.0	0.25 <i>0.010</i>
# CPB2040-0794-0794-3C	20.1 <i>0.791</i>	7.938 / 7.938	39.7 <i>1.563</i>	0.49		4-40 Cap Screw / 21.84 mm	7.0	0.51 <i>0.020</i>
# CPB2048-0794-0794-3C	20.1 <i>0.791</i>	7.938 / 7.938	47.6 <i>1.874</i>	0.35		4-40 Cap Screw / 21.84 mm	10.0	0.76 <i>0.030</i>
# CPB2032-0800-0800-3C	20.1 <i>0.791</i>	8.000 / 8.000	31.8 <i>1.252</i>	0.57		21.80 mm	5.0	0.25 <i>0.010</i>

# Indicates item not stocked at time of printing - Please enquire for lead time

E&OE Pricing and all details subject to change without notice - Copyright Miniature Bearings Australia Pty Ltd

MBA Size Listings are a guide to sizes only and must not be solely relied on for critical design information.

## Couplings - Bellows - Integral Clamp - Polished Stainless

Part Number	Bellows OD (D1) mm <i>inches</i>	Bores (d1 / d2) mm <i>inches</i>	Overall Length (L) mm <i>inches</i>	Max. Torque N.m	Max. Speed RPM	Hub Diameter (D) mm <i>inches</i>	Angular Offset Deg.	Lateral Offset mm <i>inches</i>
# CPB2040-0800-0800-3C	20.1 <i>0.791</i>	8.000 / 8.000	39.7 <i>1.563</i>	0.49		21.80 mm	7.0	0.51 <i>0.020</i>
# CPB2048-0800-0800-3C	20.1 <i>0.791</i>	8.000 / 8.000	47.6 <i>1.874</i>	0.35		21.80 mm	10.0	0.76 <i>0.030</i>

# Indicates item not stocked at time of printing - Please enquire for lead time

E&OE Pricing and all details subject to change without notice - Copyright Miniature Bearings Australia Pty Ltd

MBA Size Listings are a guide to sizes only and must not be solely relied on for critical design information.

# MBA

# MINIATURE BEARINGS AUSTRALIA PTY LTD

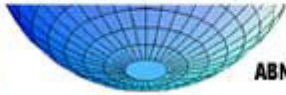

ABN 94 069 113 800



DISTRIBUTED BY

Ask us to put your name and address here

<http://www.minibearings.com.au/product>

Ph +61 7 3245 7977

Fax +61 7 3245 1017

Catalogue requests to [catalogues@minibearings.com.au](mailto:catalogues@minibearings.com.au)

**SDPSI**  
Stock Drive Products / Spring Instrument

**JK**

ANOTHER QUALITY PRODUCT BY  
**MOLYTEC**  
Australia

**Origin**  
BEARING

**WIB**

**THOMSON**

**EZO**



**myonic**  
solutions in microspace

**rino**



**inox**  
Quality Products

**GRW**

**DualVee<sup>x</sup>**  
Bishop-Wisecarver Corp.

**ondrives**  
Precision Manufacturing

**RMB**

**SOLARBOTICS<sup>INTL</sup>**

**KSK**  
BALL BEARING