

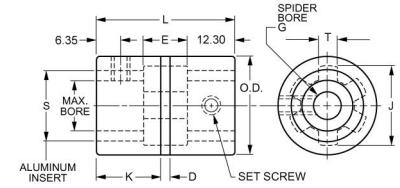

# MBA

## Couplings - Jaw Type - With Acetal Spider



Max 1800 RPM. 0.5 to 2.96 Nm.

Angular Offset = 0.1 Deg. Max.

Parallel Offset = 0.381mm Max.

Fibreglass Hubs - Acetal Spider.

### Couplings - Jaw Type - With Acetal Spider

Part Number	OD (D) mm	Bore (B) mm	Overall Length (L) mm	Bore Insert	Max. Torque N.m	Spider Width (E) mm	Hub Width (K) mm	Centre Gap (D) mm	Insert OD (S) mm
	<i>inches</i>	<i>inches</i>	<i>inches</i>			<i>inches</i>	<i>inches</i>	<i>inches</i>	<i>inches</i>
# CAS19x06.35-PL	19.1 <i>0.752</i>	6.350 <i>0.250</i>	32.544 <i>1.281</i>	None	0.497	7.9 <i>0.311</i>	15.5 <i>0.610</i>	1.6 <i>0.063</i>	N/A
# CAS19x06.35-IN	19.1 <i>0.752</i>	6.350 <i>0.250</i>	32.544 <i>1.281</i>	Aluminium	0.655	7.9 <i>0.311</i>	15.5 <i>0.610</i>	1.6 <i>0.063</i>	12.7 <i>0.500</i>
# CAS19x07.92-PL	19.1 <i>0.752</i>	7.925 <i>0.312</i>	32.544 <i>1.281</i>	None	0.497	7.9 <i>0.311</i>	15.5 <i>0.610</i>	1.6 <i>0.063</i>	N/A
# CAS19x07.92-IN	19.1 <i>0.752</i>	7.925 <i>0.312</i>	32.544 <i>1.281</i>	Aluminium	0.655	7.9 <i>0.311</i>	15.5 <i>0.610</i>	1.6 <i>0.063</i>	12.7 <i>0.500</i>

# Indicates item not stocked at time of printing - Please enquire for lead time

E&OE Pricing and all details subject to change without notice - Copyright Miniature Bearings Australia Pty Ltd

MBA Size Listings are a guide to sizes only and must not be solely relied on for critical design information.

## Couplings - Jaw Type - With Acetal Spider

Part Number	OD (D) mm	Bore (B) mm	Overall Length (L) mm	Bore Insert	Max. Torque N.m	Spider Width (E) mm	Hub Width (K) mm	Centre Gap (D) mm	Insert OD (S) mm
	<i>inches</i>	<i>inches</i>	<i>inches</i>			<i>inches</i>	<i>inches</i>	<i>inches</i>	<i>inches</i>
# CAS25x06.35-PL	25.4 <i>1.000</i>	6.350 <i>0.250</i>	34.925 <i>1.375</i>	None	0.983	10.3 <i>0.406</i>	15.48 <i>0.609</i>	2.4 <i>0.094</i>	N/A
# CAS25x06.35-IN	25.4 <i>1.000</i>	6.350 <i>0.250</i>	34.925 <i>1.375</i>	Aluminium	1.977	10.3 <i>0.406</i>	15.48 <i>0.609</i>	2.4 <i>0.094</i>	19.0 <i>0.748</i>
# CAS25x07.92-PL	25.4 <i>1.000</i>	7.925 <i>0.312</i>	34.925 <i>1.375</i>	None	0.983	10.3 <i>0.406</i>	15.48 <i>0.609</i>	2.4 <i>0.094</i>	N/A
# CAS25x07.92-IN	25.4 <i>1.000</i>	7.925 <i>0.312</i>	34.925 <i>1.375</i>	Aluminium	1.977	10.3 <i>0.406</i>	15.48 <i>0.609</i>	2.4 <i>0.094</i>	19.0 <i>0.748</i>
# CAS25x09.53-PL	25.4 <i>1.000</i>	9.525 <i>0.375</i>	34.925 <i>1.375</i>	None	0.983	10.3 <i>0.406</i>	15.48 <i>0.609</i>	2.4 <i>0.094</i>	N/A
# CAS25x09.53-IN	25.4 <i>1.000</i>	9.525 <i>0.375</i>	34.925 <i>1.375</i>	Aluminium	1.977	10.3 <i>0.406</i>	15.48 <i>0.609</i>	2.4 <i>0.094</i>	19.0 <i>0.748</i>
# CAS25x12.70-PL	25.4 <i>1.000</i>	12.700 <i>0.500</i>	34.925 <i>1.375</i>	None	0.983	10.3 <i>0.406</i>	15.48 <i>0.609</i>	2.4 <i>0.094</i>	N/A
# CAS25x12.70-IN	25.4 <i>1.000</i>	12.700 <i>0.500</i>	34.925 <i>1.375</i>	Aluminium	1.977	10.3 <i>0.406</i>	15.48 <i>0.609</i>	2.4 <i>0.094</i>	19.0 <i>0.748</i>
# CAS33x07.92-IN	33.4 <i>1.315</i>	7.925 <i>0.312</i>	38.100 <i>1.500</i>	Aluminium	2.960	13.5 <i>0.531</i>	17.46 <i>0.687</i>	3.18 <i>0.125</i>	27.0 <i>1.063</i>
# CAS33x09.53-IN	33.4 <i>1.315</i>	9.525 <i>0.375</i>	38.100 <i>1.500</i>	Aluminium	2.960	13.5 <i>0.531</i>	17.46 <i>0.687</i>	3.18 <i>0.125</i>	27.0 <i>1.063</i>

# Indicates item not stocked at time of printing - Please enquire for lead time

E&OE Pricing and all details subject to change without notice - Copyright Miniature Bearings Australia Pty Ltd

MBA Size Listings are a guide to sizes only and must not be solely relied on for critical design information.

## Couplings - Jaw Type - With Acetal Spider

Part Number	OD (D) mm	Bore (B) mm	Overall Length (L) mm	Bore Insert	Max. Torque N.m	Spider Width (E) mm	Hub Width (K) mm	Centre Gap (D) mm	Insert OD (S) mm
	<i>inches</i>	<i>inches</i>	<i>inches</i>			<i>inches</i>	<i>inches</i>	<i>inches</i>	<i>inches</i>
# CAS33x12.70-IN	33.4 <i>1.315</i>	12.700 <i>0.500</i>	38.100 <i>1.500</i>	Aluminium	2.960	13.5 <i>0.531</i>	17.46 <i>0.687</i>	3.18 <i>0.125</i>	27.0 <i>1.063</i>

# Indicates item not stocked at time of printing - Please enquire for lead time

E&OE Pricing and all details subject to change without notice - Copyright Miniature Bearings Australia Pty Ltd

MBA Size Listings are a guide to sizes only and must not be solely relied on for critical design information.



DISTRIBUTED BY

Ask us to put your name and address here

<http://www.minibearings.com.au/product>

Ph +61 7 3245 7977

Fax +61 7 3245 1017

Catalogue requests to [catalogues@minibearings.com.au](mailto:catalogues@minibearings.com.au)

