

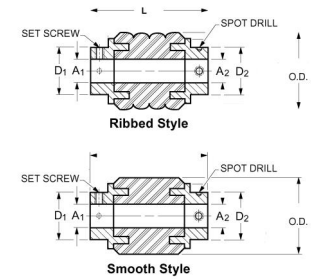

MBA

Couplings - Neo-Flex



0.71 to 1.27 Nm.

303 stainless steel with 73 durometer neoprene centre.

Shaft to shaft insulation.

Torsional vibration isolation.

Ribbed style are more flexible than smooth style.

Bore Tolerances: +0.025 / -0.000.

Couplings - Neo-Flex

Part Number	Bores (A1 / A2) mm	OD mm	Overall Length (L) mm	Max. Torque n.m	Max. Speed RPM	Hub Config. / Hub Diameter(s) mm	Body Type	Angle Misalignment Deg	Max. Parallel Offset mm
	<i>inches</i>	<i>inches</i>	<i>inches</i>			<i>inches</i>			<i>inches</i>
# CPNF-0300-0300-32S3S	3.000 / 3.000	20.6 <i>0.811</i>	31.8 <i>1.252</i>	0.71	Not Listed	Pin Hub / 7.900	Smooth	1	0.130 <i>0.005</i>
# CPNF-0300-0600-32R3S	3.000 / 6.000	20.6 <i>0.811</i>	31.8 <i>1.252</i>	0.71	Not Listed	Pin Hub / 7.900 / 12.700	Ribbed	5	0.250 <i>0.010</i>
# CPNF-0300-0600-32S3S	3.000 / 6.000	20.6 <i>0.811</i>	31.8 <i>1.252</i>	0.71	Not Listed	Pin Hub / 7.900 / 12.700	Smooth	1	0.130 <i>0.005</i>

Indicates item not stocked at time of printing - Please enquire for lead time

E&OE Pricing and all details subject to change without notice - Copyright Miniature Bearings Australia Pty Ltd

MBA Size Listings are a guide to sizes only and must not be solely relied on for critical design information.

Couplings - Neo-Flex

Part Number	Bores (A1 / A2) mm	OD mm	Overall Length (L) mm	Max. Torque n.m	Max. Speed RPM	Hub Config. / Hub Diameter(s) mm	Body Type	Angle Misalignment Deg	Max. Parallel Offset mm
	<i>inches</i>	<i>inches</i>	<i>inches</i>			<i>inches</i>			<i>inches</i>
# CPNF-0300-0400-32S3S	3.000 / 4.000	20.6	31.8	0.71	Not Listed	Pin Hub / 7.900 / 9.500	Smooth	1	0.130
		<i>0.811</i>	<i>1.252</i>						<i>0.005</i>
# CPNF-0300-0300-32R3S	3.000 / 3.000	20.6	31.8	0.71	Not Listed	Pin Hub / 7.900	Ribbed	5	0.250
		<i>0.811</i>	<i>1.252</i>						<i>0.010</i>
CPNF-0300-0400-32R3S	3.000 / 4.000	20.6	31.8	0.71	Not Listed	Pin Hub / 7.900 / 9.500	Ribbed	5	0.250
		<i>0.811</i>	<i>1.252</i>						<i>0.010</i>
# CPNF-0300-0400-33R3C	3.000 / 4.000	20.6	33.1	0.71	Not Listed	Fairloc / 11.000 / 12.500	Ribbed	5	0.250
		<i>0.811</i>	<i>1.303</i>						<i>0.010</i>
# CPNF-0300-0400-33S3C	3.000 / 4.000	20.6	33.1	0.71	Not Listed	Fairloc / 11.000 / 12.500	Smooth	1	0.130
		<i>0.811</i>	<i>1.303</i>						<i>0.005</i>
# CPNF-0300-0300-33R3C	3.000 / 3.000	20.6	33.1	0.71	Not Listed	Fairloc / 11.000	Ribbed	5	0.250
		<i>0.811</i>	<i>1.303</i>						<i>0.010</i>
# CPNF-0300-0300-33S3C	3.000 / 3.000	20.6	33.1	0.71	Not Listed	Fairloc / 11.000	Smooth	1	0.130
		<i>0.811</i>	<i>1.303</i>						<i>0.005</i>
# CPNF-0300-0500-35R3C	3.000 / 5.000	20.6	34.6	0.71	Not Listed	Fairloc / 11.000 / 16.000	Ribbed	5	0.250
		<i>0.811</i>	<i>1.362</i>						<i>0.010</i>
# CPNF-0300-0600-35S3C	3.000 / 6.000	20.6	34.6	0.71	Not Listed	Fairloc / 12.500	Smooth	1	0.130
		<i>0.811</i>	<i>1.362</i>						<i>0.005</i>

Indicates item not stocked at time of printing - Please enquire for lead time

E&OE Pricing and all details subject to change without notice - Copyright Miniature Bearings Australia Pty Ltd

MBA Size Listings are a guide to sizes only and must not be solely relied on for critical design information.

Couplings - Neo-Flex

Part Number	Bores (A1 / A2) mm	OD mm	Overall Length (L) mm	Max. Torque n.m	Max. Speed RPM	Hub Config. / Hub Diameter(s) mm	Body Type	Angle Misalignment Deg	Max. Parallel Offset mm
	<i>inches</i>	<i>inches</i>	<i>inches</i>			<i>inches</i>			<i>inches</i>
# CPNF-0300-0600-35R3C	3.000 / 6.000	20.6 <i>0.811</i>	34.6 <i>1.362</i>	0.71	Not Listed	Fairloc / 12.500	Ribbed	5	0.250 <i>0.010</i>
# CPNF-0300-0500-35S3C	3.000 / 5.000	20.6 <i>0.811</i>	34.6 <i>1.362</i>	0.71	Not Listed	Fairloc / 11.000 / 16.000	Smooth	1	0.130 <i>0.005</i>
# CPNF-0300-0400-64S3S	3.000 / 4.000	20.6 <i>0.811</i>	63.5 <i>2.500</i>	0.71	Not Listed	Pin Hub / 7.900 / 9.500	Smooth	8	0.250 <i>0.010</i>
# CPNF-0300-0300-64R3S	3.000 / 3.000	20.6 <i>0.811</i>	63.5 <i>2.500</i>	0.71	Not Listed	Pin Hub / 7.900	Ribbed	15	0.380 <i>0.015</i>
# CPNF-0300-0400-64R3S	3.000 / 4.000	20.6 <i>0.811</i>	63.5 <i>2.500</i>	0.71	Not Listed	Pin Hub / 7.900 / 9.500	Ribbed	15	0.380 <i>0.015</i>
# CPNF-0300-0300-64S3S	3.000 / 3.000	20.6 <i>0.811</i>	63.5 <i>2.500</i>	0.71	Not Listed	Pin Hub / 7.900	Smooth	8	0.250 <i>0.010</i>
# CPNF-0300-0600-64R3S	3.000 / 6.000	20.6 <i>0.811</i>	63.5 <i>2.500</i>	0.71	Not Listed	Pin Hub / 7.900 / 12.700	Ribbed	15	0.380 <i>0.015</i>
# CPNF-0300-0600-64S3S	3.000 / 6.000	20.6 <i>0.811</i>	63.5 <i>2.500</i>	0.71	Not Listed	Pin Hub / 7.900 / 12.700	Smooth	8	0.250 <i>0.010</i>
# CPNF-0300-0300-65R3C	3.000 / 3.000	20.6 <i>0.811</i>	64.8 <i>2.551</i>	0.71	Not Listed	Fairloc / 11.000	Ribbed	5	0.380 <i>0.015</i>

Indicates item not stocked at time of printing - Please enquire for lead time

E&OE Pricing and all details subject to change without notice - Copyright Miniature Bearings Australia Pty Ltd

MBA Size Listings are a guide to sizes only and must not be solely relied on for critical design information.

Couplings - Neo-Flex

Part Number	Bores (A1 / A2) mm	OD mm	Overall Length (L) mm	Max. Torque n.m	Max. Speed RPM	Hub Config. / Hub Diameter(s) mm	Body Type	Angle Misalignment Deg	Max. Parallel Offset mm
	<i>inches</i>	<i>inches</i>	<i>inches</i>			<i>inches</i>			<i>inches</i>
# CPNF-0300-0400-65R3C	3.000 / 4.000	20.6	64.8	0.71	Not Listed	Fairloc / 11.000 / 12.500	Ribbed	5	0.380
		<i>0.811</i>	<i>2.551</i>						<i>0.015</i>
# CPNF-0300-0300-65S3C	3.000 / 3.000	20.6	64.8	0.71	Not Listed	Fairloc / 11.000	Smooth	1	0.250
		<i>0.811</i>	<i>2.551</i>						<i>0.010</i>
# CPNF-0300-0400-65S3C	3.000 / 4.000	20.6	64.8	0.71	Not Listed	Fairloc / 11.000 / 12.500	Smooth	1	0.250
		<i>0.811</i>	<i>2.551</i>						<i>0.010</i>
# CPNF-0300-0500-66R3C	3.000 / 5.000	20.6	66.3	0.71	Not Listed	Fairloc / 11.000 / 16.000	Ribbed	5	0.380
		<i>0.811</i>	<i>2.610</i>						<i>0.015</i>
# CPNF-0300-0500-66S3C	3.000 / 5.000	20.6	66.3	0.71	Not Listed	Fairloc / 11.000 / 16.000	Smooth	1	0.250
		<i>0.811</i>	<i>2.610</i>						<i>0.010</i>
# CPNF-0300-0600-66R3C	3.000 / 6.000	20.6	66.3	0.71	Not Listed	Fairloc / 12.500	Ribbed	5	0.380
		<i>0.811</i>	<i>2.610</i>						<i>0.015</i>
# CPNF-0300-0600-66S3C	3.000 / 6.000	20.6	66.3	0.71	Not Listed	Fairloc / 12.500	Smooth	1	0.250
		<i>0.811</i>	<i>2.610</i>						<i>0.010</i>
# CPNF-0305-0317-32R3S	3.048 / 3.169	20.6	31.8	0.71	Not Listed	Pin Hub / 7.950	Ribbed	5	0.254
		<i>0.811</i>	<i>1.252</i>						<i>0.010</i>
# CPNF-0305-0305-32R3S	3.048 / 3.048	20.6	31.8	0.71	Not Listed	Pin Hub / 7.950	Ribbed	5	0.254
		<i>0.811</i>	<i>1.252</i>						<i>0.010</i>

Indicates item not stocked at time of printing - Please enquire for lead time

E&OE Pricing and all details subject to change without notice - Copyright Miniature Bearings Australia Pty Ltd

MBA Size Listings are a guide to sizes only and must not be solely relied on for critical design information.

Couplings - Neo-Flex

Part Number	Bores (A1 / A2) mm	OD mm	Overall Length (L) mm	Max. Torque n.m	Max. Speed RPM	Hub Config. / Hub Diameter(s) mm	Body Type	Angle Misalignment Deg	Max. Parallel Offset mm
	<i>inches</i>	<i>inches</i>	<i>inches</i>			<i>inches</i>			<i>inches</i>
# CPNF-0305-0305-32S3S	3.048 / 3.048	20.6 <i>0.811</i>	31.8 <i>1.252</i>	0.71	Not Listed	Pin Hub / 7.950	Smooth	1	0.127 <i>0.005</i>
# CPNF-0305-0317-32S3S	3.048 / 3.169	20.6 <i>0.811</i>	31.8 <i>1.252</i>	0.71	Not Listed	Pin Hub / 7.950	Smooth	1	0.127 <i>0.005</i>
# CPNF-0305-0318-32R3C	3.048 / 3.175	20.6 <i>0.811</i>	32.1 <i>1.264</i>	0.71	Not Listed	Fairloc / 11.176	Ribbed	5	0.254 <i>0.010</i>
# CPNF-0305-0305-32S3C	3.048 / 3.048	20.6 <i>0.811</i>	32.1 <i>1.264</i>	0.71	Not Listed	Fairloc / 11.176	Smooth	1	0.127 <i>0.005</i>
# CPNF-0305-0318-32S3C	3.048 / 3.175	20.6 <i>0.811</i>	32.1 <i>1.264</i>	0.71	Not Listed	Fairloc / 11.176	Smooth	1	0.127 <i>0.005</i>
# CPNF-0305-0305-32R3C	3.048 / 3.048	20.6 <i>0.811</i>	32.1 <i>1.264</i>	0.71	Not Listed	Fairloc / 11.176	Ribbed	5	0.254 <i>0.010</i>
# CPNF-0305-0317-64S3S	3.048 / 3.169	20.6 <i>0.811</i>	63.5 <i>2.500</i>	0.71	Not Listed	Pin Hub / 7.950	Smooth	8	0.254 <i>0.010</i>
# CPNF-0305-0305-64S3S	3.048 / 3.048	20.6 <i>0.811</i>	63.5 <i>2.500</i>	0.71	Not Listed	Pin Hub / 7.950	Smooth	8	0.254 <i>0.010</i>
# CPNF-0305-0305-64R3S	3.048 / 3.048	20.6 <i>0.811</i>	63.5 <i>2.500</i>	0.71	Not Listed	Pin Hub / 7.950	Ribbed	15	0.381 <i>0.015</i>
# CPNF-0305-0317-64R3S	3.048 / 3.169	20.6 <i>0.811</i>	63.5 <i>2.500</i>	0.71	Not Listed	Pin Hub / 7.950 / 7.976	Ribbed	15	0.381 <i>0.015</i>

Indicates item not stocked at time of printing - Please enquire for lead time

E&OE Pricing and all details subject to change without notice - Copyright Miniature Bearings Australia Pty Ltd

MBA Size Listings are a guide to sizes only and must not be solely relied on for critical design information.

Couplings - Neo-Flex

Part Number	Bores (A1 / A2) mm	OD mm	Overall Length (L) mm	Max. Torque n.m	Max. Speed RPM	Hub Config. / Hub Diameter(s) mm	Body Type	Angle Misalignment Deg	Max. Parallel Offset mm
	<i>inches</i>	<i>inches</i>	<i>inches</i>			<i>inches</i>			<i>inches</i>
# CPNF-0305-0318-64S3C	3.048 / 3.175	20.6 <i>0.811</i>	63.9 <i>2.516</i>	0.71	Not Listed	Fairloc / 11.176	Smooth	8	0.254 <i>0.010</i>
# CPNF-0305-0318-64R3C	3.048 / 3.175	20.6 <i>0.811</i>	63.9 <i>2.516</i>	0.71	Not Listed	Fairloc / 11.176	Ribbed	15	0.381 <i>0.015</i>
# CPNF-0305-0305-64S3C	3.048 / 3.048	20.6 <i>0.811</i>	63.9 <i>2.516</i>	0.71	Not Listed	Fairloc / 11.176	Smooth	8	0.254 <i>0.010</i>
# CPNF-0305-0305-64R3C	3.048 / 3.048	20.6 <i>0.811</i>	63.9 <i>2.516</i>	0.71	Not Listed	Fairloc / 11.176	Ribbed	15	0.381 <i>0.015</i>
# CPNF-0317-0476-32S3S	3.169 / 4.757	20.6 <i>0.811</i>	31.8 <i>1.252</i>	0.84	Not Listed	Pin Hub / 7.950 / 9.525	Smooth	1	0.127 <i>0.005</i>
# CPNF-0317-0317-32R3S	3.169 / 3.169	20.6 <i>0.811</i>	31.8 <i>1.252</i>	0.84	Not Listed	Pin Hub / 7.950	Ribbed	5	0.254 <i>0.010</i>
# CPNF-0317-0476-32R3S	3.169 / 4.757	20.6 <i>0.811</i>	31.8 <i>1.252</i>	0.84	Not Listed	Pin Hub / 7.950 / 9.525	Ribbed	5	0.254 <i>0.010</i>
# CPNF-0317-0635-32S3S	3.169 / 6.345	20.6 <i>0.811</i>	31.8 <i>1.252</i>	0.84	Not Listed	Pin Hub / 7.950 / 12.700	Smooth	1	0.127 <i>0.005</i>
# CPNF-0317-0635-32R3S	3.169 / 6.345	20.6 <i>0.811</i>	31.8 <i>1.252</i>	0.84	Not Listed	Pin Hub / 7.950 / 12.700	Ribbed	5	0.254 <i>0.010</i>

Indicates item not stocked at time of printing - Please enquire for lead time

E&OE Pricing and all details subject to change without notice - Copyright Miniature Bearings Australia Pty Ltd

MBA Size Listings are a guide to sizes only and must not be solely relied on for critical design information.

Couplings - Neo-Flex

Part Number	Bores (A1 / A2) mm	OD mm	Overall Length (L) mm	Max. Torque n.m	Max. Speed RPM	Hub Config. / Hub Diameter(s) mm	Body Type	Angle Misalignment Deg	Max. Parallel Offset mm
	<i>inches</i>	<i>inches</i>	<i>inches</i>			<i>inches</i>			<i>inches</i>
# CPNF-0317-0317-32S3S	3.169 / 3.169	20.6 <i>0.811</i>	31.8 <i>1.252</i>	0.84	Not Listed	Pin Hub / 7.950	Smooth	1	0.127 <i>0.005</i>
# CPNF-0317-0635-64S3S	3.169 / 6.345	20.6 <i>0.811</i>	63.5 <i>2.500</i>	0.84	Not Listed	Pin Hub / 7.950 / 12.700	Smooth	8	0.254 <i>0.010</i>
# CPNF-0317-0476-64R3S	3.169 / 4.757	20.6 <i>0.811</i>	63.5 <i>2.500</i>	0.84	Not Listed	Pin Hub / 7.950 / 9.525	Ribbed	15	0.381 <i>0.015</i>
# CPNF-0317-0635-64R3S	3.169 / 6.345	20.6 <i>0.811</i>	63.5 <i>2.500</i>	0.84	Not Listed	Pin Hub / 7.950 / 12.700	Ribbed	15	0.381 <i>0.015</i>
# CPNF-0317-0317-64R3S	3.169 / 3.169	20.6 <i>0.811</i>	63.5 <i>2.500</i>	0.84	Not Listed	Pin Hub / 7.950 / 8.001	Ribbed	15	0.381 <i>0.015</i>
# CPNF-0317-0476-64S3S	3.169 / 4.757	20.6 <i>0.811</i>	63.5 <i>2.500</i>	0.84	Not Listed	Pin Hub / 7.950 / 9.525	Smooth	8	0.254 <i>0.010</i>
# CPNF-0317-0317-64S3S	3.169 / 3.169	20.6 <i>0.811</i>	63.5 <i>2.500</i>	0.84	Not Listed	Pin Hub / 7.950	Smooth	8	0.254 <i>0.010</i>
# CPNF-0318-0318-32S3C	3.175 / 3.175	20.6 <i>0.811</i>	32.1 <i>1.264</i>	0.84	Not Listed	Fairloc / 11.176	Smooth	1	0.127 <i>0.005</i>
# CPNF-0318-0476-32S3C	3.175 / 4.762	20.6 <i>0.811</i>	32.1 <i>1.264</i>	0.84	Not Listed	Fairloc / 11.176 / 12.573	Smooth	1	0.127 <i>0.005</i>

Indicates item not stocked at time of printing - Please enquire for lead time

E&OE Pricing and all details subject to change without notice - Copyright Miniature Bearings Australia Pty Ltd

MBA Size Listings are a guide to sizes only and must not be solely relied on for critical design information.

Couplings - Neo-Flex

Part Number	Bores (A1 / A2) mm	OD mm	Overall Length (L) mm	Max. Torque n.m	Max. Speed RPM	Hub Config. / Hub Diameter(s) mm	Body Type	Angle Misalignment Deg	Max. Parallel Offset mm
	<i>inches</i>	<i>inches</i>	<i>inches</i>			<i>inches</i>			<i>inches</i>
# CPNF-0318-0318-32R3C	3.175 / 3.175	20.6 <i>0.811</i>	32.1 <i>1.264</i>	0.84	Not Listed	Fairloc / 11.176	Ribbed	5	0.254 <i>0.010</i>
# CPNF-0318-0476-32R3C	3.175 / 4.762	20.6 <i>0.811</i>	32.1 <i>1.264</i>	0.84	Not Listed	Fairloc / 11.176 / 12.573	Ribbed	5	0.254 <i>0.010</i>
# CPNF-0318-0635-34S3C	3.175 / 6.350	20.6 <i>0.811</i>	33.9 <i>1.335</i>	0.84	Not Listed	Fairloc / 11.176 / 15.494	Smooth	1	0.127 <i>0.005</i>
# CPNF-0318-0635-34R3C	3.175 / 6.350	20.6 <i>0.811</i>	33.9 <i>1.335</i>	0.84	Not Listed	Fairloc / 11.176 / 15.494	Ribbed	5	0.254 <i>0.010</i>
# CPNF-0318-0318-64S3C	3.175 / 3.175	20.6 <i>0.811</i>	63.9 <i>2.516</i>	0.84	Not Listed	Fairloc / 11.176	Smooth	8	0.254 <i>0.010</i>
# CPNF-0318-0476-64S3C	3.175 / 4.762	20.6 <i>0.811</i>	63.9 <i>2.516</i>	0.84	Not Listed	Fairloc / 11.176 / 12.573	Smooth	8	0.254 <i>0.010</i>
# CPNF-0318-0476-64R3C	3.175 / 4.762	20.6 <i>0.811</i>	63.9 <i>2.516</i>	0.84	Not Listed	Fairloc / 11.176 / 12.573	Ribbed	15	0.381 <i>0.015</i>
# CPNF-0318-0635-66R3C	3.175 / 6.350	20.6 <i>0.811</i>	65.6 <i>2.583</i>	0.84	Not Listed	Fairloc / 11.176 / 15.494	Ribbed	15	0.381 <i>0.015</i>
# CPNF-0318-0635-66S3C	3.175 / 6.350	20.6 <i>0.811</i>	65.6 <i>2.583</i>	0.84	Not Listed	Fairloc / 11.176 / 15.494	Smooth	8	0.254 <i>0.010</i>

Indicates item not stocked at time of printing - Please enquire for lead time

E&OE Pricing and all details subject to change without notice - Copyright Miniature Bearings Australia Pty Ltd

MBA Size Listings are a guide to sizes only and must not be solely relied on for critical design information.

Couplings - Neo-Flex

Part Number	Bores (A1 / A2) mm	OD mm	Overall Length (L) mm	Max. Torque n.m	Max. Speed RPM	Hub Config. / Hub Diameter(s) mm	Body Type	Angle Misalignment Deg	Max. Parallel Offset mm
	<i>inches</i>	<i>inches</i>	<i>inches</i>			<i>inches</i>			<i>inches</i>
# CPNF-0400-0400-32S3S	4.000 / 4.000	20.6 <i>0.811</i>	31.8 <i>1.252</i>	0.84	Not Listed	Pin Hub / 9.500	Smooth	1	0.130 <i>0.005</i>
CPNF-0400-0600-32S3S	4.000 / 6.000	20.6 <i>0.811</i>	31.8 <i>1.252</i>	0.84	Not Listed	Pin Hub / 9.500 / 12.700	Smooth	1	0.130 <i>0.005</i>
# CPNF-0400-0400-32R3S	4.000 / 4.000	20.6 <i>0.811</i>	31.8 <i>1.252</i>	0.84	Not Listed	Pin Hub / 9.500	Ribbed	5	0.250 <i>0.010</i>
# CPNF-0400-0600-32R3S	4.000 / 6.000	20.6 <i>0.811</i>	31.8 <i>1.252</i>	0.84	Not Listed	Pin Hub / 9.500 / 12.700	Ribbed	5	0.250 <i>0.010</i>
# CPNF-0400-0400-33S3C	4.000 / 4.000	20.6 <i>0.811</i>	33.1 <i>1.303</i>	0.84	Not Listed	Fairloc / 12.500 / 16.000	Smooth	1	0.130 <i>0.005</i>
# CPNF-0400-0400-33R3C	4.000 / 4.000	20.6 <i>0.811</i>	33.1 <i>1.303</i>	0.84	Not Listed	Fairloc / 12.500 / 16.000	Ribbed	5	0.250 <i>0.010</i>
# CPNF-0400-0500-35S3C	4.000 / 5.000	20.6 <i>0.811</i>	34.6 <i>1.362</i>	0.84	Not Listed	Fairloc / 12.500 / 16.000	Smooth	1	0.130 <i>0.005</i>
# CPNF-0400-0500-35R3C	4.000 / 5.000	20.6 <i>0.811</i>	34.6 <i>1.362</i>	0.84	Not Listed	Fairloc / 12.500 / 16.000	Ribbed	5	0.250 <i>0.010</i>
CPNF-0400-0600-35S3C	4.000 / 6.000	20.6 <i>0.811</i>	34.6 <i>1.362</i>	0.84	Not Listed	Fairloc / 16.000	Smooth	1	0.130 <i>0.005</i>

Indicates item not stocked at time of printing - Please enquire for lead time

E&OE Pricing and all details subject to change without notice - Copyright Miniature Bearings Australia Pty Ltd

MBA Size Listings are a guide to sizes only and must not be solely relied on for critical design information.

Couplings - Neo-Flex

Part Number	Bores (A1 / A2) mm	OD mm	Overall Length (L) mm	Max. Torque n.m	Max. Speed RPM	Hub Config. / Hub Diameter(s) mm	Body Type	Angle Misalignment Deg	Max. Parallel Offset mm
	<i>inches</i>	<i>inches</i>	<i>inches</i>			<i>inches</i>			<i>inches</i>
# CPNF-0400-0600-35R3C	4.000 / 6.000	20.6 <i>0.811</i>	34.6 <i>1.362</i>	0.84	Not Listed	Fairloc / 16.000	Ribbed	5	0.250 <i>0.010</i>
# CPNF-0400-0400-64S3S	4.000 / 4.000	20.6 <i>0.811</i>	63.5 <i>2.500</i>	0.84	Not Listed	Pin Hub / 9.500	Smooth	8	0.250 <i>0.010</i>
# CPNF-0400-0400-64R3S	4.000 / 4.000	20.6 <i>0.811</i>	63.5 <i>2.500</i>	0.84	Not Listed	Pin Hub / 9.500	Ribbed	15	0.380 <i>0.015</i>
# CPNF-0400-0600-64S3S	4.000 / 6.000	20.6 <i>0.811</i>	63.5 <i>2.500</i>	0.84	Not Listed	Pin Hub / 9.500 / 12.700	Smooth	8	0.250 <i>0.010</i>
# CPNF-0400-0600-64R3S	4.000 / 6.000	20.6 <i>0.811</i>	63.5 <i>2.500</i>	0.84	Not Listed	Pin Hub / 9.500 / 12.700	Ribbed	15	0.380 <i>0.015</i>
# CPNF-0400-0400-65S3C	4.000 / 4.000	20.6 <i>0.811</i>	64.8 <i>2.551</i>	0.84	Not Listed	Fairloc / 12.500 / 16.000	Smooth	1	0.250 <i>0.010</i>
# CPNF-0400-0400-65R3C	4.000 / 4.000	20.6 <i>0.811</i>	64.8 <i>2.551</i>	0.84	Not Listed	Fairloc / 12.500 / 16.000	Ribbed	5	0.380 <i>0.015</i>
# CPNF-0400-0500-66R3C	4.000 / 5.000	20.6 <i>0.811</i>	66.3 <i>2.610</i>	0.84	Not Listed	Fairloc / 12.500 / 16.000	Ribbed	5	0.380 <i>0.015</i>
# CPNF-0400-0600-66R3C	4.000 / 6.000	20.6 <i>0.811</i>	66.3 <i>2.610</i>	0.84	Not Listed	Fairloc / 16.000	Ribbed	5	0.380 <i>0.015</i>

Indicates item not stocked at time of printing - Please enquire for lead time

E&OE Pricing and all details subject to change without notice - Copyright Miniature Bearings Australia Pty Ltd

MBA Size Listings are a guide to sizes only and must not be solely relied on for critical design information.

Couplings - Neo-Flex

Part Number	Bores (A1 / A2) mm	OD mm	Overall Length (L) mm	Max. Torque n.m	Max. Speed RPM	Hub Config. / Hub Diameter(s) mm	Body Type	Angle Misalignment Deg	Max. Parallel Offset mm
	<i>inches</i>	<i>inches</i>	<i>inches</i>			<i>inches</i>			<i>inches</i>
# CPNF-0400-0500-66S3C	4.000 / 5.000	20.6	66.3	0.84	Not Listed	Fairloc / 12.500 / 16.000	Smooth	1	0.250
		<i>0.811</i>	<i>2.610</i>						<i>0.010</i>
# CPNF-0400-0600-66S3C	4.000 / 6.000	20.6	66.3	0.84	Not Listed	Fairloc / 16.000	Smooth	1	0.250
		<i>0.811</i>	<i>2.610</i>						<i>0.010</i>
# CPNF-0476-0476-32R3S	4.757 / 4.757	20.6	31.8	1.05	Not Listed	Pin Hub / 9.525	Ribbed	5	0.254
		<i>0.811</i>	<i>1.252</i>						<i>0.010</i>
# CPNF-0476-0635-32R3S	4.757 / 6.345	20.6	31.8	1.05	Not Listed	Pin Hub / 9.525 / 12.700	Ribbed	5	0.254
		<i>0.811</i>	<i>1.252</i>						<i>0.010</i>
# CPNF-0476-0476-32S3S	4.757 / 4.757	20.6	31.8	1.05	Not Listed	Pin Hub / 9.525	Smooth	1	0.127
		<i>0.811</i>	<i>1.252</i>						<i>0.005</i>
# CPNF-0476-0635-32S3S	4.757 / 6.345	20.6	31.8	1.05	Not Listed	Pin Hub / 9.525 / 12.700	Smooth	1	0.127
		<i>0.811</i>	<i>1.252</i>						<i>0.005</i>
# CPNF-0476-0635-64R3S	4.757 / 6.345	20.6	63.5	1.05	Not Listed	Pin Hub / 9.525 / 12.700	Ribbed	15	0.381
		<i>0.811</i>	<i>2.500</i>						<i>0.015</i>
# CPNF-0476-0635-64S3S	4.757 / 6.345	20.6	63.5	1.05	Not Listed	Pin Hub / 9.525 / 12.700	Smooth	8	0.254
		<i>0.811</i>	<i>2.500</i>						<i>0.010</i>
# CPNF-0476-0476-64R3S	4.757 / 4.757	20.6	63.5	1.05	Not Listed	Pin Hub / 9.525	Ribbed	15	0.381
		<i>0.811</i>	<i>2.500</i>						<i>0.015</i>

Indicates item not stocked at time of printing - Please enquire for lead time

E&OE Pricing and all details subject to change without notice - Copyright Miniature Bearings Australia Pty Ltd

MBA Size Listings are a guide to sizes only and must not be solely relied on for critical design information.

Couplings - Neo-Flex

Part Number	Bores (A1 / A2) mm	OD mm	Overall Length (L) mm	Max. Torque n.m	Max. Speed RPM	Hub Config. / Hub Diameter(s) mm	Body Type	Angle Misalignment Deg	Max. Parallel Offset mm
	<i>inches</i>	<i>inches</i>	<i>inches</i>			<i>inches</i>			<i>inches</i>
# CPNF-0476-0476-64S3S	4.757 / 4.757	20.6 <i>0.811</i>	63.5 <i>2.500</i>	1.05	Not Listed	Pin Hub / 9.525	Smooth	8	0.254 <i>0.010</i>
# CPNF-0476-0476-32R3C	4.763 / 4.762	20.6 <i>0.811</i>	32.1 <i>1.264</i>	1.05	Not Listed	Fairloc / 12.573	Ribbed	5	0.254 <i>0.010</i>
# CPNF-0476-0476-32S3C	4.763 / 4.762	20.6 <i>0.811</i>	32.1 <i>1.264</i>	1.05	Not Listed	Fairloc / 12.573	Smooth	1	0.127 <i>0.005</i>
# CPNF-0476-0635-34R3C	4.763 / 6.350	20.6 <i>0.811</i>	33.9 <i>1.335</i>	1.05	Not Listed	Fairloc / 12.573 / 15.494	Ribbed	5	0.254 <i>0.010</i>
# CPNF-0476-0635-34S3C	4.763 / 6.350	20.6 <i>0.811</i>	33.9 <i>1.335</i>	1.05	Not Listed	Fairloc / 12.573 / 15.494	Smooth	1	0.127 <i>0.005</i>
# CPNF-0476-0476-64R3C	4.763 / 4.762	20.6 <i>0.811</i>	63.9 <i>2.516</i>	1.05	Not Listed	Fairloc / 12.573	Ribbed	15	0.381 <i>0.015</i>
# CPNF-0476-0476-64S3C	4.763 / 4.762	20.6 <i>0.811</i>	63.9 <i>2.516</i>	1.05	Not Listed	Fairloc / 12.573	Smooth	8	0.254 <i>0.010</i>
# CPNF-0476-0635-66R3C	4.763 / 6.350	20.6 <i>0.811</i>	65.6 <i>2.583</i>	1.05	Not Listed	Fairloc / 12.573 / 15.494	Ribbed	15	0.381 <i>0.015</i>
# CPNF-0476-0635-66S3C	4.763 / 6.350	20.6 <i>0.811</i>	65.6 <i>2.583</i>	1.05	Not Listed	Fairloc / 12.573 / 15.494	Smooth	8	0.254 <i>0.010</i>

Indicates item not stocked at time of printing - Please enquire for lead time

E&OE Pricing and all details subject to change without notice - Copyright Miniature Bearings Australia Pty Ltd

MBA Size Listings are a guide to sizes only and must not be solely relied on for critical design information.

Couplings - Neo-Flex

Part Number	Bores (A1 / A2) mm	OD mm	Overall Length (L) mm	Max. Torque n.m	Max. Speed RPM	Hub Config. / Hub Diameter(s) mm	Body Type	Angle Misalignment Deg	Max. Parallel Offset mm
	<i>inches</i>	<i>inches</i>	<i>inches</i>			<i>inches</i>			<i>inches</i>
# CPNF-0500-0500-36S3C	5.000 / 5.000	20.6 <i>0.811</i>	36.1 <i>1.421</i>	1.05	Not Listed	Fairloc / 16.000	Smooth	1	0.130 <i>0.005</i>
# CPNF-0500-0600-36R3C	5.000 / 6.000	20.6 <i>0.811</i>	36.1 <i>1.421</i>	1.05	Not Listed	Fairloc / 16.000	Ribbed	5	0.250 <i>0.010</i>
# CPNF-0500-0600-36S3C	5.000 / 6.000	20.6 <i>0.811</i>	36.1 <i>1.421</i>	1.05	Not Listed	Fairloc / 16.000	Smooth	1	0.130 <i>0.005</i>
# CPNF-0500-0500-36R3C	5.000 / 5.000	20.6 <i>0.811</i>	36.1 <i>1.421</i>	1.05	Not Listed	Fairloc / 16.000	Ribbed	5	0.250 <i>0.010</i>
# CPNF-0500-0500-68R3C	5.000 / 5.000	20.6 <i>0.811</i>	67.8 <i>2.669</i>	1.05	Not Listed	Fairloc / 16.000	Ribbed	5	0.380 <i>0.015</i>
# CPNF-0500-0500-68S3C	5.000 / 5.000	20.6 <i>0.811</i>	67.8 <i>2.669</i>	1.05	Not Listed	Fairloc / 16.000	Smooth	1	0.250 <i>0.010</i>
# CPNF-0500-0600-68S3C	5.000 / 6.000	20.6 <i>0.811</i>	67.8 <i>2.669</i>	1.05	Not Listed	Fairloc / 16.000	Smooth	1	0.250 <i>0.010</i>
# CPNF-0500-0600-68R3C	5.000 / 6.000	20.6 <i>0.811</i>	67.8 <i>2.669</i>	1.05	Not Listed	Fairloc / 16.000	Ribbed	5	0.380 <i>0.015</i>
# CPNF-0600-0600-32R3S	6.000 / 6.000	20.6 <i>0.811</i>	31.8 <i>1.252</i>	1.05	Not Listed	Pin Hub / 12.700 / 7.900	Ribbed	5	0.250 <i>0.010</i>
# CPNF-0600-0600-32S3S	6.000 / 6.000	20.6 <i>0.811</i>	31.8 <i>1.252</i>	1.05	Not Listed	Pin Hub / 12.700 / 7.900	Smooth	1	0.130 <i>0.005</i>

Indicates item not stocked at time of printing - Please enquire for lead time

E&OE Pricing and all details subject to change without notice - Copyright Miniature Bearings Australia Pty Ltd

MBA Size Listings are a guide to sizes only and must not be solely relied on for critical design information.

Couplings - Neo-Flex

Part Number	Bores (A1 / A2) mm	OD mm	Overall Length (L) mm	Max. Torque n.m	Max. Speed RPM	Hub Config. / Hub Diameter(s) mm	Body Type	Angle Misalignment Deg	Max. Parallel Offset mm
	<i>inches</i>	<i>inches</i>	<i>inches</i>			<i>inches</i>			<i>inches</i>
# CPNF-0600-0600-36S3C	6.000 / 6.000	20.6 <i>0.811</i>	36.1 <i>1.421</i>	1.27	Not Listed	Fairloc / 16.000	Smooth	1	0.130 <i>0.005</i>
# CPNF-0600-0600-36R3C	6.000 / 6.000	20.6 <i>0.811</i>	36.1 <i>1.421</i>	1.27	Not Listed	Fairloc / 16.000	Ribbed	5	0.250 <i>0.010</i>
# CPNF-0600-0600-64S3S	6.000 / 6.000	20.6 <i>0.811</i>	63.5 <i>2.500</i>	1.05	Not Listed	Pin Hub / 12.700	Smooth	8	0.250 <i>0.010</i>
# CPNF-0600-0600-64R3S	6.000 / 6.000	20.6 <i>0.811</i>	63.5 <i>2.500</i>	1.05	Not Listed	Pin Hub / 12.700	Ribbed	15	0.380 <i>0.015</i>
# CPNF-0600-0600-68R3C	6.000 / 6.000	20.6 <i>0.811</i>	67.8 <i>2.669</i>	1.27	Not Listed	Fairloc / 16.000	Ribbed	5	0.380 <i>0.015</i>
# CPNF-0600-0600-68S3C	6.000 / 6.000	20.6 <i>0.811</i>	67.8 <i>2.669</i>	1.27	Not Listed	Fairloc / 16.000	Smooth	1	0.250 <i>0.010</i>
CPNF-0635-0635-32R3S	6.345 / 6.345	20.6 <i>0.811</i>	31.8 <i>1.252</i>	1.27	Not Listed	Pin Hub / 12.700	Ribbed	5	0.254 <i>0.010</i>
# CPNF-0635-0635-32S3S	6.345 / 6.345	20.6 <i>0.811</i>	31.8 <i>1.252</i>	1.27	Not Listed	Pin Hub / 12.700	Smooth	1	0.127 <i>0.005</i>
# CPNF-0635-0635-64S3S	6.345 / 6.345	20.6 <i>0.811</i>	63.5 <i>2.500</i>	1.27	Not Listed	Pin Hub / 12.700	Smooth	8	0.254 <i>0.010</i>
# CPNF-0635-0635-64R3S	6.345 / 6.345	20.6 <i>0.811</i>	63.5 <i>2.500</i>	1.27	Not Listed	Pin Hub / 12.700	Ribbed	15	0.381 <i>0.015</i>

Indicates item not stocked at time of printing - Please enquire for lead time

E&OE Pricing and all details subject to change without notice - Copyright Miniature Bearings Australia Pty Ltd

MBA Size Listings are a guide to sizes only and must not be solely relied on for critical design information.

Couplings - Neo-Flex

Part Number	Bores (A1 / A2) mm	OD mm	Overall Length (L) mm	Max. Torque n.m	Max. Speed RPM	Hub Config. / Hub Diameter(s) mm	Body Type	Angle Misalignment Deg	Max. Parallel Offset mm
	<i>inches</i>	<i>inches</i>	<i>inches</i>			<i>inches</i>			<i>inches</i>
# CPNF-0635-0635-36R3C	6.350 / 6.350	20.6 <i>0.811</i>	35.7 <i>1.406</i>	1.27	Not Listed	Fairloc / 15.494	Ribbed	5	0.254 <i>0.010</i>
# CPNF-0635-0635-36S3C	6.350 / 6.350	20.6 <i>0.811</i>	35.7 <i>1.406</i>	1.27	Not Listed	Fairloc / 15.494	Smooth	1	0.127 <i>0.005</i>
# CPNF-0635-0318-64R3C	6.350 / 3.175	20.6 <i>0.811</i>	63.9 <i>2.516</i>	0.84	Not Listed	Fairloc / 11.176	Ribbed	15	0.381 <i>0.015</i>
# CPNF-0635-0635-67S3C	6.350 / 6.350	20.6 <i>0.811</i>	67.5 <i>2.657</i>	1.27	Not Listed	Fairloc / 15.494	Smooth	8	0.254 <i>0.010</i>
# CPNF-0635-0635-67R3C	6.350 / 6.350	20.6 <i>0.811</i>	67.5 <i>2.657</i>	1.27	Not Listed	Fairloc / 15.494	Ribbed	15	0.381 <i>0.015</i>

Indicates item not stocked at time of printing - Please enquire for lead time

E&OE Pricing and all details subject to change without notice - Copyright Miniature Bearings Australia Pty Ltd

MBA Size Listings are a guide to sizes only and must not be solely relied on for critical design information.



DISTRIBUTED BY

Ask us to put your name and address here

<http://www.minibearings.com.au/product>

Ph +61 7 3245 7977

Fax +61 7 3245 1017

Catalogue requests to catalogues@minibearings.com.au

