

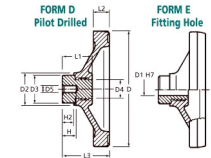

# MBA

## Cranks - Handwheel - Solid - Plastic - No Grip



Duroplastic FS 31 black. Bush in Steel, Bright and Lubricated.

Surface Finish: All edges smoothed and highly polished.

### Cranks - Handwheel - Solid - Plastic - No Grip

Part Number	Size / Form	Diameter mm <i>inches</i>	Bore (D1) mm <i>inches</i>	D2 / D3 / D4 mm <i>inches</i>	Pivot Bore (D5) mm <i>inches</i>	Crank Screw Size mm <i>inches</i>	Pivot Length(H) mm <i>inches</i>	Width mm <i>inches</i>	Crank Length mm <i>inches</i>
# HA120-12E	2 / E	120.00 <i>4.724</i>	12.00 <i>0.472</i>	34 / 28 / 20 <i>inches</i>	-	-	15.00 <i>0.591</i>	48.50 <i>1.909</i>	-
# HA120-08D	2 / D	120.00 <i>4.724</i>	-	34 / 28 / 20 <i>inches</i>	8.00 <i>0.315</i>	-	15.00 <i>0.591</i>	48.50 <i>1.909</i>	-
# HA140-14E	3 / E	140.00 <i>5.512</i>	14.00 <i>0.551</i>	40 / 32 / 24 <i>inches</i>	-	-	16.00 <i>0.630</i>	58.00 <i>2.283</i>	-
# HA140-08D	3 / D	140.00 <i>5.512</i>	-	40 / 32 / 24 <i>inches</i>	8.00 <i>0.315</i>	-	16.00 <i>0.630</i>	58.00 <i>2.283</i>	-

# Indicates item not stocked at time of printing - Please enquire for lead time

E&OE Pricing and all details subject to change without notice - Copyright Miniature Bearings Australia Pty Ltd

MBA Size Listings are a guide to sizes only and must not be solely relied on for critical design information.

## Cranks - Handwheel - Solid - Plastic - No Grip

Part Number	Size / Form	Diameter mm	Bore (D1) mm	D2 / D3 / D4 mm	Pivot Bore (D5) mm	Crank Screw Size mm	Pivot Length(H) mm	Width mm	Crank Length mm
		<i>inches</i>	<i>inches</i>	<i>inches</i>	<i>inches</i>	<i>inches</i>	<i>inches</i>	<i>inches</i>	<i>inches</i>
# HA160-16E	4 / E	160.00 <i>6.299</i>	16.00 <i>0.630</i>	50 / 36 / 35		-	20.00 <i>0.787</i>	59.00 <i>2.323</i>	-
# HA160-10D	4 / D	160.00 <i>6.299</i>	-	50 / 36 / 35	10.00 <i>0.394</i>	-	20.00 <i>0.787</i>	59.00 <i>2.323</i>	-
# HA190-18E	5 / E	190.00 <i>7.480</i>	18.00 <i>0.709</i>	50 / 40 / 35		-	30.00 <i>1.181</i>	77.00 <i>3.031</i>	-
# HA190-10D	5 / D	190.00 <i>7.480</i>	-	50 / 40 / 35	10.00 <i>0.394</i>	-	30.00 <i>1.181</i>	77.00 <i>3.031</i>	-
# HA100-10E	1 / E	100.00 <i>3.937</i>	10.00 <i>0.394</i>	28 / 24 / 16		-	12.00 <i>0.472</i>	41.00 <i>1.614</i>	-
# HA100-06D	1 / D	100.00 <i>3.937</i>	-	28 / 24 / 16	6.00 <i>0.236</i>	-	12.00 <i>0.472</i>	41.00 <i>1.614</i>	-

# Indicates item not stocked at time of printing - Please enquire for lead time

E&OE Pricing and all details subject to change without notice - Copyright Miniature Bearings Australia Pty Ltd

MBA Size Listings are a guide to sizes only and must not be solely relied on for critical design information.



DISTRIBUTED BY

Ask us to put your name and address here

<http://www.minibearings.com.au/product>

Ph +61 7 3245 7977

Fax +61 7 3245 1017

Catalogue requests to [catalogues@minibearings.com.au](mailto:catalogues@minibearings.com.au)

