

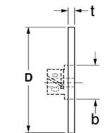

MBA

Dials - Disc - Precision



Use with disc dial indexes.

Precision Engraved.

Use with HUBS - Gear and Dial.

2024 Aluminium Black Anodized. Engraving filled with white enamel.

Dials - Disc - Precision

Part Number	Outside Diameter (D) mm	Bore Size (b) mm	No. of Graduations	Steps in Degrees	Dial Range Deg.	Width of Disc (t) mm	Marking Direction
	<i>inches</i>	<i>inches</i>				<i>inches</i>	
# DIAL-038-010-CW-10.00	38.000 <i>1.496</i>	10.000 <i>0.394</i>	10	36 Deg.	0-10	1.600 <i>0.063</i>	Clockwise
# DIAL-038-025-CW-10.00	38.000 <i>1.496</i>	10.000 <i>0.394</i>	25	14 Deg. 24 Min.	0-25	1.600 <i>0.063</i>	Clockwise
# DIAL-038-050-CW-10.00	38.000 <i>1.496</i>	10.000 <i>0.394</i>	50	7 Deg. 12 Min.	0-50	1.600 <i>0.063</i>	Clockwise
# DIAL-038-060-CW-10.00	38.000 <i>1.496</i>	10.000 <i>0.394</i>	60	6 Deg.	0-60	1.600 <i>0.063</i>	Clockwise

Indicates item not stocked at time of printing - Please enquire for lead time

E&OE Pricing and all details subject to change without notice - Copyright Miniature Bearings Australia Pty Ltd

MBA Size Listings are a guide to sizes only and must not be solely relied on for critical design information.

Dials - Disc - Precision

Part Number	Outside Diameter (D) mm	Bore Size (b) mm	No. of Graduations	Steps in Degrees	Dial Range Deg.	Width of Disc (t) mm	Marking Direction
	<i>inches</i>	<i>inches</i>				<i>inches</i>	
# DIAL-038-180-CW-10.00	38.000 <i>1.496</i>	10.000 <i>0.394</i>	180	2 Deg.	0-360	1.600 <i>0.063</i>	Clockwise
# DIAL-038-000-CW-10.00	38.000 <i>1.496</i>	10.000 <i>0.394</i>	N/A	N/A	N/A	1.600 <i>0.063</i>	Clockwise
# DIAL-038-010-CW-09.53	38.100 <i>1.500</i>	9.525 <i>0.375</i>	10	36 Deg.	0-10	1.575 <i>0.062</i>	Clockwise
# DIAL-038-025-CW-09.53	38.100 <i>1.500</i>	9.525 <i>0.375</i>	25	14 Deg. 24 Min.	0-25	1.575 <i>0.062</i>	Clockwise
# DIAL-038-050-CW-09.53	38.100 <i>1.500</i>	9.525 <i>0.375</i>	50	7 Deg. 12 Min.	0-50	1.575 <i>0.062</i>	Clockwise
# DIAL-038-060-CW-09.53	38.100 <i>1.500</i>	9.525 <i>0.375</i>	60	6 Deg.	0-60	1.575 <i>0.062</i>	Clockwise
# DIAL-038-100-CW-09.53	38.100 <i>1.500</i>	9.525 <i>0.375</i>	100	3 Deg. 36 Min.	0-100	1.575 <i>0.062</i>	Clockwise
# DIAL-038-180-CW-09.53	38.100 <i>1.500</i>	9.525 <i>0.375</i>	180	2 Deg.	0-360	1.575 <i>0.062</i>	Clockwise
# DIAL-038-000-CW-09.53	38.100 <i>1.500</i>	9.525 <i>0.375</i>	N/A	N/A	N/A	1.575 <i>0.062</i>	Clockwise
# DIAL-051-010-CW-09.53	50.800 <i>2.000</i>	9.525 <i>0.375</i>	10	36 Deg.	0-10	1.575 <i>0.062</i>	Clockwise

Indicates item not stocked at time of printing - Please enquire for lead time

E&OE Pricing and all details subject to change without notice - Copyright Miniature Bearings Australia Pty Ltd

MBA Size Listings are a guide to sizes only and must not be solely relied on for critical design information.

Dials - Disc - Precision

Part Number	Outside Diameter (D) mm	Bore Size (b) mm	No. of Graduations	Steps in Degrees	Dial Range Deg.	Width of Disc (t) mm	Marking Direction
	<i>inches</i>	<i>inches</i>				<i>inches</i>	
# DIAL-051-025-CW-09.53	50.800 <i>2.000</i>	9.525 <i>0.375</i>	25	14 Deg. 24 Min.	0-25	1.575 <i>0.062</i>	Clockwise
# DIAL-051-050-CW-09.53	50.800 <i>2.000</i>	9.525 <i>0.375</i>	50	7 Deg. 12 Min.	0-50	1.575 <i>0.062</i>	Clockwise
# DIAL-051-060-CW-09.53	50.800 <i>2.000</i>	9.525 <i>0.375</i>	60	6 Deg.	0-60	1.575 <i>0.062</i>	Clockwise
# DIAL-051-072-CW-09.53	50.800 <i>2.000</i>	9.525 <i>0.375</i>	72	5 Deg.	0-72	1.575 <i>0.062</i>	Clockwise
# DIAL-051-100-CW-09.53	50.800 <i>2.000</i>	9.525 <i>0.375</i>	100	3 Deg. 36 Min.	0-100	1.575 <i>0.062</i>	Clockwise
# DIAL-051-120-CW-09.53	50.800 <i>2.000</i>	9.525 <i>0.375</i>	120	3 Deg.	0-120	1.575 <i>0.062</i>	Clockwise
# DIAL-051-180-CW-09.53	50.800 <i>2.000</i>	9.525 <i>0.375</i>	180	2 Deg.	0-360	1.575 <i>0.062</i>	Clockwise
# DIAL-051-000-CW-09.53	50.800 <i>2.000</i>	9.525 <i>0.375</i>	N/A	N/A	N/A	1.575 <i>0.062</i>	Clockwise
# DIAL-051-025-CW-10.00	51.000 <i>2.008</i>	10.000 <i>0.394</i>	25	14 Deg. 24 Min.	0-25	1.600 <i>0.063</i>	Clockwise
# DIAL-051-060-CW-10.00	51.000 <i>2.008</i>	10.000 <i>0.394</i>	60	6 Deg.	0-60	1.600 <i>0.063</i>	Clockwise

Indicates item not stocked at time of printing - Please enquire for lead time

E&OE Pricing and all details subject to change without notice - Copyright Miniature Bearings Australia Pty Ltd

MBA Size Listings are a guide to sizes only and must not be solely relied on for critical design information.

Dials - Disc - Precision

Part Number	Outside Diameter (D) mm	Bore Size (b) mm	No. of Graduations	Steps in Degrees	Dial Range Deg.	Width of Disc (t) mm	Marking Direction
	<i>inches</i>	<i>inches</i>				<i>inches</i>	
# DIAL-051-120-CW-10.00	51.000 <i>2.008</i>	10.000 <i>0.394</i>	120	3 Deg.	0-120	1.600 <i>0.063</i>	Clockwise
# DIAL-051-180-CW-10.00	51.000 <i>2.008</i>	10.000 <i>0.394</i>	180	2 Deg.	0-360	1.600 <i>0.063</i>	Clockwise
# DIAL-051-000-CW-10.00	51.000 <i>2.008</i>	10.000 <i>0.394</i>	N/A	N/A	N/A	1.600 <i>0.063</i>	Clockwise
# DIAL-076-010-CW-10.00	76.000 <i>2.992</i>	10.000 <i>0.394</i>	10	36 Deg.	0-10	1.600 <i>0.063</i>	Clockwise
# DIAL-076-050-CW-10.00	76.000 <i>2.992</i>	10.000 <i>0.394</i>	50	7 Deg. 12 Min.	0-50	1.600 <i>0.063</i>	Clockwise
# DIAL-076-072-CW-10.00	76.000 <i>2.992</i>	10.000 <i>0.394</i>	72	5 Deg.	0-72	1.600 <i>0.063</i>	Clockwise
# DIAL-076-100-CW-10.00	76.000 <i>2.992</i>	10.000 <i>0.394</i>	100	3 Deg. 36 Min.	0-100	1.600 <i>0.063</i>	Clockwise
# DIAL-076-100-CCW-10.00	76.000 <i>2.992</i>	10.000 <i>0.394</i>	100	3 Deg. 36 Min.	0-100	1.600 <i>0.063</i>	Counter Clockwise
# DIAL-076-120-CW-10.00	76.000 <i>2.992</i>	10.000 <i>0.394</i>	120	3 Deg.	0-120	1.600 <i>0.063</i>	Clockwise
# DIAL-076-180-CCW-10.00	76.000 <i>2.992</i>	10.000 <i>0.394</i>	180	2 Deg.	0-360	1.600 <i>0.063</i>	Counter Clockwise

Indicates item not stocked at time of printing - Please enquire for lead time

E&OE Pricing and all details subject to change without notice - Copyright Miniature Bearings Australia Pty Ltd

MBA Size Listings are a guide to sizes only and must not be solely relied on for critical design information.

Dials - Disc - Precision

Part Number	Outside Diameter (D) mm	Bore Size (b) mm	No. of Graduations	Steps in Degrees	Dial Range Deg.	Width of Disc (t) mm	Marking Direction
	<i>inches</i>	<i>inches</i>				<i>inches</i>	
# DIAL-076-180-CW-10.00	76.000 <i>2.992</i>	10.000 <i>0.394</i>	180	2 Deg.	0-360	1.600 <i>0.063</i>	Clockwise
# DIAL-076-180B-CW-10.00	76.000 <i>2.992</i>	10.000 <i>0.394</i>	180	2 Deg.	0-180	1.600 <i>0.063</i>	Clockwise
# DIAL-076-200-CW-10.00	76.000 <i>2.992</i>	10.000 <i>0.394</i>	200	1 Deg. 48 Min.	0-200	1.600 <i>0.063</i>	Clockwise
# DIAL-076-360-CCW-10.00	76.000 <i>2.992</i>	10.000 <i>0.394</i>	360	1 Deg.	0-360	1.600 <i>0.063</i>	Counter Clockwise
# DIAL-076-360-CW-10.00	76.000 <i>2.992</i>	10.000 <i>0.394</i>	360	1 Deg.	0-360	1.600 <i>0.063</i>	Clockwise
# DIAL-076-000-CW-10.00	76.000 <i>2.992</i>	10.000 <i>0.394</i>	N/A	N/A	N/A	1.600 <i>0.063</i>	Clockwise
# DIAL-076-010-CW-09.53	76.200 <i>3.000</i>	9.525 <i>0.375</i>	10	36 Deg.	0-10	1.575 <i>0.062</i>	Clockwise
# DIAL-076-050-CW-09.53	76.200 <i>3.000</i>	9.525 <i>0.375</i>	50	7 Deg. 12 Min.	0-50	1.575 <i>0.062</i>	Clockwise
# DIAL-076-072-CW-09.53	76.200 <i>3.000</i>	9.525 <i>0.375</i>	72	5 Deg.	0-72	1.575 <i>0.062</i>	Clockwise
# DIAL-076-100-CCW-09.53	76.200 <i>3.000</i>	9.525 <i>0.375</i>	100	3 Deg. 36 Min.	0-100	1.575 <i>0.062</i>	Counter Clockwise

Indicates item not stocked at time of printing - Please enquire for lead time

E&OE Pricing and all details subject to change without notice - Copyright Miniature Bearings Australia Pty Ltd

MBA Size Listings are a guide to sizes only and must not be solely relied on for critical design information.

Dials - Disc - Precision

Part Number	Outside Diameter (D) mm	Bore Size (b) mm	No. of Graduations	Steps in Degrees	Dial Range Deg.	Width of Disc (t) mm	Marking Direction
	<i>inches</i>	<i>inches</i>				<i>inches</i>	
# DIAL-076-100-CW-09.53	76.200 <i>3.000</i>	9.525 <i>0.375</i>	100	3 Deg. 36 Min.	0-100	1.575 <i>0.062</i>	Clockwise
# DIAL-076-120-CW-09.53	76.200 <i>3.000</i>	9.525 <i>0.375</i>	120	3 Deg.	0-120	1.575 <i>0.062</i>	Clockwise
# DIAL-076-180-CCW-09.53	76.200 <i>3.000</i>	9.525 <i>0.375</i>	180	2 Deg.	0-360	1.575 <i>0.062</i>	Counter Clockwise
# DIAL-076-180B-CW-09.53	76.200 <i>3.000</i>	9.525 <i>0.375</i>	180	2 Deg.	0-180	1.575 <i>0.062</i>	Clockwise
# DIAL-076-180-CW-09.53	76.200 <i>3.000</i>	9.525 <i>0.375</i>	180	2 Deg.	0-360	1.575 <i>0.062</i>	Clockwise
# DIAL-076-200-CW-09.53	76.200 <i>3.000</i>	9.525 <i>0.375</i>	200	1 Deg. 48 Min.	0-200	1.575 <i>0.062</i>	Clockwise
# DIAL-076-360-CW-09.53	76.200 <i>3.000</i>	9.525 <i>0.375</i>	360	1 Deg.	0-360	1.575 <i>0.062</i>	Clockwise
# DIAL-076-360-CCW-09.53	76.200 <i>3.000</i>	9.525 <i>0.375</i>	360	1 Deg.	0-360	1.575 <i>0.062</i>	Counter Clockwise
# DIAL-076-000-CW-09.53	76.200 <i>3.000</i>	9.525 <i>0.375</i>	N/A	N/A	N/A	1.575 <i>0.062</i>	Clockwise
# DIAL-102-010-CW-10.00	101.500 <i>3.996</i>	10.000 <i>0.394</i>	10	36 Deg.	0-10	1.600 <i>0.063</i>	Clockwise

Indicates item not stocked at time of printing - Please enquire for lead time

E&OE Pricing and all details subject to change without notice - Copyright Miniature Bearings Australia Pty Ltd

MBA Size Listings are a guide to sizes only and must not be solely relied on for critical design information.

Dials - Disc - Precision

Part Number	Outside Diameter (D) mm	Bore Size (b) mm	No. of Graduations	Steps in Degrees	Dial Range Deg.	Width of Disc (t) mm	Marking Direction
	<i>inches</i>	<i>inches</i>				<i>inches</i>	
# DIAL-102-100-CW-10.00	101.500 <i>3.996</i>	10.000 <i>0.394</i>	100	3 Deg. 36 Min.	0-100	1.600 <i>0.063</i>	Clockwise
# DIAL-102-180B-CW-10.00	101.500 <i>3.996</i>	10.000 <i>0.394</i>	180	2 Deg.	0-180	1.600 <i>0.063</i>	Clockwise
# DIAL-102-180-CCW-10.00	101.500 <i>3.996</i>	10.000 <i>0.394</i>	180	2 Deg.	0-360	1.600 <i>0.063</i>	Counter Clockwise
# DIAL-102-180-CW-10.00	101.500 <i>3.996</i>	10.000 <i>0.394</i>	180	2 Deg.	0-360	1.600 <i>0.063</i>	Clockwise
# DIAL-102-200-CW-10.00	101.500 <i>3.996</i>	10.000 <i>0.394</i>	200	1 Deg. 48 Min.	0-200	1.600 <i>0.063</i>	Clockwise
# DIAL-102-360-CW-10.00	101.500 <i>3.996</i>	10.000 <i>0.394</i>	360	1 Deg.	0-360	1.600 <i>0.063</i>	Clockwise
# DIAL-102-360-CCW-10.00	101.500 <i>3.996</i>	10.000 <i>0.394</i>	360	1 Deg.	0-360	1.600 <i>0.063</i>	Counter Clockwise
# DIAL-102-000-CW-10.00	101.500 <i>3.996</i>	10.000 <i>0.394</i>	N/A	N/A	N/A	1.600 <i>0.063</i>	Clockwise
# DIAL-102-010-CW-09.53	101.600 <i>4.000</i>	9.525 <i>0.375</i>	10	36 Deg.	0-10	1.575 <i>0.062</i>	Clockwise
# DIAL-102-050-CW-09.53	101.600 <i>4.000</i>	9.525 <i>0.375</i>	50	7 Deg. 12 Min.	0-50	1.575 <i>0.062</i>	Clockwise

Indicates item not stocked at time of printing - Please enquire for lead time

E&OE Pricing and all details subject to change without notice - Copyright Miniature Bearings Australia Pty Ltd

MBA Size Listings are a guide to sizes only and must not be solely relied on for critical design information.

Dials - Disc - Precision

Part Number	Outside Diameter (D) mm	Bore Size (b) mm	No. of Graduations	Steps in Degrees	Dial Range Deg.	Width of Disc (t) mm	Marking Direction
	<i>inches</i>	<i>inches</i>				<i>inches</i>	
# DIAL-102-100-CW-09.53	101.600 <i>4.000</i>	9.525 <i>0.375</i>	100	3 Deg. 36 Min.	0-100	1.575 <i>0.062</i>	Clockwise
# DIAL-102-180-CW-09.53	101.600 <i>4.000</i>	9.525 <i>0.375</i>	180	2 Deg.	0-360	1.575 <i>0.062</i>	Clockwise
# DIAL-102-180B-CW-09.53	101.600 <i>4.000</i>	9.525 <i>0.375</i>	180	2 Deg.	0-180	1.575 <i>0.062</i>	Clockwise
# DIAL-102-180-CCW-09.53	101.600 <i>4.000</i>	9.525 <i>0.375</i>	180	2 Deg.	0-360	1.575 <i>0.062</i>	Counter Clockwise
# DIAL-102-200-CW-09.53	101.600 <i>4.000</i>	9.525 <i>0.375</i>	200	1 Deg. 48 Min.	0-200	1.575 <i>0.062</i>	Clockwise
# DIAL-102-360-CCW-09.53	101.600 <i>4.000</i>	9.525 <i>0.375</i>	360	1 Deg.	0-360	1.575 <i>0.062</i>	Counter Clockwise
# DIAL-102-360-CW-09.53	101.600 <i>4.000</i>	9.525 <i>0.375</i>	360	1 Deg.	0-360	1.575 <i>0.062</i>	Clockwise
# DIAL-102-000-CW-09.53	101.600 <i>4.000</i>	9.525 <i>0.375</i>	N/A	N/A	N/A	1.575 <i>0.062</i>	Clockwise

Indicates item not stocked at time of printing - Please enquire for lead time

E&OE Pricing and all details subject to change without notice - Copyright Miniature Bearings Australia Pty Ltd

MBA Size Listings are a guide to sizes only and must not be solely relied on for critical design information.



DISTRIBUTED BY

Ask us to put your name and address here

<http://www.minibearings.com.au/product>

Ph +61 7 3245 7977

Fax +61 7 3245 1017

Catalogue requests to catalogues@minibearings.com.au

