

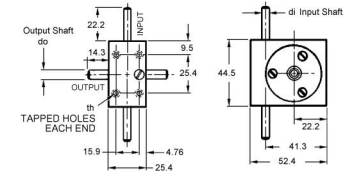

MBA

Gearboxes - Cross Axis - 52.4 x 44.5 x 25.4



Worm Gears. Precision Quality - Input Speeds up to 6000 RPM.

Max Input : 6000 RPM.

Backlash at Output : 0 Deg 30 Min.

Packed with grease at assembly - temp range -32 Deg C to +146 Deg C (-25 F to 295 F).

Gearboxes - Cross Axis - 52.4 x 44.5 x 25.4

Part Number	Ratio	Input Shaft Diameter (di) mm <i>inches</i>	Output Shaft Diameter (do) mm <i>inches</i>	Max. Output Torque at 1800 rpm N.m	Max. Start Torque N.m	Worm / Worm Wheel Material	Tapped Hole Size (th)	Bearings (Input / Output)	Shafts (Input / Output)	Housing
# WGE44-007.5	7.5 : 1	4.000 <i>0.157</i>	6.000 <i>0.236</i>	1.47	0.0012	Hardened Carbon Steel / Phosphor Bronze	M4 x 4.8 Deep	Precision Ball / Self Lubricating Bronze	Carbon Steel / Mild Steel	Aluminium Alloy (Black Anodised)
# WGE44-007.5-IN	7.5 : 1	4.750 <i>0.187</i>	6.342 <i>0.250</i>	1.47	0.0012	Phosphor Bronze	6-32 x 4.76mm deep	Precision Ball / Self Lubricating Bronze	Carbon Steel / Mild Steel	Aluminium Alloy (Black Anodised)

Indicates item not stocked at time of printing - Please enquire for lead time

E&OE Pricing and all details subject to change without notice - Copyright Miniature Bearings Australia Pty Ltd

MBA Size Listings are a guide to sizes only and must not be solely relied on for critical design information.

Gearboxes - Cross Axis - 52.4 x 44.5 x 25.4

Part Number	Ratio	Input Shaft Diameter (di) mm <i>inches</i>	Output Shaft Diameter (do) mm <i>inches</i>	Max. Output Torque at 1800 rpm N.m	Max. Start Torque N.m	Worm / Worm Wheel Material	Tapped Hole Size (th)	Bearings (Input / Output)	Shafts (Input / Output)	Housing
# WGE44-008.0	8 : 1	4.000 <i>0.157</i>	6.000 <i>0.236</i>	1.47	0.0012	Hardened Carbon Steel / Phosphor Bronze	M4 x 4.8 Deep	Precision Ball / Self Lubricating Bronze	Carbon Steel / Mild Steel	Aluminium Alloy (Black Anodised)
# WGE44-008.0-IN	8 : 1	4.750 <i>0.187</i>	6.342 <i>0.250</i>	1.47	0.0012	Phosphor Bronze	6-32 x 4.76mm deep	Precision Ball / Self Lubricating Bronze	Carbon Steel / Mild Steel	Aluminium Alloy (Black Anodised)
# WGE44-010.0	10 : 1	4.000 <i>0.157</i>	6.000 <i>0.236</i>	1.47	0.0012	Hardened Carbon Steel / Phosphor Bronze	M4 x 4.8 Deep	Precision Ball / Self Lubricating Bronze	Carbon Steel / Mild Steel	Aluminium Alloy (Black Anodised)
# WGE44-010.0-IN	10 : 1	4.750 <i>0.187</i>	6.342 <i>0.250</i>	1.47	0.0012	Phosphor Bronze	6-32 x 4.76mm deep	Precision Ball / Self Lubricating Bronze	Carbon Steel / Mild Steel	Aluminium Alloy (Black Anodised)
# WGE44-012.0	12 : 1	4.000 <i>0.157</i>	6.000 <i>0.236</i>	1.47	0.0012	Hardened Carbon Steel / Phosphor Bronze	M4 x 4.8 Deep	Precision Ball / Self Lubricating Bronze	Carbon Steel / Mild Steel	Aluminium Alloy (Black Anodised)
# WGE44-012.0-IN	12 : 1	4.750 <i>0.187</i>	6.342 <i>0.250</i>	1.47	0.0012	Phosphor Bronze	6-32 x 4.76mm deep	Precision Ball / Self Lubricating Bronze	Carbon Steel / Mild Steel	Aluminium Alloy (Black Anodised)

Indicates item not stocked at time of printing - Please enquire for lead time

E&OE Pricing and all details subject to change without notice - Copyright Miniature Bearings Australia Pty Ltd

MBA Size Listings are a guide to sizes only and must not be solely relied on for critical design information.

Gearboxes - Cross Axis - 52.4 x 44.5 x 25.4

Part Number	Ratio	Input Shaft Diameter (di) mm <i>inches</i>	Output Shaft Diameter (do) mm <i>inches</i>	Max. Output Torque at 1800 rpm N.m	Max. Start Torque N.m	Worm / Worm Wheel Material	Tapped Hole Size (th)	Bearings (Input / Output)	Shafts (Input / Output)	Housing
# WGE44-015.0	15 : 1	4.000 <i>0.157</i>	6.000 <i>0.236</i>	1.47	0.0012	Hardened Carbon Steel / Phosphor Bronze	M4 x 4.8 Deep	Precision Ball / Self Lubricating Bronze	Carbon Steel / Mild Steel	Aluminium Alloy (Black Anodised)
# WGE44-015.0-IN	15 : 1	4.750 <i>0.187</i>	6.342 <i>0.250</i>	1.47	0.0012	Phosphor Bronze	6-32 x 4.76mm deep	Precision Ball / Self Lubricating Bronze	Carbon Steel / Mild Steel	Aluminium Alloy (Black Anodised)
# WGE44-016.0	16 : 1	4.000 <i>0.157</i>	6.000 <i>0.236</i>	1.47	0.0012	Hardened Carbon Steel / Phosphor Bronze	M4 x 4.8 Deep	Precision Ball / Self Lubricating Bronze	Carbon Steel / Mild Steel	Aluminium Alloy (Black Anodised)
# WGE44-016.0-IN	16 : 1	4.750 <i>0.187</i>	6.342 <i>0.250</i>	1.47	0.0012	Phosphor Bronze	6-32 x 4.76mm deep	Precision Ball / Self Lubricating Bronze	Carbon Steel / Mild Steel	Aluminium Alloy (Black Anodised)
# WGE44-016.7	16.67 : 1	4.000 <i>0.157</i>	6.000 <i>0.236</i>	1.47	0.0012	Hardened Carbon Steel / Phosphor Bronze	M4 x 4.8 Deep	Precision Ball / Self Lubricating Bronze	Carbon Steel / Mild Steel	Aluminium Alloy (Black Anodised)
# WGE44-016.7-IN	16.67 : 1	4.750 <i>0.187</i>	6.342 <i>0.250</i>	1.47	0.0012	Phosphor Bronze	6-32 x 4.76mm deep	Precision Ball / Self Lubricating Bronze	Carbon Steel / Mild Steel	Aluminium Alloy (Black Anodised)

Indicates item not stocked at time of printing - Please enquire for lead time

E&OE Pricing and all details subject to change without notice - Copyright Miniature Bearings Australia Pty Ltd

MBA Size Listings are a guide to sizes only and must not be solely relied on for critical design information.

Gearboxes - Cross Axis - 52.4 x 44.5 x 25.4

Part Number	Ratio	Input Shaft Diameter (di) mm <i>inches</i>	Output Shaft Diameter (do) mm <i>inches</i>	Max. Output Torque at 1800 rpm N.m	Max. Start Torque N.m	Worm / Worm Wheel Material	Tapped Hole Size (th)	Bearings (Input / Output)	Shafts (Input / Output)	Housing
# WGE44-017.0	17 : 1	4.000 <i>0.157</i>	6.000 <i>0.236</i>	1.47	0.0012	Hardened Carbon Steel / Phosphor Bronze	M4 x 4.8 Deep	Precision Ball / Self Lubricating Bronze	Carbon Steel / Mild Steel	Aluminium Alloy (Black Anodised)
# WGE44-017.0-IN	17 : 1	4.750 <i>0.187</i>	6.342 <i>0.250</i>	1.47	0.0012	Phosphor Bronze	6-32 x 4.76mm deep	Precision Ball / Self Lubricating Bronze	Carbon Steel / Mild Steel	Aluminium Alloy (Black Anodised)
# WGE44-020.0	20 : 1	4.000 <i>0.157</i>	6.000 <i>0.236</i>	1.47	0.0012	Hardened Carbon Steel / Phosphor Bronze	M4 x 4.8 Deep	Precision Ball / Self Lubricating Bronze	Carbon Steel / Mild Steel	Aluminium Alloy (Black Anodised)
# WGE44-020.0-IN	20 : 1	4.750 <i>0.187</i>	6.342 <i>0.250</i>	1.47	0.0012	Phosphor Bronze	6-32 x 4.76mm deep	Precision Ball / Self Lubricating Bronze	Carbon Steel / Mild Steel	Aluminium Alloy (Black Anodised)
# WGE44-021.5	21.5 : 1	4.000 <i>0.157</i>	6.000 <i>0.236</i>	1.47	0.0012	Hardened Carbon Steel / Phosphor Bronze	M4 x 4.8 Deep	Precision Ball / Self Lubricating Bronze	Carbon Steel / Mild Steel	Aluminium Alloy (Black Anodised)
# WGE44-021.5-IN	21.5 : 1	4.750 <i>0.187</i>	6.342 <i>0.250</i>	1.47	0.0012	Phosphor Bronze	6-32 x 4.76mm deep	Precision Ball / Self Lubricating Bronze	Carbon Steel / Mild Steel	Aluminium Alloy (Black Anodised)

Indicates item not stocked at time of printing - Please enquire for lead time

E&OE Pricing and all details subject to change without notice - Copyright Miniature Bearings Australia Pty Ltd

MBA Size Listings are a guide to sizes only and must not be solely relied on for critical design information.

Gearboxes - Cross Axis - 52.4 x 44.5 x 25.4

Part Number	Ratio	Input Shaft Diameter (di) mm <i>inches</i>	Output Shaft Diameter (do) mm <i>inches</i>	Max. Output Torque at 1800 rpm N.m	Max. Start Torque N.m	Worm / Worm Wheel Material	Tapped Hole Size (th)	Bearings (Input / Output)	Shafts (Input / Output)	Housing
# WGE44-024.0	24 : 1	4.000 <i>0.157</i>	6.000 <i>0.236</i>	1.47	0.0012	Hardened Carbon Steel / Phosphor Bronze	M4 x 4.8 Deep	Precision Ball / Self Lubricating Bronze	Carbon Steel / Mild Steel	Aluminium Alloy (Black Anodised)
# WGE44-024.0-IN	24 : 1	4.750 <i>0.187</i>	6.342 <i>0.250</i>	1.47	0.0012	Phosphor Bronze	6-32 x 4.76mm deep	Precision Ball / Self Lubricating Bronze	Carbon Steel / Mild Steel	Aluminium Alloy (Black Anodised)
# WGE44-025.0	25 : 1	4.000 <i>0.157</i>	6.000 <i>0.236</i>	1.47	0.0012	Hardened Carbon Steel / Phosphor Bronze	M4 x 4.8 Deep	Precision Ball / Self Lubricating Bronze	Carbon Steel / Mild Steel	Aluminium Alloy (Black Anodised)
# WGE44-025.0-IN	25 : 1	4.750 <i>0.187</i>	6.342 <i>0.250</i>	1.47	0.0012	Phosphor Bronze	6-32 x 4.76mm deep	Precision Ball / Self Lubricating Bronze	Carbon Steel / Mild Steel	Aluminium Alloy (Black Anodised)
# WGE44-030.0	30 : 1	4.000 <i>0.157</i>	6.000 <i>0.236</i>	1.47	0.0012	Hardened Carbon Steel / Phosphor Bronze	M4 x 4.8 Deep	Precision Ball / Self Lubricating Bronze	Carbon Steel / Mild Steel	Aluminium Alloy (Black Anodised)
# WGE44-030.0-IN	30 : 1	4.750 <i>0.187</i>	6.342 <i>0.250</i>	1.47	0.0012	Phosphor Bronze	6-32 x 4.76mm deep	Precision Ball / Self Lubricating Bronze	Carbon Steel / Mild Steel	Aluminium Alloy (Black Anodised)

Indicates item not stocked at time of printing - Please enquire for lead time

E&OE Pricing and all details subject to change without notice - Copyright Miniature Bearings Australia Pty Ltd

MBA Size Listings are a guide to sizes only and must not be solely relied on for critical design information.

Gearboxes - Cross Axis - 52.4 x 44.5 x 25.4

Part Number	Ratio	Input Shaft Diameter (di) mm <i>inches</i>	Output Shaft Diameter (do) mm <i>inches</i>	Max. Output Torque at 1800 rpm N.m	Max. Start Torque N.m	Worm / Worm Wheel Material	Tapped Hole Size (th)	Bearings (Input / Output)	Shafts (Input / Output)	Housing
# WGE44-032.0	32 : 1	4.000 <i>0.157</i>	6.000 <i>0.236</i>	1.47	0.0012	Hardened Carbon Steel / Phosphor Bronze	M4 x 4.8 Deep	Precision Ball / Self Lubricating Bronze	Carbon Steel / Mild Steel	Aluminium Alloy (Black Anodised)
# WGE44-032.0-IN	32 : 1	4.750 <i>0.187</i>	6.342 <i>0.250</i>	1.47	0.0012	Phosphor Bronze	6-32 x 4.76mm deep	Precision Ball / Self Lubricating Bronze	Carbon Steel / Mild Steel	Aluminium Alloy (Black Anodised)
# WGE44-036.0	36 : 1	4.000 <i>0.157</i>	6.000 <i>0.236</i>	1.47	0.0012	Hardened Carbon Steel / Phosphor Bronze	M4 x 4.8 Deep	Precision Ball / Self Lubricating Bronze	Carbon Steel / Mild Steel	Aluminium Alloy (Black Anodised)
# WGE44-036.0-IN	36 : 1	4.750 <i>0.187</i>	6.342 <i>0.250</i>	1.47	0.0012	Phosphor Bronze	6-32 x 4.76mm deep	Precision Ball / Self Lubricating Bronze	Carbon Steel / Mild Steel	Aluminium Alloy (Black Anodised)
# WGE44-040.0	40 : 1	4.000 <i>0.157</i>	6.000 <i>0.236</i>	1.47	0.0012	Hardened Carbon Steel / Phosphor Bronze	M4 x 4.8 Deep	Precision Ball / Self Lubricating Bronze	Carbon Steel / Mild Steel	Aluminium Alloy (Black Anodised)
# WGE44-040.0-IN	40 : 1	4.750 <i>0.187</i>	6.342 <i>0.250</i>	1.47	0.0012	Phosphor Bronze	6-32 x 4.76mm deep	Precision Ball / Self Lubricating Bronze	Carbon Steel / Mild Steel	Aluminium Alloy (Black Anodised)

Indicates item not stocked at time of printing - Please enquire for lead time

E&OE Pricing and all details subject to change without notice - Copyright Miniature Bearings Australia Pty Ltd

MBA Size Listings are a guide to sizes only and must not be solely relied on for critical design information.

Gearboxes - Cross Axis - 52.4 x 44.5 x 25.4

Part Number	Ratio	Input Shaft Diameter (di) mm <i>inches</i>	Output Shaft Diameter (do) mm <i>inches</i>	Max. Output Torque at 1800 rpm N.m	Max. Start Torque N.m	Worm / Worm Wheel Material	Tapped Hole Size (th)	Bearings (Input / Output)	Shafts (Input / Output)	Housing
# WGE44-042.0	42 : 1	4.000 <i>0.157</i>	6.000 <i>0.236</i>	1.47	0.0012	Hardened Carbon Steel / Phosphor Bronze	M4 x 4.8 Deep	Precision Ball / Self Lubricating Bronze	Carbon Steel / Mild Steel	Aluminium Alloy (Black Anodised)
# WGE44-042.0-IN	42 : 1	4.750 <i>0.187</i>	6.342 <i>0.250</i>	1.47	0.0012	Phosphor Bronze	6-32 x 4.76mm deep	Precision Ball / Self Lubricating Bronze	Carbon Steel / Mild Steel	Aluminium Alloy (Black Anodised)
# WGE44-045.0	45 : 1	4.000 <i>0.157</i>	6.000 <i>0.236</i>	1.47	0.0012	Hardened Carbon Steel / Phosphor Bronze	M4 x 4.8 Deep	Precision Ball / Self Lubricating Bronze	Carbon Steel / Mild Steel	Aluminium Alloy (Black Anodised)
# WGE44-045.0-IN	45 : 1	4.750 <i>0.187</i>	6.342 <i>0.250</i>	1.47	0.0012	Phosphor Bronze	6-32 x 4.76mm deep	Precision Ball / Self Lubricating Bronze	Carbon Steel / Mild Steel	Aluminium Alloy (Black Anodised)
# WGE44-048.0	48 : 1	4.000 <i>0.157</i>	6.000 <i>0.236</i>	1.47	0.0012	Hardened Carbon Steel / Phosphor Bronze	M4 x 4.8 Deep	Precision Ball / Self Lubricating Bronze	Carbon Steel / Mild Steel	Aluminium Alloy (Black Anodised)
# WGE44-048.0-IN	48 : 1	4.750 <i>0.187</i>	6.342 <i>0.250</i>	1.47	0.0012	Phosphor Bronze	6-32 x 4.76mm deep	Precision Ball / Self Lubricating Bronze	Carbon Steel / Mild Steel	Aluminium Alloy (Black Anodised)

Indicates item not stocked at time of printing - Please enquire for lead time

E&OE Pricing and all details subject to change without notice - Copyright Miniature Bearings Australia Pty Ltd

MBA Size Listings are a guide to sizes only and must not be solely relied on for critical design information.

Gearboxes - Cross Axis - 52.4 x 44.5 x 25.4

Part Number	Ratio	Input Shaft Diameter (di) mm <i>inches</i>	Output Shaft Diameter (do) mm <i>inches</i>	Max. Output Torque at 1800 rpm N.m	Max. Start Torque N.m	Worm / Worm Wheel Material	Tapped Hole Size (th)	Bearings (Input / Output)	Shafts (Input / Output)	Housing
# WGE44-050.0	50 : 1	4.000 <i>0.157</i>	6.000 <i>0.236</i>	1.47	0.0012	Hardened Carbon Steel / Phosphor Bronze	M4 x 4.8 Deep	Precision Ball / Self Lubricating Bronze	Carbon Steel / Mild Steel	Aluminium Alloy (Black Anodised)
# WGE44-050.0-IN	50 : 1	4.750 <i>0.187</i>	6.342 <i>0.250</i>	1.47	0.0012	Phosphor Bronze	6-32 x 4.76mm deep	Precision Ball / Self Lubricating Bronze	Carbon Steel / Mild Steel	Aluminium Alloy (Black Anodised)
# WGE44-060.0	60 : 1	4.000 <i>0.157</i>	6.000 <i>0.236</i>	1.47	0.0012	Hardened Carbon Steel / Phosphor Bronze	M4 x 4.8 Deep	Precision Ball / Self Lubricating Bronze	Carbon Steel / Mild Steel	Aluminium Alloy (Black Anodised)
# WGE44-060.0-IN	60 : 1	4.750 <i>0.187</i>	6.342 <i>0.250</i>	1.47	0.0012	Phosphor Bronze	6-32 x 4.76mm deep	Precision Ball / Self Lubricating Bronze	Carbon Steel / Mild Steel	Aluminium Alloy (Black Anodised)
# WGE44-090.0	90 : 1	4.000 <i>0.157</i>	6.000 <i>0.236</i>	1.47	0.0012	Hardened Carbon Steel / Phosphor Bronze	M4 x 4.8 Deep	Precision Ball / Self Lubricating Bronze	Carbon Steel / Mild Steel	Aluminium Alloy (Black Anodised)
# WGE44-090.0-IN	90 : 1	4.750 <i>0.187</i>	6.342 <i>0.250</i>	1.47	0.0012	Phosphor Bronze	6-32 x 4.76mm deep	Precision Ball / Self Lubricating Bronze	Carbon Steel / Mild Steel	Aluminium Alloy (Black Anodised)

Indicates item not stocked at time of printing - Please enquire for lead time

E&OE Pricing and all details subject to change without notice - Copyright Miniature Bearings Australia Pty Ltd

MBA Size Listings are a guide to sizes only and must not be solely relied on for critical design information.

Gearboxes - Cross Axis - 52.4 x 44.5 x 25.4

Part Number	Ratio	Input Shaft Diameter (di) mm <i>inches</i>	Output Shaft Diameter (do) mm <i>inches</i>	Max. Output Torque at 1800 rpm N.m	Max. Start Torque N.m	Worm / Worm Wheel Material	Tapped Hole Size (th)	Bearings (Input / Output)	Shafts (Input / Output)	Housing
# WGE44-100.0	100 : 1	4.000 <i>0.157</i>	6.000 <i>0.236</i>	1.47	0.0012	Hardened Carbon Steel / Phosphor Bronze	M4 x 4.8 Deep	Precision Ball / Self Lubricating Bronze	Carbon Steel / Mild Steel	Aluminium Alloy (Black Anodised)
# WGE44-100.0-IN	100 : 1	4.750 <i>0.187</i>	6.342 <i>0.250</i>	1.47	0.0012	Phosphor Bronze	6-32 x 4.76mm deep	Precision Ball / Self Lubricating Bronze	Carbon Steel / Mild Steel	Aluminium Alloy (Black Anodised)

Indicates item not stocked at time of printing - Please enquire for lead time

E&OE Pricing and all details subject to change without notice - Copyright Miniature Bearings Australia Pty Ltd

MBA Size Listings are a guide to sizes only and must not be solely relied on for critical design information.



DISTRIBUTED BY

Ask us to put your name and address here

<http://www.minibearings.com.au/product>

Ph +61 7 3245 7977

Fax +61 7 3245 1017

Catalogue requests to catalogues@minibearings.com.au
