

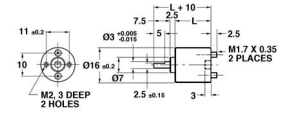

# MBA

## Gearheads - Inline - 16 mm x Various Lengths



16mm Diameter - Suits 1.5mm Motor Shaft.

Input and Output shafts have same centre line.

Input and output in same direction.

Requires 0.15 Module pinion as shown in tables.

Suits 1.5mm Motor Shaft.

### Gearheads - Inline - 16 mm x Various Lengths

Part Number	Ratio	Length mm	Efficiency %	Max Torque - Continuous N.mm (oz.in)	Max Torque - Momentary N.mm (oz.in)	Matching Input Pinion Gear	Shaft Style
# GHR16-10.24	10.24 : 1	14.75 <i>0.581</i>	66	9.8 (1.4)	29 (4.1)	GS0.15-15- 0320B0150-BR-N	With Flat
# GHR16-10.91	10.91 : 1	17.75 <i>0.699</i>	73	12.8 (1.81)		GS0.20-12- 0170B0150-BR-N	With Flat
# GHR16-19.22	19.22 : 1	17.75 <i>0.699</i>	73	12.8 (1.81)		GS0.15-15- 0170B0150-BR-N	With Flat

# Indicates item not stocked at time of printing - Please enquire for lead time

E&OE Pricing and all details subject to change without notice - Copyright Miniature Bearings Australia Pty Ltd

MBA Size Listings are a guide to sizes only and must not be solely relied on for critical design information.

## Gearheads - Inline - 16 mm x Various Lengths

Part Number	Ratio	Length mm <i>inches</i>	Efficiency %	Max Torque - Continuous N.mm (oz.in)	Max Torque - Momentary N.mm (oz.in)	Matching Input Pinion Gear	Shaft Style
# GHR16-19.36	19.36 : 1	14.75 <i>0.581</i>	66	9.8 (1.4)	29 (4.1)	GS0.15-15- 0320B0150-BR-N	With Flat
# GHR16-29.90	29.90 : 1	14.75 <i>0.581</i>	66	20 (2.8)	59 (8.4)	GS0.15-15- 0320B0150-BR-N	With Flat
# GHR16-31.06	31.06 : 1	17.75 <i>0.699</i>	66	29.4 (4.16)		GS0.20-12- 0170B0150-BR-N	With Flat
# GHR16-40.14	40.14 : 1	17.75 <i>0.699</i>	66	34.3 (4.86)		GS0.20-12- 0170B0150-BR-N	With Flat
# GHR16-41.53	41.53 : 1	14.75 <i>0.581</i>	66	20 (2.8)	59 (8.4)	GS0.15-15- 0320B0150-BR-N	With Flat
# GHR16-50.32	50.32 : 1	14.75 <i>0.581</i>	66	29 (4.1)	88 (12.5)	GS0.15-15- 0320B0150-BR-N	With Flat
# GHR16-54.58	54.58 : 1	17.75 <i>0.699</i>	66	34.3 (4.86)		GS0.20-12- 0170B0150-BR-N	With Flat
# GHR16-62.37	62.37 : 1	17.75 <i>0.699</i>	66	34.3 (4.86)		GS0.15-15- 0170B0150-BR-N	With Flat

# Indicates item not stocked at time of printing - Please enquire for lead time

E&OE Pricing and all details subject to change without notice - Copyright Miniature Bearings Australia Pty Ltd

MBA Size Listings are a guide to sizes only and must not be solely relied on for critical design information.

## Gearheads - Inline - 16 mm x Various Lengths

Part Number	Ratio	Length mm <i>inches</i>	Efficiency %	Max Torque - Continuous N.mm (oz.in)	Max Torque - Momentary N.mm (oz.in)	Matching Input Pinion Gear	Shaft Style
# GHR16-62.66	62.66 : 1	14.75 <i>0.581</i>	66	29 (4.1)	88 (12.5)	GS0.15-15- 0320B0150-BR-N	With Flat
# GHR16-97.37	97.37 : 1	17.75 <i>0.699</i>	59	49.1 (6.96)		GS0.15-15- 0170B0150-BR-N	With Flat
# GHR16-102.59	102.59 : 1	17.05 <i>0.671</i>	53	49 (6.9)	147 (20.8)	GS0.15-15- 0320B0150-BR-N	With Flat
# GHR16-150.11	150.11 : 1	17.75 <i>0.699</i>	59	58.9 (8.34)		GS0.15-15- 0170B0150-BR-N	With Flat
# GHR16-156.52	156.52 : 1	17.05 <i>0.671</i>	53	49 (6.9)	147 (20.8)	GS0.15-15- 0320B0150-BR-N	With Flat
# GHR16-206.45	206.45 : 1	17.75 <i>0.699</i>	53	58.9 (8.34)		GS0.20-12- 0170B0150-BR-N	With Flat
# GHR16-208.03	208.03 : 1	17.05 <i>0.671</i>	53	49 (6.9)	147 (20.8)	GS0.15-15- 0320B0150-BR-N	With Flat
# GHR16-257.57	257.57 : 1	17.05 <i>0.671</i>	53	49 (6.9)	147 (20.8)	GS0.15-15- 0320B0150-BR-N	With Flat

# Indicates item not stocked at time of printing - Please enquire for lead time

E&OE Pricing and all details subject to change without notice - Copyright Miniature Bearings Australia Pty Ltd

MBA Size Listings are a guide to sizes only and must not be solely relied on for critical design information.

## Gearheads - Inline - 16 mm x Various Lengths

Part Number	Ratio	Length mm <i>inches</i>	Efficiency %	Max Torque - Continuous N.mm (oz.in)	Max Torque - Momentary N.mm (oz.in)	Matching Input Pinion Gear	Shaft Style
# GHR16-258.78	258.78 : 1	17.75 <i>0.699</i>	53	58.9 (8.34)		GS0.20-12- 0170B0150-BR-N	With Flat
# GHR16-365.94	365.94 : 1	17.05 <i>0.671</i>	53	49 (6.9)	147 (20.8)	GS0.15-15- 0320B0150-BR-N	With Flat
# GHR16-375.49	375.49 : 1	17.75 <i>0.699</i>	53	58.9 (8.34)		GS0.15-15- 0170B0150-BR-N	With Flat
# GHR16-534.96	534.96 : 1	17.75 <i>0.699</i>	53	58.9 (8.34)		GS0.15-15- 0170B0150-BR-N	With Flat
# GHR16-539.82	539.82 : 1	17.05 <i>0.671</i>	53	49 (6.9)	147 (20.8)	GS0.15-15- 0320B0150-BR-N	With Flat
# GHR16-781.62	781.62 : 1	17.75 <i>0.699</i>	48	58.9 (8.34)		GS0.15-15- 0170B0150-BR-N	With Flat
# GHR16-992.36	992.36 : 1	17.75 <i>0.699</i>	48	58.9 (8.34)		GS0.15-15- 0170B0150-BR-N	With Flat
# GHR16-1237.09	1237.09 : 1	17.75 <i>0.699</i>	48	58.9 (8.34)		GS0.20-12- 0170B0150-BR-N	With Flat

# Indicates item not stocked at time of printing - Please enquire for lead time

E&OE Pricing and all details subject to change without notice - Copyright Miniature Bearings Australia Pty Ltd

MBA Size Listings are a guide to sizes only and must not be solely relied on for critical design information.

## Gearheads - Inline - 16 mm x Various Lengths

Part Number	Ratio	Length mm	Efficiency %	Max Torque - Continuous N.mm (oz.in)	Max Torque - Momentary N.mm (oz.in)	Matching Input Pinion Gear	Shaft Style
# GHR16-1413.82	1413.82 : 1	17.75	48	58.9 (8.34)		GS0.15-15- 0170B0150-BR-N	With Flat
		<i>0.699</i>					

*inches*

*0.699*

# Indicates item not stocked at time of printing - Please enquire for lead time

E&OE Pricing and all details subject to change without notice - Copyright Miniature Bearings Australia Pty Ltd

MBA Size Listings are a guide to sizes only and must not be solely relied on for critical design information.



DISTRIBUTED BY

Ask us to put your name and address here

<http://www.minibearings.com.au/product>

Ph +61 7 3245 7977

Fax +61 7 3245 1017

Catalogue requests to [catalogues@minibearings.com.au](mailto:catalogues@minibearings.com.au)

