

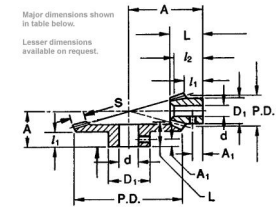

MBA

Gears - Bevel - Module 1



For 90 degree angle power transfer.

20 Degree Pressure Angle.

Do not mix gears from different sets.

See Gears - Mitre for 1:1 ratios.

Gears - Bevel - Module 1

Part Number	Ratio	Comment	Teeth No.	Material	Bore (d) mm	Pitch Diameter (PD) mm	Face Width (S) mm	Overall Width (L) mm	Hub Diameter (D1) mm	Mounting Distance (A) mm
					<i>inches</i>	<i>inches</i>	<i>inches</i>	<i>inches</i>	<i>inches</i>	<i>inches</i>
GB100-15-0500-0660-ACE	2 : 1 Set 1	Add matching gear to make a set	15	Acetal	5.000 / Plain Hub	15.00	6.60	17.00	12.20	26.40
						<i>0.591</i>	<i>0.260</i>	<i>0.669</i>	<i>0.480</i>	<i>1.039</i>
GB100-30-0800-ACE	2 : 1 Set 1	Add matching pinion to make a set	30	Acetal	8.000 / Plain Hub	30.00	6.60	16.20	18.00	20.90
						<i>1.181</i>	<i>0.260</i>	<i>0.638</i>	<i>0.709</i>	<i>0.823</i>

Indicates item not stocked at time of printing - Please enquire for lead time

E&OE Pricing and all details subject to change without notice - Copyright Miniature Bearings Australia Pty Ltd

MBA Size Listings are a guide to sizes only and must not be solely relied on for critical design information.

Gears - Bevel - Module 1

Part Number	Ratio	Comment	Teeth No.	Material	Bore (d) mm	Pitch Diameter (PD) mm	Face Width (S) mm	Overall Width (L) mm	Hub Diameter (D1) mm	Mounting Distance (A) mm
					<i>inches</i>	<i>inches</i>	<i>inches</i>	<i>inches</i>	<i>inches</i>	<i>inches</i>
GB100-40-0600-ACE	2 : 1 Set 2	Add matching pinion to make a set	40	Acetal	6.000	40.00	4.50	14.50	18.000	12.000
					<i>0.236</i>	<i>1.575</i>	<i>0.177</i>	<i>0.571</i>	<i>0.709</i>	<i>0.472</i>
GB100-20-0500-ACE	2 : 1 Set 2	Add matching gear to make a set	20	Acetal	5.000	20.00	4.50	14.50	15.000	14.500
					<i>0.197</i>	<i>0.787</i>	<i>0.177</i>	<i>0.571</i>	<i>0.591</i>	<i>0.571</i>
# GB100-20-0600-ST	2 : 1 Set 3	Add matching gear to make a set	20	Steel	6.000 / Plain Hub	20.00	5.70	15.00	16.00	29.60
						<i>0.787</i>	<i>0.224</i>	<i>0.591</i>	<i>0.630</i>	<i>1.165</i>
# GB100-40-0800-ST	2 : 1 Set 3	Add matching pinion to make a set	40	Steel	8.000 / Plain Hub	40.00	5.70	15.00	25.00	21.80
						<i>1.575</i>	<i>0.224</i>	<i>0.591</i>	<i>0.984</i>	<i>0.858</i>
# GB100-20-0800-ST	2 : 1 Set 4	Add matching gear to make a set	20	Steel	8.000 / Set Screw HUB	20.00	5.70	15.00	16.00	29.60
						<i>0.787</i>	<i>0.224</i>	<i>0.591</i>	<i>0.630</i>	<i>1.165</i>
# GB100-40-1000-ST	2 : 1 Set 4	Add matching pinion to make a set	40	Steel	10.000 / Set Screw HUB	40.00	5.70	15.00	25.00	21.80
						<i>1.575</i>	<i>0.224</i>	<i>0.591</i>	<i>0.984</i>	<i>0.858</i>
# GB100-15-0500-0920-ACE	3 : 1 Set 1	Add matching gear to make a set	15	Acetal	5.000 / Plain Hub	15.00	9.20	20.40	12.30	34.30
						<i>0.591</i>	<i>0.362</i>	<i>0.803</i>	<i>0.484</i>	<i>1.350</i>

Indicates item not stocked at time of printing - Please enquire for lead time

E&OE Pricing and all details subject to change without notice - Copyright Miniature Bearings Australia Pty Ltd

MBA Size Listings are a guide to sizes only and must not be solely relied on for critical design information.

Gears - Bevel - Module 1

Part Number	Ratio	Comment	Teeth No.	Material	Bore (d) mm	Pitch Diameter (PD) mm	Face Width (S) mm	Overall Width (L) mm	Hub Diameter (D1) mm	Mounting Distance (A) mm
					<i>inches</i>	<i>inches</i>	<i>inches</i>	<i>inches</i>	<i>inches</i>	<i>inches</i>
GB100-15-0400-ACE	3 : 1 Set 1	Add matching gear to make a set	15	Acetal	4.000 / Plain Hub	15.00	9.20	20.40	12.30	34.30
						<i>0.591</i>	<i>0.362</i>	<i>0.803</i>	<i>0.484</i>	<i>1.350</i>
GB100-45-1000-ACE	3 : 1 Set 1	Add matching pinion to make a set	45	Acetal	10.000 / Plain Hub	45.00	9.20	18.20	23.40	22.70
						<i>1.772</i>	<i>0.362</i>	<i>0.717</i>	<i>0.921</i>	<i>0.894</i>
# GB100-45-1200-ACE	3 : 1 Set 1	Add matching pinion to make a set	45	Acetal	12.000 / Plain Hub	45.00	9.20	18.20	23.40	22.70
						<i>1.772</i>	<i>0.362</i>	<i>0.717</i>	<i>0.921</i>	<i>0.894</i>
GB100-15-0600-ST	3 : 1 Set 2	Add matching gear to make a set	15	Steel	6.000 / Plain Hub	15.00	6.70	15.20	13.00	31.00
						<i>0.591</i>	<i>0.264</i>	<i>0.598</i>	<i>0.512</i>	<i>1.220</i>
GB100-45-1000-ST	3 : 1 Set 2	Add matching pinion to make a set	45	Steel	10.000 / Plain Hub	45.00	6.70	15.00	25.00	20.00
						<i>1.772</i>	<i>0.264</i>	<i>0.591</i>	<i>0.984</i>	<i>0.787</i>
GB100-10-0400-ACE	4 : 1 Set 1	Add matching gear to make a set	10	Acetal	4.000 / Plain Hub	10.00	8.20	17.70	7.80	30.10
						<i>0.394</i>	<i>0.323</i>	<i>0.697</i>	<i>0.307</i>	<i>1.185</i>
GB100-40-1000-ACE	4 : 1 Set 1	Add matching pinion to make a set	40	Acetal	10.000 / Plain Hub	40.00	8.20	17.00	23.40	20.10
						<i>1.575</i>	<i>0.323</i>	<i>0.669</i>	<i>0.921</i>	<i>0.791</i>

Indicates item not stocked at time of printing - Please enquire for lead time

E&OE Pricing and all details subject to change without notice - Copyright Miniature Bearings Australia Pty Ltd

MBA Size Listings are a guide to sizes only and must not be solely relied on for critical design information.

Gears - Bevel - Module 1

Part Number	Ratio	Comment	Teeth No.	Material	Bore (d) mm	Pitch Diameter (PD) mm	Face Width (S) mm	Overall Width (L) mm	Hub Diameter (D1) mm	Mounting Distance (A) mm
					<i>inches</i>	<i>inches</i>	<i>inches</i>	<i>inches</i>	<i>inches</i>	<i>inches</i>
GB100-12-0400-ACE	5 : 1 Set 1	Add matching gear to make a set	12	Acetal	4.000 / Plain Hub	12.00	9.50	20.30	23.40	40.50
						<i>0.472</i>	<i>0.374</i>	<i>0.799</i>	<i>0.921</i>	<i>1.594</i>
GB100-60-1000-ACE	5 : 1 Set 1	Add matching pinion to make a set	60	Acetal	10.000 / Plain Hub	60.00	9.50	17.40	20.50	21.00
						<i>2.362</i>	<i>0.374</i>	<i>0.685</i>	<i>0.807</i>	<i>0.827</i>

Indicates item not stocked at time of printing - Please enquire for lead time

E&OE Pricing and all details subject to change without notice - Copyright Miniature Bearings Australia Pty Ltd

MBA Size Listings are a guide to sizes only and must not be solely relied on for critical design information.



DISTRIBUTED BY

Ask us to put your name and address here

<http://www.minibearings.com.au/product>

Ph +61 7 3245 7977

Fax +61 7 3245 1017

Catalogue requests to catalogues@minibearings.com.au
