

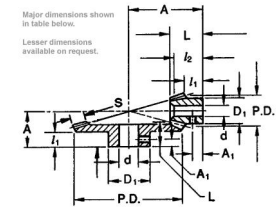

MBA

Gears - Bevel - Module 2.5



For 90 degree angle power transfer.

20 Degree Pressure Angle.

Do not mix gears from different sets.

See Gears - Mitre for 1:1 ratios.

Gears - Bevel - Module 2.5

Part Number	Ratio	Comment	Teeth No.	Material	Bore (d) mm	Pitch Diameter (PD) mm	Face Width (S) mm	Overall Width (L) mm	Hub Diameter (D1) mm	Mounting Distance (A) mm
					<i>inches</i>	<i>inches</i>	<i>inches</i>	<i>inches</i>	<i>inches</i>	<i>inches</i>
# GB250-15-1200-ACE	2 : 1 Set 1	Add matching gear to make a set	15	Acetal	12.000 / Plain Hub	37.50	17.30	31.20	26.50	53.30
						<i>1.476</i>	<i>0.681</i>	<i>1.228</i>	<i>1.043</i>	<i>2.098</i>
# GB250-30-1600-ACE	2 : 1 Set 1	Add matching pinion to make a set	30	Acetal	16.000 / Plain Hub	75.00	17.30	29.50	36.10	40.50
						<i>2.953</i>	<i>0.681</i>	<i>1.161</i>	<i>1.421</i>	<i>1.594</i>

Indicates item not stocked at time of printing - Please enquire for lead time

E&OE Pricing and all details subject to change without notice - Copyright Miniature Bearings Australia Pty Ltd

MBA Size Listings are a guide to sizes only and must not be solely relied on for critical design information.

Gears - Bevel - Module 2.5

Part Number	Ratio	Comment	Teeth No.	Material	Bore (d) mm	Pitch Diameter (PD) mm	Face Width (S) mm	Overall Width (L) mm	Hub Diameter (D1) mm	Mounting Distance (A) mm
					<i>inches</i>	<i>inches</i>	<i>inches</i>	<i>inches</i>	<i>inches</i>	<i>inches</i>
# GB250-30-1400-ACE	2 : 1 Set 1	Add matching pinion to make a set	30	Acetal	14.000 / Plain Hub	75.00	17.30	29.50	36.10	40.50
						<i>2.953</i>	<i>0.681</i>	<i>1.161</i>	<i>1.421</i>	<i>1.594</i>
# GB250-18-1200-ST	2 : 1 Set 2	Add matching gear to make a set	18	Steel	12.000 / Plain Hub	45.00	16.70	35.00	36.00	64.29
						<i>1.772</i>	<i>0.657</i>	<i>1.378</i>	<i>1.417</i>	<i>2.531</i>
# GB250-36-1400-ST	2 : 1 Set 2	Add matching pinion to make a set	36	Steel	14.000 / Plain Hub	90.00	16.70	29.00	50.00	42.55
						<i>3.543</i>	<i>0.657</i>	<i>1.142</i>	<i>1.969</i>	<i>1.675</i>
# GB250-18-1400-ST	2 : 1 Set 3	Add matching gear to make a set	18	Steel	14.000 / Keyway Hub	45.00	16.70	35.00		64.29
						<i>1.772</i>	<i>0.657</i>	<i>1.378</i>		<i>2.531</i>
# GB250-36-2200-ST	2 : 1 Set 3	Add matching pinion to make a set	36	Steel	22.000 / Keyway Hub	90.00	16.70	29.00		42.55
						<i>3.543</i>	<i>0.657</i>	<i>1.142</i>		<i>1.675</i>
GB250-10-0800-ACE	3 : 1 Set 1	Add matching gear to make a set	10	Acetal	8.000 / Plain Hub	25.00	15.70	28.80	18.80	52.40
						<i>0.984</i>	<i>0.618</i>	<i>1.134</i>	<i>0.740</i>	<i>2.063</i>
GB250-30-1800-ACE	3 : 1 Set 1	Add matching pinion to make a set	30	Acetal	18.000 / Plain Hub	75.00	15.70	29.00	36.10	35.70
						<i>2.953</i>	<i>0.618</i>	<i>1.142</i>	<i>1.421</i>	<i>1.406</i>

Indicates item not stocked at time of printing - Please enquire for lead time

E&OE Pricing and all details subject to change without notice - Copyright Miniature Bearings Australia Pty Ltd

MBA Size Listings are a guide to sizes only and must not be solely relied on for critical design information.

Gears - Bevel - Module 2.5

Part Number	Ratio	Comment	Teeth No.	Material	Bore (d) mm	Pitch Diameter (PD) mm	Face Width (S) mm	Overall Width (L) mm	Hub Diameter (D1) mm	Mounting Distance (A) mm
					<i>inches</i>	<i>inches</i>	<i>inches</i>	<i>inches</i>	<i>inches</i>	<i>inches</i>
# GB250-15-1000-ST	3 : 1 Set 2	Add matching gear to make a set	15	Steel	10.000 / Plain Hub	37.50	19.00	40.40	32.00	77.93
						<i>1.476</i>	<i>0.748</i>	<i>1.591</i>	<i>1.260</i>	<i>3.068</i>
# GB250-45-1600-ST	3 : 1 Set 2	Add matching pinion to make a set	45	Steel	16.000 / Plain Hub	112.50	19.00	28.70	60.00	40.67
						<i>4.429</i>	<i>0.748</i>	<i>1.130</i>	<i>2.362</i>	<i>1.601</i>
# GB250-15-1400-ST	3 : 1 Set 3	Add matching gear to make a set	15	Steel	14.000 / Keyway Hub	37.50	19.00	40.40		77.93
						<i>1.476</i>	<i>0.748</i>	<i>1.591</i>		<i>3.068</i>
# GB250-45-2200-ST	3 : 1 Set 3	Add matching pinion to make a set	45	Steel	22.000 / Keyway Hub	112.50	19.00	28.70		40.67
						<i>4.429</i>	<i>0.748</i>	<i>1.130</i>		<i>1.601</i>

Indicates item not stocked at time of printing - Please enquire for lead time

E&OE Pricing and all details subject to change without notice - Copyright Miniature Bearings Australia Pty Ltd

MBA Size Listings are a guide to sizes only and must not be solely relied on for critical design information.



DISTRIBUTED BY

Ask us to put your name and address here

<http://www.minibearings.com.au/product>

Ph +61 7 3245 7977

Fax +61 7 3245 1017

Catalogue requests to catalogues@minibearings.com.au

