

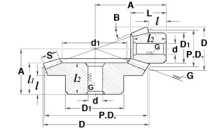

MBA

Gears - Bevel - Spiral - Module 2.5



For 90 degree angle power transfer.

See Gears - Mitre for 1:1 ratios.

ISO Class 6.

35 Degree Spiral Angle / 20 Degree Pressure Angle.

AISI 1045 Steel, Tooth surfaces induction hardened to HRC48.53.

Black oxide finish except bore and tooth surfaces.

Gears - Bevel - Spiral - Module 2.5

Part Number	Ratio	Comment	Teeth No.	Material	Bore mm	Pitch Diameter mm	Face Width mm	Overall Width mm	Hub Diameter mm	Mounting Distance mm
					<i>inches</i>	<i>inches</i>	<i>inches</i>	<i>inches</i>	<i>inches</i>	<i>inches</i>
# GBS250-20-1200-2000-ST	2 : 1 Set 1	Add matching gear to make a set	20	Steel	12.000	50.00	20.00	43.61	40.000	75.000
					<i>0.472</i>	<i>1.969</i>	<i>0.787</i>	<i>1.717</i>	<i>1.575</i>	<i>2.953</i>
# GBS250-40-1500-ST	2 : 1 Set 1	Add matching pinion to make a set	40	Steel	15.000	100.00	20.00	39.65	50.000	55.000
					<i>0.591</i>	<i>3.937</i>	<i>0.787</i>	<i>1.561</i>	<i>1.969</i>	<i>2.165</i>

Indicates item not stocked at time of printing - Please enquire for lead time

E&OE Pricing and all details subject to change without notice - Copyright Miniature Bearings Australia Pty Ltd

MBA Size Listings are a guide to sizes only and must not be solely relied on for critical design information.

Gears - Bevel - Spiral - Module 2.5

Part Number	Ratio	Comment	Teeth No.	Material	Bore mm	Pitch Diameter mm	Face Width mm	Overall Width mm	Hub Diameter mm	Mounting Distance mm
					<i>inches</i>	<i>inches</i>	<i>inches</i>	<i>inches</i>	<i>inches</i>	<i>inches</i>
# GBS250-17-1200-ST	2 : 1 Set 2	Add matching gear to make a set	17	Steel	12.000	44.20	13.50	32.00		64.290
					<i>0.472</i>	<i>1.740</i>	<i>0.531</i>	<i>1.260</i>		<i>2.531</i>
# GBS250-34-1400-ST	2 : 1 Set 2	Add matching pinion to make a set	34	Steel	14.000	88.40	13.50	27.00		42.550
					<i>0.551</i>	<i>3.480</i>	<i>0.531</i>	<i>1.063</i>		<i>1.675</i>
# GBS250-14-1000-ST	3 : 1 Set 1	Add matching gear to make a set	14	Steel	10.000	36.40	16.00	38.50		77.930
					<i>0.394</i>	<i>1.433</i>	<i>0.630</i>	<i>1.516</i>		<i>3.068</i>
# GBS250-42-1600-ST	3 : 1 Set 1	Add matching pinion to make a set	42	Steel	16.000	109.20	16.00	28.50		40.670
					<i>0.630</i>	<i>4.299</i>	<i>0.630</i>	<i>1.122</i>		<i>1.601</i>
# GBS250-15-1500-ST	3 : 1 Set 2	Add matching gear to make a set	15	Steel	15.000	37.50	20.00	38.27	30.000	75.000
					<i>0.591</i>	<i>1.476</i>	<i>0.787</i>	<i>1.507</i>	<i>1.181</i>	<i>2.953</i>
# GBS250-45-1500-ST	3 : 1 Set 2	Add matching pinion to make a set	45	Steel	15.000	112.50	20.00	38.25	50.000	50.000
					<i>0.591</i>	<i>4.429</i>	<i>0.787</i>	<i>1.506</i>	<i>1.969</i>	<i>1.969</i>
# GBS250-20-1200-1500-ST	3 : 2 Set 1	Add matching gear to make a set	20	Steel	12.000	50.00	15.00	30.88	40.000	55.000
					<i>0.472</i>	<i>1.969</i>	<i>0.591</i>	<i>1.216</i>	<i>1.575</i>	<i>2.165</i>

Indicates item not stocked at time of printing - Please enquire for lead time

E&OE Pricing and all details subject to change without notice - Copyright Miniature Bearings Australia Pty Ltd

MBA Size Listings are a guide to sizes only and must not be solely relied on for critical design information.

Gears - Bevel - Spiral - Module 2.5

Part Number	Ratio	Comment	Teeth No.	Material	Bore mm	Pitch Diameter mm	Face Width mm	Overall Width mm	Hub Diameter mm	Mounting Distance mm
					<i>inches</i>	<i>inches</i>	<i>inches</i>	<i>inches</i>	<i>inches</i>	<i>inches</i>
# GBS250-30-1500-ST	3 : 2 Set 1	Add matching pinion to make a set	30	Steel	15.000	75.00	15.00	33.86	45.000	50.000
					<i>0.591</i>	<i>2.953</i>	<i>0.591</i>	<i>1.333</i>	<i>1.772</i>	<i>1.969</i>

Indicates item not stocked at time of printing - Please enquire for lead time

E&OE Pricing and all details subject to change without notice - Copyright Miniature Bearings Australia Pty Ltd

MBA Size Listings are a guide to sizes only and must not be solely relied on for critical design information.



DISTRIBUTED BY

Ask us to put your name and address here

<http://www.minibearings.com.au/product>

Ph +61 7 3245 7977

Fax +61 7 3245 1017

Catalogue requests to catalogues@minibearings.com.au

