

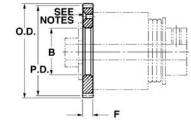

MBA

Gears - Spur - 48 Pitch - Slip Clutch Flange Mounting



For mounting to flanges of slip clutches. 2024 aluminium and 303 stainless steel.

Metallic.

Gears - Spur - 48 Pitch - Slip Clutch Flange Mounting

Part Number	Teeth (No.)	Pitch Circle Diameter (PD) mm <i>inches</i>	Bore (d) (+0.013 / - 0.000) mm <i>inches</i>	Outside Diameter (OD) mm <i>inches</i>	Face Width mm <i>inches</i>	Mtg. Holes (No. / Circle Dia.)	Mtg Holes (Type / Size)	Suits Slip Clutch Series	Pressure Angle Deg.	Material / Quality
# GS48-095-0305FM1981-A2	95	50.27 <i>1.979</i>	12.680 <i>0.499</i>	51.333 <i>2.021</i>	3.048 <i>0.120</i>	3 / 19.812	CSK / Clearance for 4-40 Screw	CSSW-16.00-	20	2024 Aluminum Alloy / AGMA 10
# GS48-095-0305FM1981-3	95	50.27 <i>1.979</i>	12.680 <i>0.499</i>	51.333 <i>2.021</i>	3.048 <i>0.120</i>	3 / 19.812	CSK / Clearance for 4-40 Screw	CSSW-16.00-	20	303 Stainless Steel / AGMA 10

Indicates item not stocked at time of printing - Please enquire for lead time

E&OE Pricing and all details subject to change without notice - Copyright Miniature Bearings Australia Pty Ltd

MBA Size Listings are a guide to sizes only and must not be solely relied on for critical design information.

Gears - Spur - 48 Pitch - Slip Clutch Flange Mounting

Part Number	Teeth (No.)	Pitch Circle Diameter (PD) mm <i>inches</i>	Bore (d) (+0.013 / - 0.000) mm <i>inches</i>	Outside Diameter (OD) mm <i>inches</i>	Face Width mm <i>inches</i>	Mtg. Holes (No. / Circle Dia.)	Mtg Holes (Type / Size)	Suits Slip Clutch Series	Pressure Angle Deg.	Material / Quality
# GS48-100-0305FM1981-A2	100	52.92 <i>2.083</i>	12.680 <i>0.499</i>	53.975 <i>2.125</i>	3.048 <i>0.120</i>	3 / 19.812	CSK / Clearance for 4-40 Screw	CSSW-16.00-	20	2024 Aluminum Alloy / AGMA 10
# GS48-100-0305FM1981-3	100	52.92 <i>2.083</i>	12.680 <i>0.499</i>	53.975 <i>2.125</i>	3.048 <i>0.120</i>	3 / 19.812	CSK / Clearance for 4-40 Screw	CSSW-16.00-	20	303 Stainless Steel / AGMA 10
# GS48-105-0305FM1981-A2	105	55.56 <i>2.187</i>	12.680 <i>0.499</i>	56.617 <i>2.229</i>	3.048 <i>0.120</i>	3 / 19.812	CSK / Clearance for 4-40 Screw	CSSW-16.00-	20	2024 Aluminum Alloy / AGMA 10
# GS48-105-0305FM1981-3	105	55.56 <i>2.187</i>	12.680 <i>0.499</i>	56.617 <i>2.229</i>	3.048 <i>0.120</i>	3 / 19.812	CSK / Clearance for 4-40 Screw	CSSW-16.00-	20	303 Stainless Steel / AGMA 10
# GS48-110-0305FM1981-A2	110	58.21 <i>2.292</i>	12.680 <i>0.499</i>	59.258 <i>2.333</i>	3.048 <i>0.120</i>	3 / 19.812	CSK / Clearance for 4-40 Screw	CSSW-16.00-	20	2024 Aluminum Alloy / AGMA 10
# GS48-110-0305FM1981-3	110	58.21 <i>2.292</i>	12.680 <i>0.499</i>	59.258 <i>2.333</i>	3.048 <i>0.120</i>	3 / 19.812	CSK / Clearance for 4-40 Screw	CSSW-16.00-	20	303 Stainless Steel / AGMA 10

Indicates item not stocked at time of printing - Please enquire for lead time

E&OE Pricing and all details subject to change without notice - Copyright Miniature Bearings Australia Pty Ltd

MBA Size Listings are a guide to sizes only and must not be solely relied on for critical design information.

Gears - Spur - 48 Pitch - Slip Clutch Flange Mounting

Part Number	Teeth (No.)	Pitch Circle Diameter (PD) mm <i>inches</i>	Bore (d) (+0.013 / - 0.000) mm <i>inches</i>	Outside Diameter (OD) mm <i>inches</i>	Face Width mm <i>inches</i>	Mtg. Holes (No. / Circle Dia.)	Mtg Holes (Type / Size)	Suits Slip Clutch Series	Pressure Angle Deg.	Material / Quality
# GS48-120-0305FM1981-A2	120	63.50 <i>2.500</i>	12.680 <i>0.499</i>	64.567 <i>2.542</i>	3.048 <i>0.120</i>	3 / 19.812	CSK / Clearance for 4-40 Screw	CSSW-16.00-	20	2024 Aluminum Alloy / AGMA 10
# GS48-120-0305FM1981-3	120	63.50 <i>2.500</i>	12.680 <i>0.499</i>	64.567 <i>2.542</i>	3.048 <i>0.120</i>	3 / 19.812	CSK / Clearance for 4-40 Screw	CSSW-16.00-	20	303 Stainless Steel / AGMA 10
# GS48-130-0305FM1981-A2	130	68.79 <i>2.708</i>	12.680 <i>0.499</i>	69.850 <i>2.750</i>	3.048 <i>0.120</i>	3 / 19.812	CSK / Clearance for 4-40 Screw	CSSW-16.00-	20	2024 Aluminum Alloy / AGMA 10
# GS48-130-0305FM1981-3	130	68.79 <i>2.708</i>	12.680 <i>0.499</i>	69.850 <i>2.750</i>	3.048 <i>0.120</i>	3 / 19.812	CSK / Clearance for 4-40 Screw	CSSW-16.00-	20	303 Stainless Steel / AGMA 10

Indicates item not stocked at time of printing - Please enquire for lead time

E&OE Pricing and all details subject to change without notice - Copyright Miniature Bearings Australia Pty Ltd

MBA Size Listings are a guide to sizes only and must not be solely relied on for critical design information.



DISTRIBUTED BY

Ask us to put your name and address here

<http://www.minibearings.com.au/product>

Ph +61 7 3245 7977

Fax +61 7 3245 1017

Catalogue requests to catalogues@minibearings.com.au

