

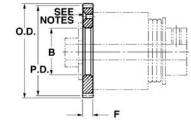

MBA

Gears - Spur - 64 Pitch - Slip Clutch Flange Mounting



For mounting to flanges of slip clutches. 2024 aluminium and 303 stainless steel.

Metallic.

Gears - Spur - 64 Pitch - Slip Clutch Flange Mounting

Part Number	Teeth (No.)	Pitch Circle Diameter (PD) mm <i>inches</i>	Bore (d) (+0.013 / - 0.000) mm <i>inches</i>	Outside Diameter (OD) mm <i>inches</i>	Face Width mm <i>inches</i>	Mtg. Holes (No. / Circle Dia.)	Mtg Holes (Type / Size)	Suits Slip Clutch Series	Pressure Angle Deg.	Material / Quality
# GS64-045-0191FM1270-A2	45	17.86 <i>0.703</i>	9.505 <i>0.374</i>	18.644 <i>0.734</i>	1.905 <i>0.075</i>	3 / 12.70	CSK / Clearance for 0-80 Screw	CSSW-09.65-	20	2024 Aluminum Alloy / AGMA 10
# GS64-045-0191FM1270-3	45	17.86 <i>0.703</i>	9.505 <i>0.374</i>	18.644 <i>0.734</i>	1.905 <i>0.075</i>	3 / 12.70	CSK / Clearance for 0-80 Screw	CSSW-09.65-	20	303 Stainless Steel / AGMA 10
# GS64-050-0191FM1270-3	50	19.85 <i>0.781</i>	9.505 <i>0.374</i>	20.650 <i>0.813</i>	1.905 <i>0.075</i>	3 / 12.70	CSK / Clearance for 0-80 Screw	CSSW-09.65-	20	303 Stainless Steel / AGMA 10

Indicates item not stocked at time of printing - Please enquire for lead time

E&OE Pricing and all details subject to change without notice - Copyright Miniature Bearings Australia Pty Ltd

MBA Size Listings are a guide to sizes only and must not be solely relied on for critical design information.

Gears - Spur - 64 Pitch - Slip Clutch Flange Mounting

Part Number	Teeth (No.)	Pitch Circle Diameter (PD) mm <i>inches</i>	Bore (d) (+0.013 / - 0.000) mm <i>inches</i>	Outside Diameter (OD) mm <i>inches</i>	Face Width mm <i>inches</i>	Mtg. Holes (No. / Circle Dia.)	Mtg Holes (Type / Size)	Suits Slip Clutch Series	Pressure Angle Deg.	Material / Quality
# GS64-050-0191FM1270-A2	50	19.85 <i>0.781</i>	9.505 <i>0.374</i>	20.650 <i>0.813</i>	1.905 <i>0.075</i>	3 / 12.70	CSK / Clearance for 0-80 Screw	CSSW-09.65-	20	2024 Aluminum Alloy / AGMA 10
# GS64-055-0191FM1270-3	55	21.83 <i>0.859</i>	9.505 <i>0.374</i>	22.631 <i>0.891</i>	1.905 <i>0.075</i>	3 / 12.70	CSK / Clearance for 0-80 Screw	CSSW-09.65-	20	303 Stainless Steel / AGMA 10
# GS64-055-0191FM1270-A2	55	21.83 <i>0.859</i>	9.505 <i>0.374</i>	22.631 <i>0.891</i>	1.905 <i>0.075</i>	3 / 12.70	CSK / Clearance for 0-80 Screw	CSSW-09.65-	20	2024 Aluminum Alloy / AGMA 10
# GS64-060-0191FM1270-3	60	23.81 <i>0.937</i>	9.505 <i>0.374</i>	24.613 <i>0.969</i>	1.905 <i>0.075</i>	3 / 12.70	CSK / Clearance for 0-80 Screw	CSSW-09.65-	20	303 Stainless Steel / AGMA 10
# GS64-060-0191FM1270-A2	60	23.81 <i>0.937</i>	9.505 <i>0.374</i>	24.613 <i>0.969</i>	1.905 <i>0.075</i>	3 / 12.70	CSK / Clearance for 0-80 Screw	CSSW-09.65-	20	2024 Aluminum Alloy / AGMA 10
# GS64-064-0191FM1270-3	64	25.40 <i>1.000</i>	9.505 <i>0.374</i>	26.187 <i>1.031</i>	1.905 <i>0.075</i>	3 / 12.70	CSK / Clearance for 0-80 Screw	CSSW-09.65-	20	303 Stainless Steel / AGMA 10

Indicates item not stocked at time of printing - Please enquire for lead time

E&OE Pricing and all details subject to change without notice - Copyright Miniature Bearings Australia Pty Ltd

MBA Size Listings are a guide to sizes only and must not be solely relied on for critical design information.

Gears - Spur - 64 Pitch - Slip Clutch Flange Mounting

Part Number	Teeth (No.)	Pitch Circle Diameter (PD) mm <i>inches</i>	Bore (d) (+0.013 / - 0.000) mm <i>inches</i>	Outside Diameter (OD) mm <i>inches</i>	Face Width mm <i>inches</i>	Mtg. Holes (No. / Circle Dia.)	Mtg Holes (Type / Size)	Suits Slip Clutch Series	Pressure Angle Deg.	Material / Quality
# GS64-064-0191FM1270-A2	64	25.40 <i>1.000</i>	9.505 <i>0.374</i>	26.187 <i>1.031</i>	1.905 <i>0.075</i>	3 / 12.70	CSK / Clearance for 0-80 Screw	CSSW-09.65-	20	2024 Aluminum Alloy / AGMA 10
# GS64-065-0191FM1270-A2	65	25.80 <i>1.016</i>	9.505 <i>0.374</i>	26.594 <i>1.047</i>	1.905 <i>0.075</i>	3 / 12.70	CSK / Clearance for 0-80 Screw	CSSW-09.65-	20	2024 Aluminum Alloy / AGMA 10
# GS64-065-0191FM1270-3	65	25.80 <i>1.016</i>	9.505 <i>0.374</i>	26.594 <i>1.047</i>	1.905 <i>0.075</i>	3 / 12.70	CSK / Clearance for 0-80 Screw	CSSW-09.65-	20	303 Stainless Steel / AGMA 10
# GS64-070-0229FM1651-3	70	27.78 <i>1.094</i>	12.680 <i>0.499</i>	28.575 <i>1.125</i>	2.286 <i>0.090</i>	3 / 16.51	CSK / Clearance for 1-72 Screw	CSSW-12.70-	20	303 Stainless Steel / AGMA 10
# GS64-070-0229FM1651-A2	70	27.78 <i>1.094</i>	12.680 <i>0.499</i>	28.575 <i>1.125</i>	2.286 <i>0.090</i>	3 / 16.51	CSK / Clearance for 1-72 Screw	CSSW-12.70-	20	2024 Aluminum Alloy / AGMA 10
# GS64-075-0229FM1651-3	75	29.77 <i>1.172</i>	12.680 <i>0.499</i>	30.556 <i>1.203</i>	2.286 <i>0.090</i>	3 / 16.51	CSK / Clearance for 1-72 Screw	CSSW-12.70-	20	303 Stainless Steel / AGMA 10

Indicates item not stocked at time of printing - Please enquire for lead time

E&OE Pricing and all details subject to change without notice - Copyright Miniature Bearings Australia Pty Ltd

MBA Size Listings are a guide to sizes only and must not be solely relied on for critical design information.

Gears - Spur - 64 Pitch - Slip Clutch Flange Mounting

Part Number	Teeth (No.)	Pitch Circle Diameter (PD) mm <i>inches</i>	Bore (d) (+0.013 / - 0.000) mm <i>inches</i>	Outside Diameter (OD) mm <i>inches</i>	Face Width mm <i>inches</i>	Mtg. Holes (No. / Circle Dia.)	Mtg Holes (Type / Size)	Suits Slip Clutch Series	Pressure Angle Deg.	Material / Quality
# GS64-075-0229FM1651-A2	75	29.77 <i>1.172</i>	12.680 <i>0.499</i>	30.556 <i>1.203</i>	2.286 <i>0.090</i>	3 / 16.51	CSK / Clearance for 1-72 Screw	CSSW-12.70-	20	2024 Aluminum Alloy / AGMA 10
# GS64-080-0229FM1651-3	80	31.75 <i>1.250</i>	12.680 <i>0.499</i>	32.537 <i>1.281</i>	2.286 <i>0.090</i>	3 / 16.51	CSK / Clearance for 1-72 Screw	CSSW-12.70-	20	303 Stainless Steel / AGMA 10
# GS64-080-0229FM1651-A2	80	31.75 <i>1.250</i>	12.680 <i>0.499</i>	32.537 <i>1.281</i>	2.286 <i>0.090</i>	3 / 16.51	CSK / Clearance for 1-72 Screw	CSSW-12.70-	20	2024 Aluminum Alloy / AGMA 10
# GS64-085-0305FM2350-3	85	33.73 <i>1.328</i>	12.680 <i>0.499</i>	34.519 <i>1.359</i>	3.048 <i>0.120</i>	3 / 23.495	No CSK / Clearance for 2-56 Screw		20	303 Stainless Steel / AGMA 10
# GS64-085-0305FM2350-A2	85	33.73 <i>1.328</i>	12.680 <i>0.499</i>	34.519 <i>1.359</i>	3.048 <i>0.120</i>	3 / 23.495	No CSK / Clearance for 2-56 Screw		20	2024 Aluminum Alloy / AGMA 10
# GS64-090-0229FM1651-3	90	35.72 <i>1.406</i>	12.680 <i>0.499</i>	36.525 <i>1.438</i>	2.286 <i>0.090</i>	3 / 16.51	CSK / Clearance for 1-72 Screw	CSSW-12.70-	20	303 Stainless Steel / AGMA 10

Indicates item not stocked at time of printing - Please enquire for lead time

E&OE Pricing and all details subject to change without notice - Copyright Miniature Bearings Australia Pty Ltd

MBA Size Listings are a guide to sizes only and must not be solely relied on for critical design information.

Gears - Spur - 64 Pitch - Slip Clutch Flange Mounting

Part Number	Teeth (No.)	Pitch Circle Diameter (PD) mm <i>inches</i>	Bore (d) (+0.013 / - 0.000) mm <i>inches</i>	Outside Diameter (OD) mm <i>inches</i>	Face Width mm <i>inches</i>	Mtg. Holes (No. / Circle Dia.)	Mtg Holes (Type / Size)	Suits Slip Clutch Series	Pressure Angle Deg.	Material / Quality
# GS64-090-0229FM1651-A2	90	35.72 <i>1.406</i>	12.680 <i>0.499</i>	36.525 <i>1.438</i>	2.286 <i>0.090</i>	3 / 16.51	CSK / Clearance for 1-72 Screw	CSSW-12.70-	20	2024 Aluminum Alloy / AGMA 10
# GS64-100-0229FM1651-A2	100	39.69 <i>1.563</i>	12.680 <i>0.499</i>	40.488 <i>1.594</i>	2.286 <i>0.090</i>	3 / 16.51	CSK / Clearance for 1-72 Screw	CSSW-12.70-	20	2024 Aluminum Alloy / AGMA 10
# GS64-100-0305FM2350-3	100	39.69 <i>1.563</i>	12.680 <i>0.499</i>	40.488 <i>1.594</i>	3.048 <i>0.120</i>	3 / 23.495	No CSK / Clearance for 2-56 Screw		20	303 Stainless Steel / AGMA 10
# GS64-100-0305FM2350-A2	100	39.69 <i>1.563</i>	12.680 <i>0.499</i>	40.488 <i>1.594</i>	3.048 <i>0.120</i>	3 / 23.495	No CSK / Clearance for 2-56 Screw		20	2024 Aluminum Alloy / AGMA 10
# GS64-100-0229FM1651-3	100	39.69 <i>1.563</i>	12.680 <i>0.499</i>	40.488 <i>1.594</i>	2.286 <i>0.090</i>	3 / 16.51	CSK / Clearance for 1-72 Screw	CSSW-12.70-	20	303 Stainless Steel / AGMA 10
# GS64-105-0229FM1651-3	105	41.67 <i>1.641</i>	12.680 <i>0.499</i>	42.469 <i>1.672</i>	2.286 <i>0.090</i>	3 / 16.51	CSK / Clearance for 1-72 Screw	CSSW-12.70-	20	303 Stainless Steel / AGMA 10

Indicates item not stocked at time of printing - Please enquire for lead time

E&OE Pricing and all details subject to change without notice - Copyright Miniature Bearings Australia Pty Ltd

MBA Size Listings are a guide to sizes only and must not be solely relied on for critical design information.

Gears - Spur - 64 Pitch - Slip Clutch Flange Mounting

Part Number	Teeth (No.)	Pitch Circle Diameter (PD) mm <i>inches</i>	Bore (d) (+0.013 / - 0.000) mm <i>inches</i>	Outside Diameter (OD) mm <i>inches</i>	Face Width mm <i>inches</i>	Mtg. Holes (No. / Circle Dia.)	Mtg Holes (Type / Size)	Suits Slip Clutch Series	Pressure Angle Deg.	Material / Quality
# GS64-105-0229FM1651-A2	105	41.67 <i>1.641</i>	12.680 <i>0.499</i>	42.469 <i>1.672</i>	2.286 <i>0.090</i>	3 / 16.51	CSK / Clearance for 1-72 Screw	CSSW-12.70-	20	2024 Aluminum Alloy / AGMA 10
# GS64-110-0305FM2350-3	110	43.66 <i>1.719</i>	12.680 <i>0.499</i>	44.450 <i>1.750</i>	3.048 <i>0.120</i>	3 / 23.495	No CSK / Clearance for 2-56 Screw		20	303 Stainless Steel / AGMA 10
# GS64-110-0305FM2350-A2	110	43.66 <i>1.719</i>	12.680 <i>0.499</i>	44.450 <i>1.750</i>	3.048 <i>0.120</i>	3 / 23.495	No CSK / Clearance for 2-56 Screw		20	2024 Aluminum Alloy / AGMA 10
# GS64-120-0305FM2350-3	120	47.63 <i>1.875</i>	12.680 <i>0.499</i>	48.412 <i>1.906</i>	3.048 <i>0.120</i>	3 / 23.495	No CSK / Clearance for 2-56 Screw		20	303 Stainless Steel / AGMA 10
# GS64-120-0305FM2350-A2	120	47.63 <i>1.875</i>	12.680 <i>0.499</i>	48.412 <i>1.906</i>	3.048 <i>0.120</i>	3 / 23.495	No CSK / Clearance for 2-56 Screw		20	2024 Aluminum Alloy / AGMA 10
# GS64-125-0305FM1981-3	125	49.61 <i>1.953</i>	12.680 <i>0.499</i>	50.394 <i>1.984</i>	3.048 <i>0.120</i>	3 / 19.812	CSK / Clearance for 4-40 Screw	CSSW-16.00-	20	303 Stainless Steel / AGMA 10

Indicates item not stocked at time of printing - Please enquire for lead time

E&OE Pricing and all details subject to change without notice - Copyright Miniature Bearings Australia Pty Ltd

MBA Size Listings are a guide to sizes only and must not be solely relied on for critical design information.

Gears - Spur - 64 Pitch - Slip Clutch Flange Mounting

Part Number	Teeth (No.)	Pitch Circle Diameter (PD) mm <i>inches</i>	Bore (d) (+0.013 / - 0.000) mm <i>inches</i>	Outside Diameter (OD) mm <i>inches</i>	Face Width mm <i>inches</i>	Mtg. Holes (No. / Circle Dia.)	Mtg Holes (Type / Size)	Suits Slip Clutch Series	Pressure Angle Deg.	Material / Quality
# GS64-125-0305FM1981-A2	125	49.61 <i>1.953</i>	12.680 <i>0.499</i>	50.394 <i>1.984</i>	3.048 <i>0.120</i>	3 / 19.812	CSK / Clearance for 4-40 Screw	CSSW-16.00-	20	2024 Aluminum Alloy / AGMA 10
# GS64-130-0305FM1981-A2	130	51.60 <i>2.031</i>	12.680 <i>0.499</i>	52.400 <i>2.063</i>	3.048 <i>0.120</i>	3 / 19.812	CSK / Clearance for 4-40 Screw	CSSW-16.00-	20	2024 Aluminum Alloy / AGMA 10
# GS64-130-0305FM2350-3	130	51.60 <i>2.031</i>	12.680 <i>0.499</i>	52.400 <i>2.063</i>	3.048 <i>0.120</i>	3 / 23.495	No CSK / Clearance for 2-56 Screw		20	303 Stainless Steel / AGMA 10
# GS64-130-0305FM1981-3	130	51.60 <i>2.031</i>	12.680 <i>0.499</i>	52.400 <i>2.063</i>	3.048 <i>0.120</i>	3 / 19.812	CSK / Clearance for 4-40 Screw	CSSW-16.00-	20	303 Stainless Steel / AGMA 10
# GS64-130-0305FM2350-A2	130	51.60 <i>2.031</i>	12.680 <i>0.499</i>	52.400 <i>2.063</i>	3.048 <i>0.120</i>	3 / 23.495	No CSK / Clearance for 2-56 Screw		20	2024 Aluminum Alloy / AGMA 10
# GS64-140-0305FM1981-3	140	55.56 <i>2.187</i>	12.680 <i>0.499</i>	56.363 <i>2.219</i>	3.048 <i>0.120</i>	3 / 19.812	CSK / Clearance for 4-40 Screw	CSSW-16.00-	20	303 Stainless Steel / AGMA 10

Indicates item not stocked at time of printing - Please enquire for lead time

E&OE Pricing and all details subject to change without notice - Copyright Miniature Bearings Australia Pty Ltd

MBA Size Listings are a guide to sizes only and must not be solely relied on for critical design information.

Gears - Spur - 64 Pitch - Slip Clutch Flange Mounting

Part Number	Teeth (No.)	Pitch Circle Diameter (PD) mm <i>inches</i>	Bore (d) (+0.013 / - 0.000) mm <i>inches</i>	Outside Diameter (OD) mm <i>inches</i>	Face Width mm <i>inches</i>	Mtg. Holes (No. / Circle Dia.)	Mtg Holes (Type / Size)	Suits Slip Clutch Series	Pressure Angle Deg.	Material / Quality
# GS64-140-0305FM1981-A2	140	55.56 <i>2.187</i>	12.680 <i>0.499</i>	56.363 <i>2.219</i>	3.048 <i>0.120</i>	3 / 19.812	CSK / Clearance for 4-40 Screw	CSSW-16.00-	20	2024 Aluminum Alloy / AGMA 10
# GS64-140-0305FM2350-3	140	55.56 <i>2.187</i>	12.680 <i>0.499</i>	56.363 <i>2.219</i>	3.048 <i>0.120</i>	3 / 23.495	No CSK / Clearance for 2-56 Screw		20	303 Stainless Steel / AGMA 10
# GS64-140-0305FM2350-A2	140	55.56 <i>2.187</i>	12.680 <i>0.499</i>	56.363 <i>2.219</i>	3.048 <i>0.120</i>	3 / 23.495	No CSK / Clearance for 2-56 Screw		20	2024 Aluminum Alloy / AGMA 10
# GS64-150-0305FM1981-3	150	59.53 <i>2.344</i>	12.680 <i>0.499</i>	60.325 <i>2.375</i>	3.048 <i>0.120</i>	3 / 19.812	CSK / Clearance for 4-40 Screw	CSSW-16.00-	20	303 Stainless Steel / AGMA 10
# GS64-150-0305FM1981-A2	150	59.53 <i>2.344</i>	12.680 <i>0.499</i>	60.325 <i>2.375</i>	3.048 <i>0.120</i>	3 / 19.812	CSK / Clearance for 4-40 Screw	CSSW-16.00-	20	2024 Aluminum Alloy / AGMA 10
# GS64-160-0305FM1981-3	160	63.50 <i>2.500</i>	12.680 <i>0.499</i>	64.287 <i>2.531</i>	3.048 <i>0.120</i>	3 / 19.812	CSK / Clearance for 4-40 Screw	CSSW-16.00-	20	303 Stainless Steel / AGMA 10

Indicates item not stocked at time of printing - Please enquire for lead time

E&OE Pricing and all details subject to change without notice - Copyright Miniature Bearings Australia Pty Ltd

MBA Size Listings are a guide to sizes only and must not be solely relied on for critical design information.

Gears - Spur - 64 Pitch - Slip Clutch Flange Mounting

Part Number	Teeth (No.)	Pitch Circle Diameter (PD) mm <i>inches</i>	Bore (d) (+0.013 / - 0.000) mm <i>inches</i>	Outside Diameter (OD) mm <i>inches</i>	Face Width mm <i>inches</i>	Mtg. Holes (No. / Circle Dia.)	Mtg Holes (Type / Size)	Suits Slip Clutch Series	Pressure Angle Deg.	Material / Quality
# GS64-160-0305FM1981-A2	160	63.50 <i>2.500</i>	12.680 <i>0.499</i>	64.287 <i>2.531</i>	3.048 <i>0.120</i>	3 / 19.812	CSK / Clearance for 4-40 Screw	CSSW-16.00-	20	2024 Aluminum Alloy / AGMA 10
# GS64-170-0305FM1981-A2	170	67.47 <i>2.656</i>	12.680 <i>0.499</i>	68.275 <i>2.688</i>	3.048 <i>0.120</i>	3 / 19.812	CSK / Clearance for 4-40 Screw	CSSW-16.00-	20	2024 Aluminum Alloy / AGMA 10
# GS64-170-0305FM1981-3	170	67.47 <i>2.656</i>	12.680 <i>0.499</i>	68.275 <i>2.688</i>	3.048 <i>0.120</i>	3 / 19.812	CSK / Clearance for 4-40 Screw	CSSW-16.00-	20	303 Stainless Steel / AGMA 10

Indicates item not stocked at time of printing - Please enquire for lead time

E&OE Pricing and all details subject to change without notice - Copyright Miniature Bearings Australia Pty Ltd

MBA Size Listings are a guide to sizes only and must not be solely relied on for critical design information.



DISTRIBUTED BY

Ask us to put your name and address here

<http://www.minibearings.com.au/product>

Ph +61 7 3245 7977

Fax +61 7 3245 1017

Catalogue requests to catalogues@minibearings.com.au
