

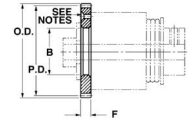

# MBA

## Gears - Spur - 72 Pitch - Slip Clutch Flange Mounting



For mounting to flanges of slip clutches. 2024 aluminium and 303 stainless steel.

Metallic.

### Gears - Spur - 72 Pitch - Slip Clutch Flange Mounting

Part Number	Teeth (No.)	Pitch Circle Diameter (PD) mm <i>inches</i>	Bore (d) (+0.013 / - 0.000) mm <i>inches</i>	Outside Diameter (OD) mm <i>inches</i>	Face Width mm <i>inches</i>	Mtg. Holes (No. / Circle Dia.)	Mtg Holes (Type / Size)	Suits Slip Clutch Series	Pressure Angle Deg.	Material / Quality
# GS72-050-0191FM1270-A2	50	17.64 <i>0.694</i>	9.505 <i>0.374</i>	18.339 <i>0.722</i>	1.905 <i>0.075</i>	3 / 12.70	CSK / Clearance for 0-80 Screw	CSSW-09.65-	20	2024 Aluminum Alloy / AGMA 10
# GS72-050-0191FM1270-3	50	17.64 <i>0.694</i>	9.505 <i>0.374</i>	18.339 <i>0.722</i>	1.905 <i>0.075</i>	3 / 12.70	CSK / Clearance for 0-80 Screw	CSSW-09.65-	20	303 Stainless Steel / AGMA 10
# GS72-055-0191FM1270-3	55	19.40 <i>0.764</i>	9.505 <i>0.374</i>	20.117 <i>0.792</i>	1.905 <i>0.075</i>	3 / 12.70	CSK / Clearance for 0-80 Screw	CSSW-09.65-	20	303 Stainless Steel / AGMA 10

# Indicates item not stocked at time of printing - Please enquire for lead time

E&OE Pricing and all details subject to change without notice - Copyright Miniature Bearings Australia Pty Ltd

MBA Size Listings are a guide to sizes only and must not be solely relied on for critical design information.

## Gears - Spur - 72 Pitch - Slip Clutch Flange Mounting

Part Number	Teeth (No.)	Pitch Circle Diameter (PD) mm <i>inches</i>	Bore (d) (+0.013 / - 0.000) mm <i>inches</i>	Outside Diameter (OD) mm <i>inches</i>	Face Width mm <i>inches</i>	Mtg. Holes (No. / Circle Dia.)	Mtg Holes (Type / Size)	Suits Slip Clutch Series	Pressure Angle Deg.	Material / Quality
# GS72-055-0191FM1270-A2	55	19.40 <i>0.764</i>	9.505 <i>0.374</i>	20.117 <i>0.792</i>	1.905 <i>0.075</i>	3 / 12.70	CSK / Clearance for 0-80 Screw	CSSW-09.65-	20	2024 Aluminum Alloy / AGMA 10
# GS72-060-0191FM1270-3	60	21.17 <i>0.833</i>	9.505 <i>0.374</i>	21.869 <i>0.861</i>	1.905 <i>0.075</i>	3 / 12.70	CSK / Clearance for 0-80 Screw	CSSW-09.65-	20	303 Stainless Steel / AGMA 10
# GS72-060-0191FM1270-A2	60	21.17 <i>0.833</i>	9.505 <i>0.374</i>	21.869 <i>0.861</i>	1.905 <i>0.075</i>	3 / 12.70	CSK / Clearance for 0-80 Screw	CSSW-09.65-	20	2024 Aluminum Alloy / AGMA 10
# GS72-065-0191FM1270-3	65	22.93 <i>0.903</i>	9.505 <i>0.374</i>	23.647 <i>0.931</i>	1.905 <i>0.075</i>	3 / 12.70	CSK / Clearance for 0-80 Screw	CSSW-09.65-	20	303 Stainless Steel / AGMA 10
# GS72-065-0191FM1270-A2	65	22.93 <i>0.903</i>	9.505 <i>0.374</i>	23.647 <i>0.931</i>	1.905 <i>0.075</i>	3 / 12.70	CSK / Clearance for 0-80 Screw	CSSW-09.65-	20	2024 Aluminum Alloy / AGMA 10
# GS72-070-0191FM1270-3	70	24.69 <i>0.972</i>	9.505 <i>0.374</i>	25.400 <i>1.000</i>	1.905 <i>0.075</i>	3 / 12.70	CSK / Clearance for 0-80 Screw	CSSW-09.65-	20	303 Stainless Steel / AGMA 10

# Indicates item not stocked at time of printing - Please enquire for lead time

E&OE Pricing and all details subject to change without notice - Copyright Miniature Bearings Australia Pty Ltd

MBA Size Listings are a guide to sizes only and must not be solely relied on for critical design information.

## Gears - Spur - 72 Pitch - Slip Clutch Flange Mounting

Part Number	Teeth (No.)	Pitch Circle Diameter (PD) mm <i>inches</i>	Bore (d) (+0.013 / - 0.000) mm <i>inches</i>	Outside Diameter (OD) mm <i>inches</i>	Face Width mm <i>inches</i>	Mtg. Holes (No. / Circle Dia.)	Mtg Holes (Type / Size)	Suits Slip Clutch Series	Pressure Angle Deg.	Material / Quality
# GS72-070-0191FM1270-A2	70	24.69 <i>0.972</i>	9.505 <i>0.374</i>	25.400 <i>1.000</i>	1.905 <i>0.075</i>	3 / 12.70	CSK / Clearance for 0-80 Screw	CSSW-09.65-	20	2024 Aluminum Alloy / AGMA 10
# GS72-072-0191FM1270-A2	72	25.40 <i>1.000</i>	9.505 <i>0.374</i>	26.111 <i>1.028</i>	1.905 <i>0.075</i>	3 / 12.70	CSK / Clearance for 0-80 Screw	CSSW-09.65-	20	2024 Aluminum Alloy / AGMA 10
# GS72-072-0191FM1270-3	72	25.40 <i>1.000</i>	9.505 <i>0.374</i>	26.111 <i>1.028</i>	1.905 <i>0.075</i>	3 / 12.70	CSK / Clearance for 0-80 Screw	CSSW-09.65-	20	303 Stainless Steel / AGMA 10
# GS72-075-0229FM1651-3	75	26.46 <i>1.042</i>	12.680 <i>0.499</i>	27.153 <i>1.069</i>	2.286 <i>0.090</i>	3 / 16.51	CSK / Clearance for 1-72 Screw	CSSW-12.70-	20	303 Stainless Steel / AGMA 10
# GS72-075-0229FM1651-A2	75	26.46 <i>1.042</i>	12.680 <i>0.499</i>	27.153 <i>1.069</i>	2.286 <i>0.090</i>	3 / 16.51	CSK / Clearance for 1-72 Screw	CSSW-12.70-	20	2024 Aluminum Alloy / AGMA 10
# GS72-080-0229FM1651-3	80	28.22 <i>1.111</i>	12.680 <i>0.499</i>	28.931 <i>1.139</i>	2.286 <i>0.090</i>	3 / 16.51	CSK / Clearance for 1-72 Screw	CSSW-12.70-	20	303 Stainless Steel / AGMA 10

# Indicates item not stocked at time of printing - Please enquire for lead time

E&OE Pricing and all details subject to change without notice - Copyright Miniature Bearings Australia Pty Ltd

MBA Size Listings are a guide to sizes only and must not be solely relied on for critical design information.

## Gears - Spur - 72 Pitch - Slip Clutch Flange Mounting

Part Number	Teeth (No.)	Pitch Circle Diameter (PD) mm <i>inches</i>	Bore (d) (+0.013 / - 0.000) mm <i>inches</i>	Outside Diameter (OD) mm <i>inches</i>	Face Width mm <i>inches</i>	Mtg. Holes (No. / Circle Dia.)	Mtg Holes (Type / Size)	Suits Slip Clutch Series	Pressure Angle Deg.	Material / Quality
# GS72-080-0229FM1651-A2	80	28.22 <i>1.111</i>	12.680 <i>0.499</i>	28.931 <i>1.139</i>	2.286 <i>0.090</i>	3 / 16.51	CSK / Clearance for 1-72 Screw	CSSW-12.70-	20	2024 Aluminum Alloy / AGMA 10
# GS72-090-0229FM1651-3	90	31.75 <i>1.250</i>	12.680 <i>0.499</i>	32.461 <i>1.278</i>	2.286 <i>0.090</i>	3 / 16.51	CSK / Clearance for 1-72 Screw	CSSW-12.70-	20	303 Stainless Steel / AGMA 10
# GS72-090-0229FM1651-A2	90	31.75 <i>1.250</i>	12.680 <i>0.499</i>	32.461 <i>1.278</i>	2.286 <i>0.090</i>	3 / 16.51	CSK / Clearance for 1-72 Screw	CSSW-12.70-	20	2024 Aluminum Alloy / AGMA 10
# GS72-095-0305FM2350-3	95	33.51 <i>1.319</i>	12.680 <i>0.499</i>	34.214 <i>1.347</i>	3.048 <i>0.120</i>	3 / 23.495	No CSK / Clearance for 2-56 Screw		20	303 Stainless Steel / AGMA 10
# GS72-095-0305FM2350-A2	95	33.51 <i>1.319</i>	12.680 <i>0.499</i>	34.214 <i>1.347</i>	3.048 <i>0.120</i>	3 / 23.495	No CSK / Clearance for 2-56 Screw		20	2024 Aluminum Alloy / AGMA 10
# GS72-100-0229FM1651-3	100	35.28 <i>1.389</i>	12.680 <i>0.499</i>	35.992 <i>1.417</i>	2.286 <i>0.090</i>	3 / 16.51	CSK / Clearance for 1-72 Screw	CSSW-12.70-	20	303 Stainless Steel / AGMA 10

# Indicates item not stocked at time of printing - Please enquire for lead time

E&OE Pricing and all details subject to change without notice - Copyright Miniature Bearings Australia Pty Ltd

MBA Size Listings are a guide to sizes only and must not be solely relied on for critical design information.

## Gears - Spur - 72 Pitch - Slip Clutch Flange Mounting

Part Number	Teeth (No.)	Pitch Circle Diameter (PD) mm <i>inches</i>	Bore (d) (+0.013 / - 0.000) mm <i>inches</i>	Outside Diameter (OD) mm <i>inches</i>	Face Width mm <i>inches</i>	Mtg. Holes (No. / Circle Dia.)	Mtg Holes (Type / Size)	Suits Slip Clutch Series	Pressure Angle Deg.	Material / Quality
# GS72-100-0229FM1651-A2	100	35.28 <i>1.389</i>	12.680 <i>0.499</i>	35.992 <i>1.417</i>	2.286 <i>0.090</i>	3 / 16.51	CSK / Clearance for 1-72 Screw	CSSW-12.70-	20	2024 Aluminum Alloy / AGMA 10
# GS72-105-0305FM2350-3	105	37.04 <i>1.458</i>	12.680 <i>0.499</i>	37.744 <i>1.486</i>	3.048 <i>0.120</i>	3 / 23.495	No CSK / Clearance for 2-56 Screw		20	303 Stainless Steel / AGMA 10
# GS72-105-0305FM2350-A2	105	37.04 <i>1.458</i>	12.680 <i>0.499</i>	37.744 <i>1.486</i>	3.048 <i>0.120</i>	3 / 23.495	No CSK / Clearance for 2-56 Screw		20	2024 Aluminum Alloy / AGMA 10
# GS72-110-0229FM1651-A2	110	38.81 <i>1.528</i>	12.680 <i>0.499</i>	39.522 <i>1.556</i>	2.286 <i>0.090</i>	3 / 16.51	CSK / Clearance for 1-72 Screw	CSSW-12.70-	20	2024 Aluminum Alloy / AGMA 10
# GS72-110-0229FM1651-3	110	38.81 <i>1.528</i>	12.680 <i>0.499</i>	39.522 <i>1.556</i>	2.286 <i>0.090</i>	3 / 16.51	CSK / Clearance for 1-72 Screw	CSSW-12.70-	20	303 Stainless Steel / AGMA 10
# GS72-115-0305FM2350-3	115	40.57 <i>1.597</i>	12.680 <i>0.499</i>	41.275 <i>1.625</i>	3.048 <i>0.120</i>	3 / 23.495	No CSK / Clearance for 2-56 Screw		20	303 Stainless Steel / AGMA 10

# Indicates item not stocked at time of printing - Please enquire for lead time

E&OE Pricing and all details subject to change without notice - Copyright Miniature Bearings Australia Pty Ltd

MBA Size Listings are a guide to sizes only and must not be solely relied on for critical design information.

## Gears - Spur - 72 Pitch - Slip Clutch Flange Mounting

Part Number	Teeth (No.)	Pitch Circle Diameter (PD) mm <i>inches</i>	Bore (d) (+0.013 / - 0.000) mm <i>inches</i>	Outside Diameter (OD) mm <i>inches</i>	Face Width mm <i>inches</i>	Mtg. Holes (No. / Circle Dia.)	Mtg Holes (Type / Size)	Suits Slip Clutch Series	Pressure Angle Deg.	Material / Quality
# GS72-115-0305FM2350-A2	115	40.57 <i>1.597</i>	12.680 <i>0.499</i>	41.275 <i>1.625</i>	3.048 <i>0.120</i>	3 / 23.495	No CSK / Clearance for 2-56 Screw		20	2024 Aluminum Alloy / AGMA 10
# GS72-120-0229FM1651-3	120	42.33 <i>1.667</i>	12.680 <i>0.499</i>	43.028 <i>1.694</i>	2.286 <i>0.090</i>	3 / 16.51	CSK / Clearance for 1-72 Screw	CSSW-12.70-	20	303 Stainless Steel / AGMA 10
# GS72-120-0229FM1651-A2	120	42.33 <i>1.667</i>	12.680 <i>0.499</i>	43.028 <i>1.694</i>	2.286 <i>0.090</i>	3 / 16.51	CSK / Clearance for 1-72 Screw	CSSW-12.70-	20	2024 Aluminum Alloy / AGMA 10
# GS72-130-0305FM2350-3	130	45.86 <i>1.806</i>	12.680 <i>0.499</i>	46.558 <i>1.833</i>	3.048 <i>0.120</i>	3 / 23.495	No CSK / Clearance for 2-56 Screw		20	303 Stainless Steel / AGMA 10
# GS72-130-0305FM2350-A2	130	45.86 <i>1.806</i>	12.680 <i>0.499</i>	46.558 <i>1.833</i>	3.048 <i>0.120</i>	3 / 23.495	No CSK / Clearance for 2-56 Screw		20	2024 Aluminum Alloy / AGMA 10
# GS72-140-0305FM1981-3	140	49.39 <i>1.944</i>	12.680 <i>0.499</i>	50.089 <i>1.972</i>	3.048 <i>0.120</i>	3 / 19.812	CSK / Clearance for 4-40 Screw	CSSW-16.00-	20	303 Stainless Steel / AGMA 10

# Indicates item not stocked at time of printing - Please enquire for lead time

E&OE Pricing and all details subject to change without notice - Copyright Miniature Bearings Australia Pty Ltd

MBA Size Listings are a guide to sizes only and must not be solely relied on for critical design information.

## Gears - Spur - 72 Pitch - Slip Clutch Flange Mounting

Part Number	Teeth (No.)	Pitch Circle Diameter (PD) mm <i>inches</i>	Bore (d) (+0.013 / - 0.000) mm <i>inches</i>	Outside Diameter (OD) mm <i>inches</i>	Face Width mm <i>inches</i>	Mtg. Holes (No. / Circle Dia.)	Mtg Holes (Type / Size)	Suits Slip Clutch Series	Pressure Angle Deg.	Material / Quality
# GS72-140-0305FM1981-A2	140	49.39 <i>1.944</i>	12.680 <i>0.499</i>	50.089 <i>1.972</i>	3.048 <i>0.120</i>	3 / 19.812	CSK / Clearance for 4-40 Screw	CSSW-16.00-	20	2024 Aluminum Alloy / AGMA 10
# GS72-145-0305FM2350-A2	145	51.15 <i>2.014</i>	12.680 <i>0.499</i>	51.867 <i>2.042</i>	3.048 <i>0.120</i>	3 / 23.495	No CSK / Clearance for 2-56 Screw		20	2024 Aluminum Alloy / AGMA 10
# GS72-145-0305FM2350-3	145	51.15 <i>2.014</i>	12.680 <i>0.499</i>	51.867 <i>2.042</i>	3.048 <i>0.120</i>	3 / 23.495	No CSK / Clearance for 2-56 Screw		20	303 Stainless Steel / AGMA 10
# GS72-150-0305FM1981-3	150	52.92 <i>2.083</i>	12.680 <i>0.499</i>	53.619 <i>2.111</i>	3.048 <i>0.120</i>	3 / 19.812	CSK / Clearance for 4-40 Screw	CSSW-16.00-	20	303 Stainless Steel / AGMA 10
# GS72-150-0305FM1981-A2	150	52.92 <i>2.083</i>	12.680 <i>0.499</i>	53.619 <i>2.111</i>	3.048 <i>0.120</i>	3 / 19.812	CSK / Clearance for 4-40 Screw	CSSW-16.00-	20	2024 Aluminum Alloy / AGMA 10
# GS72-160-0305FM1981-3	160	56.44 <i>2.222</i>	12.680 <i>0.499</i>	57.150 <i>2.250</i>	3.048 <i>0.120</i>	3 / 19.812	CSK / Clearance for 4-40 Screw	CSSW-16.00-	20	303 Stainless Steel / AGMA 10

# Indicates item not stocked at time of printing - Please enquire for lead time

E&OE Pricing and all details subject to change without notice - Copyright Miniature Bearings Australia Pty Ltd

MBA Size Listings are a guide to sizes only and must not be solely relied on for critical design information.

## Gears - Spur - 72 Pitch - Slip Clutch Flange Mounting

Part Number	Teeth (No.)	Pitch Circle Diameter (PD) mm <i>inches</i>	Bore (d) (+0.013 / - 0.000) mm <i>inches</i>	Outside Diameter (OD) mm <i>inches</i>	Face Width mm <i>inches</i>	Mtg. Holes (No. / Circle Dia.)	Mtg Holes (Type / Size)	Suits Slip Clutch Series	Pressure Angle Deg.	Material / Quality
# GS72-160-0305FM1981-A2	160	56.44 <i>2.222</i>	12.680 <i>0.499</i>	57.150 <i>2.250</i>	3.048 <i>0.120</i>	3 / 19.812	CSK / Clearance for 4-40 Screw	CSSW-16.00-	20	2024 Aluminum Alloy / AGMA 10
# GS72-160-0305FM2350-3	160	56.44 <i>2.222</i>	12.680 <i>0.499</i>	57.150 <i>2.250</i>	3.048 <i>0.120</i>	3 / 23.495	No CSK / Clearance for 2-56 Screw		20	303 Stainless Steel / AGMA 10
# GS72-160-0305FM2350-A2	160	56.44 <i>2.222</i>	12.680 <i>0.499</i>	57.150 <i>2.250</i>	3.048 <i>0.120</i>	3 / 23.495	No CSK / Clearance for 2-56 Screw		20	2024 Aluminum Alloy / AGMA 10
# GS72-170-0305FM1981-3	170	59.97 <i>2.361</i>	12.680 <i>0.499</i>	60.681 <i>2.389</i>	3.048 <i>0.120</i>	3 / 19.812	CSK / Clearance for 4-40 Screw	CSSW-16.00-	20	303 Stainless Steel / AGMA 10
# GS72-170-0305FM1981-A2	170	59.97 <i>2.361</i>	12.680 <i>0.499</i>	60.681 <i>2.389</i>	3.048 <i>0.120</i>	3 / 19.812	CSK / Clearance for 4-40 Screw	CSSW-16.00-	20	2024 Aluminum Alloy / AGMA 10
# GS72-180-0305FM1981-3	180	63.50 <i>2.500</i>	12.680 <i>0.499</i>	64.211 <i>2.528</i>	3.048 <i>0.120</i>	3 / 19.812	CSK / Clearance for 4-40 Screw	CSSW-16.00-	20	303 Stainless Steel / AGMA 10

# Indicates item not stocked at time of printing - Please enquire for lead time

E&OE Pricing and all details subject to change without notice - Copyright Miniature Bearings Australia Pty Ltd

MBA Size Listings are a guide to sizes only and must not be solely relied on for critical design information.

## Gears - Spur - 72 Pitch - Slip Clutch Flange Mounting

Part Number	Teeth (No.)	Pitch Circle Diameter (PD) mm <i>inches</i>	Bore (d) (+0.013 / - 0.000) mm <i>inches</i>	Outside Diameter (OD) mm <i>inches</i>	Face Width mm <i>inches</i>	Mtg. Holes (No. / Circle Dia.)	Mtg Holes (Type / Size)	Suits Slip Clutch Series	Pressure Angle Deg.	Material / Quality
# GS72-180-0305FM1981-A2	180	63.50 <i>2.500</i>	12.680 <i>0.499</i>	64.211 <i>2.528</i>	3.048 <i>0.120</i>	3 / 19.812	CSK / Clearance for 4-40 Screw	CSSW-16.00-	20	2024 Aluminum Alloy / AGMA 10
# GS72-190-0305FM1981-A2	190	67.03 <i>2.639</i>	12.680 <i>0.499</i>	67.742 <i>2.667</i>	3.048 <i>0.120</i>	3 / 19.812	CSK / Clearance for 4-40 Screw	CSSW-16.00-	20	2024 Aluminum Alloy / AGMA 10
# GS72-190-0305FM1981-3	190	67.03 <i>2.639</i>	12.680 <i>0.499</i>	67.742 <i>2.667</i>	3.048 <i>0.120</i>	3 / 19.812	CSK / Clearance for 4-40 Screw	CSSW-16.00-	20	303 Stainless Steel / AGMA 10

# Indicates item not stocked at time of printing - Please enquire for lead time

E&OE Pricing and all details subject to change without notice - Copyright Miniature Bearings Australia Pty Ltd

MBA Size Listings are a guide to sizes only and must not be solely relied on for critical design information.



DISTRIBUTED BY

Ask us to put your name and address here

<http://www.minibearings.com.au/product>

Ph +61 7 3245 7977

Fax +61 7 3245 1017

Catalogue requests to [catalogues@minibearings.com.au](mailto:catalogues@minibearings.com.au)

