

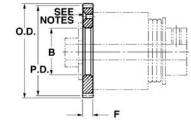

MBA

Gears - Spur - 96 Pitch - Slip Clutch Flange Mounting



For mounting to flanges of slip clutches. 2024 aluminium and 303 stainless steel.

Metallic.

Gears - Spur - 96 Pitch - Slip Clutch Flange Mounting

Part Number	Teeth (No.)	Pitch Circle Diameter (PD) mm <i>inches</i>	Bore (d) (+0.013 / - 0.000) mm <i>inches</i>	Outside Diameter (OD) mm <i>inches</i>	Face Width mm <i>inches</i>	Mtg. Holes (No. / Circle Dia.)	Mtg Holes (Type / Size)	Suits Slip Clutch Series	Pressure Angle Deg.	Material / Quality
# GS96-065-0191FM1270-A2	65	17.20 <i>0.677</i>	9.505 <i>0.374</i>	17.729 <i>0.698</i>	1.905 <i>0.075</i>	3 / 12.70	CSK / Clearance for 0-80 Screw	CSSW-09.65-	20	2024 Aluminum Alloy / AGMA 10
# GS96-065-0191FM1270-3	65	17.20 <i>0.677</i>	9.505 <i>0.374</i>	17.729 <i>0.698</i>	1.905 <i>0.075</i>	3 / 12.70	CSK / Clearance for 0-80 Screw	CSSW-09.65-	20	303 Stainless Steel / AGMA 10
# GS96-070-0191FM1270-3	70	18.52 <i>0.729</i>	9.505 <i>0.374</i>	19.050 <i>0.750</i>	1.905 <i>0.075</i>	3 / 12.70	CSK / Clearance for 0-80 Screw	CSSW-09.65-	20	303 Stainless Steel / AGMA 10

Gears - Spur - 96 Pitch - Slip Clutch Flange Mounting

Part Number	Teeth (No.)	Pitch Circle Diameter (PD) mm <i>inches</i>	Bore (d) (+0.013 / - 0.000) mm <i>inches</i>	Outside Diameter (OD) mm <i>inches</i>	Face Width mm <i>inches</i>	Mtg. Holes (No. / Circle Dia.)	Mtg Holes (Type / Size)	Suits Slip Clutch Series	Pressure Angle Deg.	Material / Quality
# GS96-070-0191FM1270-A2	70	18.52 <i>0.729</i>	9.505 <i>0.374</i>	19.050 <i>0.750</i>	1.905 <i>0.075</i>	3 / 12.70	CSK / Clearance for 0-80 Screw	CSSW-09.65-	20	2024 Aluminum Alloy / AGMA 10
# GS96-075-0191FM1270-3	75	19.85 <i>0.781</i>	9.505 <i>0.374</i>	20.371 <i>0.802</i>	1.905 <i>0.075</i>	3 / 12.70	CSK / Clearance for 0-80 Screw	CSSW-09.65-	20	303 Stainless Steel / AGMA 10
# GS96-075-0191FM1270-A2	75	19.85 <i>0.781</i>	9.505 <i>0.374</i>	20.371 <i>0.802</i>	1.905 <i>0.075</i>	3 / 12.70	CSK / Clearance for 0-80 Screw	CSSW-09.65-	20	2024 Aluminum Alloy / AGMA 10
# GS96-080-0191FM1270-3	80	21.17 <i>0.833</i>	9.505 <i>0.374</i>	21.692 <i>0.854</i>	1.905 <i>0.075</i>	3 / 12.70	CSK / Clearance for 0-80 Screw	CSSW-09.65-	20	303 Stainless Steel / AGMA 10
# GS96-080-0191FM1270-A2	80	21.17 <i>0.833</i>	9.505 <i>0.374</i>	21.692 <i>0.854</i>	1.905 <i>0.075</i>	3 / 12.70	CSK / Clearance for 0-80 Screw	CSSW-09.65-	20	2024 Aluminum Alloy / AGMA 10
# GS96-090-0191FM1270-3	90	23.81 <i>0.937</i>	9.505 <i>0.374</i>	24.333 <i>0.958</i>	1.905 <i>0.075</i>	3 / 12.70	CSK / Clearance for 0-80 Screw	CSSW-09.65-	20	303 Stainless Steel / AGMA 10

Indicates item not stocked at time of printing - Please enquire for lead time

E&OE Pricing and all details subject to change without notice - Copyright Miniature Bearings Australia Pty Ltd

MBA Size Listings are a guide to sizes only and must not be solely relied on for critical design information.

Gears - Spur - 96 Pitch - Slip Clutch Flange Mounting

Part Number	Teeth (No.)	Pitch Circle Diameter (PD) mm <i>inches</i>	Bore (d) (+0.013 / - 0.000) mm <i>inches</i>	Outside Diameter (OD) mm <i>inches</i>	Face Width mm <i>inches</i>	Mtg. Holes (No. / Circle Dia.)	Mtg Holes (Type / Size)	Suits Slip Clutch Series	Pressure Angle Deg.	Material / Quality
# GS96-090-0191FM1270-A2	90	23.81 <i>0.937</i>	9.505 <i>0.374</i>	24.333 <i>0.958</i>	1.905 <i>0.075</i>	3 / 12.70	CSK / Clearance for 0-80 Screw	CSSW-09.65-	20	2024 Aluminum Alloy / AGMA 10
# GS96-096-0229FM1270-A2	96	25.40 <i>1.000</i>	9.505 <i>0.374</i>	25.933 <i>1.021</i>	2.286 <i>0.090</i>	3 / 12.70	CSK / Clearance for 0-80 Screw	CSSW-09.65-	20	2024 Aluminum Alloy / AGMA 10
# GS96-096-0229FM1270-3	96	25.40 <i>1.000</i>	9.505 <i>0.374</i>	25.933 <i>1.021</i>	2.286 <i>0.090</i>	3 / 12.70	CSK / Clearance for 0-80 Screw	CSSW-09.65-	20	303 Stainless Steel / AGMA 10
# GS96-100-0229FM1651-3	100	26.46 <i>1.042</i>	12.680 <i>0.499</i>	27.000 <i>1.063</i>	2.286 <i>0.090</i>	3 / 16.51	CSK / Clearance for 1-72 Screw	CSSW-12.70-	20	303 Stainless Steel / AGMA 10
# GS96-100-0229FM1651-A2	100	26.46 <i>1.042</i>	12.680 <i>0.499</i>	27.000 <i>1.063</i>	2.286 <i>0.090</i>	3 / 16.51	CSK / Clearance for 1-72 Screw	CSSW-12.70-	20	2024 Aluminum Alloy / AGMA 10
# GS96-110-0229FM1651-3	110	29.10 <i>1.146</i>	12.680 <i>0.499</i>	29.642 <i>1.167</i>	2.286 <i>0.090</i>	3 / 16.51	CSK / Clearance for 1-72 Screw	CSSW-12.70-	20	303 Stainless Steel / AGMA 10

Indicates item not stocked at time of printing - Please enquire for lead time

E&OE Pricing and all details subject to change without notice - Copyright Miniature Bearings Australia Pty Ltd

MBA Size Listings are a guide to sizes only and must not be solely relied on for critical design information.

Gears - Spur - 96 Pitch - Slip Clutch Flange Mounting

Part Number	Teeth (No.)	Pitch Circle Diameter (PD) mm <i>inches</i>	Bore (d) (+0.013 / - 0.000) mm <i>inches</i>	Outside Diameter (OD) mm <i>inches</i>	Face Width mm <i>inches</i>	Mtg. Holes (No. / Circle Dia.)	Mtg Holes (Type / Size)	Suits Slip Clutch Series	Pressure Angle Deg.	Material / Quality
# GS96-110-0229FM1651-A2	110	29.10 <i>1.146</i>	12.680 <i>0.499</i>	29.642 <i>1.167</i>	2.286 <i>0.090</i>	3 / 16.51	CSK / Clearance for 1-72 Screw	CSSW-12.70-	20	2024 Aluminum Alloy / AGMA 10
# GS96-120-0229FM1651-3	120	31.75 <i>1.250</i>	12.680 <i>0.499</i>	32.283 <i>1.271</i>	2.286 <i>0.090</i>	3 / 16.51	CSK / Clearance for 1-72 Screw	CSSW-12.70-	20	303 Stainless Steel / AGMA 10
# GS96-120-0229FM1651-A2	120	31.75 <i>1.250</i>	12.680 <i>0.499</i>	32.283 <i>1.271</i>	2.286 <i>0.090</i>	3 / 16.51	CSK / Clearance for 1-72 Screw	CSSW-12.70-	20	2024 Aluminum Alloy / AGMA 10
# GS96-125-0305FM2350-3	125	33.07 <i>1.302</i>	12.680 <i>0.499</i>	33.604 <i>1.323</i>	3.048 <i>0.120</i>	3 / 23.495	No CSK / Clearance for 2-56 Screw		20	303 Stainless Steel / AGMA 10
# GS96-125-0305FM2350-A2	125	33.07 <i>1.302</i>	12.680 <i>0.499</i>	33.604 <i>1.323</i>	3.048 <i>0.120</i>	3 / 23.495	No CSK / Clearance for 2-56 Screw		20	2024 Aluminum Alloy / AGMA 10
# GS96-130-0305FM2350-3	130	34.40 <i>1.354</i>	12.680 <i>0.499</i>	34.925 <i>1.375</i>	3.048 <i>0.120</i>	3 / 23.495	No CSK / Clearance for 2-56 Screw		20	303 Stainless Steel / AGMA 10

Indicates item not stocked at time of printing - Please enquire for lead time

E&OE Pricing and all details subject to change without notice - Copyright Miniature Bearings Australia Pty Ltd

MBA Size Listings are a guide to sizes only and must not be solely relied on for critical design information.

Gears - Spur - 96 Pitch - Slip Clutch Flange Mounting

Part Number	Teeth (No.)	Pitch Circle Diameter (PD) mm <i>inches</i>	Bore (d) (+0.013 / - 0.000) mm <i>inches</i>	Outside Diameter (OD) mm <i>inches</i>	Face Width mm <i>inches</i>	Mtg. Holes (No. / Circle Dia.)	Mtg Holes (Type / Size)	Suits Slip Clutch Series	Pressure Angle Deg.	Material / Quality
# GS96-130-0229FM1651-3	130	34.40 <i>1.354</i>	12.680 <i>0.499</i>	34.925 <i>1.375</i>	2.286 <i>0.090</i>	3 / 16.51	CSK / Clearance for 1-72 Screw	CSSW-12.70-	20	303 Stainless Steel / AGMA 10
# GS96-130-0229FM1651-A2	130	34.40 <i>1.354</i>	12.680 <i>0.499</i>	34.925 <i>1.375</i>	2.286 <i>0.090</i>	3 / 16.51	CSK / Clearance for 1-72 Screw	CSSW-12.70-	20	2024 Aluminum Alloy / AGMA 10
# GS96-130-0305FM2350-A2	130	34.40 <i>1.354</i>	12.680 <i>0.499</i>	34.925 <i>1.375</i>	3.048 <i>0.120</i>	3 / 23.495	No CSK / Clearance for 2-56 Screw		20	2024 Aluminum Alloy / AGMA 10
# GS96-140-0229FM1651-A2	140	37.04 <i>1.458</i>	12.680 <i>0.499</i>	37.567 <i>1.479</i>	2.286 <i>0.090</i>	3 / 16.51	CSK / Clearance for 1-72 Screw	CSSW-12.70-	20	2024 Aluminum Alloy / AGMA 10
# GS96-140-0305FM2350-3	140	37.04 <i>1.458</i>	12.680 <i>0.499</i>	37.567 <i>1.479</i>	3.048 <i>0.120</i>	3 / 23.495	No CSK / Clearance for 2-56 Screw		20	303 Stainless Steel / AGMA 10
# GS96-140-0305FM2350-A2	140	37.04 <i>1.458</i>	12.680 <i>0.499</i>	37.567 <i>1.479</i>	3.048 <i>0.120</i>	3 / 23.495	No CSK / Clearance for 2-56 Screw		20	2024 Aluminum Alloy / AGMA 10

Indicates item not stocked at time of printing - Please enquire for lead time

E&OE Pricing and all details subject to change without notice - Copyright Miniature Bearings Australia Pty Ltd

MBA Size Listings are a guide to sizes only and must not be solely relied on for critical design information.

Gears - Spur - 96 Pitch - Slip Clutch Flange Mounting

Part Number	Teeth (No.)	Pitch Circle Diameter (PD) mm <i>inches</i>	Bore (d) (+0.013 / - 0.000) mm <i>inches</i>	Outside Diameter (OD) mm <i>inches</i>	Face Width mm <i>inches</i>	Mtg. Holes (No. / Circle Dia.)	Mtg Holes (Type / Size)	Suits Slip Clutch Series	Pressure Angle Deg.	Material / Quality
# GS96-140-0229FM1651-3	140	37.04 <i>1.458</i>	12.680 <i>0.499</i>	37.567 <i>1.479</i>	2.286 <i>0.090</i>	3 / 16.51	CSK / Clearance for 1-72 Screw	CSSW-12.70-	20	303 Stainless Steel / AGMA 10
# GS96-150-0229FM1651-3	150	39.69 <i>1.563</i>	12.680 <i>0.499</i>	40.208 <i>1.583</i>	2.286 <i>0.090</i>	3 / 16.51	CSK / Clearance for 1-72 Screw	CSSW-12.70-	20	303 Stainless Steel / AGMA 10
# GS96-150-0229FM1651-A2	150	39.69 <i>1.563</i>	12.680 <i>0.499</i>	40.208 <i>1.583</i>	2.286 <i>0.090</i>	3 / 16.51	CSK / Clearance for 1-72 Screw	CSSW-12.70-	20	2024 Aluminum Alloy / AGMA 10
# GS96-150-0305FM2350-3	150	39.69 <i>1.563</i>	12.680 <i>0.499</i>	40.208 <i>1.583</i>	3.048 <i>0.120</i>	3 / 23.495	No CSK / Clearance for 2-56 Screw		20	303 Stainless Steel / AGMA 10
# GS96-150-0305FM2350-A2	150	39.69 <i>1.563</i>	12.680 <i>0.499</i>	40.208 <i>1.583</i>	3.048 <i>0.120</i>	3 / 23.495	No CSK / Clearance for 2-56 Screw		20	2024 Aluminum Alloy / AGMA 10
# GS96-175-0305FM2350-3	175	46.30 <i>1.823</i>	12.680 <i>0.499</i>	46.838 <i>1.844</i>	3.048 <i>0.120</i>	3 / 23.495	No CSK / Clearance for 2-56 Screw		20	303 Stainless Steel / AGMA 10

Indicates item not stocked at time of printing - Please enquire for lead time

E&OE Pricing and all details subject to change without notice - Copyright Miniature Bearings Australia Pty Ltd

MBA Size Listings are a guide to sizes only and must not be solely relied on for critical design information.

Gears - Spur - 96 Pitch - Slip Clutch Flange Mounting

Part Number	Teeth (No.)	Pitch Circle Diameter (PD) mm <i>inches</i>	Bore (d) (+0.013 / - 0.000) mm <i>inches</i>	Outside Diameter (OD) mm <i>inches</i>	Face Width mm <i>inches</i>	Mtg. Holes (No. / Circle Dia.)	Mtg Holes (Type / Size)	Suits Slip Clutch Series	Pressure Angle Deg.	Material / Quality
# GS96-175-0305FM2350-A2	175	46.30 <i>1.823</i>	12.680 <i>0.499</i>	46.838 <i>1.844</i>	3.048 <i>0.120</i>	3 / 23.495	No CSK / Clearance for 2-56 Screw		20	2024 Aluminum Alloy / AGMA 10
# GS96-185-0305FM1981-A2	185	48.95 <i>1.927</i>	12.680 <i>0.499</i>	49.479 <i>1.948</i>	3.048 <i>0.120</i>	3 / 19.812	CSK / Clearance for 4-40 Screw	CSSW-16.00-	20	2024 Aluminum Alloy / AGMA 10
# GS96-185-0305FM1981-3	185	48.95 <i>1.927</i>	12.680 <i>0.499</i>	49.479 <i>1.948</i>	3.048 <i>0.120</i>	3 / 19.812	CSK / Clearance for 4-40 Screw	CSSW-16.00-	20	303 Stainless Steel / AGMA 10
# GS96-200-0305FM2350-A2	200	52.92 <i>2.083</i>	12.680 <i>0.499</i>	53.442 <i>2.104</i>	3.048 <i>0.120</i>	3 / 23.495	No CSK / Clearance for 2-56 Screw		20	2024 Aluminum Alloy / AGMA 10
# GS96-200-0305FM2350-3	200	52.92 <i>2.083</i>	12.680 <i>0.499</i>	53.442 <i>2.104</i>	3.048 <i>0.120</i>	3 / 23.495	No CSK / Clearance for 2-56 Screw		20	303 Stainless Steel / AGMA 10
# GS96-200-0305FM1981-3	200	52.92 <i>2.083</i>	12.680 <i>0.499</i>	53.442 <i>2.104</i>	3.048 <i>0.120</i>	3 / 19.812	CSK / Clearance for 4-40 Screw	CSSW-16.00-	20	303 Stainless Steel / AGMA 10

Indicates item not stocked at time of printing - Please enquire for lead time

E&OE Pricing and all details subject to change without notice - Copyright Miniature Bearings Australia Pty Ltd

MBA Size Listings are a guide to sizes only and must not be solely relied on for critical design information.

Gears - Spur - 96 Pitch - Slip Clutch Flange Mounting

Part Number	Teeth (No.)	Pitch Circle Diameter (PD) mm <i>inches</i>	Bore (d) (+0.013 / - 0.000) mm <i>inches</i>	Outside Diameter (OD) mm <i>inches</i>	Face Width mm <i>inches</i>	Mtg. Holes (No. / Circle Dia.)	Mtg Holes (Type / Size)	Suits Slip Clutch Series	Pressure Angle Deg.	Material / Quality
# GS96-200-0305FM1981-A2	200	52.92 <i>2.083</i>	12.680 <i>0.499</i>	53.442 <i>2.104</i>	3.048 <i>0.120</i>	3 / 19.812	CSK / Clearance for 4-40 Screw	CSSW-16.00-	20	2024 Aluminum Alloy / AGMA 10
# GS96-215-0305FM1981-3	215	56.89 <i>2.240</i>	12.680 <i>0.499</i>	57.404 <i>2.260</i>	3.048 <i>0.120</i>	3 / 19.812	CSK / Clearance for 4-40 Screw	CSSW-16.00-	20	303 Stainless Steel / AGMA 10
# GS96-215-0305FM1981-A2	215	56.89 <i>2.240</i>	12.680 <i>0.499</i>	57.404 <i>2.260</i>	3.048 <i>0.120</i>	3 / 19.812	CSK / Clearance for 4-40 Screw	CSSW-16.00-	20	2024 Aluminum Alloy / AGMA 10
# GS96-230-0305FM1981-3	230	60.85 <i>2.396</i>	12.680 <i>0.499</i>	61.392 <i>2.417</i>	3.048 <i>0.120</i>	3 / 19.812	CSK / Clearance for 4-40 Screw	CSSW-16.00-	20	303 Stainless Steel / AGMA 10
# GS96-230-0305FM1981-A2	230	60.85 <i>2.396</i>	12.680 <i>0.499</i>	61.392 <i>2.417</i>	3.048 <i>0.120</i>	3 / 19.812	CSK / Clearance for 4-40 Screw	CSSW-16.00-	20	2024 Aluminum Alloy / AGMA 10
# GS96-245-0305FM1981-3	245	64.82 <i>2.552</i>	12.680 <i>0.499</i>	65.354 <i>2.573</i>	3.048 <i>0.120</i>	3 / 19.812	CSK / Clearance for 4-40 Screw	CSSW-16.00-	20	303 Stainless Steel / AGMA 10

Indicates item not stocked at time of printing - Please enquire for lead time

E&OE Pricing and all details subject to change without notice - Copyright Miniature Bearings Australia Pty Ltd

MBA Size Listings are a guide to sizes only and must not be solely relied on for critical design information.

Gears - Spur - 96 Pitch - Slip Clutch Flange Mounting

Part Number	Teeth (No.)	Pitch Circle Diameter (PD) mm <i>inches</i>	Bore (d) (+0.013 / - 0.000) mm <i>inches</i>	Outside Diameter (OD) mm <i>inches</i>	Face Width mm <i>inches</i>	Mtg. Holes (No. / Circle Dia.)	Mtg Holes (Type / Size)	Suits Slip Clutch Series	Pressure Angle Deg.	Material / Quality
# GS96-245-0305FM1981-A2	245	64.82 <i>2.552</i>	12.680 <i>0.499</i>	65.354 <i>2.573</i>	3.048 <i>0.120</i>	3 / 19.812	CSK / Clearance for 4-40 Screw	CSSW-16.00-	20	2024 Aluminum Alloy / AGMA 10
# GS96-260-0305FM1981-A2	260	68.79 <i>2.708</i>	12.680 <i>0.499</i>	69.317 <i>2.729</i>	3.048 <i>0.120</i>	3 / 19.812	CSK / Clearance for 4-40 Screw	CSSW-16.00-	20	2024 Aluminum Alloy / AGMA 10
# GS96-260-0305FM1981-3	260	68.79 <i>2.708</i>	12.680 <i>0.499</i>	69.317 <i>2.729</i>	3.048 <i>0.120</i>	3 / 19.812	CSK / Clearance for 4-40 Screw	CSSW-16.00-	20	303 Stainless Steel / AGMA 10

Indicates item not stocked at time of printing - Please enquire for lead time

E&OE Pricing and all details subject to change without notice - Copyright Miniature Bearings Australia Pty Ltd

MBA Size Listings are a guide to sizes only and must not be solely relied on for critical design information.



DISTRIBUTED BY

Ask us to put your name and address here

<http://www.minibearings.com.au/product>

Ph +61 7 3245 7977

Fax +61 7 3245 1017

Catalogue requests to catalogues@minibearings.com.au

