

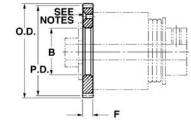

# MBA

## Gears - Spur - 120 Pitch - Slip Clutch Flange Mounting



For mounting to flanges of slip clutches. 2024 aluminium and 303 stainless steel.

Metallic.

### Gears - Spur - 120 Pitch - Slip Clutch Flange Mounting

Part Number	Teeth (No.)	Pitch Circle Diameter (PD) mm <i>inches</i>	Bore (d) (+0.013 / - 0.000) mm <i>inches</i>	Outside Diameter (OD) mm <i>inches</i>	Face Width mm <i>inches</i>	Mtg. Holes (No. / Circle Dia.) mm <i>inches</i>	Mtg Holes (Type / Size) mm <i>inches</i>	Suits Slip Clutch Series	Pressure Angle Deg.	Material / Quality
# GS120-080-0191FM1270-A2	80	16.93 <i>0.667</i>	9.505 <i>0.374</i>	17.348 <i>0.683</i>	1.905 <i>0.075</i>	3 / 12.70	CSK / Clearance for 0-80 Screw	CSSW-09.65-	20	2024 Aluminum Alloy / AGMA 10
# GS120-080-0191FM1270-3	80	16.93 <i>0.667</i>	9.505 <i>0.374</i>	17.348 <i>0.683</i>	1.905 <i>0.075</i>	3 / 12.70	CSK / Clearance for 0-80 Screw	CSSW-09.65-	20	303 Stainless Steel / AGMA 10

# Indicates item not stocked at time of printing - Please enquire for lead time  
 E&OE Pricing and all details subject to change without notice - Copyright Miniature Bearings Australia Pty Ltd  
 MBA Size Listings are a guide to sizes only and must not be solely relied on for critical design information.

## Gears - Spur - 120 Pitch - Slip Clutch Flange Mounting

Part Number	Teeth (No.)	Pitch Circle Diameter (PD) mm <i>inches</i>	Bore (d) (+0.013 / - 0.000) mm <i>inches</i>	Outside Diameter (OD) mm <i>inches</i>	Face Width mm <i>inches</i>	Mtg. Holes (No. / Circle Dia.) mm <i>inches</i>	Mtg Holes (Type / Size) mm <i>inches</i>	Suits Slip Clutch Series	Pressure Angle Deg.	Material / Quality
# GS120-085-0191FM1270-A2	85	17.99 <i>0.708</i>	9.505 <i>0.374</i>	18.415 <i>0.725</i>	1.905 <i>0.075</i>	3 / 12.70	CSK / Clearance for 0-80 Screw	CSSW-09.65-	20	2024 Aluminum Alloy / AGMA 10
# GS120-085-0191FM1270-3	85	17.99 <i>0.708</i>	9.505 <i>0.374</i>	18.415 <i>0.725</i>	1.905 <i>0.075</i>	3 / 12.70	CSK / Clearance for 0-80 Screw	CSSW-09.65-	20	303 Stainless Steel / AGMA 10
# GS120-090-0191FM1270-3	90	19.05 <i>0.750</i>	9.505 <i>0.374</i>	19.482 <i>0.767</i>	1.905 <i>0.075</i>	3 / 12.70	CSK / Clearance for 0-80 Screw	CSSW-09.65-	20	303 Stainless Steel / AGMA 10
# GS120-090-0191FM1270-A2	90	19.05 <i>0.750</i>	9.505 <i>0.374</i>	19.482 <i>0.767</i>	1.905 <i>0.075</i>	3 / 12.70	CSK / Clearance for 0-80 Screw	CSSW-09.65-	20	2024 Aluminum Alloy / AGMA 10
# GS120-100-0191FM1270-A2	100	21.17 <i>0.833</i>	9.505 <i>0.374</i>	21.590 <i>0.850</i>	1.905 <i>0.075</i>	3 / 12.70	CSK / Clearance for 0-80 Screw	CSSW-09.65-	20	2024 Aluminum Alloy / AGMA 10
# GS120-100-0191FM1270-3	100	21.17 <i>0.833</i>	9.505 <i>0.374</i>	21.590 <i>0.850</i>	1.905 <i>0.075</i>	3 / 12.70	CSK / Clearance for 0-80 Screw	CSSW-09.65-	20	303 Stainless Steel / AGMA 10

# Indicates item not stocked at time of printing - Please enquire for lead time

E&OE Pricing and all details subject to change without notice - Copyright Miniature Bearings Australia Pty Ltd

MBA Size Listings are a guide to sizes only and must not be solely relied on for critical design information.

## Gears - Spur - 120 Pitch - Slip Clutch Flange Mounting

Part Number	Teeth (No.)	Pitch Circle Diameter (PD) mm <i>inches</i>	Bore (d) (+0.013 / - 0.000) mm <i>inches</i>	Outside Diameter (OD) mm <i>inches</i>	Face Width mm <i>inches</i>	Mtg. Holes (No. / Circle Dia.) mm <i>inches</i>	Mtg Holes (Type / Size) mm <i>inches</i>	Suits Slip Clutch Series	Pressure Angle Deg.	Material / Quality
# GS120-110-0191FM1270-A2	110	23.28 <i>0.917</i>	9.505 <i>0.374</i>	23.698 <i>0.933</i>	1.905 <i>0.075</i>	3 / 12.70	CSK / Clearance for 0-80 Screw	CSSW-09.65-	20	2024 Aluminum Alloy / AGMA 10
# GS120-110-0191FM1270-3	110	23.28 <i>0.917</i>	9.505 <i>0.374</i>	23.698 <i>0.933</i>	1.905 <i>0.075</i>	3 / 12.70	CSK / Clearance for 0-80 Screw	CSSW-09.65-	20	303 Stainless Steel / AGMA 10
# GS120-120-0191FM1270-A2	120	25.40 <i>1.000</i>	9.505 <i>0.374</i>	25.832 <i>1.017</i>	1.905 <i>0.075</i>	3 / 12.70	CSK / Clearance for 0-80 Screw	CSSW-09.65-	20	2024 Aluminum Alloy / AGMA 10
# GS120-120-0191FM1270-3	120	25.40 <i>1.000</i>	9.505 <i>0.374</i>	25.832 <i>1.017</i>	1.905 <i>0.075</i>	3 / 12.70	CSK / Clearance for 0-80 Screw	CSSW-09.65-	20	303 Stainless Steel / AGMA 10
# GS120-125-0229FM1651-3	125	26.46 <i>1.042</i>	12.680 <i>0.499</i>	26.873 <i>1.058</i>	2.286 <i>0.090</i>	3 / 16.51	CSK / Clearance for 1-72 Screw	CSSW-12.70-	20	303 Stainless Steel / AGMA 10
# GS120-125-0229FM1651-A2	125	26.46 <i>1.042</i>	12.680 <i>0.499</i>	26.873 <i>1.058</i>	2.286 <i>0.090</i>	3 / 16.51	CSK / Clearance for 1-72 Screw	CSSW-12.70-	20	2024 Aluminum Alloy / AGMA 10

# Indicates item not stocked at time of printing - Please enquire for lead time

E&OE Pricing and all details subject to change without notice - Copyright Miniature Bearings Australia Pty Ltd

MBA Size Listings are a guide to sizes only and must not be solely relied on for critical design information.

## Gears - Spur - 120 Pitch - Slip Clutch Flange Mounting

Part Number	Teeth (No.)	Pitch Circle Diameter (PD) mm <i>inches</i>	Bore (d) (+0.013 / - 0.000) mm <i>inches</i>	Outside Diameter (OD) mm <i>inches</i>	Face Width mm <i>inches</i>	Mtg. Holes (No. / Circle Dia.) mm <i>inches</i>	Mtg Holes (Type / Size) mm <i>inches</i>	Suits Slip Clutch Series	Pressure Angle Deg.	Material / Quality
# GS120-130-0229FM1651-A2	130	27.52 <i>1.083</i>	12.680 <i>0.499</i>	27.940 <i>1.100</i>	2.286 <i>0.090</i>	3 / 16.51	CSK / Clearance for 1-72 Screw	CSSW-12.70-	20	2024 Aluminum Alloy / AGMA 10
# GS120-130-0229FM1651-3	130	27.52 <i>1.083</i>	12.680 <i>0.499</i>	27.940 <i>1.100</i>	2.286 <i>0.090</i>	3 / 16.51	CSK / Clearance for 1-72 Screw	CSSW-12.70-	20	303 Stainless Steel / AGMA 10
# GS120-140-0229FM1651-A2	140	29.63 <i>1.167</i>	12.680 <i>0.499</i>	30.048 <i>1.183</i>	2.286 <i>0.090</i>	3 / 16.51	CSK / Clearance for 1-72 Screw	CSSW-12.70-	20	2024 Aluminum Alloy / AGMA 10
# GS120-140-0229FM1651-3	140	29.63 <i>1.167</i>	12.680 <i>0.499</i>	30.048 <i>1.183</i>	2.286 <i>0.090</i>	3 / 16.51	CSK / Clearance for 1-72 Screw	CSSW-12.70-	20	303 Stainless Steel / AGMA 10
# GS120-150-0229FM1651-A2	150	31.75 <i>1.250</i>	12.680 <i>0.499</i>	32.182 <i>1.267</i>	2.286 <i>0.090</i>	3 / 16.51	CSK / Clearance for 1-72 Screw	CSSW-12.70-	20	2024 Aluminum Alloy / AGMA 10
# GS120-150-0229FM1651-3	150	31.75 <i>1.250</i>	12.680 <i>0.499</i>	32.182 <i>1.267</i>	2.286 <i>0.090</i>	3 / 16.51	CSK / Clearance for 1-72 Screw	CSSW-12.70-	20	303 Stainless Steel / AGMA 10

# Indicates item not stocked at time of printing - Please enquire for lead time

E&OE Pricing and all details subject to change without notice - Copyright Miniature Bearings Australia Pty Ltd

MBA Size Listings are a guide to sizes only and must not be solely relied on for critical design information.

## Gears - Spur - 120 Pitch - Slip Clutch Flange Mounting

Part Number	Teeth (No.)	Pitch Circle Diameter (PD) mm <i>inches</i>	Bore (d) (+0.013 / - 0.000) mm <i>inches</i>	Outside Diameter (OD) mm <i>inches</i>	Face Width mm <i>inches</i>	Mtg. Holes (No. / Circle Dia.) mm <i>inches</i>	Mtg Holes (Type / Size) mm <i>inches</i>	Suits Slip Clutch Series	Pressure Angle Deg.	Material / Quality
# GS120-155-0305FM2350-A2	155	32.81 <i>1.292</i>	12.680 <i>0.499</i>	33.223 <i>1.308</i>	3.048 <i>0.120</i>	3 / 23.495	No CSK / Clearance for 2-56 Screw		20	2024 Aluminum Alloy / AGMA 10
# GS120-155-0305FM2350-3	155	32.81 <i>1.292</i>	12.680 <i>0.499</i>	33.223 <i>1.308</i>	3.048 <i>0.120</i>	3 / 23.495	No CSK / Clearance for 2-56 Screw		20	303 Stainless Steel / AGMA 10
# GS120-160-0229FM1651-3	160	33.87 <i>1.333</i>	12.680 <i>0.499</i>	34.290 <i>1.350</i>	2.286 <i>0.090</i>	3 / 16.51	CSK / Clearance for 1-72 Screw	CSSW-12.70-	20	303 Stainless Steel / AGMA 10
# GS120-160-0229FM1651-A2	160	33.87 <i>1.333</i>	12.680 <i>0.499</i>	34.290 <i>1.350</i>	2.286 <i>0.090</i>	3 / 16.51	CSK / Clearance for 1-72 Screw	CSSW-12.70-	20	2024 Aluminum Alloy / AGMA 10
# GS120-170-0305FM2350-A2	170	35.98 <i>1.417</i>	12.680 <i>0.499</i>	36.398 <i>1.433</i>	3.048 <i>0.120</i>	3 / 23.495	No CSK / Clearance for 2-56 Screw		20	2024 Aluminum Alloy / AGMA 10
# GS120-170-0305FM2350-3	170	35.98 <i>1.417</i>	12.680 <i>0.499</i>	36.398 <i>1.433</i>	3.048 <i>0.120</i>	3 / 23.495	No CSK / Clearance for 2-56 Screw		20	303 Stainless Steel / AGMA 10

# Indicates item not stocked at time of printing - Please enquire for lead time

E&OE Pricing and all details subject to change without notice - Copyright Miniature Bearings Australia Pty Ltd

MBA Size Listings are a guide to sizes only and must not be solely relied on for critical design information.

## Gears - Spur - 120 Pitch - Slip Clutch Flange Mounting

Part Number	Teeth (No.)	Pitch Circle Diameter (PD) mm <i>inches</i>	Bore (d) (+0.013 / - 0.000) mm <i>inches</i>	Outside Diameter (OD) mm <i>inches</i>	Face Width mm <i>inches</i>	Mtg. Holes (No. / Circle Dia.) mm <i>inches</i>	Mtg Holes (Type / Size) mm <i>inches</i>	Suits Slip Clutch Series	Pressure Angle Deg.	Material / Quality
# GS120-170-0229FM1651-A2	170	35.98 <i>1.417</i>	12.680 <i>0.499</i>	36.398 <i>1.433</i>	2.286 <i>0.090</i>	3 / 16.51	CSK / Clearance for 1-72 Screw	CSSW-12.70-	20	2024 Aluminum Alloy / AGMA 10
# GS120-170-0229FM1651-3	170	35.98 <i>1.417</i>	12.680 <i>0.499</i>	36.398 <i>1.433</i>	2.286 <i>0.090</i>	3 / 16.51	CSK / Clearance for 1-72 Screw	CSSW-12.70-	20	303 Stainless Steel / AGMA 10
# GS120-185-0305FM2350-A2	185	39.16 <i>1.542</i>	12.680 <i>0.499</i>	39.573 <i>1.558</i>	3.048 <i>0.120</i>	3 / 23.495	No CSK / Clearance for 2-56 Screw		20	2024 Aluminum Alloy / AGMA 10
# GS120-185-0305FM2350-3	185	39.16 <i>1.542</i>	12.680 <i>0.499</i>	39.573 <i>1.558</i>	3.048 <i>0.120</i>	3 / 23.495	No CSK / Clearance for 2-56 Screw		20	303 Stainless Steel / AGMA 10
# GS120-200-0305FM2350-A2	200	42.33 <i>1.667</i>	12.680 <i>0.499</i>	42.748 <i>1.683</i>	3.048 <i>0.120</i>	3 / 23.495	No CSK / Clearance for 2-56 Screw		20	2024 Aluminum Alloy / AGMA 10
# GS120-200-0305FM2350-3	200	42.33 <i>1.667</i>	12.680 <i>0.499</i>	42.748 <i>1.683</i>	3.048 <i>0.120</i>	3 / 23.495	No CSK / Clearance for 2-56 Screw		20	303 Stainless Steel / AGMA 10

# Indicates item not stocked at time of printing - Please enquire for lead time

E&OE Pricing and all details subject to change without notice - Copyright Miniature Bearings Australia Pty Ltd

MBA Size Listings are a guide to sizes only and must not be solely relied on for critical design information.

## Gears - Spur - 120 Pitch - Slip Clutch Flange Mounting

Part Number	Teeth (No.)	Pitch Circle Diameter (PD) mm <i>inches</i>	Bore (d) (+0.013 / - 0.000) mm <i>inches</i>	Outside Diameter (OD) mm <i>inches</i>	Face Width mm <i>inches</i>	Mtg. Holes (No. / Circle Dia.) mm <i>inches</i>	Mtg Holes (Type / Size) mm <i>inches</i>	Suits Slip Clutch Series	Pressure Angle Deg.	Material / Quality
# GS120-225-0305FM2350-3	225	47.63 <i>1.875</i>	12.680 <i>0.499</i>	48.057 <i>1.892</i>	3.048 <i>0.120</i>	3 / 23.495	No CSK / Clearance for 2-56 Screw		20	303 Stainless Steel / AGMA 10
# GS120-225-0305FM2350-A2	225	47.63 <i>1.875</i>	12.680 <i>0.499</i>	48.057 <i>1.892</i>	3.048 <i>0.120</i>	3 / 23.495	No CSK / Clearance for 2-56 Screw		20	2024 Aluminum Alloy / AGMA 10
# GS120-250-0305FM2350-A2	250	52.92 <i>2.083</i>	12.680 <i>0.499</i>	53.340 <i>2.100</i>	3.048 <i>0.120</i>	3 / 23.495	No CSK / Clearance for 2-56 Screw		20	2024 Aluminum Alloy / AGMA 10
# GS120-250-0305FM2350-3	250	52.92 <i>2.083</i>	12.680 <i>0.499</i>	53.340 <i>2.100</i>	3.048 <i>0.120</i>	3 / 23.495	No CSK / Clearance for 2-56 Screw		20	303 Stainless Steel / AGMA 10

# Indicates item not stocked at time of printing - Please enquire for lead time

E&OE Pricing and all details subject to change without notice - Copyright Miniature Bearings Australia Pty Ltd

MBA Size Listings are a guide to sizes only and must not be solely relied on for critical design information.



DISTRIBUTED BY

Ask us to put your name and address here

<http://www.minibearings.com.au/product>

Ph +61 7 3245 7977

Fax +61 7 3245 1017

Catalogue requests to [catalogues@minibearings.com.au](mailto:catalogues@minibearings.com.au)
