

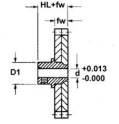

MBA

Gears - Spur - Antibacklash - Module 0.8



Steel - Stainless Steel - Aluminium - 20 Degree Pressure Angle.

Gears - Spur - Antibacklash - Module 0.8

Part Number	Teeth (No.)	Pitch Circle Diameter (PD) mm	Bore (d) mm	Outside Diameter (OD) mm	Face Width (fw) mm	Overall Width mm	Hub Diameter (D1) mm	Hub Proj / Locking Method mm	Spring Type	Material / Quality
		<i>inches</i>	<i>inches</i>	<i>inches</i>	<i>inches</i>	<i>inches</i>	<i>inches</i>	<i>inches</i>		
# GSA080-50-0800B1000-S4-HS	50	40.00	10.000		8.000	18.00	20.00	10.000 / Pin Hub - Set Screw	Torsion	AISI 4135 Steel - Hardened Teeth / ISO Class 5
		<i>1.575</i>	<i>0.394</i>		<i>0.315</i>	<i>0.709</i>	<i>0.787</i>			
# GSA080-50-0800B1000-A56-HS	50	40.00	10.000		8.000	18.00	20.00	10.000 / Pin Hub - Set Screw	Torsion	5056 Aluminium / ISO Class 8
		<i>1.575</i>	<i>0.394</i>		<i>0.315</i>	<i>0.709</i>	<i>0.787</i>			

Indicates item not stocked at time of printing - Please enquire for lead time

E&OE Pricing and all details subject to change without notice - Copyright Miniature Bearings Australia Pty Ltd

MBA Size Listings are a guide to sizes only and must not be solely relied on for critical design information.

Gears - Spur - Antibacklash - Module 0.8

Part Number	Teeth (No.)	Pitch Circle Diameter (PD) mm <i>inches</i>	Bore (d) mm <i>inches</i>	Outside Diameter (OD) mm <i>inches</i>	Face Width (fw) mm <i>inches</i>	Overall Width mm <i>inches</i>	Hub Diameter (D1) mm <i>inches</i>	Hub Proj / Locking Method mm <i>inches</i>	Spring Type	Material / Quality
# GSA080-60-0800B1000-S4-HS	60	48.00 <i>1.890</i>	10.000 <i>0.394</i>		8.000 <i>0.315</i>	18.00 <i>0.709</i>	20.00 <i>0.787</i>	10.000 / Pin Hub - Set Screw	Torsion	AISI 4135 Steel - Hardened Teeth / ISO Class 5
# GSA080-60-0800B1000-A56-HS	60	48.00 <i>1.890</i>	10.000 <i>0.394</i>		8.000 <i>0.315</i>	18.00 <i>0.709</i>	20.00 <i>0.787</i>	10.000 / Pin Hub - Set Screw	Torsion	5056 Aluminium / ISO Class 8
# GSA080-70-0800B1000-S4-HS	70	56.00 <i>2.205</i>	10.000 <i>0.394</i>		8.000 <i>0.315</i>	18.00 <i>0.709</i>	20.00 <i>0.787</i>	10.000 / Pin Hub - Set Screw	Torsion	AISI 4135 Steel - Hardened Teeth / ISO Class 5
# GSA080-70-0800B1000-A56-HS	70	56.00 <i>2.205</i>	10.000 <i>0.394</i>		8.000 <i>0.315</i>	18.00 <i>0.709</i>	20.00 <i>0.787</i>	10.000 / Pin Hub - Set Screw	Torsion	5056 Aluminium / ISO Class 8
# GSA080-80-0800B1000-S4-HS	80	64.00 <i>2.520</i>	10.000 <i>0.394</i>		8.000 <i>0.315</i>	18.00 <i>0.709</i>	20.00 <i>0.787</i>	10.000 / Pin Hub - Set Screw	Helical	AISI 4135 Steel - Hardened Teeth / ISO Class 5
# GSA080-80-0800B1000-1045-HS	80	64.00 <i>2.520</i>	10.000 <i>0.394</i>		8.000 <i>0.315</i>	18.00 <i>0.709</i>	20.00 <i>0.787</i>	10.000 / Pin Hub - Set Screw	Helical	AISI 1045 Steel - Tufftrided / ISO Class 8

Indicates item not stocked at time of printing - Please enquire for lead time

E&OE Pricing and all details subject to change without notice - Copyright Miniature Bearings Australia Pty Ltd

MBA Size Listings are a guide to sizes only and must not be solely relied on for critical design information.

Gears - Spur - Antibacklash - Module 0.8

Part Number	Teeth (No.)	Pitch Circle Diameter (PD) mm <i>inches</i>	Bore (d) mm <i>inches</i>	Outside Diameter (OD) mm <i>inches</i>	Face Width (fw) mm <i>inches</i>	Overall Width mm <i>inches</i>	Hub Diameter (D1) mm <i>inches</i>	Hub Proj / Locking Method mm <i>inches</i>	Spring Type	Material / Quality
# GSA080-90-0800B1000-S4-HS	90	72.00	10.000		8.000	18.00	20.00	10.000 / Pin Hub - Set Screw	Helical	AISI 4135 Steel - Hardened Teeth / ISO Class 5
		<i>2.835</i>	<i>0.394</i>		<i>0.315</i>	<i>0.709</i>	<i>0.787</i>			
# GSA080-90-0800B1000-1045-HS	90	72.00	10.000		8.000	18.00	20.00	10.000 / Pin Hub - Set Screw	Helical	AISI 1045 Steel - Tufftrided / ISO Class 8
		<i>2.835</i>	<i>0.394</i>		<i>0.315</i>	<i>0.709</i>	<i>0.787</i>			
# GSA080-100-0800B1000-S4-HS	100	80.00	10.000		8.000	18.00	24.00	10.000 / Pin Hub - Set Screw	Helical	AISI 4135 Steel - Hardened Teeth / ISO Class 5
		<i>3.150</i>	<i>0.394</i>		<i>0.315</i>	<i>0.709</i>	<i>0.945</i>			
# GSA080-100-0800B1000-1045-HS	100	80.00	10.000		8.000	18.00	24.00	10.000 / Pin Hub - Set Screw	Helical	AISI 1045 Steel - Tufftrided / ISO Class 8
		<i>3.150</i>	<i>0.394</i>		<i>0.315</i>	<i>0.709</i>	<i>0.945</i>			
# GSA080-120-0800B1000-S4-HS	120	96.00	10.000		8.000	18.00	24.00	10.000 / Pin Hub - Set Screw	Helical	AISI 4135 Steel - Hardened Teeth / ISO Class 5
		<i>3.780</i>	<i>0.394</i>		<i>0.315</i>	<i>0.709</i>	<i>0.945</i>			

Indicates item not stocked at time of printing - Please enquire for lead time

E&OE Pricing and all details subject to change without notice - Copyright Miniature Bearings Australia Pty Ltd

MBA Size Listings are a guide to sizes only and must not be solely relied on for critical design information.

Gears - Spur - Antibacklash - Module 0.8

Part Number	Teeth (No.)	Pitch Circle Diameter (PD) mm	Bore (d) mm	Outside Diameter (OD) mm	Face Width (fw) mm	Overall Width mm	Hub Diameter (D1) mm	Hub Proj / Locking Method mm	Spring Type	Material / Quality
		<i>inches</i>	<i>inches</i>	<i>inches</i>	<i>inches</i>	<i>inches</i>	<i>inches</i>	<i>inches</i>		
# GSA080-120-0800B1000-1045-HS	120	96.00	10.000		8.000	18.00	24.00	10.000 / Pin Hub - Set Screw	Helical	AISI 1045 Steel - Tufftrided / ISO Class 8
		<i>3.780</i>	<i>0.394</i>		<i>0.315</i>	<i>0.709</i>	<i>0.945</i>			

Indicates item not stocked at time of printing - Please enquire for lead time

E&OE Pricing and all details subject to change without notice - Copyright Miniature Bearings Australia Pty Ltd

MBA Size Listings are a guide to sizes only and must not be solely relied on for critical design information.



DISTRIBUTED BY

Ask us to put your name and address here

<http://www.minibearings.com.au/product>

Ph +61 7 3245 7977

Fax +61 7 3245 1017

Catalogue requests to catalogues@minibearings.com.au
