

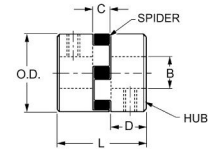

MBA

Hobby Couplings - Jaw Type



A small selection of jaw type couplings.

Angular Offset = 1 Deg. Max.

Parallel Offset = 0.381mm Max.

Max Recommended Speed 3600 RPM.

Hobby Couplings - Jaw Type

Part Number	Outside Diameter (OD) mm	Bore (B) mm	Overall Length (L) mm	Description	Windup at Maximum Torque Deg	Max. Torque N.m	KW at 1800 RPM KW	KW at 3600 RPM KW
	<i>inches</i>	<i>inches</i>	<i>inches</i>					
CRS16x03.18-COM	15.9 <i>0.626</i>	3.175 <i>0.125</i>	20.638 <i>0.813</i>	Complete	5.000	0.395	0.075	0.15
# CRS16x04.78-COM	15.9 <i>0.626</i>	4.775 <i>0.188</i>	20.638 <i>0.813</i>	Complete	5.000	0.395	0.075	0.15
# CRS16x06.35-COM	15.9 <i>0.626</i>	6.350 <i>0.250</i>	20.638 <i>0.813</i>	Complete	5.000	0.395	0.075	0.15
CRS16x07.95-COM	15.9 <i>0.626</i>	7.950 <i>0.313</i>	20.638 <i>0.813</i>	Complete	5.000	0.395	0.075	0.15

Indicates item not stocked at time of printing - Please enquire for lead time

E&OE Pricing and all details subject to change without notice - Copyright Miniature Bearings Australia Pty Ltd

MBA Size Listings are a guide to sizes only and must not be solely relied on for critical design information.

Hobby Couplings - Jaw Type

Part Number	Outside Diameter (OD) mm	Bore (B) mm	Overall Length (L) mm	Description	Windup at Maximum Torque Deg	Max. Torque N.m	KW at 1800 RPM KW	KW at 3600 RPM KW
	<i>inches</i>	<i>inches</i>	<i>inches</i>					
CRS16x09.53-COM	15.9 <i>0.626</i>	9.525 <i>0.375</i>	20.638 <i>0.813</i>	Complete	5.000	0.395	0.075	0.15
# CRS27x06.35-COM	27.4 <i>1.079</i>	6.350 <i>0.250</i>	43.656 <i>1.719</i>	Complete	4.500	2.972	0.56	1.1
# CRS27x07.95-COM	27.4 <i>1.079</i>	7.950 <i>0.313</i>	43.656 <i>1.719</i>	Complete	4.500	2.972	0.56	1.1
# CRS27x09.53-COM	27.4 <i>1.079</i>	9.525 <i>0.375</i>	43.656 <i>1.719</i>	Complete	4.500	2.972	0.56	1.1
# CRS27x11.13-COM	27.4 <i>1.079</i>	11.125 <i>0.438</i>	43.656 <i>1.719</i>	Complete	4.500	2.972	0.56	1.1
# CRS27x12.70-COM	27.4 <i>1.079</i>	12.700 <i>0.500</i>	43.656 <i>1.719</i>	Complete	4.500	2.972	0.56	1.1
# CRS35x09.53-COM	34.5 <i>1.358</i>	9.525 <i>0.375</i>	50.800 <i>2.000</i>	Complete	3.500	4.881	32.2	64.4
CRS35x11.13-COM	34.5 <i>1.358</i>	11.125 <i>0.438</i>	50.800 <i>2.000</i>	Complete	3.500	4.881	32.2	64.4
CRS35x12.70-COM	34.5 <i>1.358</i>	12.700 <i>0.500</i>	50.800 <i>2.000</i>	Complete	3.500	4.881	32.2	64.4
CRS44x06.35-COM	44.5 <i>1.752</i>	6.350 <i>0.250</i>	53.975 <i>2.125</i>	Complete	4.700	10.169	67.1	134.2

Indicates item not stocked at time of printing - Please enquire for lead time

E&OE Pricing and all details subject to change without notice - Copyright Miniature Bearings Australia Pty Ltd

MBA Size Listings are a guide to sizes only and must not be solely relied on for critical design information.

Hobby Couplings - Jaw Type

Part Number	Outside Diameter (OD) mm	Bore (B) mm	Overall Length (L) mm	Description	Windup at Maximum Torque Deg	Max. Torque N.m	KW at 1800 RPM KW	KW at 3600 RPM KW
	<i>inches</i>	<i>inches</i>	<i>inches</i>					
CRS44x07.95-COM	44.5 <i>1.752</i>	7.950 <i>0.313</i>	53.975 <i>2.125</i>	Complete	4.700	10.169	67.1	134.2
CRS44x09.53-COM	44.5 <i>1.752</i>	9.525 <i>0.375</i>	53.975 <i>2.125</i>	Complete	4.700	10.169	67.1	134.2
# CRS44x11.13-COM	44.5 <i>1.752</i>	11.125 <i>0.438</i>	53.975 <i>2.125</i>	Complete	4.700	10.169	67.1	134.2
# CRS44x12.70-COM	44.5 <i>1.752</i>	12.700 <i>0.500</i>	53.975 <i>2.125</i>	Complete	4.700	10.169	67.1	134.2
CRS54x06.35-COM	53.6 <i>2.110</i>	6.350 <i>0.250</i>	53.975 <i>2.125</i>	Complete	3.200	16.271	107.4	214.8
CRS54x07.95-COM	53.6 <i>2.110</i>	7.950 <i>0.313</i>	53.975 <i>2.125</i>	Complete	3.200	16.271	107.4	214.8
CRS54x09.53-COM	53.6 <i>2.110</i>	9.525 <i>0.375</i>	53.975 <i>2.125</i>	Complete	3.200	16.271	107.4	214.8
CRS54x11.13-COM	53.6 <i>2.110</i>	11.125 <i>0.438</i>	53.975 <i>2.125</i>	Complete	3.200	16.271	107.4	214.8
CRS54x12.70-COM	53.6 <i>2.110</i>	12.700 <i>0.500</i>	53.975 <i>2.125</i>	Complete	3.200	16.271	107.4	214.8

Indicates item not stocked at time of printing - Please enquire for lead time

E&OE Pricing and all details subject to change without notice - Copyright Miniature Bearings Australia Pty Ltd

MBA Size Listings are a guide to sizes only and must not be solely relied on for critical design information.



DISTRIBUTED BY

Ask us to put your name and address here

<http://www.minibearings.com.au/product>

Ph +61 7 3245 7977

Fax +61 7 3245 1017

Catalogue requests to catalogues@minibearings.com.au
