



MBA

Hobby Gears - Worm and Wheel 40 : 1 Metal

A small selection of popular sizes.

See main listings for sizes not shown here.

Select the gear and the worm to complete the set.

1 start 40 tooth gear.

GEARS

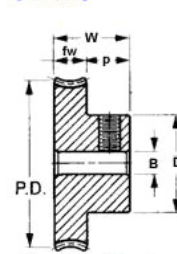

Gear with hub & set screw
TYPE G1

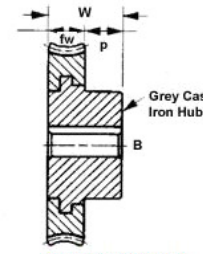

Gear with cast iron hub
Type G2

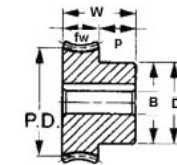
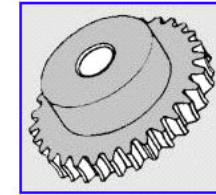

Gear with hub - No setscrew
Type G3

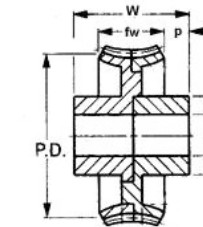

Two piece gear
Type G4

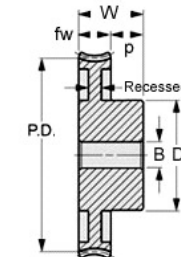

Gear with recessed centre
Type G5 (no setscrew)

WORMS

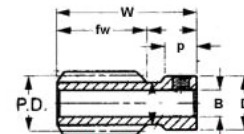

Worm with hub and set screw
Type W1

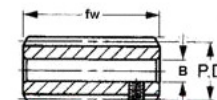

Worm with no hub
Type W4 (locking - refer tables)

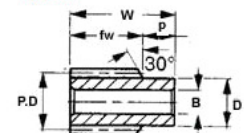
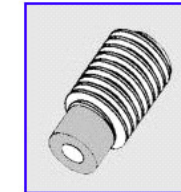

Worm with hub - no set screw
Type W2

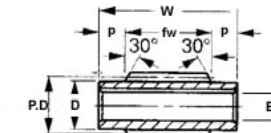

Worm with double hub
Type W3 (no set screw)

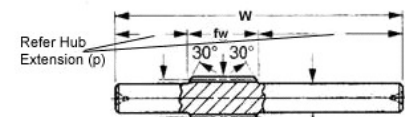

Worm with integral shaft
Type W5
Refer Hub Extension (p)
Shaft Diameter Listed instead of Bore

Indicates item not stocked at time of printing - Please enquire for lead time

E&OE Pricing and all details subject to change without notice - Copyright Miniature Bearings Australia Pty Ltd

MBA Size Listings are a guide to sizes only and must not be solely relied on for critical design information.

Hobby Gears - Worm and Wheel 40 : 1 Metal

Part Number	Gear or Worm	Teeth / PCD (No. / mm)	Direction	Starts	Bore (B) mm	Overall Width or Length (w) mm	Face Width (fw) mm	Hub Diameter / Locking Method mm	Quality / Material	Hub Projection (p) mm
					<i>inches</i>	<i>inches</i>	<i>inches</i>	<i>inches</i>		<i>inches</i>
WG1R1.0-2-040-16HP1000-NY	Gear with double hub / 2 Piece Construction	40 / 40.00	Right Hand	Single / Type G4	10.000	28.000	16.000	19.000 / No Licking Method	Commercial / Nylon Moulded	6.000
					<i>0.394</i>	<i>1.102</i>	<i>0.630</i>			<i>0.236</i>
WM1R1.0-2-034DP10.00-DCZ	Worm with Double Hub	- / 20.000	Right Hand	Single / Type W3	10.000	34.000	17.000	17.000 / No Locking	ISO 8 / Zinc Die Cast	8.5 / 8.5
					<i>0.394</i>	<i>1.339</i>	<i>0.669</i>			

Indicates item not stocked at time of printing - Please enquire for lead time

E&OE Pricing and all details subject to change without notice - Copyright Miniature Bearings Australia Pty Ltd

MBA Size Listings are a guide to sizes only and must not be solely relied on for critical design information.



DISTRIBUTED BY

Ask us to put your name and address here

<http://www.minibearings.com.au/product>

Ph +61 7 3245 7977

Fax +61 7 3245 1017

Catalogue requests to catalogues@minibearings.com.au
