



MBA

Hobby Gears - Worm and Wheel 50 : 1 Plastic

A small selection of popular sizes.

See main listings for sizes not shown here.

Select the gear and the worm to complete the set.

1 start 50 tooth gear.

GEARS

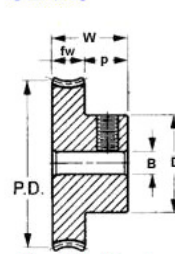

Gear with hub & set screw
TYPE G1

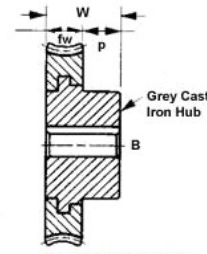

Gear with cast iron hub
Type G2

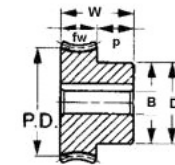
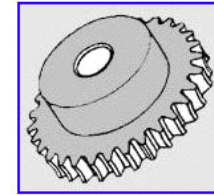

Gear with hub - No setscrew
Type G3

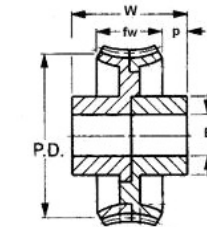

Two piece gear
Type G4

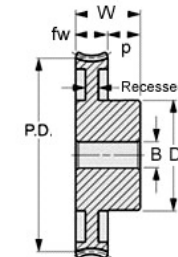

Gear with recessed centre
Type G5 (no setscrew)

WORMS

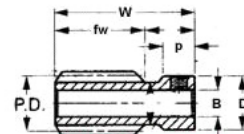

Worm with hub and set screw
Type W1

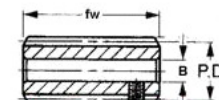

Worm with no hub
Type W4 (locking - refer tables)

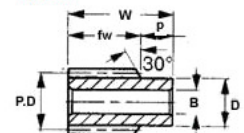
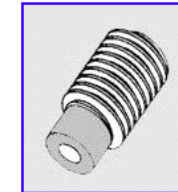

Worm with hub - no set screw
Type W2

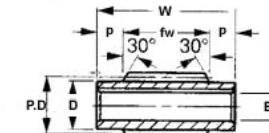

Worm with double hub
Type W3 (no set screw)

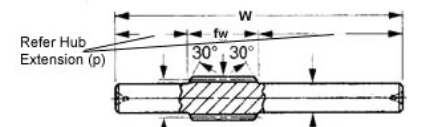

Worm with integral shaft
Type W5

Indicates item not stocked at time of printing - Please enquire for lead time

E&OE Pricing and all details subject to change without notice - Copyright Miniature Bearings Australia Pty Ltd

MBA Size Listings are a guide to sizes only and must not be solely relied on for critical design information.

Hobby Gears - Worm and Wheel 50 : 1 Plastic

Part Number	Gear or Worm	Teeth / PCD (No. / mm)	Direction	Starts	Bore (B) mm <i>inches</i>	Overall Width or Length (w) mm <i>inches</i>	Face Width (fw) mm <i>inches</i>	Hub Diameter / Locking Method mm <i>inches</i>	Quality / Material	Hub Projection (p) mm <i>inches</i>
WG1R24-1-050-06HP0793-NYB	Gear with Hub	50 / 52.91	Right Hand	Single / Type G3	7.925 <i>0.312</i>	14.288 <i>0.563</i>	6.350 <i>0.250</i>	19.05 / No Set Screw	Commercial / Mineral Filled Black Nylon	7.94 <i>0.313</i>
WG1R32-1-050-05HP0635-ACE	Gear with Hub	50 / 39.675	Right Hand	Single / Type G3	6.350 <i>0.250</i>	12.700 <i>0.500</i>	4.762 <i>0.187</i>	15.87 / No Set Screw	Commercial / Acetal	7.94 <i>0.313</i>
WM1R32-1-021HP04.76-NY	Worm with Single Hub	- / 11.125	Right Hand	Single / Type W2	4.762 <i>0.187</i>	21.034 <i>0.828</i>	16.272 <i>0.641</i>	8.128 / No Locking	Commercial / Acetal	4.762 <i>0.187</i>
WM1R24-1-023HP04.76-NY	Worm with Single Hub	- / 12.700	Right Hand	Single / Type W2	4.762 <i>0.187</i>	22.622 <i>0.891</i>	16.271 <i>0.641</i>	9.398 / No Locking	Commercial / Nylon	6.350 <i>0.250</i>

Indicates item not stocked at time of printing - Please enquire for lead time

E&OE Pricing and all details subject to change without notice - Copyright Miniature Bearings Australia Pty Ltd

MBA Size Listings are a guide to sizes only and must not be solely relied on for critical design information.



DISTRIBUTED BY

Ask us to put your name and address here

<http://www.minibearings.com.au/product>

Ph +61 7 3245 7977

Fax +61 7 3245 1017

Catalogue requests to catalogues@minibearings.com.au

