

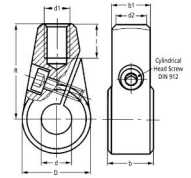

MBA

Hubs - Split



Can be fit easily to spindles with no prior machining.
Spindle tolerance should be lower than or equal to H11.

Hubs - Split

Part Number	Overall Diameter (D) mm <i>inches</i>	Mounting Hole Dia. (d) mm <i>inches</i>	Width (b +/- 0.2) mm <i>inches</i>	Thread Size (d1) mm <i>inches</i>	Screw Length (l) mm <i>inches</i>	Centre height (R) mm <i>inches</i>	b1 mm <i>inches</i>	d2 mm <i>inches</i>	Weight gm
# GN.20101	24.00 <i>0.945</i>	10.00 <i>0.394</i>	15.50 <i>0.610</i>	M8	11.00 <i>0.433</i>	36.00 <i>1.417</i>	13.00 <i>0.512</i>	10.00 <i>0.394</i>	64
# GN.20111	28.00 <i>1.102</i>	12.00 <i>0.472</i>	17.50 <i>0.689</i>	M10	14.00 <i>0.551</i>	41.00 <i>1.614</i>	15.00 <i>0.591</i>	12.00 <i>0.472</i>	108
# GN.20121	32.00 <i>1.260</i>	14.00 <i>0.551</i>	19.50 <i>0.768</i>	M12	16.00 <i>0.630</i>	45.00 <i>1.772</i>	17.00 <i>0.669</i>	14.00 <i>0.551</i>	143

Indicates item not stocked at time of printing - Please enquire for lead time
E&OE Pricing and all details subject to change without notice - Copyright Miniature Bearings Australia Pty Ltd
MBA Size Listings are a guide to sizes only and must not be solely relied on for critical design information.



DISTRIBUTED BY

Ask us to put your name and address here

<http://www.minibearings.com.au/product>

Ph +61 7 3245 7977

Fax +61 7 3245 1017

Catalogue requests to catalogues@minibearings.com.au
