

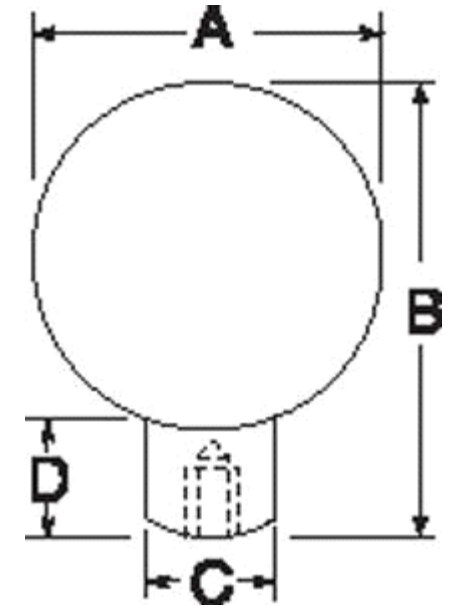

MBA

Knobs - Ball - Threaded - Phenolic with Shank



Knobs - Ball - Threaded - Phenolic with Shank

| Part Number | Diameter (A) mm <i>inches</i> | Height (B) mm <i>inches</i> | Shank Diameter (C) mm <i>inches</i> | Shank Height (D) mm <i>inches</i> | Thread Size | Thread Type |
|-------------|----------------------------------|--------------------------------|--|--------------------------------------|---------------|-------------|
| # DK-345RS | 16.89 <i>0.665</i> | 22.23 <i>0.875</i> | 9.53 <i>0.375</i> | 6.35 <i>0.250</i> | 10-32 x 3/8 | Brass |
| # DK-340RS | 16.89 <i>0.665</i> | 22.23 <i>0.875</i> | 9.53 <i>0.375</i> | 6.35 <i>0.250</i> | 8-32 x 1/4 | Brass |
| # DK-360RS | 31.75 <i>1.250</i> | 38.1 <i>1.500</i> | 13.49 <i>0.531</i> | 6.35 <i>0.250</i> | 3/8-16 x 5/8 | Tapped |
| # DK-355RS | 31.75 <i>1.250</i> | 38.1 <i>1.500</i> | 13.49 <i>0.531</i> | 6.35 <i>0.250</i> | 5/16-18 x 1/2 | Brass |

Indicates item not stocked at time of printing - Please enquire for lead time

E&OE Pricing and all details subject to change without notice - Copyright Miniature Bearings Australia Pty Ltd

MBA Size Listings are a guide to sizes only and must not be solely relied on for critical design information.

Knobs - Ball - Threaded - Phenolic with Shank

| Part Number | Diameter (A) mm <i>inches</i> | Height (B) mm <i>inches</i> | Shank Diameter (C) mm <i>inches</i> | Shank Height (D) mm <i>inches</i> | Thread Size | Thread Type |
|-------------|----------------------------------|--------------------------------|--|--------------------------------------|---------------|-------------|
| # DK-350RS | 31.75 <i>1.250</i> | 38.1 <i>1.500</i> | 13.49 <i>0.531</i> | 6.35 <i>0.250</i> | 1/4-20 x 3/8 | Brass |
| # DK-375RS | 38.1 <i>1.500</i> | 46.04 <i>1.813</i> | 15.88 <i>0.625</i> | 7.94 <i>0.313</i> | 1/4-20 x 3/8 | Tapped |
| # DK-370RS | 38.1 <i>1.500</i> | 46.04 <i>1.813</i> | 15.88 <i>0.625</i> | 7.94 <i>0.313</i> | 3/8-16 x 5/8 | Brass |
| # DK-365RS | 38.1 <i>1.500</i> | 46.04 <i>1.813</i> | 15.88 <i>0.625</i> | 7.94 <i>0.313</i> | 5/16-18 x 1/2 | Brass |
| # DK-385RS | 43.66 <i>1.719</i> | 28.58 <i>1.125</i> | 19.84 <i>0.781</i> | 12.70 <i>0.500</i> | 1/2-13 x 7/8 | Moulded |
| # DK-380RS | 43.66 <i>1.719</i> | 28.58 <i>1.125</i> | 19.84 <i>0.781</i> | 12.70 <i>0.500</i> | 3/8-16 x 5/8 | Brass |

Indicates item not stocked at time of printing - Please enquire for lead time

E&OE Pricing and all details subject to change without notice - Copyright Miniature Bearings Australia Pty Ltd

MBA Size Listings are a guide to sizes only and must not be solely relied on for critical design information.



DISTRIBUTED BY

Ask us to put your name and address here

<http://www.minibearings.com.au/product>

Ph +61 7 3245 7977

Fax +61 7 3245 1017

Catalogue requests to catalogues@minibearings.com.au

| | | | | | |
|--|--|--|--|--|--|
| | | | | | |
| | | | | | |
| | | | | | |