

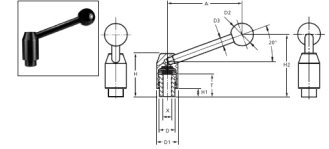

MBA

Levers - Safety Tension



Steel Parts: Quality class 5.8.

Ball Knob: Black plastic.

Surface Finish: Burnished.

Press the handle down until the teeth are fully engaged. The object can now be clamped or released.

Spring pressure releases the locking mechanism immediately, restoring the safety function (handle can be turned effortlessly).

Levers - Safety Tension

Part Number	Internal Thread Size mm <i>inches</i>	Angle DEG	Centre Ball Width mm <i>inches</i>	BaseDiameter (D / D1) mm <i>inches</i>	Shaft Diameter (D3) mm <i>inches</i>	Ball Diameter (D2) mm <i>inches</i>	Thread Length mm <i>inches</i>	Base Height (H / H1) mm <i>inches</i>	Centre Ball Height (H2 / H3) mm <i>inches</i>	Material
# STL01IM8	M8	20.00	81.00 <i>3.189</i>	17 / 24 <i>0.669</i>	10.00 <i>0.394</i>	25.00 <i>0.984</i>	23.00 <i>0.906</i>	49 / 9 <i>1.929</i>	69.00 <i>2.717</i>	Steel and Plastic Ball
# STL01IM10	M10	20.00	81.00 <i>3.189</i>	17 / 24 <i>0.669</i>	10.00 <i>0.394</i>	25.00 <i>0.984</i>	23.00 <i>0.906</i>	49 / 9 <i>1.929</i>	69.00 <i>2.717</i>	Steel and Plastic Ball

Indicates item not stocked at time of printing - Please enquire for lead time

E&OE Pricing and all details subject to change without notice - Copyright Miniature Bearings Australia Pty Ltd

MBA Size Listings are a guide to sizes only and must not be solely relied on for critical design information.

Levers - Safety Tension

Part Number	Internal Thread Size mm <i>inches</i>	Angle DEG	Centre Ball Width mm <i>inches</i>	BaseDiameter (D / D1) mm <i>inches</i>	Shaft Diameter (D3) mm <i>inches</i>	Ball Diameter (D2) mm <i>inches</i>	Thread Length mm <i>inches</i>	Base Height (H / H1) mm <i>inches</i>	Centre Ball Height (H2 / H3) mm <i>inches</i>	Material
# STL02IM10	M10	20.00	99.00 <i>3.898</i>	20 / 28 <i>0.787</i>	11.00 <i>0.433</i>	30.00 <i>1.181</i>	26.00 <i>1.024</i>	57 / 11 <i>2.244</i>	82.00 <i>3.228</i>	Steel and Plastic Ball
# STL02IM12	M12	20.00	99.00 <i>3.898</i>	20 / 28 <i>0.787</i>	11.00 <i>0.433</i>	30.00 <i>1.181</i>	26.00 <i>1.024</i>	57 / 11 <i>2.244</i>	82.00 <i>3.228</i>	Steel and Plastic Ball
# STL03IM12	M12	20.00	118.00 <i>4.646</i>	24 / 33 <i>0.945</i>	12.00 <i>0.472</i>	32.00 <i>1.260</i>	30.00 <i>1.181</i>	64 / 12 <i>2.520</i>	94.00 <i>3.701</i>	Steel and Plastic Ball
# STL03IM16	M16	20.00	118.00 <i>4.646</i>	24 / 33 <i>0.945</i>	12.00 <i>0.472</i>	32.00 <i>1.260</i>	30.00 <i>1.181</i>	64 / 12 <i>2.520</i>	94.00 <i>3.701</i>	Steel and Plastic Ball

Indicates item not stocked at time of printing - Please enquire for lead time

E&OE Pricing and all details subject to change without notice - Copyright Miniature Bearings Australia Pty Ltd

MBA Size Listings are a guide to sizes only and must not be solely relied on for critical design information.



DISTRIBUTED BY

Ask us to put your name and address here

<http://www.minibearings.com.au/product>

Ph +61 7 3245 7977

Fax +61 7 3245 1017

Catalogue requests to catalogues@minibearings.com.au
