

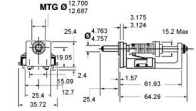

# MBA

## Limit Stops - Electromagnetic



### Adjustable Limits.

Material: Cast aluminium, black anodised.

Shaft: Stainless Steel.

Ball bearings used throughout.

Four miniature single pole double throw switches.

Two adjusting screws to permit simple accurate adjustment of the miniature switch actuators.

## Limit Stops - Electromagnetic

Part Number	Rotation Limit Degrees	Max. Torque Capacity N.m	Overall Length mm <i>inches</i>	Overall Width mm <i>inches</i>
# ELS-0150-0450	150 - 450	1.059	91.262 <i>3.593</i>	35.712 <i>1.406</i>
# ELS-0450-0750	450 - 750	1.059	91.262 <i>3.593</i>	35.712 <i>1.406</i>
# ELS-0750-1050	750 - 1050	1.059	91.262 <i>3.593</i>	35.712 <i>1.406</i>

# Indicates item not stocked at time of printing - Please enquire for lead time

E&OE Pricing and all details subject to change without notice - Copyright Miniature Bearings Australia Pty Ltd

MBA Size Listings are a guide to sizes only and must not be solely relied on for critical design information.

## Limit Stops - Electromagnetic

Part Number	Rotation Limit Degrees	Max. Torque Capacity N.m	Overall Length mm <i>inches</i>	Overall Width mm <i>inches</i>
# ELS-1050-1350	1050 - 1350	1.059	91.262 <i>3.593</i>	35.712 <i>1.406</i>
# ELS-1350-1650	1350 - 1650	1.059	91.262 <i>3.593</i>	35.712 <i>1.406</i>
# ELS-1650-1950	1650 - 1950	1.059	91.262 <i>3.593</i>	35.712 <i>1.406</i>
# ELS-1950-2250	1950 - 2250	1.059	91.262 <i>3.593</i>	35.712 <i>1.406</i>
# ELS-2250-2550	2250 - 2550	1.059	91.262 <i>3.593</i>	35.712 <i>1.406</i>
# ELS-2550-2850	2550 - 2850	1.059	91.262 <i>3.593</i>	35.712 <i>1.406</i>
# ELS-2850-3150	2850 - 3150	1.059	91.262 <i>3.593</i>	35.712 <i>1.406</i>
# ELS-3150-3450	3150 - 3450	1.059	91.262 <i>3.593</i>	35.712 <i>1.406</i>
# ELS-3450-3750	3450 - 3750	1.059	91.262 <i>3.593</i>	35.712 <i>1.406</i>
# ELS-3750-4050	3750 - 4050	1.059	91.262 <i>3.593</i>	35.712 <i>1.406</i>

# Indicates item not stocked at time of printing - Please enquire for lead time  
 E&OE Pricing and all details subject to change without notice - Copyright Miniature Bearings Australia Pty Ltd  
 MBA Size Listings are a guide to sizes only and must not be solely relied on for critical design information.

## Limit Stops - Electromagnetic

Part Number	Rotation Limit Degrees	Max. Torque Capacity N.m	Overall Length mm	Overall Width mm
			<i>inches</i>	<i>inches</i>
# ELS-4050-4350	4050 - 4350	1.059	91.262 <i>3.593</i>	35.712 <i>1.406</i>
# ELS-4350-4650	4350 - 4650	1.059	91.262 <i>3.593</i>	35.712 <i>1.406</i>
# ELS-4650-4950	4650 - 4950	1.059	91.262 <i>3.593</i>	35.712 <i>1.406</i>
# ELS-4950-5250	4950 - 5250	1.059	91.262 <i>3.593</i>	35.712 <i>1.406</i>
# ELS-5250-5550	5250 - 5550	1.059	91.262 <i>3.593</i>	35.712 <i>1.406</i>
# ELS-5550-5850	5550 - 5850	1.059	91.262 <i>3.593</i>	35.712 <i>1.406</i>
# ELS-5850-6150	5850 - 6150	1.059	91.262 <i>3.593</i>	35.712 <i>1.406</i>
# ELS-6150-6450	6150 - 6450	1.059	91.262 <i>3.593</i>	35.712 <i>1.406</i>
# ELS-6450-6750	6450 - 6750	1.059	91.262 <i>3.593</i>	35.712 <i>1.406</i>
# ELS-6750-7050	6750 - 7050	1.059	91.262 <i>3.593</i>	35.712 <i>1.406</i>

# Indicates item not stocked at time of printing - Please enquire for lead time

E&OE Pricing and all details subject to change without notice - Copyright Miniature Bearings Australia Pty Ltd

MBA Size Listings are a guide to sizes only and must not be solely relied on for critical design information.

## Limit Stops - Electromagnetic

Part Number	Rotation Limit Degrees	Max. Torque Capacity N.m	Overall Length mm <i>inches</i>	Overall Width mm <i>inches</i>
# ELS-7050-7350	7050 - 7350	1.059	91.262 <i>3.593</i>	35.712 <i>1.406</i>
# ELS-7350-7650	7350 - 7650	1.059	91.262 <i>3.593</i>	35.712 <i>1.406</i>
# ELS-7650-7950	7650 - 7950	1.059	91.262 <i>3.593</i>	35.712 <i>1.406</i>
# ELS-7950-8250	7950 - 8250	1.059	91.262 <i>3.593</i>	35.712 <i>1.406</i>
# ELS-8250-8550	8250 - 8550	1.059	91.262 <i>3.593</i>	35.712 <i>1.406</i>
# ELS-8550-8850	8550 - 8850	1.059	91.262 <i>3.593</i>	35.712 <i>1.406</i>
# ELS-8850-9150	8850 - 9150	1.059	91.262 <i>3.593</i>	35.712 <i>1.406</i>
# ELS-9150-9450	9150 - 9450	1.059	91.262 <i>3.593</i>	35.712 <i>1.406</i>
# ELS-9450-9750	9450 - 9750	1.059	91.262 <i>3.593</i>	35.712 <i>1.406</i>
# ELS-9750-1005	9750 - 1005	1.059	91.262 <i>3.593</i>	35.712 <i>1.406</i>

# Indicates item not stocked at time of printing - Please enquire for lead time  
 E&OE Pricing and all details subject to change without notice - Copyright Miniature Bearings Australia Pty Ltd  
 MBA Size Listings are a guide to sizes only and must not be solely relied on for critical design information.

## Limit Stops - Electromagnetic

Part Number	Rotation Limit Degrees	Max. Torque Capacity N.m	Overall Length mm <i>inches</i>	Overall Width mm <i>inches</i>
# ELS-0000-0150	0 - 150	1.059	91.262 <i>3.593</i>	35.712 <i>1.406</i>
# ELS-10050-10350	10050 - 10350	1.059	91.262 <i>3.593</i>	35.712 <i>1.406</i>
# ELS-10350-10650	10350 - 10650	1.059	91.262 <i>3.593</i>	35.712 <i>1.406</i>
# ELS-10650-10950	10650 - 10950	1.059	91.262 <i>3.593</i>	35.712 <i>1.406</i>
# ELS-10950-11250	10950 - 11250	1.059	91.262 <i>3.593</i>	35.712 <i>1.406</i>
# ELS-11250-11550	11250 - 11550	1.059	91.262 <i>3.593</i>	35.712 <i>1.406</i>
# ELS-11550-11850	11550 - 11850	1.059	91.262 <i>3.593</i>	35.712 <i>1.406</i>
# ELS-11850-12150	11850 - 12150	1.059	91.262 <i>3.593</i>	35.712 <i>1.406</i>
# ELS-12150-12450	12150 - 12450	1.059	91.262 <i>3.593</i>	35.712 <i>1.406</i>
# ELS-12450-12750	12450 - 12750	1.059	91.262 <i>3.593</i>	35.712 <i>1.406</i>

# Indicates item not stocked at time of printing - Please enquire for lead time  
 E&OE Pricing and all details subject to change without notice - Copyright Miniature Bearings Australia Pty Ltd  
 MBA Size Listings are a guide to sizes only and must not be solely relied on for critical design information.

## Limit Stops - Electromagnetic

Part Number	Rotation Limit Degrees	Max. Torque Capacity N.m	Overall Length mm <i>inches</i>	Overall Width mm <i>inches</i>
# ELS-12750-13050	12750 - 13050	1.059	91.262 <i>3.593</i>	35.712 <i>1.406</i>
# ELS-13050-13350	13050 - 13350	1.059	91.262 <i>3.593</i>	35.712 <i>1.406</i>
# ELS-13350-13650	13350 - 13650	1.059	91.262 <i>3.593</i>	35.712 <i>1.406</i>
# ELS-13650-13950	13650 - 13950	1.059	91.262 <i>3.593</i>	35.712 <i>1.406</i>
# ELS-13950-14250	13950 - 14250	1.059	91.262 <i>3.593</i>	35.712 <i>1.406</i>
# ELS-14250-14550	14250 - 14550	1.059	91.262 <i>3.593</i>	35.712 <i>1.406</i>
# ELS-14550-14850	14550 - 14850	1.059	91.262 <i>3.593</i>	35.712 <i>1.406</i>
# ELS-14850-15150	14850 - 15150	1.059	91.262 <i>3.593</i>	35.712 <i>1.406</i>

# Indicates item not stocked at time of printing - Please enquire for lead time  
 E&OE Pricing and all details subject to change without notice - Copyright Miniature Bearings Australia Pty Ltd  
 MBA Size Listings are a guide to sizes only and must not be solely relied on for critical design information.



DISTRIBUTED BY

Ask us to put your name and address here

<http://www.minibearings.com.au/product>

Ph +61 7 3245 7977

Fax +61 7 3245 1017

Catalogue requests to [catalogues@minibearings.com.au](mailto:catalogues@minibearings.com.au)

