

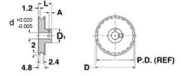

MBA

Pulleys - Posi-Drive - 4.00 mm Circular Pitch



Same as US 20 Pitch - Use with Single Core Belts.

Use with Single Core Posi-Drive Belts.

3.990mm Circular Pitch. Same as US 20 Pitch.

Pulleys - Posi-Drive - 4.00 mm Circular Pitch

Part Number	Teeth No.	Bore mm	Outside Diameter mm	Material	Locking Type	Suit Belt Type mm	Pitch Diameter mm	Face Width mm	Overall Length mm	Hub Diameter
		<i>inches</i>	<i>inches</i>			<i>inches</i>	<i>inches</i>	<i>inches</i>	<i>inches</i>	
# PDP040-010-03.18-AL-P	10	3.175	14.275	2024-T4 Aluminum	Pin Hub	Single Core	12.700	4.750	9.525	7.925
		<i>0.125</i>	<i>0.562</i>				<i>0.500</i>	<i>0.187</i>	<i>0.375</i>	
# PDP040-010-03.18-303-P	10	3.175	14.275	303 Stainless Steel	Pin Hub	Single Core	12.700	4.750	9.525	7.925
		<i>0.125</i>	<i>0.562</i>				<i>0.500</i>	<i>0.187</i>	<i>0.375</i>	
# PDP040-010-04.00-303-P	10	4.000	14.300	303 Stainless Steel	Pin Hub	Single Core	12.700	4.800	10.300	9.500
		<i>0.157</i>	<i>0.563</i>				<i>0.500</i>	<i>0.189</i>	<i>0.406</i>	

Indicates item not stocked at time of printing - Please enquire for lead time
 E&OE Pricing and all details subject to change without notice - Copyright Miniature Bearings Australia Pty Ltd
 MBA Size Listings are a guide to sizes only and must not be solely relied on for critical design information.

Pulleys - Posi-Drive - 4.00 mm Circular Pitch

Part Number	Teeth No.	Bore mm	Outside Diameter mm	Material	Locking Type	Suit Belt Type mm	Pitch Diameter mm	Face Width mm	Overall Length mm	Hub Diameter
		<i>inches</i>	<i>inches</i>			<i>inches</i>	<i>inches</i>	<i>inches</i>	<i>inches</i>	
# PDP040-010-04.00-AL-P	10	4.000	14.300	2024-T4 Aluminum	Pin Hub	Single Core	12.700	4.800	10.300	9.500
		<i>0.157</i>	<i>0.563</i>				<i>0.500</i>	<i>0.189</i>	<i>0.406</i>	
# PDP040-010-04.76-303-P	10	4.762	14.275	303 Stainless Steel	Pin Hub	Single Core	12.700	4.750	10.312	9.525
		<i>0.187</i>	<i>0.562</i>				<i>0.500</i>	<i>0.187</i>	<i>0.406</i>	
# PDP040-010-04.76-AL-P	10	4.762	14.275	2024-T4 Aluminum	Pin Hub	Single Core	12.700	4.750	10.312	9.525
		<i>0.187</i>	<i>0.562</i>				<i>0.500</i>	<i>0.187</i>	<i>0.406</i>	
# PDP040-011-03.18-AL-P	11	3.175	15.545	2024-T4 Aluminum	Pin Hub	Single Core	13.970	4.750	9.525	7.925
		<i>0.125</i>	<i>0.612</i>				<i>0.550</i>	<i>0.187</i>	<i>0.375</i>	
# PDP040-011-03.18-303-P	11	3.175	15.545	303 Stainless Steel	Pin Hub	Single Core	13.970	4.750	9.525	7.925
		<i>0.125</i>	<i>0.612</i>				<i>0.550</i>	<i>0.187</i>	<i>0.375</i>	
# PDP040-011-04.00-303-P	11	4.000	15.500	303 Stainless Steel	Pin Hub	Single Core	14.000	4.800	10.300	9.500
		<i>0.157</i>	<i>0.610</i>				<i>0.551</i>	<i>0.189</i>	<i>0.406</i>	
# PDP040-011-04.00-AL-P	11	4.000	15.500	2024-T4 Aluminum	Pin Hub	Single Core	14.000	4.800	10.300	9.500
		<i>0.157</i>	<i>0.610</i>				<i>0.551</i>	<i>0.189</i>	<i>0.406</i>	
# PDP040-011-04.76-303-P	11	4.762	15.545	303 Stainless Steel	Pin Hub	Single Core	13.970	4.750	10.312	9.525
		<i>0.187</i>	<i>0.612</i>				<i>0.550</i>	<i>0.187</i>	<i>0.406</i>	

Indicates item not stocked at time of printing - Please enquire for lead time

E&OE Pricing and all details subject to change without notice - Copyright Miniature Bearings Australia Pty Ltd

MBA Size Listings are a guide to sizes only and must not be solely relied on for critical design information.

Pulleys - Posi-Drive - 4.00 mm Circular Pitch

Part Number	Teeth No.	Bore mm	Outside Diameter mm	Material	Locking Type	Suit Belt Type mm	Pitch Diameter mm	Face Width mm	Overall Length mm	Hub Diameter
		<i>inches</i>	<i>inches</i>			<i>inches</i>	<i>inches</i>	<i>inches</i>	<i>inches</i>	
# PDP040-011-04.76-AL-P	11	4.762	15.545	2024-T4 Aluminum	Pin Hub	Single Core	13.970	4.750	10.312	9.525
		<i>0.187</i>	<i>0.612</i>				<i>0.550</i>	<i>0.187</i>	<i>0.406</i>	
# PDP040-012-03.18-303-P	12	3.175	16.815	303 Stainless Steel	Pin Hub	Single Core	15.240	4.750	9.525	7.925
		<i>0.125</i>	<i>0.662</i>				<i>0.600</i>	<i>0.187</i>	<i>0.375</i>	
# PDP040-012-03.18-AL-P	12	3.175	16.815	2024-T4 Aluminum	Pin Hub	Single Core	15.240	4.750	9.525	7.925
		<i>0.125</i>	<i>0.662</i>				<i>0.600</i>	<i>0.187</i>	<i>0.375</i>	
# PDP040-012-04.00-303-P	12	4.000	16.800	303 Stainless Steel	Pin Hub	Single Core	15.200	4.800	10.300	9.500
		<i>0.157</i>	<i>0.661</i>				<i>0.598</i>	<i>0.189</i>	<i>0.406</i>	
# PDP040-012-04.00-AL-P	12	4.000	16.800	2024-T4 Aluminum	Pin Hub	Single Core	15.200	4.800	10.300	9.500
		<i>0.157</i>	<i>0.661</i>				<i>0.598</i>	<i>0.189</i>	<i>0.406</i>	
# PDP040-012-04.76-303-P	12	4.762	16.815	303 Stainless Steel	Pin Hub	Single Core	15.240	4.750	10.312	9.525
		<i>0.187</i>	<i>0.662</i>				<i>0.600</i>	<i>0.187</i>	<i>0.406</i>	
# PDP040-012-04.76-AL-P	12	4.762	16.815	2024-T4 Aluminum	Pin Hub	Single Core	15.240	4.750	10.312	9.525
		<i>0.187</i>	<i>0.662</i>				<i>0.600</i>	<i>0.187</i>	<i>0.406</i>	
# PDP040-012-06.00-303-P	12	6.000	16.800	303 Stainless Steel	Pin Hub	Single Core	15.200	4.800	11.000	12.700
		<i>0.236</i>	<i>0.661</i>				<i>0.598</i>	<i>0.189</i>	<i>0.433</i>	

Indicates item not stocked at time of printing - Please enquire for lead time

E&OE Pricing and all details subject to change without notice - Copyright Miniature Bearings Australia Pty Ltd

MBA Size Listings are a guide to sizes only and must not be solely relied on for critical design information.

Pulleys - Posi-Drive - 4.00 mm Circular Pitch

Part Number	Teeth No.	Bore mm	Outside Diameter mm	Material	Locking Type	Suit Belt Type mm	Pitch Diameter mm	Face Width mm	Overall Length mm	Hub Diameter
		<i>inches</i>	<i>inches</i>			<i>inches</i>	<i>inches</i>	<i>inches</i>	<i>inches</i>	
# PDP040-012-06.00-AL-P	12	6.000	16.800	2024-T4 Aluminum	Pin Hub	Single Core	15.200	4.800	11.000	12.700
		<i>0.236</i>	<i>0.661</i>				<i>0.598</i>	<i>0.189</i>	<i>0.433</i>	
# PDP040-012-06.35-303-P	12	6.350	16.815	303 Stainless Steel	Pin Hub	Single Core	15.240	4.750	11.100	12.700
		<i>0.250</i>	<i>0.662</i>				<i>0.600</i>	<i>0.187</i>	<i>0.437</i>	
# PDP040-012-06.35-303-S	12	6.350	16.815	303 Stainless Steel	Split Hub	Single Core	15.240	4.750	11.887	7.925
		<i>0.250</i>	<i>0.662</i>				<i>0.600</i>	<i>0.187</i>	<i>0.468</i>	
# PDP040-012-06.35-AL-P	12	6.350	16.815	2024-T4 Aluminum	Pin Hub	Single Core	15.240	4.750	11.100	12.700
		<i>0.250</i>	<i>0.662</i>				<i>0.600</i>	<i>0.187</i>	<i>0.437</i>	
# PDP040-012-06.35-AL-S	12	6.350	16.815	2024-T4 Aluminum	Split Hub	Single Core	15.240	4.750	11.887	7.925
		<i>0.250</i>	<i>0.662</i>				<i>0.600</i>	<i>0.187</i>	<i>0.468</i>	
# PDP040-013-03.18-303-P	13	3.175	18.085	303 Stainless Steel	Pin Hub	Single Core	16.510	4.750	9.525	7.925
		<i>0.125</i>	<i>0.712</i>				<i>0.650</i>	<i>0.187</i>	<i>0.375</i>	
# PDP040-013-03.18-AL-P	13	3.175	18.085	2024-T4 Aluminum	Pin Hub	Single Core	16.510	4.750	9.525	7.925
		<i>0.125</i>	<i>0.712</i>				<i>0.650</i>	<i>0.187</i>	<i>0.375</i>	
# PDP040-013-04.00-AL-P	13	4.000	18.100	2024-T4 Aluminum	Pin Hub	Single Core	16.500	4.800	10.300	9.500
		<i>0.157</i>	<i>0.713</i>				<i>0.650</i>	<i>0.189</i>	<i>0.406</i>	

Indicates item not stocked at time of printing - Please enquire for lead time

E&OE Pricing and all details subject to change without notice - Copyright Miniature Bearings Australia Pty Ltd

MBA Size Listings are a guide to sizes only and must not be solely relied on for critical design information.

Pulleys - Posi-Drive - 4.00 mm Circular Pitch

Part Number	Teeth No.	Bore mm	Outside Diameter mm	Material	Locking Type	Suit Belt Type mm	Pitch Diameter mm	Face Width mm	Overall Length mm	Hub Diameter
		<i>inches</i>	<i>inches</i>			<i>inches</i>	<i>inches</i>	<i>inches</i>	<i>inches</i>	
# PDP040-013-04.00-303-P	13	4.000	18.100	303 Stainless Steel	Pin Hub	Single Core	16.500	4.800	10.300	9.500
		<i>0.157</i>	<i>0.713</i>				<i>0.650</i>	<i>0.189</i>	<i>0.406</i>	
# PDP040-013-04.76-303-P	13	4.762	18.085	303 Stainless Steel	Pin Hub	Single Core	16.510	4.750	10.312	9.525
		<i>0.187</i>	<i>0.712</i>				<i>0.650</i>	<i>0.187</i>	<i>0.406</i>	
# PDP040-013-04.76-AL-P	13	4.762	18.085	2024-T4 Aluminum	Pin Hub	Single Core	16.510	4.750	10.312	9.525
		<i>0.187</i>	<i>0.712</i>				<i>0.650</i>	<i>0.187</i>	<i>0.406</i>	
# PDP040-013-06.00-303-P	13	6.000	18.100	303 Stainless Steel	Pin Hub	Single Core	16.500	4.800	11.000	12.700
		<i>0.236</i>	<i>0.713</i>				<i>0.650</i>	<i>0.189</i>	<i>0.433</i>	
# PDP040-013-06.00-AL-P	13	6.000	18.100	2024-T4 Aluminum	Pin Hub	Single Core	16.500	4.800	11.000	12.700
		<i>0.236</i>	<i>0.713</i>				<i>0.650</i>	<i>0.189</i>	<i>0.433</i>	
# PDP040-013-06.35-AL-S	13	6.350	18.085	2024-T4 Aluminum	Split Hub	Single Core	16.510	4.750	11.887	7.925
		<i>0.250</i>	<i>0.712</i>				<i>0.650</i>	<i>0.187</i>	<i>0.468</i>	
# PDP040-013-06.35-AL-P	13	6.350	18.085	2024-T4 Aluminum	Pin Hub	Single Core	16.510	4.750	11.100	12.700
		<i>0.250</i>	<i>0.712</i>				<i>0.650</i>	<i>0.187</i>	<i>0.437</i>	
# PDP040-013-06.35-303-S	13	6.350	18.085	303 Stainless Steel	Split Hub	Single Core	16.510	4.750	11.887	7.925
		<i>0.250</i>	<i>0.712</i>				<i>0.650</i>	<i>0.187</i>	<i>0.468</i>	

Indicates item not stocked at time of printing - Please enquire for lead time

E&OE Pricing and all details subject to change without notice - Copyright Miniature Bearings Australia Pty Ltd

MBA Size Listings are a guide to sizes only and must not be solely relied on for critical design information.

Pulleys - Posi-Drive - 4.00 mm Circular Pitch

Part Number	Teeth No.	Bore mm	Outside Diameter mm	Material	Locking Type	Suit Belt Type mm	Pitch Diameter mm	Face Width mm	Overall Length mm	Hub Diameter
		<i>inches</i>	<i>inches</i>			<i>inches</i>	<i>inches</i>	<i>inches</i>	<i>inches</i>	
# PDP040-013-06.35-303-P	13	6.350	18.085	303 Stainless Steel	Pin Hub	Single Core	16.510	4.750	11.100	12.700
		<i>0.250</i>	<i>0.712</i>				<i>0.650</i>	<i>0.187</i>	<i>0.437</i>	
# PDP040-014-03.18-AL-P	14	3.175	19.355	2024-T4 Aluminum	Pin Hub	Single Core	17.780	4.750	9.525	7.925
		<i>0.125</i>	<i>0.762</i>				<i>0.700</i>	<i>0.187</i>	<i>0.375</i>	
# PDP040-014-03.18-303-P	14	3.175	19.355	303 Stainless Steel	Pin Hub	Single Core	17.780	4.750	9.525	7.925
		<i>0.125</i>	<i>0.762</i>				<i>0.700</i>	<i>0.187</i>	<i>0.375</i>	
# PDP040-014-04.00-303-P	14	4.000	19.400	303 Stainless Steel	Pin Hub	Single Core	17.800	4.800	10.300	9.500
		<i>0.157</i>	<i>0.764</i>				<i>0.701</i>	<i>0.189</i>	<i>0.406</i>	
# PDP040-014-04.00-AL-P	14	4.000	19.400	2024-T4 Aluminum	Pin Hub	Single Core	17.800	4.800	10.300	9.500
		<i>0.157</i>	<i>0.764</i>				<i>0.701</i>	<i>0.189</i>	<i>0.406</i>	
# PDP040-014-04.76-303-P	14	4.762	19.355	303 Stainless Steel	Pin Hub	Single Core	17.780	4.750	10.312	9.525
		<i>0.187</i>	<i>0.762</i>				<i>0.700</i>	<i>0.187</i>	<i>0.406</i>	
# PDP040-014-04.76-AL-P	14	4.762	19.355	2024-T4 Aluminum	Pin Hub	Single Core	17.780	4.750	10.312	9.525
		<i>0.187</i>	<i>0.762</i>				<i>0.700</i>	<i>0.187</i>	<i>0.406</i>	
# PDP040-014-06.00-303-P	14	6.000	19.400	303 Stainless Steel	Pin Hub	Single Core	17.800	4.800	11.000	12.700
		<i>0.236</i>	<i>0.764</i>				<i>0.701</i>	<i>0.189</i>	<i>0.433</i>	

Indicates item not stocked at time of printing - Please enquire for lead time

E&OE Pricing and all details subject to change without notice - Copyright Miniature Bearings Australia Pty Ltd

MBA Size Listings are a guide to sizes only and must not be solely relied on for critical design information.

Pulleys - Posi-Drive - 4.00 mm Circular Pitch

Part Number	Teeth No.	Bore mm	Outside Diameter mm	Material	Locking Type	Suit Belt Type mm	Pitch Diameter mm	Face Width mm	Overall Length mm	Hub Diameter
		<i>inches</i>	<i>inches</i>			<i>inches</i>	<i>inches</i>	<i>inches</i>	<i>inches</i>	
# PDP040-014-06.00-AL-P	14	6.000	19.400	2024-T4 Aluminum	Pin Hub	Single Core	17.800	4.800	11.000	12.700
		<i>0.236</i>	<i>0.764</i>				<i>0.701</i>	<i>0.189</i>	<i>0.433</i>	
# PDP040-014-06.35-303-S	14	6.350	19.355	303 Stainless Steel	Split Hub	Single Core	17.780	4.750	11.887	7.925
		<i>0.250</i>	<i>0.762</i>				<i>0.700</i>	<i>0.187</i>	<i>0.468</i>	
# PDP040-014-06.35-AL-P	14	6.350	19.355	2024-T4 Aluminum	Pin Hub	Single Core	17.780	4.750	11.100	12.700
		<i>0.250</i>	<i>0.762</i>				<i>0.700</i>	<i>0.187</i>	<i>0.437</i>	
# PDP040-014-06.35-AL-S	14	6.350	19.355	2024-T4 Aluminum	Split Hub	Single Core	17.780	4.750	11.887	7.925
		<i>0.250</i>	<i>0.762</i>				<i>0.700</i>	<i>0.187</i>	<i>0.468</i>	
# PDP040-014-06.35-303-P	14	6.350	19.355	303 Stainless Steel	Pin Hub	Single Core	17.780	4.750	11.100	12.700
		<i>0.250</i>	<i>0.762</i>				<i>0.700</i>	<i>0.187</i>	<i>0.437</i>	
# PDP040-015-03.18-303-P	15	3.175	20.625	303 Stainless Steel	Pin Hub	Single Core	19.050	4.750	9.525	7.925
		<i>0.125</i>	<i>0.812</i>				<i>0.750</i>	<i>0.187</i>	<i>0.375</i>	
# PDP040-015-03.18-AL-P	15	3.175	20.625	2024-T4 Aluminum	Pin Hub	Single Core	19.050	4.750	9.525	7.925
		<i>0.125</i>	<i>0.812</i>				<i>0.750</i>	<i>0.187</i>	<i>0.375</i>	
# PDP040-015-04.00-AL-P	15	4.000	20.600	2024-T4 Aluminum	Pin Hub	Single Core	19.100	4.800	10.300	9.500
		<i>0.157</i>	<i>0.811</i>				<i>0.752</i>	<i>0.189</i>	<i>0.406</i>	

Indicates item not stocked at time of printing - Please enquire for lead time

E&OE Pricing and all details subject to change without notice - Copyright Miniature Bearings Australia Pty Ltd

MBA Size Listings are a guide to sizes only and must not be solely relied on for critical design information.

Pulleys - Posi-Drive - 4.00 mm Circular Pitch

Part Number	Teeth No.	Bore mm	Outside Diameter mm	Material	Locking Type	Suit Belt Type mm	Pitch Diameter mm	Face Width mm	Overall Length mm	Hub Diameter
		<i>inches</i>	<i>inches</i>			<i>inches</i>	<i>inches</i>	<i>inches</i>	<i>inches</i>	
# PDP040-015-04.00-303-P	15	4.000	20.600	303 Stainless Steel	Pin Hub	Single Core	19.100	4.800	10.300	9.500
		<i>0.157</i>	<i>0.811</i>				<i>0.752</i>	<i>0.189</i>	<i>0.406</i>	
# PDP040-015-04.76-AL-P	15	4.762	20.625	2024-T4 Aluminum	Pin Hub	Single Core	19.050	4.750	10.312	9.525
		<i>0.187</i>	<i>0.812</i>				<i>0.750</i>	<i>0.187</i>	<i>0.406</i>	
# PDP040-015-04.76-303-P	15	4.762	20.625	303 Stainless Steel	Pin Hub	Single Core	19.050	4.750	10.312	9.525
		<i>0.187</i>	<i>0.812</i>				<i>0.750</i>	<i>0.187</i>	<i>0.406</i>	
# PDP040-015-06.00-303-P	15	6.000	20.600	303 Stainless Steel	Pin Hub	Single Core	19.100	4.800	11.000	12.700
		<i>0.236</i>	<i>0.811</i>				<i>0.752</i>	<i>0.189</i>	<i>0.433</i>	
# PDP040-015-06.00-AL-P	15	6.000	20.600	2024-T4 Aluminum	Pin Hub	Single Core	19.100	4.800	11.000	12.700
		<i>0.236</i>	<i>0.811</i>				<i>0.752</i>	<i>0.189</i>	<i>0.433</i>	
# PDP040-015-06.35-303-P	15	6.350	20.625	303 Stainless Steel	Pin Hub	Single Core	19.050	4.750	11.100	12.700
		<i>0.250</i>	<i>0.812</i>				<i>0.750</i>	<i>0.187</i>	<i>0.437</i>	
# PDP040-015-06.35-303-S	15	6.350	20.625	303 Stainless Steel	Split Hub	Single Core	19.050	4.750	11.887	7.925
		<i>0.250</i>	<i>0.812</i>				<i>0.750</i>	<i>0.187</i>	<i>0.468</i>	
# PDP040-015-06.35-AL-P	15	6.350	20.625	2024-T4 Aluminum	Pin Hub	Single Core	19.050	4.750	11.100	12.700
		<i>0.250</i>	<i>0.812</i>				<i>0.750</i>	<i>0.187</i>	<i>0.437</i>	

Indicates item not stocked at time of printing - Please enquire for lead time

E&OE Pricing and all details subject to change without notice - Copyright Miniature Bearings Australia Pty Ltd

MBA Size Listings are a guide to sizes only and must not be solely relied on for critical design information.

Pulleys - Posi-Drive - 4.00 mm Circular Pitch

Part Number	Teeth No.	Bore mm	Outside Diameter mm	Material	Locking Type	Suit Belt Type mm	Pitch Diameter mm	Face Width mm	Overall Length mm	Hub Diameter
		<i>inches</i>	<i>inches</i>			<i>inches</i>	<i>inches</i>	<i>inches</i>	<i>inches</i>	
# PDP040-015-06.35-AL-S	15	6.350	20.625	2024-T4 Aluminum	Split Hub	Single Core	19.050	4.750	11.887	7.925
		<i>0.250</i>	<i>0.812</i>				<i>0.750</i>	<i>0.187</i>	<i>0.468</i>	
# PDP040-016-03.18-303-P	16	3.175	21.895	303 Stainless Steel	Pin Hub	Single Core	20.320	4.750	9.525	7.925
		<i>0.125</i>	<i>0.862</i>				<i>0.800</i>	<i>0.187</i>	<i>0.375</i>	
# PDP040-016-03.18-AL-P	16	3.175	21.895	2024-T4 Aluminum	Pin Hub	Single Core	20.320	4.750	9.525	7.925
		<i>0.125</i>	<i>0.862</i>				<i>0.800</i>	<i>0.187</i>	<i>0.375</i>	
# PDP040-016-04.00-AL-P	16	4.000	21.900	2024-T4 Aluminum	Pin Hub	Single Core	20.300	4.800	10.300	9.500
		<i>0.157</i>	<i>0.862</i>				<i>0.799</i>	<i>0.189</i>	<i>0.406</i>	
# PDP040-016-04.00-303-P	16	4.000	21.900	303 Stainless Steel	Pin Hub	Single Core	20.300	4.800	10.300	9.500
		<i>0.157</i>	<i>0.862</i>				<i>0.799</i>	<i>0.189</i>	<i>0.406</i>	
# PDP040-016-04.76-303-P	16	4.762	21.895	303 Stainless Steel	Pin Hub	Single Core	20.320	4.750	10.312	9.525
		<i>0.187</i>	<i>0.862</i>				<i>0.800</i>	<i>0.187</i>	<i>0.406</i>	
# PDP040-016-04.76-AL-P	16	4.762	21.895	2024-T4 Aluminum	Pin Hub	Single Core	20.320	4.750	10.312	9.525
		<i>0.187</i>	<i>0.862</i>				<i>0.800</i>	<i>0.187</i>	<i>0.406</i>	
# PDP040-016-06.00-303-P	16	6.000	21.900	303 Stainless Steel	Pin Hub	Single Core	20.300	4.800	11.000	12.700
		<i>0.236</i>	<i>0.862</i>				<i>0.799</i>	<i>0.189</i>	<i>0.433</i>	

Indicates item not stocked at time of printing - Please enquire for lead time

E&OE Pricing and all details subject to change without notice - Copyright Miniature Bearings Australia Pty Ltd

MBA Size Listings are a guide to sizes only and must not be solely relied on for critical design information.

Pulleys - Posi-Drive - 4.00 mm Circular Pitch

Part Number	Teeth No.	Bore mm	Outside Diameter mm	Material	Locking Type	Suit Belt Type mm	Pitch Diameter mm	Face Width mm	Overall Length mm	Hub Diameter
		<i>inches</i>	<i>inches</i>			<i>inches</i>	<i>inches</i>	<i>inches</i>	<i>inches</i>	
# PDP040-016-06.00-AL-P	16	6.000	21.900	2024-T4 Aluminum	Pin Hub	Single Core	20.300	4.800	11.000	12.700
		<i>0.236</i>	<i>0.862</i>				<i>0.799</i>	<i>0.189</i>	<i>0.433</i>	
# PDP040-016-06.35-303-P	16	6.350	21.895	303 Stainless Steel	Pin Hub	Single Core	20.320	4.750	11.100	12.700
		<i>0.250</i>	<i>0.862</i>				<i>0.800</i>	<i>0.187</i>	<i>0.437</i>	
# PDP040-016-06.35-AL-S	16	6.350	21.895	2024-T4 Aluminum	Split Hub	Single Core	20.320	4.750	11.887	7.925
		<i>0.250</i>	<i>0.862</i>				<i>0.800</i>	<i>0.187</i>	<i>0.468</i>	
# PDP040-016-06.35-303-S	16	6.350	21.895	303 Stainless Steel	Split Hub	Single Core	20.320	4.750	11.887	7.925
		<i>0.250</i>	<i>0.862</i>				<i>0.800</i>	<i>0.187</i>	<i>0.468</i>	
# PDP040-016-06.35-AL-P	16	6.350	21.895	2024-T4 Aluminum	Pin Hub	Single Core	20.320	4.750	11.100	12.700
		<i>0.250</i>	<i>0.862</i>				<i>0.800</i>	<i>0.187</i>	<i>0.437</i>	
# PDP040-017-03.18-303-P	17	3.175	23.165	303 Stainless Steel	Pin Hub	Single Core	21.590	4.750	9.525	7.925
		<i>0.125</i>	<i>0.912</i>				<i>0.850</i>	<i>0.187</i>	<i>0.375</i>	
# PDP040-017-03.18-AL-P	17	3.175	23.165	2024-T4 Aluminum	Pin Hub	Single Core	21.590	4.750	9.525	7.925
		<i>0.125</i>	<i>0.912</i>				<i>0.850</i>	<i>0.187</i>	<i>0.375</i>	
# PDP040-017-04.00-303-P	17	4.000	23.200	303 Stainless Steel	Pin Hub	Single Core	21.600	4.800	10.300	9.500
		<i>0.157</i>	<i>0.913</i>				<i>0.850</i>	<i>0.189</i>	<i>0.406</i>	

Indicates item not stocked at time of printing - Please enquire for lead time

E&OE Pricing and all details subject to change without notice - Copyright Miniature Bearings Australia Pty Ltd

MBA Size Listings are a guide to sizes only and must not be solely relied on for critical design information.

Pulleys - Posi-Drive - 4.00 mm Circular Pitch

Part Number	Teeth No.	Bore mm	Outside Diameter mm	Material	Locking Type	Suit Belt Type mm	Pitch Diameter mm	Face Width mm	Overall Length mm	Hub Diameter
		<i>inches</i>	<i>inches</i>			<i>inches</i>	<i>inches</i>	<i>inches</i>	<i>inches</i>	
# PDP040-017-04.00-AL-P	17	4.000	23.200	2024-T4 Aluminum	Pin Hub	Single Core	21.600	4.800	10.300	9.500
		<i>0.157</i>	<i>0.913</i>				<i>0.850</i>	<i>0.189</i>	<i>0.406</i>	
# PDP040-017-04.76-303-P	17	4.762	23.165	303 Stainless Steel	Pin Hub	Single Core	21.590	4.750	10.312	9.525
		<i>0.187</i>	<i>0.912</i>				<i>0.850</i>	<i>0.187</i>	<i>0.406</i>	
# PDP040-017-04.76-AL-P	17	4.762	23.165	2024-T4 Aluminum	Pin Hub	Single Core	21.590	4.750	10.312	9.525
		<i>0.187</i>	<i>0.912</i>				<i>0.850</i>	<i>0.187</i>	<i>0.406</i>	
# PDP040-017-06.00-303-P	17	6.000	23.200	303 Stainless Steel	Pin Hub	Single Core	21.600	4.800	11.000	12.700
		<i>0.236</i>	<i>0.913</i>				<i>0.850</i>	<i>0.189</i>	<i>0.433</i>	
# PDP040-017-06.00-AL-P	17	6.000	23.200	2024-T4 Aluminum	Pin Hub	Single Core	21.600	4.800	11.000	12.700
		<i>0.236</i>	<i>0.913</i>				<i>0.850</i>	<i>0.189</i>	<i>0.433</i>	
# PDP040-017-06.35-303-S	17	6.350	23.165	303 Stainless Steel	Split Hub	Single Core	21.590	4.750	11.887	7.925
		<i>0.250</i>	<i>0.912</i>				<i>0.850</i>	<i>0.187</i>	<i>0.468</i>	
# PDP040-017-06.35-AL-P	17	6.350	23.165	2024-T4 Aluminum	Pin Hub	Single Core	21.590	4.750	11.100	12.700
		<i>0.250</i>	<i>0.912</i>				<i>0.850</i>	<i>0.187</i>	<i>0.437</i>	
# PDP040-017-06.35-AL-S	17	6.350	23.165	2024-T4 Aluminum	Split Hub	Single Core	21.590	4.750	11.887	7.925
		<i>0.250</i>	<i>0.912</i>				<i>0.850</i>	<i>0.187</i>	<i>0.468</i>	

Indicates item not stocked at time of printing - Please enquire for lead time

E&OE Pricing and all details subject to change without notice - Copyright Miniature Bearings Australia Pty Ltd

MBA Size Listings are a guide to sizes only and must not be solely relied on for critical design information.

Pulleys - Posi-Drive - 4.00 mm Circular Pitch

Part Number	Teeth No.	Bore mm	Outside Diameter mm	Material	Locking Type	Suit Belt Type mm	Pitch Diameter mm	Face Width mm	Overall Length mm	Hub Diameter
		<i>inches</i>	<i>inches</i>			<i>inches</i>	<i>inches</i>	<i>inches</i>	<i>inches</i>	
# PDP040-017-06.35-303-P	17	6.350	23.165	303 Stainless Steel	Pin Hub	Single Core	21.590	4.750	11.100	12.700
		<i>0.250</i>	<i>0.912</i>				<i>0.850</i>	<i>0.187</i>	<i>0.437</i>	
# PDP040-018-03.18-303-P	18	3.175	24.435	303 Stainless Steel	Pin Hub	Single Core	22.860	4.750	9.525	7.925
		<i>0.125</i>	<i>0.962</i>				<i>0.900</i>	<i>0.187</i>	<i>0.375</i>	
# PDP040-018-03.18-AL-P	18	3.175	24.435	2024-T4 Aluminum	Pin Hub	Single Core	22.860	4.750	9.525	7.925
		<i>0.125</i>	<i>0.962</i>				<i>0.900</i>	<i>0.187</i>	<i>0.375</i>	
# PDP040-018-04.00-AL-P	18	4.000	24.400	2024-T4 Aluminum	Pin Hub	Single Core	22.900	4.800	10.300	9.500
		<i>0.157</i>	<i>0.961</i>				<i>0.902</i>	<i>0.189</i>	<i>0.406</i>	
# PDP040-018-04.00-303-P	18	4.000	24.400	303 Stainless Steel	Pin Hub	Single Core	22.900	4.800	10.300	9.500
		<i>0.157</i>	<i>0.961</i>				<i>0.902</i>	<i>0.189</i>	<i>0.406</i>	
# PDP040-018-04.76-AL-P	18	4.762	24.435	2024-T4 Aluminum	Pin Hub	Single Core	22.860	4.750	10.312	9.525
		<i>0.187</i>	<i>0.962</i>				<i>0.900</i>	<i>0.187</i>	<i>0.406</i>	
# PDP040-018-04.76-303-P	18	4.762	24.435	303 Stainless Steel	Pin Hub	Single Core	22.860	4.750	10.312	9.525
		<i>0.187</i>	<i>0.962</i>				<i>0.900</i>	<i>0.187</i>	<i>0.406</i>	
# PDP040-018-06.00-303-P	18	6.000	24.400	303 Stainless Steel	Pin Hub	Single Core	22.900	4.800	11.000	12.700
		<i>0.236</i>	<i>0.961</i>				<i>0.902</i>	<i>0.189</i>	<i>0.433</i>	

Indicates item not stocked at time of printing - Please enquire for lead time

E&OE Pricing and all details subject to change without notice - Copyright Miniature Bearings Australia Pty Ltd

MBA Size Listings are a guide to sizes only and must not be solely relied on for critical design information.

Pulleys - Posi-Drive - 4.00 mm Circular Pitch

Part Number	Teeth No.	Bore mm	Outside Diameter mm	Material	Locking Type	Suit Belt Type mm	Pitch Diameter mm	Face Width mm	Overall Length mm	Hub Diameter
		<i>inches</i>	<i>inches</i>			<i>inches</i>	<i>inches</i>	<i>inches</i>	<i>inches</i>	
# PDP040-018-06.00-AL-P	18	6.000	24.400	2024-T4 Aluminum	Pin Hub	Single Core	22.900	4.800	11.000	12.700
		<i>0.236</i>	<i>0.961</i>				<i>0.902</i>	<i>0.189</i>	<i>0.433</i>	
# PDP040-018-06.35-303-P	18	6.350	24.435	303 Stainless Steel	Pin Hub	Single Core	22.860	4.750	11.100	12.700
		<i>0.250</i>	<i>0.962</i>				<i>0.900</i>	<i>0.187</i>	<i>0.437</i>	
# PDP040-018-06.35-303-S	18	6.350	24.435	303 Stainless Steel	Split Hub	Single Core	22.860	4.750	11.887	7.925
		<i>0.250</i>	<i>0.962</i>				<i>0.900</i>	<i>0.187</i>	<i>0.468</i>	
# PDP040-018-06.35-AL-P	18	6.350	24.435	2024-T4 Aluminum	Pin Hub	Single Core	22.860	4.750	11.100	12.700
		<i>0.250</i>	<i>0.962</i>				<i>0.900</i>	<i>0.187</i>	<i>0.437</i>	
# PDP040-018-06.35-AL-S	18	6.350	24.435	2024-T4 Aluminum	Split Hub	Single Core	22.860	4.750	11.887	7.925
		<i>0.250</i>	<i>0.962</i>				<i>0.900</i>	<i>0.187</i>	<i>0.468</i>	
# PDP040-019-03.18-303-P	19	3.175	25.705	303 Stainless Steel	Pin Hub	Single Core	24.130	4.750	9.525	7.925
		<i>0.125</i>	<i>1.012</i>				<i>0.950</i>	<i>0.187</i>	<i>0.375</i>	
# PDP040-019-03.18-AL-P	19	3.175	25.705	2024-T4 Aluminum	Pin Hub	Single Core	24.130	4.750	9.525	7.925
		<i>0.125</i>	<i>1.012</i>				<i>0.950</i>	<i>0.187</i>	<i>0.375</i>	
# PDP040-019-04.00-AL-P	19	4.000	25.700	2024-T4 Aluminum	Pin Hub	Single Core	24.100	4.800	10.300	9.500
		<i>0.157</i>	<i>1.012</i>				<i>0.949</i>	<i>0.189</i>	<i>0.406</i>	

Indicates item not stocked at time of printing - Please enquire for lead time

E&OE Pricing and all details subject to change without notice - Copyright Miniature Bearings Australia Pty Ltd

MBA Size Listings are a guide to sizes only and must not be solely relied on for critical design information.

Pulleys - Posi-Drive - 4.00 mm Circular Pitch

Part Number	Teeth No.	Bore mm	Outside Diameter mm	Material	Locking Type	Suit Belt Type mm	Pitch Diameter mm	Face Width mm	Overall Length mm	Hub Diameter
		<i>inches</i>	<i>inches</i>			<i>inches</i>	<i>inches</i>	<i>inches</i>	<i>inches</i>	
# PDP040-019-04.00-303-P	19	4.000	25.700	303 Stainless Steel	Pin Hub	Single Core	24.100	4.800	10.300	9.500
		<i>0.157</i>	<i>1.012</i>				<i>0.949</i>	<i>0.189</i>	<i>0.406</i>	
# PDP040-019-04.76-303-P	19	4.762	25.705	303 Stainless Steel	Pin Hub	Single Core	24.130	4.750	10.312	9.525
		<i>0.187</i>	<i>1.012</i>				<i>0.950</i>	<i>0.187</i>	<i>0.406</i>	
# PDP040-019-04.76-AL-P	19	4.762	25.705	2024-T4 Aluminum	Pin Hub	Single Core	24.130	4.750	10.312	9.525
		<i>0.187</i>	<i>1.012</i>				<i>0.950</i>	<i>0.187</i>	<i>0.406</i>	
# PDP040-019-06.00-AL-P	19	6.000	25.700	2024-T4 Aluminum	Pin Hub	Single Core	24.100	4.800	11.000	12.700
		<i>0.236</i>	<i>1.012</i>				<i>0.949</i>	<i>0.189</i>	<i>0.433</i>	
# PDP040-019-06.00-303-P	19	6.000	25.700	303 Stainless Steel	Pin Hub	Single Core	24.100	4.800	11.000	12.700
		<i>0.236</i>	<i>1.012</i>				<i>0.949</i>	<i>0.189</i>	<i>0.433</i>	
# PDP040-019-06.35-AL-S	19	6.350	25.705	2024-T4 Aluminum	Split Hub	Single Core	24.130	4.750	11.887	7.925
		<i>0.250</i>	<i>1.012</i>				<i>0.950</i>	<i>0.187</i>	<i>0.468</i>	
# PDP040-019-06.35-AL-P	19	6.350	25.705	2024-T4 Aluminum	Pin Hub	Single Core	24.130	4.750	11.100	12.700
		<i>0.250</i>	<i>1.012</i>				<i>0.950</i>	<i>0.187</i>	<i>0.437</i>	
# PDP040-019-06.35-303-S	19	6.350	25.705	303 Stainless Steel	Split Hub	Single Core	24.130	4.750	11.887	7.925
		<i>0.250</i>	<i>1.012</i>				<i>0.950</i>	<i>0.187</i>	<i>0.468</i>	

Indicates item not stocked at time of printing - Please enquire for lead time

E&OE Pricing and all details subject to change without notice - Copyright Miniature Bearings Australia Pty Ltd

MBA Size Listings are a guide to sizes only and must not be solely relied on for critical design information.

Pulleys - Posi-Drive - 4.00 mm Circular Pitch

Part Number	Teeth No.	Bore mm	Outside Diameter mm	Material	Locking Type	Suit Belt Type mm	Pitch Diameter mm	Face Width mm	Overall Length mm	Hub Diameter
		<i>inches</i>	<i>inches</i>			<i>inches</i>	<i>inches</i>	<i>inches</i>	<i>inches</i>	
# PDP040-019-06.35-303-P	19	6.350	25.705	303 Stainless Steel	Pin Hub	Single Core	24.130	4.750	11.100	12.700
		<i>0.250</i>	<i>1.012</i>				<i>0.950</i>	<i>0.187</i>	<i>0.437</i>	
# PDP040-020-03.18-303-P	20	3.175	26.975	303 Stainless Steel	Pin Hub	Single Core	25.400	4.750	9.525	7.925
		<i>0.125</i>	<i>1.062</i>				<i>1.000</i>	<i>0.187</i>	<i>0.375</i>	
# PDP040-020-03.18-AL-P	20	3.175	26.975	2024-T4 Aluminum	Pin Hub	Single Core	25.400	4.750	9.525	7.925
		<i>0.125</i>	<i>1.062</i>				<i>1.000</i>	<i>0.187</i>	<i>0.375</i>	
# PDP040-020-04.00-303-P	20	4.000	27.000	303 Stainless Steel	Pin Hub	Single Core	25.400	4.800	10.300	9.500
		<i>0.157</i>	<i>1.063</i>				<i>1.000</i>	<i>0.189</i>	<i>0.406</i>	
# PDP040-020-04.00-AL-P	20	4.000	27.000	2024-T4 Aluminum	Pin Hub	Single Core	25.400	4.800	10.300	9.500
		<i>0.157</i>	<i>1.063</i>				<i>1.000</i>	<i>0.189</i>	<i>0.406</i>	
# PDP040-020-04.76-AL-P	20	4.762	26.975	2024-T4 Aluminum	Pin Hub	Single Core	25.400	4.750	10.312	9.525
		<i>0.187</i>	<i>1.062</i>				<i>1.000</i>	<i>0.187</i>	<i>0.406</i>	
# PDP040-020-04.76-303-P	20	4.762	26.975	303 Stainless Steel	Pin Hub	Single Core	25.400	4.750	10.312	9.525
		<i>0.187</i>	<i>1.062</i>				<i>1.000</i>	<i>0.187</i>	<i>0.406</i>	
# PDP040-020-06.00-303-P	20	6.000	27.000	303 Stainless Steel	Pin Hub	Single Core	25.400	4.800	11.000	12.700
		<i>0.236</i>	<i>1.063</i>				<i>1.000</i>	<i>0.189</i>	<i>0.433</i>	

Indicates item not stocked at time of printing - Please enquire for lead time

E&OE Pricing and all details subject to change without notice - Copyright Miniature Bearings Australia Pty Ltd

MBA Size Listings are a guide to sizes only and must not be solely relied on for critical design information.

Pulleys - Posi-Drive - 4.00 mm Circular Pitch

Part Number	Teeth No.	Bore mm	Outside Diameter mm	Material	Locking Type	Suit Belt Type mm	Pitch Diameter mm	Face Width mm	Overall Length mm	Hub Diameter
		<i>inches</i>	<i>inches</i>			<i>inches</i>	<i>inches</i>	<i>inches</i>	<i>inches</i>	
# PDP040-020-06.00-AL-P	20	6.000	27.000	2024-T4 Aluminum	Pin Hub	Single Core	25.400	4.800	11.000	12.700
		<i>0.236</i>	<i>1.063</i>				<i>1.000</i>	<i>0.189</i>	<i>0.433</i>	
# PDP040-020-06.35-303-P	20	6.350	26.975	303 Stainless Steel	Pin Hub	Single Core	25.400	4.750	11.100	12.700
		<i>0.250</i>	<i>1.062</i>				<i>1.000</i>	<i>0.187</i>	<i>0.437</i>	
# PDP040-020-06.35-303-S	20	6.350	26.975	303 Stainless Steel	Split Hub	Single Core	25.400	4.750	11.887	7.925
		<i>0.250</i>	<i>1.062</i>				<i>1.000</i>	<i>0.187</i>	<i>0.468</i>	
# PDP040-020-06.35-AL-P	20	6.350	26.975	2024-T4 Aluminum	Pin Hub	Single Core	25.400	4.750	11.100	12.700
		<i>0.250</i>	<i>1.062</i>				<i>1.000</i>	<i>0.187</i>	<i>0.437</i>	
# PDP040-020-06.35-AL-S	20	6.350	26.975	2024-T4 Aluminum	Split Hub	Single Core	25.400	4.750	11.887	7.925
		<i>0.250</i>	<i>1.062</i>				<i>1.000</i>	<i>0.187</i>	<i>0.468</i>	
# PDP040-022-03.18-AL-P	22	3.175	29.515	2024-T4 Aluminum	Pin Hub	Single Core	27.940	4.750	9.525	7.925
		<i>0.125</i>	<i>1.162</i>				<i>1.100</i>	<i>0.187</i>	<i>0.375</i>	
# PDP040-022-03.18-303-P	22	3.175	29.515	303 Stainless Steel	Pin Hub	Single Core	27.940	4.750	9.525	7.925
		<i>0.125</i>	<i>1.162</i>				<i>1.100</i>	<i>0.187</i>	<i>0.375</i>	
# PDP040-022-04.00-AL-P	22	4.000	29.500	2024-T4 Aluminum	Pin Hub	Single Core	27.900	4.800	10.300	9.500
		<i>0.157</i>	<i>1.161</i>				<i>1.098</i>	<i>0.189</i>	<i>0.406</i>	

Indicates item not stocked at time of printing - Please enquire for lead time

E&OE Pricing and all details subject to change without notice - Copyright Miniature Bearings Australia Pty Ltd

MBA Size Listings are a guide to sizes only and must not be solely relied on for critical design information.

Pulleys - Posi-Drive - 4.00 mm Circular Pitch

Part Number	Teeth No.	Bore mm	Outside Diameter mm	Material	Locking Type	Suit Belt Type mm	Pitch Diameter mm	Face Width mm	Overall Length mm	Hub Diameter
		<i>inches</i>	<i>inches</i>			<i>inches</i>	<i>inches</i>	<i>inches</i>	<i>inches</i>	
# PDP040-022-04.00-303-P	22	4.000	29.500	303 Stainless Steel	Pin Hub	Single Core	27.900	4.800	10.300	9.500
		<i>0.157</i>	<i>1.161</i>				<i>1.098</i>	<i>0.189</i>	<i>0.406</i>	
# PDP040-022-04.76-303-P	22	4.762	29.515	303 Stainless Steel	Pin Hub	Single Core	27.940	4.750	10.312	9.525
		<i>0.187</i>	<i>1.162</i>				<i>1.100</i>	<i>0.187</i>	<i>0.406</i>	
# PDP040-022-04.76-AL-P	22	4.762	29.515	2024-T4 Aluminum	Pin Hub	Single Core	27.940	4.750	10.312	9.525
		<i>0.187</i>	<i>1.162</i>				<i>1.100</i>	<i>0.187</i>	<i>0.406</i>	
# PDP040-022-06.00-303-P	22	6.000	29.500	303 Stainless Steel	Pin Hub	Single Core	27.900	4.800	11.000	12.700
		<i>0.236</i>	<i>1.161</i>				<i>1.098</i>	<i>0.189</i>	<i>0.433</i>	
# PDP040-022-06.00-AL-P	22	6.000	29.500	2024-T4 Aluminum	Pin Hub	Single Core	27.900	4.800	11.000	12.700
		<i>0.236</i>	<i>1.161</i>				<i>1.098</i>	<i>0.189</i>	<i>0.433</i>	
# PDP040-022-06.35-303-S	22	6.350	29.515	303 Stainless Steel	Split Hub	Single Core	27.940	4.750	11.887	7.925
		<i>0.250</i>	<i>1.162</i>				<i>1.100</i>	<i>0.187</i>	<i>0.468</i>	
# PDP040-022-06.35-AL-P	22	6.350	29.515	2024-T4 Aluminum	Pin Hub	Single Core	27.940	4.750	11.100	12.700
		<i>0.250</i>	<i>1.162</i>				<i>1.100</i>	<i>0.187</i>	<i>0.437</i>	
# PDP040-022-06.35-303-P	22	6.350	29.515	303 Stainless Steel	Pin Hub	Single Core	27.940	4.750	11.100	12.700
		<i>0.250</i>	<i>1.162</i>				<i>1.100</i>	<i>0.187</i>	<i>0.437</i>	

Indicates item not stocked at time of printing - Please enquire for lead time

E&OE Pricing and all details subject to change without notice - Copyright Miniature Bearings Australia Pty Ltd

MBA Size Listings are a guide to sizes only and must not be solely relied on for critical design information.

Pulleys - Posi-Drive - 4.00 mm Circular Pitch

Part Number	Teeth No.	Bore mm	Outside Diameter mm	Material	Locking Type	Suit Belt Type mm	Pitch Diameter mm	Face Width mm	Overall Length mm	Hub Diameter
		<i>inches</i>	<i>inches</i>			<i>inches</i>	<i>inches</i>	<i>inches</i>	<i>inches</i>	
# PDP040-022-06.35-AL-S	22	6.350	29.515	2024-T4 Aluminum	Split Hub	Single Core	27.940	4.750	11.887	7.925
		<i>0.250</i>	<i>1.162</i>				<i>1.100</i>	<i>0.187</i>	<i>0.468</i>	
# PDP040-024-03.18-303-P	24	3.175	32.055	303 Stainless Steel	Pin Hub	Single Core	30.480	4.750	9.525	7.925
		<i>0.125</i>	<i>1.262</i>				<i>1.200</i>	<i>0.187</i>	<i>0.375</i>	
# PDP040-024-03.18-AL-P	24	3.175	32.055	2024-T4 Aluminum	Pin Hub	Single Core	30.480	4.750	9.525	7.925
		<i>0.125</i>	<i>1.262</i>				<i>1.200</i>	<i>0.187</i>	<i>0.375</i>	
# PDP040-024-04.00-303-P	24	4.000	32.100	303 Stainless Steel	Pin Hub	Single Core	30.500	4.800	10.300	9.500
		<i>0.157</i>	<i>1.264</i>				<i>1.201</i>	<i>0.189</i>	<i>0.406</i>	
# PDP040-024-04.00-AL-P	24	4.000	32.100	2024-T4 Aluminum	Pin Hub	Single Core	30.500	4.800	10.300	9.500
		<i>0.157</i>	<i>1.264</i>				<i>1.201</i>	<i>0.189</i>	<i>0.406</i>	
# PDP040-024-04.76-303-P	24	4.762	32.055	303 Stainless Steel	Pin Hub	Single Core	30.480	4.750	10.312	9.525
		<i>0.187</i>	<i>1.262</i>				<i>1.200</i>	<i>0.187</i>	<i>0.406</i>	
# PDP040-024-04.76-AL-P	24	4.762	32.055	2024-T4 Aluminum	Pin Hub	Single Core	30.480	4.750	10.312	9.525
		<i>0.187</i>	<i>1.262</i>				<i>1.200</i>	<i>0.187</i>	<i>0.406</i>	
# PDP040-024-06.00-AL-P	24	6.000	32.100	2024-T4 Aluminum	Pin Hub	Single Core	30.500	4.800	11.000	12.700
		<i>0.236</i>	<i>1.264</i>				<i>1.201</i>	<i>0.189</i>	<i>0.433</i>	

Indicates item not stocked at time of printing - Please enquire for lead time

E&OE Pricing and all details subject to change without notice - Copyright Miniature Bearings Australia Pty Ltd

MBA Size Listings are a guide to sizes only and must not be solely relied on for critical design information.

Pulleys - Posi-Drive - 4.00 mm Circular Pitch

Part Number	Teeth No.	Bore mm	Outside Diameter mm	Material	Locking Type	Suit Belt Type mm	Pitch Diameter mm	Face Width mm	Overall Length mm	Hub Diameter
		<i>inches</i>	<i>inches</i>			<i>inches</i>	<i>inches</i>	<i>inches</i>	<i>inches</i>	
# PDP040-024-06.00-303-P	24	6.000	32.100	303 Stainless Steel	Pin Hub	Single Core	30.500	4.800	11.000	12.700
		<i>0.236</i>	<i>1.264</i>				<i>1.201</i>	<i>0.189</i>	<i>0.433</i>	
# PDP040-024-06.35-303-P	24	6.350	32.055	303 Stainless Steel	Pin Hub	Single Core	30.480	4.750	11.100	12.700
		<i>0.250</i>	<i>1.262</i>				<i>1.200</i>	<i>0.187</i>	<i>0.437</i>	
# PDP040-024-06.35-303-S	24	6.350	32.055	303 Stainless Steel	Split Hub	Single Core	30.480	4.750	11.887	7.925
		<i>0.250</i>	<i>1.262</i>				<i>1.200</i>	<i>0.187</i>	<i>0.468</i>	
# PDP040-024-06.35-AL-P	24	6.350	32.055	2024-T4 Aluminum	Pin Hub	Single Core	30.480	4.750	11.100	12.700
		<i>0.250</i>	<i>1.262</i>				<i>1.200</i>	<i>0.187</i>	<i>0.437</i>	
# PDP040-024-06.35-AL-S	24	6.350	32.055	2024-T4 Aluminum	Split Hub	Single Core	30.480	4.750	11.887	7.925
		<i>0.250</i>	<i>1.262</i>				<i>1.200</i>	<i>0.187</i>	<i>0.468</i>	
# PDP040-025-03.18-AL-P	25	3.175	33.325	2024-T4 Aluminum	Pin Hub	Single Core	31.750	4.750	9.525	7.925
		<i>0.125</i>	<i>1.312</i>				<i>1.250</i>	<i>0.187</i>	<i>0.375</i>	
# PDP040-025-03.18-303-P	25	3.175	33.325	303 Stainless Steel	Pin Hub	Single Core	31.750	4.750	9.525	7.925
		<i>0.125</i>	<i>1.312</i>				<i>1.250</i>	<i>0.187</i>	<i>0.375</i>	
# PDP040-025-04.00-303-P	25	4.000	33.300	303 Stainless Steel	Pin Hub	Single Core	31.800	4.800	10.300	9.500
		<i>0.157</i>	<i>1.311</i>				<i>1.252</i>	<i>0.189</i>	<i>0.406</i>	

Indicates item not stocked at time of printing - Please enquire for lead time

E&OE Pricing and all details subject to change without notice - Copyright Miniature Bearings Australia Pty Ltd

MBA Size Listings are a guide to sizes only and must not be solely relied on for critical design information.

Pulleys - Posi-Drive - 4.00 mm Circular Pitch

Part Number	Teeth No.	Bore mm	Outside Diameter mm	Material	Locking Type	Suit Belt Type mm	Pitch Diameter mm	Face Width mm	Overall Length mm	Hub Diameter
		<i>inches</i>	<i>inches</i>			<i>inches</i>	<i>inches</i>	<i>inches</i>	<i>inches</i>	
# PDP040-025-04.00-AL-P	25	4.000	33.300	2024-T4 Aluminum	Pin Hub	Single Core	31.800	4.800	10.300	9.500
		<i>0.157</i>	<i>1.311</i>				<i>1.252</i>	<i>0.189</i>	<i>0.406</i>	
# PDP040-025-04.76-303-P	25	4.762	33.325	303 Stainless Steel	Pin Hub	Single Core	31.750	4.750	10.312	9.525
		<i>0.187</i>	<i>1.312</i>				<i>1.250</i>	<i>0.187</i>	<i>0.406</i>	
# PDP040-025-04.76-AL-P	25	4.762	33.325	2024-T4 Aluminum	Pin Hub	Single Core	31.750	4.750	10.312	9.525
		<i>0.187</i>	<i>1.312</i>				<i>1.250</i>	<i>0.187</i>	<i>0.406</i>	
# PDP040-025-06.00-303-P	25	6.000	33.300	303 Stainless Steel	Pin Hub	Single Core	31.800	4.800	11.000	12.700
		<i>0.236</i>	<i>1.311</i>				<i>1.252</i>	<i>0.189</i>	<i>0.433</i>	
# PDP040-025-06.00-AL-P	25	6.000	33.300	2024-T4 Aluminum	Pin Hub	Single Core	31.800	4.800	11.000	12.700
		<i>0.236</i>	<i>1.311</i>				<i>1.252</i>	<i>0.189</i>	<i>0.433</i>	
# PDP040-025-06.35-AL-S	25	6.350	33.325	2024-T4 Aluminum	Split Hub	Single Core	31.750	4.750	11.887	7.925
		<i>0.250</i>	<i>1.312</i>				<i>1.250</i>	<i>0.187</i>	<i>0.468</i>	
# PDP040-025-06.35-AL-P	25	6.350	33.325	2024-T4 Aluminum	Pin Hub	Single Core	31.750	4.750	11.100	12.700
		<i>0.250</i>	<i>1.312</i>				<i>1.250</i>	<i>0.187</i>	<i>0.437</i>	
# PDP040-025-06.35-303-S	25	6.350	33.325	303 Stainless Steel	Split Hub	Single Core	31.750	4.750	11.887	7.925
		<i>0.250</i>	<i>1.312</i>				<i>1.250</i>	<i>0.187</i>	<i>0.468</i>	

Indicates item not stocked at time of printing - Please enquire for lead time

E&OE Pricing and all details subject to change without notice - Copyright Miniature Bearings Australia Pty Ltd

MBA Size Listings are a guide to sizes only and must not be solely relied on for critical design information.

Pulleys - Posi-Drive - 4.00 mm Circular Pitch

Part Number	Teeth No.	Bore mm	Outside Diameter mm	Material	Locking Type	Suit Belt Type mm	Pitch Diameter mm	Face Width mm	Overall Length mm	Hub Diameter
		<i>inches</i>	<i>inches</i>			<i>inches</i>	<i>inches</i>	<i>inches</i>	<i>inches</i>	
# PDP040-025-06.35-303-P	25	6.350	33.325	303 Stainless Steel	Pin Hub	Single Core	31.750	4.750	11.100	12.700
		<i>0.250</i>	<i>1.312</i>				<i>1.250</i>	<i>0.187</i>	<i>0.437</i>	
# PDP040-026-03.18-AL-P	26	3.175	34.595	2024-T4 Aluminum	Pin Hub	Single Core	33.020	4.750	9.525	7.925
		<i>0.125</i>	<i>1.362</i>				<i>1.300</i>	<i>0.187</i>	<i>0.375</i>	
# PDP040-026-03.18-303-P	26	3.175	34.595	303 Stainless Steel	Pin Hub	Single Core	33.020	4.750	9.525	7.925
		<i>0.125</i>	<i>1.362</i>				<i>1.300</i>	<i>0.187</i>	<i>0.375</i>	
# PDP040-026-04.00-303-P	26	4.000	34.600	303 Stainless Steel	Pin Hub	Single Core	33.000	4.800	10.300	9.500
		<i>0.157</i>	<i>1.362</i>				<i>1.299</i>	<i>0.189</i>	<i>0.406</i>	
# PDP040-026-04.00-AL-P	26	4.000	34.600	2024-T4 Aluminum	Pin Hub	Single Core	33.000	4.800	10.300	9.500
		<i>0.157</i>	<i>1.362</i>				<i>1.299</i>	<i>0.189</i>	<i>0.406</i>	
# PDP040-026-04.76-303-P	26	4.762	34.595	303 Stainless Steel	Pin Hub	Single Core	33.020	4.750	10.312	9.525
		<i>0.187</i>	<i>1.362</i>				<i>1.300</i>	<i>0.187</i>	<i>0.406</i>	
# PDP040-026-04.76-AL-P	26	4.762	34.595	2024-T4 Aluminum	Pin Hub	Single Core	33.020	4.750	10.312	9.525
		<i>0.187</i>	<i>1.362</i>				<i>1.300</i>	<i>0.187</i>	<i>0.406</i>	
# PDP040-026-06.00-303-P	26	6.000	34.600	303 Stainless Steel	Pin Hub	Single Core	33.000	4.800	11.000	12.700
		<i>0.236</i>	<i>1.362</i>				<i>1.299</i>	<i>0.189</i>	<i>0.433</i>	

Indicates item not stocked at time of printing - Please enquire for lead time

E&OE Pricing and all details subject to change without notice - Copyright Miniature Bearings Australia Pty Ltd

MBA Size Listings are a guide to sizes only and must not be solely relied on for critical design information.

Pulleys - Posi-Drive - 4.00 mm Circular Pitch

Part Number	Teeth No.	Bore mm	Outside Diameter mm	Material	Locking Type	Suit Belt Type mm	Pitch Diameter mm	Face Width mm	Overall Length mm	Hub Diameter
		<i>inches</i>	<i>inches</i>			<i>inches</i>	<i>inches</i>	<i>inches</i>	<i>inches</i>	
# PDP040-026-06.00-AL-P	26	6.000	34.600	2024-T4 Aluminum	Pin Hub	Single Core	33.000	4.800	11.000	12.700
		<i>0.236</i>	<i>1.362</i>				<i>1.299</i>	<i>0.189</i>	<i>0.433</i>	
# PDP040-026-06.35-303-S	26	6.350	34.595	303 Stainless Steel	Split Hub	Single Core	33.020	4.750	11.887	7.925
		<i>0.250</i>	<i>1.362</i>				<i>1.300</i>	<i>0.187</i>	<i>0.468</i>	
# PDP040-026-06.35-AL-P	26	6.350	34.595	2024-T4 Aluminum	Pin Hub	Single Core	33.020	4.750	11.100	12.700
		<i>0.250</i>	<i>1.362</i>				<i>1.300</i>	<i>0.187</i>	<i>0.437</i>	
# PDP040-026-06.35-AL-S	26	6.350	34.595	2024-T4 Aluminum	Split Hub	Single Core	33.020	4.750	11.887	7.925
		<i>0.250</i>	<i>1.362</i>				<i>1.300</i>	<i>0.187</i>	<i>0.468</i>	
# PDP040-026-06.35-303-P	26	6.350	34.595	303 Stainless Steel	Pin Hub	Single Core	33.020	4.750	11.100	12.700
		<i>0.250</i>	<i>1.362</i>				<i>1.300</i>	<i>0.187</i>	<i>0.437</i>	
# PDP040-028-03.18-303-P	28	3.175	37.135	303 Stainless Steel	Pin Hub	Single Core	35.560	4.750	9.525	7.925
		<i>0.125</i>	<i>1.462</i>				<i>1.400</i>	<i>0.187</i>	<i>0.375</i>	
# PDP040-028-03.18-AL-P	28	3.175	37.135	2024-T4 Aluminum	Pin Hub	Single Core	35.560	4.750	9.525	7.925
		<i>0.125</i>	<i>1.462</i>				<i>1.400</i>	<i>0.187</i>	<i>0.375</i>	
# PDP040-028-04.00-AL-P	28	4.000	37.100	2024-T4 Aluminum	Pin Hub	Single Core	35.600	4.800	10.300	9.500
		<i>0.157</i>	<i>1.461</i>				<i>1.402</i>	<i>0.189</i>	<i>0.406</i>	

Indicates item not stocked at time of printing - Please enquire for lead time

E&OE Pricing and all details subject to change without notice - Copyright Miniature Bearings Australia Pty Ltd

MBA Size Listings are a guide to sizes only and must not be solely relied on for critical design information.

Pulleys - Posi-Drive - 4.00 mm Circular Pitch

Part Number	Teeth No.	Bore mm	Outside Diameter mm	Material	Locking Type	Suit Belt Type mm	Pitch Diameter mm	Face Width mm	Overall Length mm	Hub Diameter
		<i>inches</i>	<i>inches</i>			<i>inches</i>	<i>inches</i>	<i>inches</i>	<i>inches</i>	
# PDP040-028-04.00-303-P	28	4.000	37.100	303 Stainless Steel	Pin Hub	Single Core	35.600	4.800	10.300	9.500
		<i>0.157</i>	<i>1.461</i>				<i>1.402</i>	<i>0.189</i>	<i>0.406</i>	
# PDP040-028-04.76-303-P	28	4.762	37.135	303 Stainless Steel	Pin Hub	Single Core	35.560	4.750	10.312	9.525
		<i>0.187</i>	<i>1.462</i>				<i>1.400</i>	<i>0.187</i>	<i>0.406</i>	
# PDP040-028-04.76-AL-P	28	4.762	37.135	2024-T4 Aluminum	Pin Hub	Single Core	35.560	4.750	10.312	9.525
		<i>0.187</i>	<i>1.462</i>				<i>1.400</i>	<i>0.187</i>	<i>0.406</i>	
# PDP040-028-06.00-303-P	28	6.000	37.100	303 Stainless Steel	Pin Hub	Single Core	35.600	4.800	11.000	12.700
		<i>0.236</i>	<i>1.461</i>				<i>1.402</i>	<i>0.189</i>	<i>0.433</i>	
# PDP040-028-06.00-AL-P	28	6.000	37.100	2024-T4 Aluminum	Pin Hub	Single Core	35.600	4.800	11.000	12.700
		<i>0.236</i>	<i>1.461</i>				<i>1.402</i>	<i>0.189</i>	<i>0.433</i>	
# PDP040-028-06.35-303-P	28	6.350	37.135	303 Stainless Steel	Pin Hub	Single Core	35.560	4.750	11.100	12.700
		<i>0.250</i>	<i>1.462</i>				<i>1.400</i>	<i>0.187</i>	<i>0.437</i>	
# PDP040-028-06.35-303-S	28	6.350	37.135	303 Stainless Steel	Split Hub	Single Core	35.560	4.750	11.887	7.925
		<i>0.250</i>	<i>1.462</i>				<i>1.400</i>	<i>0.187</i>	<i>0.468</i>	
# PDP040-028-06.35-AL-P	28	6.350	37.135	2024-T4 Aluminum	Pin Hub	Single Core	35.560	4.750	11.100	12.700
		<i>0.250</i>	<i>1.462</i>				<i>1.400</i>	<i>0.187</i>	<i>0.437</i>	

Indicates item not stocked at time of printing - Please enquire for lead time

E&OE Pricing and all details subject to change without notice - Copyright Miniature Bearings Australia Pty Ltd

MBA Size Listings are a guide to sizes only and must not be solely relied on for critical design information.

Pulleys - Posi-Drive - 4.00 mm Circular Pitch

Part Number	Teeth No.	Bore mm	Outside Diameter mm	Material	Locking Type	Suit Belt Type mm	Pitch Diameter mm	Face Width mm	Overall Length mm	Hub Diameter
		<i>inches</i>	<i>inches</i>			<i>inches</i>	<i>inches</i>	<i>inches</i>	<i>inches</i>	
# PDP040-028-06.35-AL-S	28	6.350	37.135	2024-T4 Aluminum	Split Hub	Single Core	35.560	4.750	11.887	7.925
		<i>0.250</i>	<i>1.462</i>				<i>1.400</i>	<i>0.187</i>	<i>0.468</i>	
# PDP040-030-03.18-303-P	30	3.175	39.675	303 Stainless Steel	Pin Hub	Single Core	38.100	4.750	9.525	7.925
		<i>0.125</i>	<i>1.562</i>				<i>1.500</i>	<i>0.187</i>	<i>0.375</i>	
# PDP040-030-03.18-AL-P	30	3.175	39.675	2024-T4 Aluminum	Pin Hub	Single Core	38.100	4.750	9.525	7.925
		<i>0.125</i>	<i>1.562</i>				<i>1.500</i>	<i>0.187</i>	<i>0.375</i>	
# PDP040-030-04.00-AL-P	30	4.000	39.700	2024-T4 Aluminum	Pin Hub	Single Core	38.100	4.800	10.300	9.500
		<i>0.157</i>	<i>1.563</i>				<i>1.500</i>	<i>0.189</i>	<i>0.406</i>	
# PDP040-030-04.00-303-P	30	4.000	39.700	303 Stainless Steel	Pin Hub	Single Core	38.100	4.800	10.300	9.500
		<i>0.157</i>	<i>1.563</i>				<i>1.500</i>	<i>0.189</i>	<i>0.406</i>	
# PDP040-030-04.76-303-P	30	4.762	39.675	303 Stainless Steel	Pin Hub	Single Core	38.100	4.750	10.312	9.525
		<i>0.187</i>	<i>1.562</i>				<i>1.500</i>	<i>0.187</i>	<i>0.406</i>	
# PDP040-030-04.76-AL-P	30	4.762	39.675	2024-T4 Aluminum	Pin Hub	Single Core	38.100	4.750	10.312	9.525
		<i>0.187</i>	<i>1.562</i>				<i>1.500</i>	<i>0.187</i>	<i>0.406</i>	
# PDP040-030-06.00-303-P	30	6.000	39.700	303 Stainless Steel	Pin Hub	Single Core	38.100	4.800	11.000	12.700
		<i>0.236</i>	<i>1.563</i>				<i>1.500</i>	<i>0.189</i>	<i>0.433</i>	

Indicates item not stocked at time of printing - Please enquire for lead time

E&OE Pricing and all details subject to change without notice - Copyright Miniature Bearings Australia Pty Ltd

MBA Size Listings are a guide to sizes only and must not be solely relied on for critical design information.

Pulleys - Posi-Drive - 4.00 mm Circular Pitch

Part Number	Teeth No.	Bore mm	Outside Diameter mm	Material	Locking Type	Suit Belt Type mm	Pitch Diameter mm	Face Width mm	Overall Length mm	Hub Diameter
		<i>inches</i>	<i>inches</i>			<i>inches</i>	<i>inches</i>	<i>inches</i>	<i>inches</i>	
# PDP040-030-06.00-AL-P	30	6.000	39.700	2024-T4 Aluminum	Pin Hub	Single Core	38.100	4.800	11.000	12.700
		<i>0.236</i>	<i>1.563</i>				<i>1.500</i>	<i>0.189</i>	<i>0.433</i>	
# PDP040-030-06.35-303-P	30	6.350	39.675	303 Stainless Steel	Pin Hub	Single Core	38.100	4.750	11.100	12.700
		<i>0.250</i>	<i>1.562</i>				<i>1.500</i>	<i>0.187</i>	<i>0.437</i>	
# PDP040-030-06.35-AL-S	30	6.350	39.675	2024-T4 Aluminum	Split Hub	Single Core	38.100	4.750	11.887	7.925
		<i>0.250</i>	<i>1.562</i>				<i>1.500</i>	<i>0.187</i>	<i>0.468</i>	
# PDP040-030-06.35-AL-P	30	6.350	39.675	2024-T4 Aluminum	Pin Hub	Single Core	38.100	4.750	11.100	12.700
		<i>0.250</i>	<i>1.562</i>				<i>1.500</i>	<i>0.187</i>	<i>0.437</i>	
# PDP040-030-06.35-303-S	30	6.350	39.675	303 Stainless Steel	Split Hub	Single Core	38.100	4.750	11.887	7.925
		<i>0.250</i>	<i>1.562</i>				<i>1.500</i>	<i>0.187</i>	<i>0.468</i>	
# PDP040-032-03.18-303-P	32	3.175	42.215	303 Stainless Steel	Pin Hub	Single Core	40.640	4.750	9.525	7.925
		<i>0.125</i>	<i>1.662</i>				<i>1.600</i>	<i>0.187</i>	<i>0.375</i>	
# PDP040-032-03.18-AL-P	32	3.175	42.215	2024-T4 Aluminum	Pin Hub	Single Core	40.640	4.750	9.525	7.925
		<i>0.125</i>	<i>1.662</i>				<i>1.600</i>	<i>0.187</i>	<i>0.375</i>	
# PDP040-032-04.00-303-P	32	4.000	42.200	303 Stainless Steel	Pin Hub	Single Core	40.600	4.800	10.300	9.500
		<i>0.157</i>	<i>1.661</i>				<i>1.598</i>	<i>0.189</i>	<i>0.406</i>	

Indicates item not stocked at time of printing - Please enquire for lead time

E&OE Pricing and all details subject to change without notice - Copyright Miniature Bearings Australia Pty Ltd

MBA Size Listings are a guide to sizes only and must not be solely relied on for critical design information.

Pulleys - Posi-Drive - 4.00 mm Circular Pitch

Part Number	Teeth No.	Bore mm	Outside Diameter mm	Material	Locking Type	Suit Belt Type mm	Pitch Diameter mm	Face Width mm	Overall Length mm	Hub Diameter
		<i>inches</i>	<i>inches</i>			<i>inches</i>	<i>inches</i>	<i>inches</i>	<i>inches</i>	
# PDP040-032-04.00-AL-P	32	4.000	42.200	2024-T4 Aluminum	Pin Hub	Single Core	40.600	4.800	10.300	9.500
		<i>0.157</i>	<i>1.661</i>				<i>1.598</i>	<i>0.189</i>	<i>0.406</i>	
# PDP040-032-04.76-AL-P	32	4.762	42.215	2024-T4 Aluminum	Pin Hub	Single Core	40.640	4.750	10.312	9.525
		<i>0.187</i>	<i>1.662</i>				<i>1.600</i>	<i>0.187</i>	<i>0.406</i>	
# PDP040-032-04.76-303-P	32	4.762	42.215	303 Stainless Steel	Pin Hub	Single Core	40.640	4.750	10.312	9.525
		<i>0.187</i>	<i>1.662</i>				<i>1.600</i>	<i>0.187</i>	<i>0.406</i>	
# PDP040-032-06.00-303-P	32	6.000	42.200	303 Stainless Steel	Pin Hub	Single Core	40.600	4.800	11.000	12.700
		<i>0.236</i>	<i>1.661</i>				<i>1.598</i>	<i>0.189</i>	<i>0.433</i>	
# PDP040-032-06.00-AL-P	32	6.000	42.200	2024-T4 Aluminum	Pin Hub	Single Core	40.600	4.800	11.000	12.700
		<i>0.236</i>	<i>1.661</i>				<i>1.598</i>	<i>0.189</i>	<i>0.433</i>	
# PDP040-032-06.35-303-P	32	6.350	42.215	303 Stainless Steel	Pin Hub	Single Core	40.640	4.750	11.100	12.700
		<i>0.250</i>	<i>1.662</i>				<i>1.600</i>	<i>0.187</i>	<i>0.437</i>	
# PDP040-032-06.35-303-S	32	6.350	42.215	303 Stainless Steel	Split Hub	Single Core	40.640	4.750	11.887	7.925
		<i>0.250</i>	<i>1.662</i>				<i>1.600</i>	<i>0.187</i>	<i>0.468</i>	
# PDP040-032-06.35-AL-P	32	6.350	42.215	2024-T4 Aluminum	Pin Hub	Single Core	40.640	4.750	11.100	12.700
		<i>0.250</i>	<i>1.662</i>				<i>1.600</i>	<i>0.187</i>	<i>0.437</i>	

Indicates item not stocked at time of printing - Please enquire for lead time

E&OE Pricing and all details subject to change without notice - Copyright Miniature Bearings Australia Pty Ltd

MBA Size Listings are a guide to sizes only and must not be solely relied on for critical design information.

Pulleys - Posi-Drive - 4.00 mm Circular Pitch

Part Number	Teeth No.	Bore mm	Outside Diameter mm	Material	Locking Type	Suit Belt Type mm	Pitch Diameter mm	Face Width mm	Overall Length mm	Hub Diameter
		<i>inches</i>	<i>inches</i>			<i>inches</i>	<i>inches</i>	<i>inches</i>	<i>inches</i>	
# PDP040-032-06.35-AL-S	32	6.350	42.215	2024-T4 Aluminum	Split Hub	Single Core	40.640	4.750	11.887	7.925
		<i>0.250</i>	<i>1.662</i>				<i>1.600</i>	<i>0.187</i>	<i>0.468</i>	
# PDP040-035-03.18-303-P	35	3.175	46.025	303 Stainless Steel	Pin Hub	Single Core	44.450	4.750	9.525	7.925
		<i>0.125</i>	<i>1.812</i>				<i>1.750</i>	<i>0.187</i>	<i>0.375</i>	
# PDP040-035-03.18-AL-P	35	3.175	46.025	2024-T4 Aluminum	Pin Hub	Single Core	44.450	4.750	9.525	7.925
		<i>0.125</i>	<i>1.812</i>				<i>1.750</i>	<i>0.187</i>	<i>0.375</i>	
# PDP040-035-04.00-303-P	35	4.000	46.000	303 Stainless Steel	Pin Hub	Single Core	44.500	4.800	10.300	9.500
		<i>0.157</i>	<i>1.811</i>				<i>1.752</i>	<i>0.189</i>	<i>0.406</i>	
# PDP040-035-04.00-AL-P	35	4.000	46.000	2024-T4 Aluminum	Pin Hub	Single Core	44.500	4.800	10.300	9.500
		<i>0.157</i>	<i>1.811</i>				<i>1.752</i>	<i>0.189</i>	<i>0.406</i>	
# PDP040-035-04.76-303-P	35	4.762	46.025	303 Stainless Steel	Pin Hub	Single Core	44.450	4.750	10.312	9.525
		<i>0.187</i>	<i>1.812</i>				<i>1.750</i>	<i>0.187</i>	<i>0.406</i>	
# PDP040-035-04.76-AL-P	35	4.762	46.025	2024-T4 Aluminum	Pin Hub	Single Core	44.450	4.750	10.312	9.525
		<i>0.187</i>	<i>1.812</i>				<i>1.750</i>	<i>0.187</i>	<i>0.406</i>	
# PDP040-035-06.00-303-P	35	6.000	46.000	303 Stainless Steel	Pin Hub	Single Core	44.500	4.800	11.000	12.700
		<i>0.236</i>	<i>1.811</i>				<i>1.752</i>	<i>0.189</i>	<i>0.433</i>	

Indicates item not stocked at time of printing - Please enquire for lead time

E&OE Pricing and all details subject to change without notice - Copyright Miniature Bearings Australia Pty Ltd

MBA Size Listings are a guide to sizes only and must not be solely relied on for critical design information.

Pulleys - Posi-Drive - 4.00 mm Circular Pitch

Part Number	Teeth No.	Bore mm	Outside Diameter mm	Material	Locking Type	Suit Belt Type mm	Pitch Diameter mm	Face Width mm	Overall Length mm	Hub Diameter
		<i>inches</i>	<i>inches</i>			<i>inches</i>	<i>inches</i>	<i>inches</i>	<i>inches</i>	
# PDP040-035-06.00-AL-P	35	6.000	46.000	2024-T4 Aluminum	Pin Hub	Single Core	44.500	4.800	11.000	12.700
		<i>0.236</i>	<i>1.811</i>				<i>1.752</i>	<i>0.189</i>	<i>0.433</i>	
# PDP040-035-06.35-AL-S	35	6.350	46.025	2024-T4 Aluminum	Split Hub	Single Core	44.450	4.750	11.887	7.925
		<i>0.250</i>	<i>1.812</i>				<i>1.750</i>	<i>0.187</i>	<i>0.468</i>	
# PDP040-035-06.35-303-P	35	6.350	46.025	303 Stainless Steel	Pin Hub	Single Core	44.450	4.750	11.100	12.700
		<i>0.250</i>	<i>1.812</i>				<i>1.750</i>	<i>0.187</i>	<i>0.437</i>	
# PDP040-035-06.35-303-S	35	6.350	46.025	303 Stainless Steel	Split Hub	Single Core	44.450	4.750	11.887	7.925
		<i>0.250</i>	<i>1.812</i>				<i>1.750</i>	<i>0.187</i>	<i>0.468</i>	
# PDP040-035-06.35-AL-P	35	6.350	46.025	2024-T4 Aluminum	Pin Hub	Single Core	44.450	4.750	11.100	12.700
		<i>0.250</i>	<i>1.812</i>				<i>1.750</i>	<i>0.187</i>	<i>0.437</i>	
# PDP040-036-03.18-303-P	36	3.175	47.295	303 Stainless Steel	Pin Hub	Single Core	45.720	4.750	9.525	7.925
		<i>0.125</i>	<i>1.862</i>				<i>1.800</i>	<i>0.187</i>	<i>0.375</i>	
# PDP040-036-03.18-AL-P	36	3.175	47.295	2024-T4 Aluminum	Pin Hub	Single Core	45.720	4.750	9.525	7.925
		<i>0.125</i>	<i>1.862</i>				<i>1.800</i>	<i>0.187</i>	<i>0.375</i>	
# PDP040-036-04.00-303-P	36	4.000	47.300	303 Stainless Steel	Pin Hub	Single Core	45.700	4.800	10.300	9.500
		<i>0.157</i>	<i>1.862</i>				<i>1.799</i>	<i>0.189</i>	<i>0.406</i>	

Indicates item not stocked at time of printing - Please enquire for lead time

E&OE Pricing and all details subject to change without notice - Copyright Miniature Bearings Australia Pty Ltd

MBA Size Listings are a guide to sizes only and must not be solely relied on for critical design information.

Pulleys - Posi-Drive - 4.00 mm Circular Pitch

Part Number	Teeth No.	Bore mm	Outside Diameter mm	Material	Locking Type	Suit Belt Type mm	Pitch Diameter mm	Face Width mm	Overall Length mm	Hub Diameter
		<i>inches</i>	<i>inches</i>			<i>inches</i>	<i>inches</i>	<i>inches</i>	<i>inches</i>	
# PDP040-036-04.00-AL-P	36	4.000	47.300	2024-T4 Aluminum	Pin Hub	Single Core	45.700	4.800	10.300	9.500
		<i>0.157</i>	<i>1.862</i>				<i>1.799</i>	<i>0.189</i>	<i>0.406</i>	
# PDP040-036-04.76-303-P	36	4.762	47.295	303 Stainless Steel	Pin Hub	Single Core	45.720	4.750	10.312	9.525
		<i>0.187</i>	<i>1.862</i>				<i>1.800</i>	<i>0.187</i>	<i>0.406</i>	
# PDP040-036-04.76-AL-P	36	4.762	47.295	2024-T4 Aluminum	Pin Hub	Single Core	45.720	4.750	10.312	9.525
		<i>0.187</i>	<i>1.862</i>				<i>1.800</i>	<i>0.187</i>	<i>0.406</i>	
# PDP040-036-06.00-AL-P	36	6.000	47.300	2024-T4 Aluminum	Pin Hub	Single Core	45.700	4.800	11.000	12.700
		<i>0.236</i>	<i>1.862</i>				<i>1.799</i>	<i>0.189</i>	<i>0.433</i>	
# PDP040-036-06.00-303-P	36	6.000	47.300	303 Stainless Steel	Pin Hub	Single Core	45.700	4.800	11.000	12.700
		<i>0.236</i>	<i>1.862</i>				<i>1.799</i>	<i>0.189</i>	<i>0.433</i>	
# PDP040-036-06.35-AL-S	36	6.350	47.295	2024-T4 Aluminum	Split Hub	Single Core	45.720	4.750	11.887	7.925
		<i>0.250</i>	<i>1.862</i>				<i>1.800</i>	<i>0.187</i>	<i>0.468</i>	
# PDP040-036-06.35-AL-P	36	6.350	47.295	2024-T4 Aluminum	Pin Hub	Single Core	45.720	4.750	11.100	12.700
		<i>0.250</i>	<i>1.862</i>				<i>1.800</i>	<i>0.187</i>	<i>0.437</i>	
# PDP040-036-06.35-303-P	36	6.350	47.295	303 Stainless Steel	Pin Hub	Single Core	45.720	4.750	11.100	12.700
		<i>0.250</i>	<i>1.862</i>				<i>1.800</i>	<i>0.187</i>	<i>0.437</i>	

Indicates item not stocked at time of printing - Please enquire for lead time

E&OE Pricing and all details subject to change without notice - Copyright Miniature Bearings Australia Pty Ltd

MBA Size Listings are a guide to sizes only and must not be solely relied on for critical design information.

Pulleys - Posi-Drive - 4.00 mm Circular Pitch

Part Number	Teeth No.	Bore mm	Outside Diameter mm	Material	Locking Type	Suit Belt Type mm	Pitch Diameter mm	Face Width mm	Overall Length mm	Hub Diameter
		<i>inches</i>	<i>inches</i>			<i>inches</i>	<i>inches</i>	<i>inches</i>	<i>inches</i>	
# PDP040-036-06.35-303-S	36	6.350	47.295	303 Stainless Steel	Split Hub	Single Core	45.720	4.750	11.887	7.925
		<i>0.250</i>	<i>1.862</i>				<i>1.800</i>	<i>0.187</i>	<i>0.468</i>	
# PDP040-040-03.18-303-P	40	3.175	52.375	303 Stainless Steel	Pin Hub	Single Core	50.800	4.750	9.525	7.925
		<i>0.125</i>	<i>2.062</i>				<i>2.000</i>	<i>0.187</i>	<i>0.375</i>	
# PDP040-040-03.18-AL-P	40	3.175	52.375	2024-T4 Aluminum	Pin Hub	Single Core	50.800	4.750	9.525	7.925
		<i>0.125</i>	<i>2.062</i>				<i>2.000</i>	<i>0.187</i>	<i>0.375</i>	
# PDP040-040-04.00-303-P	40	4.000	52.400	303 Stainless Steel	Pin Hub	Single Core	50.800	4.800	10.300	9.500
		<i>0.157</i>	<i>2.063</i>				<i>2.000</i>	<i>0.189</i>	<i>0.406</i>	
# PDP040-040-04.00-AL-P	40	4.000	52.400	2024-T4 Aluminum	Pin Hub	Single Core	50.800	4.800	10.300	9.500
		<i>0.157</i>	<i>2.063</i>				<i>2.000</i>	<i>0.189</i>	<i>0.406</i>	
# PDP040-040-04.76-303-P	40	4.762	52.375	303 Stainless Steel	Pin Hub	Single Core	50.800	4.750	10.312	9.525
		<i>0.187</i>	<i>2.062</i>				<i>2.000</i>	<i>0.187</i>	<i>0.406</i>	
# PDP040-040-04.76-AL-P	40	4.762	52.375	2024-T4 Aluminum	Pin Hub	Single Core	50.800	4.750	10.312	9.525
		<i>0.187</i>	<i>2.062</i>				<i>2.000</i>	<i>0.187</i>	<i>0.406</i>	
# PDP040-040-06.00-303-P	40	6.000	52.400	303 Stainless Steel	Pin Hub	Single Core	50.800	4.800	11.000	12.700
		<i>0.236</i>	<i>2.063</i>				<i>2.000</i>	<i>0.189</i>	<i>0.433</i>	

Indicates item not stocked at time of printing - Please enquire for lead time

E&OE Pricing and all details subject to change without notice - Copyright Miniature Bearings Australia Pty Ltd

MBA Size Listings are a guide to sizes only and must not be solely relied on for critical design information.

Pulleys - Posi-Drive - 4.00 mm Circular Pitch

Part Number	Teeth No.	Bore mm	Outside Diameter mm	Material	Locking Type	Suit Belt Type mm	Pitch Diameter mm	Face Width mm	Overall Length mm	Hub Diameter
		<i>inches</i>	<i>inches</i>			<i>inches</i>	<i>inches</i>	<i>inches</i>	<i>inches</i>	
# PDP040-040-06.00-AL-P	40	6.000	52.400	2024-T4 Aluminum	Pin Hub	Single Core	50.800	4.800	11.000	12.700
		<i>0.236</i>	<i>2.063</i>				<i>2.000</i>	<i>0.189</i>	<i>0.433</i>	
# PDP040-040-06.35-303-P	40	6.350	52.375	303 Stainless Steel	Pin Hub	Single Core	50.800	4.750	11.100	12.700
		<i>0.250</i>	<i>2.062</i>				<i>2.000</i>	<i>0.187</i>	<i>0.437</i>	
# PDP040-040-06.35-303-S	40	6.350	52.375	303 Stainless Steel	Split Hub	Single Core	50.800	4.750	11.887	7.925
		<i>0.250</i>	<i>2.062</i>				<i>2.000</i>	<i>0.187</i>	<i>0.468</i>	
# PDP040-040-06.35-AL-P	40	6.350	52.375	2024-T4 Aluminum	Pin Hub	Single Core	50.800	4.750	11.100	12.700
		<i>0.250</i>	<i>2.062</i>				<i>2.000</i>	<i>0.187</i>	<i>0.437</i>	
# PDP040-040-06.35-AL-S	40	6.350	52.375	2024-T4 Aluminum	Split Hub	Single Core	50.800	4.750	11.887	7.925
		<i>0.250</i>	<i>2.062</i>				<i>2.000</i>	<i>0.187</i>	<i>0.468</i>	
# PDP040-045-03.18-303-P	45	3.175	58.725	303 Stainless Steel	Pin Hub	Single Core	57.150	4.750	9.525	7.925
		<i>0.125</i>	<i>2.312</i>				<i>2.250</i>	<i>0.187</i>	<i>0.375</i>	
# PDP040-045-03.18-AL-P	45	3.175	58.725	2024-T4 Aluminum	Pin Hub	Single Core	57.150	4.750	9.525	7.925
		<i>0.125</i>	<i>2.312</i>				<i>2.250</i>	<i>0.187</i>	<i>0.375</i>	
# PDP040-045-04.00-303-P	45	4.000	58.700	303 Stainless Steel	Pin Hub	Single Core	57.200	4.800	10.300	9.500
		<i>0.157</i>	<i>2.311</i>				<i>2.252</i>	<i>0.189</i>	<i>0.406</i>	

Indicates item not stocked at time of printing - Please enquire for lead time

E&OE Pricing and all details subject to change without notice - Copyright Miniature Bearings Australia Pty Ltd

MBA Size Listings are a guide to sizes only and must not be solely relied on for critical design information.

Pulleys - Posi-Drive - 4.00 mm Circular Pitch

Part Number	Teeth No.	Bore mm	Outside Diameter mm	Material	Locking Type	Suit Belt Type mm	Pitch Diameter mm	Face Width mm	Overall Length mm	Hub Diameter
		<i>inches</i>	<i>inches</i>			<i>inches</i>	<i>inches</i>	<i>inches</i>	<i>inches</i>	
# PDP040-045-04.00-AL-P	45	4.000	58.700	2024-T4 Aluminum	Pin Hub	Single Core	57.200	4.800	10.300	9.500
		<i>0.157</i>	<i>2.311</i>				<i>2.252</i>	<i>0.189</i>	<i>0.406</i>	
# PDP040-045-04.76-303-P	45	4.762	58.725	303 Stainless Steel	Pin Hub	Single Core	57.150	4.750	10.312	9.525
		<i>0.187</i>	<i>2.312</i>				<i>2.250</i>	<i>0.187</i>	<i>0.406</i>	
# PDP040-045-04.76-AL-P	45	4.762	58.725	2024-T4 Aluminum	Pin Hub	Single Core	57.150	4.750	10.312	9.525
		<i>0.187</i>	<i>2.312</i>				<i>2.250</i>	<i>0.187</i>	<i>0.406</i>	
# PDP040-045-06.00-303-P	45	6.000	58.700	303 Stainless Steel	Pin Hub	Single Core	57.200	4.800	11.000	12.700
		<i>0.236</i>	<i>2.311</i>				<i>2.252</i>	<i>0.189</i>	<i>0.433</i>	
# PDP040-045-06.00-AL-P	45	6.000	58.700	2024-T4 Aluminum	Pin Hub	Single Core	57.200	4.800	11.000	12.700
		<i>0.236</i>	<i>2.311</i>				<i>2.252</i>	<i>0.189</i>	<i>0.433</i>	
# PDP040-045-06.35-303-P	45	6.350	58.725	303 Stainless Steel	Pin Hub	Single Core	57.150	4.750	11.100	12.700
		<i>0.250</i>	<i>2.312</i>				<i>2.250</i>	<i>0.187</i>	<i>0.437</i>	
# PDP040-045-06.35-AL-S	45	6.350	58.725	2024-T4 Aluminum	Split Hub	Single Core	57.150	4.750	11.887	7.925
		<i>0.250</i>	<i>2.312</i>				<i>2.250</i>	<i>0.187</i>	<i>0.468</i>	
# PDP040-045-06.35-303-S	45	6.350	58.725	303 Stainless Steel	Split Hub	Single Core	57.150	4.750	11.887	7.925
		<i>0.250</i>	<i>2.312</i>				<i>2.250</i>	<i>0.187</i>	<i>0.468</i>	

Indicates item not stocked at time of printing - Please enquire for lead time

E&OE Pricing and all details subject to change without notice - Copyright Miniature Bearings Australia Pty Ltd

MBA Size Listings are a guide to sizes only and must not be solely relied on for critical design information.

Pulleys - Posi-Drive - 4.00 mm Circular Pitch

Part Number	Teeth No.	Bore mm	Outside Diameter mm	Material	Locking Type	Suit Belt Type mm	Pitch Diameter mm	Face Width mm	Overall Length mm	Hub Diameter
		<i>inches</i>	<i>inches</i>			<i>inches</i>	<i>inches</i>	<i>inches</i>	<i>inches</i>	
# PDP040-045-06.35-AL-P	45	6.350	58.725	2024-T4 Aluminum	Pin Hub	Single Core	57.150	4.750	11.100	12.700
		<i>0.250</i>	<i>2.312</i>				<i>2.250</i>	<i>0.187</i>	<i>0.437</i>	
# PDP040-050-04.76-303-P	50	4.762	65.075	303 Stainless Steel	Pin Hub	Single Core	63.500	4.750	10.312	9.525
		<i>0.187</i>	<i>2.562</i>				<i>2.500</i>	<i>0.187</i>	<i>0.406</i>	
# PDP040-050-04.76-AL-P	50	4.762	65.075	2024-T4 Aluminum	Pin Hub	Single Core	63.500	4.750	10.312	9.525
		<i>0.187</i>	<i>2.562</i>				<i>2.500</i>	<i>0.187</i>	<i>0.406</i>	
# PDP040-050-06.00-303-P	50	6.000	65.100	303 Stainless Steel	Pin Hub	Single Core	63.500	4.800	11.000	12.700
		<i>0.236</i>	<i>2.563</i>				<i>2.500</i>	<i>0.189</i>	<i>0.433</i>	
# PDP040-050-06.00-AL-P	50	6.000	65.100	2024-T4 Aluminum	Pin Hub	Single Core	63.500	4.800	11.000	12.700
		<i>0.236</i>	<i>2.563</i>				<i>2.500</i>	<i>0.189</i>	<i>0.433</i>	
# PDP040-050-06.35-AL-P	50	6.350	65.075	2024-T4 Aluminum	Pin Hub	Single Core	63.500	4.750	11.100	12.700
		<i>0.250</i>	<i>2.562</i>				<i>2.500</i>	<i>0.187</i>	<i>0.437</i>	
# PDP040-050-06.35-303-P	50	6.350	65.075	303 Stainless Steel	Pin Hub	Single Core	63.500	4.750	11.100	12.700
		<i>0.250</i>	<i>2.562</i>				<i>2.500</i>	<i>0.187</i>	<i>0.437</i>	
# PDP040-060-04.76-AL-P	60	4.762	77.775	2024-T4 Aluminum	Pin Hub	Single Core	76.200	4.750	10.312	9.525
		<i>0.187</i>	<i>3.062</i>				<i>3.000</i>	<i>0.187</i>	<i>0.406</i>	

Indicates item not stocked at time of printing - Please enquire for lead time

E&OE Pricing and all details subject to change without notice - Copyright Miniature Bearings Australia Pty Ltd

MBA Size Listings are a guide to sizes only and must not be solely relied on for critical design information.

Pulleys - Posi-Drive - 4.00 mm Circular Pitch

Part Number	Teeth No.	Bore mm	Outside Diameter mm	Material	Locking Type	Suit Belt Type mm	Pitch Diameter mm	Face Width mm	Overall Length mm	Hub Diameter
		<i>inches</i>	<i>inches</i>			<i>inches</i>	<i>inches</i>	<i>inches</i>	<i>inches</i>	
# PDP040-060-04.76-303-P	60	4.762	77.775	303 Stainless Steel	Pin Hub	Single Core	76.200	4.750	10.312	9.525
		<i>0.187</i>	<i>3.062</i>				<i>3.000</i>	<i>0.187</i>	<i>0.406</i>	
# PDP040-060-06.00-303-P	60	6.000	77.800	303 Stainless Steel	Pin Hub	Single Core	76.200	4.800	11.000	12.700
		<i>0.236</i>	<i>3.063</i>				<i>3.000</i>	<i>0.189</i>	<i>0.433</i>	
# PDP040-060-06.00-AL-P	60	6.000	77.800	2024-T4 Aluminum	Pin Hub	Single Core	76.200	4.800	11.000	12.700
		<i>0.236</i>	<i>3.063</i>				<i>3.000</i>	<i>0.189</i>	<i>0.433</i>	
# PDP040-060-06.35-303-P	60	6.350	77.775	303 Stainless Steel	Pin Hub	Single Core	76.200	4.750	11.100	12.700
		<i>0.250</i>	<i>3.062</i>				<i>3.000</i>	<i>0.187</i>	<i>0.437</i>	
# PDP040-060-06.35-AL-P	60	6.350	77.775	2024-T4 Aluminum	Pin Hub	Single Core	76.200	4.750	11.100	12.700
		<i>0.250</i>	<i>3.062</i>				<i>3.000</i>	<i>0.187</i>	<i>0.437</i>	
# PDP040-070-04.76-303-P	70	4.762	90.475	303 Stainless Steel	Pin Hub	Single Core	88.900	4.750	10.312	9.525
		<i>0.187</i>	<i>3.562</i>				<i>3.500</i>	<i>0.187</i>	<i>0.406</i>	
# PDP040-070-04.76-AL-P	70	4.762	90.475	2024-T4 Aluminum	Pin Hub	Single Core	88.900	4.750	10.312	9.525
		<i>0.187</i>	<i>3.562</i>				<i>3.500</i>	<i>0.187</i>	<i>0.406</i>	
# PDP040-070-06.00-303-P	70	6.000	90.500	303 Stainless Steel	Pin Hub	Single Core	88.900	4.800	11.000	12.700
		<i>0.236</i>	<i>3.563</i>				<i>3.500</i>	<i>0.189</i>	<i>0.433</i>	

Indicates item not stocked at time of printing - Please enquire for lead time

E&OE Pricing and all details subject to change without notice - Copyright Miniature Bearings Australia Pty Ltd

MBA Size Listings are a guide to sizes only and must not be solely relied on for critical design information.

Pulleys - Posi-Drive - 4.00 mm Circular Pitch

Part Number	Teeth No.	Bore mm	Outside Diameter mm	Material	Locking Type	Suit Belt Type mm	Pitch Diameter mm	Face Width mm	Overall Length mm	Hub Diameter
		<i>inches</i>	<i>inches</i>			<i>inches</i>	<i>inches</i>	<i>inches</i>	<i>inches</i>	
# PDP040-070-06.00-AL-P	70	6.000	90.500	2024-T4 Aluminum	Pin Hub	Single Core	88.900	4.800	11.000	12.700
		<i>0.236</i>	<i>3.563</i>				<i>3.500</i>	<i>0.189</i>	<i>0.433</i>	
# PDP040-070-06.35-AL-P	70	6.350	90.475	2024-T4 Aluminum	Pin Hub	Single Core	88.900	4.750	11.100	12.700
		<i>0.250</i>	<i>3.562</i>				<i>3.500</i>	<i>0.187</i>	<i>0.437</i>	
# PDP040-070-06.35-303-P	70	6.350	90.475	303 Stainless Steel	Pin Hub	Single Core	88.900	4.750	11.100	12.700
		<i>0.250</i>	<i>3.562</i>				<i>3.500</i>	<i>0.187</i>	<i>0.437</i>	
# PDP040-080-04.76-303-P	80	4.762	103.175	303 Stainless Steel	Pin Hub	Single Core	101.600	4.750	10.312	9.525
		<i>0.187</i>	<i>4.062</i>				<i>4.000</i>	<i>0.187</i>	<i>0.406</i>	
# PDP040-080-04.76-AL-P	80	4.762	103.175	2024-T4 Aluminum	Pin Hub	Single Core	101.600	4.750	10.312	9.525
		<i>0.187</i>	<i>4.062</i>				<i>4.000</i>	<i>0.187</i>	<i>0.406</i>	
# PDP040-080-06.00-303-P	80	6.000	103.200	303 Stainless Steel	Pin Hub	Single Core	101.600	4.800	11.000	12.700
		<i>0.236</i>	<i>4.063</i>				<i>4.000</i>	<i>0.189</i>	<i>0.433</i>	
# PDP040-080-06.00-AL-P	80	6.000	103.200	2024-T4 Aluminum	Pin Hub	Single Core	101.600	4.800	11.000	12.700
		<i>0.236</i>	<i>4.063</i>				<i>4.000</i>	<i>0.189</i>	<i>0.433</i>	
# PDP040-080-06.35-AL-P	80	6.350	103.175	2024-T4 Aluminum	Pin Hub	Single Core	101.600	4.750	11.100	12.700
		<i>0.250</i>	<i>4.062</i>				<i>4.000</i>	<i>0.187</i>	<i>0.437</i>	

Indicates item not stocked at time of printing - Please enquire for lead time

E&OE Pricing and all details subject to change without notice - Copyright Miniature Bearings Australia Pty Ltd

MBA Size Listings are a guide to sizes only and must not be solely relied on for critical design information.

Pulleys - Posi-Drive - 4.00 mm Circular Pitch

Part Number	Teeth No.	Bore mm	Outside Diameter mm	Material	Locking Type	Suit Belt Type mm	Pitch Diameter mm	Face Width mm	Overall Length mm	Hub Diameter
		<i>inches</i>	<i>inches</i>			<i>inches</i>	<i>inches</i>	<i>inches</i>	<i>inches</i>	
# PDP040-080-06.35-303-P	80	6.350	103.175	303 Stainless Steel	Pin Hub	Single Core	101.600	4.750	11.100	12.700
		<i>0.250</i>	<i>4.062</i>				<i>4.000</i>	<i>0.187</i>	<i>0.437</i>	

Indicates item not stocked at time of printing - Please enquire for lead time

E&OE Pricing and all details subject to change without notice - Copyright Miniature Bearings Australia Pty Ltd

MBA Size Listings are a guide to sizes only and must not be solely relied on for critical design information.



DISTRIBUTED BY

Ask us to put your name and address here

<http://www.minibearings.com.au/product>

Ph +61 7 3245 7977

Fax +61 7 3245 1017

Catalogue requests to catalogues@minibearings.com.au

